

GETTING TO KNOW YOUR SHARK ION ROBOT™

WELCOME! Congratulations on your purchase. Use this instruction manual to learn about your new vacuum's great features. From assembly to use to maintenance, you will find it all in here.

NOTE: When using for the first time, fully charge and discharge your Shark ION ROBOT to condition the battery. Failure to do so may cause LED indications to work incorrectly.

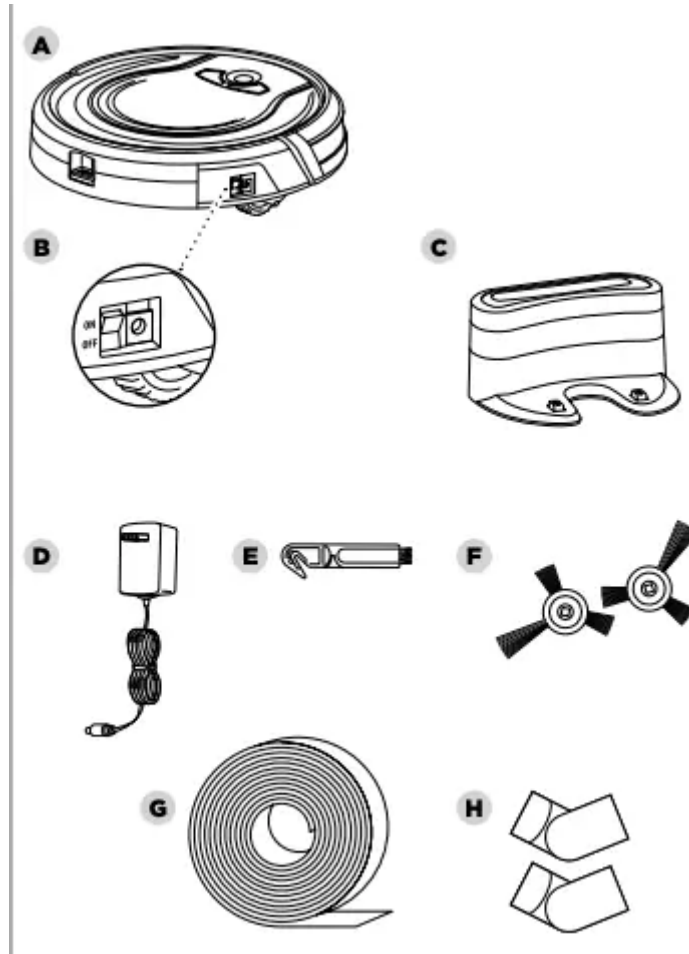

A Shark ION ROBOT

B Main Power Switch

C Charging Dock

D Charger

E Hair Removal Tool

F Side Brush (x2)

G BotBoundary™ Strip

H BotBoundary Connectors (x2)



LEAN BUTTON

To begin cleaning with your Shark ION ROBOT™, press the CLEAN button. Press button again to stop.

DOCK BUTTON

Press DOCK button to stop cleaning and send the unit back to the charging dock.

SPOT BUTTON

For thorough cleaning of an area of concentrated dust or debris, press the SPOT button.

BATTERY CHARGE INDICATOR LIGHTS

The indicator lights display the amount of charge remaining in the battery. See page for more details.

ERROR INDICATOR

When a blockage or a filter problem occurs, the “!” error indicator light will illuminate. Clear any blockages and clean filters. Remove dust bin and make sure nothing is blocking suction. See page 21 for a full list of error codes.

WI-FI INDICATOR

Illuminates blue when unit is connected to Wi-Fi. If the icon illuminates red, the connection has been lost. When the icon is flashing blue, the robot is in setup mode. When the icon is off, the robot has not been set up to connect to the Internet.

CHARGING YOUR SHARK ION ROBOT™

IMPORTANT: Install the charging dock in a location that can be easily accessed by your Shark ION ROBOT. Always keep the charging dock plugged in, or the Shark ION ROBOT will not be able to automatically return to the base. The Shark ION ROBOT will beep when it is first connected to power or when it starts charging on the dock.

RECYCLING YOUR BATTERY

When your robot's battery needs to be replaced, dispose of it or recycle it in accordance with local ordinances or regulations. In some areas, it is illegal to place spent lithium-ion batteries in the trash or in a municipal solid waste stream. Return spent batteries to an authorized recycling center or to retailer for recycling. Contact your local recycling center for information on where to drop off the spent battery

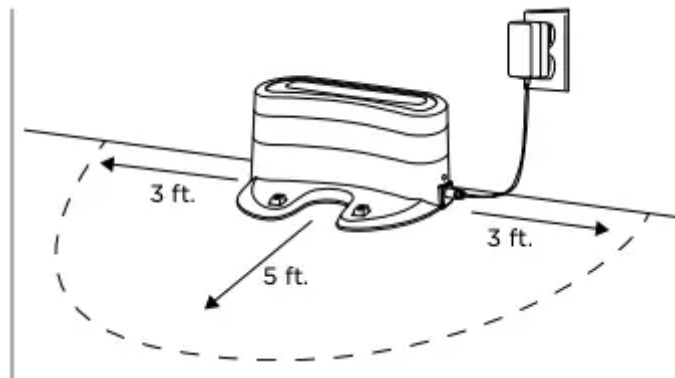

INSTALLING THE CHARGING DOCK

Set the charging dock on a hard, level surface, with its back against the wall. Remove any objects that are closer than 3 feet (1 meter) from either side of the base, or closer than 5 feet (1.52 meters) from the front of the base. Plug the charging cable into the port on the side of the dock, and connect the charger plug to a wall outlet.



IMPORTANT CHARGING INFORMATION

The Shark ION ROBOT has a pre-installed rechargeable battery. Battery must be fully charged before using. The Power switch must be in the ON position in order to charge the battery. When the cleaning cycle is complete or the battery is running low, Shark ION ROBOT will automatically return to the charging dock. If your unit doesn't return to the dock, the battery charge may have run out. See charging instructions on page 10.

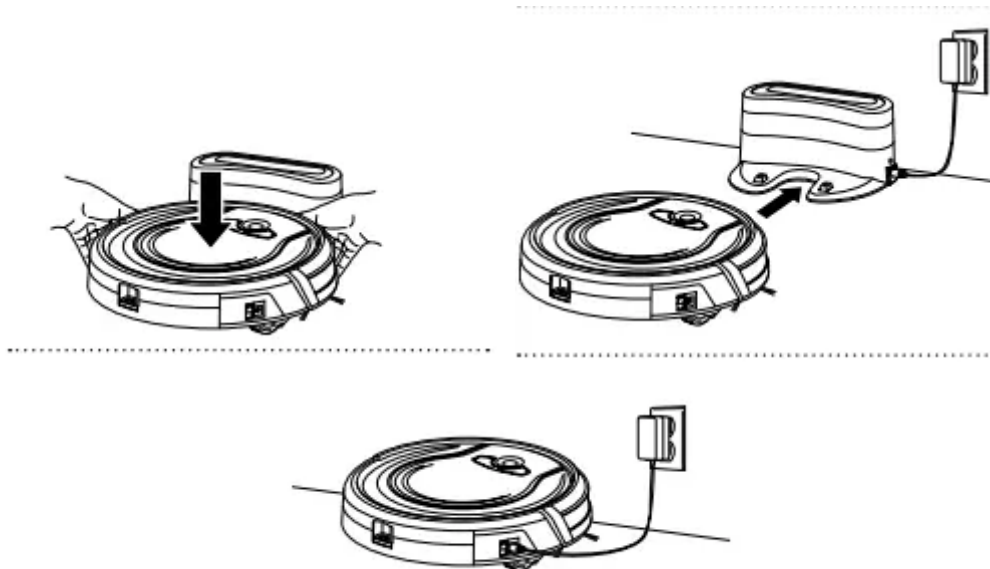

Shark ION ROBOT™ can be charged three different ways:

- 1 Manually place Shark ION ROBOT on the charging dock, aligning its charging pads with the charging contacts on the base.
- 2 Using the app, press the DOCK button to automatically send Shark ION ROBOT to the charging dock.
- 3 To charge unit directly, plug the charger into a wall outlet, then connect the charger cable to the jack on the side of the Shark ION ROBOT.

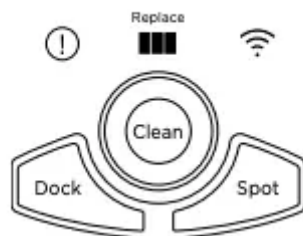

BATTERY CHARGE INDICATOR LIGHTS

While the battery is charging, all three blue LED lights will cycle until fully charged.



As the unit cleans, its battery discharges. The blue lights indicate how much charge is remaining.



If the red “Replace” light is on, then the battery needs to be replaced. See page 20 for more information. If all the battery indicator lights are off, then either the power switch is turned off or



there is no charge remaining. Turn the Power switch to the ON position. If all indicator lights remain off, then charge the unit directly, using the charger.

SETTING UP YOUR SHARK ION ROBOT™

NOTE: Some carpets may cause the robot to malfunction due to pile height.

IMPORTANT: Before cleaning an entire room for the first time, we recommend that you first test your unit on a small section of the floor to ensure there is no scratching.

IMPORTANT: Shark ION ROBOT uses cliff sensors to avoid stairs and other steep drops. Sensors may work less effectively when they are dirty. For best results, clean sensors as needed.

TIP: Turn off the power switch if Shark ION ROBOT will not be used for a long period of time.

TIP: To preserve battery life, unit should be recharged at least once every three months

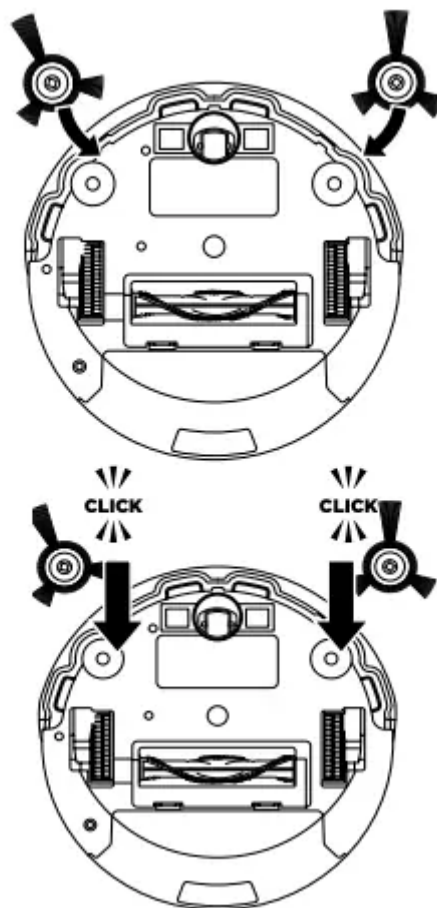

INSTALLING THE SIDE BRUSHES

- 1 Turn the unit over.
- 2 Align hole in center of side brush over brush post on bottom of unit.
- 3 Press side brush down over the post until it snaps into place.

USING YOUR SHARK ION ROBOT™



DOWNLOADING THE SHARK APP

The app will guide you through easy setup of your Shark ION ROBOT, and allow you to schedule cleaning times and to control the unit remotely.

The app will also provide access to:

- Tips, Tricks, and FAQs
- Tech Support
- Troubleshooting

NOTE: Before cleaning, the robot's power must be turned on. Press the top of the power switch on the side of the unit to turn on power.

TIP: Shark ION ROBOT will automatically return to the charging dock when the battery level is low.

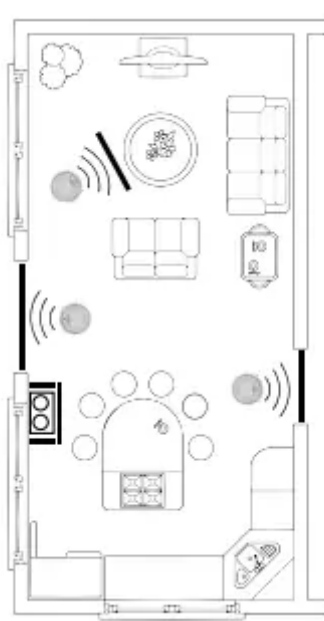

BOTBOUNDARY™ STRIPS

You may need to keep Shark ION ROBOT away from certain areas, such as pet bowls, fragile objects, power strips, or doorways. Use the BotBoundary strips to quickly and easily create “no-go zones” to keep Shark ION ROBOT out of the areas you would like it to avoid.

- 1 Identify areas or objects you want Shark ION ROBOT to avoid. Cut the BotBoundary strip to the desired length so that it covers the entire perimeter of an object or spans the length of the doorway you want to block off. With the provided connecting joints, you can shape the strips to fit your needs. Insert the ends of the strips into the connecting joints to form angles and create customized boundaries. You can connect up to four BotBoundary strips at a time.
- 2 Place the strips on the floor or under an area rug to create perimeters around the objects and areas you'd like to block.

NOTE: If blocking an object, place the BotBoundary strip two inches in front to ensure ION ROBOT will not bump into it.

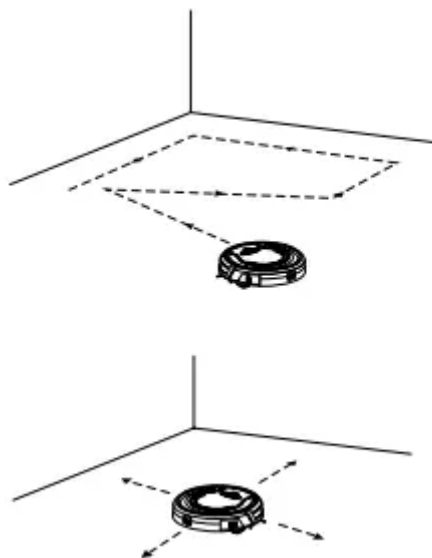

CLEANING MODES Manual Start/Stop

You can manually start and stop Shark ION ROBOT™.

- 1 To start cleaning, press the CLEAN button on Shark ION ROBOT or the CLEAN/ENTER button on the mobile app. Shark ION ROBOT selects different cleaning modes and automatically operates until cleaning is complete.
- 2 To stop the unit before it automatically finishes cleaning and returns to dock, press the CLEAN button on Shark ION ROBOT or the CLEAN/ENTER button on the mobile app.

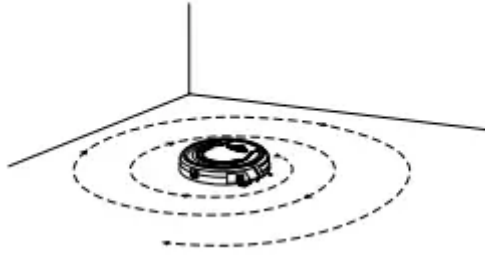

Spot Cleaning

In Spot mode, Shark ION ROBOT will thoroughly clean an area in a spiral pattern. Use Spot mode to clean a concentrated area of dust or debris.

1. To start cleaning in Spot mode, press the SPOT button on Shark ION ROBOT or on the mobile app.

SENDING SHARK ION ROBOT TO CHARGING DOCK

To return the unit to the Charging Dock, press the DOCK button on the unit or on the mobile app.

MAINTAINING YOUR SHARK ION ROBOT™

WARNING: Wash the dust bin and filter cover with water only. Be sure to air-dry them completely before reassembling. DO NOT wash the HEPA filter with water, as it may damage the filter and reduce suction power.

CAUTION: Turn off power before performing any maintenance.

TIP: For best results, empty the dust bin after every cleaning.

RECOMMENDED CLEANING SCHEDULE:

Dust Bin

Empty after each use

Main Brushroll

Check weekly

Side Brushes

Check weekly

Dust Bin Filter

Clean weekly

Front Caster Wheel

Remove and clean weekly

RECOMMENDED REPLACEMENT SCHEDULE:

Main Brushroll

Every 6–12 months

Side Brushes

When visibly worn

Dust Bin Filter

Every 2 months

Front Caster Wheel

Every 12 months

EMPTYING THE DUST BIN

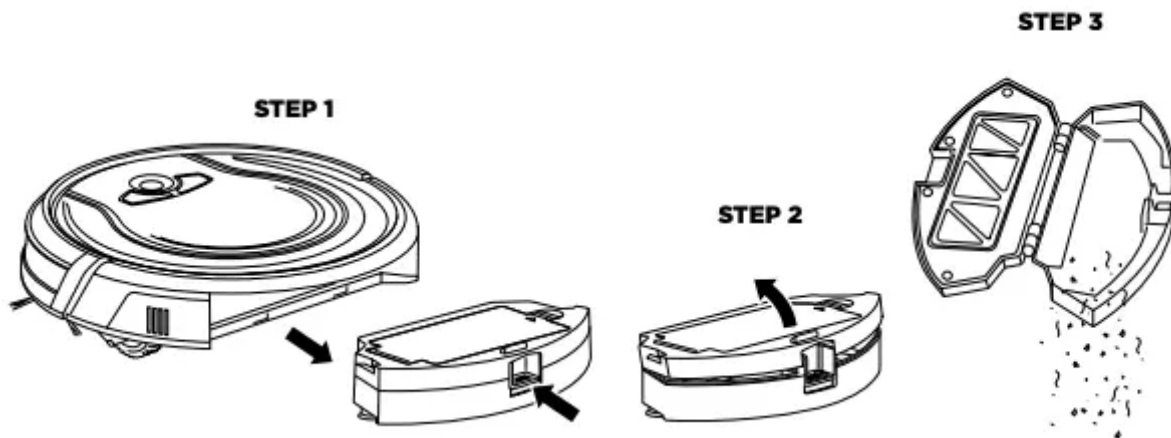

- 1 Press the dust bin removal latch and slide out the dust bin.
- 2 Open the dust bin.
- 3 Empty debris and dust into trash.

CLEANING THE FILTERS

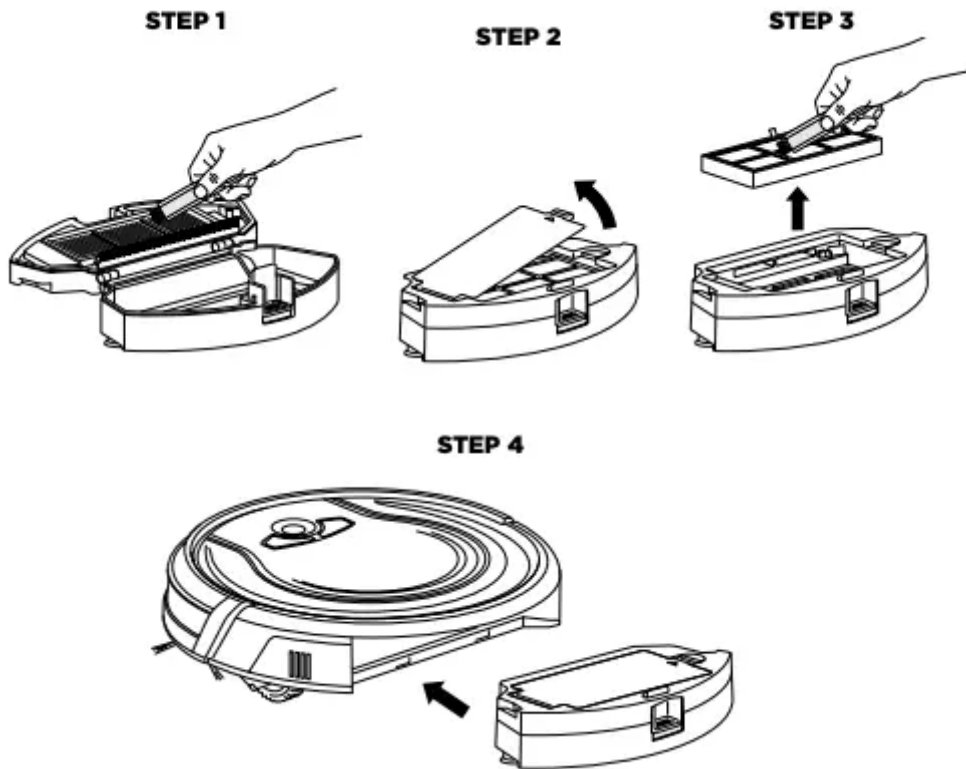

- 1 With the dust bin out of the unit, clear hair from the Anti-Tangle Comb on the dust bin.
- 2 Press the filter door release button to open the door and remove the filters.
- 3 Clean the dust bin and filters with a cleaning brush.
- 4 Replace the filters and the filter cover. Close the dust bin and slide it back into Shark ION ROBOT™.

CAUTION: Turn off power before performing any maintenance.

NOTE: When cleaning brushroll, be sure to not cut anything other than hair, string, fibers, or other debris.

CLEANING THE BRUSHROLL

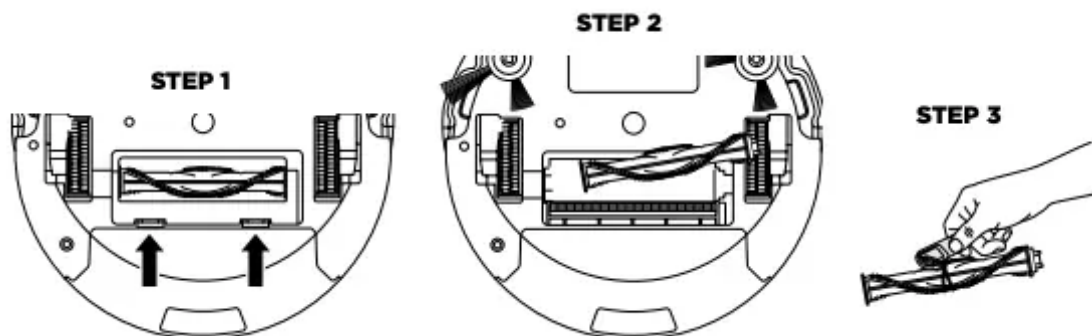

- 1 Push up on the tabs on the brushroll access door, then lift off the door.

- 2 Remove the brushroll.
- 3 Clean the brushroll with the provided hair removal tool.
- 4 To reinstall the brushroll, insert the flat end first, then the protruding end, then click brushroll securely into place.
- 5 Close the brushroll access door and press down until it clicks into place.

CLEANING THE CLIFF SENSORS AND CHARGING PADS

For best results, clean cliff sensors and charging pads periodically as needed. With a cloth or a cleaning brush, gently dust off the sensors and pads.

CLEANING THE SIDE BRUSHES

The side brushes need regular cleaning, as dirt may adhere to them and hair and fibers can easily get tangled in them.

1. Carefully unwind and remove string and hair from side brushes.
2. Gently wipe side brushes with a damp cloth. Be sure to let them air-dry completely before replacing them.

REPLACING THE SIDE BRUSHES

To remove a bent or damaged side brush, pull it off its post. To install new side brush, align hole in center of brush over post on bottom of unit. Press side brush down over the post until it clicks into place.

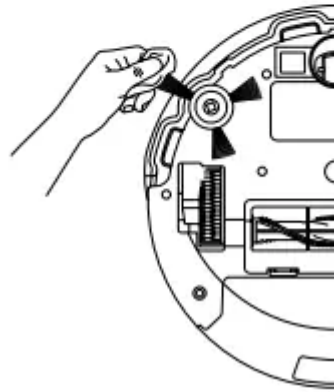
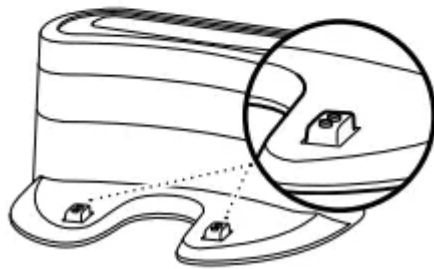
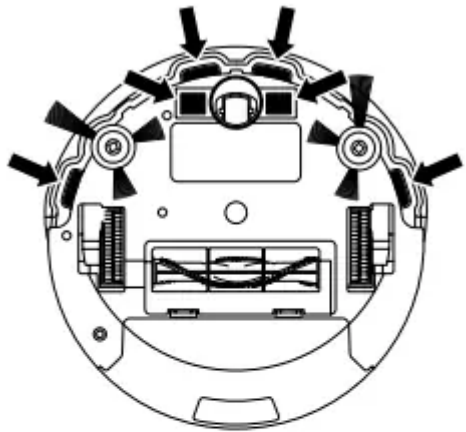

CAUTION: Turn off power before performing any maintenance.

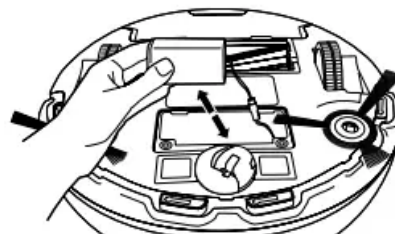
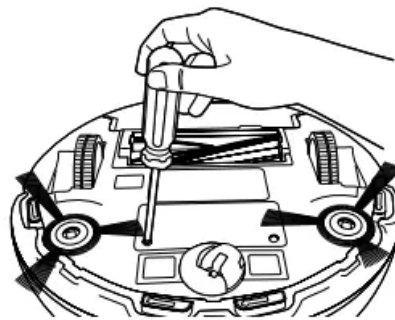
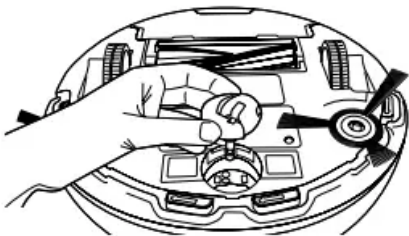

CLEANING THE REMOVABLE FRONT WHEEL

The sensor below the removable rotating front wheel on the bottom of the unit should be cleaned once a week. Pull out the wheel and carefully dust the sensor in the cavity below. Replace the wheel and push it in until it clicks into place.

REPLACING THE BATTERY

When the battery needs replacement, the red "Replace" light will illuminate.

To remove the battery, turn the unit over and unscrew the battery cover with a Phillips-head screwdriver. Unplug the old battery from its connector, then plug in the new battery. Replace battery cover and screw it back into place.

Replacement batteries can be purchased at [sharkaccessories](#)

TIPS AND TRICKS FOR GREAT PERFORMANCE

CORDS AND OBSTRUCTIONS

Always prep your home before cleaning. Some furniture or loose cords may create problems for your robot. Clear away cords and obstructions or block off the area with the included BotBoundary™ strips.

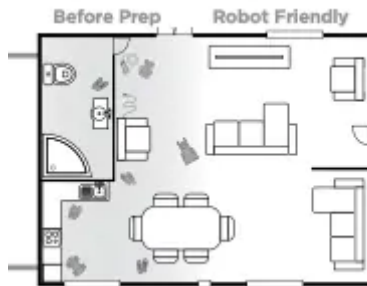

LOW-CLEARANCE FURNITURE

Your robot may find its way under furniture with low clearance, but not be able to free itself. Use furniture risers to increase clearance, or create a no-go zone with the included BotBoundary strips.

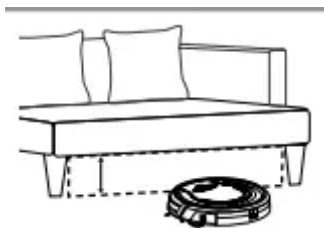

DOORWAY THRESHOLDS

Your robot can easily climb over most common thresholds. However in some situations they may present a challenge. Use the included BotBoundary strips to block off these areas.

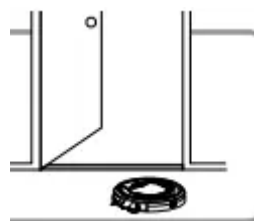

RETURNING TO DOCK

Make sure the dock is set up as shown. If your robot roams too far, it could have trouble finding the dock. It may be helpful to block off part of your home with the included BotBoundary strips, or to add a second dock (available at sharkaccessories)

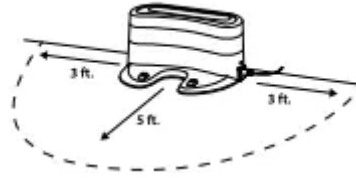

Tip: You can use the included connectors to create angles with your included BotBoundary strips.

PREPPING YOUR HOME USING BOTBOUNDARY™ STRIPS

Use the BotBoundary strips to quickly and easily create “no-go zones” to keep your robot out of the areas you would like it to avoid. These may include:



- Near power cords that might cause tangles
- Hallways where you'd rather your robot not travel
- Around furniture with low clearance that may trap your robot

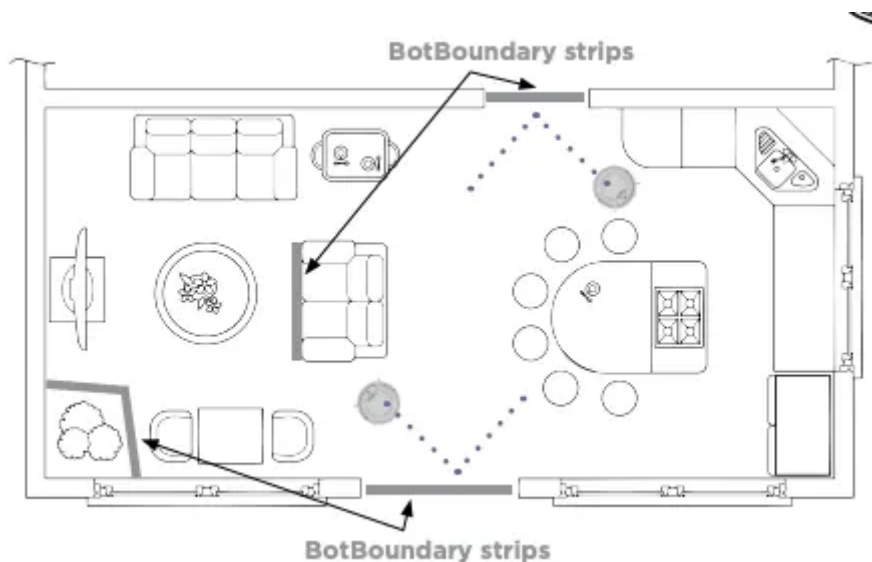

USAGE INSTRUCTIONS

- 1. Cut the BotBoundary strip to the desired length, 18" Minimum, so it covers the entire perimeter of an object or spans the length of the doorway you'd rather your robot not cross.
- 2. Simply lay the BotBoundary strip flat on the floor or under an area rug. For best results, make sure your BotBoundary strip is completely flat against the floor.
- 3. With the provided connectors, you can create angles to customize the BotBoundary strips to fit your home.

When setting up your BotBoundary strips it is useful to either make a closed loop around an object using the included connectors or to place them between fixed objects, like door frames or legs of a couch.

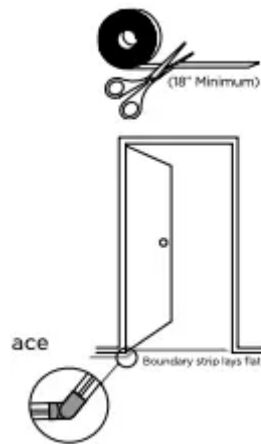

TROUBLESHOOTING GUIDE

WARNING: Always turn off Power switch before performing any maintenance

If any error lights are illuminated or flashing on your Shark ION ROBOT™, see the error code chart below:

All LED lights are off Unit is turned off.

- Cycle power switch. If no response, plug in to charge unit.

Red "Replace" LED light is on

- Your battery is ready to be replaced. Visit sharkclean for replacement

DOCK and SPOT alternate flashing

- A side brush is stuck. Remove debris from side brushes.

DOCK and SPOT flashing together

- Something is stuck in the main brushroll. Remove obstruction.

CLEAN flashing blue

- The front wheel sensor, drop sensor, or bumper is reporting an error. Make sure your robot is able to move freely by moving it to a new location on a level surface. Make sure the front bumper is not stuck. If Clean light continues to flash blue, remove the front wheel and clean the wheel cavity.

SPOT flashing blue

- The unit cannot move due to surface or obstruction. Move robot to a new location.

CLEAN flashing red

- Cliff sensors are reporting an error. Wipe cliff sensors with a clean cloth.
- Robot cannot start due to an error. Ensure your robot is on a level surface with no obstructions.

"!" symbol flashing

- Suction motor failure. Remove blockages and clean filters. Remove dust bin and make sure nothing is blocking suction.

CLEAN flashing red and "!" stays solid red

- Your charger is experiencing an issue. Please contact Customer Service at 1-800-798-7398.

"!" and CLEAN symbols flashing

- Your robot's BotBoundary™ sensors are reporting an error. Please contact Customer Service at 1-800-798-7398.

CLEAN solid red

- The dust bin has been removed and needs to be reinserted.

CLEAN solid blue

- Your robot is in sleep mode. Press any button on the robot or remote to start it again.

Warning

This content is compiled from multiple sources and is provided for reference purposes only. It may not be complete or fully applicable to all situations. If you are unable to resolve your issue, please contact the product manufacturer or an authorized service provider for official support.