

Owner Manual Remote





PRODUCT DISPOSAL (EUROPEAN DIRECTIVE 2002/96/EC)

The crossed out wheeled bin symbol on this product ensures that this product is manufactured using high quality components that can be recycled and reused according European Directive 2002/96/EC. Please do not dispose this product with your normal household waste but inform yourself about the local separate collection for electrical and electronic products to dispose this product correctly. This will help preventing potential negative effects on the environment and/or human health.

BATTERY DISPOSAL (EUROPEAN DIRECTIVE 2006/66/EC)

Please do not dispose your batteries with your normal household waste but inform yourself about the local separate collection for empty batteries to dispose them correctly. This will help preventing potential negative effects on the environment and/or human health.

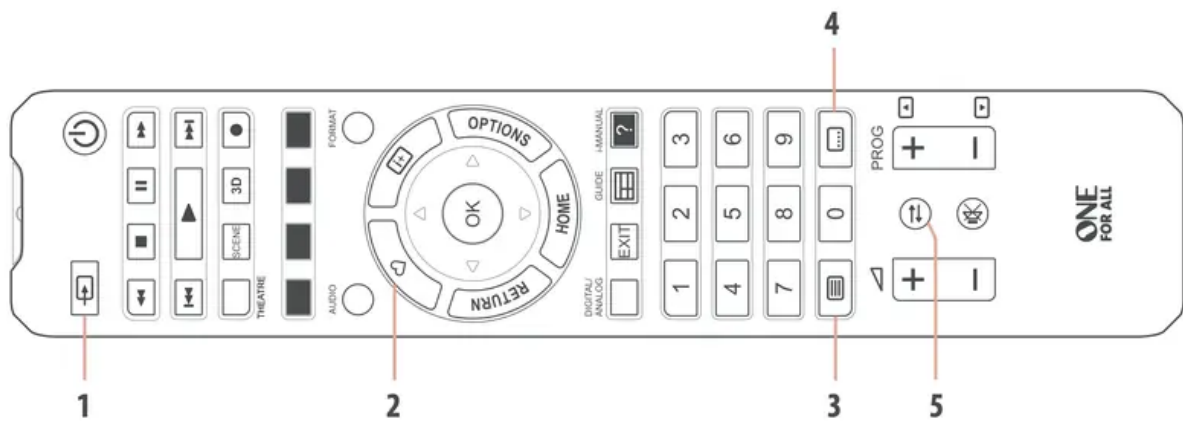

1. INPUT SELECT

AV Input

2. FAVOURITE

Access your Favourite Channel List

3. TEXT

Teletext On

4. SUBTITLE

Subtitles

5. LAST CHANNEL

Previous Channel

STEP 1: SET UP YOUR TELEVISION

THE MAJORITY OF NEWER SONY TVS SHOULD WORK DIRECTLY.

After putting batteries in, just test some of the keys, and if they work, your remote is ready. If not, follow the next steps:

1. Make sure your TV is on (not on standby).

Hold down RED + BLUE until the LED behind the Power Key blinks twice.

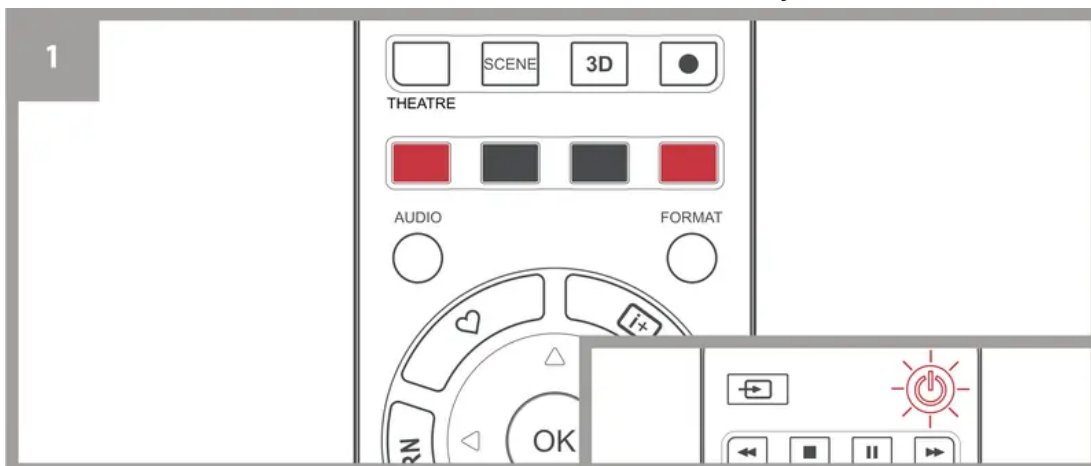

2. Point towards the TV and hold down the POWER KEY until the TV turns off.

The remote will send a different Power signal every 3 seconds. As soon as the TV turns off, let go of the POWER KEY.

The LED will blink twice. Now test the rest of the keys on the remote. If they work as your original did, your remote is ready to use.

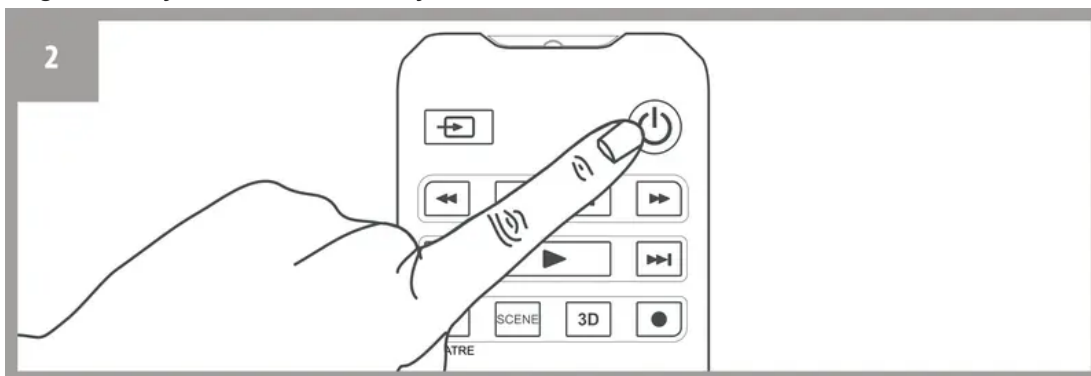

If you find some keys still do not work as expected (or not at all), proceed to the next step.

STEP 2: IF STEP 1 DOES NOT WORK AS EXPECTED

ARE SOME KEYS NOT WORKING AS EXPECTED?

If you find some keys do not work as expected (or not at all), proceed to the next step.

1. Make sure your TV is on (not on standby).

Hold down RED + BLUE until the LED behind the Power Key blinks twice.

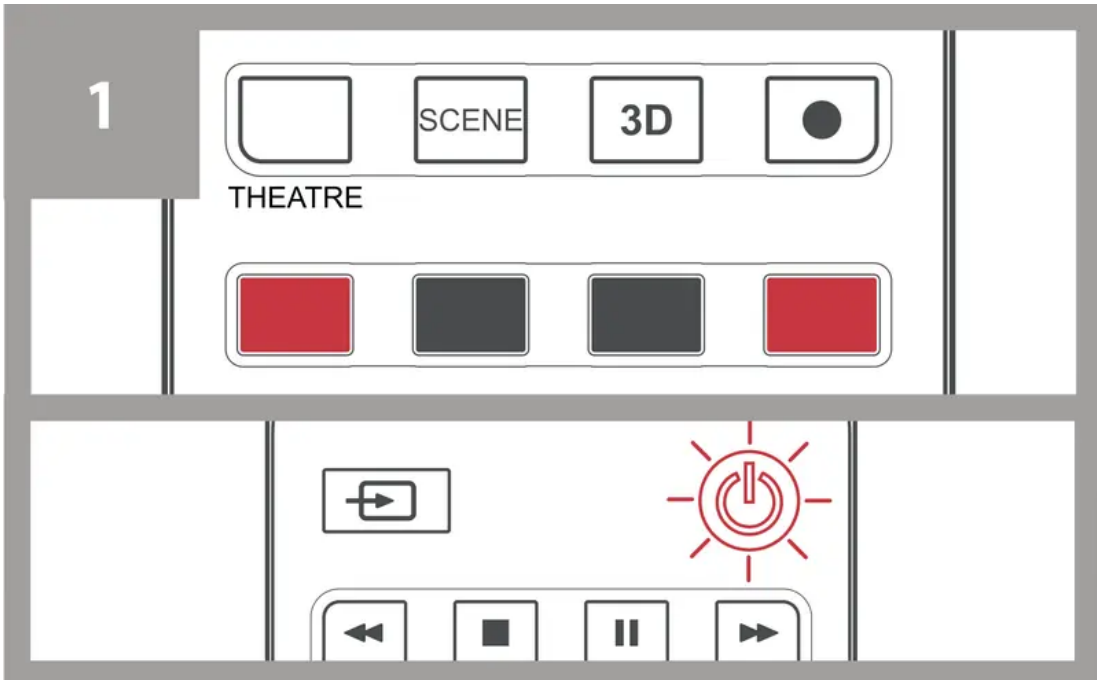

2. Point towards the TV and hold one of the keys that is not working correctly (for example HOME).

The remote will send a signal every 3 seconds.

When the correct function is shown on the screen (in this case the HOME), let go of the key.

The LED will blink twice - your remote is ready to use.

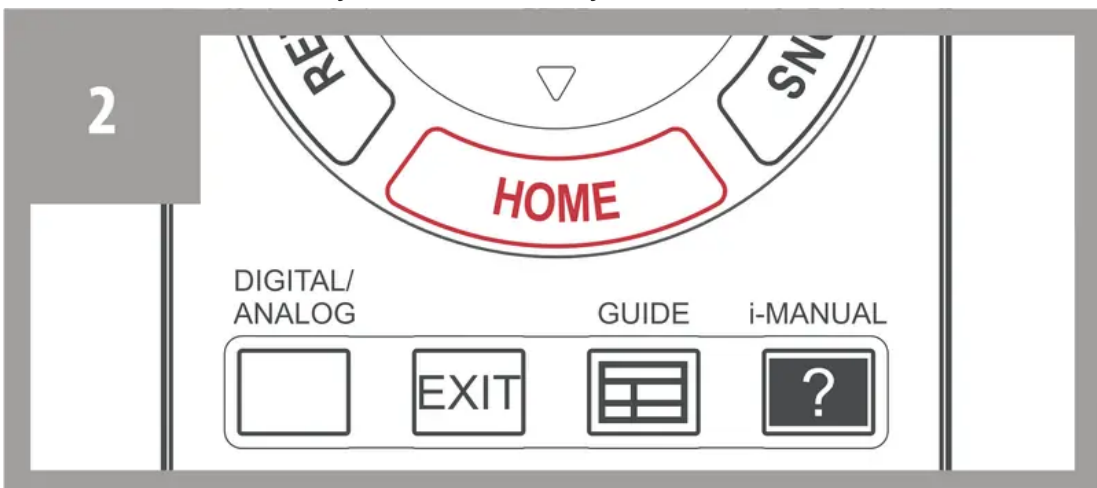

If you find some keys still do not work as expected (or not at all), proceed to the next step.

3. Make sure your TV is on (not on standby).

Hold down RED + BLUE until the LED behind the Power Key blinks twice.

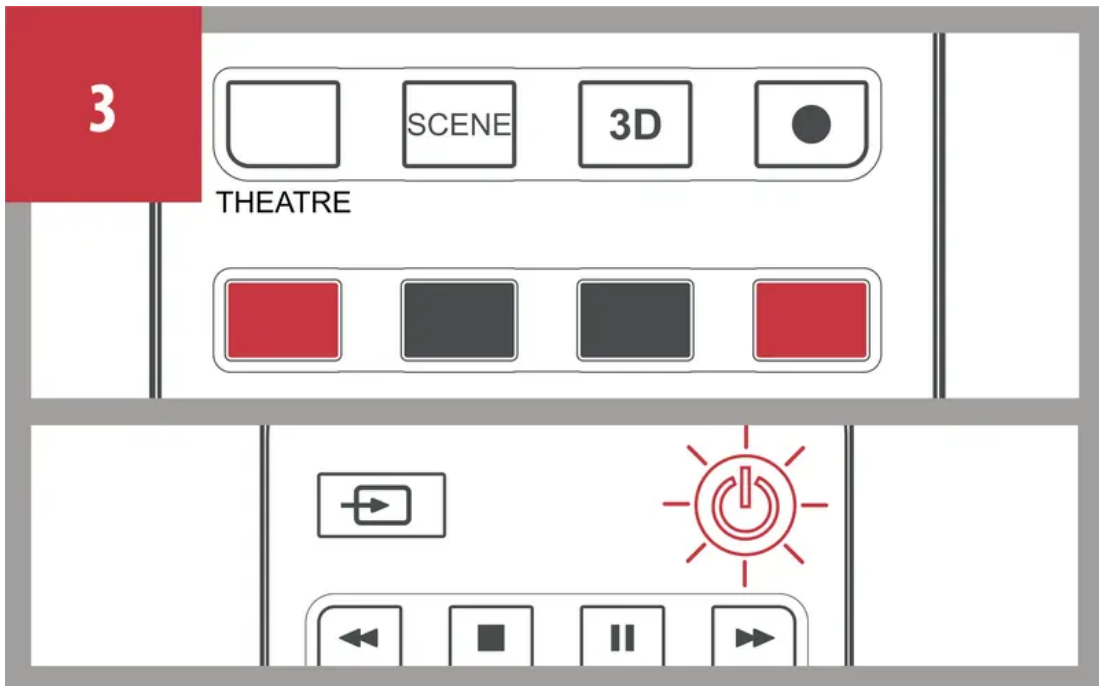

4. Point towards the TV and hold one of the keys that is not working correctly. The remote will send a signal every 3 seconds.

When the correct function is shown on the screen, let go of the key.

The LED will blink twice. Now test the rest of the keys on the remote, if they work as your original did, your remote is ready to use.

If you still find some keys are not working, repeat steps 3 and 4.

LEARNING

START: LEARN A NEW FUNCTION TO YOUR REMOTE

Your One For All remote can learn any function from your original (working) remote.

1. Place the original remote facing the One For All remote on a flat surface.

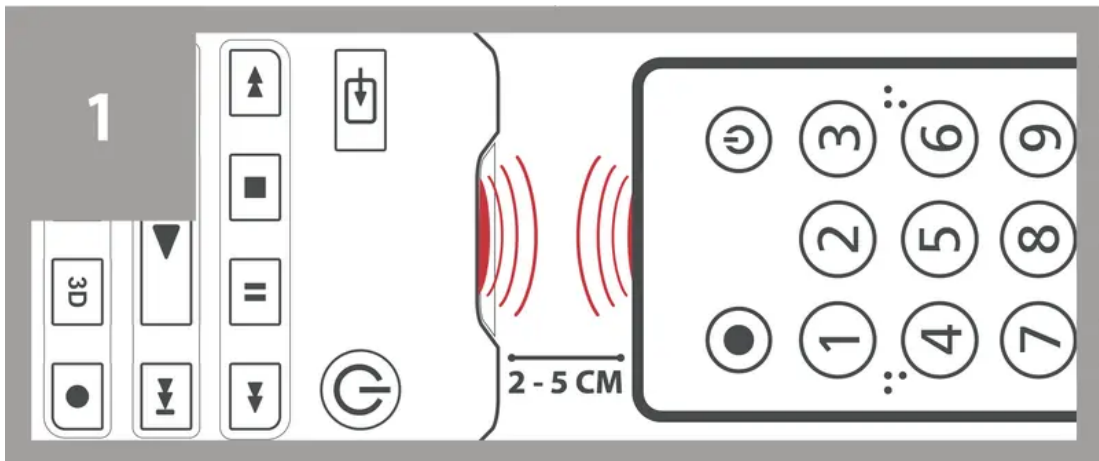

2. To learn: Hold down GREEN + YELLOW until the LED blinks twice.

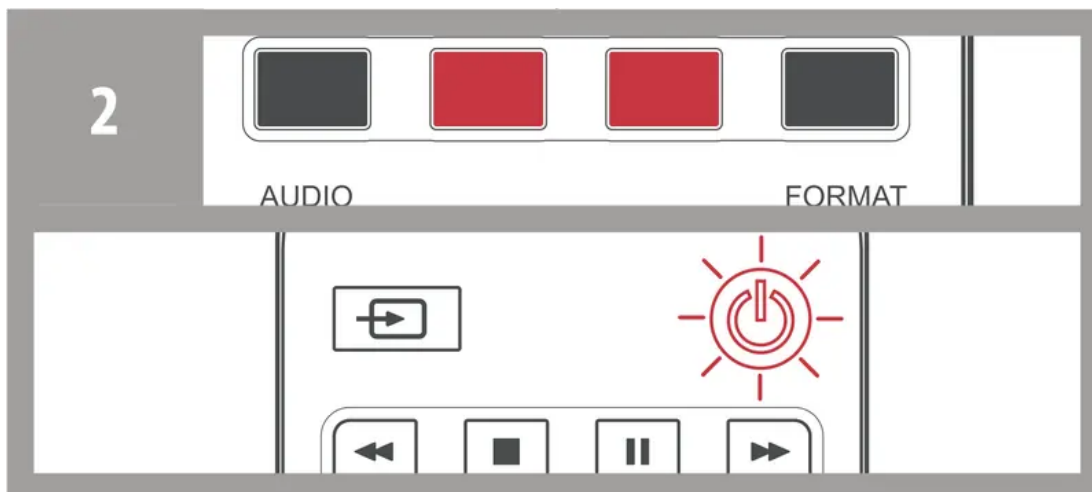

3. Press **975**. The LED will blink twice.

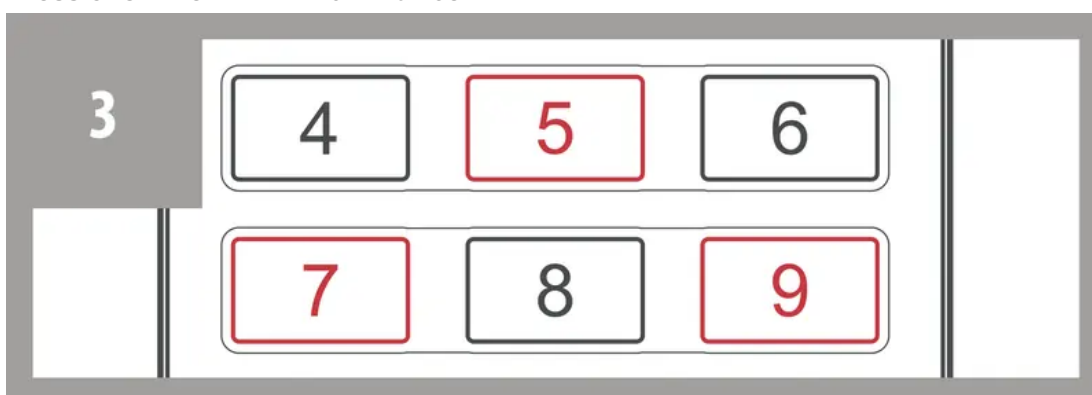

4. Press the key on the One For All remote you want to learn on, for example: the **VOL +** key.

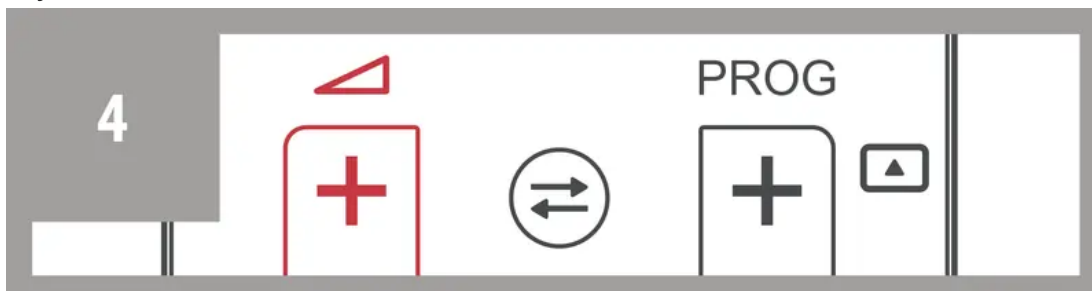

5. Press the key on the original remote you want to learn, for example: the **VOL +** key of your AUDIO remote.

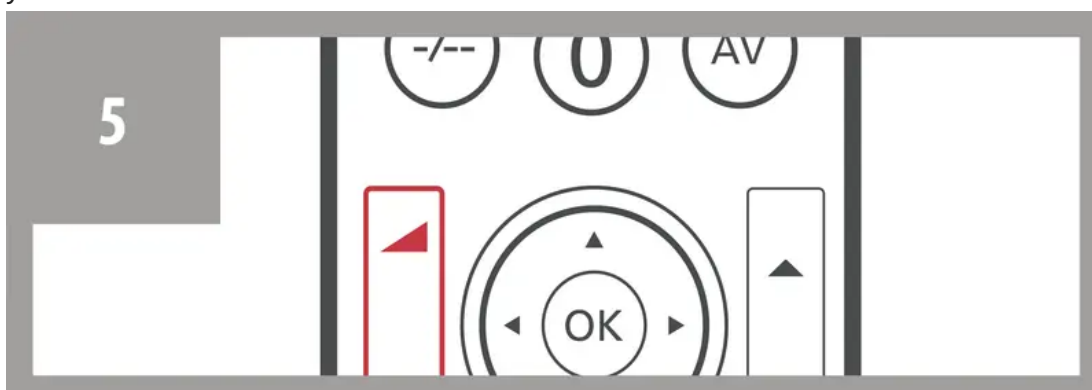

6. **Two blinks:** ok. Repeat from step 4 for any more keys to learn.

Long blink: try again from step 4.

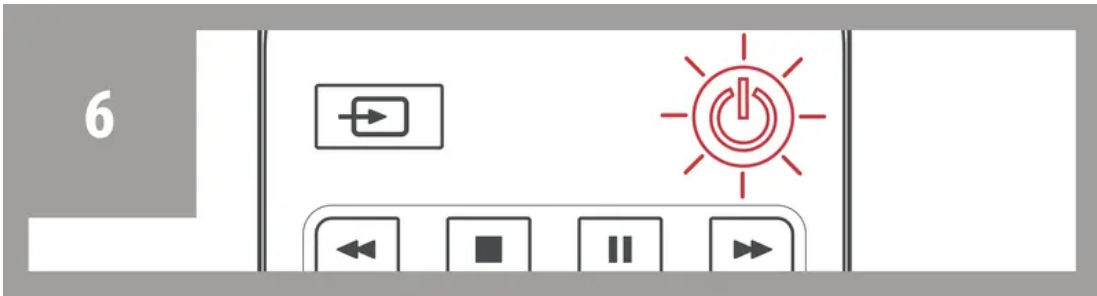

7. When you have learned all the keys you need, press and hold the **OK KEY** for 3 seconds. The LED will blink twice.

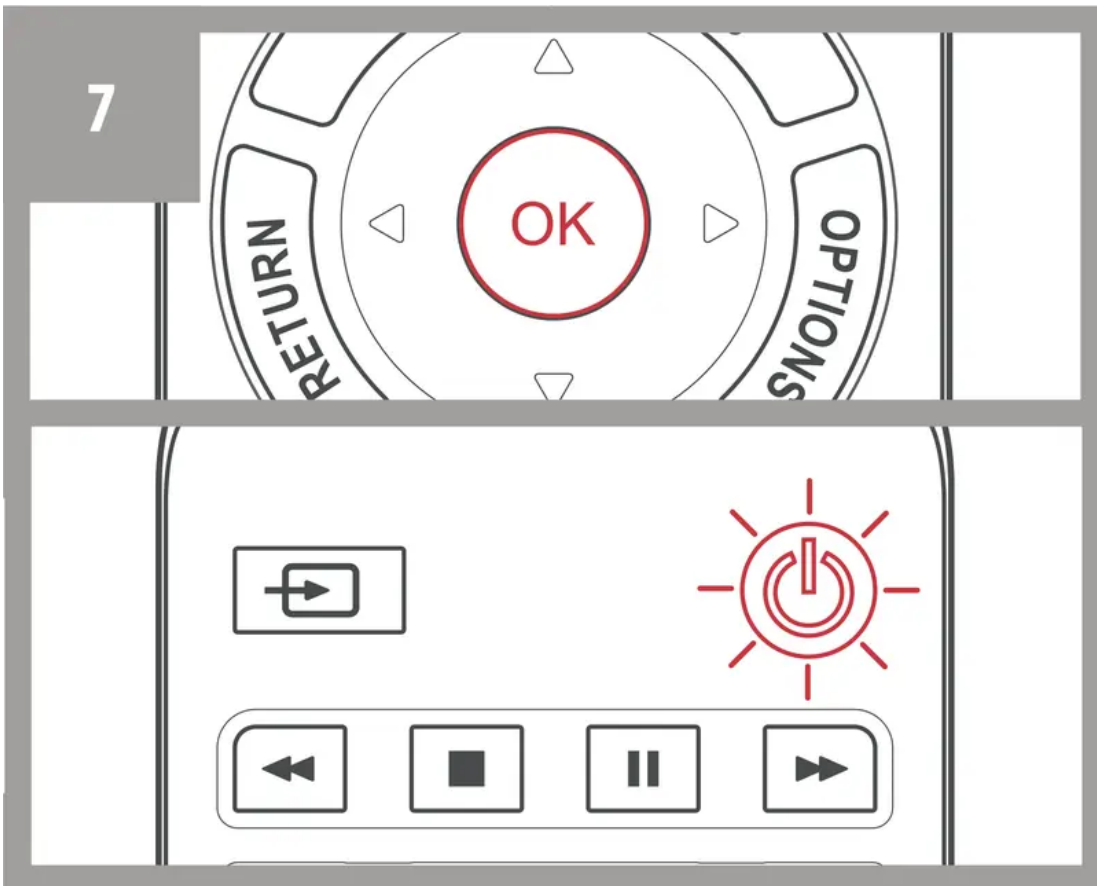

HOW TO DELETE A LEARNED FUNCTION

1. Hold down GREEN + YELLOW until the LED blinks twice.
2. PRESS 976.
3. Press the key to reset twice.

The LED flashes twice and the key will be restored to the original function.

Warning

This content is compiled from multiple sources and is provided for reference purposes only. It may not be complete or fully applicable to all situations. If you are unable to resolve your issue, please contact the product manufacturer or an authorized service provider for official support.

Document generated by [ManualsFile](#)

