

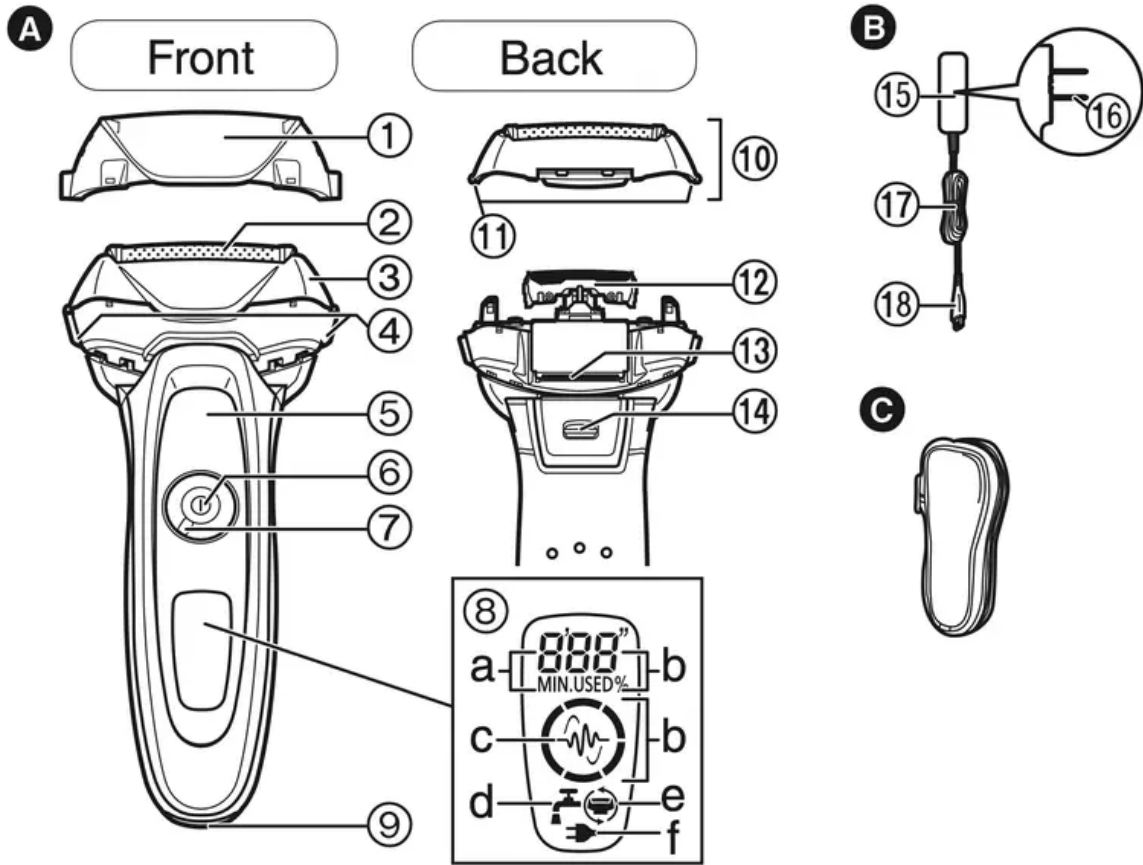

Parts Identification



A. Main body

1. Protective cap
2. System outer foil
3. Foil frame
4. Foil frame release buttons
5. Finger rest
6. Power switch
7. Lock ring
8. Lamp display
 - a. Used time lamp
 - b. Battery capacity lamp
 - c. Shaving sensor lamp ()
 - d. Clean lamp

- e. Foil/blade check lamp
- f. Charge status lamp ()
- 9. Appliance socket
- 10. Outer foil section
- 11. System outer foil release buttons
- 12. Inner blades
- 13. Trimmer
- 14. Trimmer handle

B. AC Adaptor

- 15. Power plug
- 16. Cord
- 17. Appliance plug

Accessory

C. Travel case

Using the lock ring

Use the lock ring to lock or unlock the power switch. Rotate the lock ring until it clicks.

Rotate the lock ring to “ o ” to unlock the power switch: Used when shaving, washing the shaver, lubricating the shaver.





Rotate the lock ring to “  ” to lock the power switch: Used when carrying the shaver.

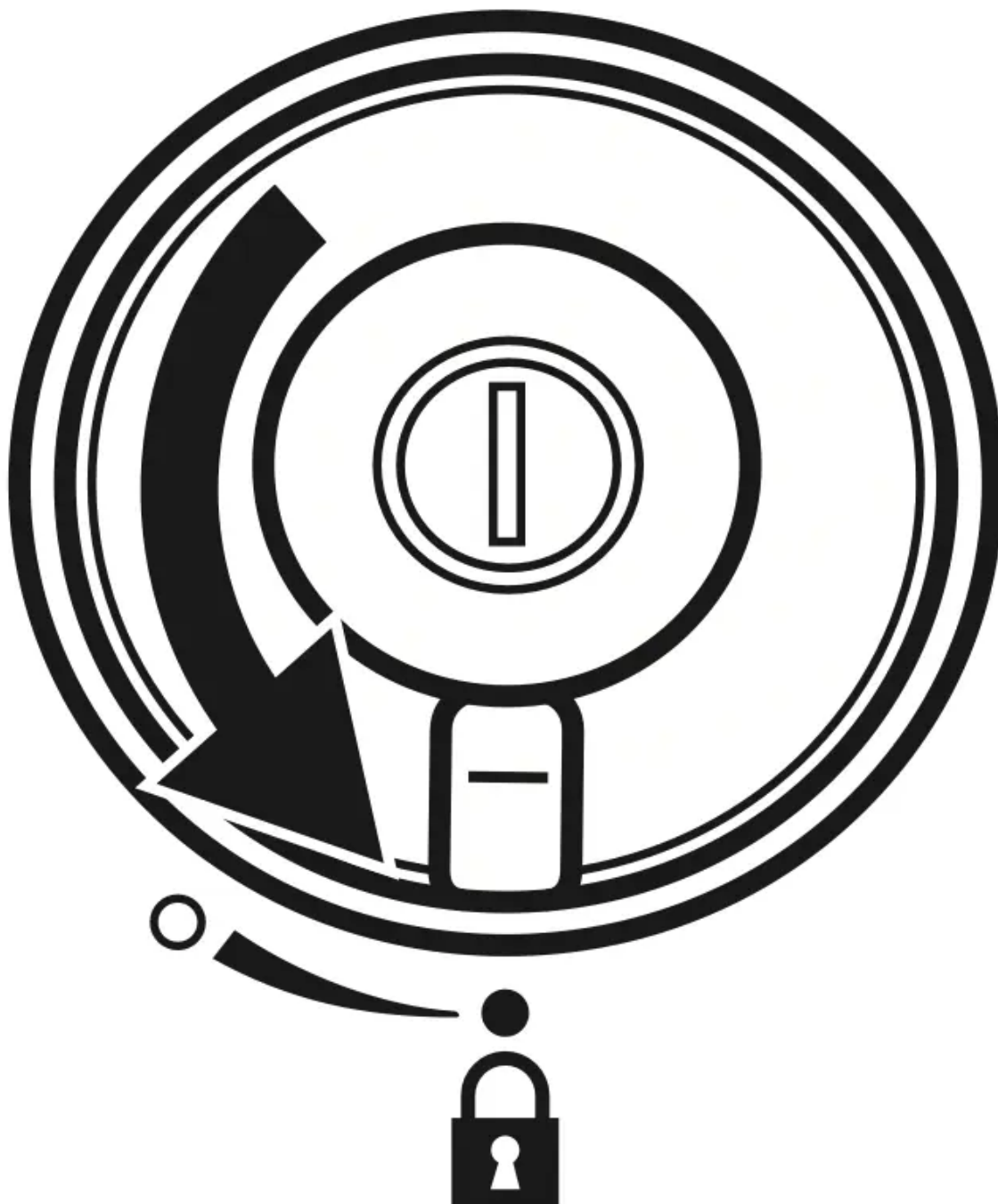

Charging the shaver

1. **Insert the appliance plug into the shaver.**
Turn the shaver off before inserting.

2. Plug in the adaptor into a household outlet.

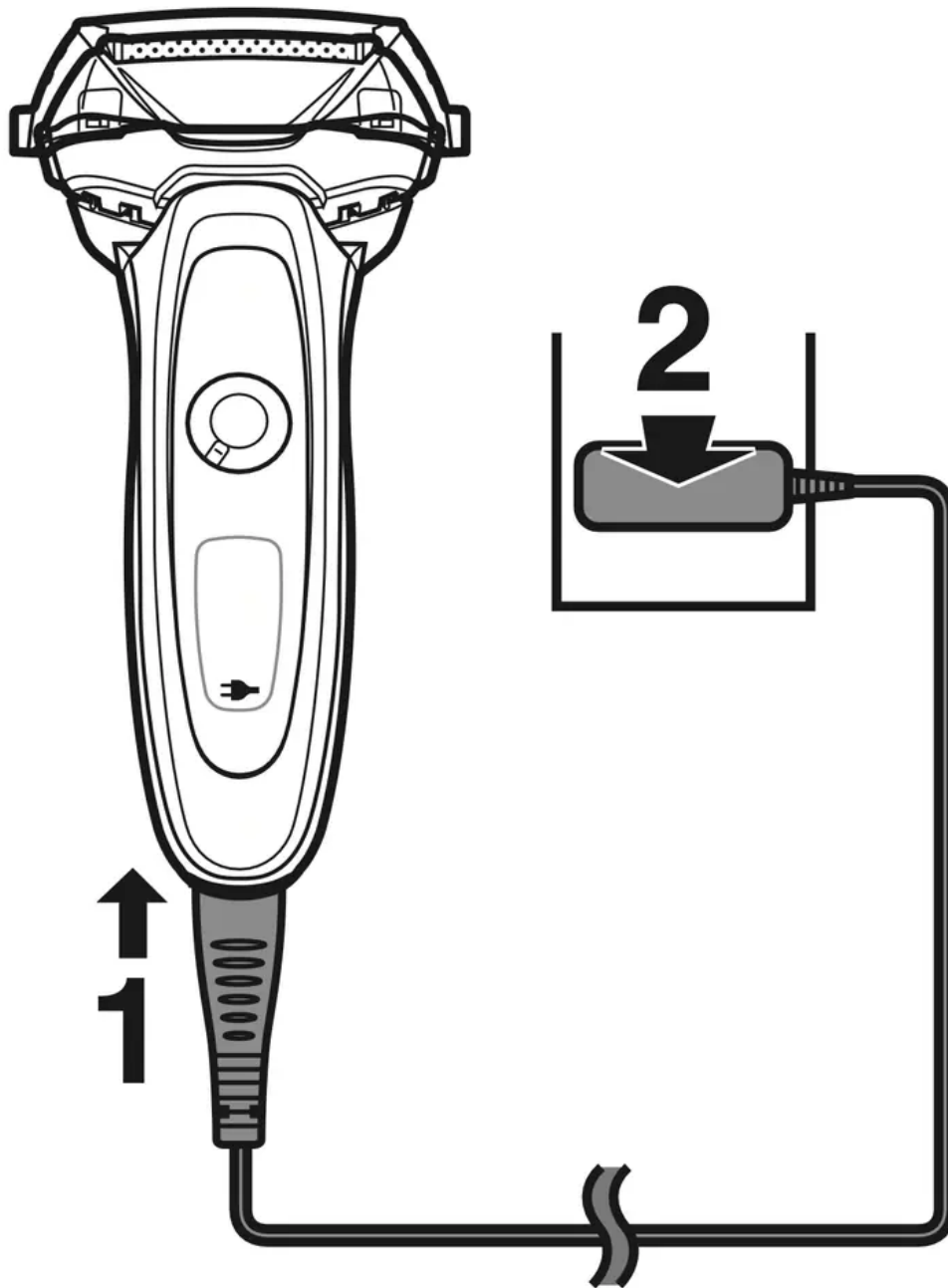

Check that the charge status lamp () glows.

Charging is completed after approx. 1 hour.

The charging time may decrease depending on the charging capacity.

Wipe off any water droplets on the appliance socket.

Check that the outer foil is not deformed or damaged when you are attaching the shaver.

If the shape of the plug does not fit the power outlet, use an attachment plug adaptor of the proper configuration.

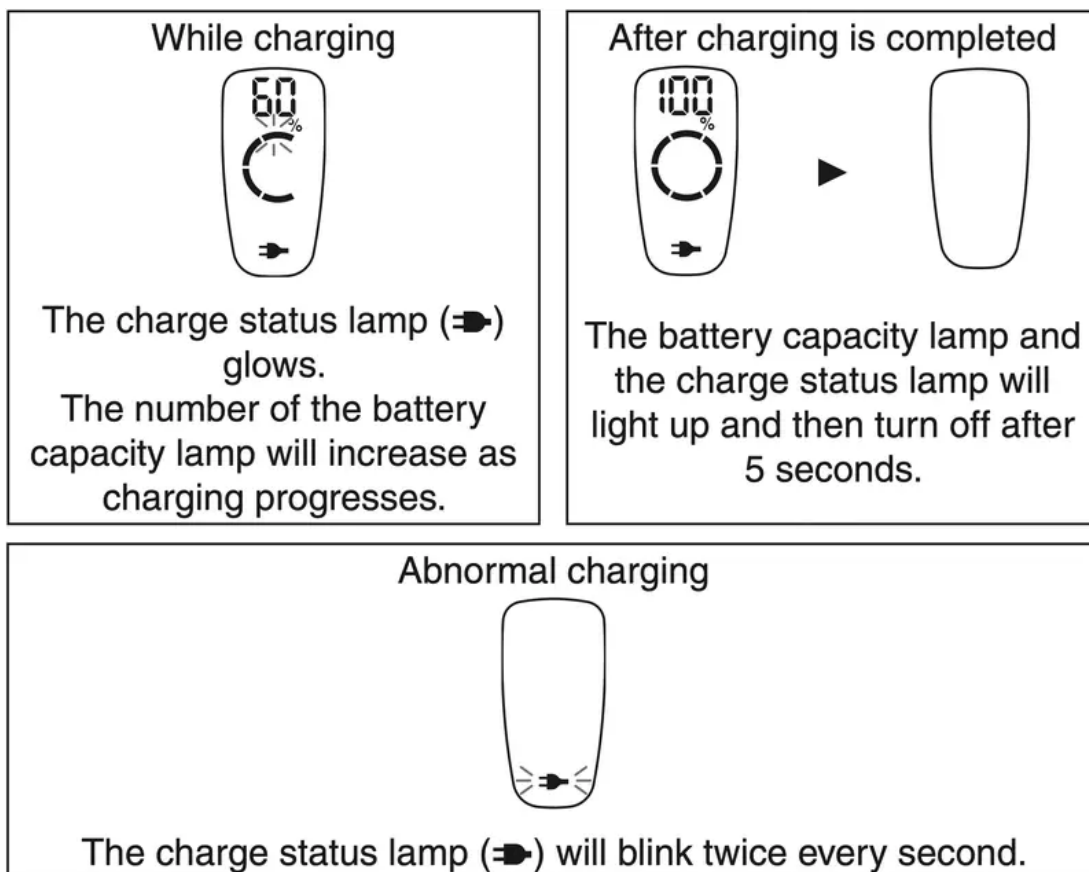

After charging is completed, turning the power switch ON with the shaver plugged in will cause the battery capacity lamp and the charge status lamp to light up and then turn off after 5 seconds. This shows that the shaver is fully charged.

Recommended ambient temperature for charging is 10 – 35 °C (50 – 95 °F). It may take longer to charge or the battery may fail to charge properly in extremely high or low temperatures. Charge the shaver within the recommended ambient temperature range. When charging the shaver for the first time or when it has not been in use for more than 6 months, the charge status lamp () may not glow. It will eventually glow if kept connected.

3. Disconnect the adaptor after charging is completed.





Charging the battery for more than 1 hour will not affect battery performance.

Note: You cannot operate the shaver while charging.

Using the shaver

1. Rotate the lock ring to unlock the power switch. (See page 9.)
2. Press the power switch to select the desired shaving mode.

Each time you press the power switch, the shaving mode changes from “Shaving sensor mode” “Normal mode” “OFF”.

Shaving mode	Shaving sensor mode	Normal mode	OFF
Description	Beard thickness is automatically sensed and the power is automatically adjusted when shaving.	The power level is constantly maintained while shaving.	—
Operation			
Shaving sensor lamp	 The shaving sensor lamp blinks.	— The shaving sensor lamp turns off.	— The shaving sensor lamp turns off.

The shaving sensor may not respond depending on the thickness of the beard or the type of the shaving gel and shaving foam, but this is normal.

The shaving sensor may not respond when the remaining battery capacity is low. If this happens, recharge the shaver.

3. Hold the shaver as illustrated and shave.

Start shaving by applying gentle pressure to your face. Stretch your skin with your free hand and move the shaver back and forth in the direction of your beard. You may gently increase the amount of pressure as your skin becomes accustomed to this shaver.

Applying excessive pressure does not provide a closer shave.

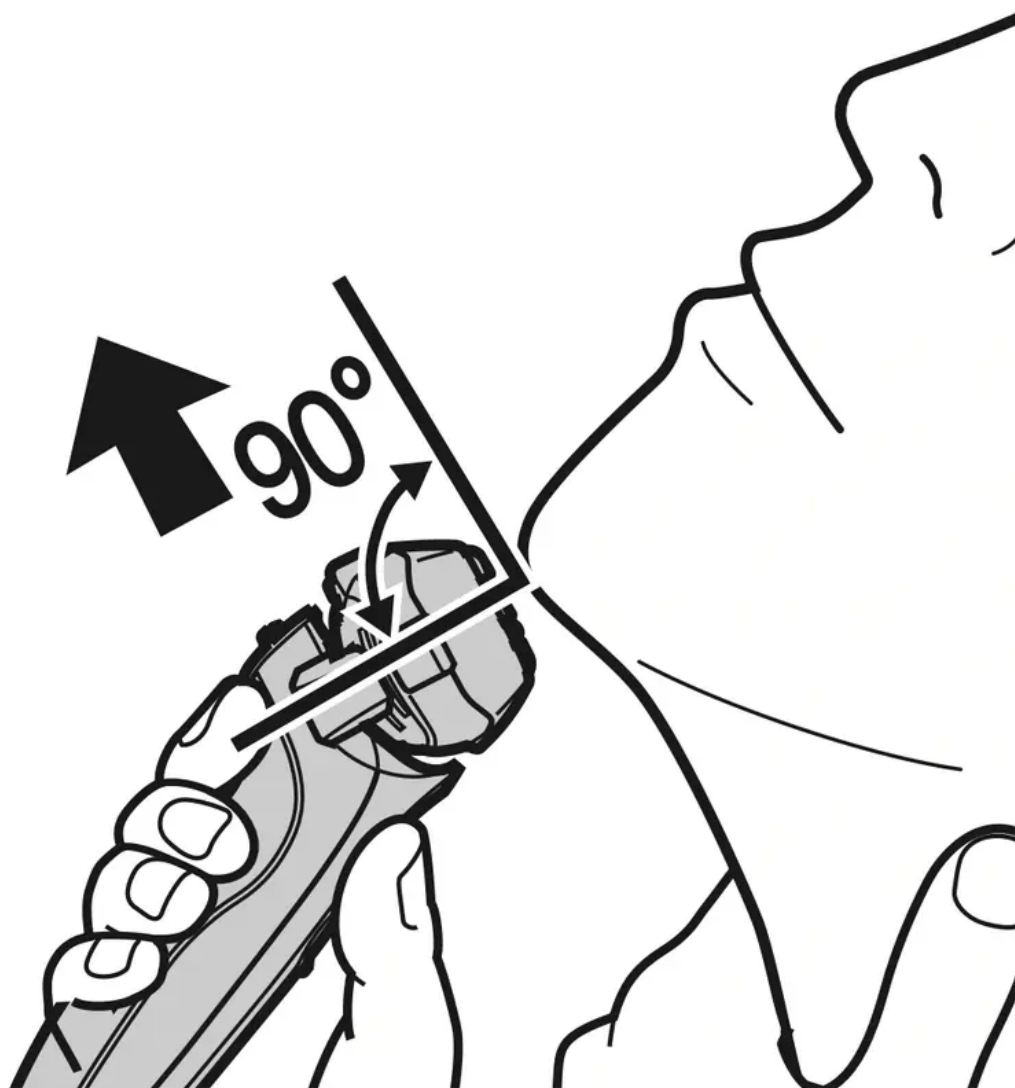

Switching the shaver head

You can change the pivot action.

FREE

You can move the shaver head.

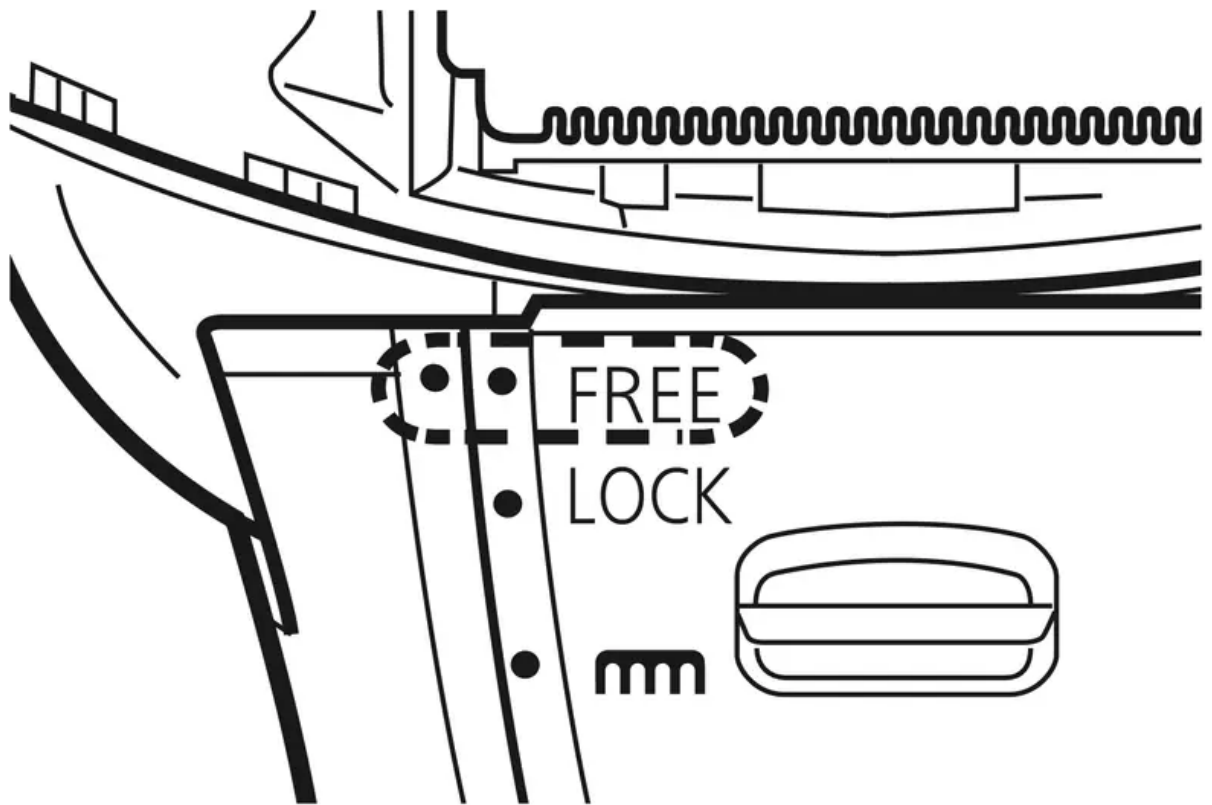

LOCK

You can lock the shaver head.

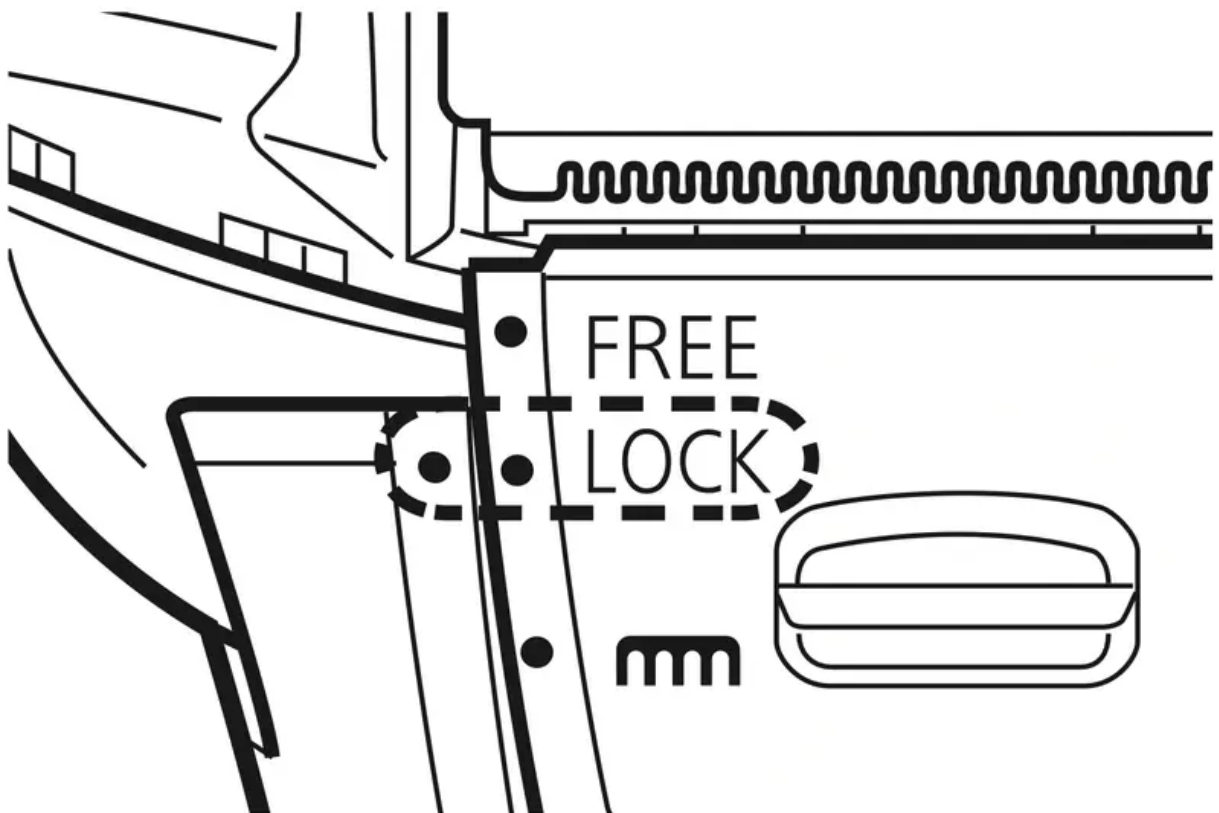

Using the trimmer

Slide the trimmer handle up to the “” position so that the trimmer stands upright.

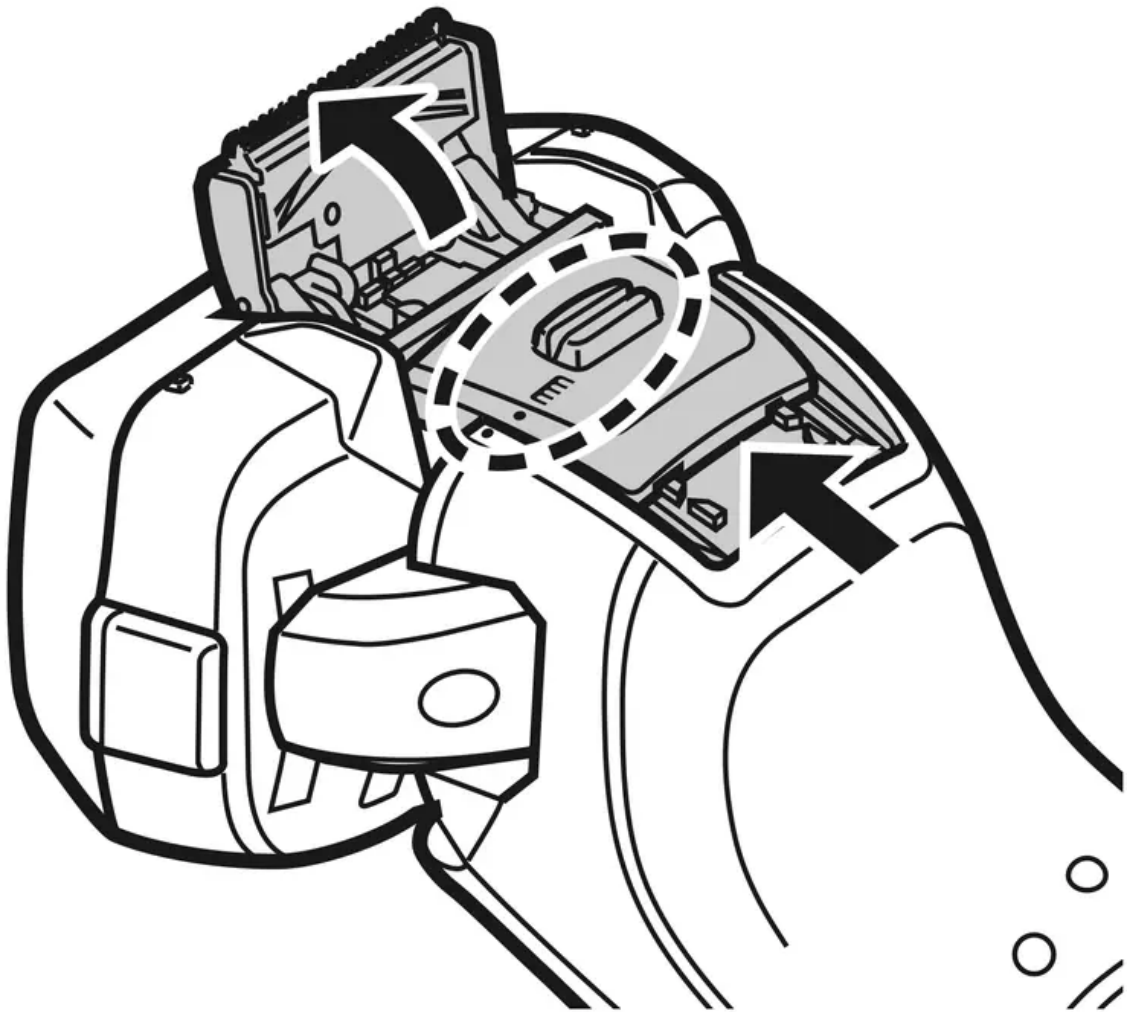

Press and hold the lock release button (a) and slide the trimmer handle down to lower the trimmer.

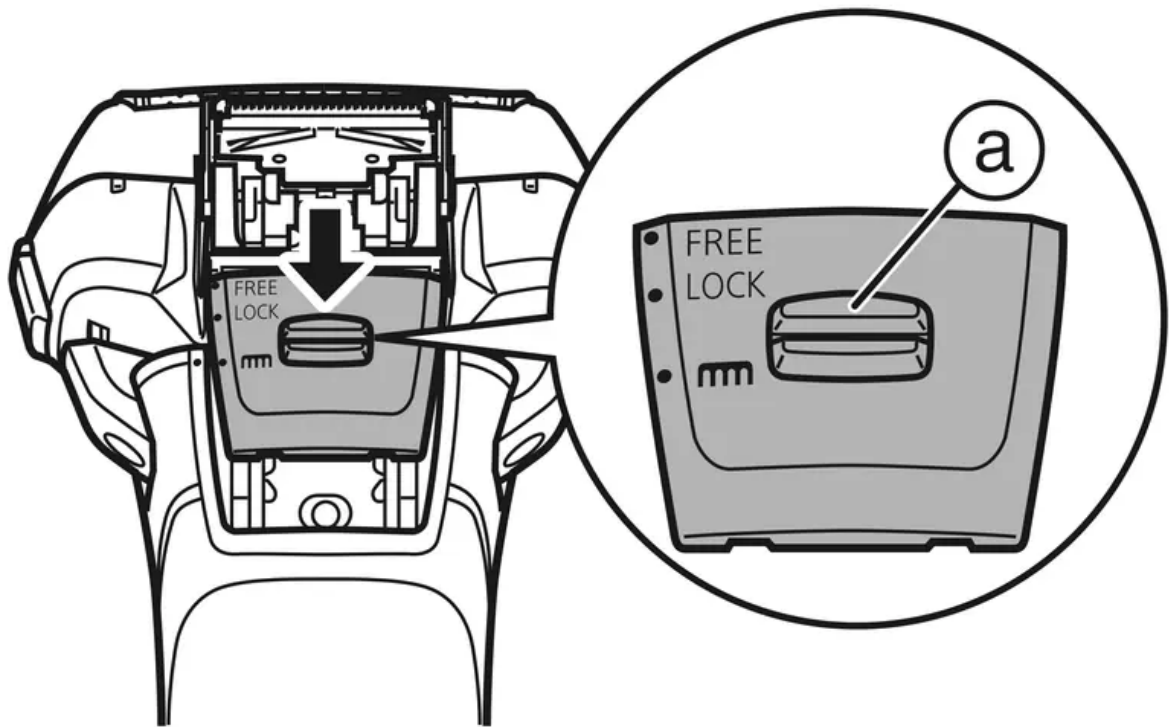

Trimming sideburns

Slide the trimmer handle up. Turn the shaver on and place at a right angle to your skin and move downwards to trim your sideburns.

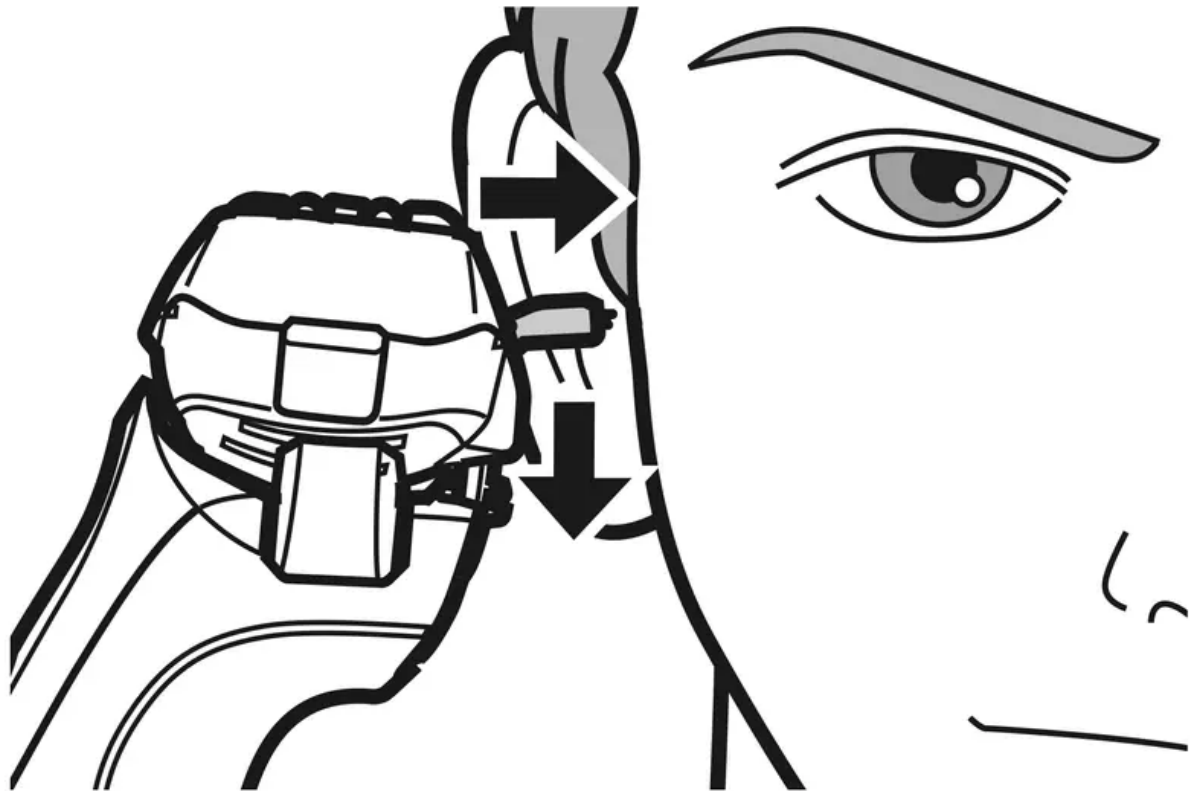

Pre-shave

The trimmer can be used for a pre-shave of long beards.



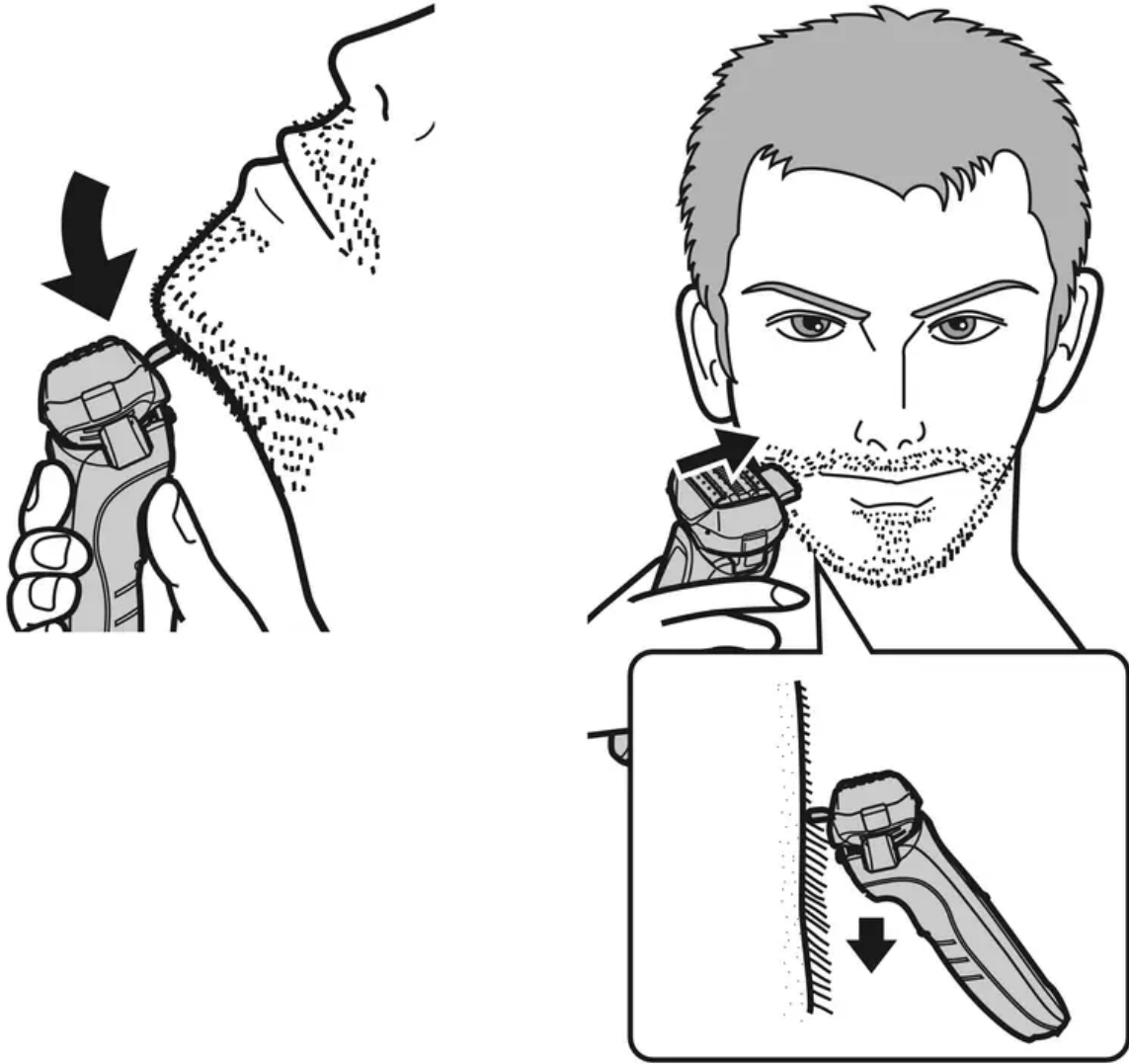

Notes

- If you press the power switch for more than 2 seconds, the sonic vibration cleaning mode is activated. (See page 13.)
You cannot shave in this mode.
- Do not place your fingers on the power switch while using the shaver. This may cause the shaver to switch the mode or turn off. Place your fingers on the finger rest while using the shaver.
- We recommend using the shaver in an ambient temperature range of 5 – 35 °C (41 – 95 °F). If used outside this range, the appliance may stop operating.

Reading lamps when using

During use



00"
MIN.USED

The used time and remaining battery capacity are shown and then turn off after 5 seconds.

- The shown time returns to [0'00"] after 10 minutes.

After use

The lamps will light up and then turn off after 8 seconds.

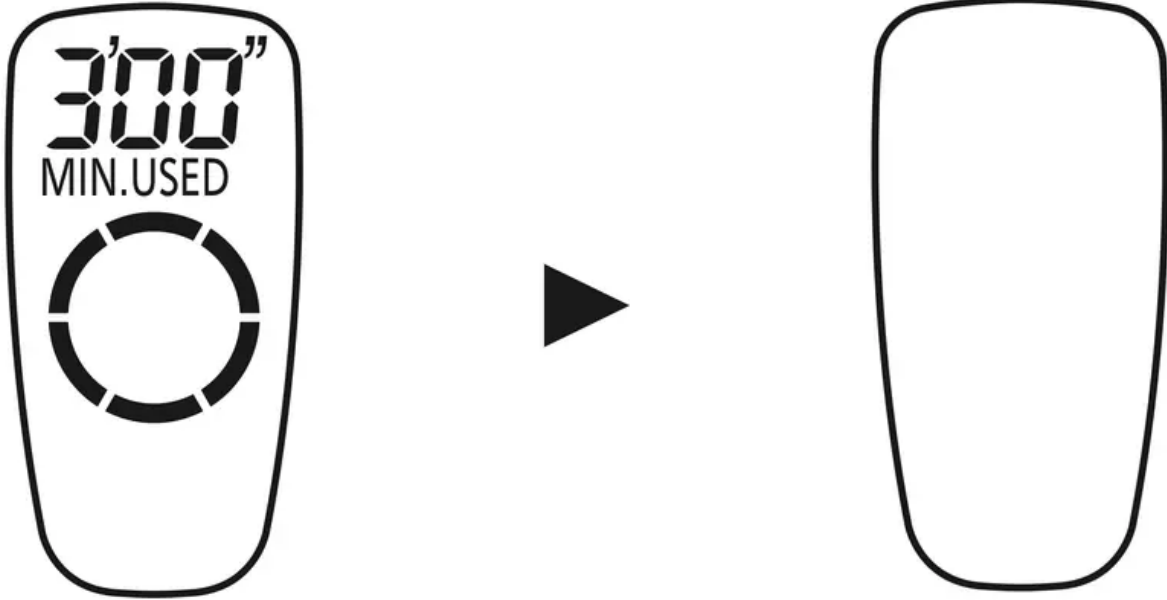

When the battery capacity is low

"10%" appears and "  " blinks.



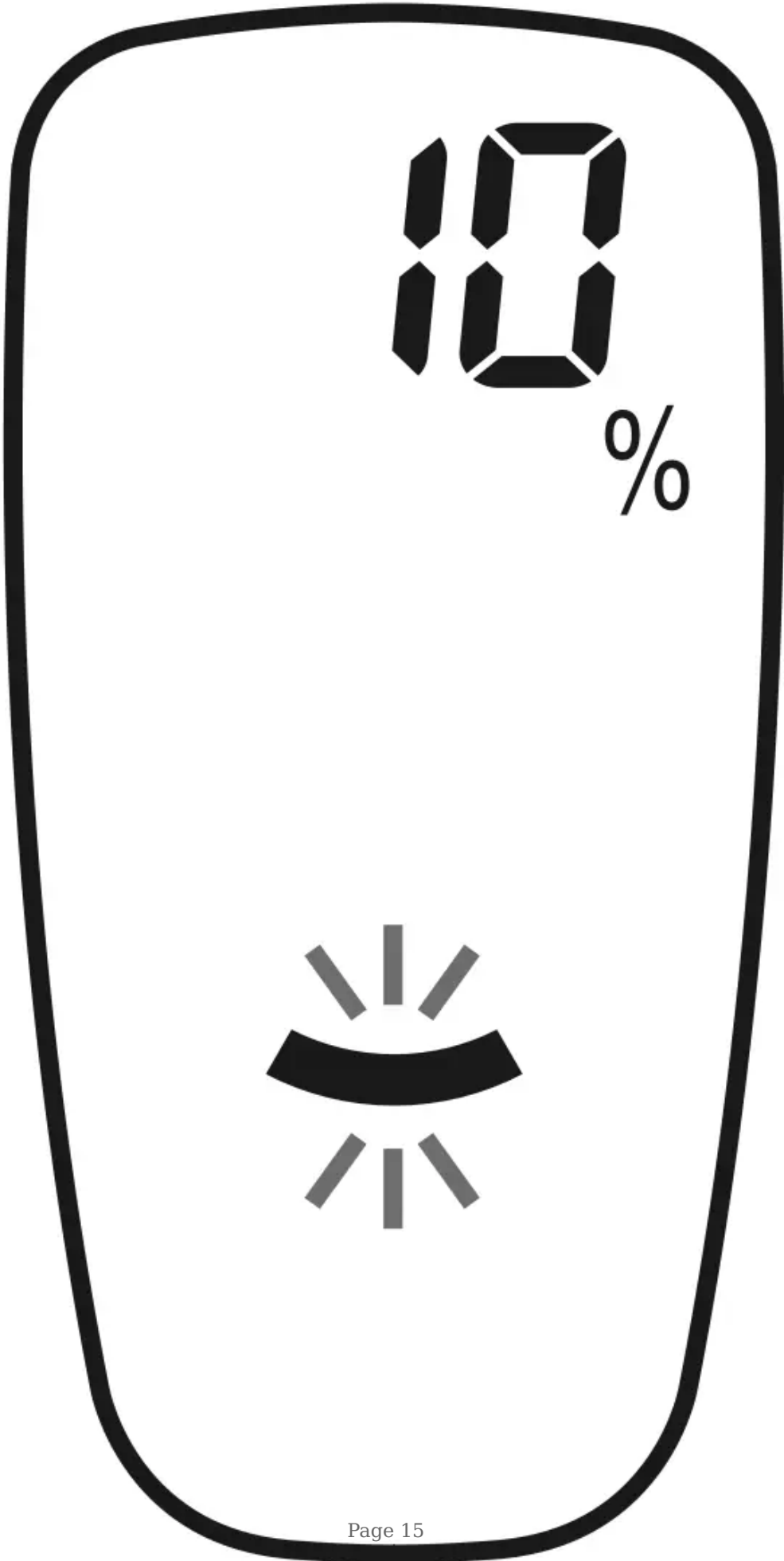

- You can shave 1 to 2 times after “10%” appears. (This will differ depending on usage.)
- A full charge will supply enough power for approx. 14 shaves of 3 minutes each. (This will differ depending on usage.)

Cleaning the shaver

We recommend that you clean your shaver with the sonic vibration cleaning mode when the faucet

symbol  appears on the lamp display.

1. Disconnect the cord from the shaver.
2. Apply some hand soap and some water to the system outer foil.
3. Rotate the lock ring to unlock the power switch.
4. Press the power switch for more than 2 seconds to activate the sonic vibration cleaning mode.

The battery capacity lamps blink in order.

After about 20 seconds, it will be automatically turned off, or you can turn it off by pressing the power switch.

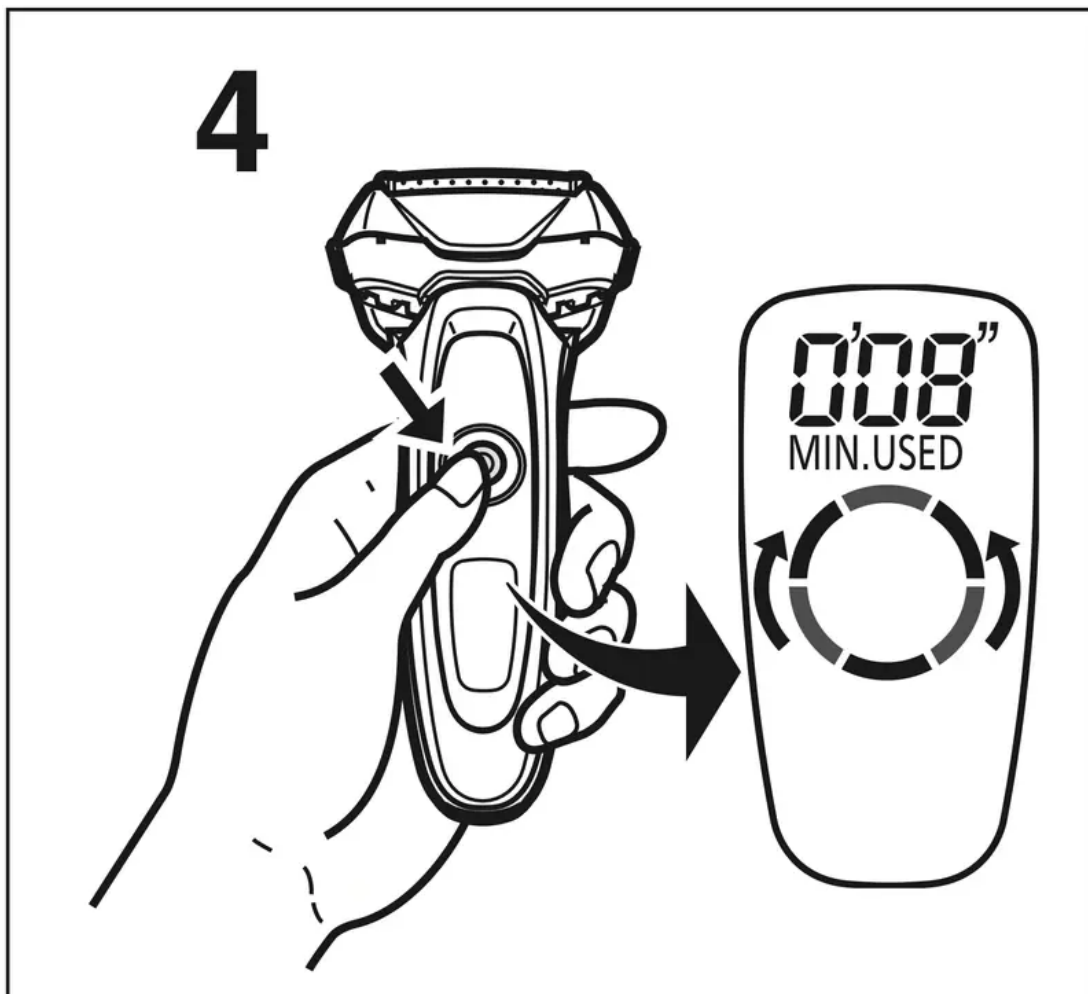

5. Remove the outer foil section and press the power switch for more than 2 seconds to activate the sonic vibration cleaning mode and clean it with running water.

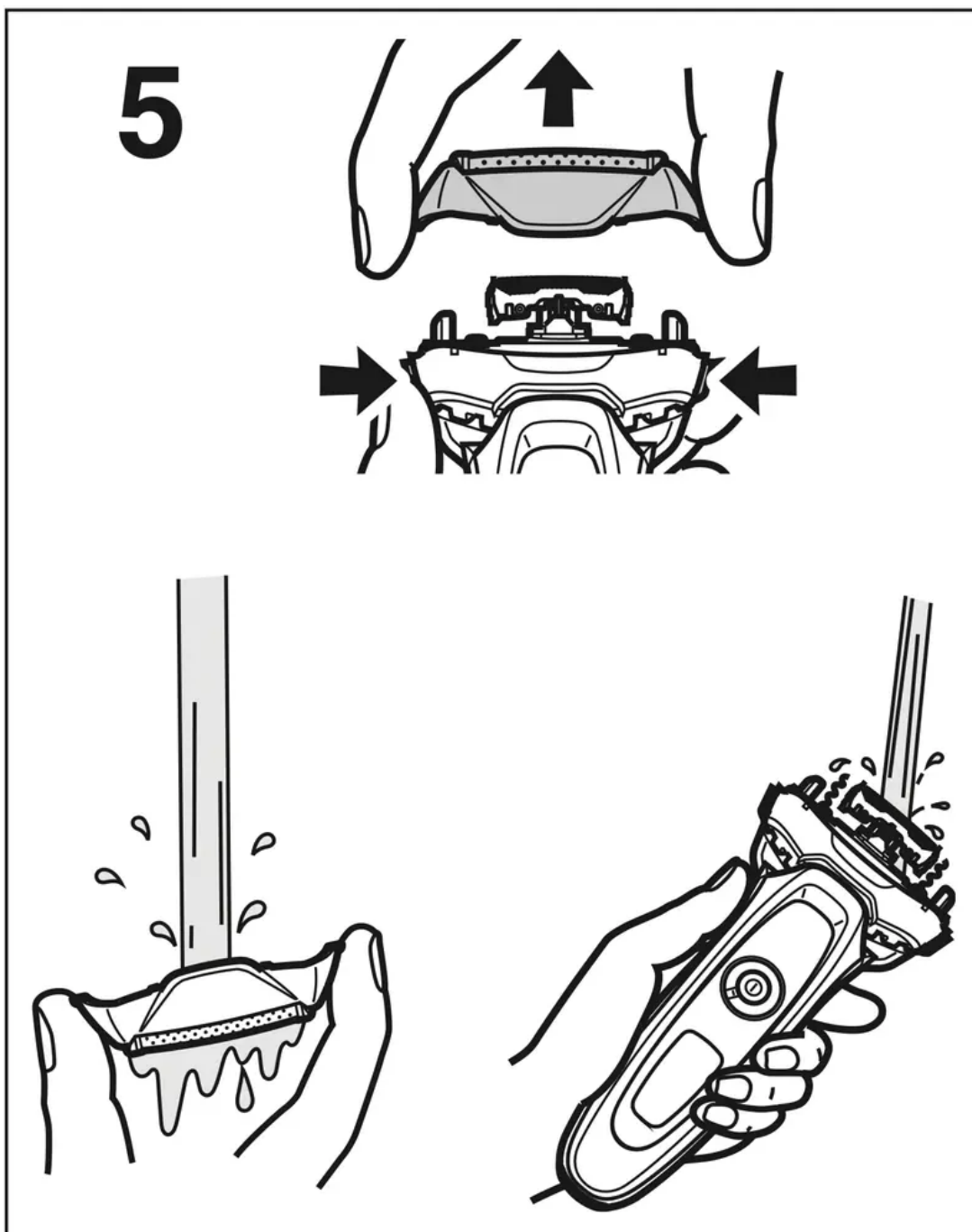

6. Wipe off any drops of water with a dry cloth.

7. Dry the outer foil section and the shaver completely.

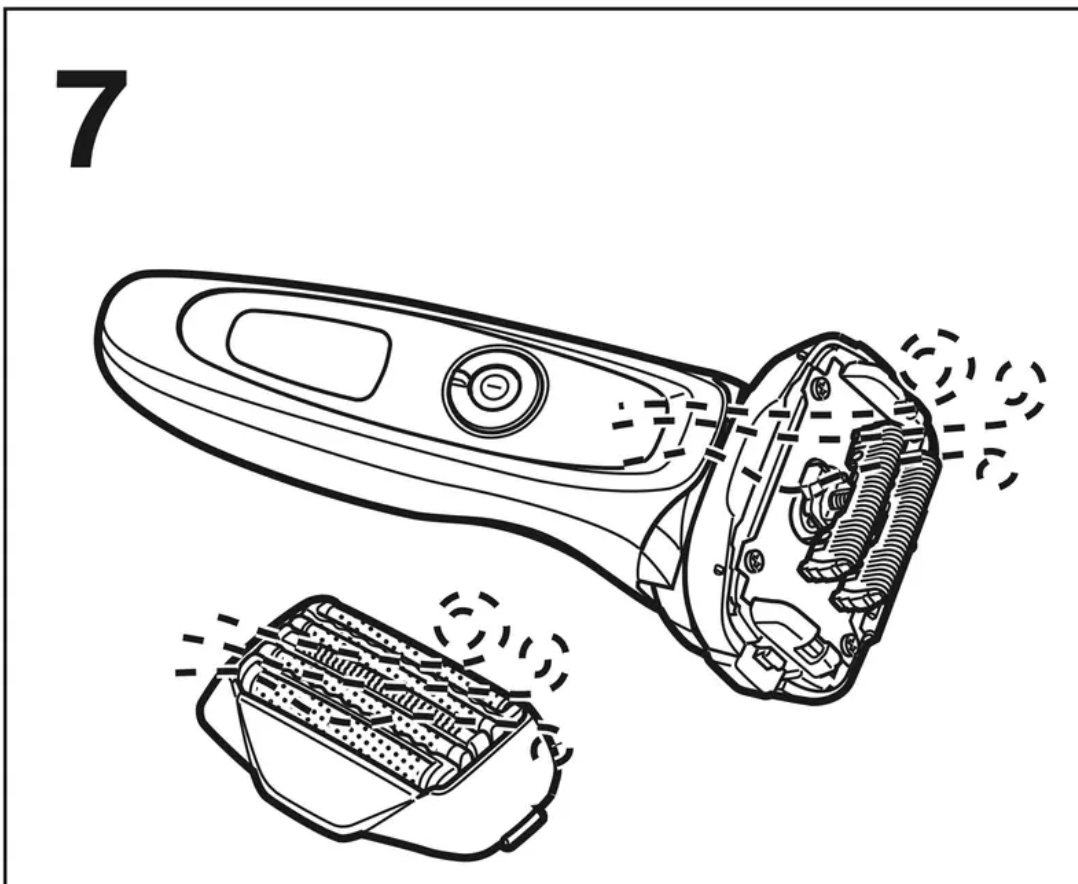

8. Attach the outer foil section to the shaver.

Replacing the system outer foil and the inner blades



appears on the lamp display once a year. (This will differ depending on usage.) We recommend checking the system outer foil and the inner blades when it appears.



Press the power switch for more than 30 seconds to turn off .

system outer foil	once every year
inner blades	once every two years

Removing the outer foil section

Press the foil frame release buttons and lift the outer foil section upwards.

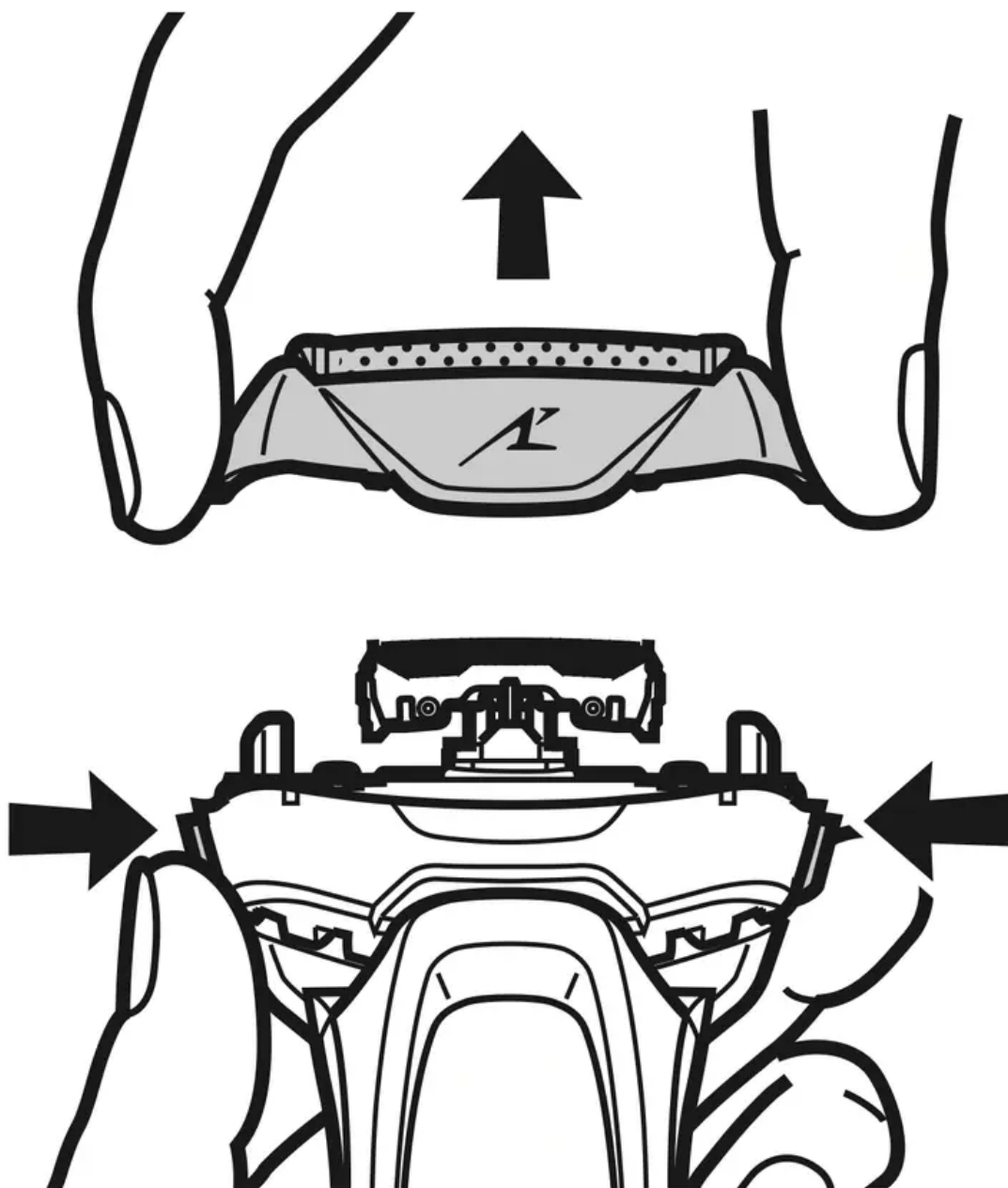

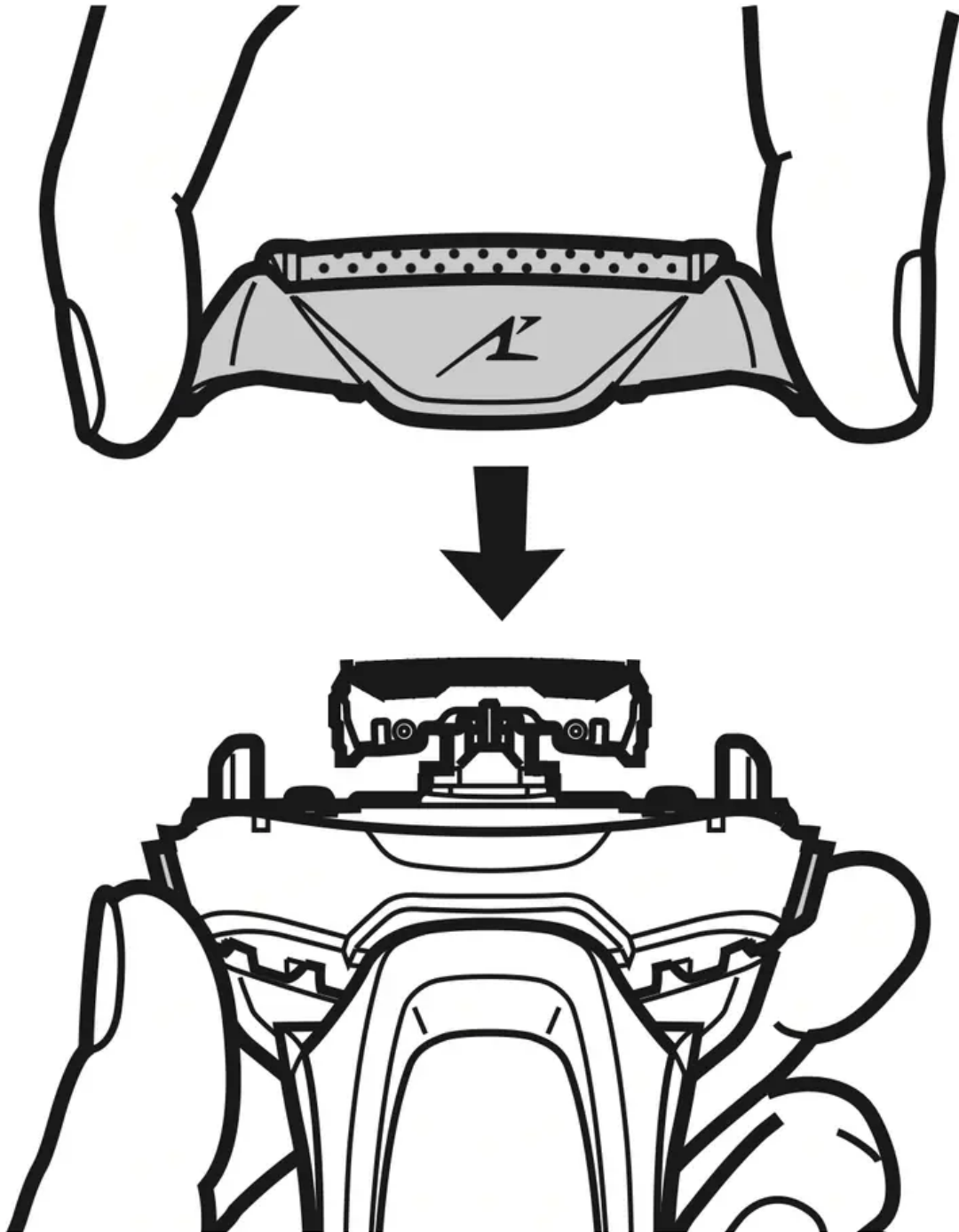

Attaching the outer foil section

After turning the foil frame mark () to the front, securely attach the outer foil section to the shaver until it clicks.



Replacing the system outer foil

1. Press the system outer foil release buttons and pull down the system outer foil.
- 2.

Align the foil frame mark () and the system outer foil mark () and securely attach together.

The system outer foil cannot be reversely attached.

Always insert the system outer foil to the foil frame when attaching to the shaver.

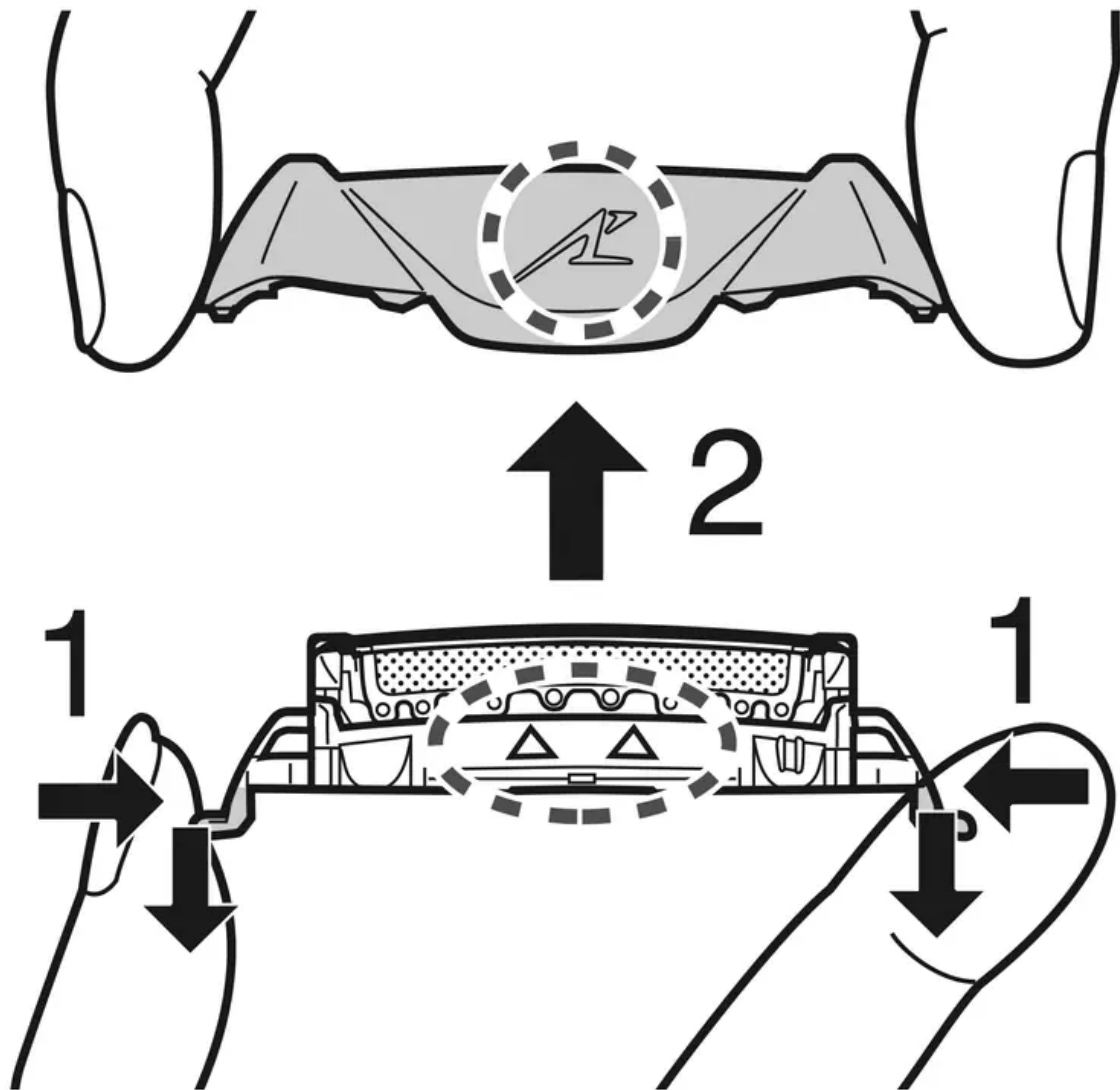

Replacing the inner blades

1. Remove the inner blades one at a time.
Do not touch the edges (metal parts) of the inner blades to prevent injury to your hand.
2. Insert the inner blades one at a time until they click.

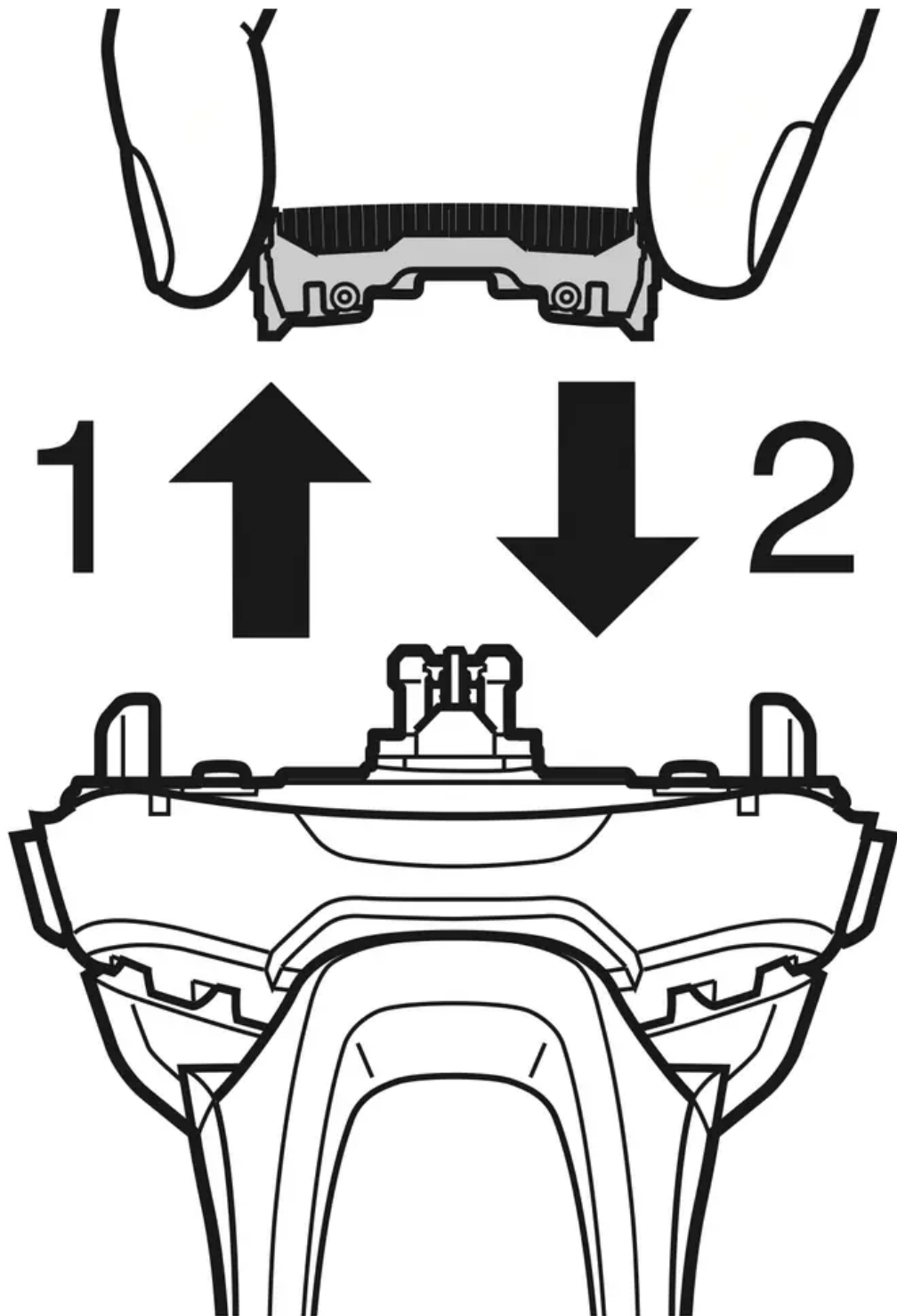

Replacement parts

Replacement parts are available at your dealer or Service Center.

Replacement parts for ES-LV65	System outer foil and inner blades	WES9032
	System outer foil	WES9173
	Inner blades	WES9170

Troubleshooting



Problem	Action
Trimmed hairs fly all over.	This can be improved by cleaning every time after shaving.
	Clean the inner blades.
System outer foil gets hot.	Replace the system outer foil if it is damaged or deformed. (See page 13.)
The power switch cannot be pressed.	Unlock the power switch.
Operating time is short even after charging.	When the number of operations per charge starts to decrease, the battery is nearing the end of its life.
Makes a loud sound.	Confirm that the blades are properly attached.
	The shaver makes a high-pitched sound due to the linear motor drive. This does not indicate a problem.
	Clean the system outer foil.
The odor is getting stronger.	This can be improved by cleaning every time after shaving.
You do not get as close a shave as before.	This can be improved by cleaning every time after shaving.
	<p>Replace the system outer foil and/ or inner blades.</p> <p>Expected life of system outer foil and inner blades:</p> <p>System outer foil: Approximately 1 year</p> <p>Inner blades: Approximately 2 years</p>
The shaving sensor does not respond.	The shaving sensor may not respond when the remaining battery capacity is low. If this happens, recharge the shaver.
	Depending on the beard thickness, the shaving sensor may not react and the driving sound may not change. This is not abnormal.

Problem	Action
	The shaving sensor may not respond depending on the thickness of the beard or the type of the shaving gel and shaving foam, but this is normal.
The shaving sensor responds even though the shaver is not in contact with the skin.	Clean the beard trimmings from the shaver. When the shaver is extremely dirty, remove the foil frame and wash with water. (See page 13.)
	Replace the system outer foil and/ or inner blades. Expected life of system outer foil and inner blades: System outer foil: Approximately 1 year Inner blades: Approximately 2 years
The shaver cannot be charged.	The recommended temperature for charging is 10 – 35 °C (50 – 95 °F). If charged at a temperature other than the recommended temperature, the shaver may take longer to charge or may not charge at all.
Shaver stopped functioning.	Recommended ambient temperature for operation is 5 – 35 °C (41 – 95 °F). The shaver may stop functioning when out of recommended ambient temperature range.
	The battery has reached the end of its life.
The driving sound changes while shaving.	While the shaving sensor lamp glows, the shaving sensor is operating. The sound changes depending on the beard thickness.
The power will not switch to OFF.	Press the power switch twice while using in the shaving sensor mode.

If the problems still cannot be solved, contact the store where you purchased the unit or a service center authorised by Panasonic for repair.

Warning

This content is compiled from multiple sources and is provided for reference purposes only. It may not be complete or fully applicable to all situations. If you are unable to resolve your issue, please contact the product manufacturer or an authorized service provider for official support.

