

DESCRIPTION

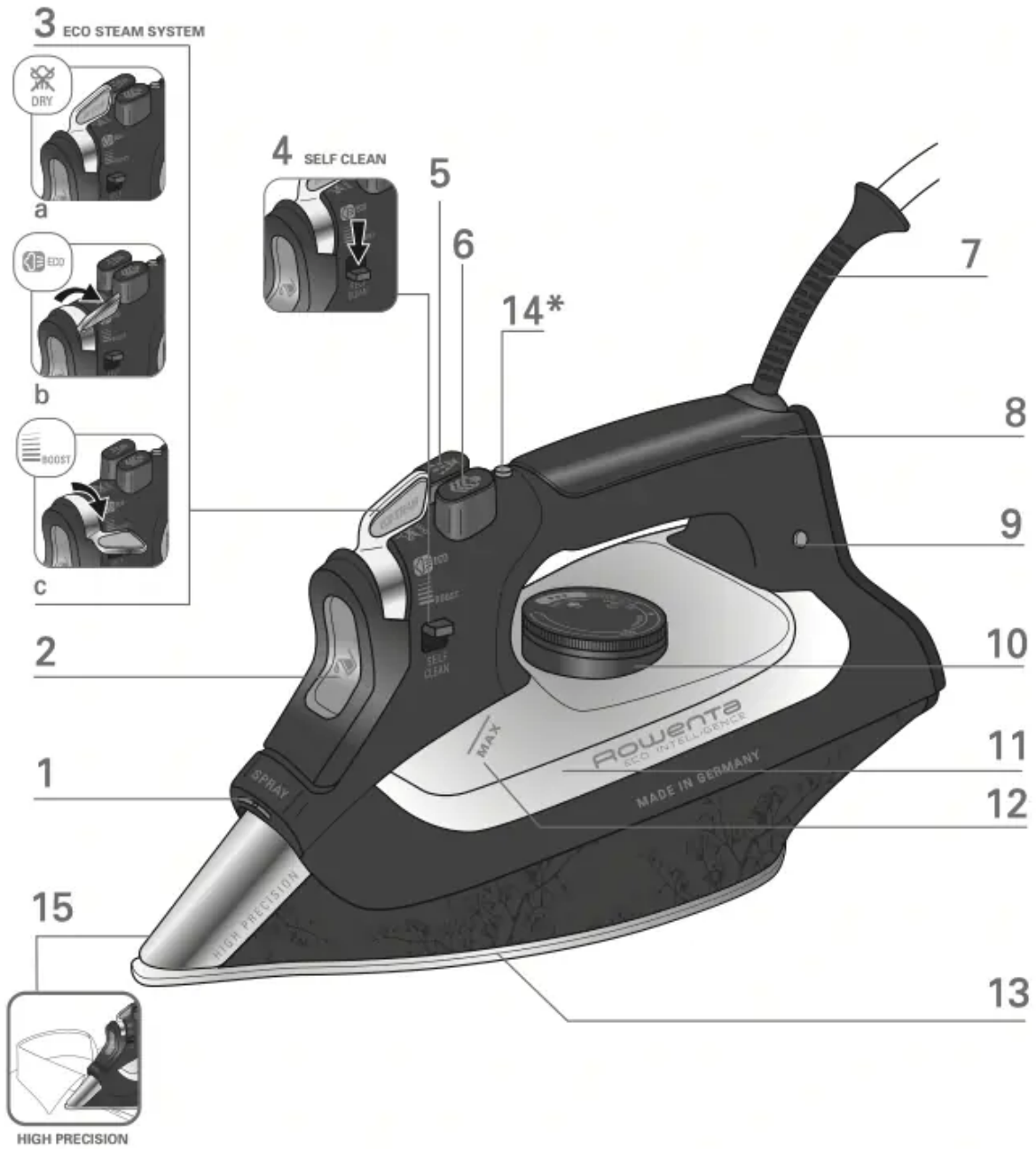

1 Spray nozzle

2 Filling inlet (with slide-button opening)

3 Eco steam system

a Dry ironing

b ECO position

- C BOOST position
- 4 Self Clean
- 5 Spray button
- 6 Shot of steam button
- 7 Cord
- 8 Handle
- 9 Thermostat control light
- 10 Temperature control dial
- 11 Water tank
- 12 Maximum water level indicator
- 13 Soleplate
- 14 Auto-Off*
- 15 High Precision Tip

IMPORTANT SAFETY INSTRUCTIONS

When using an iron, basic precautions should always be followed, including the following:

Read all instructions before using

1. Only use an iron for its intended use.
2. To avoid the risk of electric shock, do not immerse the iron in water or other liquids.
3. Always turn the iron OFF before plugging or unplugging the iron from the electrical outlet. Never pull on the cord to disconnect the iron from the electrical outlet; instead, grasp the plug and pull on the plug to disconnect the iron.
4. Do not let the cord touch hot surfaces. Let the iron cool completely before putting the iron away. Coil the cord loosely around the iron when storing.
5. Always disconnect the iron from the electrical outlet before filling the iron with water, emptying the water from the iron, and when the iron is not in use.
6. Do not operate the iron with a damaged cord or in the event the iron has been dropped or damaged. To avoid the risk of electric shock, do not disassemble the iron. Take it to a qualified serviceman for examination and repair. Incorrect assembly might result in a risk of electric shock when the iron is used after reassembly.
7. Close supervision is required for any appliance used by or near children. Do not leave the iron unattended while the iron is connected or on an ironing board.

8. Burns can occur from touching hot metal parts, hot water, or steam. Use caution when you turn a STEAM IRON upside down – there might be hot water in the reservoir.
9. To avoid a circuit overload, do not operate an iron on the same circuit with another high wattage appliance.
10. If an extension cord is absolutely necessary, a cord with an ampere rating equal to or greater than the maximum rating of the iron shall be used. A cord rated for less amperage can result in a risk of fire or electric shock due to overheating. Care shall be taken to arrange the cord so that it cannot be pulled or be tripped over.
11. This appliance is not intended for use by children and other persons whose physical, sensory, or mental capabilities or lack of experience and knowledge prevents them from using the appliance safely without supervision or instruction by a responsible person to ensure that they can use the appliance safely.
12. Children should be supervised by the responsible person to ensure that they do not play with the appliance.
13. the iron must be used and rested on a stable surface;
14. when placing the iron on its stand, ensure that the surface on which the stand is placed is stable;
15. the iron is not to be used if it has been dropped, if there are visible signs of damage or if it is leaking.

SPECIAL INSTRUCTIONS

16. The iron must not be left unattended while it is connected to supply mains.
17. Always disconnect the iron from the electrical outlet, before you leave the room.

BEFORE USE

WARNING ! Remove any labels from the soleplate before heating up the iron.

WARNING ! Before using your iron with the steam function for the first time, we recommend that you operate it in a horizontal position for a few moments, away from your linen, i.e. press the Shot of Steam button a few times.

During the first few uses, a harmless odour and a small amount of smoke may be given off.

This has no effect on the use of the iron and will disappear quickly.

Upon the first use, you may notice small particles coming out of the soleplate. This is part of manufacturing process and is not harmful to you or your garments. It will disappear after several uses. You may accelerate this by using the self cleaning function (fig 5a – 5b) and shaking the iron gently.



fig.5a



fig.5b

1 • What water may be used ?

Your iron has been designed to operate using untreated tap water. If in doubt, check with your local water authority. However, if your water is very hard, you can mix 50% untreated tap water with 50% distilled or demineralised water.

IMPORTANT Heat concentrates the elements contained in water during evaporation. The types of water listed below contain organic waste or mineral elements that can cause spitting, brown staining or premature wear of the appliance : water from clothes dryers, scented or softened water, water from refrigerators, batteries or air conditioners, pure distilled or demineralised water or rain water should not be used in your iron. Also do not use boiled, filtered or bottled water.

IRONING BOARD: Due to the powerful steam output, a mesh type ironing board must be used to allow any excess steam to escape and to avoid steam venting sideways.

USE

2 • Filling the water tank

IMPORTANT Before filling the water tank, unplug the iron and set the steam control to dry position



Tilt the iron. Open the filling inlet (fig.6). Pour in water up to the max mark (fig.7). Close the filling inlet (fig.8) and return the iron to the horizontal.



fig.6



fig.7



fig.8

3 • Temperature and steam adjustment

Set the iron temperature to suit the type of material using the temperature control dial (fig.3).

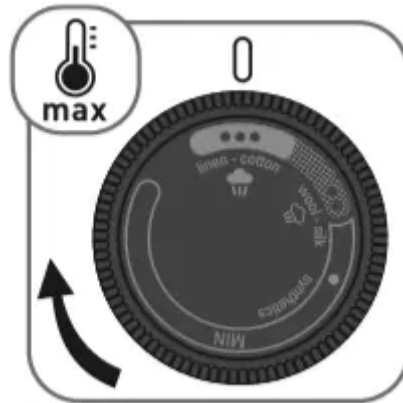









fig.3

Temperature control: The temperature control light indicates that the soleplate is heating up. When the temperature control light goes off (fig.10), the set temperature is reached and you can begin ironing.



fig.10

				ECO STEAM
	Cotton linen		•••	 BOOST / ECO
	Silk, wool		••	 ECO
	Nylon		•	

IMPORTANT The iron takes longer to cool down than to heat up. We recommend that you start with fabrics to be ironed at a low temperature. For mixed fabrics set the temperature for the most delicate fabric.

TIP Always spray starch onto the reverse side of the fabric to be ironed.

4 • Dry ironing

Set the variable steam control to  DRY (fig.11) and set the temperature to suit the type of material (care points •, ••, •••).



fig.11

5 • Eco steam system

Your Steam Iron is equipped with the Eco Steam System. This function offers 3 steam settings for optimal ironing:

- DRY position: For an ironing without steam, ideal for delicates or perfect finishes.
- ECO position: For an optimized ironing with a steam output perfectly adapted to all fabric types. This setting ensures qualitative ironing results while saving energy.
- BOOST position: For increased variable steam output to reach perfect result on thickest fabrics.

6 • Shot of steam

(from temperature setting •• upwards)

Press the shot of steam button  to generate a powerful jet of steam (fig.16). Wait a few seconds between each shot before pressing the button again.



fig.16

7 • Vertical shot of steam

(from temperature setting •• upwards)

TIP Hold the iron 10 to 20 centimetres away from the garment to avoid burning delicate fabrics.

Hold the iron to the vertical and press the shot of steam button  (fig.17) to remove creases from suits, jackets, skirts, hanging curtains etc.



fig.17

* depending on model

Wait a few seconds between each shot before pressing the button again.

IMPORTANT Never direct the steam at persons or animals!

8 • Spray

Press the spray button  to dampen stubborn creases (fig.18).



fig.18

9 • Anti-Drip system*

This prevents water escaping from the soleplate when the temperature is too low.

10 • Automatic electronic 3-position shut-off*

If, although switched on, the appliance is not moved, it will automatically switch off and the auto off light will blink after the following intervals:

- After 30 sec., if the iron is left resting on the the soleplate or lying on its side.
- After 8 mins., if the iron is left resting on its heel. To switch the iron back on, move the iron gently.

AFTER USE

11 • Emptying

Unplug the iron (fig.4), pour away remaining water (fig.20) and set steam control to  DRY

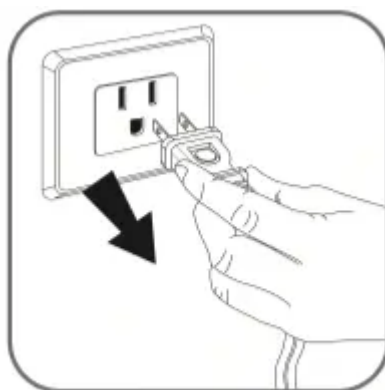

fig.4



fig.20

Open and close the steam control several times (fig.16) to prevent the valve hole into the steam chamber from scaling or blocking up.

12 • Storing

Allow the appliance to cool down before storing the iron standing on its heel (fig.21).



fig.21

IMPORTANT Do not wind the cord around the hot soleplate. Never store your iron placed down on the soleplate.

MAINTENANCE AND CLEANING

IMPORTANT Unplug and allow the iron to fully cool down before maintenance and cleaning.

13 • Anti-scale system

Your iron contains an anti-scale cartridge to reduce scale deposits. This considerably prolongs the operational life of your iron.

The anti-scale cartridge is an integral part of the water tank and does not need to be replaced.

14 • Self Clean function

(prolongs the life of the iron)

The Self Clean function flushes dirt and scale particles out of the steam chamber.

IMPORTANT Do not use descaling agents, as these damage the lining of the steam chamber and so may impair the steam function.

Fill the water tank with untreated tap water up to the max mark and heat the iron to the ••• temperature. Unplug the iron and hold it over a sink horizontally. Hold the Self-clean button into the Self Clean position (fig.5a-b) and shake it gently: steam will now begin to build up.



fig.5a



fig.5b

After a few seconds water will emerge from the soleplate, rinsing dirt and scale particles out of the steam chamber.

Move the steam control to position after approx. 1 minute.

Plug in the iron and allow the iron to heat up again. Wait until the remaining water has evaporated. Unplug from the mains and allow the iron to fully cool down. When cool, the soleplate can be wiped with a damp cloth.

TIP Use the Self Clean function approx. every 2 weeks. If the water is very hard, clean the iron weekly.

15 • Cleaning the iron

When the appliance has cooled down, wipe it down with a damp cloth or sponge, as required.

Remove the dirt from the soleplate with a damp cloth or sponge.

IMPORTANT Do not use sharp or abrasive cleaning agents or objects to clean soleplate and other parts of the iron.



If the appliance has been standing unused for long periods, use the Self Clean function (see § 14).



fig.14

PROBLEMS?



Problems	Cause	Solution
<p>The iron is plugged in, but the soleplate of the iron remains cold.</p> <p>None or too little steam is being emitted.</p>	No mains supply.	Check that the mains plug is properly inserted or try plugging the iron into a different socket.
	Temperature control set too low.	Set the temperature control to a higher temperature.
	The automatic electronic shut-off* is active.	Move your iron.
	Steam control set on dry position  .	Turn the steam control to the required setting area.
	Not enough water in the water tank.	Fill the water tank.
	<p>Anti-Drip* is active (§ 11).</p>  <p>fig.11</p>	Wait for the soleplate to reach the correct temperature.
<p>Brown streaks come through the holes in the soleplate and stain the linen.</p>	Residues in the steam chamber or on the soleplate.	Use the Self Clean function then clean your iron.
	Use of chemical descaling agents.	Do not add any descaling agents to the water in the water tank. Use the Self Clean function and clean your iron.
	Fabric fibres have accumulated in the holes of the soleplate and are burning.	<p>Clean the soleplate with a non-metallic sponge.</p> <p>Vacuum the holes of the soleplate from time to time.</p>

	Your linen is not rinsed sufficiently or you have ironed a new garment before washing it.	Ensure linen is rinsed thoroughly to remove any soap deposits or chemicals on new garments which may be sucked by the iron.
	Use of starch.	Always spray starch onto the reverse side of the fabric to be ironed and clean your iron soleplate.
	Pure distilled / demineralised or softened water is being used.	Only use untreated tap water or mix half tap water with half distilled/ demineralised water. Use the Self Clean function and clean your iron.
Iron is leaking.	Overuse of shot of steam button.	Allow more time between each shot.
	Soleplate temperature too low .	Set the temperature control to a higher temperature.



fig.1



fig.2



fig.3

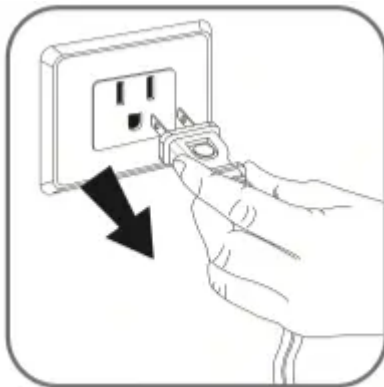

fig.4



fig.5a



fig.5b



fig.6



fig.7



fig.8



fig.9



fig.10



fig.11



fig.12



fig.13



fig.14



fig.15



fig.16



fig.17



fig.18



fig.19



fig.20



fig.21



fig.22



fig.23

Warning

This content is compiled from multiple sources and is provided for reference purposes only. It may not be complete or fully applicable to all situations. If you are unable to resolve your issue, please contact the product manufacturer or an authorized service provider for official support.