

## PRODUCT DIAGRAM

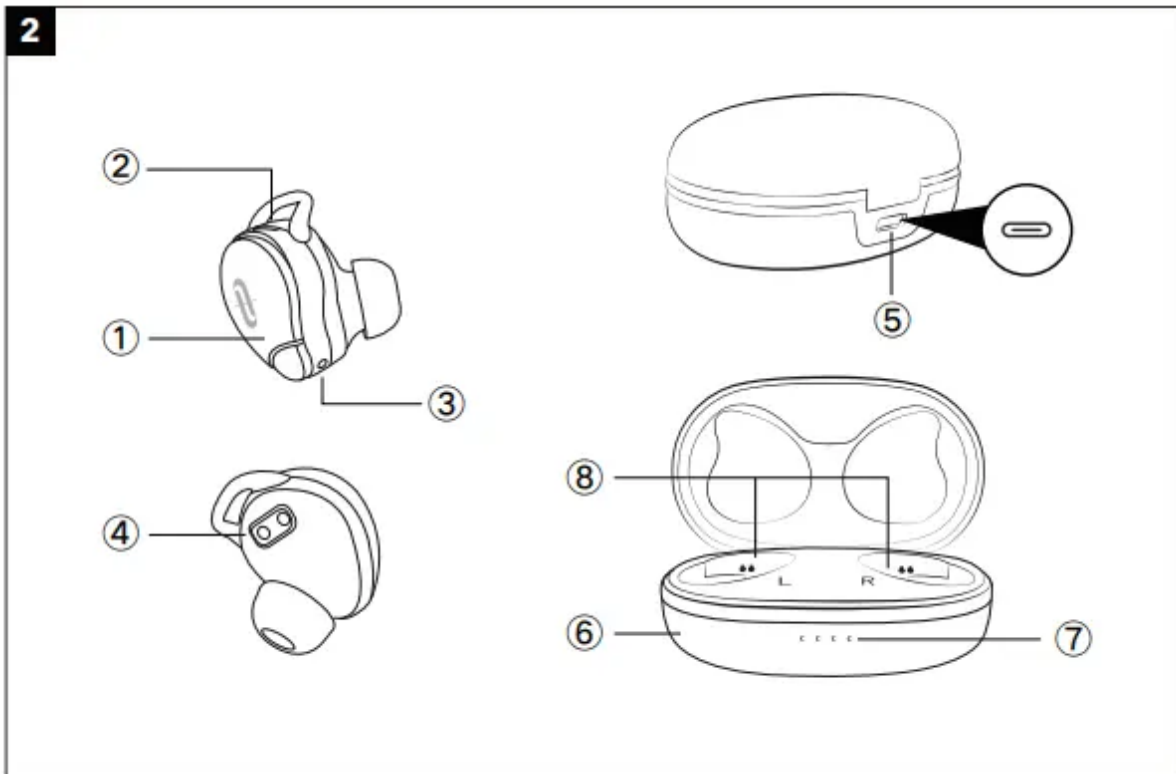

1 Multifunction Touch Control

2 LED Indicator

3 Microphone

4 Charging Contacts

5 USB-C Charging Port

6 Charging Case

7 Charging Indicator

8 Charging Slot

## HOW TO WEAR

### Choose the Right Tips

- Ear tips and ear hooks with different sizes are included in the package, try all sizes and choose the ones fitting you best.

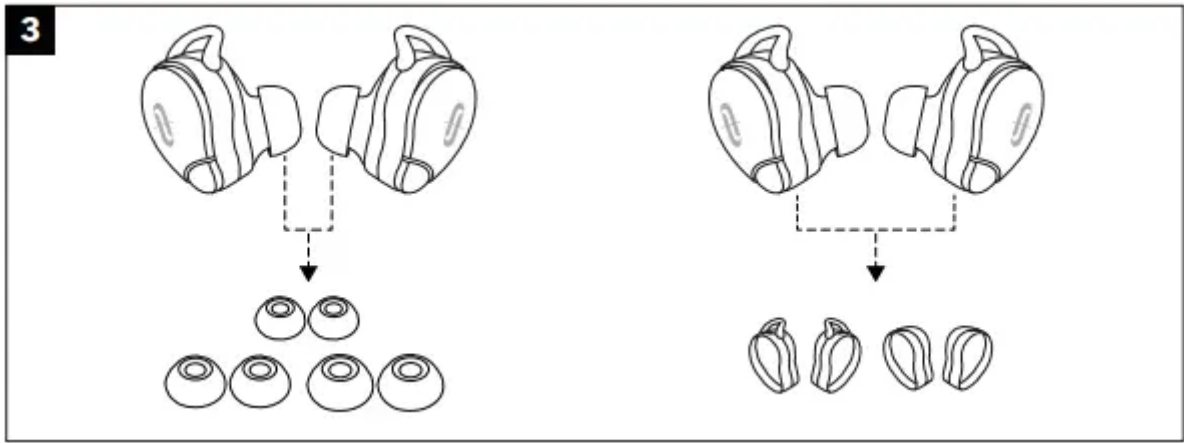

## Wear the Earbuds

- Please wear the earbuds as shown below.

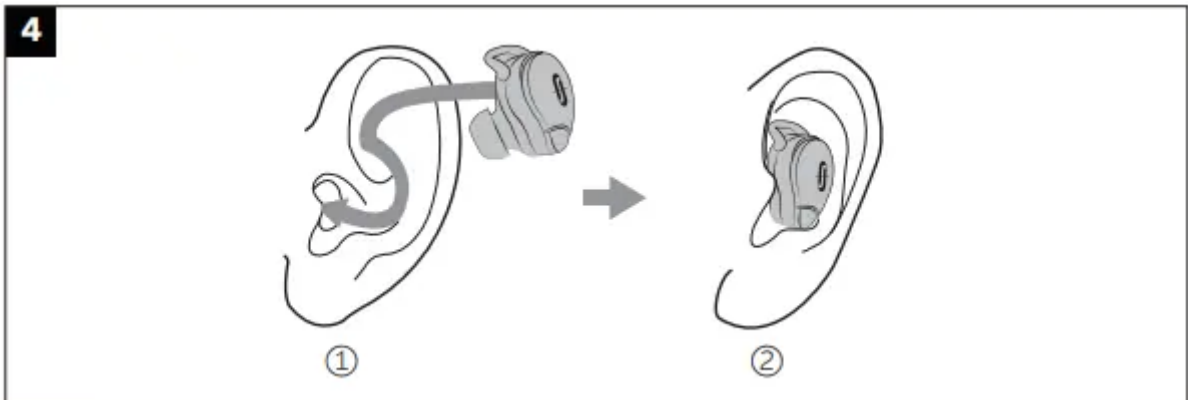

- Pictures only for reference.

## Bluetooth Caution

- When the device is connected wirelessly to another device, place the two devices close to each other to achieve their normal functionalities and avoid possible signal interference.
- The maximum effective Bluetooth range is 10 meters (33 feet), which may vary with the environmental circumstances.
- When using a wireless connection, make sure there are no obstacles between the two devices. Obstacles including walls and fences may shorten the effective range.

## USING YOUR EARBUDS

### Charging

#### Charging the Earbuds

1. Put the earbuds into the charging case as per the L (left) and R (right) marks

## 2. Cover the lid and charging will start automatically

Note:

- Please fully charge the earbuds when using them for the first time.
- When battery is low, a “Battery low” voice prompt will be heard (if you are wearing the earbuds). Please charge it in time or the earbuds will turn off automatically around 10 minutes later.
- Charge the earbuds at least once every 3 months when not using for a long time.

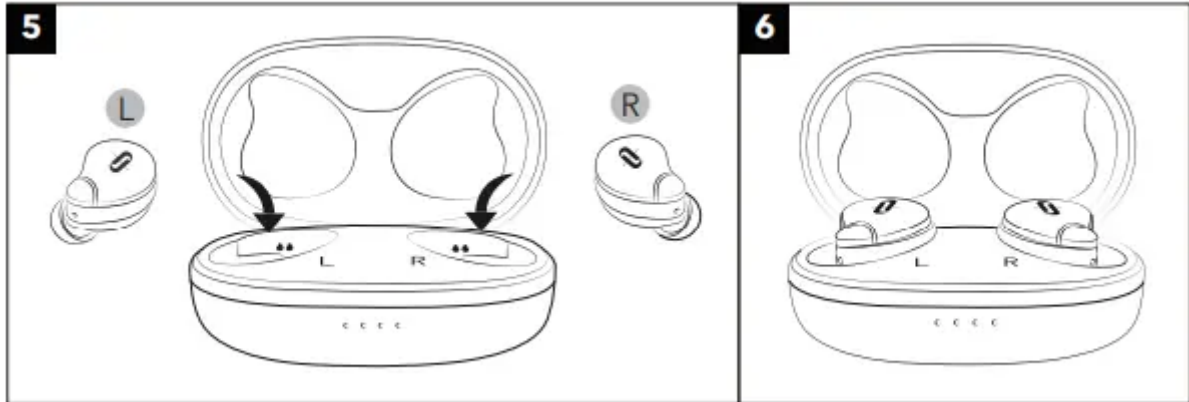

## Charging the Charging Case

1. Connect the charging port with any USB charging adapter or active computer USB port (Fig. 7).
2. The four charging indicators will light up progressively.

Note: Unplug the charging cable (timely) when fully charged.

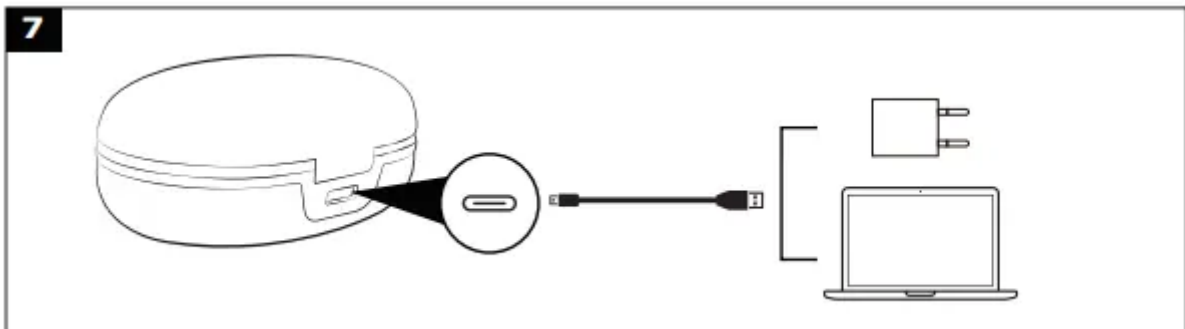

## Power On (Fig. 8)

- Uncover the lid and they will power on automatically.

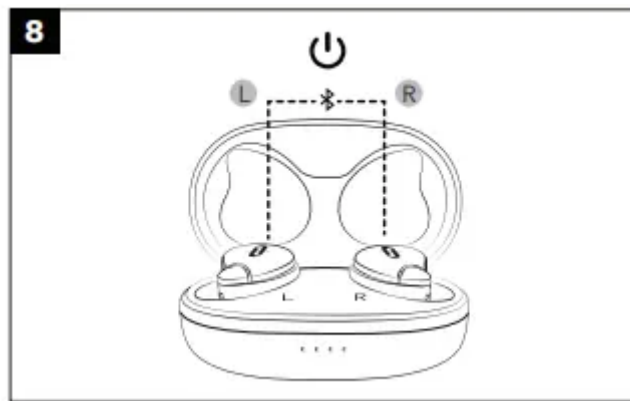

### Power Off (Fig. 9)

- Put the earbuds into the charging case and close the lid, they will turn off automatically.

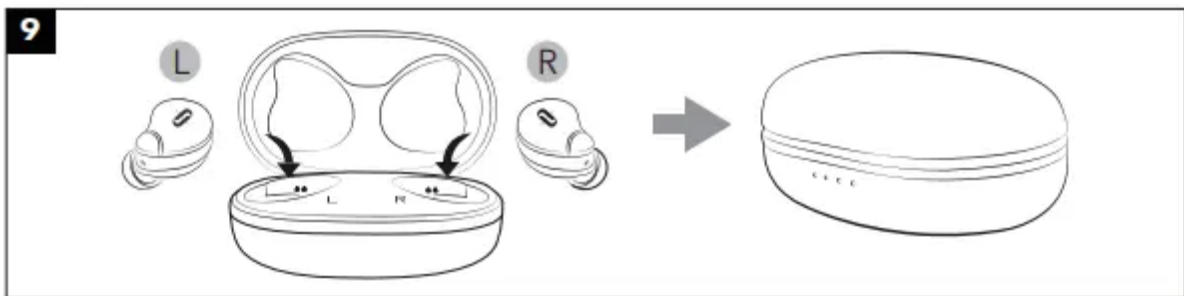

### Pairing

- You can use one earbud or both earbuds as per your preference. Please refer to the corresponding pairing instructions.
- Before pairing, please turn off other Bluetooth devices and place the device to be connected close to the earbuds
- When the earbuds are disconnected from your device for more than 10 minutes, they will turn off automatically.

### Couple Earbuds Mode

1. Uncover the lid to turn on the earbuds, they will connect with each other automatically. The LED indicators on both earbuds will flash blue and white alternately indicating the earbuds are in pairing mode now.
2. Turn on the Bluetooth function on your device and search for nearby devices. Find "TAOTRONICS SoundLiberty 79" in the searching results, tap on the name to connect.
3. Once connected, the LED indicators on both earbuds will flash blue slowly.

Note:

- The earbuds can remember the devices paired previously, and will attempt to pair with the last connected device for the first 20 seconds. If re-pairing failed in 20 seconds, the earbuds will enter pairing mode.
- It is not recommended to wear the two earbuds on different people. If needed, please keep the 2 earbuds within 3 meters / 9.8 feet in couple earbuds mode.

## Single Earbud Mode

Single Earbud Mode is available only when the earbuds have been paired with your device in Couple Earbuds Mode.

1. Take out one earbud from the charging case, and make sure the other one is placed in the charging case and the lid is covered.
2. It will try to pair with the last paired device in Couple Earbuds Mode. Once connected, the LED indicator on the earbud will flash blue slowly.
3. If pairing failed, re-pair both earbuds with your Bluetooth® device first as instructed in "Couple Earbuds Mode" section.

Note: If you want to change to couple mode, simply take out the other earbud from the charging case, they will pair with each other automatically.

## Clear Pairing List

If you failed to pair your device with the earbuds, please clear the pairing history as instructed below:

1. Take out one of the earbuds, close the lid, then press and hold the Multifunction Touch Control of the earbud for 10 seconds until the LED indicator flashes white three times.
2. Uncover the lid, take out the other earbud, then press and hold its Multifunction Touch Control for 10 seconds until the LED indicator flashes white three times.
3. Put both earbuds back into the charging case, close the lid, then uncover it after 5 seconds to re-pair with your Bluetooth® device as instructed in "Pairing" section.
4. If you have paired your device with the earbuds before, remove "TAOTRONICS SoundLiberty 79" from the Bluetooth device list and pair again.

Note: If you want to pair the earbuds with another device when you have already paired them with a device, deactivate the Bluetooth function on the paired device or clear "TAOTRONICS SoundLiberty 79" from its Bluetooth list. Restore the earbuds to factory settings as instructed above if pairing failed.

## OPERATION AND FUNCTIONS

| Function                 | Operation   | Voice Prompt                          |
|--------------------------|---|---------------------------------------|
| Play / Pause             | Tap the Touch Control on either of the earbuds twice                  | /                                     |
| Volume +                 | Tap the Touch Control on the right earbud.                            | Toots when highest setting is reached |
| Volume -                 | Tap the Touch Control on the left earbud                              | Toots when lowest setting is reached  |
| Next Track               | Tap the Touch Control on the right earbud three times                 | /                                     |
| Previous Track           | Tap the Touch Control on the left earbud three times                  | /                                     |
| Answer Phone Call        | Tap the Touch Control on either of the earbuds once                   | /                                     |
| Hang up Phone Call       | Tap and hold the Touch Control on either of the earbuds for 2 seconds | /                                     |
| Decline an Incoming Call | Tap and hold the Touch Control on either of the earbuds for 2 seconds | Call rejected                         |
| Redial                   | Tap the Touch Control on either of the earbuds four times             | /                                     |

|  |   |              |
|--|---|--------------|
| Turn On / Off Voice Control                              | When paired successfully, press and hold the Touch Control on either of the earbuds for 2 seconds until a beep is heard | Toot         |
| Clear Pairing List                                       | Refer to the "Clear Pairing List" section   | /            |
| Go into Pairing Mode                                     | Refer to the "Pairing" section  | Pairing      |
| Successfully paired with your device                     | /   | Connected    |
| Bluetooth out of Range / Failed to pair with your device | /   | Disconnected |

Note: Only when you are wearing the earbuds can you hear the voice prompt.

## CLEANING AND MAINTENANCE

1. Clean the earbuds and the charging case on a regular basis.
2. Use dry and soft cotton cloth to wipe the unit. Note: Do not insert anything into the product.
3. Keep away from sharp objects to avoid scratches.
4. Put the unit in a dry and shady place if it is to be idle for a long time.
5. Do not clean the product with detergent or chemicals.

# TROUBLESHOOTING



| No. | Problem  | Solution   |
|-----|--|--|
| 1   | Failed to turn on the earbuds  | Earbuds low battery, please charge them  |
| 2   | Failed to charge the earbuds   | <ul style="list-style-type: none"> <li>• Place the earbuds into the charging case properly</li> <li>• Make sure the charging case is charged fully</li> </ul>  |
| 3   | Can't charge the charging case                                       | Make sure the charging cable is intact and plugged in properly   |
| 4   | Can't find "TAOTRONICS SoundLiberty 79" in the Bluetooth device list | <p>The earbuds reconnected with previously paired device automatically:</p> <ul style="list-style-type: none"> <li>• Deactivate the Bluetooth function of previously paired device or clear "TAOTRONICS SoundLiberty 79" from its Bluetooth device list, and then search again</li> <li>• Put the device to be connected and the earbuds within 10 meters / 33 feet</li> </ul> |
| 5   | Failed to pair the earbuds with your device                          | <ul style="list-style-type: none"> <li>• Turn on the device and activate its Bluetooth function before pairing</li> <li>• Bring the earbuds into pairing mode as instructed in the "Pairing" section</li> </ul>  |
| 6   | No sound in one of the earbuds in couple earbuds mode                | Place both earbuds back to the charging case then take them out, they will pair with each other automatically. If pairing failed, restore them back to the factory settings as instructed in the "Restore to Factory Settings" section   |
| 7   | Poor sound quality   | <ul style="list-style-type: none"> <li>• Wear the earbuds properly and keep them close to each other.</li> <li>• Place the connected device close to the earbuds or remove the obstacles between them</li> <li>• Clear the debris on the earbuds</li> </ul>  |
| 8   | Unstable connection  | <ul style="list-style-type: none"> <li>• Keep the earbuds and your Bluetooth device within 10 meters / 33 feet</li> </ul>  |



|    |  |   |
|----|--|---|
|    |  | <ul style="list-style-type: none"> <li>• The effective distance may shorten with obstacles in the way</li> <li>• Turn off other Bluetooth devices to decrease the interference</li> </ul> |
| 9  | Can't hear the other party during a phone call             | Set the volume to higher level  |
| 10 | The other party can't hear your voice during a phone call  | Free the built-in microphone of any covers  |
| 11 | Multifunction Touch control of the earbuds is unresponsive | Place the two earbuds into the charging case and cover the lid, disconnect the Bluetooth connection. Uncover the lid to turn on the earbuds and pair again.                               |

### Warning

This content is compiled from multiple sources and is provided for reference purposes only. It may not be complete or fully applicable to all situations. If you are unable to resolve your issue, please contact the product manufacturer or an authorized service provider for official support.