



# Portable Tire Inflator User Manual

Please read the instructions carefully before use



Thank you for choosing Our tire inflator.  
CAUTION - To reduce the risk of electric shock, do not expose to rain.

## CONTENTS

1. Packaging Contents.....	02
2. Tire Pressure Reference Range.....	03
3. Product Overview.....	04
4. Display Overview.....	05
5. How To Turn On/off The Device.....	05
6. How To Charge Your Device.....	06
7. How To Connect The Inflation Hose.....	07
8. How To Inflate A Car Tire.....	07
9. How To Inflate A Bike Tire.....	07
10. How To Inflate A Motorcycle Tire.....	08
11. How To Inflate A Ball.....	08
12. How To Switch Units.....	08
13. How To Turn Lights On/off.....	08
14. How To Use the 12V Plug.....	09
15. Troubleshooting.....	09
16. Specifications.....	10
17. Safety Instructions.....	10-11
18. Warranty Information.....	11-12

# PACKAGING CONTENTS



Tire Inflator x1

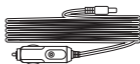

12V Plug x1



Charging cable x1



French bicycle valve x1



Ball needle x1



Universal valve x1

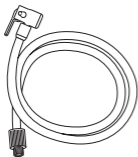

Inflation Hose x1



Storage bag x1



Manual x1

## TIRE PRESSURE REFERENCE RANGE

NAMET	TYPE	REFERENCE RANGE
Car	Sedan	32-36 psi
	SUV	32-36 psi
Bike	Mountain Bike	30-90 psi
	Road Vehicles	80-120 psi
Motorcycle	Motorcycle	26-44 psi
Ball	Basketball	7-9 psi
	Soccer	8-10 psi
	Football	12.5-13.5 psi

# PRODUCT OVERVIEW

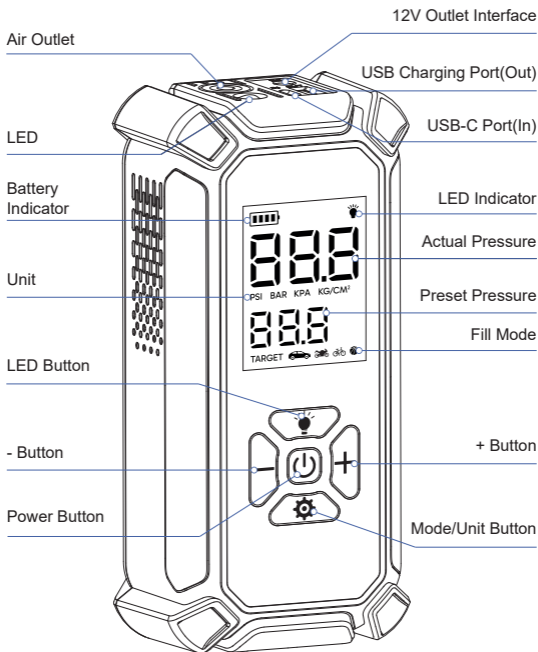

## DISPLAY OVERVIEW

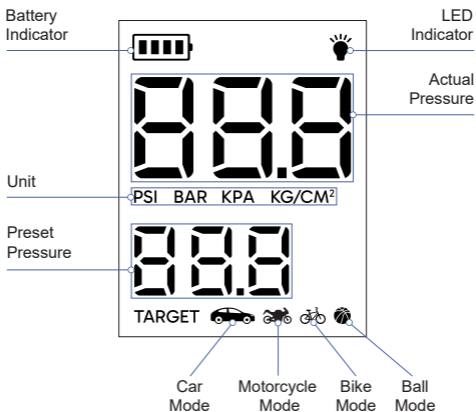

## HOW TO TURN ON/OFF THE DEVICE?

### How to turn on?

Press the power button “” for 2 seconds.

### How to turn off?

Press the power button “” for 2 seconds.

# HOW TO CHARGE THE DEVICE?

## BATTERY LEVEL INDICATOR

4 Bars: 75-100% Battery

3 Bars: 50-75% Battery

2 Bars: 25-50% Battery

1 Bar: 5-25% Battery

1 bar Blinking: 0-5% Battery





## Reminder:

1. A blinking 1-bar indicator signals low battery. Recharge promptly when this occurs.
2. When charging, the icon  is flashing means that the charger is faulty and you need to change to another charger for charging.

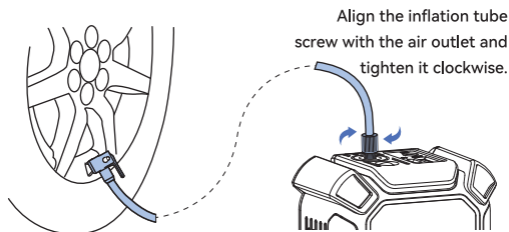

## HOW TO CONNECT THE INFLATION HOSE?





## HOW TO INFLATE A CAR TIRE?

1. Align the inflation tube screw with the air outlet and tighten it clockwise.
2. Affix the nozzle to the tire valve.
3. Select the car mode “” and choose the desired air pressure.
4. Press the power button “” to start inflating.
5. After the inflation is completed, the device will automatically stop.



## HOW TO INFLATE A BIKE TIRE?

1. Align the inflation tube screw with the air outlet and tighten it clockwise.
2. Affix the nozzle to the tire valve.
3. Select bicycle mode “” and choose the desired air pressure.
4. Press the power button “” to start inflating.
5. After the inflation is completed, the device will automatically stop.

## HOW TO INFLATE A MOTORCYCLE TIRE?

1. Align the inflation tube screw with the air outlet and tighten it clockwise.
2. Affix the nozzle to the tire valve.
3. Select the motorcycle mode “” and choose the desired air pressure.
4. Press the power button “” to start inflating.
5. After the inflation is completed, the device will automatically stop.

## HOW TO INFLATE THE BALL?

1. Align the inflation tube screw with the air outlet and tighten it clockwise.
2. Affix the nozzle to the ball needle and insert into the ball hole.
3. Select the ball mode “” and choose the desired air pressure.
4. Press the power button “” to start inflating.
5. After the inflation is completed, the device will automatically stop.

## HOW TO SWITCH UNITS?

This product provides four air pressure units for your choice.

The four units are: PSI, BAR, KPA, KG/CM<sup>2</sup>

You can long press the mode button “” to switch units.

## HOW TO TURN LIGHTS ON/OFF

Turn on the device, press the light button “” to turn on, press the light button again to slow down the flashing.

Press the light button “” again to speed up the flashing.

To turn it off, press the light button “” again.

## How To Use the 12V Plug?

If the inflator is low in battery.  
You can use the 12V Plug to inflate.

**The steps are as follows:**

1. Start the car
2. Insert into the car's 12V plugin hole
3. Connect the 12V Plug port on top of the machine

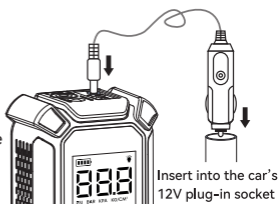

## TROUBLESHOOTING

PROBLEM NAME	SOLUTION
Inflates Slowly	<ol style="list-style-type: none"><li>1. Check whether the battery of the air pump is sufficient.</li><li>2. Check whether the air pipe is leaking.</li><li>3. Check whether or not both ends of the inflation hose are firmly connected.</li><li>4. Check whether the item being inflated is leaking</li></ol>
Not Inflatable	<ol style="list-style-type: none"><li>1. Check whether the battery of the air pump is sufficient.</li><li>2. Check whether the pressure of the inflated item exceeds the preset pressure.</li></ol>
Not Charging	<ol style="list-style-type: none"><li>1. Using the certified adapter and the included charging cable, try charging again.</li></ol>

## SPECIFICATION

PRODUCT NAME	PORTABLE TIRE INFLATOR
Operating Temperature	0-45°C
Charging Port	USB-C
Charging Time	3.5 hours

## SAFETY INSTRUCTIONS

1. This product is not a toy. Please keep it away from children.
2. There is a lithium battery inside the product. Please do not put the product in fire.
3. For better product performance, allow the pump to cool for 2 minutes after 20 minutes of continuous use.
4. Storing the product for a long time may reduce the energy efficiency of the battery. Charge the device every three months to maintain its performance.
5. This product has a built-in DC motor, which may generate sparks during operation. Please do not use it in an environment with dust or explosive gas
6. If there is abnormal noise or the temperature is too high during the inflation process, please turn it off immediately.
7. Do not run the equipment unattended to avoid danger.
8. Please use it in a dry and clean environment. The intrusion of sand and dust may damage the product. Do not wash the product with water.

9. Please use the certified 5V/2A adapter and the accompanying charging cable to charge this product. Failures caused by failure to operate as required are not covered by the warranty.
10. After long-term operation, the temperature at the connection between the air pipe and the device will become very high. To avoid burns, please avoid touching it.

## **WARRANTY INFORMATION**

### **TWO YEAR NON-TRANSFERRABLE LIMITED WARRANTY**

To provide customers with quality shopping and user experience, we guarantee to replace or issue a refund or provide acceptable solutions to any defective products (per customer preference) from the date of purchase to 2 years.

The warranty is not transferable. We only provide warranty services for buyers purchased from our store and the recipients possess the purchase proof, and not any other purchaser or subsequent owner.

Price matching policy is not applicable. No price difference refund.

## **WHAT IS COVERED**

- 1.Received defective or used (proof needed) products;
- 2.Received with missing parts;
- 3.Defective item under proper use.

## **WHAT IS NOT COVERED**

- 1.Purchased from non-Aborder Products or other physical stores;
- 2.Gift without proof of purchase;
- 3.Tampering/abnormal use/accidental damage;
- 4.Replacements and parts,
- 5.Installation fee/labor fee.

## **MAKING A CLAIM**

Gifted parts, replacements, consumable products are not covered by the 2-year warranty. Manufacturer's warranties may not apply in all cases, depending on factors such as use of the product, where the product was purchased, or who you purchased the product from. Please review the warranty carefully, and contact the manufacturer if you have any questions.

**This device complies with Part 15 of the FCC Rules. Operation is subject to the following two conditions:**

(1) this device may not cause harmful interference, and (2) this device must accept any interference received, including interference that may cause undesired operation.

Warning: Changes or modifications to this unit not expressly approved by the party responsible for compliance could void the user's authority to operate the equipment.

Note: This equipment has been tested and found to comply with the limits for a Class B digital device, pursuant to part 15 of the FCC Rules. These limits are designed to provide reasonable protection against harmful interference in a residential installation. This equipment generates, uses and can radiate radio frequency energy and, if not installed and used in accordance with the instructions, may cause harmful interference to radio communications. However, there is no guarantee that interference will not occur in a particular installation. If this equipment does cause harmful interference to radio or television reception, which can be determined by turning the equipment off and on, the user is encouraged to try to correct the interference by one or more of the following measures:

- Reorient or relocate the receiving antenna.
- Increase the separation between the equipment and receiver.
- Connect the equipment into an outlet on a circuit different from that to which the receiver is connected.
- Consult the dealer or an experienced radio/TV technician for help.