

Setup Guide

(EN, DE, FR, IT, ES)



We're here to help

Nixplay cares deeply about providing your family with a great frame and service. We go to great lengths to ensure your frame is delivered into your hands in perfect working order.

If your Nixplay Frame isn't working perfectly, please do let us know. We're just a phone call, email or chat away.

Online Help Center:
www.nixplay.com/support

Contact Us:
support@nixplay.com

Call Us:
 US (855)-649-7529, (855)-NIXPLAY

Mon – Sat, 9am - 5pm, Central Time

For more information on how to use your frame, please visit: www.nixplay.com

Your frame's serial number is available on the stand of your frame or under your frame's Settings.

The e-label can be found in the Information section of your frame's Settings.

Step 1: Open up Settings page

Step 2: Select Information

Step 3: Scroll to view e-label for product and compliance information

Step 1

- EN Insert the stand into the hole on the frame
- DE Stecken Sie den Ständer in das Loch am Rahmen
- FR Insérez le support dans le trou du cadre
- IT Inserire il supporto nel foro sul telaio
- ES Inserte el soporte en el agujero del marco

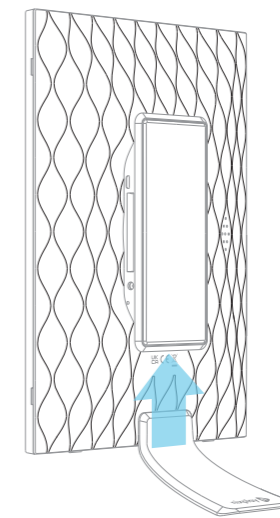

Portrait View

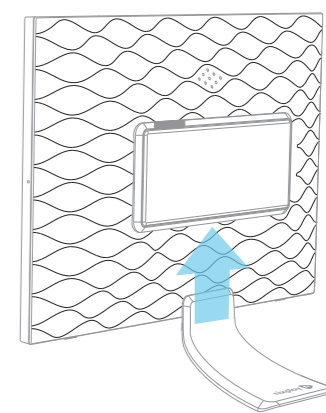

Landscape View

Step 2

- EN Insert power cord firmly
- DE Netzkabel fest einstecken
- FR Insérez fermement le câble d'alimentation
- IT Inserisci correttamente il cavo di alimentazione
- ES Inserte el cable de alimentación firmemente

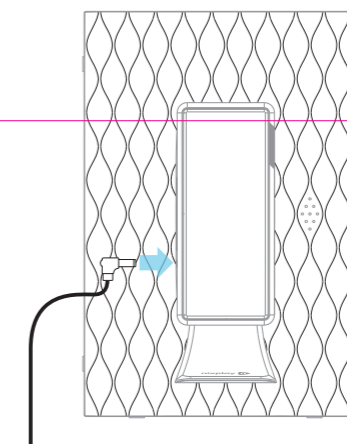

Portrait View

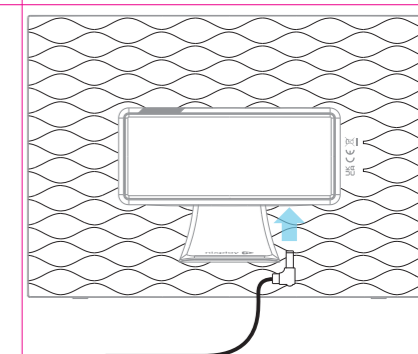

Landscape View

Step 3

- EN Position in landscape or portrait
- DE Im Quer- oder Hochformat positionieren
- FR Positionnez le cadre en mode paysage ou portrait
- IT Posiziona la cornice in orizzontale o verticale
- ES Coloque la unidad en posición vertical u horizontal

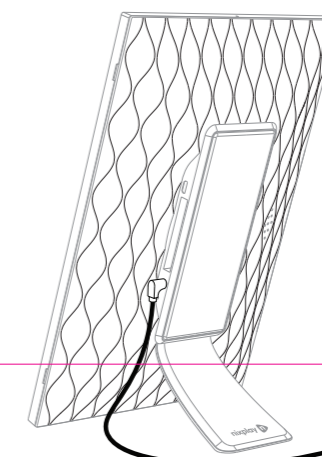

Portrait View

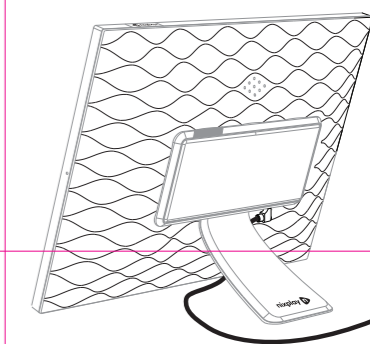

Landscape View

Step 4

You're almost there!

Create your Nixplay account and add your frame, use either your Mobile Phone or Computer:

Apple App Store or Google Play



Computer: nixplay.com/setup

DE Erstellen Sie Ihr Nixplay-Konto und fügen Sie Ihren Rahmen hinzu, entweder über Ihr Handy oder Ihren Rechner

FR Créez votre compte Nixplay et ajoutez le cadre en utilisant votre smartphone ou votre ordinateur

IT Crea il tuo account Nixplay, aggiungi la cornice e usala con il cellulare o il computer

ES Cree su cuenta de Nixplay y agregue el marco mediante su teléfono móvil o equipo informático

DE

Wir sind für Sie da

Online-Hilfe-Center:

www.nixplay.com/support

Kontaktieren Sie uns:

support@nixplay.com

Weitere Informationen zur Verwendung Ihres Rahmens finden Sie unter:

www.nixplay.com

Die Seriennummer Ihres Rahmens finden Sie auf der Rückseite Ihres Rahmens oder in den Einstellungen Ihres Rahmens. Das E-Label finden Sie im Bereich Informationen in den Einstellungen Ihres Rahmens.

Das e-Label finden Sie im Abschnitt Informationen in den Einstellungen Ihres Rahmens:

- 1 - Öffnen Sie die Seite „Einstellungen“
- 2 - Wählen Sie „Informationen“
- 3 - Scrollen Sie, um das e-Label für Produkt- und Compliance-Informationen anzuzeigen

FR

Nous sommes là pour vous aider

Centre d'assistance en ligne :

www.nixplay.com/support

Contactez-nous :

support@nixplay.com

Pour plus d'informations sur l'utilisation de votre cadre, veuillez consulter le site :

www.nixplay.com

Le numéro de série de votre cadre est indiqué au dos de votre cadre et dans les Paramètres de votre cadre. L'étiquette électronique figure dans la section Informations des Paramètres de votre cadre.

L'étiquette électronique se trouve dans la section « Informations » des paramètres de votre cadre :

- 1 - Ouvrez la page « Paramètres »
- 2 - Sélectionnez « Informations »
- 3 - Descendez pour voir les informations relatives au produit et à sa conformité

IT

Siamo qui per aiutarti

Centro di assistenza online:

www.nixplay.com/support

Contattaci:

support@nixplay.com

Per ulteriori informazioni su come utilizzare la tua cornice, visita:

www.nixplay.com

Il numero di serie della cornice è riportato sul retro della cornice o nelle Impostazioni della cornice. L'etichetta elettronica si trova nella sezione Informazioni delle Impostazioni della cornice.

L'e-label si trova nella sezione informazioni delle impostazioni della tua cornice:

- 1 - Apri la pagina "Impostazioni"
- 2 - Seleziona "Informazioni"
- 3 - Scorri per visualizzare l'e-label per informazioni sul prodotto e sulla conformità

ES

Estamos aquí para ayudarle

Centro de ayuda en línea:

www.nixplay.com/support

Póngase en contacto con nosotros:

support@nixplay.com

Para más información sobre el uso de su marco, visite:

www.nixplay.com

El número de serie del marco se encuentra en la parte posterior de este, o en el menú Configuración. La etiqueta electrónica se puede encontrar en la sección Información del menú Configuración del marco.

La etiqueta electrónica se encuentra en la sección "Información", dentro de "Configuración" de su marco:

- 1 - Abra la página "Configuración"
- 2 - Seleccione "Información"
- 3 - Desplácese para ver la etiqueta electrónica y así obtener información sobre el producto y su cumplimiento

FCC Compliance Notification

Warning:

This device complies with Part 15 of the FCC Rules. Operation is subject to the following two conditions:

1. this device may not cause harmful interference, and
2. this device must accept any interference received, including interference that may cause undesired operation. Changes or modifications not expressly approved by the party responsible for compliance could void the user's authority to operate the equipment.

This equipment has been tested and found to comply with the limits for a Class B digital device, pursuant to Part 15 of the FCC Rules. These limits are designed to provide reasonable protection against harmful interference in a residential installation. This equipment generates, uses and can radiate radio frequency energy and, if not installed and used in accordance with the instructions, may cause harmful interference to radio communications. However, there is no guarantee that interference will not occur in a particular installation. If this equipment does cause harmful interference to radio or television reception, which can be determined by turning the equipment off and on, the user is encouraged to try to correct the interference by one or more of the following measures:

- Reorient or relocate the receiving antenna.
- Increase the separation between the equipment and receiver.
- Connect the equipment into an outlet on a circuit different from that to which the receiver is connected.
- Consult the dealer or an experienced radio/TV technician for help.

This equipment complies with FCC radiation exposure limits set forth for an uncontrolled environment. This equipment should be installed and operated with minimum distance 20cm between the radiator and your body. This transmitter must not be co-located or operating in conjunction with any other antenna or transmitter.

ISED Compliance Notification

Warning:

This device contains licence-exempt transmitter(s)/receiver(s) that comply with Innovation, Science and Economic Development Canada's licence-exempt RSS(s). Operation is subject to the following two conditions:

1. This device may not cause interference.
2. This device must accept any interference, including interference that may cause undesired operation of the device.

This equipment complies with IC RSS-102 radiation exposure limits set forth for an uncontrolled environment. This equipment should be installed and operated with minimum distance 20cm between the radiator and your body.

Avertissement:

L'émetteur/récepteur exempt de licence contenu dans le présent appareil est conforme aux CNR d'Innovation, Sciences et Développement économique Canada applicables aux appareils radio exempts de licence. L'exploitation est autorisée aux deux conditions suivantes :

1. L'appareil ne doit pas produire de brouillage;
2. L'appareil doit accepter tout brouillage radioélectrique subi, même si le brouillage est susceptible d'en compromettre le fonctionnement.

Cet équipement est conforme aux limites d'exposition aux radiations IC CNR-102 établies pour un environnement non contrôlé. Cet équipement doit être installé et utilisé avec une distance minimale de 20 cm entre le radiateur et votre corps.