

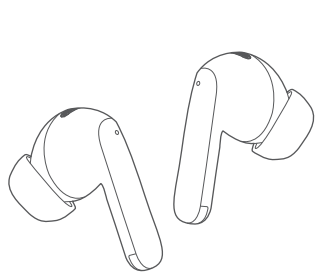

# QCY MeloBuds Pro 真无线降噪耳机

## 认识耳机



使用前,请下载安装QCY手机APP客户端  
以获得更便捷的耳机操控体验

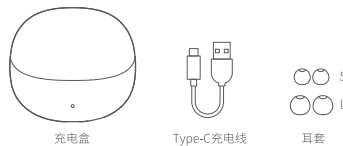
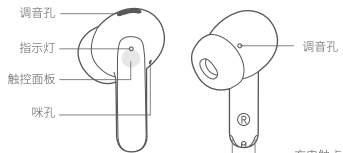

本说明书中的图片均为示意图,可能与实物有偏差,请以实物为准。

## 耳机配对

### 首次配对方法:

- 取出两只耳机,同时撕掉耳机上的隔离膜,再将两只耳机放回充电盒中,合上充电盒盖子。(此步骤为新机激活)
- 再次取出两只耳机。
- 刷新手机蓝牙设备列表,点击配对QCY MeloBuds Pro,完成配对。  
\*充电盒打开盖子,耳机自动开机,若未自动开机,请充电后重新尝试。

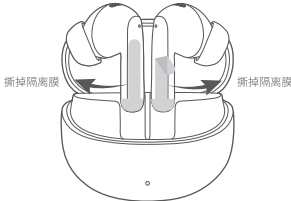

### 一键切换配对设备:

- (此步骤为A设备切换B设备)
- 打开盖子,左右耳机在充电盒中,长按充电盒按键约3秒,耳机闪白1次,在设备上搜索耳机,点击连接。  
\*耳机支持同时连接两台设备(需要在QCY APP设置开启)。

## 多设备连接

### 多设备连接方法:

- (需要在QCY APP设置开启)
- 耳机开机进入配对状态,连接设备A后,从手机端关闭蓝牙。耳机再次进入配对状态。
  - 设备B打开蓝牙并点击耳机配对名QCY MeloBuds Pro,完成配对。
  - 设备A上打开蓝牙并点击已配对过的耳机配对名,配对成功,此时耳机端同时连接两台设备。(一拖二功能和LDAC音频解码格式,不能同时开启)



## 恢复出厂设置

### 清除配对记录

(此方法用于无法正常连接的情况)

耳机在充电盒内,充电盒开盖,长按充电盒按键10秒,耳机红闪5次,闪烁停止后位置完成。  
\*恢复出厂设置后用首次配对的方法连接即可正常使用。

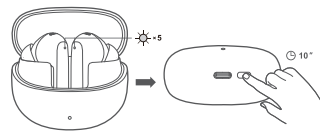

## 操作说明

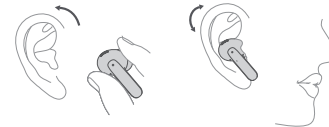

- 请正确佩戴左右耳机,戴上耳机后可微微转动调整,找到个人舒适且稳固的位置。
- 麦克风风口往下,朝嘴巴方向。
- 错误佩戴耳机会导致通话,听觉都受到不同程度的影响。  
\*若佩戴不够密闭,ANC降噪效果会变弱,可以尝试调整佩戴角度和方向后重新开启自适应降噪模式。

## 耳机充电

充电中红色灯长亮,充满后灯熄灭

## 充电盒充电

充电中: 红色灯长亮  
充满电: 白色灯长亮

## 充电盒亮灯电量提示

充电盒有电: 充电盒开盖,白色灯长亮5秒后熄灭  
充电盒低电: 充电盒开盖,红色灯长亮5秒后熄灭

## 功能介绍

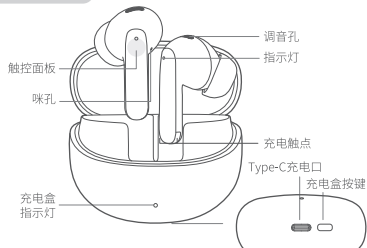

- Ⓞ 开机: 充电盒开盖(耳机在充电盒内)  
长按触控面板1.5秒(耳机在充电盒外)
- Ⓞ 关机: 耳机放入充电盒,合盖
- Ⓞ 接听/挂断: 双击触控面板
- Ⓞ 拒接电话: 长按触控面板1.5秒
- Ⓞ 播放/暂停: 双击触控面板
- Ⓞ 下一曲: 三击右耳触控面板
- Ⓞ 语音助手: 三击左耳触控面板
- Ⓞ 低延迟: 长按左耳触控面板1.5秒
- Ⓞ 自适应ANC/普通模式/通透模式: 长按右耳触控面板  
1.5秒循环切换

## 售后服务

QCY产品售后服务承诺: 严格按照《中华人民共和国消费者权益保护法》、《中华人民共和国产品质量法》实行售后三包服务,服务内容如下:  
在三包有效期内,您可凭购买凭证依照国家规定享受免费的修理、更换、退货的权利。

- 自您购买之日起7日内,本产品出现故障,经由QCY售后服务中心确定为产品质量问题,可享受修理、更换、退货的服务。
- 自您购买之日起15日内,本产品出现故障,经由QCY售后服务中心确定为产品质量问题,可享受修理或更换的服务。
- 自您购买之日起12个月内,本产品出现故障,经由QCY售后服务中心确定为产品质量问题,可享受修理的服务。

售后服务与保修期:  
自产品购买之日起12个月(请妥善保管购买凭证)。

免费服务:  
在产品保修期内,凡属产品本身质量引起的故障,请用户凭购买凭证与经商取得联系享受售后服务。  
如有任何产品损害或损坏非可归咎于产品质量本身,则不在保修范围内。有下列情形者不属于保修范围:  
1、因火灾、地震、雷击、异常电压、环境因素而发生之故障或毁损。  
2、自行或委托未经原厂授权维修之厂商拆卸、改装或更换非原厂零件。  
3、未按使用手册操作或因为使用不当而造成损坏者,如产品浸水、腐蚀、掉落、挤压或落在异常温湿度环境下。

## 三包凭证

产品信息:  
产品型号: \_\_\_\_\_  
订单编号: \_\_\_\_\_  
用户信息:  
用户姓名: \_\_\_\_\_  
联系电话: \_\_\_\_\_  
用户地址: \_\_\_\_\_  
退换货原因: \_\_\_\_\_  
购买信息:  
销售单位: \_\_\_\_\_

## FAQ

- Q: 只有一只耳机有声音怎么办?  
A: 将两只耳机放回充电盒盖盖,再重新取出,查看双耳是否有声音,若还是只有单耳耳机有声音,请对两只耳机恢复出厂设置。
- Q: 手机提示无法连接怎么办?  
A: 将手机上的配对记录删除,删除后重新进行搜索配对连接即可。
- Q: 听歌/通话没声音怎么办?  
A: 安卓手机在蓝牙连接名字的右边有个设置图标,点击进入,关闭手机音频和媒体音频,再重新开启,若还是无声,请将耳机重新与手机配对连接。
- Q: 为什么视频/游戏有延迟?  
A: 受使用环境、网络、手机编解码等因素的影响,会引起手机发送音频数据到耳机时有不同程度的延迟。
- Q: 听到的声音卡顿/断续怎么解决?  
A: 在使用时若周围有大量的Wi-Fi、5G/4G信号、大功率电器等等产生干扰,可能会引起卡顿、断续的情况,换个环境或者重新配对连接就可以解决了。

若有售后服务需求,请联系客服  
电话: 4008-306-708  
网址: www.qcy.com  
制造商: 东莞市和东电子有限公司  
地址: 广东省东莞市道滘镇粤晖路325号

## 提示

- 使用产品前请仔细阅读本使用说明书并请妥善保管;
- 首次使用时,请先将本产品充满电;
- 如果产品长期(超过2个星期)不用,请对其充电;
- 必须选择正规厂家生产且经过国家CCC认证的充电器;
- 若手机无法搜索到蓝牙耳机,请将蓝牙耳机重新进入配对模式或将蓝牙耳机恢复出厂设置,若手机程序出错,请把手机蓝牙关闭再开启或重启手机。

## 电池安全

- 请勿拆解或改装电池、插入异物、置入高温、或浸入水或其他液体中,以免引起电池漏液、过热、起火或爆炸。电池只能由制造商更换。
- 请勿跌落、挤压或穿刺电池。避免让电池遭受外部的压力,从而导致电池内部短路和过热。

- 请勿以任何理由拆除或维修改装耳机,否则可能会导致起火,电子击穿甚至彻底损坏本品;
- 请勿将产品置于温度过低或过高(0°C以下或45°C以上的环境温度);
- 请避免靠近儿童或动物的眼睛使用产品指示灯;
- 请勿在雷暴天气下使用该产品,雷暴可导致本产品工作不正常,并增加触电的危险;
- 请勿用油及其他挥发性液体擦拭本产品;



长时间使用耳机可能会造成听力损害,请合理安排使用时间。

## 产品有害物质名称及含量

部件名称	有害物质					
	铅 (Pb)	汞 (Hg)	镉 (Cd)	六价铬 (Cr(VI))	多溴联苯 (PBB)	多溴二苯醚 (PBDE)
外壳	○	○	○	○	○	○
电路板组件	×	○	○	○	○	○
电池	○	○	○	○	○	○
充电线	×	○	○	○	○	○
附件	○	○	○	○	○	○

本表格依据SJ/T 11364的规定编制  
○: 表示该有害物质在该部件所有均质材料中的含量均在GB/T 26572规定的限量要求以下。  
×: 表示该有害物质至少在该部件的某一均质材料中的含量超出GB/T 26572规定的限量要求。

使用年限  
如本手册所述,在正常使用条件下,本产品的环保使用期限为10年。  
在此期间,产品不会泄露任何危险物质,本产品可以回收,必须按照当地法规处理。



默认开启LDAC,如需关闭LDAC功能请在APP里操作。



## QCY MeloBuds Pro

Truely Wireless Noise Cancelling Earbuds

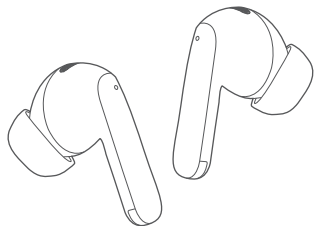

Download the QCY APP to experience the full range of features such as ambient sound modes, EQ tuning, firmware updates, and more.

## Functions

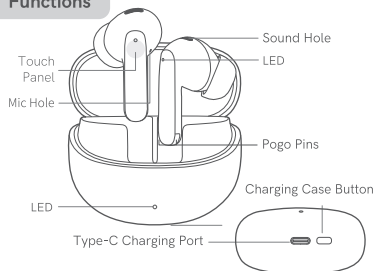

- Ⓜ Power On: Open the charging case (earbuds inside) or, if the earbuds are outside the case, long-press the touch panel for 1.5 seconds.
- Ⓜ Power Off: Place the earbuds into the charging case and close the lid.
- 📞 Answer/End Call: Double-tap the touch panel.
- 📞 Reject Call: Long-press the touch panel for 1.5 seconds.
- 🎵 Play/Pause: Double-tap the touch panel.
- 🎵 Next Track: Triple-tap the touch panel of the right earbud.
- 🎵 Voice Assistant: Triple-tap the touch panel of the left earbud.
- 🔊 Low Latency: Long-press the touch panel of the left earbud for 1.5 seconds.
- 🔊 Adaptive ANC/Normal Mode, Transparency Mode: Long-press the touch panel of the right earbud for 1.5 seconds to cycle through the modes.

**M** DAC is activated by default. If you need to disable it, please do it via the app.

## Overview

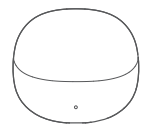
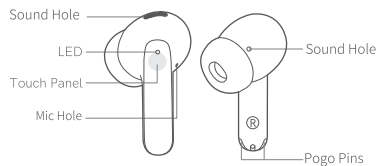

Charging Case



Type-C Charging Cable



Eartips

Note: The images in this manual are for reference only and may vary from the actual product. Please refer to the actual product for accuracy.

## Bluetooth Pairing

### Initial Pairing:

1. Take out both earbuds, peel off the isolation film from each, and place them back into the charging case. Close the lid to activate the new device.
2. Retrieve both earbuds again, Refresh your phone's Bluetooth devices, pair with QCY MeloBuds Pro, and complete the setup.

\*Opening the charging case turns on the earbuds. If not, try again after charging.

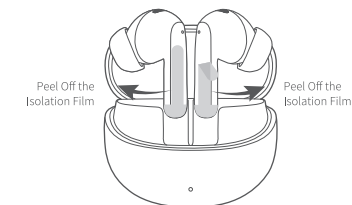

### One-Click Device Switching: (This step switches from Device A to Device B.)

Open the lid, keep both earbuds in the charging case, and press the case button for about 3 seconds. The earbuds will flash white once. Search for them on the device and click to connect.

\*The earbuds support connecting to two devices simultaneously. (Enable in the QCY APP settings)

## Multi-Device Connection

### Steps for Multi-Device Connection: (Enable in the QCY APP settings)

1. Power on the earbuds to initiate pairing. After connecting to Device A, turn off Bluetooth on the phone. The earbuds will enter pairing mode again.
2. Enable Bluetooth on Device B and select "QCY MeloBuds Pro" for pairing.
3. On Device A, turn on Bluetooth and click the paired earbuds' name. Successful pairing means the earbuds are now connected to both devices simultaneously. (Note: The one-drag-two function and LDAC audio decoding format cannot be enabled simultaneously.)



## Factory Reset

**Clearing Pairing Records (Use in case of connection issues)**  
Place the earbuds in the charging case, open the lid, and press the charging case button for 10 seconds. The earbuds will flash red 5 times, indicating the reset is complete after the blinking stops.

\* After the factory reset, follow the initial pairing method to connect for normal usage.

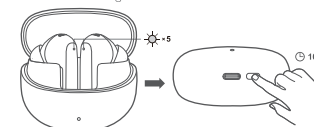

## FCC Statement

This equipment has been tested and found to comply with the limits for a Class B digital device, pursuant to Part 15 of the FCC Rules. These limits are designed to provide reasonable protection against harmful interference in a residential installation. This equipment generates uses and can radiate radio frequency energy and, if not installed and used in accordance with the instructions, may cause harmful interference to radio communications. However, there is no guarantee that interference will not occur in a particular installation. If this equipment does cause harmful interference to radio or television reception, which can be determined by turning the equipment off and on, the user is encouraged to try to correct the interference by one or more of the following measures:

- Reorient or relocate the receiving antenna.
- Increase the separation between the equipment and receiver.
- Connect the equipment into an outlet on a circuit different from that to which the receiver is connected.
- Consult the dealer or an experienced radio/TV technician for help.

This device complies with part 15 of the FCC Rules. Operation is subject to the following two conditions:

- (1) This device may not cause harmful interference, and
- (2) this device must accept any interference received, including interference that may cause undesired operation.

Changes or modifications not expressly approved by the party responsible for compliance could void the user's authority to operate the equipment.

## User Guide

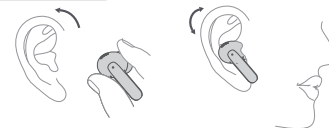

1. Properly wear the earbuds on both the left and right sides. After wearing them, you can make slight adjustments by rotating to find a personally comfortable and secure position.
  2. Ensure the microphone opening is facing downward towards the mouth.
  3. Incorrect earbuds placement may affect both calls and hearing to varying degrees.
- \* If the fit is not snug enough, the ANC (active noise cancellation) effectiveness may decrease. Try adjusting the wearing angle and direction before reactivating the adaptive noise cancellation mode.

## Earbuds Charging

While charging, the red light stays on and turns off when fully charged.

## Charging Case Charging

During charging: The red light stays on.  
Fully charged: The white light stays on.

## Charging Case Battery Status

Sufficient battery: When the charging case is opened, the white light will stay on for 5 seconds before turning off.  
Low battery: When the charging case is opened, the red light will stay on for 5 seconds before turning off.

**Manufacturer:** Dongguan Hele Electronics Co., Ltd.  
**Address:** No. 325 Yuehui Rd, Daojiao Town Dongguan City Guangdong Province China

**Notice:** This marking indicates that this product should not be disposed with other household wastes throughout the EU. To prevent possible harm to the environment or human health from uncontrolled waste disposal, recycle it responsibly to promote the sustainable reuse of material resources. To return your used device, please use the return and collection systems or contact the retailer where the product was purchased. They can take this product for environmental safe recycling.

