

# VENUCAST™

## FreeMic W / Duo

Wireless Headset  
(& Handheld) Microphone Kit



VMC-01  
FreeMic W  
FCC ID:WJ5-MIC01



VMC-02  
FreeMic Duo  
FCC ID:WJ5-MIC02

## Interactive User Guide

Version 2.3



First Time Setup



Troubleshooting

< Back



# Main Menu

1. Before You Start
2. Check Compatibility
3. Connect to Transmitter
4. Other Connections
  - Connect to Speaker
  - Connect to Mixer
5. Use the Microphone
6. Power & Charging
7. Troubleshooting
8. Register & Support

Next



# 1. Before You Start

Wireless mic for AUX audio systems

Best for:

- Teaching / presentations
- Meetings / small events
- Use with Venucast transmitters

Check compatibility before use.

Next



## 2. Check Compatibility

Find the right audio input on your device.

 Works best



3.5mm

- AUX IN

 Also works



6.35 mm

-  IN or MIC IN with a volume knob
- LINE/MIC Combo (Mixer)

 Not Supported

- LINE IN (Mixer)
- MIC IN without a volume knob

Next



< Back



Menu

## Choose your device

Select the device you'll use with the wireless mic kit.



**Transmitter**  
(Recommended)



**Speaker**



**Mixer**



### 3. Connect to Transmitter

Recommended: [Oasis Aura](#)



#### Get full volume & stable sound:

- Use included 3.5mm cable
- Keep the receiver and transmitter apart



What to expect:



**With Headphones:**

- Clear sound
- Low latency



**With Speakers:**

→ [Normal slight delay](#)

→ [Feedback noise?](#)

Next



## 4. Other Connections

### 4.1 Connect to Speaker

★ Works best: AUX IN 3.5mm

**Get full volume & best sound:** Use the included **3.5mm stereo to mono cable**

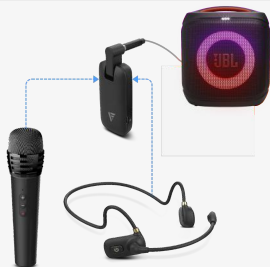

✓ Also works:

👉 IN or MIC IN with a volume knob

*Use the included 6.35mm adapter*



Next



## 4.2 Connect to Mixer

### ✓ Works with

- MIC IN
- LINE/MIC Combo

*Use the included 6.35mm adapter*



Next





## 5. Use the Microphone

Simple controls for everyday use.

- **Power & Connect**

On both mic & receiver, hold Power to turn on

→ Auto-connect (LEDs turn **solid**)

- **Volume**

Press + / - on mic or receiver



- **Range**

Up to 20 m (65 ft)

Next



## 6. Power & Charging

- Use the **USB-C** cable (5V, 1-2.4A).
- **Charging:** LED stays **red**
- **Fully charged:** LED turns **off** (~3h)
- **Playtime:**
  -  48h
  -  11.5h
  -  11.5h

Next



< Back



Menu

## Rate This Guide

Your feedback helps us improve this guide for everyone.

It only takes a moment.



Next



## 7. Troubleshooting

- **Delay** Hear your own voice with **a slight delay?**

→ This is **normal** with Auracast systems

→ Place the speaker further away from you

- **Feedback** High-pitched noise?

→ Lower the volume

→ Keep the mic  $\geq$  **5 m** from the speaker

- **Audio cuts out?**

→ Keep mic closer to the receiver

→ Keep some distance between the transmitter and receiver



*Still need help?* [Contact support](#) ↗

Next



< Back



Menu

## 8. Register & Support

### Agent Support

Need help? We're here.



Email



Call



Chat

### Register Your Product

Extended warranty & get updates.

[Get 36M Warranty](#)



## FCC Requirement

Any changes or modifications not expressly approved by the party responsible for compliance could void the user ' s authority to operate the equipment.

This device complies with Part 15 of the FCC Rules. Operation is subject to the following two conditions:

- (1) this device may not cause harmful interference, and
- (2) this device must accept any interference received, including interference that may cause undesired operation.

Note: This equipment has been tested and found to comply with the limits for a Class B digital device, pursuant to Part 15 of the FCC Rules. These limits are designed to provide reasonable protection against harmful interference in a residential installation. This equipment generates, uses, and can radiate radio frequency energy, and if not installed and used in accordance with the instructions, may cause harmful interference to radio communications. However, there is no guarantee that interference will not occur in a particular installation. If this equipment does cause harmful interference to radio or television reception, which can be determined by turning the equipment off and on, the user is encouraged to try to correct the interference by one or more of the following measures:

- Reorient or relocate the receiving antenna.
- Increase the separation between the equipment and receiver.
- Connect the equipment into an outlet on a circuit different from that to which the receiver is connected.
- Consult the dealer or an experienced radio/TV technician for help.