

Operating Instructions Wireless Speaker System

Model No. SC-NE5DB



Thank you for purchasing this product.

Please read these instructions carefully before using this product,
and save this manual for future use.

Included Installation Instructions (→ 3, 28, 29)

The installation work should be done by a qualified installation specialist.

Before commencing work, carefully read these installation instructions and the operating instructions to ensure that installation is performed correctly.

(Please keep these instructions. You may need them when maintaining or moving this system.)

Model number suffix "EB" denotes UK model.

EB GN

VQT4U56

Table of contents

Safety precautions.....	3
Caution for AC Mains Lead.....	3
Supplied items	4
Unit and media care.....	4
Playable media.....	5
Control reference guide	6
Connections	8
Inserting media	9
Network settings.....	10
Using AirPlay with this system's speakers	14
Playing back music files on the DLNA server	15
Bluetooth® operations	16
About Bluetooth®.....	17
Media playback operations.....	17
Listening to DAB/DAB+.....	19
Listening to FM radio	21
Sound adjustment	22
Clock and Timer	22
Others	23
Troubleshooting.....	25
Attaching the speaker unit to a wall (optional)....	28
Specifications	30
Limited Warranty (ONLY FOR AUSTRALIA)	31

About descriptions in these operating instructions

- Pages to be referred to are indicated as “→ ○○”
- Unless otherwise indicated, operations are described using the remote control.

Made for



“Made for iPod”, “Made for iPhone”, and “Made for iPad” mean that an electronic accessory has been designed to connect specifically to iPod, iPhone, or iPad, respectively, and has been certified by the developer to meet Apple performance standards. Apple is not responsible for the operation of this device or its compliance with safety and regulatory standards.

Please note that the use of this accessory with iPod, iPhone, or iPad may affect wireless performance.

AirPlay, the AirPlay logo, iPad, iPhone, iPod, iPod classic, iPod nano, and iPod touch are trademarks of Apple Inc., registered in the U.S. and other countries.

Android™, Google Play™, Google Chrome™ browser are trademarks or registered trademarks of Google Inc.



The Wi-Fi CERTIFIED Logo is a certification mark of the Wi-Fi Alliance.

The Wi-Fi Protected Setup Mark is a mark of the Wi-Fi Alliance. “Wi-Fi”, “Wi-Fi Protected Setup”, “WPA” and “WPA2” are marks or registered marks of the Wi-Fi Alliance.

MPEG Layer-3 audio coding technology licensed from Fraunhofer IIS and Thomson.

The Bluetooth® word mark and logos are owned by the Bluetooth SIG, Inc. and any use of such marks by Panasonic Corporation is under license. Other trademarks and trade names are those of their respective owners.

Windows is a trademark or a registered trademark of Microsoft Corporation in the United States and other countries.

For the United Kingdom and Ireland

CE 1731

Declaration of Conformity (DoC)

Hereby, “Panasonic Corporation” declares that this product is in compliance with the essential requirements and other relevant provisions of Directive 1999/5/EC.

Customers can download a copy of the original DoC to our R&TTE products from our DoC server:

<http://www.doc.panasonic.de>

Contact to Authorised Representative: Panasonic Marketing Europe GmbH,
Panasonic Testing Centre, Winsbergring 15, 22525 Hamburg, Germany

This product is intended for general consumer. (Category 3)
This product on purpose to connect to access point of 2.4 GHz WLAN.

Gaeilge

Dearbhú Comhréachtá (DoC)

Leis seo, dearbhatáinn “Panasonic Corporation” go bhfuil an táirge seo i gcomhréir le riachtanais riachtanacha agus forálacha ábhartha eile den Treoir 1999/5/EC.

Féadfaidh custaiméirí coip dár nDearbhú Comhréachtá (DoC) bunaidh dár dtáirgí R&TTE ónár bhfreastalaí um Dhearbhú Comhréachtá (DoC):

<http://www.doc.panasonic.de>

Mionsonraí Teagmhála Ionadaí Údaraithe: Panasonic Marketing Europe GmbH,
Panasonic Testing Centre, Winsbergring 15, 22525 Hamburg, An Ghearmáin

Tá an táirge seo ceaptha don ghnáth-thomhaltóir. (Catagóir 3)
Tá an táirge seo ceaptha chun nascadh le pointe rochtana de 2,4 GHz WLAN.

Safety precautions

WARNING

Unit

- To reduce the risk of fire, electric shock or product damage,
 - Do not expose this unit to rain, moisture, dripping or splashing.
 - Do not place objects filled with liquids, such as vases, on this unit.
 - Use only the recommended accessories.
 - Do not remove covers.
 - Do not repair this unit by yourself. Refer servicing to qualified service personnel.
 - Do not let metal objects fall inside this unit.
 - Do not place heavy items on this unit.

AC mains lead

- To reduce the risk of fire, electric shock or product damage,
 - Ensure that the power supply voltage corresponds to the voltage printed on this unit.
 - Insert the mains plug fully into the socket outlet.
 - Do not pull, bend, or place heavy items on the lead.
 - Do not handle the plug with wet hands.
 - Hold onto the mains plug body when disconnecting the plug.
 - Do not use a damaged mains plug or socket outlet.
- The mains plug is the disconnecting device. Install this unit so that the mains plug can be unplugged from the socket outlet immediately.

Button-type battery (Lithium battery)

- Risk of fire, explosion and burns. Do not recharge, disassemble, heat above 60 °C or incinerate.
- Keep the Button-Type battery out of the reach of children. Never put Button-Type battery in mouth. If swallowed call your doctor.

CAUTION

Unit

- This unit utilizes a laser. Use of controls or adjustments or performance of procedures other than those specified herein may result in hazardous radiation exposure.
- Do not place sources of naked flames, such as lighted candles, on this unit.
- This unit may receive radio interference caused by mobile telephones during use. If such interference occurs, please increase separation between this unit and the mobile telephone.
- This unit is intended for use in moderate climates.

Placement

- Place this unit on an even surface.
- To reduce the risk of fire, electric shock or product damage,
 - Do not install or place this unit in a bookcase, built-in cabinet or in another confined space. Ensure this unit is well ventilated.
 - Do not obstruct this unit's ventilation openings with newspapers, tablecloths, curtains, and similar items.
 - Do not expose this unit to direct sunlight, high temperatures, high humidity, and excessive vibration.

Button-type battery (Lithium battery)

- Danger of explosion if battery is incorrectly replaced. Replace only with the type recommended by the manufacturer.
- Insert with poles aligned.
- Mishandling of batteries can cause electrolyte leakage and may cause a fire.
 - Remove the battery if you do not intend to use the remote control for a long period of time. Store in a cool, dark place.
 - Do not heat or expose to flame.
 - Do not leave the battery(ies) in a car exposed to direct sunlight for a long period of time with doors and windows closed.
- When disposing of the batteries, please contact your local authorities or dealer and ask for the correct method of disposal.

Product Identification Marking is located on the bottoms of the CD unit and the speaker unit.

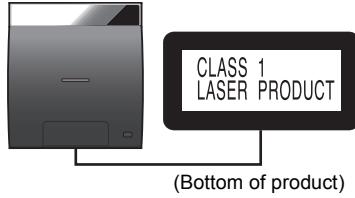

Caution for AC Mains Lead



(For the AC mains plug of three pins)

For your safety, please read the following text carefully.

This appliance is supplied with a moulded three pin mains plug for your safety and convenience.

A 5-ampere fuse is fitted in this plug.

Should the fuse need to be replaced please ensure that the replacement fuse has a rating of 5-ampere and that it is approved by ASTA or BSI to BS1362.

Check for the ASTA mark  or the BSI mark  on the body of the fuse.

If the plug contains a removable fuse cover you must ensure that it is refitted when the fuse is replaced. If you lose the fuse cover the plug must not be used until a replacement cover is obtained. A replacement fuse cover can be purchased from your local dealer.

Before use

Remove the connector cover.

How to replace the fuse

The location of the fuse differ according to the type of AC mains plug (figures A and B). Confirm the AC mains plug fitted and follow the instructions below. Illustrations may differ from actual AC mains plug.

1. Open the fuse cover with a screwdriver.

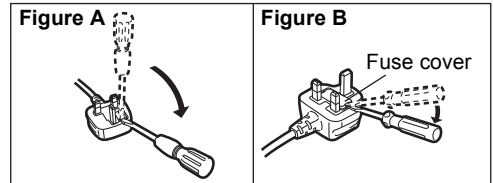

2. Replace the fuse and close or attach the fuse cover.

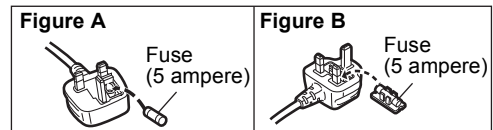

Supplied items

This system (SC-NE5DB)

- 1 CD unit (SL-NE5DB)
- 1 Speaker unit (SB-NE5DB)

Accessories

Check the supplied accessories before using this system.

- 1 Remote control (with a battery)
(N2QAYC000090)
- For the United Kingdom and Ireland**
2 AC mains lead (K2CT2YY00097)
- For Australia and New Zealand**
2 AC mains lead (K2CJ2YY00093)
- 1 DAB antenna (RFA3425)



Wall mounting accessories

- 1 Safety holder (RGQ0660-K)
- 2 Wall mount brackets (RMQX1082-S)

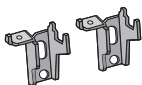
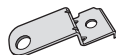

- 1 Screw (XTB3+8JFJK-J)



- Do not use AC mains lead with other equipment.
- Product numbers provided in these operating instructions are correct as of January 2013. These may be subject to change.

For the United Kingdom and Ireland customers

Sales and Support Information

Customer Communications Centre

- For customers within the UK: 0844 844 3899
- For customers within Ireland: 01 289 8333
- Monday–Friday 9:00 am – 5:00 pm
(Excluding public holidays).
- For further support on your product, please visit our website: www.panasonic.co.uk

Direct Sales at Panasonic UK

- Order accessory and consumable items for your product with ease and confidence by phoning our Customer Communications Centre Monday–Friday 9:00 am – 5:00 pm (Excluding public holidays).
- Or go on line through our Internet Accessory ordering application at www.pas-europe.com.
- Most major credit and debit cards accepted.
- All enquiries transactions and distribution facilities are provided directly by Panasonic UK.
- It couldn't be simpler!
- Also available through our Internet is direct shopping for a wide range of finished products. Take a browse on our website for further details.

Unit and media care

Pull out the AC mains lead from the outlet before maintenance.

■ Clean this system with a soft, dry cloth

- When dirt is heavy, wring a cloth moistened in water tightly to wipe the dirt, and then wipe it with a dry cloth.
- Never use alcohol, paint thinner or benzene to clean this system.
- Before using chemically treated cloth, carefully read the instructions that came with the cloth.

■ Maintenance of the lens

- Clean the lens regularly to prevent malfunctions. Use a blower to remove dust and a cotton swab if it is extremely dirty.
- You cannot use a CD type lens cleaner.
- Do not leave the door open for prolonged periods of time. This will cause the lens to get dirty.
- Be careful not to touch the lens with your fingers.

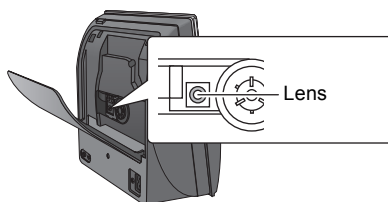

■ Clean discs

DO



DO NOT



Wipe with a damp cloth and then wipe dry.

■ Disc handling precautions

- Handle discs by the edges to avoid inadvertent scratches or fingerprints on the disc.
- Do not attach labels or stickers to discs.
- Do not use record cleaning sprays, benzene, thinner, static electricity prevention liquids or any other solvent.
- Do not use the following discs:
 - Discs with exposed adhesive from removed stickers or labels (rented discs etc.).
 - Discs that are badly warped or cracked.
 - Irregularly shaped discs, such as heart shapes.

■ To dispose or transfer this system

This system may keep the user settings information internally. If you discard this system either by disposal or transfer, then follow the procedure to return all the settings to the factory presets to delete the user settings. (→ 25, "To return all settings to the factory preset")

- The operation history may be recorded in the memory of this system.

Playable media

Compatible iPod/iPhone/iPad

Compatible with “IPOD_DOCK” connection
(Using Lightning connector)

iPod touch (5th generation)

iPod nano (7th generation)

iPhone 5

Compatible with “IPOD_PORT” connection
(Using dedicated USB cable (not supplied))

iPod touch

1st, 2nd, 3rd, 4th, and 5th generation

iPod nano

2nd, 3rd, 4th, 5th, 6th, and 7th generation

**iPhone 5 / iPhone 4S / iPhone 4 /
iPhone 3GS / iPhone 3G / iPhone**

iPad (3rd, and 4th generation) / **iPad 2** / **iPad**

iPad mini

(as of January 2013)



- Compatibility depends on the software version. Update your iPod/iPhone/iPad to the latest software before using it with this system.
- Please be aware that Panasonic accepts no responsibility for the loss of data and/or information.

Compatible CD

- A disc with the CD Logo.



- This system can play back discs that conform to the CD-DA format.
- This system may not be able to play some discs due to the condition of the recording.

Compatible AirPlay devices

iOS 4.3.3 or later

iPod touch

3rd, 4th, and 5th generation

iPhone 5 / iPhone 4S / iPhone 4 / iPhone 3GS

iPad (3rd, and 4th generation) / **iPad 2** / **iPad**

iPad mini

iTunes 10.2.2 or later (Mac / PC)

(as of January 2013)

Compatible USB devices

- This system does not guarantee connection with all USB devices.
- FAT12, FAT16 and FAT32 file systems are supported.
- This system supports USB 2.0 full speed.
- This system can support USB devices of up to 32 GB.

Compatible MP3 files

- Supported format: Files with the extension “.mp3” or “.MP3”.
- Compatible compression rate: Between 64 kbps and 320 kbps (stereo).
- Depending on how you create the MP3 files, they may not play in the order you numbered them or may not play at all.

Creating MP3 files on a CD-R/RW

- Maximum number of tracks and albums: 999 tracks and 254 albums (Excluding Root folder).
- Disc formats: ISO9660 level 1 and level 2 (except for extended formats).
- If the disc includes both MP3 and normal audio data (CD-DA), this system plays the type recorded in the inner part of the disc.
- This system cannot play files recorded using packet write.

Creating MP3 files on a USB device

- Maximum number of tracks and albums: 2500 tracks and 254 albums (Excluding Root folder).
- Only one memory card will be selected when connecting a multiport USB card reader, typically the first memory card inserted.

Control reference guide

This system consists of the CD unit and the speaker unit. The both units are wirelessly connected when turned on.

■ CD unit

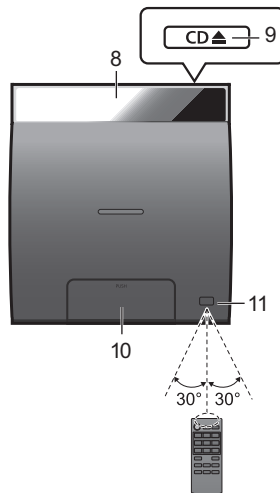
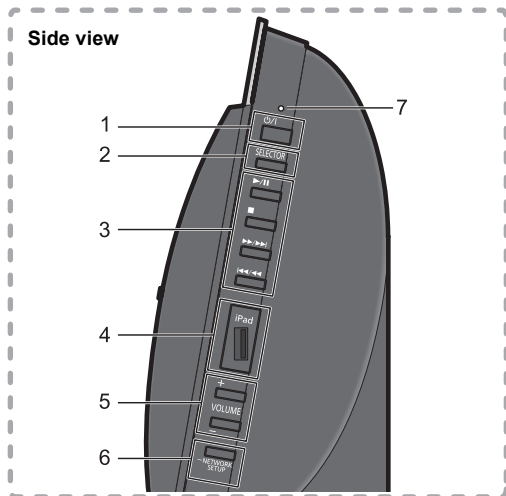

■ Speaker unit

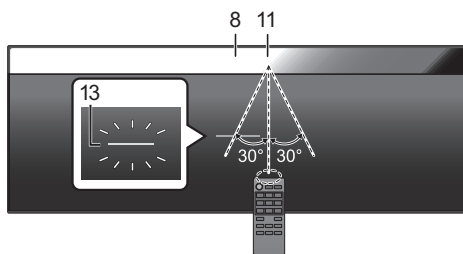
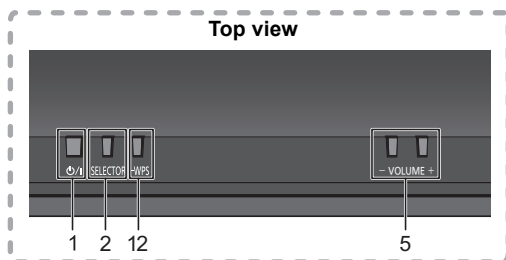

1 Standby/on switch (⏻/⏻)

Press to switch the unit from on to standby mode or vice versa.

In standby mode, the unit is still consuming a small amount of power.

- The CD unit and the speaker unit operate simultaneously. Press either standby/on switch to turn both units on or to standby mode.

Refer to page 25 when the units do not turn on simultaneously.

2 Select the audio source

"CD" → "DAB/DAB+" → "FM" → "BLUETOOTH"
 ↑ "IPOD_PORT" / "USB" ← "IPOD_DOCK" ← "AUX" ←

3 Basic playback control buttons

4 iPod port for iPod/iPhone/iPad and USB devices (→ 5, 9)

5 Adjust the volume (0 (min) to 50 (max))

6 Network setup button (→ 11)

7 Standby/on indicator

While this system is turned on:

The indicator lights in green when the CD unit and the speaker unit are connected successfully, blinks in green when they are connecting, and lights in red when they fail to connect.

8 Display

9 Open the CD lid

10 Dock for iPod/iPhone with Lightning connector (→ 9)

11 Remote control signal sensor

Distance:

Within approx. 7 m directly in front.

- To avoid interference, please do not put any objects in front of signal sensor.

12 WPS pairing button (→ 10)

13 Wi-Fi® status indicator



- The CD unit's display turns off if the CD unit is left unused for more than 3 minutes and the audio selector is set to an option other than "CD", "IPOD_DOCK", or "IPOD_PORT". To turn the display on, press any button on the CD unit, or select "CD", "IPOD_DOCK", or "IPOD_PORT" as an audio source.
- Placing the CD unit and the speaker unit:
 - Keep a minimum distance of 1 cm between the CD unit and the speaker unit when placing them.
 - The distance between the CD unit and the speaker unit should be a maximum of 10 m. The range can decrease depending on the environment, obstacles or interference.
 - This system may not function properly and troubles such as noise and sound jumps may arise due to radio wave interference if this system is located too close to the devices that use the 2.4 GHz band.
 - This system may not function properly if radio waves from a nearby broadcasting station, etc. is too strong.
 - Do not use this system near equipment or in an environment that is sensitive to radio frequency interference (example: airports, hospitals, laboratories, etc).

■ Remote control

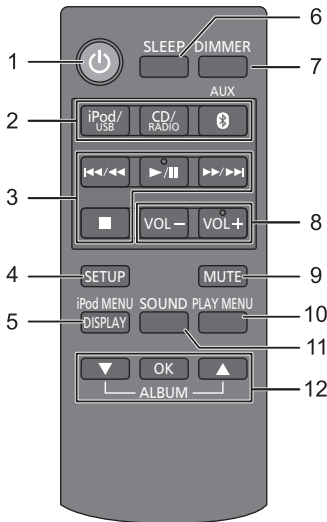

- 1 Turn this system on or off
- 2 Select the audio source
 [iPod/USB] : "IPOD_DOCK" ↔ "IPOD_PORT" / "USB"
 [CD/RADIO] : "CD" → "DAB/DAB+" → "FM"
 [Bluetooth, AUX] : "BLUETOOTH" ↔ "AUX"
- 3 Basic playback control buttons
- 4 Enter setup menu
- 5 Enter the iPod/iPhone menu /
Change displayed information
- 6 Set the sleep timer
- 7 Change the brightness of the display panel
 • Press to dim the display panel.
Press again to cancel.
- 8 Adjust the volume (0 (min) to 50 (max))
- 9 Mute the sound
Mutes the sound. Press again to cancel. "MUTE" is also cancelled when the volume is adjusted or this system is turned off.
- 10 Enter playback menu
- 11 Enter sound menu
- 12 Selection/OK

■ Before using for the first time

Remove the insulation sheet **A**.

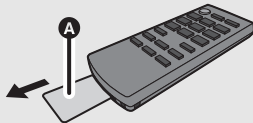

■ To replace a button-type battery

Battery type: CR2025 (Lithium battery)

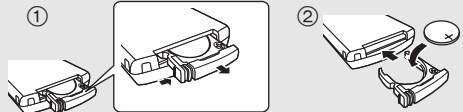

- Set the button-type battery with its (+) mark facing upward.
- Keep the button-type battery out of reach of children to prevent swallowing.

Connections

Basic connection

- 1 Connect the DAB indoor antenna (supplied) to the speaker unit.

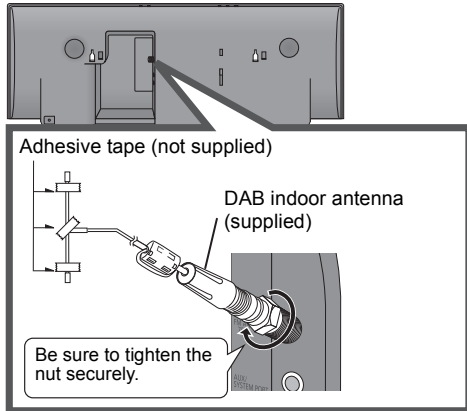

- 2 Connect the AC mains lead after all other connections are completed.

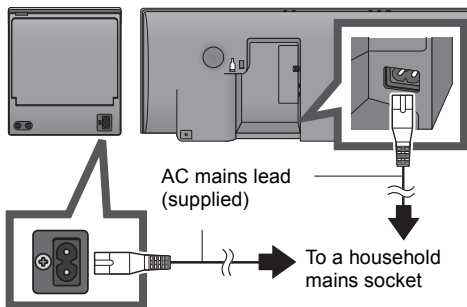

- After connecting the AC mains lead to the mains socket, wait for more than 15 seconds to turn on the Standby/on switch.
- When this system is turned on, the CD unit and the speaker unit are connected wirelessly.
- When this system is turned on for the first time after purchase, a message prompting you to connect a Bluetooth® device ("PAIRING") is displayed. (→ 16)
- This system consumes a small amount of AC power (→ 30) even when turned off.
- In the interest of power conservation, if you will not be using this system for an extended period of time, unplug it from the household mains socket.

For the United Kingdom and Ireland

READ THE CAUTION FOR THE AC MAINS LEAD ON PAGE 3 BEFORE CONNECTION.



- These speakers do not have magnetic shielding. Do not place them near a television, personal computer or other devices easily influenced by magnetism.
- Tape the antenna to a wall or column in a position with the least amount of interference. (Use a DAB outdoor antenna if radio reception is poor.)

Connect an external music device (for AUX mode)

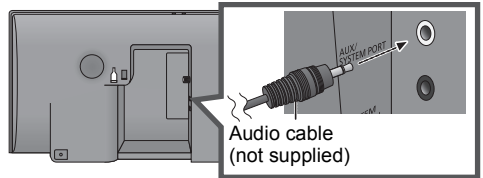

- ① Plug the audio cable (not supplied) into the AUX jack.
Plug type: Ø3.5 mm stereo
- ② Press [⏮], [AUX] to select "AUX" and start playback on the connected device.

To select the sound input level of the external device

- ① While in AUX mode, press [PLAY MENU] to select "INPUT LEVEL" and then press [OK].
- ② Press [▲], [▼] to select "NORMAL" or "HIGH".
 - The default setting is "NORMAL".



- Switch the equalizer off or turn the volume of the external device down to reduce the input signal. High level of input signal will distort the sound.
- For details, refer to the instruction manual of the other equipment.
- The cables and the devices are not supplied.

Connect the CD unit and the speaker unit with cables (optional)

If the CD unit and the speaker unit are not wirelessly connected, or the output sound is interrupted, connect the both units with two audio cables (plug type: Ø3.5 mm stereo, not supplied) as illustrated below.

- We recommend you use cables of less than 5 m.

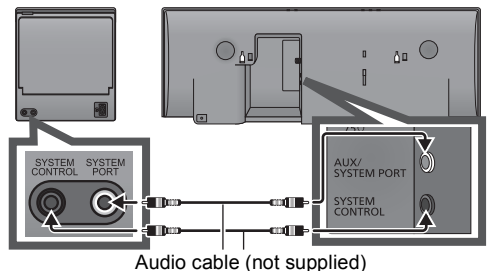

- If the cables are connected, the displays show "WIRED MODE" and this system starts wired communication. This system automatically connects wirelessly when the cables are disconnected.

Inserting media

Inserting a disc

Select "CD" as the source.

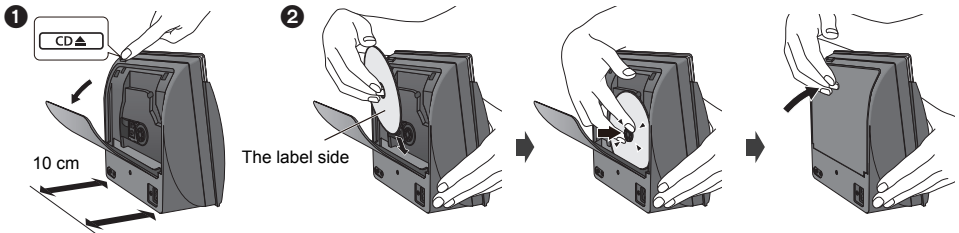

1 Press [CD ▲] to open the lid on the back of the CD unit.

- Leave a space more than 10 cm behind the unit.
- Do not place any objects behind the unit.

2 While holding the unit, push the centre of the CD until it clicks into place, and then close the CD lid.

- Be careful not to scratch the CD.
- Make sure you place the centre of the CD onto the CD spindle.

Note: Remove the CD only after it stops rotating.

Connect an iPod/iPhone/iPad^{1,2} or USB device



PUSH

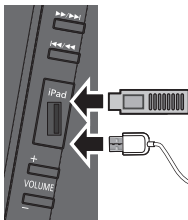

Select "IPOD_PORT" as the source.

- When connecting an iPod/iPhone/iPad, use the dedicated USB cable (not supplied).
- "USB" is displayed when a compatible USB device is inserted.
- Insert the USB device directly. Do not use any USB extension cable.
- Before removing the USB device, select a source other than "USB".

Connect an iPod/iPhone with Lightning connector^{*1}

Select "IPOD_DOCK" as the source.

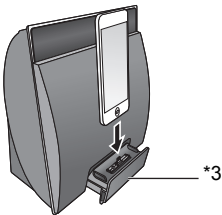

- Make sure that the unit does not fall when inserting or removing media.
- When moving this unit, be sure to remove all media and turn this unit to standby mode.

*1: Refer to "Playable media" for compatible models. (→ 5)

*2: When using the "IPOD_PORT" connection, do not connect the following models to this unit:

- iPod classic, iPod [4th (colour display), and 5th (video) generation], iPod nano (1st generation)

Unexpected behaviour may occur.

■ Charging an iPod/iPhone/iPad^{*4}

Charging starts when an iPod^{*2}/iPhone/iPad is connected to this unit.

- During standby mode, charging will not start from the USB cable connection, however it will start as usual from the Lightning connector.
 - To charge from the USB cable connection, start the charging before turning this unit to standby mode.
- Check the iPod/iPhone/iPad to see if the battery is fully charged. (Once fully recharged, additional recharging will not occur.)
- If this unit is switched to standby mode "IPOD CHARGING" is shown on the unit's display.

*3: When using the "IPOD_DOCK" connection:

- Be sure to remove the iPod/iPhone from its case.
- Make sure that the iPod/iPhone is fully inserted and its back is resting against the cushion pad.
- Make sure to hold the dock when removing the iPod/iPhone.

*4: Use the "IPOD_PORT" connection to charge the iPad.

Network settings

You can wirelessly stream music from an iOS device (iPhone, iPod, iPad), an Android device or a Mac/PC to this system's speakers by using the AirPlay or DLNA feature.

To use these features, this system must join the same 2.4 GHz wireless network as the AirPlay compatible device (→ 5) or the DLNA compatible device.

- It is also possible to use AirPlay without a wireless network router. (→ 14, "Directly streaming to this system (AirPlay)")

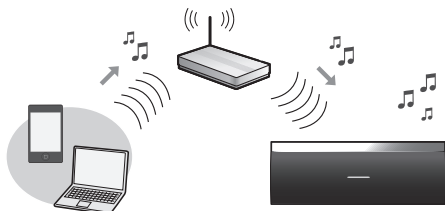

Preparation

- Place this system close to the wireless network router.

- 1 Turn this system on.
- 2 Follow the chart below to choose the network setting method.

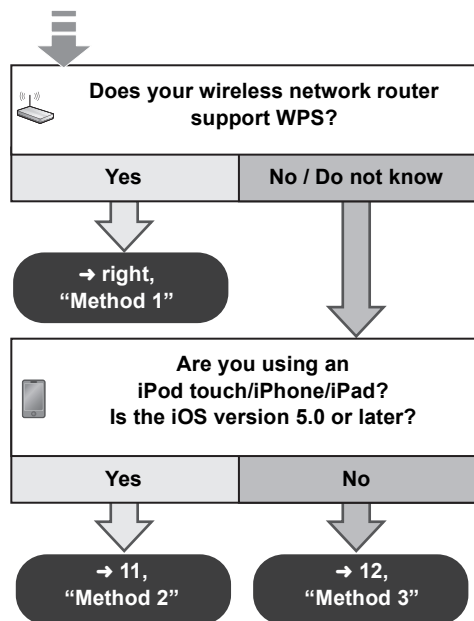

- If you want to perform wireless setting with your Mac/PC, or you want to apply the advanced setting, try "Method 4" on page 12.



- To cancel this setting in the middle, press [⏻] to turn off this system.
- Simultaneous use with other 2.4 GHz devices, such as microwaves, cordless telephones, etc., may result in connection interruptions.
- For up to date compatibility information on your wireless network router refer to <http://panasonic.jp/support/global/cs/> (This site is in English only.)

Method 1

If your wireless network router supports WPS (Wi-Fi Protected Setup™).

■ Using the WPS Push Button Configuration (PBC)

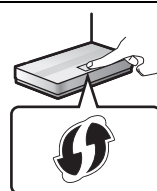

The WPS identifier mark

WPS Push Button Configuration (PBC) compatible wireless network router may have this mark.

- 1 Press and hold [– WPS] on the speaker unit.
↳ "WPS" flashes on the display.
(The Wi-Fi status indicator blinks blue.)
 - Complete step 2 within 2 mins.
- 2 After "WPS" is indicated, press the WPS button on the wireless network router.
- 3 The settings are completed when "SUCCESS" is displayed and the Wi-Fi status indicator **stops blinking and lights in blue**.

"FAIL" may be displayed if the connection was not made within the set time limit. Try the setting again. If "FAIL" is still displayed, try other methods on page 11 or 12.
- 4 Press [OK] on the remote control to exit the setting.



- To use the WPS PIN code, refer to the notes on page 13.

Method 2

If you're using an iPod touch/iPhone/iPad.
(iOS version 5.0 or later.)

With this method you will share the wireless network settings of your iPod touch/iPhone/iPad with this system.

- The following explanations are based on an iPhone.

- 1 Disconnect any devices connected to the CD unit.
- 2 Connect the **iPhone** to your **home wireless network**.
- 3 Connect the **iPhone** to the **CD unit**.
Choose one of the following connections.

"IPOD_DOCK" connection compatible iPod touch/iPhone:

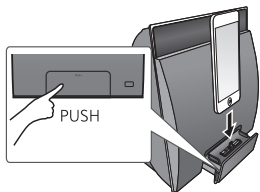

iPod touch/iPhone/iPad with iOS 5.0 or later:

Connect to the iPod port on the side of the CD unit with a dedicated USB cable.

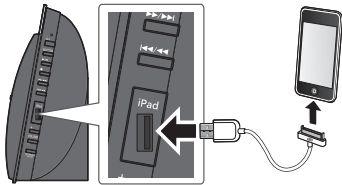

- 4 Unlock your iPhone and then press and hold **[–NETWORK SETUP]** on the CD unit for more than 3 seconds.
 - If "NOT SUPPORTED" or "SET WI-FI" is displayed, check that the iPhone is connected to the wireless network and try again from step 1.
- 5 A message will pop-up on your iPhone. Allow the iPhone to share the wireless network settings.*1
 - ↳ The Wi-Fi status indicator blinks.

- 6 The settings are completed when "**SUCCESS**" is displayed and the Wi-Fi status indicator **stops blinking and lights in blue**.

If "FAIL" is displayed press [OK] and try the setting again. If "FAIL" is still displayed, try other methods on page 10 or 12.

- If the iPhone was disconnected midway through, try again without disconnecting it.

- 7 Press [OK] on the remote control to exit the settings.

*1: Depending on the network environment or the wireless network router settings, it may take more than 10 mins. to complete the settings.

Method 3

Setting the network connection with the smartphone app.

You can make the wireless network settings with the app, "Panasonic Stereo System Network Setup" (for free).

If you're using an Android device, download the app at the Google Play Store. If you're using an iPod touch/iPhone/iPad, download it at the App Store.

Preparation

- Connect your smartphone to your home wireless network.
- Check the password for your home wireless network.

1 Press **[SETUP]** on the remote control repeatedly to select **"NET SETUP"** and then press **[OK]**.
↳ "SETTING" is indicated on the display.
(The Wi-Fi status indicator blinks purple.)

2 Start **"Panasonic Stereo System Network Setup"** on your smartphone and follow the indications.

■ Note for the iOS version

After step 2

- 1 Enter the password for the home wireless network to which the iOS device is connected.
- 2 When a message instructing you to connect the iOS device to this system is displayed, press the home button to close the app.
- 3 On the Wi-Fi network selection screen in "Settings", select "00 Setup _____".
 - " _ " stands for a digit that is unique to each set.



- 4 When a message indicating the completion of the connection to this system is displayed, restart the app.

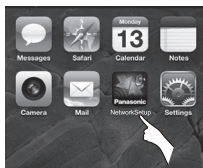

- 5 When a message indicating the completion of the Wi-Fi setup of this system is displayed, close the app, and then check the operation of AirPlay, etc.



- "Panasonic Stereo System Network Setup" for Mac OS is also available at the App Store.

Method 4

Setting the network connection from an Internet browser.

With this method, you will access this system's wireless network settings from the Internet browser of your compatible device.

- The following explanations are based on an iPhone.

1 Press **[SETUP]** on the remote control repeatedly to select **"NET SETUP"** and then press **[OK]**.

↳ "SETTING" is indicated on the display.
(The Wi-Fi status indicator blinks purple.)

2 After "SETTING" is indicated, connect your compatible device to this system's wireless network named **"00 Setup _____"**.

- " _ " stands for a digit that is unique to each set.
- Make sure that DHCP is enabled for the network setting on your compatible device.



3 Start the Internet browser on your compatible device and type **"http://192.168.1.12"** into the URL address field and display the page.

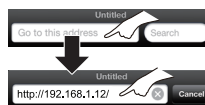

↳ This system's setup window is displayed.

- **Examples of Internet browsers**
iOS device/Mac : Safari
Android device : Google Chrome browser
PC : Windows Internet Explorer

4 Select **"Search wireless network"**.

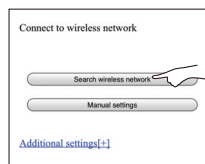

5 Select and input the details.

- Check your **home wireless network name** (Network name (SSID)) and **password** for this network. This can often be found on the wireless network router itself.

Search wireless network

Network name (SSID)
Select

Password

[Advanced network settings\(+\)](#)

- 1 Select your **home wireless network name**.^{*1}
- 2 Type the **password**.

6 Select "JOIN" to apply the settings.

- In the pop-up screen, select "OK" to continue.
 - Select "Cancel" to return to the setup window.

7 The settings are completed when "SUCCESS" is displayed and the Wi-Fi status indicator **stops blinking and lights in blue**.

If "FAIL" is displayed press [OK], check the wireless network password and other settings and start again from step 1.

8 Make sure to connect your compatible device back to your **home wireless network**.

^{*1}: If you have set your wireless network to be invisible, select "BACK" and refer to "Alternative settings".

Advanced network settings

- The below settings are the alternative or additional settings for "Method 4". (→ 12)

Alternative settings

Instead of steps 4 and 5

Select "**Manual settings**".

- 1 Type your **home wireless network name** into the "Network name (SSID)" field.
- 2 Select the **encryption method** from the "Security system" drop down list.
- 3 Type the **password** into the "Password" field and then select "JOIN".

Additional settings

If your home wireless network has been configured to use specific IP Addresses, Subnet Mask, Default Gateway, Primary DNS, etc.

Before step 6

Select "**Advanced network settings**".

↳ Input the required addresses into each field and select "JOIN".

- To change the settings back to DHCP, select "ON" from the "DHCP" drop down list.

If you want to change the name of this system that is displayed as the AirPlay speakers or DLNA renderer.

Before step 4

Select "**Additional settings**".

- 1 Select "**Edit STEREO SYSTEM name**".
- 2 Type a new name into the "STEREO SYSTEM name" field.
 - ↳ Only ASCII characters can be used.
- 3 Select "**OK**".
- 4 If this system is already connected to your home wireless network:
 - Select "**Additional settings**", and then select "**Exit**".

If this system is not connected to your home wireless network:

- Continue to **step 4** of "Method 4".



- Enable Java and Cookies in your browser settings.
- This system can also be set using the WPS PIN code. Replace step 2 of "Method 1" with the following steps. (Before starting, refer to the wireless network router's operating instructions for details on how to enter the PIN code.)

- 1 While "WPS" is flashing press and hold [– WPS] again to display the 8 digit PIN code.
 - ↳ Wi-Fi status indicator blinks purple.
- 2 Enter the PIN code into the wireless network router.

Using AirPlay with this system's speakers

Preparation

- Complete the network settings. (→ 10)
- Connect the iOS device or Mac/PC to the same **home wireless network** as this system.

- 1 Turn this system on.
 - Check that the Wi-Fi status indicator **lights in blue**.
 - If it doesn't light in blue, check the wireless network settings. (→ 10)
- 2 iOS device: Start the **"Music"** (or iPod) app.
Mac/PC: Start **"iTunes"**.
 - If the Music app on your iOS device is used, select the audio file you want to play.
- 3 Select **"Panasonic NE5 _____"*1,2** from the AirPlay  icon.
 - ↳ Check the volume settings before starting the playback. (When AirPlay is used for the first time, the volume may be output at the maximum setting.)

e.g., iPhone iOS 6.0.1

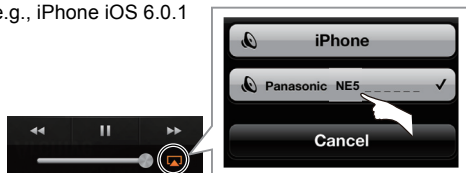

e.g., iTunes 11.0

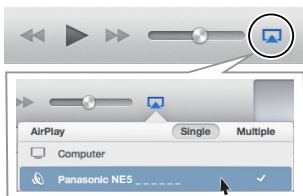

- 4 Start play.
 - The playback will start with a slight delay.



- This system can be set to turn on automatically when this system is selected as the output speakers. (→ 24)
- Playback of other audio sources will stop and AirPlay output will have priority.
- Volume changes on the iOS device or iTunes will be applied to this system. (Refer to the iTunes Help for the required settings in iTunes.)
- With some iOS and iTunes versions, it may not be possible to restart the AirPlay playback if the selector is changed (e.g., "CD") or this system is turned off, during the AirPlay playback. In this case, select a different device from the AirPlay icon of the Music App or iTunes and then re-select this system as the output speakers.
- AirPlay will not work when playing back videos on iTunes.

*1: " _ " stands for a digit that is unique to each set.

*2: The name that is displayed for this system can be changed from the "Edit STEREO SYSTEM name" settings. (→ 13, "Advanced network settings")

Directly streaming to this system (AirPlay)

With this function set to "ON", you can stream music from the iOS device or Mac / PC (iTunes 10.2.2 or later) to this system without the need of a wireless network router.

- Previous network settings will be deleted when this function is set to "ON".
- The following explanations are based on an iPhone.

- 1 Press [SETUP] repeatedly to select "D.CONNECT".
- 2 Press [▲, ▼] to select "ON" and then press [OK].
- 3 Press [▲, ▼] to select "OK? YES" and then press [OK].

"PW _____"*1 is displayed.

The 5 digits after "PW" is the password for this network.

- 4 Connect your iPhone to this system's wireless network named "NE5 _____"*2.



- 5 Enter the password that is indicated on this system's display.
- 6 Once the iPhone is connected to this system's wireless network, the setup is completed.

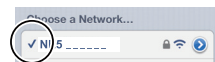

- 7 Continue to step 2 of "Using AirPlay with this system's speakers".



- This setting is reset to "OFF" when other network settings are performed. (→ 10)
- When "D.CONNECT" is set to "ON", this system will not be connected to the Internet. It is not possible to update the software or check the Wi-Fi signal strength.
- When AirPlay is not being used, disconnect the AirPlay compatible device from this network.
- When using a computer on this network, make sure that all the shared files are encrypted.
- This feature is only compatible with the "Open System" authentication method. It is not compatible with "Shared Key" authentication method.

*1: " _ " stands for a digit.

*2: " _ " stands for a digit that is unique to each set.

Display the password

The first time "D.CONNECT" is set to "ON", a password for this system's wireless network is randomly created and memorised in this system.

- This password is memorised until it is changed.
- 1 While "D.CONNECT" is set to "ON":
Press [SETUP] repeatedly to select "D.CONNECT".
 - 2 Press [▲, ▼] to select "ON" and then press [OK].
 - 3 The current password is displayed.
 - The 5 digits after "PW" is the password for this network.
 - 4 Press any button to exit.

Change the password

- 1 While "D.CONNECT" is set to "OFF":
Press [SETUP] repeatedly to select "D.CONNECT".
- 2 Press [▲, ▼] to select "CHANGE PW" and then press [OK].
- 3 Press [▲, ▼] to select "OK? YES" and then press [OK].
- 4 The new password is displayed.
 - The 5 digits after "PW" is the new password for this network.
- 5 Press any button to exit.

■ Note about changing the password

After changing this system's wireless network password, if you are not prompted to change the password on the other devices, the following changes are required.

iOS device (iPod touch/iPhone/iPad)*1:

- Before choosing this system's network,
 - 1 Select  located beside this system's wireless network name.
 - 2 Select "Forget this Network" and then select "Forget".
 - 3 Select this system's wireless network and enter the new password.

Mac/PC:

- If the computer has memorised the old password, be sure to change the memorised password for this system's wireless network to the new one.



- Refer to the devices's operating instructions for details.

*1: Steps are based on iOS 6.0.1.

Playing back music files on the DLNA server

You can share music files stored in the DLNA Certified media server (PC with Windows 7 installed, smartphone, etc.) connected to your home wireless network, and enjoy the contents with this system's speaker.

Preparation

- Complete the network settings. (→ 10)
- Connect your device with DMC (Digital Media Controller) compatible software installed to the same **home wireless network** as this system.
- Add the contents and folder to the libraries of the Windows Media® Player or the smartphone, etc.
 - Playlist of Windows Media® Player can play back only the contents that are stored in the libraries.

- 1 Turn this system on.
 - Check that the Wi-Fi status indicator **lights in blue**.
 - If it doesn't light in blue, check the wireless network settings. (→ 10)
- 2 Operate the DMC compatible device and connect to this system.
 - The device name of this system will be displayed as "Panasonic NE5_ _ _ _ _"*1, 2.
 - For details on how to use DMC compatible devices, refer to the operating instructions of the devices or the software.

■ Support format of DLNA client

File formats that are not supported by your DLNA server cannot be played.

Audio codec	Example of file extension
MP3	.mp3
WAV	.wav



- Depending on the contents and the connected equipment, playback may not be possible.

*1: " _ " stands for a digit that is unique to each set.

*2: The name that is displayed for this system can be changed from the "Edit STEREO SYSTEM name" settings. (→ 13, "Advanced network settings")

Bluetooth® operations

By using the Bluetooth® connection, you can listen to the sound from the Bluetooth® audio device from this system wirelessly.

- Refer to the operating instructions of the Bluetooth® device for details.

Pairing Bluetooth® devices

Preparation

- Turn on the Bluetooth® feature of the device and place the device near the speaker unit.
- If this system is already connected to a Bluetooth® device, disconnect it.

- 1 Press [, AUX] to select "BLUETOOTH".
 - If "PAIRING" is indicated on the display, go to step 3.
- 2 Press [PLAY MENU] to select "NEW DEV." and then press [OK].
 - ↳ "PAIRING" is indicated on the display.
- 3 Select "SC-NE5" from the Bluetooth® device's Bluetooth® menu.
- 4 Start play on the Bluetooth® device.



- If prompted for the passkey, input "0000".
- You can register up to 8 devices with this system. If a 9th device is paired, the device that has not been used for the longest time will be replaced.

Connecting a paired Bluetooth® device

Preparation

- Turn on the Bluetooth® feature of the device and place the device near the speaker unit.
- If this system is already connected to a Bluetooth® device, disconnect it.

- 1 Press [, AUX] to select "BLUETOOTH".
 - ↳ "READY" is indicated on the display.
- 2 Select "SC-NE5" from the Bluetooth® device's Bluetooth® menu.
 - ↳ The name of the connected device is indicated on the display for 2 seconds.
- 3 Start play on the Bluetooth® device.





- This system can only be connected to one device at a time.
- When "BLUETOOTH" is selected as the source, this system will automatically try and connect to the last connected Bluetooth® device.
- The Bluetooth® device will be disconnected if a different audio source (e.g., [CD]) is selected.

Bluetooth® transmission mode

You can change the transmission speed to prioritize transmission quality or sound quality.

Preparation

- Press [, AUX] to select "BLUETOOTH".
- If a Bluetooth® device is already connected, disconnect it.

- 1 Press [PLAY MENU] repeatedly to select "LINK MODE".
- 2 Press [, ] to select the mode and then press [OK].
 - MODE 1:** Emphasis on connectivity
 - MODE 2:** Emphasis on sound quality





- The default setting is "MODE 1".

Bluetooth® input level

If the sound input level of the Bluetooth® transmission is too low, change the input level setting.

Preparation



- Connect a Bluetooth® device.

- 1 Press [PLAY MENU] repeatedly to select "INPUT LEVEL".
- 2 Press [, ] to select the level and then press [OK].
 - "LEVEL 0" ↔ "LEVEL +1" ↔ "LEVEL +2"



- Select "LEVEL 0" if the sound is distorted.
- The default setting is "LEVEL 0".

Disconnecting a Bluetooth® device

- 1 While a Bluetooth® device is connected:
Press [PLAY MENU] to select "DISCONNECT?".
- 2 Press [, ] to select "OK? YES" and then press [OK].

About Bluetooth®

Panasonic bears no responsibility for data and/or information that is compromised during a wireless transmission.

■ Frequency band used

- This system uses the 2.4 GHz frequency band.

■ Certification of this device

- This system conforms to frequency restrictions and has received certification based on frequency laws. Thus, a wireless permit is not necessary.
- The actions below are punishable by law in some countries:
 - Taking apart or modifying this system.
 - Removing specification indications.

■ Restrictions of use

- Wireless transmission and/or usage with all Bluetooth® equipped devices is not guaranteed.
- All devices must conform to standards set by Bluetooth SIG, Inc.
- Depending on the specifications and settings of a device, it can fail to connect or some operations can be different.
- This system supports Bluetooth® security features. But depending on the operating environment and/or settings, this security is possibly not sufficient. Transmit data wirelessly to this system with caution.
- This system cannot transmit data to a Bluetooth® device.

■ Range of use

- Use this device at a maximum range of 10 m. The range can decrease depending on the environment, obstacles or interference.

■ Interference from other devices

- This system may not function properly and troubles such as noise and sound jumps may arise due to radio wave interference if this system is located too close to other Bluetooth® devices or the devices that use the 2.4 GHz band.
- This system may not function properly if radio waves from a nearby broadcasting station, etc. is too strong.

■ Intended usage

- This system is for normal, general use only.
- Do not use this system near an equipment or in an environment that is sensitive to radio frequency interference (example: airports, hospitals, laboratories, etc).

Media playback operations

The following marks indicate the availability of the feature.

- CD** : CD audio in CD-DA format and a CD that contains MP3 files (→ 5)
- iPod** : Compatible iPod/iPhone/iPad (→ 5)
- USB** : USB devices containing MP3 files (→ 5)
- AirPlay** : When connected to an AirPlay compatible device. (→ 14)
- Bluetooth** : Connected Bluetooth® device (→ 16)

Preparation

- Turn this system on.
- Insert the media (→ 9) or connect the Bluetooth® (→ 16) / AirPlay (→ 14) compatible device.
- Press [CD/RADIO], [iPod/USB] or [⊗], [AUX] to select the audio source.



- When using iPod/iPhone/iPad, the operation may vary among those models.

Basic play

(**CD**, **iPod**, **USB**, **AirPlay**, **Bluetooth**)

Play	Press [▶/].
Stop	Press [■]. <ul style="list-style-type: none">• USB : The position is memorised and "RESUME" is displayed.
Pause	Press [▶/]. Press again to restart play.
Skip	Press [◀◀/◀◀] or [▶▶/▶▶] to skip track. CD , USB Press [▲] or [▼] to skip the MP3 album.
Search (Except AirPlay)	During play or pause Press and hold [◀◀/◀◀] or [▶▶/▶▶]. <ul style="list-style-type: none">• Point the remote control at the CD unit to operate.• iPod : Backwards search is only within the current track.

CD, **USB** To display information

Press [DISPLAY, iPod MENU] repeatedly.



- To use this system's remote control with a Bluetooth® device, the Bluetooth® device must support AVRCP (Audio Video Remote Control Profile). Depending on the device or the status of the device, some operations may not work.
- Maximum number of displayable characters: approx. 30
- This system supports ver. 1.0, 1.1 and 2.3 ID3 tags. Text data that is not supported will not be displayed or shown differently.
- Album and track indication for MP3 files.



"A _ _ _": MP3 album number.

"T _ _ _": MP3 track number.

- " _ " stands for the album or track number.

"■": This indication is also used to refer to an album.

"👉": This indication is also used to refer to a track.

■ iPod To navigate through the iPod/iPhone menu

- Open the Music App to use this feature with iPod touch/iPhone.
- [▲, ▼]: To navigate menu items.
- [OK]: To go to the next menu.
- [DISPLAY, iPod MENU]: To return to the previous menu.



- Depending on the model (e.g., iPod nano 7th generation, etc.), it may be necessary to select the album, artist, etc. on the iPod/iPhone.

Playback modes

(CD, USB, AirPlay*1)

Select the playback mode.

- 1 Press [PLAY MENU] to select "REPEAT", "RANDOM" / "SHUFFLE" or "PLAYMODE".
- 2 Press [▲, ▼] to select the setting and then press [OK].

REPEAT

CD	USB
OFF	Select to cancel repeat playback.
1-TRACK	Only plays the selected track. <ul style="list-style-type: none"> • "1, 📁, 🔄" is displayed. (Skip to the desired track.)
ALL	All tracks are repeated. <ul style="list-style-type: none"> • "🔄" is displayed.
AirPlay	
Refer to the connected device to verify the selected setting.	

CD	USB	RANDOM
ON		Plays the contents randomly. <ul style="list-style-type: none"> • "RND" is displayed. • "RND" will not be displayed when "1-TRACK" is selected.
OFF		Random playback is turned off.

AirPlay	SHUFFLE
Refer to the connected device to verify the selected setting.	

CD (MP3)	USB	PLAYMODE
ALL		Play all MP3 tracks.
1-ALBUM		Only plays the selected MP3 album. <ul style="list-style-type: none"> • "1, 📁" is displayed.



- When using an iPod/iPhone/iPad or Bluetooth® device, use the setting on the device, if available.
- During random play, you cannot skip to the previous track.
- **CD**: The mode is cancelled when you open the door for discs.

AirPlay: The applied settings will remain until it is changed.

*1: **AirPlay**: Perform the settings during playback.

Listening to DAB/DAB+

Preparation

- Make sure that the DAB antenna is connected. (→ 8)
- Turn this system on.

Memorising stations

To listen to DAB/DAB+ broadcasts, the available stations need to be memorised in this system.

- This system will automatically start the “DAB AUTO SCAN” and memorise the stations that are available in your region if the memory is empty.

Press [CD/RADIO] repeatedly to select “DAB/DAB+”.



- “SCAN FAILED” is displayed when the auto scan is unsuccessful. Locate the position with the best reception (→ 20, “To verify or improve the signal reception quality”) and then re-scan DAB/DAB+ stations.

To re-scan DAB/DAB+ stations

When new stations are added or when the antenna has been moved, reperform the auto scan.

- 1 Press [PLAY MENU] repeatedly to select “AUTOSCAN” and then press [OK].
- 2 While “START ?” is flashing, press [OK].



When updating the memory with the auto scan, preset stations will be erased. Preset them again (→ right).

Listening to the memorised stations

Preparation*1

- 1 Press [CD/RADIO] repeatedly to select “DAB/DAB+”.
- 2 Press [PLAY MENU] repeatedly to select “TUNEMODE” and then press [OK].
- 3 Press [▲, ▼] to select “STATION” and then press [OK].

- 1 Press [CD/RADIO] repeatedly to select “DAB/DAB+”.

- 2 Press [◀◀/◀◀] or [▶▶/▶▶] to select the station.

Presetting DAB/DAB+ stations

You can preset up to 20 DAB/DAB+ stations.

Preparation

- Press [CD/RADIO] repeatedly to select “DAB/DAB+”.

- 1 While listening to a DAB broadcast Press [OK].
- 2 Press [▲, ▼] to select the desired preset channel number and then press [OK].



- You cannot preset stations when the station is not broadcasting or when the secondary service is selected.
- The station occupying a channel is erased if another station is preset in that channel.

Listening to preset DAB/DAB+ stations Preparation*1

- 1 Press [CD/RADIO] repeatedly to select “DAB/DAB+”.
- 2 Press [PLAY MENU] repeatedly to select “TUNEMODE” and then press [OK].
- 3 Press [▲, ▼] to select “PRESET” and then press [OK].

- 1 Press [CD/RADIO] repeatedly to select “DAB/DAB+”.

- 2 Press [◀◀/◀◀] or [▶▶/▶▶] to select the station.



- To select by preset, make sure that stations have already been preset manually.
- To add additional preset stations, select the station using the method mentioned in “Listening to the memorised stations” (→ left).

Listening to the secondary service

Some DAB/DAB+ stations provide a secondary service as well as the primary service. If the station you are listening to is providing secondary service, “” will be displayed.

- 1 While “” is displayed. Press [PLAY MENU] repeatedly to select “DAB SECONDARY” and then press [OK].
- 2 Press [▲, ▼] to select the secondary service and press [OK].



The setting will go back to primary service when changes are made (e.g. the station is changed).

*1: The “TUNEMODE” setting is memorised until it is changed.

Display

Press [DISPLAY, iPod MENU] to change the display.

The information will scroll through the display.

Each time you press the button:

Dynamic label:	Information about the broadcast
PTY display:	Programme type
Ensemble label:	The name of the ensemble
Frequency display:	The frequency block and frequency is displayed.
Time display	Current time

Automatic clock adjustment

If the DAB broadcast includes time information, this system's clock will be automatically updated.

- 1 Press [PLAY MENU] repeatedly to select "AUTO CLOCK ADJ" and then press [OK].
- 2 Press [▲, ▼] to select "ON ADJUST" and then press [OK].



Select "OFF ADJUST" to turn the automatic clock adjustment function off.

To verify or improve the signal reception quality

To check the signal reception quality, at least 1 frequency block needs to be successfully memorised.

- If "SCAN FAILED" is displayed after "DAB/DAB+" is selected or after an auto scan, proceed to "Manually tuning 1 frequency block" (→ below)
- If stations have already been memorised to this system, proceed to "Checking the DAB/DAB+ signal reception quality" (→ right)

Manually tuning 1 frequency block

Use this function to scan 1 frequency block after adjusting the position of the DAB antenna.

Preparation

Note down a frequency block that can be received in your region (e.g., 12B 225.648 MHz).

- 1 While "SCAN FAILED" is displayed. Adjust the position of the DAB antenna.
- 2 Press [PLAY MENU] repeatedly to select "MANUAL SCAN" and then press [OK].
- 3 Press [▲, ▼] to select the frequency block that is receivable in your region and then press [OK].



- If broadcasting stations are memorised, proceed to "To re-scan DAB/DAB+ stations" to memorise stations on other frequency blocks. (→ 19)
- If "SCAN FAILED" is still displayed, repeat steps 1 to 3 until a station is memorised. If the situation does not improve, try using an outdoor DAB antenna or consult your dealer.

Checking the DAB/DAB+ signal reception quality

- 1 While listening to the DAB broadcast: Press [PLAY MENU] repeatedly to select "SIGNAL QUALITY" and then press [OK].
 - The current frequency block is displayed and then the reception quality is indicated.

Reception quality
0 (poor) - 8 (excellent)



- 2 If the signal reception quality is poor, move the antenna to a position where the reception quality improves.
- 3 To continue checking the quality of other frequency blocks Press [▲, ▼] again and select the desired frequency.
- 4 Press [OK] to exit.



If the antenna has been adjusted, perform auto scanning and update the station memory. (→ 19)

Changing the Auto scan frequency range

Only the frequencies currently used in the UK as of January 2013 on BAND III are Auto scanned ("LOCAL", factory setting).

Select "ALL BAND III" when you want to store stations on other frequencies to memory.

- 1 Press [PLAY MENU] repeatedly to select "SCAN MODE".
- 2 Press [▲, ▼] to select "ALL BAND III" or "LOCAL" and then press [OK].
 - The "DAB AUTO SCAN" begins automatically.



- The DAB preset channels are erased when the "SCANMODE" is changed.
- If the play timer has been set and DAB/DAB+ is the music source, the timer switches off. (→ 22)

Listening to FM radio

You can preset up to 30 channels.

Preparation

- Make sure that the antenna is connected. (→ 8)
- Turn this system on.
- Press [CD/RADIO] repeatedly to select "FM".



A station previously stored is overwritten when another station is stored in the same channel preset.

Presetting stations automatically

- 1 Press [PLAY MENU] to select "A.PRESET".
- 2 Press [▲, ▼] to select "LOWEST" or "CURRENT" and then press [OK].

LOWEST:

To begin auto preset with the lowest frequency (FM 87.50).

CURRENT:

To begin auto preset with the current frequency.*
* To change the frequency, refer to "Manual tuning and presetting".

The tuner starts to preset all the stations it can receive into the channels in ascending order.

Listening to a preset channel

Preparation

- ① Press [PLAY MENU] repeatedly to select "TUNEMODE".
- ② Press [▲, ▼] to select "PRESET" and then press [OK].

Press [◀◀/▶▶] or [▶▶/▶▶] to select the channel.

Manual tuning and presetting

Select a radio broadcast.

- 1 Press [PLAY MENU] repeatedly to select "TUNEMODE".
- 2 Press [▲, ▼] to select "MANUAL" and then press [OK].
- 3 Press [◀◀/▶▶] or [▶▶/▶▶] to tune to the required station.
 - To start automatic tuning, press and hold [◀◀/▶▶], [▶▶/▶▶] until the frequency starts scrolling. Tuning stops when a station is found.

To preset the channel

- 4 While listening to the radio broadcast Press [OK].
- 5 Press [▲, ▼] to select the channel and then press [OK].

To improve FM sound quality

- 1 While receiving FM broadcasts, press [PLAY MENU] repeatedly to select "FM MODE".
 - 2 Press [▲, ▼] to select "MONO" and then press [OK].
- This setting can be preset and memorised. To do so, continue to step 4 of "Manual tuning and presetting".



- Select "STEREO" in step 2 to return to stereo broadcasts.
- "MONO" is cancelled if the frequency is changed.
- If "MONO" is selected, regardless of the type of signal this system is receiving, "FM MONO" is displayed. (→ below)

To display the current FM signal status

While receiving FM broadcast, press [DISPLAY, iPod MENU].

"FM ST": The FM signal is in stereo.

"FM": The FM signal is in monaural.

- "FM" is also displayed even if this system is not tuned to a station.



- "STEREO" is displayed when this system tunes to a stereo broadcast.

Sound adjustment

The following sound effects can be added to the audio output.

- 1 Press [SOUND] repeatedly to select the effect.
- 2 Press [▲, ▼] to select the setting and then press [OK].

Direct-Vocal Surround (D.SURROUND)	“LEVEL 1”, “LEVEL 2” or “OFF”. <ul style="list-style-type: none">• The factory preset is “OFF”.
Preset EQ (PRESET EQ)	“HEAVY” (heavy), “SOFT” (soft), “CLEAR” (clear), “VOCAL” (vocal) or “FLAT” (flat/off). <ul style="list-style-type: none">• The factory preset is “HEAVY”.
Bass (BASS) or Treble (TREBLE)	Adjust the level (–4 to +4).
Dynamic Bass (D.BASS)	“ON D.BASS” or “OFF D.BASS”. <ul style="list-style-type: none">• The factory preset is “ON D.BASS”.

- You may experience a reduction in sound quality when these effects are used with some sources. If this occurs, turn the sound effects off.

Clock and Timer

To make this setting, point the remote control at the speaker unit.

Setting the clock

This is a 24-hour clock.

- 1 Press [SETUP] to select “CLOCK”.
- 2 Press [▲, ▼] to set the time and then press [OK].



- To display the clock, press [SETUP] to select “CLOCK” and then press [OK] once. The time is displayed for 10 seconds. (During standby, press [DISPLAY, iPod MENU] once.)
- The clock is reset when there is a power failure or when the AC mains lead is removed.
- Reset the clock regularly to maintain accuracy.

Play timer

You can set the timer so this system turns on at a certain time every day.

Preparation

Set the clock (→ left).

Setting the timer

- 1 Press [SETUP] repeatedly to select “TIMER ADJ”.
- 2 Press [▲, ▼] to set the starting time (“ON TIME”) and then press [OK].
- 3 Press [▲, ▼] to set the finishing time (“OFF TIME”) and then press [OK].

Turn the timer on

- 1 Select the music source*1 and set the desired volume.
- 2 Press [SETUP] repeatedly to select “TIMER SET”.
- 3 Press [▲, ▼] to select “SET” and then press [OK].
 - “⊙” is displayed.
 - To turn the timer off, select “OFF”.
- 4 Press [⏻] to turn this system off.



- To display the timer settings, press [SETUP] repeatedly to select “TIMER ADJ” and then press [OK] once. The music source and volume will also be displayed if the timer is turned on.
- During standby, if the timer is turned on, press [DISPLAY, iPod MENU] twice to display the settings.
- This system can be used as normal after the timer is set, however:
 - Turn this system to standby mode before the timer start time.
 - Even if the audio source or the volume is changed, the timer will still use the audio source and volume that was set when the timer was turned on.
- If this system is having a wireless communication problem at the set time, an electronic sound may go off instead of the set music source. Turn this system off to stop the electronic sound.

*1: “CD”, “DAB/DAB+”, “FM”, “AUX”, “IPOD_DOCK” and “IPOD_PORT” / “USB” can be set as the music source.

Sleep timer

The sleep timer can turn this system off after a set time.

- 1 Press [SLEEP] repeatedly to set the time (in minutes) and then press [OK].

“SLEEP 30” → “SLEEP 60” → “SLEEP 90” → “SLEEP 120”
↑ OFF (Cancel) ↓
- The remaining time is indicated on this system’s display except when other operations are performed.
- The play timer and sleep timer can be used together. The sleep timer always has priority.

Others

Automatic standby

As a factory preset, this system will always turn off automatically if there is no sound output and no operation for approx. 30 minutes.

To cancel this function

- 1 Press [SETUP] repeatedly to select "AUTO OFF".
- 2 Press [▲, ▼] to select "OFF" and then press [OK].



- To turn automatic standby on, select "ON" in step 2.
- This setting cannot be selected when "DAB/DAB+" or "FM" is the source.
- When connected to a Bluetooth® device, the automatic standby function does not work.

Changing the remote control code

When other Panasonic equipment responds to the supplied remote control, change the remote control code.

- 1 Press [⊗], AUX] to select "AUX".
- 2 While pressing and holding [SELECTOR] on the speaker unit, press and hold [CD/RADIO] on the remote control until this system's displays show "REMOTE 2".
- 3 Press and hold [OK] and [CD/RADIO] on the remote control for at least 4 seconds.



To change the mode back to "REMOTE 1", repeat the steps above but replace the button pressed on the remote control from [CD/RADIO] to [⊗], AUX].

Software update

Occasionally, Panasonic may release updated software for this system that may add or improve the way a feature operates. These updates are available free of charge.

The CD unit and the speaker unit need to be updated separately.

DO NOT DISCONNECT the AC mains lead while one of the following messages is displayed.

- "LINKING", "UPDATING" or "□□□%"
("□" stands for a number.)
- During the update process, no other operations can be performed.

Preparation

- Turn this system on.
- Connect this system to the wireless network. (→ 10)
 - Make sure that the wireless network is connected to the Internet.
 - If "D.CONNECT" is set to "ON", change the setting to "OFF" and connect this system to a wireless network that is connected to the Internet.

Updating the CD unit

- 1 Download the latest firmware from the following website and burn it to a CD-R to update the firmware.
<http://panasonic.jp/support/global/cs/>
(This site is in English only.)
- 2 Insert the CD-R to the CD unit.
- 3 Press [CD/RADIO] repeatedly to select "CD".
- 4 Press [▲, ▼] to select "UPDATE? Y" and then press [OK] to start the update.
 - Select "UPDATE? N" to cancel the update.
 - ↳ After the update has finished, "SUCCESS" is displayed.
- 5 Disconnect the AC mains lead and reconnect it after 3 minutes.

Updating the speaker unit

- 1 Press [SETUP] repeatedly to select "SW UPDATE" and then press [OK].
- 2 Press [▲, ▼] to select "UPDATE? Y" and then press [OK] to start the update.
 - Select "UPDATE? N" to cancel the update.
 - ↳ After the update has finished, "SUCCESS" is displayed.
- 3 Disconnect the AC mains lead and reconnect it after 3 minutes.



- If there are no updates, "NO NEED" is displayed.
- **Downloading will require several minutes. It may take longer or may not work properly depending on the connection environment.**

Checking the software version

- 1 Press [SETUP] repeatedly to select "SW VER." and then press [OK].
 - ↳ The version of the installed software is displayed.
- 2 Press [OK] to exit.

Changing the communication mode

To change the wireless communication quality between the CD unit and the speaker unit. If the units are not wirelessly connected, or output sound is interrupted, select "C.MODE1" in step 2.

- 1 Press [SETUP] repeatedly to select "COM.MODE" and then press [OK].
- 2 Press [▲, ▼] to select "C.MODE1" or "C.MODE2" and then press [OK].

C.MODE1 : Priority is given to connectivity (229 bps)

C.MODE2 : Priority is given to sound quality (384 bps, default setting)



- **CD iPod USB** : Stop play before switching communication modes. If you switch modes while this system is playing, sound output will be lost during the switching process.

Wi-Fi signal strength

To check the Wi-Fi signal strength where this system is located.

Preparation

Connect this system to the wireless network. (→ 10)

- 1 Press [SETUP] repeatedly to select "SIG.LEVEL" and then press [OK].
 - This system's displays show "LEVEL □". ("□" stands for a number.)
- 2 Press [OK] to exit this display mode.



- It is recommended to have a signal strength of "3". Change the position or angle of your wireless network router or this system if the indication is "2" or "1" and see if the connection improves.
- If "LEVEL 0" is displayed, this system cannot establish a link with the wireless network router. (→ 27)
- This function does not work when "D.CONNECT" is set to "ON".

Network standby

This system can turn on automatically from standby mode when this system is selected as the AirPlay speakers.

Preparation

Connect this system to the wireless network. (→ 10)

- 1 Press [SETUP] repeatedly to select "NET STNBY" and then press [OK].
- 2 Press [▲, ▼] to select "ON" and then press [OK].



- To cancel this function, select "OFF" in step 2.
- The factory preset is "OFF". If this function is set to "ON" the standby power consumption will increase.

Wireless network name (SSID)

Display the name for the connected wireless network (SSID).

- 1 Press and hold [- WPS] on the speaker unit and [OK] on the remote control until this system's displays show the SSID.
- 2 Press [OK] to exit.



- If "NOCONNECT" is displayed this system is not connected to a wireless network.
- All letters are displayed as capital letters, and characters that cannot be displayed are replaced with "*".

IP/MAC Address

To check this system's IP address or the Wi-Fi MAC address.

- 1 Press and hold [- WPS] on the speaker unit and [▼] on the remote control until this system's displays show the IP address.
 - ↳ The IP address is partially displayed.
 - To display the MAC address on this system, repeat the steps above by replacing [▼] with [▲].
- 2 Press [▲, ▼] on the remote control to show the rest of the IP address.



- To exit the setting, wait 20 sec.
- The "-" displayed on the top or bottom left of the display indicate the first and last units respectively.

Troubleshooting

Before requesting service, make the following checks. If you are in doubt about some of the check points, or if the solutions indicated in the following guide do not solve the problem, consult your dealer for instructions.

To return all settings to the factory preset

When the following situations occur, reset the memory of both the CD unit and the speaker unit:

- There is no response when buttons are pressed.
 - You want to clear and reset the memory contents.
- ① Disconnect the AC mains lead. (Wait for at least 3 minutes before proceeding to step ②.)
 - ② While pressing and holding down [⏻] on the unit, reconnect the AC mains lead.
 - Keep holding down [⏻] until “-----” appears on the display.
 - ③ Release [⏻].



All the settings are returned to the factory preset. You will need to reset the memory items.

Do you have the latest software installed?

- Occasionally, Panasonic may release updated software for this system that may add or improve the way a feature operates. (→ 23)

Common problems

The CD unit and the speaker unit are not wirelessly connected.

The sound is interrupted.

The standby/on indicator on the side of the CD unit lights red.

The display shows “NOCONNECT” or “CANNOT ACCEPT”.

This system has a wireless communication problem, follow the instructions below.

- ① Check that the AC mains leads are connected to the both units.
 - ② If the devices which use 2.4 GHz are being used near this system, turn them off temporarily.
 - ③ Move the both units closer together.
A wireless connection will be automatically established.
- If a wireless connection is not established, set the communication mode to “C.MODE1”. (→ 24)
 - **If the problem persists, connect the units with cables.** (→ 8)

Only the speaker unit's display turns on

- Press any button on the CD unit, or select “CD”, “IPOD_DOCK”, or “IPOD_PORT” as an audio source.

Humming heard during play.

- An AC mains lead or fluorescent light is near the cords. Keep other appliances and cords away from this system's cables.

MP3 cannot be read.

- You may not be able to play MP3 if you have copied a multi-session disc that has no data between sessions.
- When creating a multi-session disc, it is necessary to close the session.
- The amount of data on the disc is too small. Set the amount of data to above 5 MB.

Bluetooth®

Pairing cannot be done.

- Check the Bluetooth® device condition.

The device cannot be connected.

- The pairing of the device was unsuccessful or the registration has been replaced. Try pairing the device again.
- This system might be connected to a different device. Disconnect the other device and try pairing the device again.

The device is connected but audio cannot be heard through the speaker unit.

- For some built-in Bluetooth® devices, you have to set the audio output to “SC-NE5” manually. Read the operating instructions for the device for details.

The sound is interrupted.

- The device is out of the 10 m communication range. Bring the Bluetooth® device closer to this system.
- Remove any obstacle between this system and the device.
- Other devices that use the 2.4 GHz frequency band (wireless router, microwaves, cordless phones, etc.) are interfering. Bring the Bluetooth® device closer to the speaker unit and distance it from the other devices.
- Select “MODE 1” for stable communication. (→ 16).

Disc operations

Incorrect display or play will not start.

- Make sure that the disc is compatible with this system. (→ 5)
- There is moisture on the lens. Wait for about an hour and then try again.

USB operations

No response when [▶/||] is pressed.

- Disconnect the USB device and then reconnect it. Alternatively, turn this system off and on again.

The USB drive or its contents cannot be read.

- The USB drive format or its contents is/are not compatible with this system (→ 5).
- The USB host function of this product may not work with some USB devices.

Slow operation of the USB flash drive.

- Large file size or high memory USB flash drive takes longer time to read.

The elapsed time displayed is different from the actual play time.

- Copy the data to another USB device or backup the data and reformat the USB device.

Radio

DAB/DAB+ reception is poor.

- Keep the antenna away from computers, televisions, other cables and cords.
- Use an outdoor antenna (→ 8).

A beat sound or noise is heard while receiving radio broadcast.

- Confirm the DAB antenna is properly connected. (→ 8)
- Adjust the position of the antenna.
- Try to keep a certain amount of distance between the antenna and AC mains lead.
- Try using outdoor antenna if there are buildings or mountains nearby.
- Switch the television or other audio player off or separate it from this system.
- Keep this system away from mobile phones if the interference is apparent.

iPod/iPhone/iPad operations

Cannot charge or operate.

- Have you selected the appropriate selector?
Press [iPod/USB] to select either "IPOD_DOCK" or "IPOD_PORT".
- Check that the iPod/iPhone/iPad is connected properly. (→ 9)
- The battery of the iPod/iPhone/iPad is depleted. Charge the iPod/iPhone/iPad, and then operate again.
- Connect the iPod/iPhone/iPad again or try to restart the iPod/iPhone/iPad.
- When this system is in standby mode, charging will not start when using the "IPOD_PORT" connection. Turn this system on and make sure the charging has started before switching this system to standby mode.
- Charging an iPod/iPhone/iPad whose battery is depleted:
 - When using the "IPOD_PORT" connection, turn this system on. Do not turn this system off until the iPod/iPhone/iPad becomes operational.
 - When using the "IPOD_DOCK" connection, "CHECKING CONNECTION" will be displayed until the iPod/iPhone/iPad becomes operational, but this system will have begun charging.

AirPlay operations

Cannot connect to the network.

- Confirm the network connection and settings. (→ 10)
- Your wireless network might be set to be invisible. In this case select "Manual settings" in "Method 4". (→ 13)
- This system cannot join a wireless network using WEP security settings with the WPS methods ("Method 1"). Use "Method 4" to join the wireless network. (→ 12)
- Make sure that the multicast function on the wireless network router is set to on (enabled).
- When "D.CONNECT" is used, if the password for "D.CONNECT" has been changed connect the other device to this system using the new password. (→ 14)

Cannot connect to this system.

- Display the wireless network name that this system is connected to and make sure that the device is connected to the same network. (→ 10, 24)
- If "NET STNBY" is set to "OFF", the AirPlay compatible device cannot be connected when this system is off.
- Turn off the Wi-Fi setting on the AirPlay compatible device, set "NET STNBY" to "OFF" (→ 24) and then turn this system off and on. Reconnect the compatible device to the Wi-Fi network and then select this system as the AirPlay speakers again.

My wireless network router is WPS PBC compatible, but the pairing does not work.

- If the network is set to be invisible, the push button configuration does not work. In this case, either make the wireless network visible while you set up the network for this system or use "Method 2", "Method 3" or "Method 4". (→ 11, 12)

Playback does not start.

The sound is interrupted.

- Simultaneous use with other 2.4 GHz devices, such as microwaves, cordless telephones, etc., may result in connection interruptions.
Increase the distance between this system and these devices.
- Do not place this system inside a metal cabinet, for it might block the Wi-Fi signal.
- Place this system closer to the wireless network router.
- If "D.CONNECT" is set to "ON", place the AirPlay compatible device closer to the speaker unit.
- If several wireless devices are simultaneously using the same wireless network as this system, try turning off the other devices or reducing their wireless network usage.
- If the playback stops, check the playback status on the iOS device or iTunes.
- If play does not start (even though the Wi-Fi status indicator lights in blue and the AirPlay icon is displayed), restart the wireless network router, turn the Wi-Fi connection on the iOS device or Mac/PC off and on, and then make sure that your home wireless network is selected.
- If the AirPlay icon is not displayed even if Wi-Fi status indicator lights in blue, try restarting the wireless network router.
- With some iOS and iTunes versions, it may not be possible to restart the AirPlay playback if the selector is changed (e.g., "CD") or this system is turned off, during the AirPlay playback.
In this case, select a different device from the AirPlay icon of the Music App or iTunes and then re-select this system as the output speakers. (→ 14)

Remote control

The remote control doesn't work properly.

- The remote control and this system are using a different code. (→ 27, "REMOTE □")
- Is the battery depleted or is the battery inserted incorrectly? (→ 7)

Messages

The following messages or service numbers may appear on this system's displays.

"--:--"

- You plugged the AC mains lead in for the first time or there was a power failure recently. Set the time (→ 22).

"ADJUST CLOCK"

- Clock is not set. Adjust the clock accordingly.

"ADJUST TIMER"

- Play timer is not set. Adjust the play timer accordingly.

"AUTO OFF"

- This system has been left unused for about 30 minutes and will shut down within a minute. Press any button to cancel it.

“CANNOT ACCEPT”

- The remote control cannot be operated due to a wireless communication problem between the CD unit and the speaker unit. (→ 25)

“CANNOT SET”

- Select an audio source other than “AIRPLAY” or “BLUETOOTH”.

“CHECKING CONNECTION”

- This system is checking the connected iPod/iPhone/iPad.
- If this display keeps appearing, make sure that the battery of the iPod/iPhone/iPad is not depleted and that the iPod/iPhone/iPad is turned on and connected correctly (→ 9).

“DL ERROR”

- The software download has failed. Press any button to exit. Please try again later.
- The server cannot be found. Press any button to exit. Make sure that the wireless network is connected to the Internet.

“ERROR”

- Incorrect operation is performed. Read the instructions and try again.

“F □□” (“□” stands for a number.)

- There is a problem with this system.
Note down the displayed number, disconnect the AC mains lead and consult your dealer.

“FAIL”

- Updating or setting has failed. Read the instructions and try again.

“IPOD_DOCK OVER CURRENT ERROR”

“IPOD_PORT OVER CURRENT ERROR”

- The iPod/iPhone/iPad is drawing too much power. Remove the iPod/iPhone/iPad and turn this system off and on again.
- The USB device is drawing too much power. Switch to “CD” mode, remove the USB and turn this system off.

“LEVEL 0”

- There is no link between this system and the wireless network router.
Try the following operations:
 - Check that the wireless network router is turned on.
 - Turn this system off and on again.
 - Reset the wireless network settings. (→ 10)If the problem persists, consult your dealer.

“LEVEL ...”

- When “D.CONNECT” is set to “ON” the Wi-Fi signal strength cannot be checked. To check the Wi-Fi signal strength from the wireless network router, set “D.CONNECT” to “OFF”. (→ 14)

“LINKING”

- This system is communicating with the wireless network router to complete the network settings.
Depending on the wireless network router this process may take a few minutes. Try moving this system closer to the wireless network router.

“NOCONNECT”

- This system cannot connect to the network.
Check the network connection. (→ 10)
- This system has a wireless communication problem between the CD unit and the speaker unit. (→ 25)

“NODEVICE”

- The iPod/iPhone/iPad device is not inserted correctly. Read the instructions and try again (→ 9).
- The battery of the iPod/iPhone/iPad is depleted. Charge the iPod/iPhone/iPad and turn it on before connecting.
- The USB device is not inserted. Check the connection.

“NO DISC”

- Insert the disc to be played (→ 9).

“NO MEMORY”

- There are no preset DAB/DAB+ stations to select. Preset some channels. (→ 19)

“NO PLAY”

- A CD that is not in CD-DA or MP3 format is inserted. It cannot be played.
- If there are more than 255 albums or folders (audio and non-audio), some of the MP3 files in these albums may not be read and played. Transfer these music albums to another USB. Alternatively, reformat the USB device and save these music albums prior to saving the other non-audio folders.

“NO SIGNAL”

- This station cannot be received. Check your antenna (→ 8).

“NOT SUPPORTED”

- You have inserted an iPod/iPhone/iPad that cannot be played (→ 5).
- If the iPod/iPhone/iPad is compatible, turn it on and connect it correctly.
- The connected iPod touch/iPhone/iPad is not connected to a wireless network. Connect it to a wireless network and try again. (→ 10)

“READING”

- This system is checking the CD information. After this display has disappeared, start operating.

“REMOTE □” (“□” stands for a number.)

- The remote control and this system are using different codes. Change the code on the remote control.
 - When “REMOTE 1” is displayed, press and hold [OK] and [Ⓜ, AUX] for more than 4 seconds.
 - When “REMOTE 2” is displayed, press and hold [OK] and [CD/RADIO] for more than 4 seconds.

“SCAN FAILED”

- Stations are not receivable. Check your antenna and try Auto scanning (→ 19).
If “SCAN FAILED” is still displayed find the best signal reception with the “MANUAL” tuning function. (→ 20)

“SET WI-FI”

- The connected iPod touch/iPhone/iPad is not connected to a wireless network. Connect it to a wireless network and try again. (→ 10)
-

Attaching the speaker unit to a wall (optional)

The speaker unit can be wall mounted using the supplied wall mount brackets, etc. Make sure that the screw used and the wall are strong enough to support the weight of at least 33 kg.

The screws and other items are not supplied as the type and size will vary with each installation.

- Refer to step 2 of "Wall mount instructions" for details about the required screws.
- Be sure to attach the fall prevention cord as a secondary safety measure.

Installation accessories

■ Supplied accessories

- 1 Safety holder
- 1 Screw
- 2 Wall mount brackets

■ Additionally required accessories (commercially available)

- 4 Wall mount bracket fixing screws
- 1 Safety holder fixing screw
- 1 Fall prevention cord*
- 1 Screw eye

- Keep the safety holder out of reach of children to prevent swallowing.
- Keep the screws out of reach of children to prevent swallowing.
- Keep the wall mount brackets out of reach of children to prevent swallowing.

* Use a cord that is capable of supporting over 33 kg (with a diameter of about 1.5 mm).

Safety precautions

Professional installation is required.
The installation should never be done by any other than a qualified installation specialist.
PANASONIC DISCLAIMS ANY PROPERTY DAMAGE AND/OR SERIOUS INJURY, INCLUDING DEATH RESULTING FROM IMPROPER INSTALLATION OR INCORRECT HANDLING.

- Be sure to install this unit as indicated within these operating instructions.

Wall mount instructions

Before installation, turn the unit off and disconnect the AC mains lead from the mains socket.

- 1 Measure and mark the position of the wall mount brackets (Both sides).

↳ Use figures below to identify the screwing positions.

The position to attach the wall mount brackets

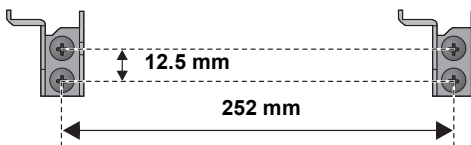

Space required

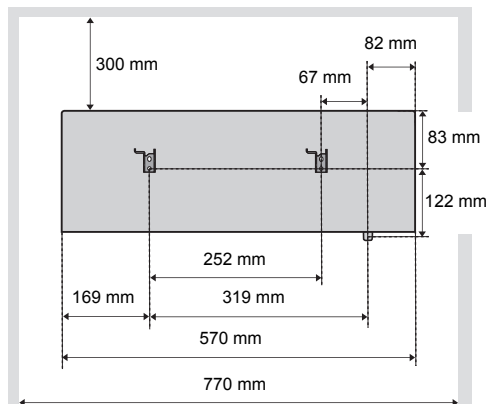

2 Attach the wall mount bracket to the wall with 2 screws (not supplied). (Both sides)

- Use a level to ensure both wall mount brackets are level.

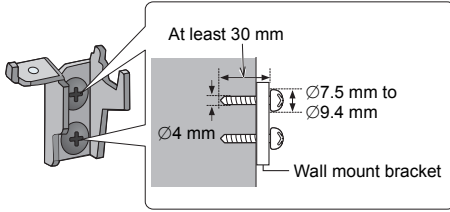

3 Fix the safety holder onto the unit with the screw (supplied).

↳ Screw tightening torque: 50 N•cm to 70 N•cm.

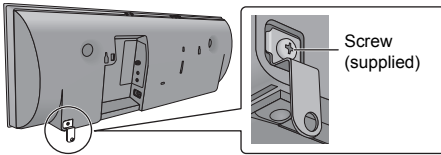

4 Attach the fall prevention cord (not supplied) to this unit.

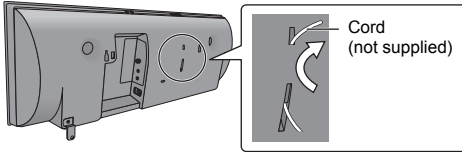

5 Hook the unit securely onto the wall mount brackets with both hands.

- Connect the antenna and the AC mains lead to the unit before hanging the unit onto the wall. (→ 8)
- After hanging the unit, release your hands carefully to confirm the unit sits securely on the wall.

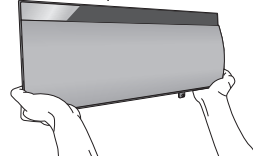
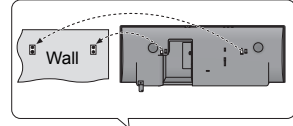

6 Drive the safety holder fixing screw (not supplied) to secure the safety holder onto the wall.

- Refer to step 2 for requirements before screwing.

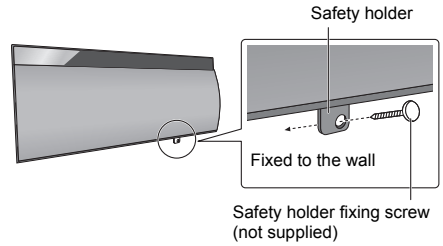

7 Attach the fall prevention cord (not supplied) to the wall.

- Make sure that the slack of the cord is minimal.

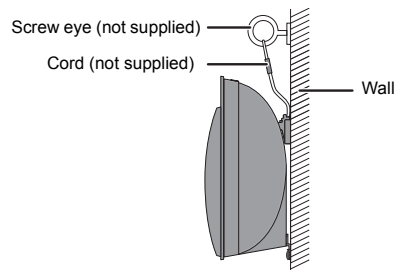

Specifications

■ GENERAL

Power consumption	
CD unit	23 W
Speaker unit	14 W
Power consumption in standby mode*1	
CD unit	Approx. 0.3 W
Speaker unit	Approx. 0.3 W
Power consumption in standby mode*1 (When "NET STNBY" is "ON")	
Speaker unit	Approx. 4.0 W
Power supply	AC 220 V to 240 V, 50 Hz

Dimensions (W×H×D)

CD unit	192 mm×206 mm×93 mm
Speaker unit	570 mm×206 mm×100 mm

Mass

CD unit	Approx. 0.9 kg
Speaker unit	Approx. 2.8 kg
Operating temperature range 0 °C to +40 °C	
Operating humidity range 35 % to 80 % RH (no condensation)	

■ AMPLIFIER SECTION

RMS Output Power Stereo mode

Front Ch (both ch driven)	20 W per channel (6 Ω), 1 kHz, 10 % THD
Total RMS Stereo mode power	40 W

■ TUNER SECTION

Frequency Modulation (FM)

Preset Memory	FM 30 stations
Frequency range	87.50 MHz to 108.00 MHz (50 kHz step)
Antenna terminals	75 Ω (unbalanced)

■ DAB SECTION

DAB memories 20 channels

Frequency Band (Wavelength)

Band III (UK Only)	10B (211.648 MHz) 11B to 12D (218.640 MHz to 229.072 MHz)
--------------------	--

Band III (Europe/Australia)

5A to 13F (174.928 MHz to 239.200 MHz)

Australia

9A to 9C (202.928 MHz to 206.352 MHz)

Sensitivity *BER 4x10⁻⁴

Min Requirement -98 dBm

DAB External Antenna

Terminal F - Connector (75 Ω)

■ TERMINALS SECTION

iPod Port

USB Standard	USB 2.0 full speed
Media file format support	MP3 (*.mp3)
USB device file system	FAT12, FAT16, FAT32
iPod port power	DC OUT 5 V 2.1 A MAX
Lightning Connector	DC OUT 5 V 1.0 A MAX
AUX Terminal	Stereo, Ø3.5 mm jack

■ DISC SECTION

Disc played (8 cm or 12 cm)

CD, CD-R/RW (CD-DA, MP3)

Pick up

Wavelength	790 nm (CD)
Laser power	CLASS 1

Audio output (Disc)

Number of channels 2 ch (FL, FR)

■ SPEAKER SECTION

Type

2 way, 2 speaker system (Bass reflex)

Speaker unit(s)

1. Woofer 8 cm × 1 per channel

2. Tweeter 2.5 cm × 1 per channel

Impedance 6 Ω

Output sound pressure 83.5 dB/W (1 m)

Frequency range

52 Hz to 25 kHz (-16 dB), 75 Hz to 22 kHz (-10 dB)

■ Wi-Fi/ AirPlay SECTION

Wi-Fi

WLAN Standards	IEEE802.11b/g
Frequency range	2.4 GHz band
Security	WEP (64 bit/128 bit), WPA™, WPA2™
WPS version	Version 2.0 (WEP not support)

■ BLUETOOTH SECTION

Version Bluetooth® Ver.2.1 +EDR

Output Class 2 (2.5 mW)

Communication distance About 10 m*2

Communication method 2.4 GHz band FH-SS

Correspondence profile A2DP / AVRCP



*1: When the iPod/iPhone/iPad is not charging.

*2: Prospective communication distance

Measurement environment:
Temperature 25 °C / Height 1 m
Measure in "MODE 1"

- Specifications are subject to change without notice. Mass and dimensions are approximate.
- Total harmonic distortion is measured by a digital spectrum analyzer.

Limited Warranty (ONLY FOR AUSTRALIA)

Panasonic Warranty

1. The product is warranted for 12 months from the date of purchase. Subject to the conditions of this warranty Panasonic or its Authorised Service Centre will perform necessary service on the product without charge for parts or labour, if in the opinion of Panasonic, the product is found to be faulty within the warranty period.
2. This warranty only applies to Panasonic products purchased in Australia and sold by Panasonic Australia or its Authorised Distributors or Dealers and only where the products are used and serviced within Australia or its territories. Warranty cover only applies to service carried out by a Panasonic Authorised Service Centre and only if valid proof of purchase is presented when warranty service is requested.
3. This warranty only applies if the product has been installed and used in accordance with the manufacturer's recommendations (as noted in the operating instructions) under normal use and reasonable care (in the opinion of Panasonic). The warranty covers normal domestic use only and does not cover damage, malfunction or failure resulting from use of incorrect voltages, incorrect installation, accident, misuse, neglect, build-up of dirt or dust, abuse, maladjustment of customer controls, mains supply problems, thunderstorm activity, infestation by insects or vermin, tampering or repair by unauthorised persons (including unauthorised alterations), introduction of sand, humidity or liquids, commercial use such as hotel, office, restaurant, or other business or rental use of the product, exposure to abnormally corrosive conditions or any foreign object or matter having entered the product.
4. This warranty does not cover the following items unless the fault or defect existed at the time of purchase:
 - (a) Cabinet Part(s)
 - (b) Video or Audio Tapes
 - (c) SD cards or USB devices
 - (d) User replaceable Batteries
etc
 - (e) DVD, Blu-ray or Recordable Discs
 - (f) Video / Audio Heads from wear and tear in normal use
 - (g) Information stored on Hard Disk Drive, USB stick or SD card
 - (h) DTV reception issues caused by TV Aerial / Cabling / Wall socket(s)
5. Some products may be supplied with Ethernet connection hardware. The warranty is limited on such products and will not cover
 - (a) Internet and or DLNA connection / setup related problems
 - (b) Access fees and or charges incurred for internet connection
 - (c) The use of incompatible software or software not specifically stipulated in the product operations manual;
and
 - (d) Any indirect or consequential costs associated with the incorrect use or misuse of the hardware, its connection to the internet or any other device.
6. To claim warranty service, when required, you should:
 - Telephone Panasonic's Customer Care Centre on 132600 or visit our website referred to below and use the Service Centre Locator for the name/address of the nearest Authorised Service Centre.
 - Send or take the product to a Panasonic Authorised Service Centre together with your proof of purchase receipt as a proof of purchase date. Please note that freight and insurance to and / or from your nearest Authorised Service Centre must be arranged by you.
 - Note that home or pick-up/delivery service is available for the following products in the major metropolitan areas of Australia or the normal operating areas of the nearest Authorised Service Centres:
 - Plasma/LCD televisions / displays (screen size greater than 103 cm)
7. The warranties hereby conferred do not extend to, and exclude, any costs associated with the installation, de-installation or re-installation of a product, including costs related to the mounting, de-mounting or remounting of any screen, (and any other ancillary activities), delivery, handling, freight, transportation or insurance of the product or any part thereof or replacement of and do not extend to, and exclude, any damage or loss occurring by reason of, during, associated with, or related to such installation, de-installation, re-installation or transit.

Panasonic Authorised Service Centres are located in major metropolitan areas and most regional centres of Australia, however, coverage will vary dependant on product. For advice on exact Authorised Service Centre locations for your product, please telephone our Customer Care Centre on 132600 or visit our website and use the Service Centre Locator.

In addition to your rights under this warranty, Panasonic products come with consumer guarantees that cannot be excluded under the Australian Consumer Law. If there is a major failure with the product, you can reject the product and elect to have a refund or to have the product replaced or if you wish you may elect to keep the goods and be compensated for the drop in value of the goods. You are also entitled to have the product repaired or replaced if the product fails to be of acceptable quality and the failure does not amount to a major failure.

If there is a major failure in regard to the product which cannot be remedied then you must notify us within a reasonable period by contacting the Panasonic Customer Care Centre. If the failure in the product is not a major failure then Panasonic may choose to repair or replace the product and will do so in a reasonable period of time from receiving notice from you.

**THIS WARRANTY CARD AND THE PURCHASE DOCKET (OR SIMILAR PROOF OF PURCHASE)
SHOULD BE RETAINED BY THE CUSTOMER AT ALL TIMES**

If you require assistance regarding warranty conditions or any other enquiries, please visit the **Panasonic Australia** website www.panasonic.com.au or contact by phone on **132 600**
if phoning in, please ensure you have your operating instructions available.

Panasonic Australia Pty. Limited

ACN 001 592 187 ABN 83 001 592 187

1 Innovation Road, Macquarie Park NSW 2113

PRO-031-F11 Issue: 4.0

01-01-2011

31

VQT4U56

Information for Users on Collection and Disposal of Old Equipment and used Batteries



These symbols on the products, packaging, and/or accompanying documents mean that used electrical and electronic products and batteries should not be mixed with general household waste.

For proper treatment, recovery and recycling of old products and used batteries, please take them to applicable collection points, in accordance with your national legislation and the Directives 2002/96/EC and 2006/66/EC.

By disposing of these products and batteries correctly, you will help to save valuable resources and prevent any potential negative effects on human health and the environment which could otherwise arise from inappropriate waste handling.

For more information about collection and recycling of old products and batteries, please contact your local municipality, your waste disposal service or the point of sale where you purchased the items.

Penalties may be applicable for incorrect disposal of this waste, in accordance with national legislation.



For business users in the European Union

If you wish to discard electrical and electronic equipment, please contact your dealer or supplier for further information.

[Information on Disposal in other Countries outside the European Union]

These symbols are only valid in the European Union. If you wish to discard these items, please contact your local authorities or dealer and ask for the correct method of disposal.



Note for the battery symbol (bottom two symbol examples):

This symbol might be used in combination with a chemical symbol. In this case it complies with the requirement set by the Directive for the chemical involved.

Cd



EU

Pursuant to the applicable EU legislation
Panasonic Marketing Europe GmbH
Panasonic Testing Centre
Winsbergring 15, 22525 Hamburg, Germany



Panasonic Corporation
Web Site: <http://panasonic.net>

En