

## User Manual

No: OS-Sa01E

**Statement:** The sensor contains lithium battery and send signal by radio signal. Same mechanical size sensor may be used for totally different cars, users must make sure the sensor is suitable for your car.

**1. Before user installs the sensor, we recommend user to read the sensor ID by TPMS diagnostic unit, making sure the sensor is qualified before putting it**

**in the tire. This is not mandatory, but sometimes single cause happened that the installation process may cause the sensor broken.**

2. For tire pressure sensor installation, we recommend user to go to

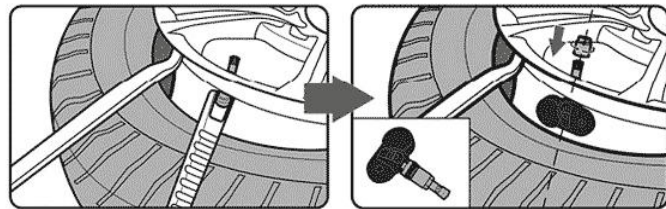

experienced shop to change the sensor. **After implement installation, we recommend user read the sensor ID by TPMS diagnostic. Not mandatory.**

3. After replacement, mandatory requirement that the tire pressure

should be set at the required value like 250MPa . Then go the next: how to let the car recognize new sensor. There are two ways to relearn the sensor.

a) **Stationary relearn:**

Turn the car to relearn mode, different cars have different operation methods and we recommend user to check with Car 4S shop.

**For example: Ford B-Max 2015 EU**

**Step 1:** Engage Parking Brake

**Step 2:** Turn the ignition to OFF position the press and release the brake pedal.

**Step 3:** Quickly turn the ignition from OFF to RUN (engine OFF) 3 times (stop in RUN position)

**Step 4:** Press and release the brake pedal

**Step 5:** Set the ignition to OFF

**Step 6:** Quickly turn the ignition from OFF to RUN (engine OFF) 3 times (stop in RUN position)

**Attention:** All the above need to be performed within 10 sec.

**Step 7:** The horn will sound once

**Step 8:** If equipped with message centre, TRAIN LF tire appears

**Step 9:** Read/ trigger Left Front sensor until a single horn sounds representing the sensor learning successful.

**Step 10:** Repeat steps for Front Right, Rear Right and Left Rear tires.



**Step 11:** TRAINING Mode COMPLETE is displayed.

*If the vehicle is not equipped with the message centre display, successful completion can be verified by turning the ignition OFF and not hearing the horn sound.*

#### **b) OBDII method**

**Step 1:** Must use diagnostic with TPMS OBDII function.

**Step 2:** Turn ignition ON.

**Step 3:** Connect the OBDII Cable/

Module to OBD connector.

**Step 4:** Follow the diagnostic screen's learning instruction until OBDII learning successful.

**Step 5:** Drive for 20min if the TPMS warning lamp remains ON.



**OBDII method is the most stable way to relearn the TPMS.**

After-sales failure:

1. If your car can't recognize the sensor, please provide the sensor OE number user bought, the car's VIN and the original sensor's picture to seller. We will feedback the solution ASAP.
2. Car accident and abnormal intense vibrations may cause the sensor broken.