

**AURZEN**

 Google TV

Hey  
Google  



# **BOOM air**

## USER MANUAL

V1.04

# ENGLISH ▶



Tutorial Videos



AurzenHub App

Download the AurzenHub app to easily control your Aurzen projector and unlock amazing features.

# CONTENTS

TROUBLESHOOTING GUIDE .....	01
READ BEFORE USE .....	02
IN THE BOX .....	03
PRODUCT OVERVIEW .....	03
Projector .....	03
Remote Control .....	05
QUICK START .....	06
1. Projector Installation .....	06
2. Power On/Off .....	07
3. Remote Control Pairing .....	07
4. Setup Wizard .....	08
5. Image Adjustment .....	08
PROJECTOR CONNECTION AND INPUT SOURCE .....	13
WIFI CONNECTION .....	13
GOOGLE ASSISTANT .....	14
GOOGLE CAST™ .....	14
BT SPEAKER MODE .....	15
MORE SETTINGS .....	16
PROJECTION DISTANCE AND SIZE .....	17
SPECIFICATION .....	17

# TROUBLESHOOTING GUIDE

1. The copyrighted content from Hulu, Netflix, and similar services cannot be mirrored or cast.

- \* This projector offers a range of officially licensed streaming apps. You can go to the **homepage > Apps**, search for the app, download and log in to your account to play the content. For casting, refer to the "GOOGLE CAST" section.

## 2. Fuzzy Image

- \* Adjust the focus of the projector.
- \* Make sure the projection distance is in the effective focal range of the projector.
- \* Remove the dust or dirt from the lens with a soft cloth or soft-bristled brush.

## 3. Non-rectangular Image

- \* Place the projector perpendicular to the screen/wall if the keystone correction function is not used.
- \* Use the keystone correction function to adjust the image shape.

## 4. Automatic keystone correction failure

- \* Make sure the adjustment sensors on the front of the projector are not blocked or smudged.
- \* The projector supports  $\pm 20^\circ$  vertical and  $\pm 15^\circ$  horizontal keystone correction. Do not tilt the projector too much.

## 5. Autofocus failure

- \* Make sure the adjustment sensors on the front of the projector are not blocked or smudged.
- \* Move the projector back and forth until the projector is in recommended projection distance.

## 6. Remote control unresponsive

- \* Make sure the batteries are installed correctly and not drained.
- \* Remove any obstructions between your projector and remote control.
- \* Ensure the remote control is successfully paired with projector via BT.
- \* Make sure no button is pressed or stuck and check if the power indicator is still on. If yes, please contact customer support or local service center.

## 7. Connect the BT devices

- \* Go to **Homepage > Dashboard**  **> All settings**  **> Remotes & Accessories** to check the BT device list, and connect the device.

## 8. Power adapter getting warm

- \* It's normal for the power adapter to generate heat during use. It's been tested and meets safety standards. Rest assured.

## 9. Others

- \* Please feel free to contact us via email.

# READ BEFORE USE

### Please read the Product Instructions carefully:

Thank you for purchasing and using this product.

For your safety and interests, please read the Product Instructions carefully before using the product.

### About the Product Instructions:

The trademarks and names mentioned in the Product Instructions are the property of their respective owners. All Product Instructions shown are for illustration purposes only. The actual product may vary due to product enhancements.

We shall not be liable for any personal injury, property damage, or other damages caused by the failure of the user to comply with the Product Instructions or precautions.

**Aurzen** reserves the right to interpret and modify the Product Instructions.

## IN THE BOX



Projector



Remote (Batteries Not Included)

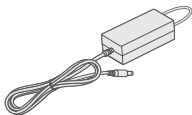

Power Adapter



User Manual

## PRODUCT OVERVIEW

### Projector

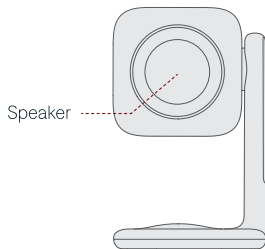
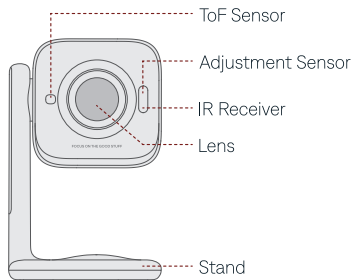

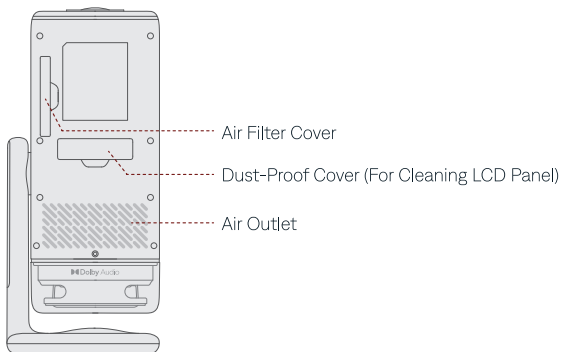
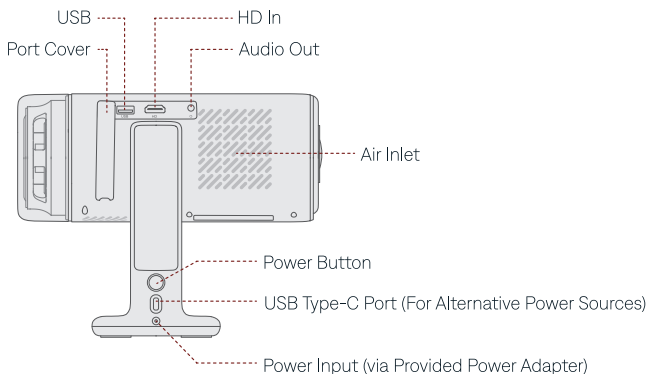

\* Power sources (such as power banks or charging stands) connected via the USB-C port must support 65W (20V  $\overline{=}$  3.25A) power delivery. For optimal performance and safety, ensure to use a power cord with a rated current of 5A or above.

\* The integrated stand offers a 110° rotation angle for flexible viewing adjustments.

## Remote Control

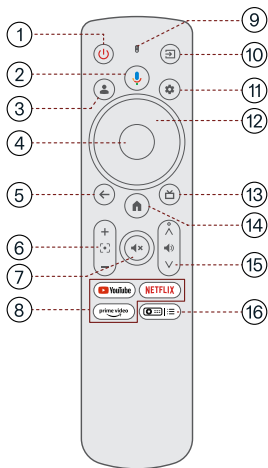

- ⑦ Mute
- ⑧ Streaming Apps  
Jump to video streaming pages
- ⑨ Indicator Light
- ⑩ Input Source  
Press to choose from input sources
- ⑪ Settings  
Press to access dashboard
- ⑫ Navigation  
Control cursor on the screen
- ⑬ HD Quick Switch  
Press to switch directly to the HD input signal
- ⑭ Home  
Access homepage
- ⑮ Volume +/-
- ⑯ Projector Setting (Shortcut)  
Access projector setting shortcut menu

- ① Power  
Press to power on/switch to standby mode/wake up/press and hold for 3s to power off

- ② Google Assistant  
Press and hold and talk

- ③ User Profile  
Press to see profile page

- ④ OK  
Confirm a selection/pause/resume

- ⑤ Back  
Return to previous page

- ⑥ Focus Adjustment

\* Please install 2 AAA batteries (not included) into the remote control before use.

# QUICK START

## 1. Projector Installation

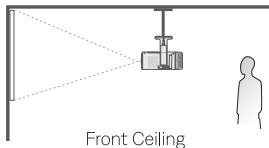
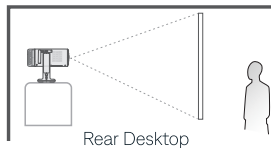
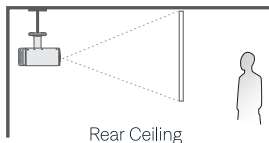
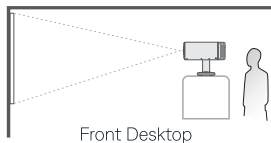

### Notes:

- \* Go to **Homepage** > **Dashboard** (⚙️) > **All settings** (⚙️) > **Projector** > **Advanced Settings** > **Projection Mode** to select the corresponding projection mode, so the images can be projected correctly.
- \* Mounting Screw: 1/4" (not included)

## 2. Power On/Off

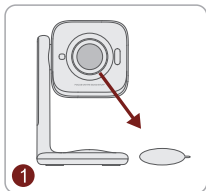

1 Take off the protective film.

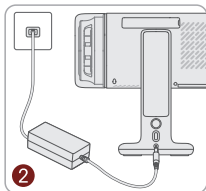

2 Connect the power adapter to an outlet.

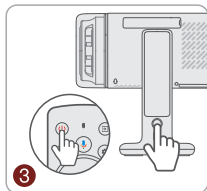



3 Press the **Power Button** to turn on the projector; press and hold the **Power Button** to turn off the projector.

### Notes:

- \* When the projector is on, press the power button once to put it into standby mode; press it again to wake it up.
- \* Please use the power adapter provided in the box to prevent product damage.

## 3. Remote Control Pairing

Turn on the projector and wait for the pairing prompt on the screen. Bring the remote control within 0.33 ft/10 cm of the projector, then simultaneously press and hold the  and  buttons. Wait for the pairing to complete.

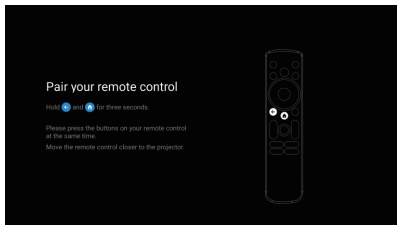

### Remote Indicator Light Status

Not paired	Single red flash after button press
Pairing	Flashing blue
Paired	Single blue flash after button press

## 4. Setup Wizard

Follow the setup wizard to choose your preferred language, select the correct region, and sign in with your Google Account or set up a basic TV.

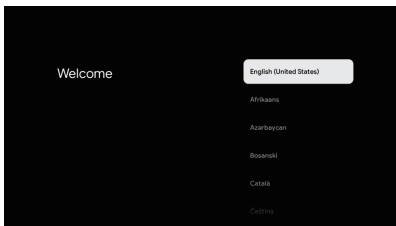

## 5. Image Adjustment

### Focus

#### 1. Auto Focus

When the projector detects shaking/rapid movement, it will automatically adjust the image quality. You can also trigger auto focus by going to **Homepage > Dashboard** ⚙️ > **All settings** ⚙️ > **Projector > Focus > Auto Focus**.

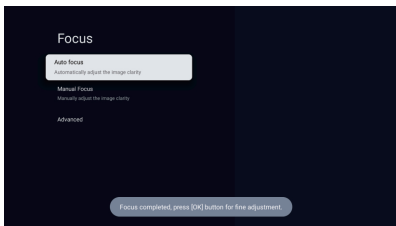

### Tip:

Go to **Homepage** > **Dashboard** (⚙️) > **All settings** (⚙️) > **Projector** > **Focus** > **Advanced**, you can enable/disable:

**Auto Focus at Startup**, allowing the projector to automatically adjust the focus upon powering on.

**Auto Focus When Moving**, allowing the projector to automatically adjust the focus when it is moved.

## 2. Electric/Manual Focus

Press the **Focus** buttons on the remote, or go to **Homepage** > **Dashboard** (⚙️) > **All settings** (⚙️) > **Projector** > **Focus** > **Manual Focus** and use the up & down buttons to sharpen the image focus until the blurry image becomes clear.

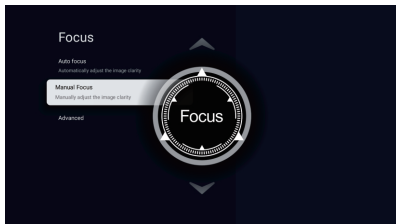

## Keystone Correction

### 1. Auto Keystone Correction

When the projector detects shaking/rapid movement, it will automatically correct the keystone distortion. You can also trigger auto keystone correction by going to **Homepage > Dashboard** ⚙️ > **All settings** ⚙️ > **Projector > Image Correction > Auto Keystone Correction**.

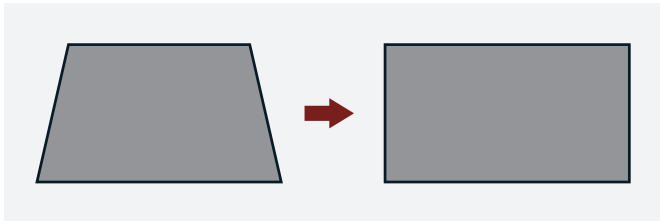

#### **Tip:**

Go to **Homepage > Dashboard** ⚙️ > **All settings** ⚙️ > **Projector > Image Correction > Advanced**, you can enable/disable:

**Auto Keystone at Startup**, allowing the projector to automatically correct the distortion upon powering on.

**Auto Keystone When Moving**, allowing the projector to automatically correct the distortion when it is moved.

### 2. Manual Keystone Correction

Go to **Homepage > Dashboard** ⚙️ > **All settings** ⚙️ > **Projector > Image Correction > Manual Keystone Correction** to manually correct the image shape by four points.

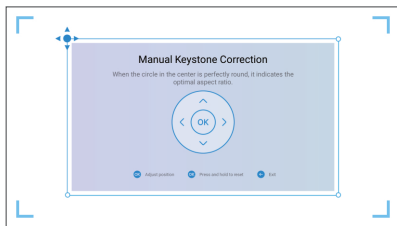

## Intelligent Screen Fit

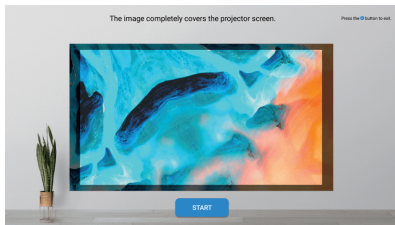

Go to **Homepage > Dashboard** ⚙️ > **All settings** ⚙️ > **Projector > Image Correction > Fit to Screen** to enable the projector to adjust the projected image to fit the screen.



### Tip:

You can go to **Homepage > Dashboard** ⚙️ > **All settings** ⚙️ > **Projector > Image Correction > Advanced > Auto Fit to Screen** to enable the projector to automatically adjust the projected image to fit the screen during correction.

## Intelligent Obstacle Avoidance

Go to **Homepage > Dashboard**  > **All settings**  > **Projector > Image Correction > Advanced > Avoid Obstacles** to enable the function. The projector will automatically adjust the projected image to avoid any objects on the projection surface.

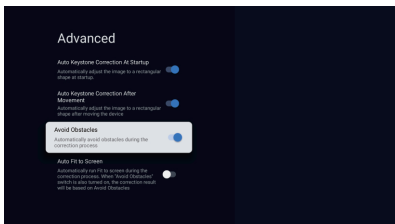

## Image Size & Position

Go to **Homepage > Dashboard**  > **All settings**  > **Projector > Image Correction > Zoom & Shift** to adjust the image size and image position.

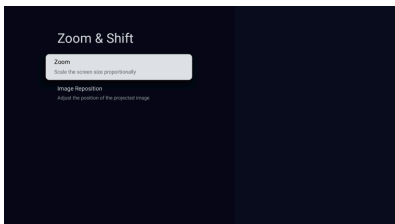

# PROJECTOR CONNECTION AND INPUT SOURCE

Connect your device to the projector correctly, then select the right input source.

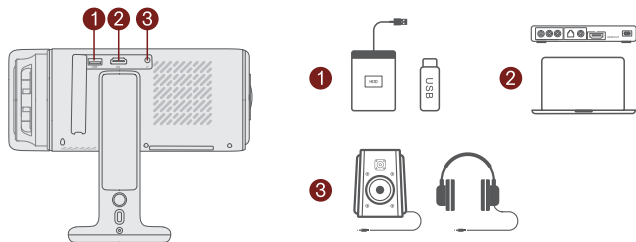

**USB Connection:** Insert the disk. Then go to **Homepage > Apps** and select **IMPlayer** under **Your apps** tab to locate and play the file.

**HD Connection:** Connect the device. Then press the **Input** button on the remote control or go to **Homepage > Dashboard** (⚙️) > **Inputs** and select **HD**.

**Wired Speaker and Headphones Connection:** Not required to select any input source.

## WIFI CONNECTION

You can connect your projector to your router's WiFi by going to **Homepage > Dashboard** (⚙️) > **All settings** (⚙️) > **Network & Internet**.

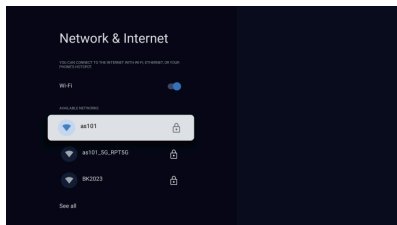

## GOOGLE ASSISTANT

Your TV is more helpful than ever. Use your voice to find movies, streaming apps, play music and control the TV. Ask Google Assistant to find a specific title, search by genre, or get personalized recommendations. Even get answers on screen, control smart home devices, and more.

Press the Google Assistant button on the remote to get started.



## GOOGLE CAST™

Google Cast is a platform that lets you stream your favorite entertainment from your phone, tablet or laptop right to your projector. Easily control your TV with apps you already know and love from your iPhone®, iPad®, Android™ phone or tablet, Mac® or Windows® laptop, or Chromebook.

To use Google Cast, please ensure you are using a Google Cast compatible app and follow the instructions below.

- ① Connect your device and the projector to the same wireless network.
- ② Open the streaming app on your device.
- ③ Play a video and tap the casting icon  on the video screen.
- ④ Select **BOOMAIR** to connect. The projector will display the video from your device.

Due to copyright restrictions, certain content cannot be cast to the projector. You can stream the content on the projector by installing same applications from the **Apps** tab.

### \* Screen Mirroring Using the Google Home App (For Android Devices)

You can mirror your entire Android device screen onto the projector screen.

- ① Ensure that you have installed the Google Home app on your device.
- ② Ensure that both your device and the projector are connected to the same wireless network.
- ③ Open the Google Home app and go to the **Devices** tab. Find and select **BOOMAIR** (or the name of your projector if you have renamed it).

- ④ On the device page, tap **Cast my screen** and confirm when prompted. Your device's screen will be mirrored on the projector screen.

### \* Screen Mirroring Using the AirScreen App

You can mirror the entire screen from your device onto the projector screen.

- ① Ensure that both your device and the projector are connected to the same wireless network.
- ② Search and install AirScreen on the Apps tab - AirPlay is available on your projector.
- ③ Open AirScreen app and follow the on-screen instructions to complete the process.

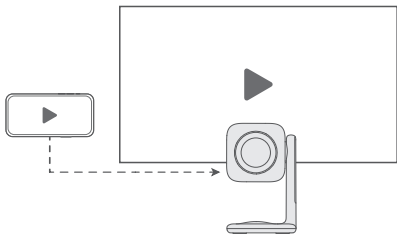

#### Tip:

Feel free to search for and install other screen mirroring apps as needed.

## BT SPEAKER MODE

You can use this projector as a BT speaker by connecting your mobile device to it through a BT connection.

#### Step 1:

Go to **Homepage > Dashboard**  **> All settings**  **> Projector > BT Speaker Mode** to make the projector ready for a BT connection.

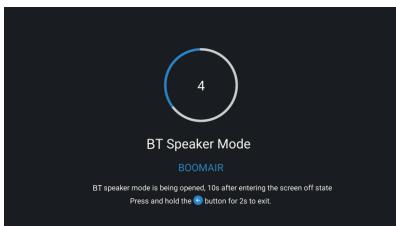

## Step 2:

Access your mobile device's BT settings and activate BT. Search for **BOOMAIR** in the available devices list to pair your mobile device with the projector.

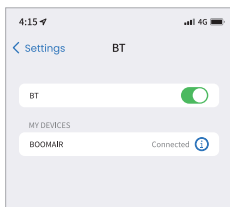

### Tip:

To exit the **BT Speaker Mode**, simply press the **Back** button on the remote control for 2 seconds.

## MORE SETTINGS

### 1. Reset

Go to **Homepage > Dashboard** ⚙️ > **All settings** ⚙️ > **System > About > Reset** to restore the projector to factory settings.

### 2. System & Product Info

Go to **Homepage > Dashboard** ⚙️ > **All settings** ⚙️ > **System > About** to check system & product information.

## PROJECTION DISTANCE AND SIZE

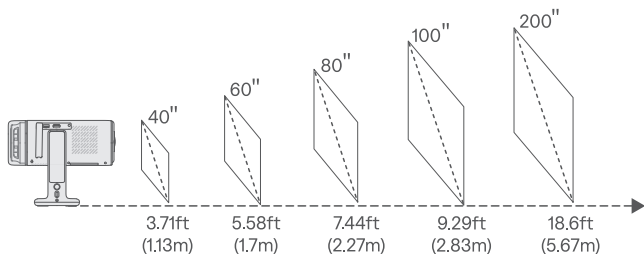

- \* For optimal image quality, we recommend a projection size of 60". Position the projector 5.58ft (1.7m) away from the wall or screen.
- \* The recommended projection distance varies with different projection contents. Please adjust the distance between the wall/screen and the projector as needed.
- \* Ambient darkness will improve the clarity of the projected images.

## SPECIFICATION

Display Technology	LCD
Resolution	Native 1920 x 1080P
Installation Type	Front/Rear/Ceiling
Focus	Auto and Electric/Manual
Unit Dimension	3.9×3.9×10.2 inches(100×100×260 mm)
Photo Format Supported	JPEG, BMP, GIF, PNG
Audio Format Supported	OGG, AAC, Mp3, FLAC, WAV

Video Format Supported	MPEG-1/2/4, H.264, H.265, VC-1, VP8, VP9
Mounting Screws	1/4"
Speaker	10W x 1
Light Source	LED
Input Signal	576i/576P/720i/720P/1080i/1080P
Aspect Ratio	4:3/16:9/Auto
Keystone	Auto and Electric/Manual
Power Supply	24.0V $\equiv$ 3.75A
Screw Number	1 (not included)
Ports	HD In x 1 / USB x 1 / Audio Out x 1

## Statement

Google TV is the name of this device's software experience and a trademark of Google LLC. Google, YouTube, Google Home, Google Cast and other marks are trademarks of Google LLC.

## Dolby Audio

Dolby, Dolby Audio, and the double-D symbol are registered trademarks of Dolby Laboratories Licensing Corporation. Manufactured under license from Dolby Laboratories.

## NETFLIX

Netflix is a trademark of Netflix, Inc.



This device complies with part 15 of the FCC Rules. Operation is subject to the following two conditions: (1) This device may not cause harmful interference, and (2) this device must accept any interference received, including interference that may cause undesired operation.

Note: This equipment has been tested and found to comply with the limits for a Class B digital device, pursuant to part 15 of the FCC rules. These limits are designed to provide reasonable protection against harmful interference in a residential installation. This equipment generates, uses and can radiate radio frequency energy and, if not installed and used in accordance with the instructions, may cause harmful interference to radio communications. However, there is no guarantee that interference will not occur in a particular installation. If this equipment does cause harmful interference to radio or television reception, which can be determined by turning the equipment off and on, the user is encouraged to try to correct the interference by one or more of the following measures:

- Reorient or relocate the receiving antenna.
- Increase the separation between the equipment and receiver.
- Connect the equipment into an outlet on a circuit different from that to which the receiver is connected.
- Consult the dealer or an experienced radio/TV technician for help.

Important: You are cautioned that changes or modifications not expressly approved by the party responsible for compliance could void the user's authority to operate the equipment.

RF Exposure Information:

- The radiated output power of this device meets the limits of FCC radio frequency exposure limits. This device should be operated with a minimum separation distance of 20cm (8 inches) between the equipment and a person's body.
- The portable device has been evaluated to meet general RF exposure requirement. It can be used in portable exposure condition without restriction.

### **Canada compliance statement /Conformité réglementaire canadienne :**

This device complies with Innovation, Science and Economic Development Canada license-exempt RSS standard(s). Operation is subject to the following two conditions: (1) this device may not cause interference, and (2) this device must accept any interference, including interference that may cause undesired operation of the device.

Operation in the band 5150–5250 MHz is only for indoor use to reduce the potential for harmful interference to co-channel mobile satellite systems.

Exposure to radio frequency energy:

- The radiated output power of this device meets the limits of IC radio frequency exposure limits. This device should be operated with a minimum separation distance of 20 cm (8 inches) between the equipment and a person's body.

- The portable device has been evaluated to meet general RF exposure requirement. It can be used in portable exposure condition without restriction.

Le présent appareil est conforme aux CNR d'Innovation, Sciences et Développement économique Canada applicables aux appareils radio exempts de licence. L'exploitation est autorisée aux deux conditions suivantes : (1) l'appareil ne doit pas produire de brouillage, et (2) l'utilisateur de l'appareil doit accepter tout brouillage radioélectrique subi, même si le brouillage est susceptible d'en compromettre le fonctionnement.

La bande 5150–5250 MHz est réservée uniquement pour une utilisation à l'intérieur afin de réduire les risques de brouillage préjudiciable aux systèmes de satellites mobiles utilisant les mêmes canaux.

L'exposition à l'énergie radiofréquence:

- La puissance de sortie rayonné de cet appareil est conforme aux limites de la IC limites d'exposition aux fréquences radio. Cet appareil doit être utilisé avec une distance minimale de séparation de 20 cm entre l'appareil et le corps d'une personne.
- L'appareil a été évalué et répond aux exigences générales d'exposition aux RF. L'appareil peut être utilisé dans des conditions d'exposition portables sans restriction.

CAN ICES (B) / NMB (B)



RECYCLING

This product bears the selective sorting symbol for Waste electrical and electronic equipment (WEEE). This means that this product must be handled pursuant to European directive 2012/19/EU in order to be recycled or dismantled to minimize its impact on the environment.

User has the choice to give his product to a competent recycling organization or to the retailer when he buys a new electrical or electronic equipment.



The symbol indicates class II equipment



The symbol indicates AC voltage



The symbol indicates DC voltage



For indoor use only



The exclamation point within an equilateral triangle is intended to alert the user to the presence of important operating and maintenance (servicing) instructions in the literature accompanying the appliance.

The mains plug is used as the disconnect device. The socket-outlet shall be installed near the equipment and shall be easily accessible.



EU Compliance Statement: Shenzhen Neutop Optoelectronics Co., Ltd, hereby declares that this device is in compliance with the essential requirements and other relevant provisions of the Directive 2014/53/EU.

The full text of the EU declaration of conformity is available at the following internet address:  
[https://aurzen.s3.us-west-1.amazonaws.com/resource/doc/Boom\\_air\\_D004\\_Neutop\\_Declaration\\_of\\_Conformity.pdf](https://aurzen.s3.us-west-1.amazonaws.com/resource/doc/Boom_air_D004_Neutop_Declaration_of_Conformity.pdf)

The below radio frequency specification only apply to EU and UK regions:

	Frequency Range	Transmit Power (EIRP)
Wi-Fi 2.4G/BT	2400-2483.5MHz	<20dBm
Wi-Fi 5G	5150-5250MHz	<23dBm
	5725-5850MHz	<14dBm

Operations in the 5.15-5.35GHz band are restricted to indoor usage only in following Countries:



AT	BE	CY	CZ	DK	EE	FL
FR	DE	EL	HU	IE	IT	LV
LT	LU	MT	NL	PL	PT	SK
SI	ES	SE	UK	BG	RO	HR



The product complies with \*RG1 IEC/EN 62471-5:2015\*.

The product label and certification information are located at the bottom of the product.

# CONTACT US

 **Email** | [support@aurzen.com](mailto:support@aurzen.com)

 **Phone** | +1-667-218-4830  
(Mon-Fri, 9:00 to 17:00 EST)

\*If you need assistance outside these hours,  
please email us for assistance.