

**Pur**  **Steam**  
World's Best Steamers

# Steam Cleaner

Multi-functional handheld steam cleaner

Model: PS-581x

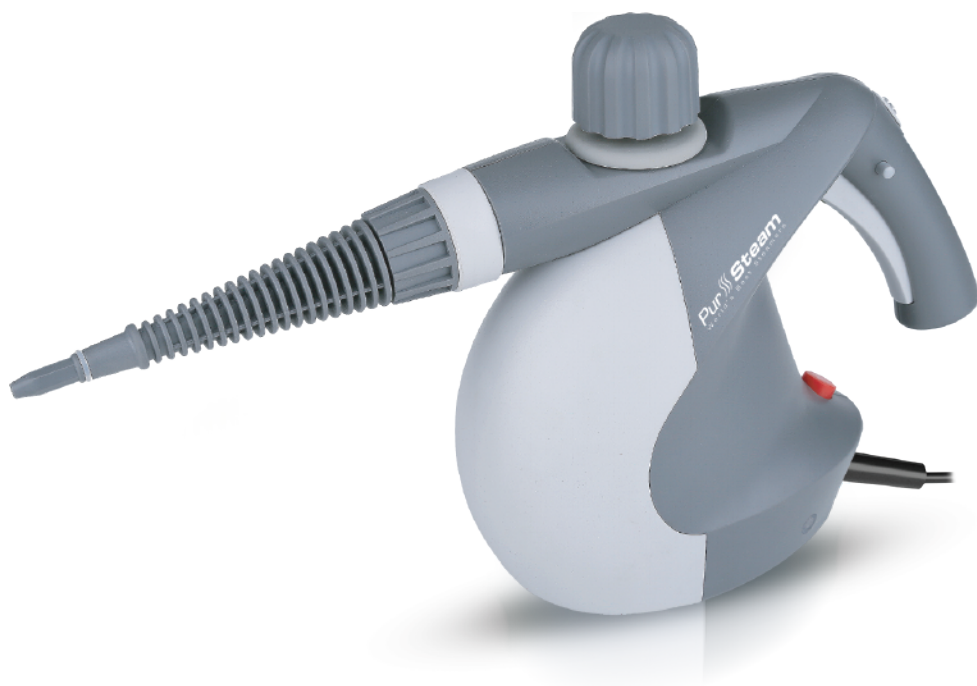

## Instruction Manual

## IMPORTANT SAFETY INSTRUCTIONS



**Before using this product, please read the instructions carefully. The manufacturer is not responsible for any damages due to any misuse.**

Do not allow to be used as a toy. Keep the appliance and its cord out of reach of children. Close attention is necessary when used by or near children. People with physical, sensory or mental capabilities or lack of knowledge and experience, must have supervision when using the appliance, and understand the hazards involved. Plastic film and packaging may present suffocation risk. Keep away from children.

Steam is very hot and can cause burns. **NEVER POINT THE NOZZLE TO YOUR FACE OR ANY PART OF YOUR SKIN. THIS CAN CAUSE SCALDING AND SERIOUS INJURIES.** Do not place hands or fingers near the steam or direct the steam at people or animals while using the unit. Keep your body at least 8 inches away from the nozzle. Do not point the steamer or apply steamer to another person or animal.

**CAUTION:** Do not immerse in water or any other liquids. To protect against electrical shock do not put steamer body in water or other liquid.

Never leave the product connected to the power source without supervision. Even when use is interrupted for a short time, or when it is left unattended, turn it off from the network, unplug the power. Unplug from outlet when not in use and before servicing. To unplug, grasp the plug at the base and pull from the outlet. Never pull from the power cord.

This product is designed for household use only. Commercial use or any use unintended by the manufacturer will void product warranty. Do not use on wet surfaces. Do not handle plug or appliance with wet hands. Do not use the product for any purpose that is not compatible with its application.

Do not use with damaged cord or plug, if appliance is not working as it should, has been dropped, damaged, left outdoors, or submerged in water. Return the damaged product to the manufacturer, its service agents, or similarly qualified persons to be replaced to avoid serious injury or harm.

Do not pull or carry this product by its cord, use cord as a handle, close a door on cord, or pull cord around sharp edges or corners. Keep cord away from heated surfaces.

Do not put any object into openings. Do not use with any opening blocked.

Do not use appliance in any spaces filled with toxic or flammable vapors, including but not limited to oil-based paints, paint thinners, flammable dust, etc.

Do not put any object into openings. Do not use with any opening blocked.

Not for space heating.

**Fill the water tank with water ONLY.** Do not add any other liquids or chemicals to the reservoir as it may damage the unit or cause injury.

Use only as described in this manual. Use only manufacturer's recommended attachments.

Make sure the steamer is **NOT plugged in before** filling the tank with water. Unplug and allow the steamer to completely cool before cleaning it.

Never operate the steam cleaner without water inside the tank. **Fill water and close the safety valve tightly, then plug into electrical outlet.** Fill at least 150 ml (5 fl oz) of water for every use. Otherwise, it will leak steam, overheat, and damage the appliance. Do not fill tank with more than 8.45 fl oz (250 ml).

**Electrical outlet voltage must correspond to that of the appliance.** Connecting to incorrect voltage may cause damage to the unit and will void your warranty.

Do not share the outlet with any other high-powered electrical appliances.

**Do not let the power cord come directly in contact** with the hot steam or pull the power cord around sharp edges. It could cause damage or possible injury.

**Always close the safety valve tightly before using,** the safety valve cannot be opened when there is pressure in the boiler. Don't open the safety valve forcibly when in use. The safety valve can be opened when there is no pressure in the boiler.

**A thermostat** within the steam cleaner is used to control the temperature of the appliance and to avoid overheating. **If you notice that temperature of the appliance keeps rising continuously, stop using the appliance** immediately and unplug it from the electrical outlet. Contact PurSteam Customer Support for maintenance.

**DO NOT attempt to steam the following objects:**

- Electrical switches
- Electrical sockets
- Any electrical appliance
- Any other objects with live electrical parts

**DO NOT attempt to clean:**

- Chemical fiber
- Synthetic fibers
- Low temperature plastic materials such as nylon, steam sensitive materials
- Leather
- Wax polished furniture or floor
- Porous surfaces

High pressure and temp of steam may cause some material to melt, damage, or deform. Please ensure the material can withstand the high temp 221°F (105°C) and pressure.

Test steamer on an inconspicuous area before first using it on any hard non-porous surface. If hard surface is affected, do not use the steamer on surface.

**When in use, DO NOT flip over the main unit. Use the steamer in a straight motion, not upside down.**

**Please do not repair the machine on your own.** If the steam cleaner, the power cord, or the plug is damaged, have a qualified appliance repair person check it before you use it.

**SAVE THESE INSTRUCTIONS**

# OVERVIEW OF PARTS

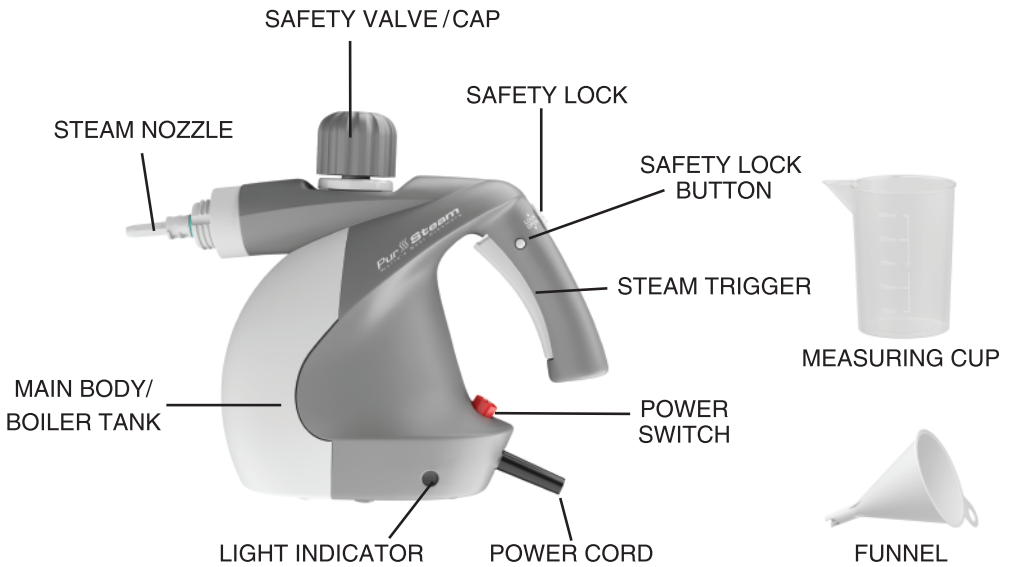

**NOTE:** Close the safety valve before using. Always use only water in the tank.

# ATTACHMENTS

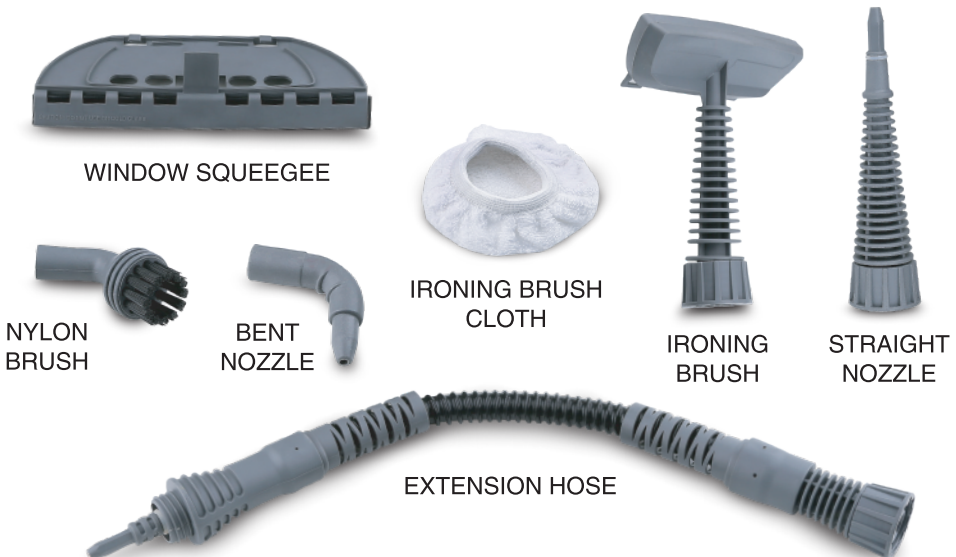

# HOW TO USE

## Prep the Steamer

- 1 Align your selected attachment (Straight Nozzle shown here) with the unit's Steam Nozzle then screw it on tightly.
- 2 While unplugged, press down the safety cap and turn it counterclockwise to open it.
- 3 Fill the boiler tank with water, using the included funnel and the measuring cup. SEE TIP BELOW.
- 4 Carefully screw the safety cap back on tightly. If not screwed on properly, steam could escape from the opening.

**TIP:** Ordinary tap water may be used.

Since water contains limestone (which may cause scaling over time) we recommend using a mixture of 50% tap water and 50% distilled water or bottled spring water.

We recommend **filling the boiler tank with around 8.45 fl oz (250 ml)** with the included cup. Do not fill tank completely or there will not be enough room in the boiler tank for the steam to build. Alternately, using only a little water, less than 5 fl oz (150 ml), will cause the unit to overheat and damage the appliance.

See Page 16 for descaling maintenance.

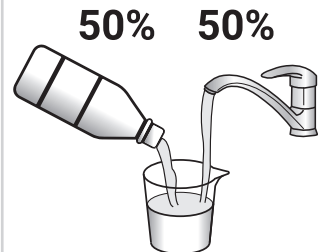
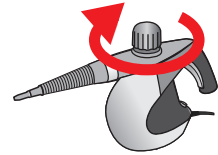
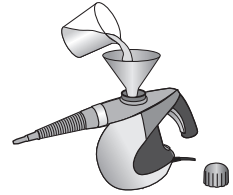
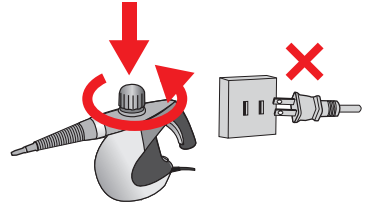
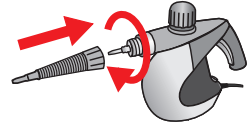

**8.45 fl oz**

- 5 To unlock the steam trigger, press and hold the safety lock button (on the side), then slide the lock downwards to the OPEN position.

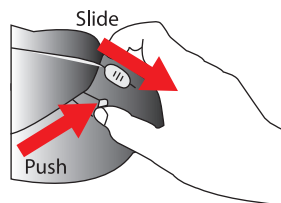

- 6 Plug the unit into a wall socket. Press the power switch to turn it on.

**CAUTION:** Always point the nozzle away from you or any other person or pets.

- 7 While heating, the indicator light will turn **RED**. When ready to use, the light will turn **GREEN**. You will see the indicator intermittently red/green during use as the temperature is maintained.

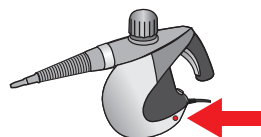
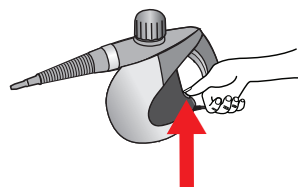

**RED** Heating      **GREEN** Ready

## Steaming

- 8 When the unit is ready, press and hold the steam trigger. Hot steam will emit from the nozzle tip.



- 9 Maintain the nozzle (or any cleaning attachment) one inch away from the surface you are cleaning.

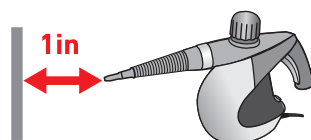

- 10 Sweep the steam across the surface material. It is normal for high temperature steam to leave a little water on the work surface. Wipe up when finished. When using a brush or other accessory, follow the detailed use instructions.

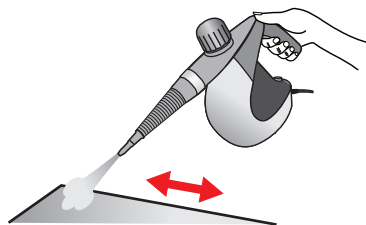

**! CAUTION:** DO NOT LEAVE STEAMER UNATTENDED, even during heating.

**NOTE:** It is normal for the unit to spurt out some water when using it for the first time, or after some time has passed since the last use.

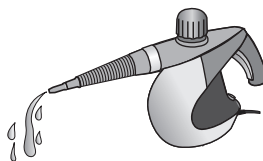

**! NOTE:** This product will not apply to all purpose cleaning jobs. If you discover steaming alone does not clean well, please try other ways.

**For areas with stubborn dirt**, such as oil and heavy scale, improve the effect of steam cleaning by preprocessing the area with special detergents and use other cleaning tools.

**For some applications**, using a tool in addition to the steam will help. For example: Gently scrape wallpaper with a tool, such as a putty knife, after pre-steaming the old wallpaper surface. Remember to keep your fingers and hands away from the hot steam as you work.

**! NOTE:** The **Safety Cap** is designed to avoid scalding and cannot be opened when there is pressure in the boiler. **DO NOT USE FORCE TO OPEN THE SAFETY CAP.** See **Page 9** for detailed information.

## Finishing: How to Release the Pressure

- 11** When finished cleaning, you will need to release the pressure before opening the safety cap to dump any remaining water. Choose one of these two methods:

### OPTION 1

Unplug the unit and wait about 5 minutes for it to cool down. This will allow the pressure to release. When the indicator light turns OFF, then move on to Step 11.

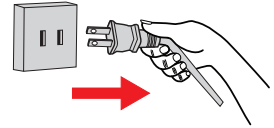

### OPTION 2

Press and hold the steam trigger to release any built-up pressure. Do this until there is no more steam coming out of the unit. Unplug the unit. Wait a few seconds, then move on to Step 11.

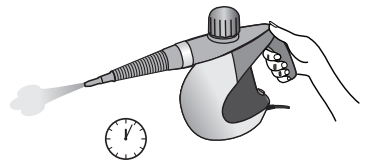

- 12** Once pressure has been released, press down the safety cap and turn it counter-clockwise to open it.

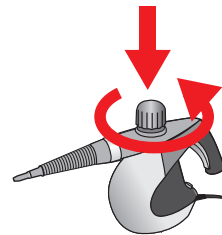

- 13** Carefully empty the water from the boiler tank by tilting the steamer.

### **DANGERS OF SCALDING WATER:**

Use caution when emptying the boiler. Water will be hot. Keep the steamer away from your body and face. To avoid risk of serious injury or harm, it is strongly recommended that you allow the steamer to cool down fully before emptying the boiler tank.

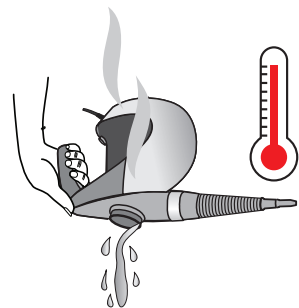

## Refilling During Use

### CONTINUOUS STEAM & INTERMITTENT STEAM

A continuous steam burst is around 20-25 seconds. When you use intermittent steam bursts, as opposed to continuous, you can use the steamer for around 5-10 minutes before refilling.

**NOTE: Always release the steam pressure inside the water tank before refilling.** See previous page for details

- 1 Unplug the unit and wait about 5 minutes for it to cool down.



- 2 Press and hold the steam trigger to release any built-up pressure. Do this until there is no more steam coming out of the unit.

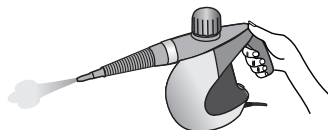

- 3 Once depressurized completely, press down the safety cap and turn it counter-clockwise to open it.

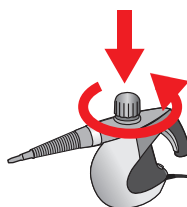

- 4 Fill the boiler tank with water, using the included funnel and the measuring cup.

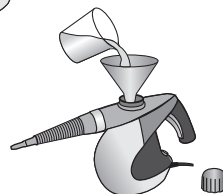

- 5 Carefully screw the safety cap back on tightly. If not screwed on properly, steam could escape from the opening.

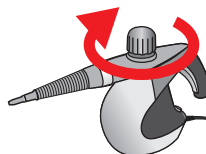

- 6 Plug in to heat the water and continue steaming.

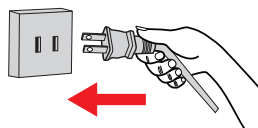

**TIP:** Always use the included cup when filling the boiler tank. It holds 8.45 fl oz (250 ml), which leaves space to hold the high-pressure steam.  
To avoid rusting during storage, please empty any remaining water inside or clean the tank after the unit cools down.

## USING THE ATTACHMENTS

**! NOTE:** Hot steam can deform or melt surfaces not intended for high temperatures and high pressure. Use care and caution in all instances. Ensure attachment is firmly secured before use.

**! WARNING:** Release pressure before removing or adjusting attachments. Keep finger away from trigger when changing attachments.

### STRAIGHT NOZZLE

#### USAGE

Clean and degrease many working surfaces, ventilation hoods, see through oven doors, ventilation grating, kitchen, some furniture, stainless steel or enamel sinks, hand-basins, bathtubs, water taps (to remove scale and water residue), doors, metal frames, car wheel rims, pet areas, etc.

#### How to Attach to Body

Align the Straight Nozzle with the unit's Steam Nozzle then screw it on tightly. You may need to apply some force to securely install it. Ensure attachment is firmly secured before use.

#### How to Attach to Extension Hose

After attaching the Extension Hose, align the Straight Nozzle to the Hose Nozzle then screw it on tightly.

#### COMPATIBILITY

- Extension Hose

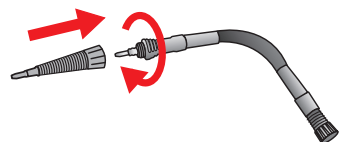
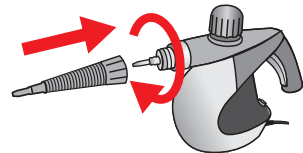

## EXTENSION HOSE

### USAGE

Perfect for hard-to-access places.

### How to Attach to Body

Align the Extension Hose with the unit's Steam Nozzle then screw it on tightly. You may need to apply some force to securely install it.

### How to Attach to Extension Hose

After attaching the Extension Hose, align the Straight Nozzle or the Ironing Brush to the Hose Nozzle then screw it on tightly.

### COMPATIBILITY

- Straight Nozzle
- Ironing Brush

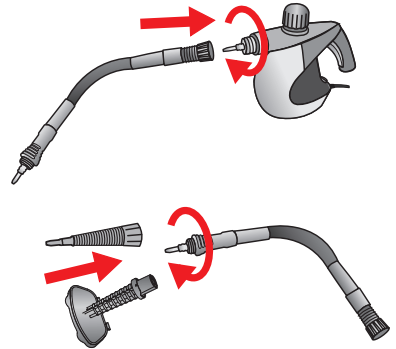

## NYLON BRUSH

### USAGE

Use to remove the dirt in grout, sinks, corners, and angles on the furniture fabric, and other surfaces where you need light scrubbing action with the hard nylon bristles.

### How to Attach to Body

First attach the Straight Nozzle per the directions on Page 10. Next, align the Nylon Brush with the Straight Nozzle. Push it in place and twist slightly to ensure it is firmly attached.

### COMPATIBILITY

- Straight Nozzle

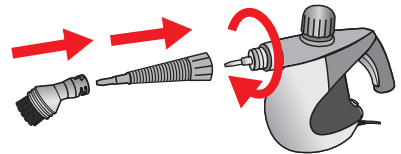

## BENT NOZZLE

### USAGE

Easily direct steam without the need to over tilt the steamer body.

Ideal for cleaning the hard-to-access areas, such as inside the toilet rim.

### How to Attach to Body

First attach the Straight Nozzle per the directions on Page 10. Next, align the Bent Nozzle with the Straight Nozzle. Push it in place and twist slightly to ensure it is firmly attached.

### COMPATIBILITY

- Straight Nozzle

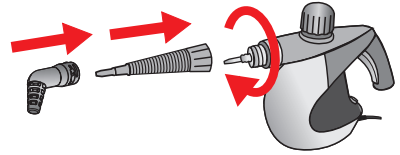

## WINDOW SQUEEGEE

### USAGE

Clean windows, mirrors, and stainless-steel surfaces. May also be effective for some flat work surfaces and sturdy glass coffee tables.

### How to Attach to Body

First attach the Ironing Brush per the directions on Page 13. Next, insert the lugs on the Window Squeegee into the hooks on the Ironing Brush. Press upwards until the central lug locks into place. You should hear a click.

### COMPATIBILITY

- Ironing Brush

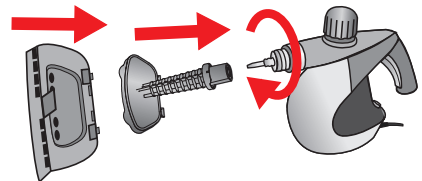

## IRONING BRUSH

### USAGE

Clean furniture, sofas, rugs, clothing, etc. Add the Ironing Brush Cloth when cleaning delicate surfaces such as sofas, armchairs, rugs, curtains, upholstery, freshening garments, and vertical steaming. High-temperature steam allows you to remove wrinkles and freshen garments.

### How to Attach to Body

Align the Ironing Brush with the unit's Steam Nozzle then screw it on until tight. You may need to apply some force to securely install it.

### How to Attach to Hose

After attaching the Extension Hose, align the Ironing Brush to the Hose Nozzle then screw it on tightly.

### COMPATIBILITY

- Extension Hose
- Ironing Brush Cloth

### TIP:

Add the Cloth after installing the Ironing Brush.

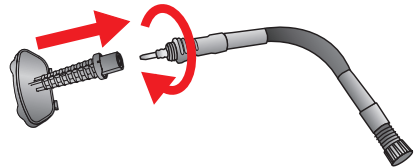
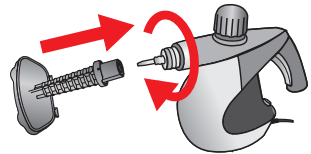

## WHERE TO USE THIS STEAMER IN YOUR HOME

### BATHROOMS

Toilets | Tile | Grout | Sinks & Drains | Faucets | Tubs & Showers  
Cabinet Hardware

### BEDROOMS

Mattresses | Wrinkled Clothes (non-delicate) | Dressers | Toys  
Plastic Bins | Shoe Organizers | Closet Doorse

### LIVING ROOMS & FAMILY ROOMS

Throw Pillows | Upholstery | Rugs & Carpet | Floors

### KITCHENS

Tile | Grout | Sinks & Drains | Furnace Ring and Cover | Trough Sinks  
Cupboards | Oven Inner Walls

### GARAGES

Garbage Cans | Outdoor Furniture | Auto Upholstery | Car Seats &  
Strollers | Washing Machines | Vents | Sanitize Reclaimed Wood

### OTHER HOUSEHOLD USES

Baseboards | Windows | Window Tracks | Curtains | Blinds | Door Knobs  
Steam Off Wallpaper

## CLEANING AND MAINTENANCE

- Wipe the surface of the appliance with a dry cloth only.
- Never immerse the appliance in water for cleaning.
- Store it in a dry and cool place.
- Always unplug the unit before cleaning.
- Detached accessories can be washed by hand with mild soap and water.

# STEAM TEMPERATURE & SCHEMATIC DIAGRAM

The steam output temperature can reach a maximum of 221°F (105°C). It will cool down after released and mixed with the surrounding air.

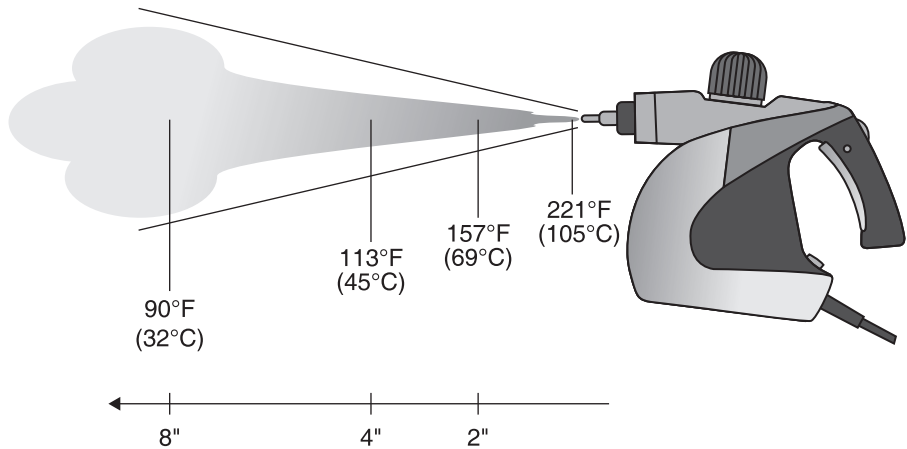

## TECHNICAL DATA

<b>Model:</b>	PS-581X	<b>Steam Temperature:</b>	221°F
<b>Voltage:</b>	AC 100–120 V	<b>Cord Length:</b>	9.8 ft
<b>Frequency:</b>	60 Hz	<b>Boiler Tank Capacity:</b>	350 ml
<b>Power:</b>	1000 W	<b>Preheat Time:</b>	~3 min
<b>Continuous Steam:</b>	20–30 s	<b>Reheat Time:</b>	45–60 s
<b>Steam Pressure:</b>	3 Bars (0.3 mPa or 43.5 psi)		

## REMOVING MINERAL BUILD-UP

To maintain maximum performance, you should descale your steamer occasionally. This is standard maintenance needed for steam appliances to remove build-up caused by high mineral content in many municipal water supplies.

### Want to minimize mineral build-up?

Use distilled or demineralized water when using your Steam Cleaner. If you cannot use demineralized or distilled water, we recommend you **follow this procedure once a month:**

1. Make sure the boiler is empty, and the unit is cooled down.  
See Page 8.
2. Add a solution of 10% white vinegar and 90% water to your steam cleaner. For example: For 4.5 oz (135 ml) of water add 0.5 oz (15 ml) of vinegar. Combined, this solution should be between 5 oz (150 ml) and 8.5 oz (250 ml).
3. Screw on the safety cap. Plug in the steam cleaner and turn it on. The red indicator light will appear.
4. As soon as the indicator light turns green, unplug the steam cleaner.
5. Allow the solution to sit for approximately 1 hour.
6. Shake the water-vinegar solution within the unit for 30 seconds.
7. Unscrew the safety cap then drain the solution into a sink or a tub.
8. Rinse the boiler with fresh water. Drain and repeat until vinegar odor dissipates.

## FCC STATEMENT

This equipment has been tested and found to comply with the limits for a Class B digital device, pursuant to part 15 of the FCC Rules. These limits are designed to provide reasonable protection against harmful interference in a residential installation. This equipment generates, uses and can radiate radio frequency energy and, if not installed and used in accordance with the instructions, may cause harmful interference to radio communications. However, there is no guarantee that interference will not occur in a particular installation. If this equipment does cause harmful interference to radio or television reception, which can be determined by turning the equipment off and on, the user is encouraged to try to correct the interference by one or more of the following measures:

- Reorient or relocate the receiving antenna.
- Increase the separation between the equipment and receiver.
- Connect the equipment into an outlet on a circuit different from that to which the receiver is connected.
- Consult the dealer or an experienced radio/TV technician for help.



### **1-Year Limited Warranty**

---

This product is warranted to be free from defects in material and workmanship under normal use and service for one year from the date of the original purchase with the receipt. The manufacturer's obligation shall be limited to repairing or replacing any part of the product that is defective. Such warranty shall not apply to damages resulting from accidents, abuse, or misuse.





🏠 350 Springfield Avenue, Suite #200,  
Summit, NJ 07901

---

✉ E-mail: [support@pursteam.us](mailto:support@pursteam.us)

---

🌐 Web: [www.pursteam.us](http://www.pursteam.us)

---