



QUICK START GUIDE

FIELDSENTINEL™ ADD-A-DOG® COLLAR

with



WELCOME

Thank you for choosing the SportDOG® Brand FieldSentinel™ Add-A-Dog® Collar. With proper use, this system will help you train your dog efficiently and safely.

The Quick Start Guide will get you and your dog started with this remote training system. For the best experience, review this guide thoroughly.

For more detailed information, we recommend visiting our online support page which provides guidance for pairing your Collar and Handheld, information on the Collar stim ranges, etc. You can easily access it by scanning the QR code provided.



To get the most protection out of your warranty and to be notified for critical updates, please register your product within 30 days at www.sportdog.com. By registering and keeping your receipt you will enjoy the product's full warranty and, should you ever need to call the Customer Care Center, we will be able to help you faster. Most importantly, your valuable information will never be given or sold to anyone. Complete warranty information is available online at www.sportdog.com.

OTHER IMPORTANT INFORMATION

Use of this product implies acceptance of any and all terms, conditions, and notices related to this product including, but not limited to, those found in this Quick Start Guide and the Insert containing important Regulatory Compliance and Safety information.

STEP 1: CHARGE YOUR COLLAR

1. Snap the charging clip on the Collar by aligning the brass contacts on the clip to the connection points on the Collar and matching up the SportDOG® logos. The Collar takes 4 hours to charge.



2. Connect the USB end on the charging cable to the wall adapter and plug into a standard wall outlet. The Collar Indicator Light will be solid green while charging and flash green when fully charged.



To power the Collar ON, press and release the power button. The Collar will beep and the Indicator Light will flash blue then green or red depending on the battery status. After several seconds, the health sensor lights will glow steady green.

To power OFF, press and hold the button until the Collar beeps and light is red.

STEP 2: FIT THE COLLAR ON YOUR DOG

PROPER FIT AND PLACEMENT OF THE COLLAR IS IMPERATIVE FOR EFFECTIVE TRAINING AND USE. THE HEALTH SENSORS AND CONTACT POINTS MUST HAVE DIRECT CONTACT WITH YOUR DOG'S SKIN.

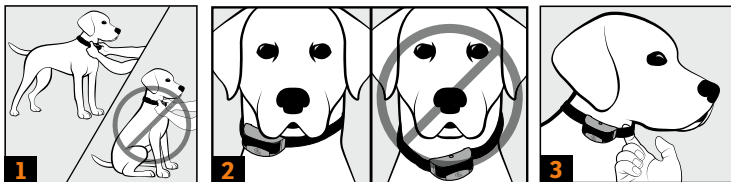

1. Your dog should be standing comfortably while fitting the collar.
2. Position the collar as high as possible on your dog's neck and slightly to either side, not directly centered. Buckle the collar so that it fits snugly.
3. You should only be able to fit one finger between the strap and your dog's neck. This will help ensure the health sensor and the contact points are both touching your dog's skin. If your dog has a long or thick coat, trim the hair around the contact points to ensure contact with the skin.

Check the fit again after your dog becomes more comfortable wearing it and adjust as necessary.

NOTE: If using an additional Collar (such as GPS), it should be located beneath this training collar.

STEP 3: HOW TO CHANGE THE HANDHELD MODE

Your FieldSentinel™ Handheld has multiple 2-Dog operational modes to allow you to select the best match for your type or style of training.

Should you choose to update your FieldSentinel Handheld mode to something other than Mode 1 in the Toggle Switch UP position, refer to the mode chart on the following page and use the below steps. Otherwise, move to STEP 4 to match both Collars to your system.

TO CHANGE THE MODE

1. Adjust both the Intensity Dial and Toggle Switch to match your desired mode from the chart on page 6.
2. Turn the Remote Transmitter over and remove the belt clip (if attached).
3. Using a pen or the tine on the buckle of your collar strap, press and release the Mode Button. When the Mode Button is pressed, the Transmitter Indicator Light will be solid in color. When it is released, it will flash a number of times that corresponds to the mode selected.



For example, if mode **6:↑** is desired, switch the toggle to the **↑** position and adjust the Intensity Dial to Level 6. Once the Mode Button has been depressed, the Transmitter Indicator Light will be solid, and once the Mode Button is released, the Handheld Indicator Light will flash 6 times.

MODE CHART: 2-DOG MODES

BUTTON FUNCTIONS

MODE	↑	↓	A	B	C	NOTES
1↑	D1	D2	T	C	M	If dial is set to V/T, buttons B & C are VIBE
2↑	D1	D2	V	C	M	If dial is set to V/T, buttons B & C are TONE
3↑	D1	D2	T	R	C	If dial is set to V/T, buttons B & C are VIBE
4↑	D1	D2	V	R	C	If dial is set to V/T, buttons B & C are TONE
5↑	D1	D2	T	R	M	If dial is set to V/T, buttons B & C are VIBE
6↑	D1	D2	V	R	M	If dial is set to V/T, buttons B & C are TONE
1↓	D1	D2	HIGH C	MEDIUM C	LOW C	If dial is set to V/T, all buttons are TONE
2↓	D1	D2	HIGH C	MEDIUM C	LOW C	If dial is set to V/T, all buttons are VIBE
3↓	D1	D2	T	C	V	If dial is set to V/T, button B is VIBE
4↓	D1	D2	V	C	T	If dial is set to V/T, button B is TONE

MODE CHART LEGEND



D1/D2 Dog 1 or Dog 2

- A** Side Button
- B** Upper Button
- C** Lower Button
- ↑** Toggle Up
- ↓** Toggle Down
- V/T** Intensity Dial set to V/T

1-7 Intensity Dial set to a number, 1-7

- C** Continuous Static Stim.
- R** Rising Static Stim.
- M** Momentary/Nick Static Stim.
- T** Tone
- V** Vibe

STEP 4: PROGRAM THE SYSTEM FOR 2-DOG OPERATION

A SportDOG® Add-A-Dog® Collar (FS-AD) must be purchased to train an additional dog with your FieldSentinel™ system.

TWO-DOG OPERATION

SportDOG Collars can be set to respond to either the ↑ or ↓ toggle position on the Remote Transmitter. Once you have a multi-dog mode selected, make sure the Toggle Switch is in the ↑ position to program the first collar using these steps:

1. Turn off the Collar Receiver.
2. Press and hold the On/Off Button on the Collar. The Indicator Light will come on, then turn off in 4-5 seconds. If the On/Off Button is released too early, the Indicator Light will begin its normal flashing. If this occurs, start over from beginning.
3. After the Indicator Light has turned off, release the On/Off Button.
4. Press and hold the Upper Button on the Handheld until the Collar Indicator Light flashes 5 times. If the Collar Indicator Light does not flash 5 times, start over from beginning.
5. To program the second Collar, repeat Steps 1 through 4, but with the toggle switch in the ↓ position.

NOTE: Should you wish to raise or lower the stim range setting on either collar, detailed instructions can be found on our support site. Scan the QR code found here.



BATTERY

This Collar operates on one Li-Ion battery pack. Only replace with battery received from the Customer Care Center.

- Batteries should never be removed from the battery compartment for charging.
- Rechargeable Lithium Ion (Li-Ion) batteries are not memory sensitive, do not require depletion before charging, and cannot be over charged.
- The battery comes partially charged from the factory, but will require a full charge before the first use.
- **When storing the unit for long periods, remember to regularly give batteries a full charge. This should be done once every 3 to 4 months.**
- You should expect hundreds of recharge cycles from your battery. However, all rechargeable batteries lose capacity over time relative to the number of recharge cycles they experience. This is normal. If your operating time drops to half of the original life, contact the Customer Care Center to purchase a new battery.
- The battery should last for a period of 3-5 years. When a battery needs replacement, you can order a new pack by contacting our Customer Care Center.

AT END OF PRODUCT LIFE, USE THESE BATTERY REMOVAL INSTRUCTIONS FOR FINAL DISPOSAL (DO NOT OPEN THE COLLAR UNTIL YOU HAVE RECEIVED THE REPLACEMENT):

- Using a 3/32 Hex Key for your Collar, remove the case screws.
- Remove the case back or cover.
- Remove the old battery pack.

These instructions are not valid for repair or battery replacement. To avoid invalidating your warranty, please contact the Customer Care Center for help in replacing your battery with one that is specifically approved by Radio Systems Corporation.

SKU number: FS-AD

Collar - FCC ID: KE3-3003444, IC: 2721A-3003444

Contains: FCC ID: QOQ-GM240S, IC: 5123A-GM240S

This equipment complies with FCC and RSS-102 radiation exposure limits set forth for an uncontrolled environment and meets the FCC and RSS-102 radio frequency (RF) Exposure Guidelines. This equipment should be installed and operated keeping the radiator at least 20 cm or more away from person's body.

Cet équipement est conforme aux limites d'exposition aux rayonnements de la FCC et RSS-102 établies pour un environnement non contrôlé et respecte les directives d'exposition aux radiofréquences (RF) de la FCC et RSS-102. Lors de l'installation ou de l'utilisation de cet équipement, tenez-vous à plus de 20 cm de distance du radiateur.

FCC

This device complies with part 15 of the FCC Rules. Operation is subject to the following two conditions: (1) This device may not cause harmful interference, and (2) this device must accept any interference received, including interference that may cause undesired operation.

NOTE: This equipment has been tested and found to comply with the limits for a Class B digital device, pursuant to part 15 of the FCC Rules. These limits are designed to provide reasonable protection against harmful interference in a residential installation. This equipment generates, uses, and can radiate radio frequency energy and, if not installed and used in accordance with the instructions, may cause harmful interference to radio communications. However, there is no guarantee that interference will not occur in a specific installation. If interference does occur to radio or television reception, which can be determined by turning the equipment off and on, the user is encouraged to try to correct the interference by one or more of the following measures:

- Reorient or relocate the receiving antenna.
- Increase the separation between the equipment and the receiver.
- Connect the equipment to an outlet on a circuit different from that to which the receiver is connected.
- Consult customer care, the dealer, or an experienced radio/TV technician for help.

CAUTION: Modification or changes to this equipment not expressly approved by Radio Systems Corporation may void the user's authority to operate the equipment.

IC

This device complies with Industry Canada licence-exempt RSS standard(s). Operation is subject to the following two conditions: (1) this device may not cause interference, and (2) this device must accept any interference, including interference that may cause the undesired operation thereof.

Le présent appareil est conforme aux CNR d'Industrie Canada applicables aux appareils radio exempts de licence. L'exploitation est autorisée aux deux conditions suivantes : (1) l'appareil ne doit pas produire de brouillage, et (2) l'utilisateur de l'appareil doit accepter tout brouillage radioélectrique subi, même si le brouillage est susceptible d'en compromettre le fonctionnement.



SUPPORT.SPORTDOG.COM

© 2023 RADIO SYSTEMS CORPORATION
Radio Systems Corporation • 10427 PetSafe Way • Knoxville, TN 37932
YU400-2556