



Activation

Turn on the wall switch and open the MiDo Link App to sync.

Smart App Pairing ("MiDo Link")

01.Download

Search for "MiDo Link" in the App Store or Google Play



02.Ensure Bluetooth is active on your smartphone

03.Register

Open the app and register or log in to your account.

04.Search for devices

Tap the "+" icon in the top right corner, select "Device", and find "OWL03 Wall light". Tap to add the device and follow the onscreen instructions to complete pairing.



05. Adding multiple devices

To add the second device, return to the "Add Device" screen, find "OWL03 Wall light 2", and tap to add it.



06. Group control

Tap the "+" icon again, select "Group", and check both added devices to synchronize them.

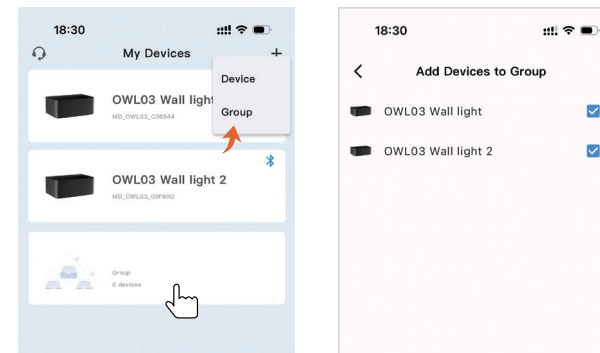

Now you can control both lights simultaneously.

Troubleshooting

1.Cannot connect to the "MiDo Link" app.

- Check if the lamp is powered on.
- Check if Bluetooth on the smartphone is enabled, or try connecting with another smartphone.
- While connecting, ensure the smartphone is near the light.
- If the connection error still exists, please delete the connected device from "My Device" on the app. Reconnect to the "MiDo Link" app by following the instructions provided previously.

2.The light doesn't sync with another device in the group.

- Ensure both devices are correctly added to the same group.
- If one light lags behind, toggling the Sync button will refresh the connection and align the colors/modes across all units.



Smart RGB Outdoor Wall Light User Manual



[English]

Important Safety Instructions Read and follow all safety instructions before starting installation:

- This product must be installed in accordance with local building laws. Consult or engage a registered and qualified electrician.
- Never take risks with electricity. Ensure the power is completely cut off and the environment is safe before starting work.
- This product is rated IP65 Waterproof. It is suitable for outdoor use but must not be immersed in water.
- The operating temperature must remain between -20°C to 45°C (-4°F to 113°F).
- Use only the control specified in these instructions. This lamp will not operate properly if connected to a standard incandescent dimmer.
- The light source is not replaceable; the entire luminaire must be replaced when the light source reaches its end of life.
- Keep the light away from children. This product is not a toy and should be used by children or the disabled only under adult supervision.

Package Contents



Wall Light



Backplate

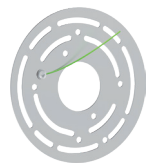

Universal Mounting Plate

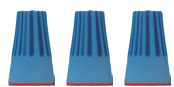

Twist-on Wire Connectors



Screws



Expansion Tubes & Screws

Installation Guide



WARNING

Turn off power at the circuit breaker before installation. Then remove the Circular Universal Mounting Plate from the Backplate by unscrewing the pre-installed screws.

Option A: Standard J-Box Installation

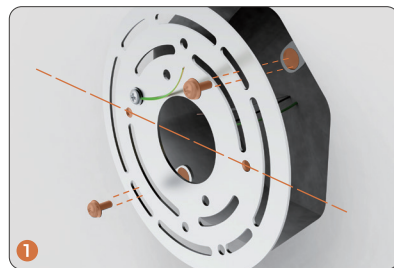

1. Secure the Circular Universal Mounting Plate to your junction box using the provided screws.

IMPORTANT: Before tightening, rotate the plate to ensure the two mounting holes (for the Backplate) are perfectly horizontal.

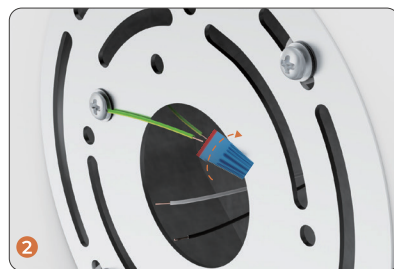

2. Connect your house ground wire (Green/Yellow) to the Ground wire on the metal mounting plate using the provided waterproof twist-on wire connector.



3. Pass the Neutral (White) and Live (Black) wires through the center hole of the Backplate.

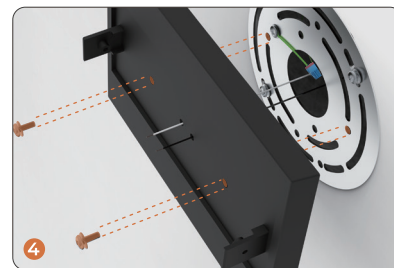

4. Align the Backplate with the Universal Plate and lock it in place with the mounting screws.

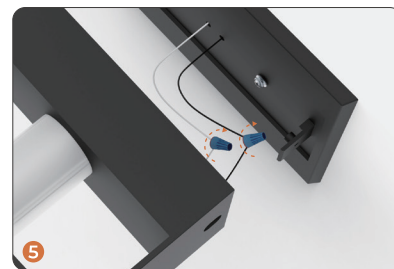

5. Connect Black to Black (Live) and White to White (Neutral). Secure each with a waterproof wire nut.

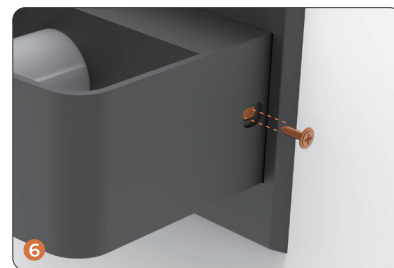

6. Fix the fixture body onto the Backplate and tighten the side screws to lock.

Option B: Direct Surface Mount

Note: This fixture features a Class II Double-Insulated Housing. The fully non-conductive plastic exterior provides maximum safety without the need for a ground wire.



1. Position the Backplate on the wall, mark the holes, and drill. Insert the provided plastic wall anchors.

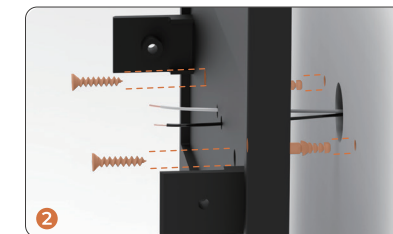

2. Pass the Neutral (White) and Live (Black) wires through the center hole. Screw the Backplate directly into the wall anchors.

Note: If a ground wire is present in your wall, secure it with the provided waterproof wire nut (twist-on connector) and tuck it back into the wall.

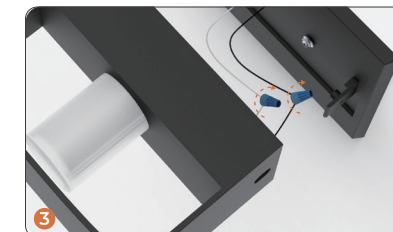

3. Connect Black to Black (Live) and White to White (Neutral) using wire nuts.

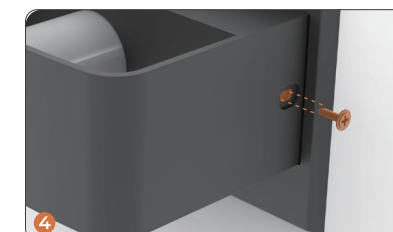

4. Fix the fixture body onto the Backplate and tighten the side screws to lock.



FCC Warning:

This equipment has been tested and found to comply with the limits for a Class B digital device, pursuant to part 15 of the FCC Rules. These limits are designed to provide reasonable protection against harmful interference in a residential installation. This equipment generates, uses and can radiate radio frequency energy and, if not installed and used in accordance with the instructions, may cause harmful interference to radio communications. However, there is no guarantee that interference will not occur in a particular installation. If this equipment does cause harmful interference to radio or television reception, which can be determined by turning the equipment off and on, the user is encouraged to try to correct the interference by one or more of the following measures:

- Reorient or relocate the receiving antenna.
- Increase the separation between the equipment and receiver.
- Connect the equipment into an outlet on a circuit different from that to which the receiver is connected.
- Consult the dealer or an experienced radio/TV technician for help.

Caution: Any changes or modifications to this device not explicitly approved by manufacturer could void your authority to operate this equipment.

This device complies with part 15 of the FCC Rules. Operation is subject to the following two conditions:

(1) This device may not cause harmful interference, and (2) this device must accept any interference received, including interference that may cause undesired operation.

This equipment complies with FCC radiation exposure limits set forth for an uncontrolled environment. This equipment should be installed and operated with minimum distance 20cm between the radiator and your body.