

Reolink

TrackFlex Floodlight WiFi

Operational Instructions

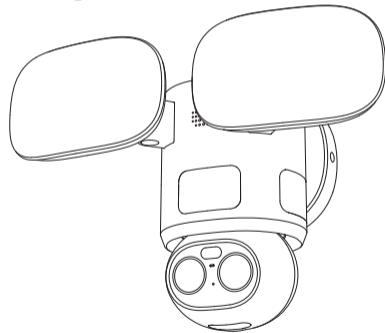

58.03.001.0848

  @ReolinkTech <https://reolink.com>

Item No. : F850W

Contents

01	What's in the Box	02
02	Camera Overview	03
03	Important Safety Instructions	05
04	Set up the Camera	07
05	Install the Camera	12
06	Troubleshooting	30
07	Specifications	31
08	Legal Disclaimer	31
09	Notification of Compliance	33

01 What's in the Box

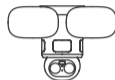

Floodlight Camera



Mounting Plate (Pre-installed)



USB-C Cable



Bag A
(Junction Box Screws)



Bag B
(Wall Screws & Anchors)



Bag C
(Bracket Screws & Hex Key)



Bag D (Wire Nuts)



Surveillance Sticker



Operational Instructions



NOTE:

The mounting plate is compatible with 4-inch junction boxes (not included).

What You Also Need *Not Included

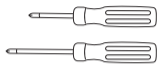

#2 Philips screwdriver



Marker

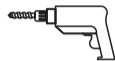

Power Drill



Ladder
(If Necessary)



5V/2A
Power Adapter

02 Camera Overview

- 1 Floodlight
- 2 Speaker
- 3 PIR Sensor
- 4 Infrared Light
- 5 Indicator Light
- 6 Microphone

- 7 Lens
 - 8 Mounting Plate (Pre-installed)
 - 9 USB-C Port
 - 10 Reset Button
 - 11 microSD Card Slot
 - 12 Silicone Plug
- * Press and hold for 10 seconds to restore.

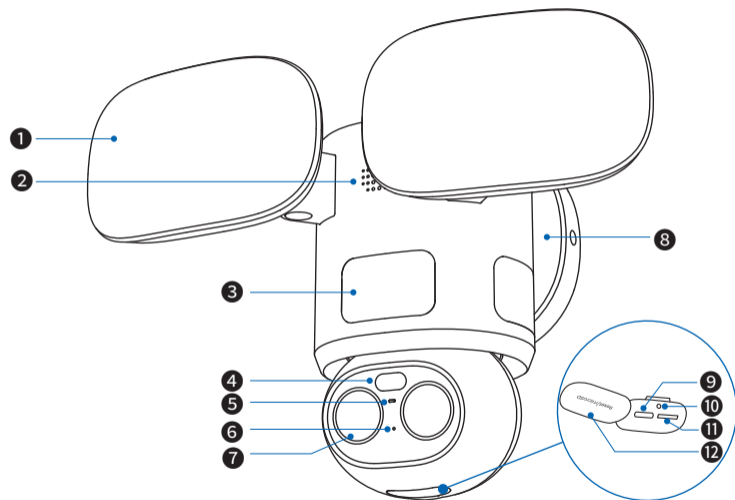

03 Important Safety Instructions

Please read the following important safety instructions carefully before use.



1. Local Legal Compliance

Adhere to your local laws and regulations for electrical installation. In regions outside of North America, installation and wiring must be performed by a licensed electrician. Be sure to follow all relevant codes and standards during camera installation.



2. Risk of Electrical Shock

Before installation, turn off the power at the breaker or fuse box. Make sure the camera is not connected to any power source. Always be careful when handling wires.



3. Fire Hazard

Avoid installing the camera near flammable materials. Do not use it in extreme temperatures or high humidity. Do not expose it to direct sunlight.



4. Installation Requirement

Ensure the floodlight camera is installed on a wall-mounted, UL-certified junction box for safety and compliance.

Precautions for Use

1. Replace only with the same or equivalent type of accessories recommended by Reolink.
2. Do not use the device in an environment that exceeds the recommended temperature range.
3. Do not use the device in an environment that exceeds the recommended humidity range.
4. Do not attempt to disassemble, repair, or alter the device by yourself.
5. Always follow the local safety laws and regulations when using the device.
6. The device contains (or comes with) small components, small plastic elements, and other small parts that may cause choking hazards. Keep the device and its accessories out of reach of children. Consult a physician immediately if small parts are swallowed.
7. The device contains (or comes with) cables or cords that may cause strangulation hazards. Keep the device and its accessories out of reach of children.
8. The light source of this luminaire is not replaceable; when the light source reaches its end of life the whole luminaire shall be replaced.
9. Terminal block not included. Installation must be performed by a qualified person.

04 Set up the Camera

Step 1. Download the Reolink App or Client

• On Smartphone



• On PC

Download the Reolink Client: Go to <https://reolink.com> > Support > App & Client.

Step 2. Power on the Camera

Power the camera using the USB-C cable and a 5V/2A power adapter (not provided).

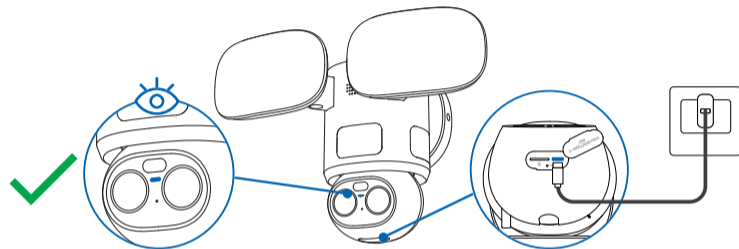

NOTE:

After powering on, the status light will turn blue and flash.

Indicator Light Status:

- Solid Blue: Power on and the network connection succeeded.
- Flashing Blue: Power on and network error.
- No Light: No power.

Step 3. Initialize the Camera

Tap the "+" button in the top corner, scan the camera's QR code, and follow the on-screen instructions to complete the setup.

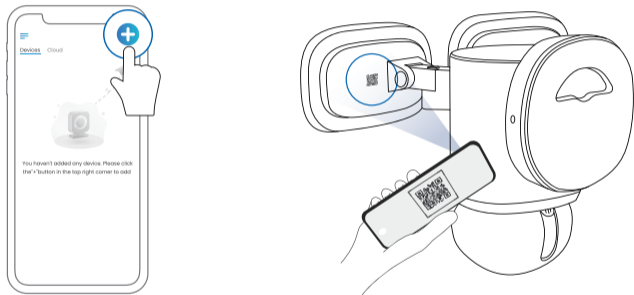

NOTE:

After the initialization, the status light will change from blinking blue to a solid blue.

Step 4. Insert the microSD Card (Optional)

Open the slot cover, insert the microSD card (not provided), and securely put the cover back on.

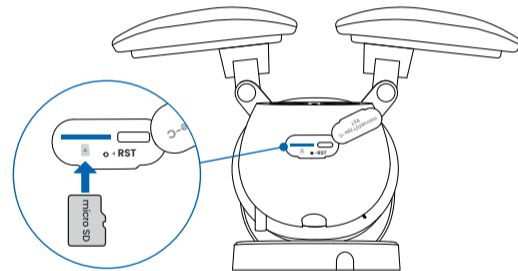

NOTE:

It is recommended to use a Class 10, 512GB micro SD card for video storage.

Step 5. Disconnect the USB-C Cable Before Installation

Disconnect the USB-C Cable, then close the USB port cover.

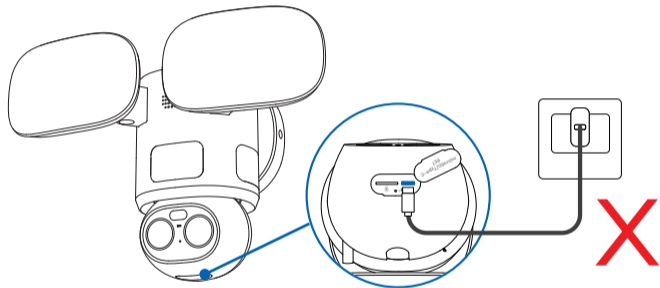

NOTE:

Always keep the USB port cover closed to prevent water ingress.

05 Install the Camera

Step 1. Turn Off the Power at the Circuit Breaker



Check local laws and regulations before installation.

Adhere to your local laws and regulations for electrical installation. In regions outside of North America, installation and wiring must be performed by a licensed electrician. Be sure to follow all relevant codes and standards during camera installation.



Risk of Electrical Shock

Before installation, turn off the power at the breaker or fuse box. Make sure the camera is not connected to any power source. Always be careful when handling wires.

- During installation, you will be handling electrical wires. If you are unsure of the location of the circuit breaker or fuse box, or how to turn off power to the floodlight circuit, it is recommended to hire a licensed electrician.
- Do not use this product with a dimmer switch or timer.
- Ensure that the power supply is between 100–240V AC, 50/60 Hz.

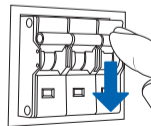

Step 2. Choose a Mounting Location

Install the camera 2–3 meters (7–10 feet)* high for optimal PIR detection performance.

**The PIR sensor detects motion within a range of 2 to 10 meters and a 270° coverage angle.*

For optimal detection, install the camera at an angle where motion moves laterally across the PIR sensor's field of view.

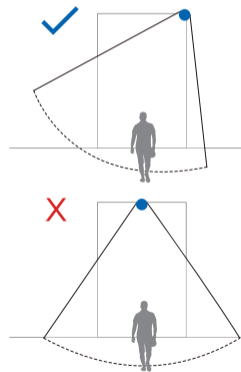
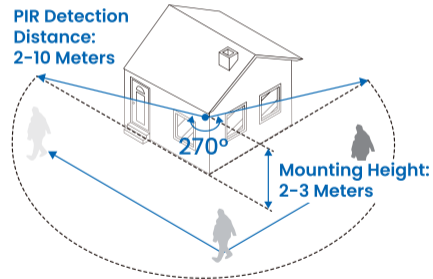

Step 3. Choose a Mounting Method

A Wall Mounting

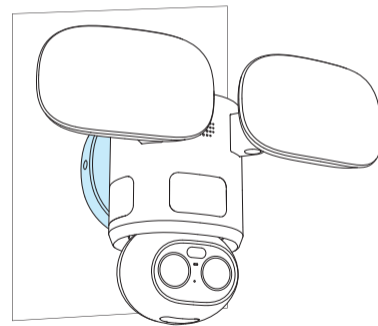

B Overhang Mounting

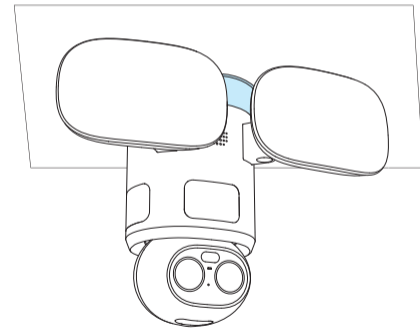

Step 4. Remove the Mounting Bracket

A Wall Mounting

Slide the bracket out from the base and remove it.

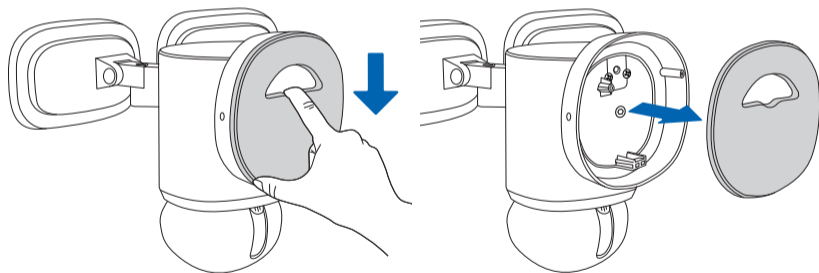

B Overhang Mounting

Slide the mounting plate out from the camera base and remove it. Then, unscrew the base using the hex key (from Bag C) and a #1 Philips screwdriver. Reinstall the base on top of the camera, and tighten it with 3 screws.

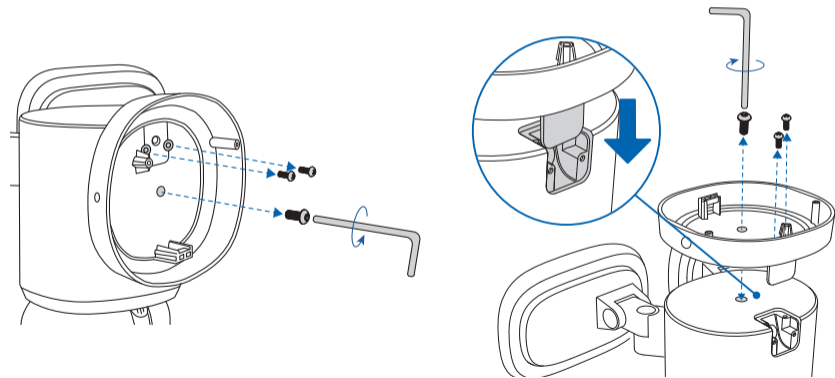

Step 5. Secure the Mounting Plate

Option 1. Install on an Existing Junction Box



A Wall Mounting

Thread the wires from the junction box through the mounting plate, then secure the plate using three screws (from Bag A). Ensure the arrow on the plate points upward and the bubble in the level is centered.

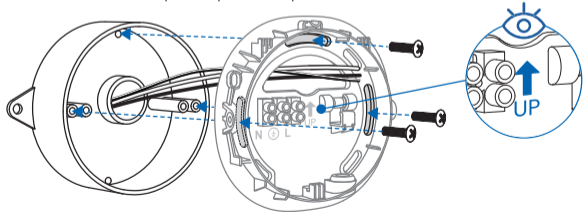

B Overhang Mounting

Thread the wires from the junction box through the mounting plate, then secure the plate using three screws (from Bag A). Ensure the arrow on the plate points toward the house (away from the monitored area).

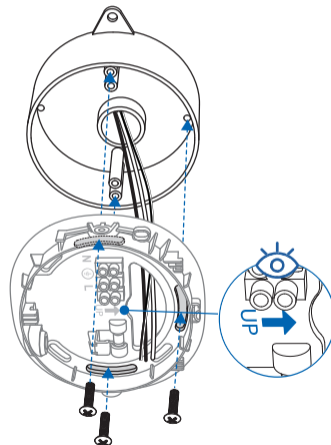

Option 2. Install Directly to a Surface

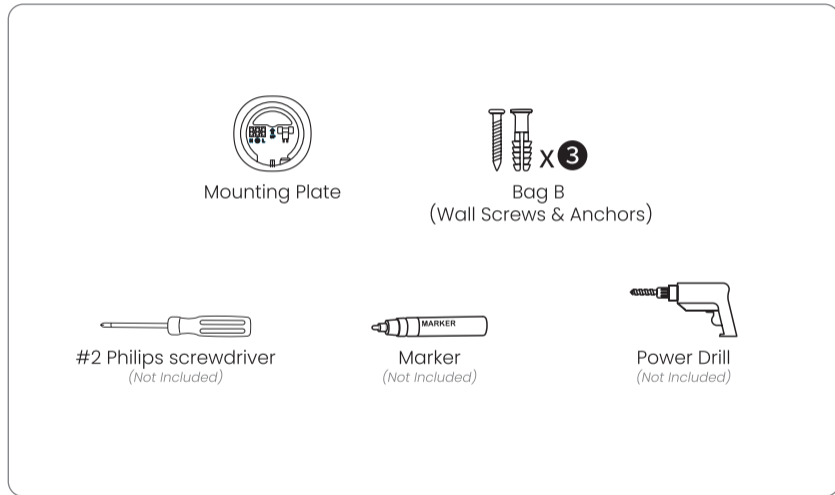

Mark and Drill Holes

A **Wall Mounting**
Place the plate on the mounting surface and mark three hole locations. Drill holes approximately 1 inch deep at the marks. Ensure the arrow on the plate points upward and the bubble in the level is centered.

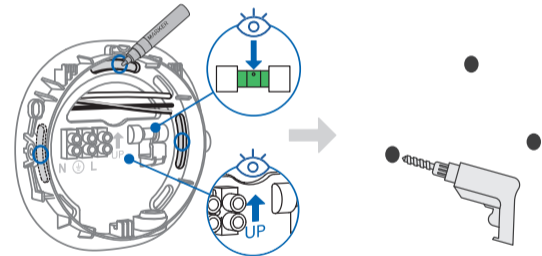

B Overhang Mounting

Place the plate on the mounting surface and mark three hole locations. Drill holes approximately 1 inch deep at the marks.

Ensure the arrow on the plate points toward the house (away from the monitored area)

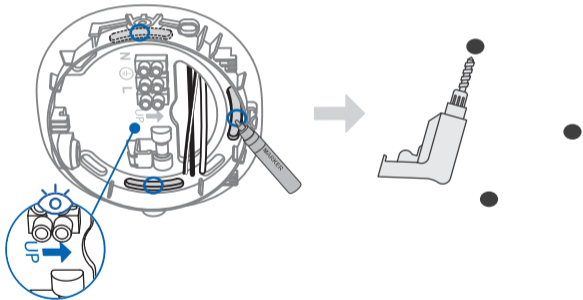

Secure the Mounting Plate

Hard Walls (e.g. Concrete, Brick, and Plaster Walls)

Insert three wall anchors from Bag B into the drilled holes. Then, secure the mounting plate to the wall with the three long screws.

Soft Walls (e.g. Wooden walls)

Secure the mounting plate to the wall using three long screws from Bag B.

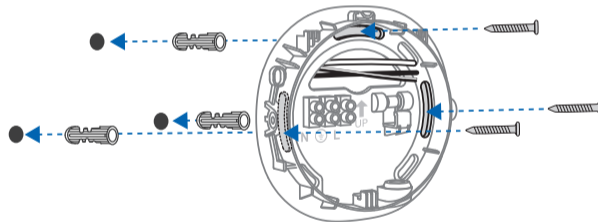

Step 6. Connect the Wires

Hang the Camera on the Mounting Plate

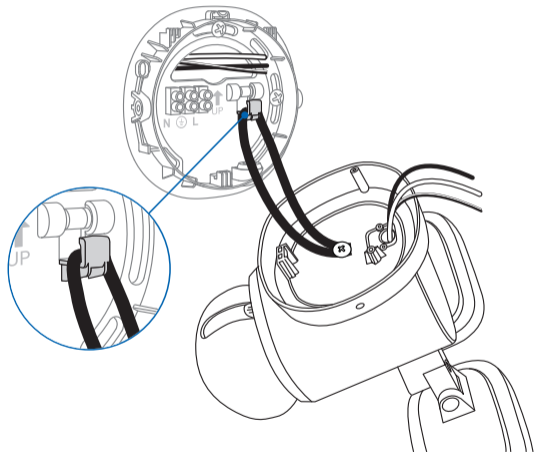



Connect the Wires

Use a #1 Philips screwdriver to secure the live (black), neutral (white), and ground (yellow-green/green) wires from the junction box or wall to the wire connector. Then, connect the camera wires to the corresponding terminals on the connector. *

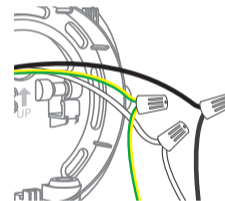
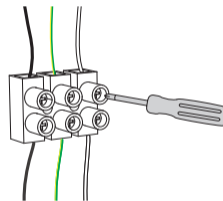
*You can also use wire nuts to connect and secure the wires. Once done, gently pull each wire to ensure a secure connection.

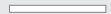

Live Wire	Neutral Wire	Ground Wire
		



Important Notice:

Avoid crossing cables. If you're unsure or can't identify the wires, consult an electrician for safety.

Step 7. Secure the Camera



Bag C
(Bracket Screws & Hex Key)

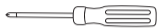

#2 Philips screwdriver
(Not Included)

Attach the Camera to the Mounting Plate.

Make sure the cable outlets on the mounting plate and the camera base are aligned.

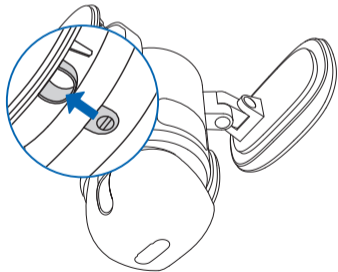

A **Wall Mounting**
Slide the camera toward the ground until it locks into the mounting plate.

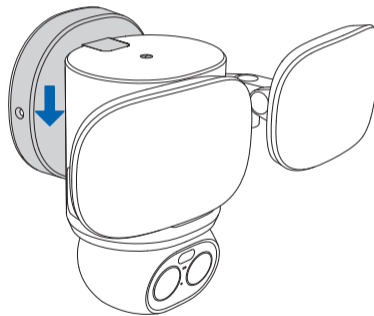

B **Overhang Mounting**
Slide the camera toward the monitoring area until it locks into the mounting plate.

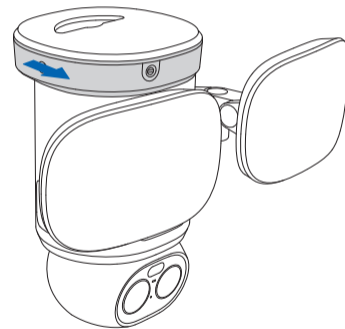

Use a #2 Philips screwdriver and two screws (from Bag C) to secure the camera to the mounting plate.

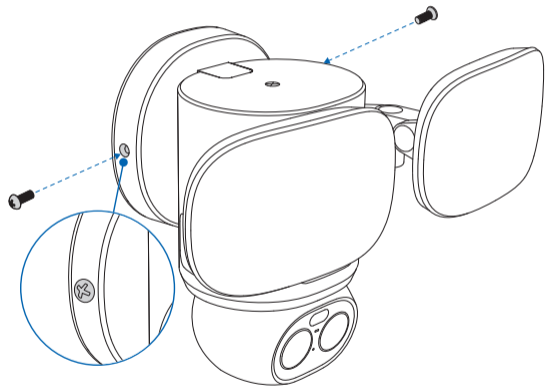

Step 8. Adjust the Floodlights

Adjust the two floodlights as needed to ensure they illuminate the monitoring area. Remove the protective films from the PIR sensors before use.

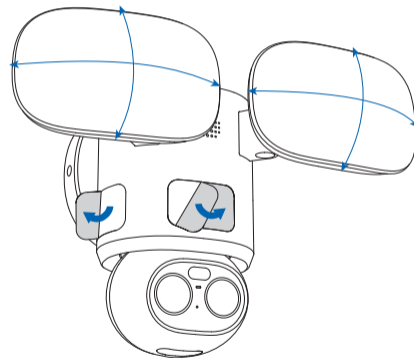

Step 9. Turn on the Circuit Breaker

Wait for the indicator light to turn solid blue, and turn on the circuit breaker.

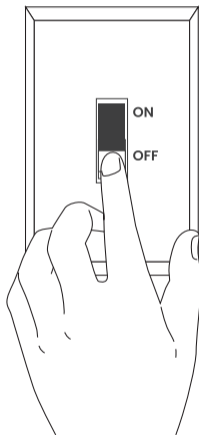

06 Troubleshooting

Wi-Fi Connection Failed During initial setup

If the camera failed to connect to Wi-Fi during setup, please try:

- Please ensure you have entered the correct Wi-Fi password.
- Put your camera close to your router to ensure a strong Wi-Fi signal.
- Change the encryption method of the WiFi network to WPA2-PSK/WPA-PSK(safer encryption)on your router interface.
- Change your Wi-Fi SSID or password and make sure that SSiD is within 31 characters and password is within 64 characters.
- Set your password using only the characters on the keyboard If these steps don't work, contact Reolink Support at <https://supportreolink.com/>.

07 Specifications

Operating Temperature: -10°C ~+55°C (14°F~131°F)

Operating Humidity: 10%~90%

Dimensions(Wall Mounting): 283*184*199 mm

Weight: 1.2 kg

For additional specifications, please visit <https://reolink.com/>.

08 Legal Disclaimer

To the maximum extent permitted by applicable law, this document and the product described, with its hardware, software, firmware, and services, are delivered on an "as-is" and "as-available" basis, with all faults and without warranty of any kind. Reolink disclaims all warranties, express or implied, including but not limited to, warranties of merchantability, satisfactory quality, fitness for a particular purpose, accuracy, and non-infringement of third-party rights. In no event will Reolink, its directors, officers,

employees, or agents be liable to you for any special, consequential, incidental or indirect damages, including but not limited to damages for loss of business profits, business interruption, or loss of data or documentation, in connection with the use of this product, even if Reolink has been advised of the possibility of such damages.

To the extent permitted by applicable law, your use of the Reolink products and services is at your sole risk and you assume all risks associated with internet access. Reolink does not take any responsibilities for abnormal operation, privacy leakage or other damages resulting from cyber attacks, hacker attacks, virus inspections, or other internet security risks. However, Reolink will provide timely technical support if required.

The laws and regulations related to this product vary by jurisdiction. Please check all relevant laws and regulations in your jurisdiction before using this product to ensure that your use conforms to the applicable law and regulation. During the use of the product, you must comply with relevant local laws and regulations. Reolink is not responsible for any illegal or improper use and its consequences. Reolink is not liable in the event that this product is used with illegitimate purposes, such as third-party rights infringement, medical treatment, safety equipment, or other situations where the product failure could lead to death or personal injury, or for weapons of mass destruction, chemical and biological weapons, nuclear explosion, and any unsafe nuclear energy uses or anti-humanity purposes. In the event of any conflicts between this manual and the applicable law, the latter prevails.

09 Notification of Compliance

FCC Statement

This device complies with Part 15 of the FCC Rules. Operation is subject to the following two conditions:

- (1) This device may not cause harmful interference, and
 - (2) This device must accept any interference received, including interference that may cause undesired operation.
- Changes or modifications not expressly approved by the party responsible for compliance could void the user's authority to operate the equipment.

This equipment has been tested and found to comply with the limits for a Class B digital device, pursuant to Part 15 of the FCC Rules. These limits are designed to provide reasonable protection against harmful interference in a residential installation. This equipment generates uses and can radiate radio frequency energy and, if not installed and used in accordance with the instructions, may cause harmful interference to radio communications. However, there is no guarantee that interference will not occur in a particular installation. If this equipment does cause harmful interference to radio or television reception, which can be determined by turning the equipment off and on, the user is encouraged to try to correct the interference by one or more of the following measures:

- Reorient or relocate the receiving antenna.
- Increase the separation between the equipment and receiver.
- Connect the equipment into an outlet on a circuit different from that to which the receiver is connected.
- Consult the dealer or an experienced radio/TV technician for help.

FCC Radiation Exposure statement

This equipment complies with FCC radiation exposure limits set forth for an uncontrolled environment. This equipment should be installed and operated with minimum distance 20cm between the radiator & your body.

ISED Statement

This device complies with Industry Canada licence-exempt RSS standard(s). Operation is subject to the following two conditions:

- (1) this device may not cause interference, and
- (2) this device must accept any interference, including interference that may cause undesired operation of the device.

This equipment should be installed and operated with a minimum distance of 20 cm between the radiator and your body.

Le présent appareil est conforme aux CNR d'Industrie Canada applicables aux appareils radio exempts de licence.

L'exploitation est autorisée aux deux conditions suivantes :

- (1) l'appareil ne doit pas produire de brouillage, et
- (2) l'utilisateur de l'appareil doit accepter tout brouillage radioélectrique subi, même si le brouillage est susceptible d'en compromettre le fonctionnement.

Cet équipement doit être installé et utilisé avec une distance minimale de 20 cm entre la source de rayonnement et votre corps.

MODIFICATION: Any changes or modifications not expressly approved by the grantee of this device could void the user's authority to operate the device.

MODIFICATION: les changements ou modifications non expressément approuvés par le fournisseur de licence de l'appareil sont susceptibles d'annuler l'autorisation accordée à l'utilisateur de se servir de l'équipement.

This Class B digital apparatus complies with Canadian ICES-003.

Cet appareil numérique de la classe B est conforme à la norme NMB-003 du Canada.

Operation of 5150-5350 MHz is restricted to indoor use only.

Le fonctionnement de 5150-5350 MHz est limité à une utilisation en intérieur uniquement.

Limited Warranty

This product comes with a 2-year limited warranty that is valid only if purchased from Reolink Official Store or a Reolink authorized reseller. Learn more: <https://reolink.com/warranty-and-return/>.

NOTE: We hope that you enjoy the new purchase. But if you are not satisfied with the product and plan to return, we strongly suggest that you reset the camera to factory default settings and take out the inserted SD card before returning.

Terms and Privacy

Use of the product is subject to your agreement to the Terms of Service and Privacy Policy at reolink.com

Technical Support

If you need any technical help, please visit our official support site and contact our support team before returning the products, <https://support.reolink.com>.

Terms of Service

By using the Product Software that is embedded on the Reolink product, you agree to the terms&conditions between you and Reolink. Learn more: <https://reolink.com/terms-conditions/>

Trademarks Acknowledgement

"Reolink" and other Reolink's trademarks and logos are the properties of Reolink. Other trademarks and logos mentioned are the properties of their respective owners.

REOLINK TECHNOLOGY PTE. LTD.
31 KAKI BUKIT ROAD 3, #06-02, TECHLINK, SINGAPORE 417818