



## USER'S MANUAL

### SMOKE & CARBON MONOXIDE ALARM

MODEL SMC100

#### IMPORTANT! PLEASE READ CAREFULLY AND SAVE.

The warnings/limitations card and manual contains important information about your Smoke Alarm's operation. If you are installing this Alarm for use by others, you must leave this manual—or a copy of it—with the end user.

Para el manual del usuario en español, por favor visitar [firstalert.com](http://firstalert.com)

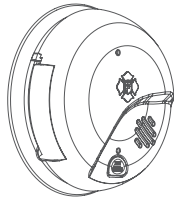

#### RECOMMENDED PLACEMENT:

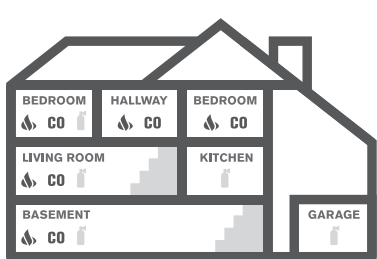

**Smoke Alarm**  
One on every level and in every bedroom

**Carbon Monoxide Alarm**  
One on every level and in every bedroom

**Fire Extinguisher**  
One on every level, plus kitchen and garage

- When installing on the wall, the top edge of Smoke Alarms should be placed between 4 inches (102 mm) and 12 inches (305 mm) from the wall/ceiling line.
- When installing on the ceiling, place the Alarm close to the center as possible.
- In either case, install at least 4 inches (102 mm) from where the wall and ceiling meet.

**NOTE:** For any location, make sure no door or other obstruction could keep carbon monoxide or smoke from reaching the Alarm.

#### WHERE NOT TO INSTALL THIS ALARM FOR BEST PERFORMANCE, IT IS RECOMMENDED YOU AVOID INSTALLING SMOKE/CO ALARMS IN THESE AREAS:

- In garages, furnace rooms, crawl spaces and unfinished attics. Avoid extremely dusty, dirty or greasy areas.
- Where combustion particles are produced. Combustion particles form when something burns. Areas to avoid include poorly ventilated kitchens, garages, and furnace rooms. Keep units at least 20 feet (6 meters) from the sources of combustion particles (stove, furnace, water heater, space heater) if possible. In areas where a 20-foot (6 meter) distance is not possible – in modular, mobile, or smaller homes, for example – it is recommended the Smoke Alarm be placed as far from these fuel-burning sources as possible. The placement recommendations are intended to keep these Alarms at a reasonable distance from a fuel-burning source, and thus reduce “unwanted” Alarms. Unwanted Alarms can occur if a Smoke Alarm is placed directly next to a fuel-burning source. Ventilate these areas as much as possible.
- Within 5 feet (1.5 meters) of any cooking appliance. In air streams near kitchens. Air currents can draw cooking smoke into the smoke sensor and cause unwanted Alarms.
- In extremely humid areas. This Alarm should be at least 10 feet (3 meters) from a shower, sauna, humidifier, vaporizer, dishwasher, laundry room, utility room, or other source of high humidity.
- In direct sunlight.
- In turbulent air, like near ceiling fans or open windows. Blowing air may prevent CO or smoke from reaching the sensors.
- In areas where temperature is colder than 40° F (4.4° C) or hotter than 100° F (37.8° C). These areas include non-airconditioned crawl spaces, unfinished attics, uninsulated or poorly insulated ceilings, porches, and garages.
- In insect infested areas. Insects can clog the openings to the sensing chamber.
- Less than 12 inches (305 mm) away from fluorescent lights. Electrical “noise” can interfere with the sensor.
- In “dead air” spaces.

#### AVOIDING DEAD AIR SPACES

“Dead air” spaces may prevent smoke from reaching the Smoke/CO Alarm. To avoid dead air spaces, follow installation recommendations below.

**On ceilings,** install Smoke/CO Alarms as close to the center of the ceiling as possible. If this is not possible, install the Smoke/CO Alarm at least 4 inches (102 mm) from the wall or corner.

**For wall mounting** (if allowed by building codes), the top edge of Smoke/CO Alarms should be placed between 4 inches (102 mm) and 12 inches (305 mm) from the wall/ceiling line.

**On a peaked, gabled, or cathedral ceiling,** install the first Smoke/CO Alarm within 3 feet (0.9 meters) of the peak of the ceiling, measured horizontally. Additional Smoke/CO Alarms may be required depending on the length, angle, etc. of the ceiling's slope. Refer to NFPA 72 for details on requirements for sloped or peaked ceilings.

#### HOW TO INSTALL THIS ALARM

This unit is designed to be mounted on the ceiling, or on the wall if necessary.

**Tools you will need:** pencil, drill with 3/16” (5 mm) drill bit, standard flathead screwdriver, hammer.

#### THE PARTS OF THIS SMOKE/CO ALARM

- A Smoke/CO LED (RED)
- B Power LED (GREEN)
- C Test/Silence button

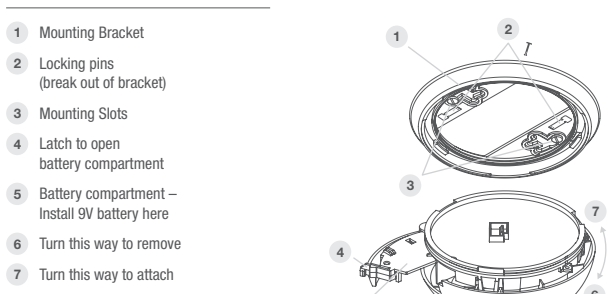

#### FOLLOW THESE SIMPLE STEPS

- Choose a location. See “Where to Install This Alarm” for references.
- WARNING! Do not install this Alarm over an existing electrical box. Only AC powered units are intended for installation over electrical boxes.**
- Hold the bracket against the ceiling or wall and make a mark inside each hole where you will drill your mounting hole. To install on the wall, ensure that the round portions of the holes are vertical. Put the Alarm where it won't get covered with dust while you drill the holes.
- Use a 3/16” (5mm) drill bit to drill through the marks you made for the mounting holes.
- Insert the plastic screw anchors (in the plastic bag with the screws) into the holes. Tap the screw anchors gently with a hammer, if necessary, until they are flush with the ceiling or wall.
- Insert the screws but do not tighten completely. Leave them about 1/8” (3mm) away from the wall.
- Activate the battery. With the battery compartment open, install the battery so the terminals on the battery match the terminals on the Smoke Alarm. Match “+” to “+” and “-” to “-”. Push the battery in until it snaps in securely and cannot be shaken loose. If the battery is not snapped in completely, the unit cannot receive battery power. The Smoke Alarm may beep briefly when you install the battery—this is normal.
- Position the base of the Smoke Alarm over the mounting bracket and turn. The Alarm can be positioned over the bracket every 60°. Turn the Smoke Alarm clockwise (right) until the unit is in place.
- Test the Smoke Alarm. See “Weekly Testing.”

Action	What You Will See & Hear
<b>Normal Operations</b>	Horn: Silent; Power LED: Flashes Green every minute; Smoke/CO LED: Off
<b>When You Test the Alarm</b>	Horn: 3 beeps, pause, 3 beeps, followed by 4 beeps, pause, 4 beeps; Power LED: Off; Smoke/CO LED: Flashes Red in sync with horn.
<b>If Battery Becomes Low or is Missing</b>	Horn: Chirps 1 time every minute; Power LED: Flashes Green 1 time every minute; Smoke/CO LED: Off
<b>If Alarm is Not Operating Properly (MALFUNCTION SIGNAL)</b>	Horn: 3 chirps every minute; Power LED: 3 Green Flashes approximately one a minute; Smoke/CO LED: Off
<b>Alarm has reached its End of Life</b>	Horn: 5 chirps every minute; Power LED: 5 Green Flashes approximately one a minute; Smoke/CO LED: Off
<b>Smoke is Detected</b>	Horn: 3 beeps, pause, 3 beeps; Power LED: Off; Smoke/CO LED: Flashes Red in sync with the horn pattern.
<b>Smoke Alarm is Silenced</b>	Horn: Off (for up to 15 minutes); Power LED: Off; Smoke/CO LED: Flashes Red
<b>Alarm Levels of CO are Detected</b>	Horn: 4 fast beeps, pause, 4 fast beeps; Power LED: Off; Smoke/CO LED: Flashes Red in sync with the horn pattern.
<b>CO Alarm is Silenced</b>	Horn: Off (for up to 6 minutes); Power LED: Off; Smoke/CO LED: Flashes Red
<b>CO is Detected in Another Interconnected Alarm</b>	Horn: 4 fast beeps, pause, 4 fast beeps; Power LED: Off; Smoke LED: Off

## 03 INSTALLATION

#### WHERE TO INSTALL THIS ALARM

Minimum coverage for Smoke Alarms, as recommended by the National Fire Protection Association (NFPA), is one Smoke Alarm on every floor, in every sleeping area, and in every bedroom. (See “Regulatory Information for Smoke Alarms” for details on the NFPA recommendations).

For CO Alarms, the National Fire Protection Association (NFPA) recommends that a CO Alarm should be centrally located outside of each separate sleeping area in the immediate vicinity of the bedrooms. For added protection, install additional CO Alarms in each separate bedroom, and on every level of your home.

**NOTE:** For added protection, install an additional Smoke/CO Alarm at least 15 feet (4.6 meters) away from the furnace or fuel burning heat source where possible. In smaller homes or in manufactured homes where this distance cannot be maintained, install the Alarm as far away as possible from the furnace or other fuel burning source. Installing the Alarm closer than 15 feet (4.6 meters) will not harm the Alarm, but may increase the frequency of unwanted Alarms.

#### IN GENERAL, INSTALL COMBINATION SMOKE AND CARBON MONOXIDE ALARMS:

- On every level of your home, including finished attics and basements.
- Inside every bedroom, especially if people sleep with the door partly or completely closed.
- In the hall near every sleeping area. If your home has multiple sleeping areas, install a unit in each.
- If a hall is more than 40 feet (12 meters) long, install a unit at each end.
- At the top of first-to-second floor stairs.
- At the bottom of the basement stairs.
- For additional coverage, install Alarms in all rooms, halls, and storage areas, where temperatures normally remain between 40° F and 100° F (4.4° C and 37.8° C).

## 04 ALARM FEATURES

- Easy Installation:** Add protection in minutes

#### LOCKING FEATURES

The optional locking features are designed to discourage unauthorized removal of the battery or Alarm. It is not necessary to activate the locks in single-family households where unauthorized battery or Alarm removal is not a concern.

**These Smoke/CO Alarms have two separate locking features:** one locks the battery compartment, and the other locks the Smoke/CO Alarm to the mounting bracket. You can choose to use either feature independently, or use them both.

**Tools you will need:** Needle-nose pliers or utility knife, standard flathead screwdriver

Both locking features use locking pins, which are molded into the mounting bracket. Using needle nose pliers or a utility knife, remove one or both pins from the mounting bracket, depending on how many locking features you want to use.

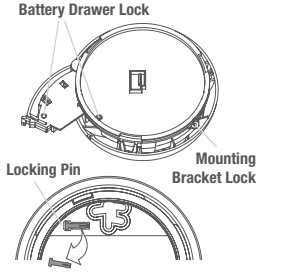

#### DO NOT LOCK THE BATTERY COMPARTMENT UNTIL YOU HAVE INSTALLED THE BATTERY AND TESTED THE BATTERY BACK-UP.

Unit will not Alarm when you press the Test/Silence button.

- Push and release the Test/Silence button on the Smoke/CO Alarm until the Alarm sounds: 3 beeps, pause, 3 beeps, pause, 4 beeps, pause.

**IMPORTANT!** If the unit does not Alarm during testing, DO NOT lock the battery compartment! Install a new battery and test again. If the Alarm still does not Alarm, replace it immediately.

- Using needle-nose pliers or a utility knife, detach one locking pin from the mounting bracket.
- Push the locking pin through the black dot on the label on the back of the Smoke/CO Alarm.

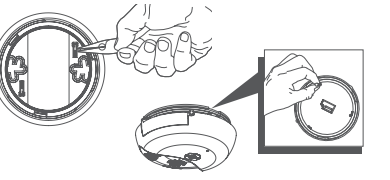

#### TO UNLOCK THE BATTERY COMPARTMENT

Once the Alarm is installed, you must disconnect it from the AC power before unlocking the battery compartment.

**▲ DANGER! ELECTRICAL SHOCK HAZARD.** Turn off the power to the area where the Alarm is installed before removing it from the mounting bracket. Failure to turn off the power first may result in serious electrical shock, injury or death.

- Remove the Alarm from the mounting bracket. If the unit is locked to the bracket, see the section “To Unlock the Mounting Bracket.”

- Disconnect the power connector by gently prying it away from the back of the Alarm.

- Insert a flathead screwdriver under the head of the locking pin, and gently pry it out of the battery compartment lock. (If you plan to relock the battery compartment, save the locking pin.)



- To relock the battery compartment, close the battery door and reinsert locking pin in lock.

- Reconnect the power connector to the back of the Alarm, reattach the Smoke Alarm to the mounting bracket, and restore the power.

**IMPORTANT!** When replacing the batteries, always test the Alarm before relocking the battery compartment.

#### TO LOCK THE MOUNTING BRACKET

- Using needle-nose pliers, detach one locking pin from mounting bracket.



- Insert the locking pin into the Cut the Alarm from the battery drawer as shown in the diagram.



- When you attach the Alarm to the mounting bracket, the locking pin's head will fit into a notch on the bracket.

#### TO UNLOCK THE MOUNTING BRACKET

- Insert a flathead screwdriver between the mounting bracket pin and the mounting bracket.

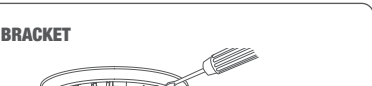

- Pry the Alarm away from the bracket by turning both the screwdriver and the Alarm counterclockwise (left) at the same time.



## 05 TESTING & MAINTENANCE

#### WEEKLY TESTING

- WARNING!** NEVER use an open flame of any kind to test this unit. You might accidentally damage or set fire to the unit or to your home. NEVER use vehicle exhaust! Exhaust may cause permanent damage and voids your warranty.
- DO NOT** stand close to the Alarm when the horn is sounding. Exposure at close range may be harmful to your hearing. When testing, step away when horn starts sounding.

**▲ CAUTION!** It is important to test this unit every week to make sure it is working properly. Using the test button is the recommended way to test this Smoke/CO Alarm.

- Push and release the Test/Silence button on the cover until you hear a “chirp.” The “chirp” marks the start of the self-test sequence.
- During testing, you will hear a loud, repeating horn pattern: 3 beeps, pause, 3 beeps, pause, while the red smoke LED flashes. Then you will hear a loud, repeating horn pattern: 4 beeps, pause, 4 beeps, pause, while the red CO LED flashes.
- When testing a series of interconnected units you must test each unit individually. Make sure all units Alarm when each one is tested.

**If the Smoke/CO Alarm does not test properly:**

- Make sure the AC power is applied and battery is fresh and installed correctly.
- Be sure the Alarm is clean and dust-free.
- Test the unit again.

If the Smoke/CO Alarm is still not working properly, replace it immediately. Refer to the “Limited Warranty” at the end of this manual.

**▲ WARNING!** If there is still a problem, do not try to fix the Alarm yourself. This will void your warranty!

#### REGULAR MAINTENANCE

**▲ WARNING!** Use only the replacement batteries listed below. The unit may not operate properly with other batteries. Never use rechargeable batteries since they will not provide a constant charge.

This unit has been designed to be as maintenance-free as possible, but there are a few simple things you must do to keep it working properly:

- Test it at least once a week.
- Clean the Smoke/CO Alarm at least once a month; gently vacuum the outside of the Smoke/CO Alarm using your household vacuum's soft brush attachment. Test the Smoke/CO Alarm. Never use water, cleaners or solvents since they may damage the unit.
- If the Smoke/CO Alarm becomes contaminated by excessive dirt, dust and/or grime, and cannot be cleaned to avoid unwanted Alarms, replace the unit immediately.
- If the green power LED flashes 2 times every minute (horn is silent) it means that the Alarm needs to be cleaned as indicated above. If green LED continues to flash, please call Consumer Support.
- Cover your nose and mouth with a cloth (preferably damp). Take short, shallow breaths.
- Meet at your planned meeting place outside your home, and do a head count to make sure everybody got out safely.
- Call the Fire Department as soon as possible from outside. Give your address, then your name.
- Never go back inside a burning building for any reason.
- Contact your Fire Department for ideas on making your home safer.

**▲ WARNING!** DO NOT spray cleaning chemicals or insect sprays directly on or near the Alarm. DO NOT paint over the Alarm. Doing so may permanently damage the Alarm.

#### CHOOSING A REPLACEMENT BATTERY:

This Smoke/CO Alarm requires one standard 9V alkaline battery. The following alkaline batteries are acceptable as replacements: Duracell® #141004, Eveready® #K1604, Eveready® “Energizer” 522. These batteries are available at many local retail stores.

- ▲ WARNING!** Always use the exact batteries specified by this User's Manual. DO NOT use rechargeable batteries. Clean the battery contacts and also those of the device prior to battery installation. Install batteries correctly with regard to polarity (+ and -).
- Please dispose of or recycle used batteries properly, following any local regulations. Consult your local waste management authority or recycling organization to find an electronics recycling facility in your area. **DO NOT DISPOSE OF BATTERIES IN FIRE. BATTERIES MAY EXPLODE OR LEAK.**

- ▲ WARNING!** Keep battery out of reach of children. In the event a battery is swallowed, immediately contact your poison control center, your physician, or the National Battery Ingestion Hotline at 202-625-3333 as serious injury may occur.

**IMPORTANT!** Actual battery service life depends on the Alarm and the environment in which it is installed. All the batteries specified above are acceptable replacement batteries for this unit. Regardless of the manufacturer's suggested battery life, you MUST replace the battery immediately once the unit starts “chirping” (the “low battery warning”).

TROUBLESHOOTING GUIDE		
IF THE ALARM...	PROBLEM...	YOU SHOULD...
Green Power LED is Off. Unit will not Alarm when you press the Test/Silence button.	Battery may be dead or missing.	Replace Battery*
Horn “chirps” and Green Power LED flashes once every minute.	Battery is low or missing.	Replace Battery*
Horn “chirps” and Green Power LED flashes 3 times every minute.	<b>MALFUNCTION SIGNAL.</b> Device is not working properly, and needs to be replaced.	If unit is under warranty, contact Consumer Support to process a warranty replacement.
Horn “chirps” and Green Power LED flashes 5 times every minute.	<b>END OF LIFE SIGNAL.</b> Alarm needs to be replaced.	Immediately replace the Alarm.
Alarm goes back into Alarm 4 minutes after you silence it.	Smoke and/or CO levels are still potentially dangerous.	Refer to “If Your Smoke/CO Alarm Sounds” for details on how to respond to an Alarm. If anyone is feeling ill, EVACUATE your home immediately and call 911.
Power LED flashes Green 2 times every minute.	Alarm requires cleaning.	Clean Alarm then press and release the test button. See “Regular Maintenance” section. If Green LED continues to flash, contact Consumer Support.
<b>CARBON MONOXIDE ALARM ONLY</b>		
CO Alarm goes back into Alarm 4 minutes after you silence it.	CO levels indicate a potentially dangerous situation.	Relocate your Alarm. If frequent Alarms continue, have home rechecked for potential CO problems. You may be experiencing an intermittent CO problem.
CO Alarm sounds frequently even though no high levels of CO are revealed in an investigation.	The CO Alarm may be improperly located. Refer to “Where to Install This Alarm” for details.	
<b>SMOKE ALARM ONLY</b>		
Smoke Alarm sounds when no smoke is visible.	Unwanted Alarm may be caused by noncooking smoke.	Silence Alarm using manual button; clean the Alarm's cover with a soft, clean cloth. If frequent unwanted Alarms continue, relocate your Alarm. Alarm may be too close to a kitchen, cooking appliance, or steamy bathroom.
*For a list of acceptable replacement batteries, see “Regular Maintenance.”		
If you have questions that cannot be answered by reading this manual, call the Consumer Support Team at 1-800-323-9005.		

#### FIRE SAFETY TIPS

Follow safety rules and prevent hazardous situations: 1) Use smoking materials properly. Never smoke in bed. 2) Keep matches or lighters away from children; 3) Store flammable materials in proper containers; 4) Keep electrical appliances in good condition and don't overload electrical circuits; 5) Keep stoves, barbecue grills, fireplaces and chimneys grease- and debris-free; 6) Never leave anything cooking on the stove unattended; 7) Keep portable heaters and open flames, like candles, away from flammable materials; 8) Don't let rubbish accumulate. Keep Alarms clean, and test them weekly. Replace Alarms immediately if they are not working properly. Smoke Alarms that do not work cannot alert you to a fire. Keep at least one working fire extinguisher on every level, and an additional one in the kitchen. Have fire escape ladders or other reliable means of escape from an upper level in case stairs are blocked; 9) Have an escape plan and practice it regularly.

## 06 IF YOUR SMOKE/CO ALARM SOUNDS

#### WHAT TO DO FIRST: IDENTIFY THE TYPE OF ALARM SIGNAL

Refer to previous section “What You Will See And Hear With This Alarm”.

- ▲ WARNING!** Activation of your CO Alarm indicates the presence of carbon monoxide (CO) which can kill you. In other words, when you CO Alarm sounds, you must not ignore it!

**IF THE CO ALARM SIGNAL SOUNDS:**

- Press the Test/Silence button.
- Call your emergency services, fire department or 911. Write down the number of your local emergency service here:

- Immediately move to fresh air—outdoors or by an open door or window. Do a head count to check that all persons are accounted for. Do not re-enter the premises, or move away from the open door or window until the emergency services responder has arrived, the premises have been aired out, and your CO Alarm returns to its normal condition.

- After following steps 1-3, if your CO Alarm reactivates within a 24-hour period, repeat steps 1-3 and call a qualified appliance technician to investigate for sources of CO from fuel-burning equipment and appliances, and inspect for proper operation of this equipment. If problems are identified during this inspection have the equipment serviced immediately. Note any combustion equipment not inspected by the technician, and consult the manufacturers' instructions, or contact the manufacturers directly, for more information about CO safety and this equipment. Make sure that motor vehicles are not, and have not, been operating in an attached garage or adjacent to the residence. Write down the number of a qualified appliance technician here:

**NOTE:** A qualified appliance technician is defined as “a person, firm, corporation, or company that either in person or through a representative, is engaged in and responsible for the installation, testing, servicing, or replacement of heating, ventilation, air conditioning (HVAC) equipment, combustion appliances and equipment, and/or gas fireplaces or other dedicated combustion equipment.”

**IF THE SMOKE/CO ALARM SOUNDS: RESPONDING TO AN ALARM**

- ▲ WARNING!** If the unit Alarms and you are not testing the unit, it is warning you of a potentially dangerous situation that requires your immediate attention. NEVER ignore any Alarm. Ignoring the Alarm may result in injury or death.

- Never remove the batteries from a battery operated Smoke/CO Alarm to stop an unwanted Alarm (caused by cooking smoke, etc.). Removing batteries disables the Alarm so it cannot sense smoke, and removes your protection. Instead open a window or fan the smoke away from the unit. The Alarm will reset automatically.
- If the unit Alarms get everyone out of the house immediately.

#### WHAT TO DO IN CASE OF FIRE

- Don't panic; stay calm. Follow your family escape plan.
- Get out of the house as quickly as possible. Don't stop to get dressed or collect anything.
- Feel doors with the back of your hand before opening them. If a door is cool, open it slowly. Don't open a hot door. Keep doors and windows closed, unless you must escape through them.
- Cover your nose and mouth with a cloth (preferably damp). Take short, shallow breaths.
- Meet at your planned meeting place outside your home, and do a head count to make sure everybody got out safely.
- Call the Fire Department as soon as possible from outside. Give your address, then your name.
- Never go back inside a burning building for any reason.
- Contact your Fire Department for ideas on making your home safer.

**▲ WARNING!** Alarms have various limitations. See “General Limitations of Smoke/CO Alarms” for details.

## 07 USING THE SILENCE FEATURES

**▲ WARNING!** The Silence Feature does not disable the unit—it makes it temporarily less sensitive to smoke. For your safety, if smoke alarms the unit to sense danger it suggests a potentially dangerous situation. The unit will still Alarm or may re-Alarm quickly, if you do not know the source of the smoke, do not assume it is an unwanted Alarm. Not responding to an Alarm can result in property loss, injury, or death. If the unit will not silence and no heavy smoke is present, or if it stays in silence mode continuously, it should be replaced immediately.

**Never remove the batteries to quiet an unwanted Alarm. Removing the batteries disables the Alarm and removes your protection.**

- The Silence Feature is intended to temporarily silence the horn while you identify and correct the problem. Do not use the Silence Feature in emergency situations. It will not correct a CO problem or extinguish a fire.
- The Silence Feature can temporarily quiet an unwanted Alarm for several minutes. You can silence this Smoke/CO Alarm by pressing the Test/Silence button on the Alarm cover.

**Activate the Alarm Test, reset or silence function by use of a finger or thumb. Use of any other instrument is strictly prohibited.**

When the Smoke Alarm is Silenced	When the CO Alarm is Silenced
The Smoke Alarm will remain silent for up to 15 minutes, then returns to normal operation.	The CO Alarm will remain silent for up to 6 minutes.
If the smoke has not cleared—or continues to increase—the device will go back into Alarm.	After 6 minutes, if CO levels remain potentially dangerous the horn will start sounding again.

#### SILENCING THE LOW BATTERY WARNING

This Silence Feature can temporarily quiet the Low Battery Warning “chirp”. Press the Test/Silence button on the Alarm. The Green light flashes normally, once every minute, during Low Battery Warning silence. After time, the low battery “chirp” will resume. Replace the battery immediately.

#### SILENCING THE END OF LIFE SIGNAL

This Silence Feature can temporarily quiet the End of Life warning “chirp” for up to 2 days. You can silence the End of Life warning “chirp” by pressing the Test/Silence button. The horn will chirp, acknowledging that the End of Life Silence Feature has been activated.

After approximately 2 days, the End of Life “chirp” will resume. The timer shall not be able to reset after 14 days following the initial end-of-life signal.

## 08 WHAT YOU NEED TO KNOW ABOUT CO

#### WHAT IS CO?

CO is an invisible, odorless, tasteless gas produced when fossil fuels do not burn completely, or are exposed to heat (usually fire). Electrical appliances typically do not produce CO.

**These fuels include:** Wood, coal, charcoal, oil, natural gas, gasoline, kerosene, and propane.

Common appliances are often sources of CO. If they are not properly maintained, are improperly ventilated, or malfunction, CO levels can rise quickly. CO is a real danger now that homes are more energy efficient. “Air-tight” homes with added insulation, sealed windows, and other weatherproofing can “trap” CO inside.

#### SYMPTOMS OF CO POISONING

These symptoms are related to CO POISONING and should be discussed with ALL household members.

**Mild Exposure:** Slight headache, nausea, vomiting, fatigue (“flu-like” symptoms).

**Moderate Exposure:** Throbbing headache, drowsiness, confusion, fast heart rate.

**Extreme Exposure:** Convulsions, unconsciousness, heart and lung failure. Exposure to carbon monoxide can cause brain damage, death.

**IMPORTANT!** This CO Alarm measures exposure to CO over time. It alarms if CO levels are extremely high in a short period of time, or if CO levels reach a certain minimum over a long period of time. The CO Alarm generally sounds because of the onset of symptoms in average, healthy adults. Why is this important? Because you need to be warned of a potential CO problem while you can still react in time. In many reported cases of CO exposure, victims may be aware that they are not feeling well, but become disoriented and can no longer react well enough to exit the building or get help. Also, young children and pets may be the first affected. The average healthy adult might not feel any symptoms when the CO Alarm sounds. However, people with cardiac or respiratory problems, infants, unborn babies, pregnant mothers, or elderly people can be more quickly and severely affected by CO. If you experience even mild symptoms of CO poisoning, consult your doctor immediately!

**FINDING THE SOURCE OF CO AFTER AN ALARM**  
Carbon monoxide is an odorless, invisible gas, which often makes it difficult to locate the source of CO after an Alarm. These are a few of the factors that can make it difficult to locate sources of CO:

- House well ventil

## 14 GENERAL LIMITATIONS OF SMOKE/CO ALARMS

This Smoke/CO Alarm is intended for residential use. This product is intended for use in ordinary indoor locations of family living units. It is not designed to measure CO levels in compliance with Occupational Safety and Health Administration (OSHA) commercial or industrial standards. Individuals with medical conditions that may make them more sensitive to carbon monoxide may consider using warning devices which provide audible and visual signals for carbon monoxide concentrations under 30 ppm. For additional information on carbon monoxide and your medical condition contact your physician.

**Smoke/CO Alarms may not waken all individuals.** Practice the escape plan at least twice a year, making sure that everyone is involved – from kids to grandparents. Allow children to master fire escape planning and practice before holding a fire drill at night when they are sleeping. If children or others do not readily waken to the sound of the Smoke/CO Alarm, or if there are infants or family members with mobility limitations, make sure that someone is assigned to assist them in fire drill and in the event of an emergency. It is recommended that you hold a fire drill while family members are sleeping in order to determine their response to the sound of the Smoke/CO Alarm while sleeping and to determine whether they may need assistance in the event of an emergency.

**Smoke/CO Alarms cannot work without power.** Battery operated units cannot work if the batteries are missing, disconnected or dead, if the wrong type of batteries are used, or if the batteries are not installed correctly. AC units cannot work if the AC power is cut off for any reason (open fuse or circuit breaker, failure along a power line or at a power station, electrical fire that burns the electrical wires, etc.). If you are concerned about the limitations of battery or AC power, install both types of units.

**This Smoke/CO Alarm will not sense smoke or CO that does not reach the sensors.** It will only sense smoke or CO at the sensor. Smoke or CO may be present in other areas. Doors or other obstructions may affect the rate at which CO or smoke reaches the sensors. If bedroom doors are usually closed at night, we recommend you install an Alarm device (Combination CO and Smoke Alarm, or separate CO Alarms and Smoke Alarms) in each bedroom and in the hallway between them.

**This Smoke/CO Alarm may not sense smoke or CO on another level of the home.** Example: This Alarm device, installed on the second floor, may not sense smoke or CO in the basement. For this reason, one Alarm device may not give adequate early warning. Recommended minimum protection is one Alarm device in every sleeping area, every bedroom, and on every level of your home. Some experts recommend battery powered smoke and CO Alarms be used in conjunction with interconnected AC powered Smoke Alarms. For details, see "About Smoke Alarms" for details.

**Smoke/CO Alarms may not be heard.** The Alarm horn loudness meets or exceeds current UL standards of 85 dB at 10 feet (3 meters). However, if the Smoke/CO Alarm is installed outside the bedroom, it may not wake up a sound sleeper or one who has recently used drugs or has been drinking alcoholic beverages. This is especially true if the door is closed or only partly open. Even persons who are awake may not hear the Alarm horn if the sound is blocked by distance or closed doors. Noise from traffic, stereo, radio, television, air conditioner, or other appliances may also prevent alert persons from hearing the Alarm horn. This Smoke/CO Alarm is not intended for people who are hearing impaired.

**The Alarm may not have time to Alarm before the fire itself causes damage, injury, or death, since smoke from some fires may not reach the unit immediately.** Examples of this include persons smoking in bed, children playing with matches, when a person's clothing catches fire while cooking, fires caused by violent explosions resulting from escaping gas, or incendiary fires where the fire grows so rapidly that an occupant's egress is blocked even with properly located Smoke Alarms.

**This Smoke/CO Alarm is not a substitute for life insurance.** Though this Smoke/CO Alarm warns against increasing CO levels or the presence of smoke, First Alert does not warrant or imply in any way that they will protect lives. Homeowners and renters must still insure their lives.

**This Smoke/CO Alarm has a limited life.** Although this Smoke/CO Alarm and all of its parts have passed many stringent tests and are designed to be as reliable as possible, any of these parts could fail at any time. Therefore, you must test this device weekly. The unit should be replaced immediately if it is not operating properly.

**This Smoke/CO Alarm is not foolproof.** Like all other electronic devices, this Smoke/CO Alarm has limitations. It can only detect smoke or CO that reaches the sensors. It may not give early warning of the source of smoke or CO is in a remote part of the home, away from the Alarm device.

## 15 LIMITED WARRANTY

First Alert® warrants that for a period of ten years from the date of purchase, this product will be free from defects in material and workmanship. First Alert, at its option, will repair or replace this product or any component of the product found to be defective during the warranty period. Replacement will be made with a new or remanufactured product or component. If the product is no longer available, replacement may be made with a similar product of equal or greater value. This is your exclusive warranty.

This warranty is valid for the original retail purchaser from the date of initial retail purchase and is not transferable. Keep the original sales receipt. Proof of purchase is required to obtain warranty performance. First Alert dealers, service centers, or retail stores selling First Alert products do not have the right to alter, modify or any way change the terms and conditions of this warranty.

This warranty does not cover normal wear or damage resulting from any of the following: negligent use or misuse of the product, use on improper voltage or current, use contrary to the operating instructions, disassembly, repair or alteration by anyone other than First Alert or an authorized service center. Further, the warranty does not cover Acts of God, such as fire, flood, hurricanes and tornadoes or any batteries that are included with this unit.

First Alert shall not be liable for any incidental or consequential damages caused by the breach of any express or implied warranty. Except to the extent prohibited by applicable law, any implied warranty of merchantability or fitness for a particular purpose is limited in duration to the duration of the above warranty. Some states, provinces or jurisdictions do not allow the exclusion or limitation of incidental or consequential damages or limitations on how long an implied warranty lasts, so the above limitations or exclusion may not apply to you. This warranty gives you specific legal rights, and you may also have other rights that vary from state to state or province to province.

### HOW TO OBTAIN WARRANTY SERVICE

**Service:** If service is required, do not return the product to your retailer. In order to obtain warranty service, contact the Consumer Support Team at 1-800-323-9005. To assist us in serving you, please have the model number and date of purchase available when calling.

**Battery:** First Alert makes no warranty, express or implied, written or oral, including that of merchantability or fitness for any particular purpose with respect to battery.

**Disposal:** Please follow local guidelines regarding the disposal or recycling of batteries and/or electronics.

<b>For your records, please record:</b>
<b>Date Purchased:</b> _____
<b>Where Purchased:</b> _____
<b>Date Installed:</b> _____ / _____ <b>Month/Year</b>
<b>Replace Alarm 10 years after installation.</b>
<b>Please write the date in the space provided:</b> _____ / _____ <b>Month/Year</b>

The Alarm will also provide an audible End-of-Life Signal approximately 10 years after installation to remind you to replace the unit.

The End-of-Life Signal can be silenced for up to 2 days. Do not unplug or deactivate the Alarm until you get replacement.

Printed in Mexico | M08-178313 04/23

CONFORMS TO UL STD 217 AND UL STD 2034

firstalert.com



© 2023 Resideo Technologies, Inc. All rights reserved. These products are manufactured by Resideo Technologies, Inc. and its affiliates. 3901 Liberty Street, Aurora, IL 60504-8122. Consumer Support Team: (800) 323-9005 | firstalert.com

