

*请注意本页无需打印, 仅用于版本更新的说明

产品名称(型号)	S2 PRO MAX直式电动螺丝刀套装说明书
材质	105g铜版纸
尺寸	55x550mm
印刷	单黑
装订方式	胶贴方式
制图人	林嘉华
版本时间	2026/04/08
最新版本名称	Fanttik 直式电动螺丝刀套装S2 PRO MAX-英文说明书-V1-20260408
变更版本	REV1.0 在V12版本的基础上修改, 仅保留英文 REV2.0 P9加. P10 加. REV3.0 更新产品图片 REV4.0 更新转速、充电时间参数 REV5.0 更新重量, 尺寸参数
备注	

Fanttik

NEX S2 Pro Max

Cordless Screwdriver

User Manual

Please read this instruction manual carefully before use and keep it for future reference.



Contents

1. Safety Warnings	02
2. Package Contents	03
3. Product Overview	04
4. Operation and Functions	06
5. Specifications	11
6. Warranty	13

1. Safety Warnings

- Avoid moisture, dust, and drop.
- Do not store the product in extreme temperature environment.
- Stay alert, watch what you are doing and use common sense when operating. Do not operate while you are tired or under the influence of drugs, alcohol or medication.
- This product is not a toy and should not be used by kids under 10 years old.
- This product has built-in battery, do not throw it into fire and should be recycled by local laws and regulations.
- Do not dismantle the machine by yourself. Have your power tool serviced by a qualified repair person or contact us for advice.

2. Package Contents

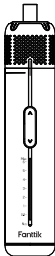

NEX S2 Pro Max
screwdriver x 1

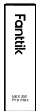

Aluminum
Housing x 1



Storage Box x 1



2-inch bit x 16



User Manual x 1



90° angle
adapter x 1

3. Product Overview

Product Storage

1. Protective Lid
2. Cordless Screwdriver
3. Storage Box
4. Screwdriver Bits
5. Aluminum Housing
6. 90° angle adapter

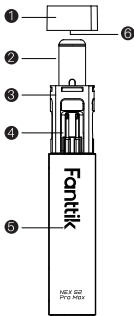

Electric Screwdriver

- 1.Bit Chuck
- 2.LED Light
- 3.Torque Setting Knob
- 4.Forward/Reverse Rotation Button
- 5.Energy Bar
- 6.Battery Indicator
- 7.Type-C Charging Port

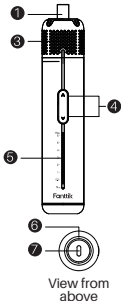

View from below



View from above

4. Operation and Functions

How to take/store the screwdriver

- When the storage box pressed, the screwdriver and storage box are ejected simultaneously from the aluminum housing.

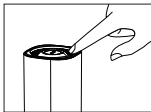

- Insert the screwdriver and storage box into the aluminum housing and press down to lock.



Storage of screwdriver bits

- The 16 bits are attached in bit holder on the storage box and are attracted by magnet. Please put bits back in place after use to avoid losing.

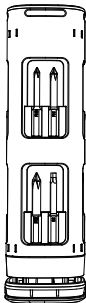

Torque settings

- Rotate the Torque Setting Knob to select from 7 torque levels : 0.5, 1.0, 2.0, 3.0, 4.0, 5.0, 6.0 Nm.



Tighten or loosen screws

- Press the Forward/Reverse Rotation Button on the screwdriver to tighten or loosen a screw.



Energy bar

- When adjusting the torque setting, the length of the Energy Bar changes accordingly. Higher torque levels result in a longer Energy Bar.
- When the Forward/Reverse Rotation Button is pressed, the Energy Bar displays a flowing effect accordingly.



Turn on/off the LED light

- The LED light automatically turns on when the Forward/Reverse Rotation Button is pressed. The LED light remains on for 10seconds after the button is released.



Power indicator

- When the battery level drops below 20% during use, the indicator blinks red rapidly.
- During charging, the indicator blinks green slowly.
- When the battery is fully charged, the indicator turns solid green.



Power Indicator

Battery charging

- This screwdriver is equipped with a universal Type-C charging port. A charger is not included; please use a 5V charger for charging.



Type-C Port

- The screwdriver supports a maximum charging input of 10W(5V/2A) .

Use 90° Angle Adapter

- Insert the 90° angle adapter into the screwdriver chuck. Then attach a bit to the chuck at the end of the 90° angle adapter.



Manual operation

- This screwdriver can be used manually regardless of the torque setting on the knob. Use it manually if a screw is too tight to loosen or if you need to tighten a screw beyond the motor's capability.
- A slight rotational play (about half a turn) is normal; after that, the gearbox will lock in place.
- Note that the screwdriver supports a maximum manual driving torque of 8 N-m(70.8 in-lb); exceeding this limit may damage the transmission gear box.

5. Specifications

Product Name	Cordless Screwdriver
Product Model	NEX S2 Pro Max
Product Dimension	66.2×66.2×240mm
Screwdriver Dimension	Ø37×183.5mm
Weight (bare unit)	940g
Torque Control	0.5/1.0/2.0/3.0/4.0/5.0/6.0 Nm
Max. hard torque	6.0 Nm
Max. manual torque	8.0 Nm
Rotation Speed(unloaded)	250±10%RPM
Battery Capacity	2000mAh / 7.4Wh
Rated Voltage	3.7V
Charging Input	5V/2A
Charging Time	60-90 minutes

Bit specifications

Bit Shank: 1/4-inch hex shank

Bit Length: 2 inch

Bit Material: Coated S2 Steel

Bit Types

 PH0 PH1 PH2

 H3 H4 H5 H6

 TR10 TR15 TR20 TR25

 S1 S2

 SL3 SL4 SL5

6. Warranty

This product is covered by a **12-month** limited warranty for manufacturing defects.

[Service hotline available in the U.S. and Canada only]

929-693-6066 MON-FRI 9AM-5PM[ET]

www.fanttik.com

support@fanttik.com

Manufacturer/Hersteller: METASEE LLC

Address/Adresse: 12 GREENWAY PLZ
STE 1161A HOUSTON, TX 77046-1203

Made in China

CAN ICES(B)/NMB(B)

RoHS     