

SwitchBot Outdoor Pan/Tilt Cam 3K

User Manual

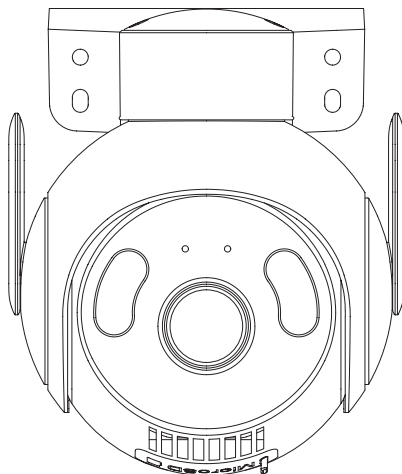

Scannen Sie den QR-Code, um die deutsche Version unseres Benutzerhandbuchs zu erhalten.

Scannez le code QR pour obtenir notre manuel d'utilisation en version française.

Escanee el código QR para obtener la versión en español de nuestro manual de usuario.

Scan de QR code voor de Nederlandse versie van onze gebruikershandleiding.

Scansionate il codice QR per ottenere la versione italiana del nostro manuale d'uso.

Zeskanuj kod QR, aby pobrać instrukcję obsługi w języku polskim.
<https://www.switch-bot.com/pages/switchbot-user-manual>



User Manual

Package Contents

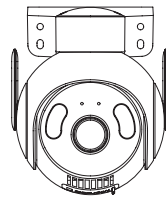

Outdoor Pan/Tilt Cam 3K × 1

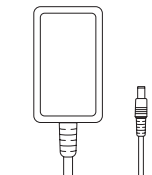

12V/2A DC Power Adapter × 1

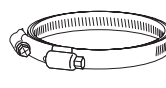

Clamp (Φ 200 mm / 7.9 in.) × 2

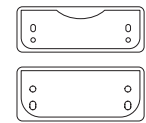

Hole Marking Sticker × 2

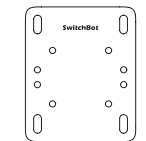

Pole Mount Bracket × 1

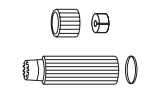

Waterproof Seal Set × 1



Waterproof Cap × 1



Screw Pack A × 1



Screw Pack B × 1

List of Components

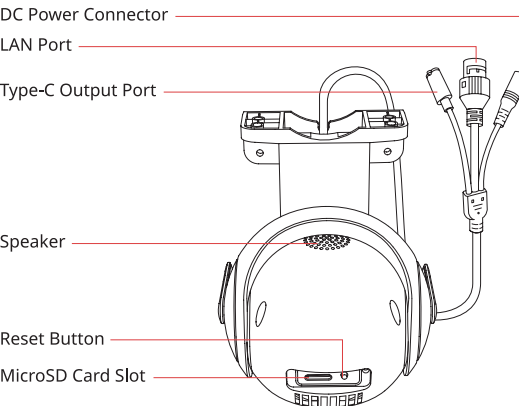
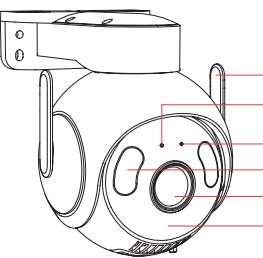

Preparation

You will need:

- A smartphone or tablet using Bluetooth 4.2 or later.
- The latest version of our app, downloadable via the Apple App Store or Google Play Store.
- A SwitchBot account, you can register via our app or sign in to your account directly if you already have one.



iOS and Android system requirements:

<https://support.switch-bot.com/hc/en-us/articles/12567397397271>



Device Setup

1. Power up the device.

Plug in the adapter to power up your device.

2. Add the device to the app.

Open the SwitchBot app and sign in. Then tap the "+" icon at the top right of the home page. Find the device's icon and select. Then follow the instructions to complete the setup.

Mounting Methods

Option 1: Wall Mount

- 1 Stick the marking sticker where you want to install the camera, then drill four holes through the marked spots.
- 2 Insert the wall plugs into the holes, then align the camera and fasten it with the provided screws.

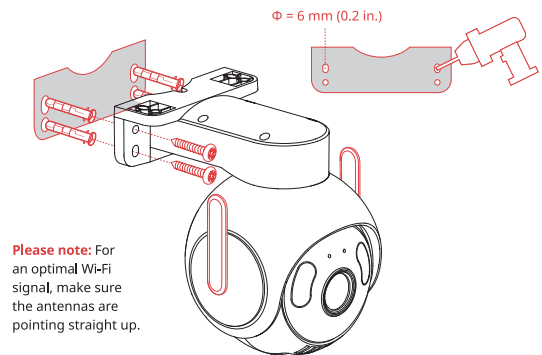

Please note: For an optimal Wi-Fi signal, make sure the antennas are pointing straight up.

Option 2: Overhang Mount

- 1 Stick the marking sticker where you want to install the camera, then drill four holes through the marked spots.
- 2 Insert the wall plugs into the holes, then align the camera and fasten it with the provided screws.

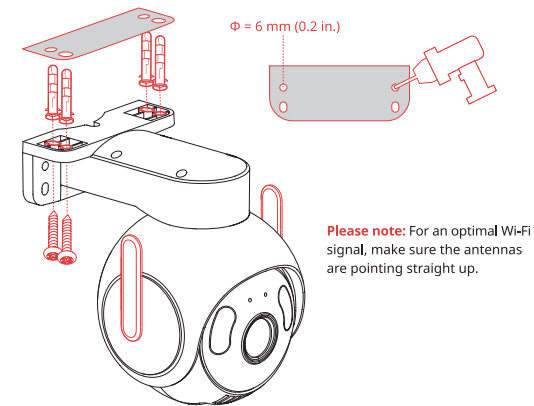

Please note: For an optimal Wi-Fi signal, make sure the antennas are pointing straight up.

Option 3: Pole Mount

- Tools: Phillips screwdriver, work gloves.
- Wear work gloves when installing.
- Choose a suitable pole ($\Phi < 200$ mm / 7.9 in.) to secure the camera.

Step 1: Fix the bracket to the pole.

- Thread one clamp through the top hole of the bracket, and the other through the bottom hole.

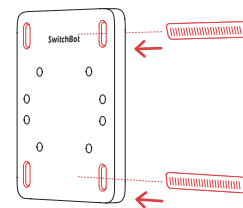

- Tighten the clamp with a Phillips screwdriver, adjusting tightness to fit the pole.
- Ensure the bracket is securely positioned at the desired location.

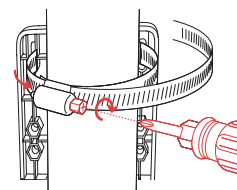

- The mounting strap (≈ 65 cm / 25.6 in.) fits all pole sizes. Cut off excess if needed.

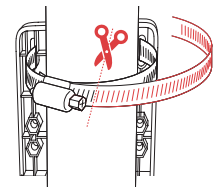

Step 2: Mount the camera on the bracket.

- Align the camera with the bracket holes and secure with screws from Screw Pack B.

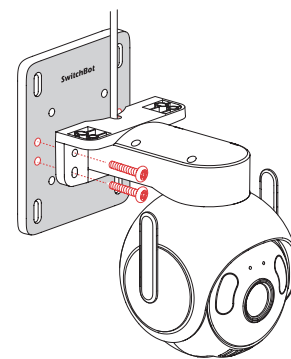

Installing Waterproof Seals

When the LAN port is used:

- 1 Remove the waterproof cap from the LAN port.
- 2 Guide the network cable through the waterproof seals in the order shown.

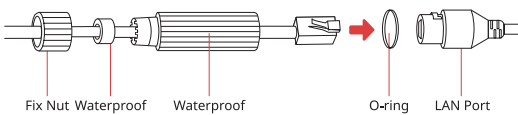

- 3 Fix the O-ring to the LAN port and connect the network cable.
- 4 Attach the waterproof jacket to the LAN port and twist to lock.
- 5 Insert the waterproof ring into the waterproof jacket.
- 6 Rotate the fix nut to secure the waterproof jacket.

Warning: The power adapter is not waterproof. Please place it indoors or inside a waterproof junction box to avoid potential safety hazards.

When the LAN port is not used:

Cover the LAN port with the waterproof cap and press the cap firmly to ensure a tight seal.

When the Type-C port is not used:

Cover the Type-C port with the waterproof plug and press the plug firmly to ensure a tight seal.

Please note: The Type-C port is for power output only (5V, 1A).

Precautions

- Do not use any other chargers than the provided one.
- Adapter should be used indoors where the ambient temperature is lower than or equal to 40°C (104°F).
- When you leave the product unused for a long time, unplug the device from the power outlet.
- Keep the device away from any heat sources or open flames.
- Do not disassemble the device yourself, as this will compromise its waterproof seal.
- Avoid touching the device with wet hands.
- This device may cause radio interference with other electronics, such as TVs, radios, computers, phones, and microwave ovens.

Device Cleaning

- Always disconnect the power before cleaning.
- For light stains: Wipe the device with a dry cloth.
- If the device is heavily soiled, use a well-wrung cloth dampened with water or a diluted, neutral detergent to wipe it, then dry thoroughly.
- Never use volatile substances like thinner or benzene, and do not spray insecticides, as this may cause damage or discoloration.
- Do not allow rubber, adhesive tape, or vinyl products to be in prolonged contact with the device.

LED Indicator Light

LED Indicator Light	Description	
Red	Steady on	Device starting up
	Blinking rapidly	Device ready for pairing
	Blinking slowly	Device offline
Green	Steady on	Voice calling
	Blinking rapidly	Device connected to network
	Blinking slowly	Device connecting to Wi-Fi
Red + Green	Blinking alternatively	Firmware upgrading

Restoring to Factory Settings

Open the waterproof plug on the device then press and hold the Reset button for 3s.

Firmware Upgrades

In order to improve user experience, we will regularly release firmware updates to introduce new functions and solve any software defects that may occur during usage. When a new firmware version is available, we will send an upgrade notification to your account via our app. When upgrading, please make sure your product has sufficient battery or stay powered on and make sure your smartphone is within range to prevent interference.

Frequently Asked Questions

Please visit our website or scan the QR code for more information.
<https://support.switch-bot.com/hc/en-us/categories/4411678651671>



Specifications

Material: PC + ABS
Field of View: 110° diagonal
Pan/Tilt Angle: 360° horizontal, 90° vertical
IR Night Vision Range: 20 m (65.6 ft.)
Video Resolution: 3K 5MP (2592 × 1620)
Size: 112 × 128 × 132 mm (4.4 × 5.0 × 5.2 in.)
Weight: 350 g (12.3 oz)
Power: DC 12V, 2A
Output (Type-C Port): 5V, 1A
Operating Temperature: -20°C to 45°C (-4°F to 113°F)
Operating Humidity: $\leq 95\%$ RH
Weatherproof Rating: IP66
Storage: Supports FAT32 formatted microSD card up to 512GB (not included)
Connectivity: 802.11 b/g/n, 2.4 GHz Wi-Fi; Bluetooth Low Energy 5.0

Warranty

We warrant to the original owner of the product that the product will be free from defects in materials and workmanship. Please note that this limited warranty does not cover:

1. Products submitted beyond the original limited warranty period.
2. Products on which repairs or modifying have been attempted.
3. Products subjected to falls, extreme temperatures, water, or other operating conditions outside the product specifications.
4. Damage due to natural disaster (including but not limited to lightning, flood, tornado, earthquake, or hurricane, etc.).
5. Damage due to misuse, abuse, negligence or casualty (e.g. fire).
6. Other damage that is not attributable to defects in the manufacture of product materials.
7. Products purchased from unauthorized resellers.
8. Consumable parts (including but not limited to batteries).
9. Natural wear of the product.

Contact & Support

Feedback: If you have any concerns or problems when using our products, please send feedback via our app through the Profile > Support page.

Setup and Troubleshooting: support.switch-bot.com

Support Email: support@switch-bot.com

