

SoundDrum 1

10W TWS Portable Bluetooth Speaker

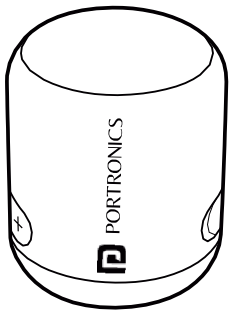

 User Manual

1 What's Inside

Package Contents :

1. Bluetooth Speaker
2. Charging Cable
3. User Manual



Type-C Charging Cable



User Manual

2 Introduction

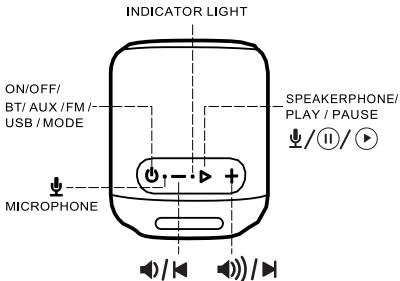

- A. Long press "+" or "-" for VOL+ and VOL-
B. Short press to choose the previous or next song

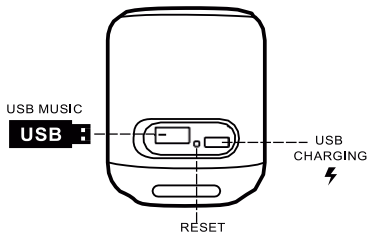

3 Bluetooth Wireless

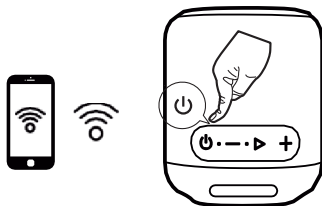

- Step 1 - Hold the Button for 3 Seconds to Power On/Off
Step 2 - Choose Bluetooth Mode
Step 3 - Open ON Setting on your mobile Device, & select "SoundDrum 1"
Step 4 - While Pairing is successful, you can play music

4 Speaker Phone

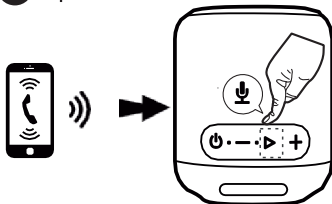

Button functions in Bluetooth mode

- | | |
|---------------|-----------------------------------|
| Status | |
| Incoming call | Press to answer an incoming call. |
| During a call | Press to end the current call. |

5 USB Play Music Mode

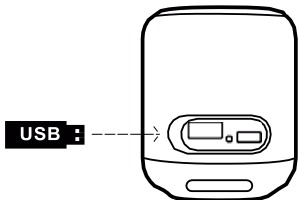

Step 1 - Short press the M button to change the mode to "USB MODE"

It will play the music on your USB flash disk

It needs to insert USB first and then only you can choose the USB mode.

6 FM Mode

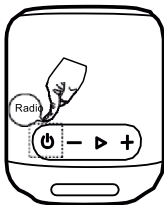

Step 1 - Short press the M button to change the mode to " FM mode "

Step 2 - Press ▶ button, it will Auto Search FM channels

Step 3 - Hold press "+" or "-" Previous Radio Station and Next Radio Station

Step 4 - Support semi-auto scan the FM channels (87.5MHz -108 MHz)

7 TWS (True Wireless Stereo)

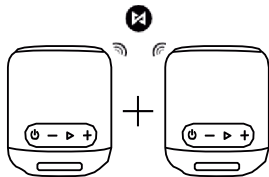

Turn on the two speakers and connect both through bluetooth. Long press on the play / pause button so that the two speakers are paired automatically. After matching, the indicator light of one of the speakers will turn on.

B . Now Please turn on the bluetooth function of your mobile device, you will find the SoundDrum 1 , please connect it and from this connect you can play music via the true wireless function.

C. Disconnect the true wireless, please press the button play/ pause for 3 seconds, and it will disconnect the true wireless.

8 LED Indications

Status	LED indiation
Fully charged	OFF
Charging	Red light up
Pairing mode	Blue Blinking
Working mode	Blue light up

DOS AND DON'TS

To ensure safe operations for your Soundbar, please follow these rules:

1. Always place the Soundbar in a safe location. When mounting to a wall, carefully screw it in to avoid damage later.
2. Avoid excessive pressure on either equipment.
3. When not in use, switch off the Soundbar & Subwoofer and unplug them from the power source
4. If the product is defective, kindly do not attempt to fix it yourself. We recommended professional help.
5. Keep the product away from water, to not cause internal damage.

Technical Specifications

Output Power	: 10W (RMS)
BT version	: 5.0
Supports	: A2DP and AVRCP
Frequency Response	: 70 - 15k Hz
Power Input	: DC 5V, 1A
S/N Ratio	: 90dB
Battery Capacity	: 2000mAh
Playback Time	: 8-10 Hours (with 60-70% Volume)
Product Dimension	: L79 * W79 * H95 mm

NOTE: Any damage caused by physical impact, water/liquid, fire, etc, caused by the customer or nature shall not be covered under warranty. Only product design, feature and functionality related faults will be considered. Never dismantle the product without due permission, otherwise it may nullify the warranty clause.



www.portronics.com

For Support

Visit : www.portronics.com

Email : help@portronics.com

Contact No. : +91 9555245245 , 011-42413131
(Working Hrs. : Monday - Saturday 10:00am - 6:00pm)



For E-waste & ROHS compliance refer to
<http://www.portronics.com/ewaste.html>