

# **VEVOR<sup>®</sup>**

## **TOUGH TOOLS, HALF PRICE**

Technical Support and E-Warranty Certificate [www.vevor.com/support](http://www.vevor.com/support)

### **Patient Transfer Chair**

**MODEL:XFL-QX-YW01-1**

We continue to be committed to provide you tools with competitive price.

"Save Half", "Half Price" or any other similar expressions used by us only represents an estimate of savings you might benefit from buying certain tools with us compared to the major top brands and does not necessarily mean to cover all categories of tools offered by us. You are kindly reminded to verify carefully when you are placing an order with us if you are actually saving half in comparison with the top major brands.

# VEVOR<sup>®</sup>

TOUGH TOOLS, HALF PRICE

## Patient Transfer Chair

**MODEL:**XFL-QX-YW01-1



Note:The product picture is for reference, the actual details shall prevail

### NEED HELP? CONTACT US!

Have product questions? Need technical support? Please feel free to contact us:

**Technical Support and E-Warranty Certificate**  
**[www.vevor.com/support](http://www.vevor.com/support)**

This is the original instruction, please read all manual instructions carefully before operating. VEVOR reserves a clear interpretation of our user manual. The appearance of the product shall be subject to the product you received. Please forgive us that we won't inform you again if there are any technology or software updates on our product.

Thank you very much for choosing this Patient Transfer Chair  
Please read all of the instructions before using it. The information will help you achieve the best possible results.

## Operation safety

Please put this manual in a place easy to check and keep it properly. This instruction manual clearly indicates how to use the equipment safely and correctly, so as to prevent any harm or property loss caused for you and others.

### **Warning**

1. Must use matched adapter with this product when charging.
2. This chair is not recommended to use for showering, if you have to must turn off the power and put the waterproof cover on the charging port.
3. The light on adapter will be on red while charging, it will stop charging automatically when the battery is fully charged, and the light will turn green.
4. The maintenance of this machine must be carried out by professionals.

### **Prohibition**

1. Do not open the battery box when it is charging
2. Do not use the product during the charging process
3. Do not use it if the weight over 300 lbs(150kg)
4. Do not put it in the place that the kids can touch it to avoid injury
5. It is strictly forbidden to operate the machine when there are objects blocking it , otherwise the machine will be damaged

\*Our company will not be responsible for any loss or damage caused by operation neglecting warning and attention. Please pay attention on.

## Product introduction

### Intended use

Electric lift transfer chair is the nursing device which helps disabled people moving without barrier, it is designed for short distance transferring and rehabilitation nursing. The caregivers can transfer the patients easily by controlling the lift button, which improve the nursing efficiency greatly. It help the caregivers to transfer patient who is immobile to car, living room, toilet, and bath room. In summary, it can greatly reduce the nursing intensity for caregivers and lower the nursing risk of secondary injury during the transfer process.

### Circuit principle block diagram

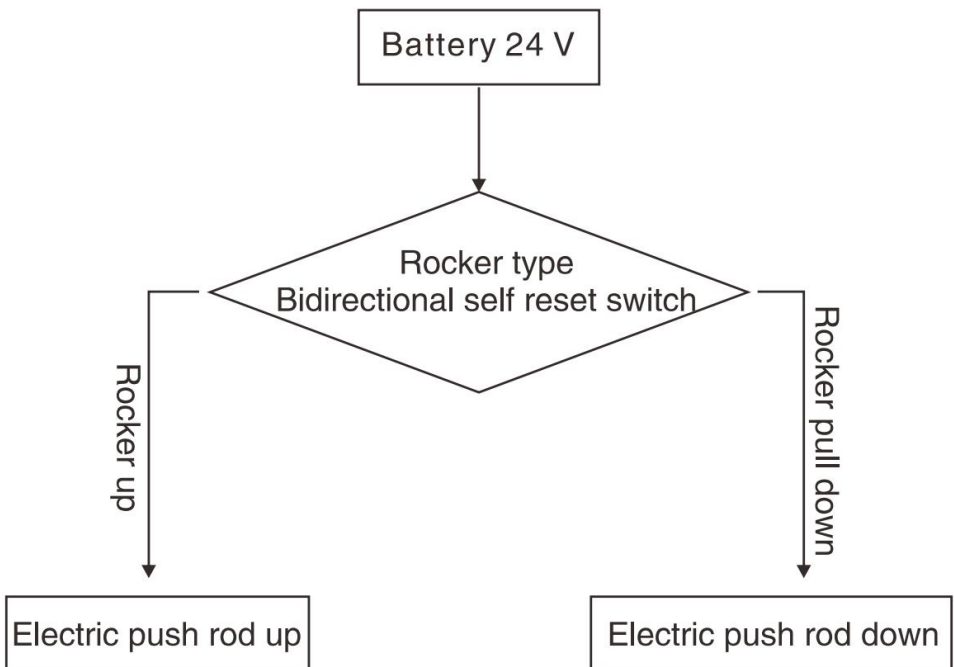

## Environmental requirements

### ◆ Use environment:

Ambient temperature range: +10°C ~ +40°C  
Relative humidity range: 30% ~ 75%  
Atmospheric pressure range: 700hPa ~ 1060hPa  
No corrosive and combustible materials, dry and less dust indoor

### ◆ Storage environment:

Ambient temperature: 0°C ~ +50°C  
relative humidity: ≤ 93%  
Atmospheric pressure: 500hPa ~ 1060hPa  
No corrosive gas, well ventilated room.

◆ During transportation and storage, handle with care, and do not throw or drop objects.

Do not store the equipment in a place where liquid may splash.

Do not store the equipment under the risk of combustible gas.

## Product parameter

Model	XFL-QX-YW01-1	
Colour	White + black	
Lift Range	330mm	
Waterproof Class	IPX44	
Maximum Load	≤ 150 KG (330 lbs)	
Product Size	810 x 530 x 940 mm	

## Part List



1.Backrest x2	2.Frame component x1
3.Handrail gantryx1	4.Left seat cushion side frame x1
5.Right seat cushion side frame x1	6.Mandrel x2
7.Power adapter x1	8.Electric push rod assembly x1
9.Toilet bucket x1	10.Toilet bucket stand x 1
11.Soft seat cushion x 1	12.Mounting fittings x 1set

## Installation instructions

### Step 1: Mounting body



#### 1.1 Pre-unplug the latch on the frame assembly



#### 1.2 Insert the mandrel into the mounting holes on the left and right sides of the frame assembly and insert the latch

(Note: The perforated end of the mandrel is the insert end)

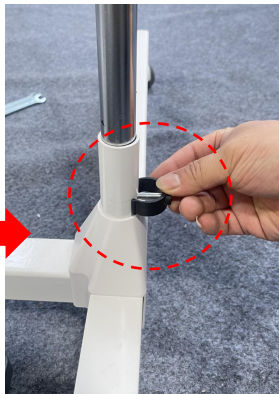

1.31.3 Remove the screws upper and lower ends of the push rod assembly. Then attach the lower end of the push rod assembly to the base frame with wrench.

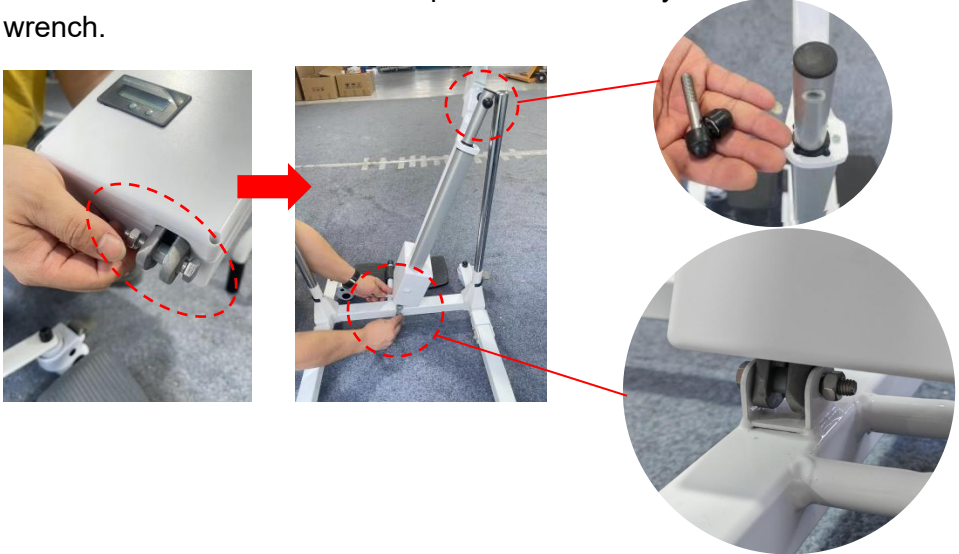

1.4 After installation, the push rod assembly is kept upright and then inserted into the handrail gantry. Align the mounting holes and lock the screws.

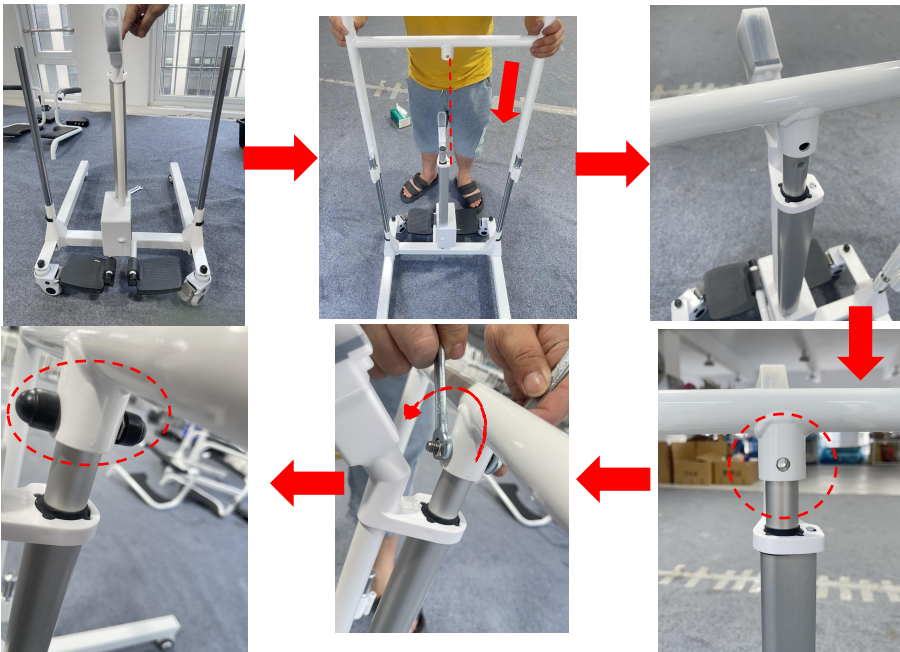

## Step 2: Mounting cushion



2.1 Install the backrest separately on the left and right cushion frames, Tighten the nut with a wrench.

2.2 Then insert the left and right seat cushion side frames respectively into the mounting holes on the left and right sides of the frame assembly



### Step 3: Mounting Toilet

3.1 First, insert the two ends of the toilet support into the mounting holes on the left and right seat cushion frames.



3.2 Insert the toilet into the toilet holder from behind, And the left and right cushion frame close buckle, finished.



## Instructions

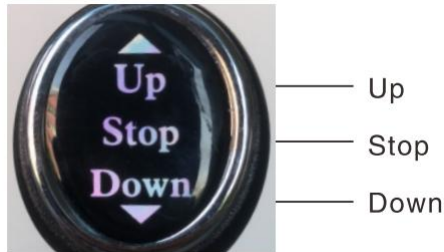

Product Controller Diagram

After charging, it can be used normally. It can be adjusted up and down. The proper height can be moved. Before use, it must be confirmed that the spindle of the frame is inserted to ensure safety. According to the height of the product, press the up button to the appropriate height, release and stop. If the key is not released, the product automatically stops at its highest point. The power supply designed for this product is low voltage power supply, please rest assured.

Note :There is a power display on the battery box. Please check the power display on the monitor regularly and charge it in time

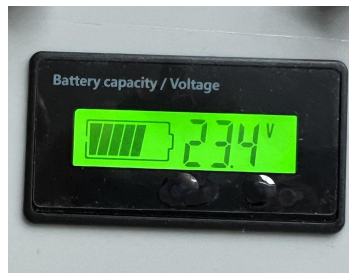

## Troubleshooting

In the event of a failure, please contact our after-sales personnel or log on to our official website for contact information. With the trust of our technical staff, we will solve the problem. If we can't solve this problem, we will return it to the manufacturer free of charge. If the warranty period ends or is

caused by personnel, our company will not give you a free warranty. Materials and shipping are required.

## **Maintenance**

Warning: Do not disassemble and repair the machine without the permission of the manufacturer.

## **Cleaning and disinfection**

It is recommended to wipe the seat ring with a soft cotton cloth and alcohol before use, and disinfect it after cleaning. The conveyor shell and accessories should be scrubbed with medical alcohol or other non-corrosive disinfectants.

Warning:

When cleaning and disinfecting, do not charge or use the machine.

It is forbidden to wash or disinfect the transfer machine and accessories in liquid.

It is forbidden to use corrosive detergent to clean the shifter and accessories.

It is forbidden to use corrosive disinfectant to disinfect the moving machine and accessories.

Only after the detergent and disinfectant are dried, can the shifter and accessories be used.

When the machine is not used for a long time, please take it out and charge it regularly to avoid battery failure

## **Safe use and maintenance**

1. Do not always plug in power supply during the process. At least once a week, the battery should be used to work, and until the battery is exhausted, it is necessary to ensure that the battery is recharged when the battery is exhausted. Although the lithium battery has no memory effect, it can prolong the life span of the battery.
2. Please destroy the battery according to the relevant local regulations when the machine is scrapped.
3. After using the machine, it is not necessary to clean and maintain it every time. It can be used normally after charging when the battery is not

powered. If it is found that there will be jitter when the machine is rising or falling, touch the electric lubricating oil on both long shafts.

4. After using the product for a period of time, check whether the screws of each part are loose. If there is any looseness, it should be tightened in time.

5. The internal power supply of this product is DC low voltage power supply. If there is water on the surface of the body, it can be dried with towel. Do not bubble in water directly.

## CORRECT DISPOSAL



This product is subject to the provision of European Directive 2012/19/EU. The symbol showing a wheeled bin crossed through indicates that the product requires separate refuse collection in the European Union. This applies to the product and all accessories marked with this symbol. Products marked as such may not be discarded with normal domestic waste, but must be taken to a collection point for recycling electrical and electronic devices.

## BATTERY DISPOSAL



To minimize hazards to health and the environment at the end of this product's life, laws dealing with Waste Electrical and Electronic Equipment (WEEE) and The Waste Battery Directive require you to dispose of this product at a suitable collection facility where it will be sent in order to remove the batteries and for appropriate recycling. Please contact your local authorities for more details on recycling and safe disposal of these in your area.

**XIANG FALI TECHNOLOGY(XIAMEN) CO.LTD**

Address: Floor 5th,No. 63,Pingcheng North Road, Haicang District  
Xiamen Fujian,CN 361026

Imported to AUS: SIHAO PTY LTD. 1 ROKEVA STREETEASTWOOD  
NSW 2122 Australia

Imported to USA: Sanven Technology Ltd. Suite 250, 9166 Anaheim  
Place, Rancho Cucamonga, CA 91730

<b>UK</b>	<b>REP</b>
-----------	------------

**YH CONSULTING LIMITED.**

C/O YH Consulting Limited Office 147,  
Centurion House,  
London Road, Staines-upon-Thames, Surrey,  
TW18 4AX

<b>EC</b>	<b>REP</b>
-----------	------------

**E-CrossStu GmbH**  
Mainzer Landstr.69, 60329 Frankfurt am  
Main.



**VEVOR<sup>®</sup>**

**TOUGH TOOLS, HALF PRICE**

**Technical Support and E-Warranty Certificate**

**[www.vevor.com/support](http://www.vevor.com/support)**