



Worry-Free
 Ten Year Sealed Battery
 Smoke & Carbon Monoxide Alarms

Worry-Free Hallway Plug-In Carbon Monoxide Alarm AC Powered with Sealed Lithium Battery Backup, Digital Display, and Escape / Night Light

Part Number: 900-0284
 Model KN-COP-DP-10YH



Sealed Lithium Battery Backup — 10-year* tamper proof battery eliminates need for battery replacement. Alerts User to replace alarm after 10 years of operation.

Night Light / Escape Light Feature — LED provides automatic illumination in dark conditions, bright intensity during alarm situation to help evacuate rooms.

Digital Display — Displays the level of carbon monoxide the unit is sensing. Automatically dims in low light conditions.

Peak Level Memory — Displays the peak CO level recorded since its last reset.

End of Life Alarm — Alerts user to replace alarm after 10 years of operation. Can be temporarily silenced for convenience.

No Night Chirps — End of Life and low battery signals programmed not to occur in dark conditions, helping to prevent needless waking of user.

Description

The Kidde 900-0284 AC Powered, Plug-in carbon monoxide alarm with sealed lithium battery backup and digital display is an easy to install unit that provides reliable protection against the dangers of carbon monoxide. The 10-year* sealed battery offers protection during power outages, prevents unwarranted removal of the battery, and eliminates the need for annual battery replacement.

The alarm includes both night light and escape light features. The brightness of the night light can be adjusted to ten different levels by pushing the peak level button, or turned off if needed. The ambient light sensor will automatically turn the night light on or off depending on ambient light conditions, when connected to AC power.

The escape light feature will brightly illuminate during alarm mode, helping those present to exit during dark conditions and when electrical power outages occur.

The digital display feature adds an advanced level of protection showing CO levels in PPM allowing you to see if levels change. This display uses LED technology which allows the CO levels to be visible in dark conditions and further distances than other alarms that use less visible LCD components. The display will automatically adjust brightness level to adapt to ambient light conditions, which offers both a brighter display during lighted environments and dims to provide a visible, but softer contrast at night. The display deactivates when AC power is removed to conserve battery life.

The Kidde 900-0284 has a 10-year operational life, which provides a 40% longer lifespan than other plug-in CO alarms. The alarm includes a 10-year limited warranty, and is listed by UL to the UL2034 Standard.

Features and Benefits

- **10 Year Sealed Battery** – Provides protection during power outages and does not need replacement during life of the alarm.
- **Digital Display** – Displays the level of CO the unit is sensing. LEDs provide clear daytime visibility that automatically dims in dark conditions.
- **Night Light / Escape Light Feature** – Nightlight with adjustable brightness levels auto-activates during low light conditions. The higher intensity escape light can help people exit rooms during alarm situations.
- **Peak Level Button** – Displays the highest level of CO recorded since last reset. Ideal for checking previous conditions while away or to assist medical responders.
- **Test/Reset Button** – Tests the unit for proper operation. Resets the Carbon Monoxide Alarm.
- **10-Year End of Life Warning** – Alerts user to replace CO alarm after 10 years of operation, as required by UL.
- **Rotating AC Blades** – Unit remains vertical whether electrical socket is in vertical or horizontal orientation.
- **UL Listed** – Listed by UL to the UL2034 Standard..

*10-Year Limited Warranty



Architectural and Engineering Specifications

The carbon monoxide alarm shall be Kidde model number KN-COP-DP-10YH (Part Number 900-0284) or approved equal. It shall be powered by a 120VAC, 60 Hz source along with a 3V sealed lithium battery backup. The temperature rating shall be between 40°F and 100°F (4°C and 38°C) and the humidity operating range shall be 10% - 95% relative humidity, non-condensing.

The CO sensor shall be of a fuel cell design and shall meet the sensitivity requirements of Underwriters Laboratories UL2034 Single and Multiple Station Carbon Monoxide Alarms. The unit shall provide an accuracy of +/- 30% when reading concentration levels.

The alarm shall include an integral plug that can be installed in any outlet following the UL/NFPA/Manufacturer's recommended guidelines. The AC blades remain vertical independent of whether the electrical socket is mounted vertically or horizontally. The unit shall incorporate a digital display that meets the sensitivity requirements of UL2034. The display will identify the levels of CO in parts per million (ppm) once that level reaches 30ppm. The display will automatically dim in low light conditions, and will turn off when AC power is removed unless more than 100ppm is detected or in alarm mode.

The alarm shall include a test/reset button. If pressed and released during normal operation, it shall electronically simulate the presence of CO and cause the unit to go into alarm. This sequence tests the unit's electronics to ensure proper operation. If pressed during alarm mode, the unit will be silenced and will begin monitoring CO levels again.

In accordance with UL2034, the CO sensor will not alarm to levels of CO below 30 ppm and will alarm in the following time range when exposed to the corresponding levels of CO.

70 ppm CO concentration:	60-240 minutes
150 ppm CO concentration:	10-50 minutes
400 ppm CO concentration:	4-15 minutes

The alarm shall include a piezoelectric horn that is rated at 85 decibels at 10 feet. When the unit detects carbon monoxide, the alarm pattern will be four (4) short beeps – followed by five (5) seconds of silence. This pattern repeats as long as dangerous CO conditions exist. The red Alarm LED will flash the alarm pattern, the escape light will illuminate, and the PPM will be displayed on the digital display.

See user guide for additional important information.

Technical Specifications

Part Number:	900-0284
Model:	KN-COP-DP-10YH
Power Source:	120VAC, 60 Hz, 90mA max
Sensor:	Electrochemical
Audio Alarm:	85dB at 10ft
Temperature Range:	40°F (4°C) to 100°F (38°C)
Humidity Range:	10%-95% relative humidity (RH), non-condensing
Size:	3.0" x 5.6" x 1.5"
Weight:	.62 lb.
Interconnects:	No
Warranty:	10 year limited

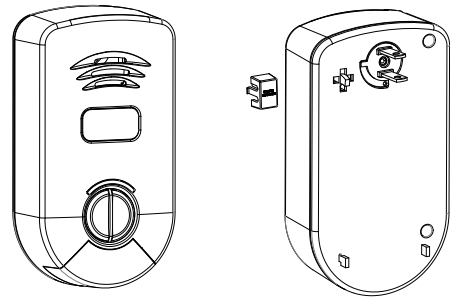

⚠ WARNING: This product is intended for use in ordinary indoor locations of family living units. It is not designed to measure compliance with Occupational Safety and Health Administration (OSHA) commercial or industrial standards.

This device is designed to protect individuals from acute effects of Carbon Monoxide exposure. It will not fully safeguard individuals with specific medical conditions. If in doubt, consult a medical practitioner. Individuals with medical problems may consider using warning devices which provide audible and visual signals for carbon monoxide concentrations under 30 ppm.

Industry experts recommend a CO alarm be installed on each level of the home—ideally on any level with fuel burning appliances and outside of sleeping areas.— see User Guide for further information.

Ordering Information

Ordering No:	UPC	I 2 of 5	Pack Config.	Pack Qty	Dimensions (w" x d" x h")	Weight (lbs.)	Cartons/ Pallet
21026365	0-47871-26365-3	100-47871-26365-0	Clam	3	8 x 9.5 x 11.5	2.64	75

Distributed by:



1016 Corporate Park Drive
Mebane NC 27302
1-800-880-6788
www.Kidde.com