

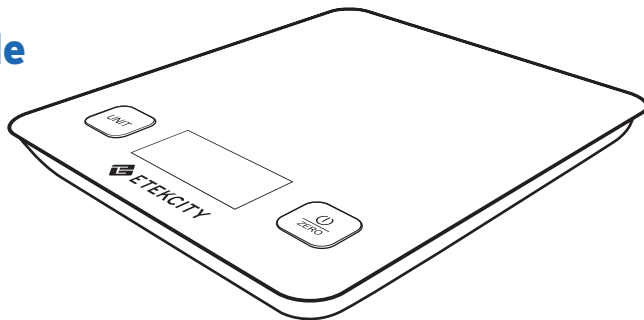

Digital Kitchen Scale

Model No.: EK6212-S



Questions or Concerns? (855) 686-3835 • support@etekcity.com

Thank You.

Thank you for purchasing the EK6212-S Digital Kitchen Scale by Etekcity. We are dedicated to providing our customers with quality products for building a better living. Should you have any questions or concerns about using your new product, feel free to reach out to our helpful customer support team at (855) 686-3835 or by email at support@etekcity.com. We hope you enjoy your new product!

Package Contents

1 x Digital Kitchen Scale
2 x 1.5V AAA batteries
1 x User Manual

Table of Contents

Safety Information	4
Main Functions	5
Set-Up	6
Operation	7
Weight Measurement	7
Volume Measurement	8
Tare Function	9
Maintenance	9
Specifications	10
Troubleshooting	11
Warranty	12
Customer Support	13

Safety Information

IMPORTANT: Please read and comply with all of the instructions and warnings provided in this manual before using the product. Failure to comply with the instructions and warnings provided herein may result in inaccurate results and/or damage to the product itself.

- Always place the scale on a hard, dry, and flat surface before measurement in order to ensure accurate results.
- Dirt, dust, vibration, wind, air currents, and electromagnetic interference may contribute to inaccurate results.
- **DO NOT** exceed the 11 lb (5 kg) weight capacity; doing so may damage the scale. An overload indicator will appear on the LCD display if the limit is exceeded.
- Avoid exposing the device to damp environments or extreme temperatures.
- **DO NOT** immerse the scale in water or corrosive liquids. If a liquid is spilled on the digital display or buttons, immediately wipe the scale clean with a soft cloth in order to avoid potential internal damage.
- When replacing batteries, make sure to insert them under the correct polarity as indicated within the battery compartment.
- If the low battery indicator is displayed, please replace the batteries.
- **DO NOT** mix new and used batteries to power the device.
- This scale is not intended for commercial or heavy-duty use.
- Handle the scale with care. Keep the scale in a cool, dry environment.
- If the scale fails to turn on, check if the batteries are installed correctly. Replace the batteries if necessary.
- If the scale is not in use for an extended period of time, remove the batteries to conserve battery life and extend the lifetime of the scale.

Main Functions

Function Diagram

1. Weighing Platform
2. LCD Display
3. Unit Button
4. Power/Zero Button
5. Anti-skid Padding
6. Battery Compartment

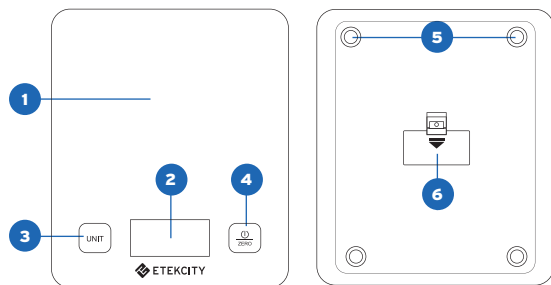

Digital Display

1. Weight Value
2. Tare Mode
3. Zero Weight
4. Negative Weight Value
5. Mode
6. Measurement Unit

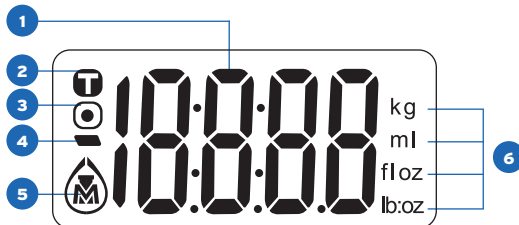

Icon	Mode	Units	Use
	Weight Mode	oz / lb:oz / g	Measures the weight of food and solid objects.
	Milk Volume	ml	Measures the volume of milk and other liquids with similar densities.
	Water Volume	ml	Measures the volume of water and other similar liquids.

Set-Up

1. Open the battery compartment on the underside of the scale.
2. Insert the included AAA batteries, making sure they are under the correct polarity. Place the battery cover back on.
3. Press the **'Power/Zero'** button to turn on the scale.

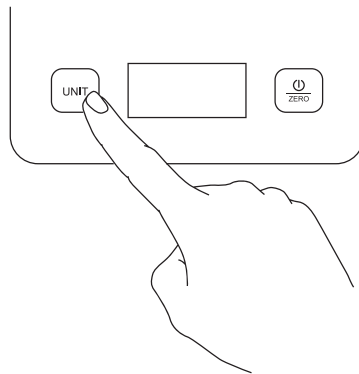
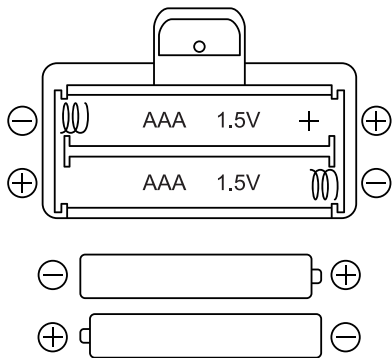

Operation

Weight Measurement Mode

1. Place the scale on a flat, dry surface.
2. Press **'Power/Zero'** to turn on the scale.

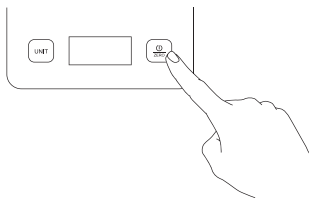

3. Press **'UNIT'** to select your desired measuring unit. Allow the scale to read zero before measuring.



4. Gently place your object on the scale. The LCD display will automatically display the object's

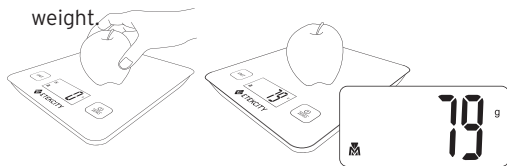

5. Press and hold **'Power/Zero'** for 3 seconds to turn off the scale.

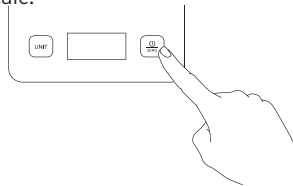

NOTE: The scale will automatically turn off after 2 minutes of inactivity.

Volume Measurement Mode

1. Place the scale on a flat, level surface, then press the power button to turn it on.
2. Press the **'Unit'** button to select either the milk or water volume measurement mode.
3. The scale will display "0" when ready.



4. Place an empty container onto the platform. The screen will display the container weight.



5. Press the **'Power/Zero'** button to tare the weight of the container.

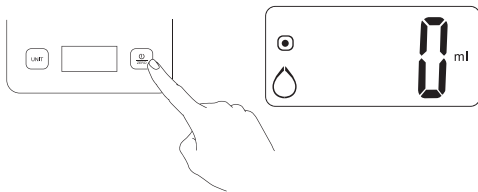

6. Once the screen displays "0" pour the liquid into the container. The LCD screen will automatically display the final volume.

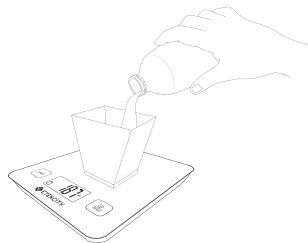

NOTE: To reset, remove all weight from the platform and press the **'Power/Zero'** button.

Tare Function

The tare function allows you to measure objects in a container without having to include the container's weight in the final measurement.

1. Place the scale on a flat, dry surface.
2. Power on the scale and wait for the display to read zero.



3. Place an empty container on the scale and press **'Power/Zero.'** The display will now show zero.

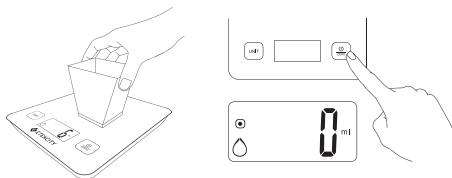

4. Place objects in the container, and the display will show weight of the items.

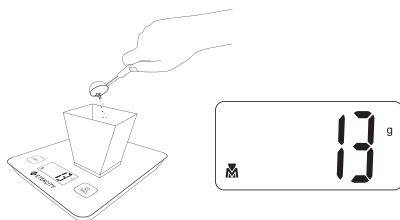

5. Take the container off the platform when you have finished weighing your items. Press **'Power/Zero'** once to reset the scale.

Maintenance

Use a slightly damp cloth to clean the surface of the scale, followed by a dry soft cloth to wipe away the remaining moisture. You can also use a dry soft cloth to wipe off any dust that may be on the scale. Be sure not to wash the device or immerse it in water or any other liquids.

Specifications

Weight Capacity:	176.4oz / 11lb / 5000g / 5000ml
Units:	oz / lb:oz / g / ml
Division Value:	0.1oz / 1g / 1ml
Auto-Off:	120 seconds
Backlight Auto-off:	30 seconds
Dimensions:	8.5" x 7.3" x 0.6" (217mm x 187mm x 16mm)

Troubleshooting

Problem	Cause	Solution
LCD display is dim or shows "Lo."	Not enough power.	Replace batteries.
Device does not turn on.	Batteries are no longer good.	Replace batteries.
	Batteries not inserted correctly.	Insert batteries under the correct polarity as marked on battery compartment.
Display shows "Err."	Scale is placed on an uneven surface.	Place scale on a flat, stable surface.
	Scale needs to be reset.	Remove the batteries, wait 10 seconds, then replace the batteries.
	Weight exceeds 11 lbs (5kg).	Promptly remove object from scale to protect its sensors. Use a different scale with a higher weight range.
	Objects exceeding 1000 g are on top of scale before it is turned on.	Remove objects from scale; wait until display reads zero before weighing.
	Weight is unstable during measurement.	Keep weight stable on the measuring platform.

Warranty

Product Name	<i>Digital Kitchen Scale</i>
Model	<i>EK6212-S</i>
For your own reference, we strongly recommend that you record your order ID and date of purchase.	
Order ID	
Date of Purchase	

Terms & Policy

Etekcitey Corporation (“Etekcitey”) warrants this product to the original purchaser to be free from defects in material and workmanship, under normal use and conditions, for a period of 2 years from the date of original purchase.

Etekcitey agrees, at our option during the warranty period, to repair any defect in material or workmanship or furnish an equal product in exchange without charge, subject to verification of the defect or malfunction and proof of the date of purchase.

There is no other express warranty. This warranty does not apply:

- If the product has been modified from its original condition;
- If the product has not been used in accordance with directions and instructions in the user manual;
- To damages or defects caused by accident, abuse, misuse or improper or inadequate maintenance;
- To damages or defects caused by service or repair of the product performed by an unauthorized service provider or by anyone other than Etekcitey;
- To damages or defects occurring during commercial use, rental use, or any use for which the product is not intended;
- To damages or defects exceeding the cost of the product.

Etekcitey will not be liable for indirect, incidental, or consequential damages in connection with the use of the product covered by this warranty.

This warranty extends only to the original consumer purchaser of the product and is not transferable to any subsequent owner of the product regardless of whether the product is transferred during the specified term of the warranty.

This warranty does not extend to products purchased from unauthorized sellers. Etekcitey’s warranty extends only to products purchased from authorized sellers that are subject to Etekcitey’s quality controls and have agreed to follow its quality controls.

All implied warranties are limited to the period of this limited warranty.

This warranty gives you specific legal rights and you may also have other rights which vary from state to state. Some states do not allow the exclusion or limitation of incidental or consequential damages, so the above limitation or exclusion may not apply to you.

If you discover that your product is defective within the specified warranty period, please contact Customer Support via support@etekcity.com. DO NOT dispose of your product before contacting us. Once our Customer Support Team has approved your request, please return the product with a copy of the invoice and order ID.

Every Etekcitey product automatically includes a 2-year warranty. To make the customer support process quick and easy, register your product online at www.etekcity.com/warranty.

This warranty is made by:

Etekcitey Corporation
1202 N. Miller St., Suite A
Anaheim, CA 92806

Customer Support

Should you encounter any issues or have any questions regarding your new product, feel free to contact our helpful Customer Support Team. Your satisfaction is ours!

Customer Support

Etekcity Corporation
1202 N. Miller St. Suite A
Anaheim, CA 92806

Toll-Free: (855) 686-3835
Fax: (657) 202-1693
Local: (657) 500-1872
Email: support@etekcity.com

Support Hours

Monday - Friday:
9:00 am - 5:00 pm PST

**Please have your order confirmation number ready before contacting customer support.*



21H10_us