

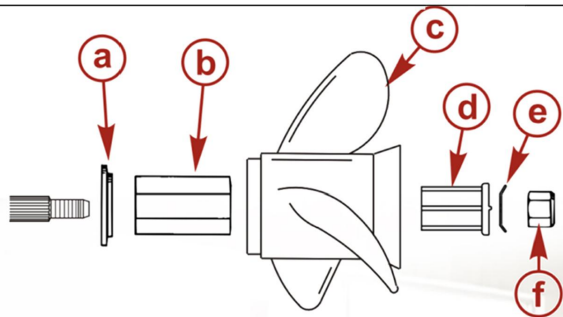

PROPELLER INSTALLATION INSTRUCTIONS

⚠ WARNING

Rotating propellers can cause serious injury or death. Never operate the boat out of the water with a propeller installed. Before installing or removing a propeller, place the drive unit in neutral and engage the lanyard stop switch to prevent the engine from starting. Place a block of wood between the propeller blade and the anti-ventilation plate.



Flo-Torq II propeller without a hub bushing

- a - Forward thrust washer
- b - Drive sleeve
- c - Propeller
- d - Drive sleeve adapter
- e - Locknut retainer
- f - Locknut

Remove all hardware kits and propeller from engine shaft before installing the new propeller. The old thrust washer may be stuck onto shaft please make sure you have removed it.

Step1. Install the propeller onto the shaft with the supplied components. If the components supplied with the propeller are different than what is shown, refer to the propeller installation instructions provided with your product or contact your dealer.

Step2. Slide the propeller onto shaft, then Put the Thrust Washer on propeller shaft. The taper on the Thrust Washer should mate properly with the taper on the propeller shaft.



Step3. Place the locknut retainer over the raised pins on the drive sleeve adapter and tighten the locknut to the specified torque.



Step4. Secure the locknut by bending the tabs up against the flats on the nut.



Scan the QR code to view the video tutorial



REGISTERED TRADEMARK ACKNOWLEDGEMENTS

The use of third party company name or trademarks herein is intended for informational and identification purposes only and does not constitute or imply endorsement-sponsorship or recommendation. Honda is a registered trademark of Honda Motor Company, Nissan is a registered trademark of Nissan Motor Co, nc.Suzuki is a registered trademark of Suzuki Motor Co.,LTD.Tohatsu is a registered trademark of Tohatsu Corporation. Volvo is a registered trademark of Volvo Trademark AB. Yamaha is registered trademarks or Yamaha Corporation.Evinrude,Johnson, OMC are registered trademarks of BRP (Bombardier Recreational Products Inc. or its subsidiaries). Mercury, Mercurier are registered trademarks of Brunswick Corporation.

