

Veise

Installation Instructions of Handleset

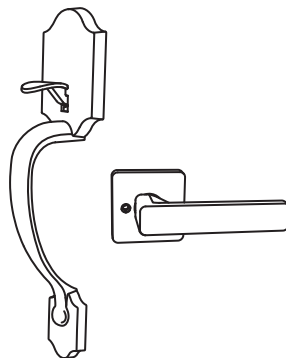

Tutorial Video

Scan the QR code to get the video.

Need Help? Contact Us!

Call us at **+1(855)400-3853** (Monday-Friday 9:00am-5:00pm PST),
if you have any questions.  support@iveise.com  iveise.com







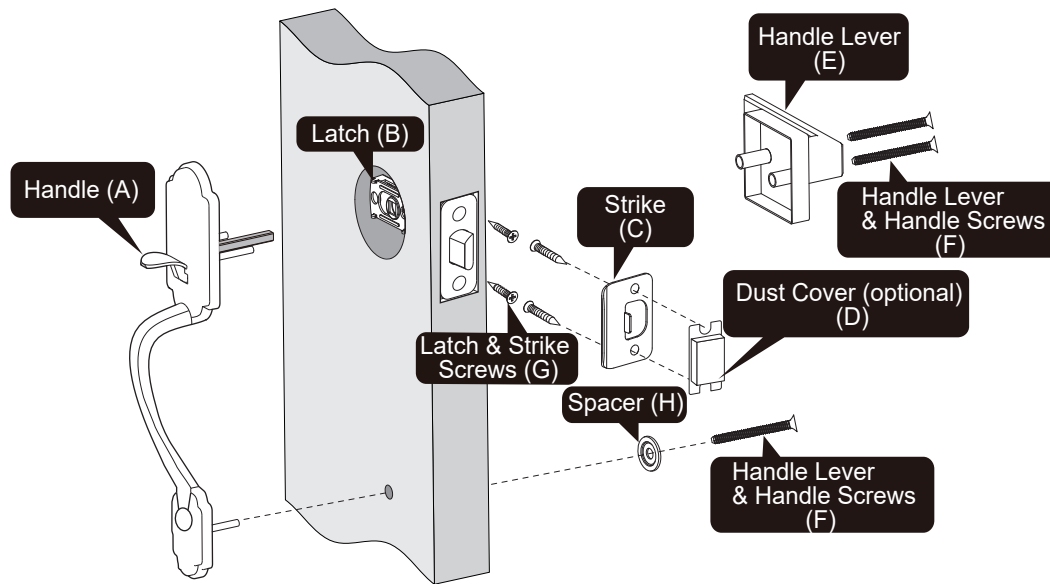

Content

- Parts List 01
- Prepare the Door & Check Dimensions 02
- Latch Adjustment 03
- Install the Latch & Strike 04
- Install the Handle 05
- Install the Handle Lever 06

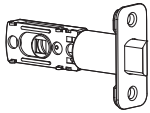
► Installation Overview

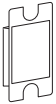
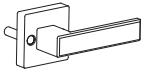

▶ **Parts List**

<p>A Handle x1</p> 	<p>B Latch x1</p> 	<p>C Strike x1</p> 
<p>D Dust Cover x1 (optional)</p> 	<p>E Handle Lever x1</p> 	<p>F Handle Lever & Handle Screws x3</p> 
<p>G Latch & Strike Screws x4</p> 	<p>H Spacer x1</p> 	

TOOL REQUIRED:



Do not use an electric screwdriver during installation.

Prepare the Door & Check Dimensions

If your door already has the holes shown in the picture below, proceed to the next step; if your door does not have holes, use the mounting template to drill a new hole.

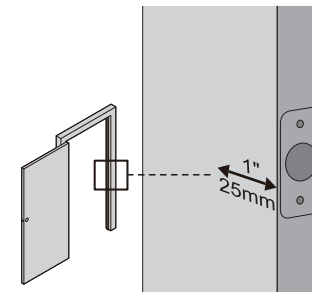
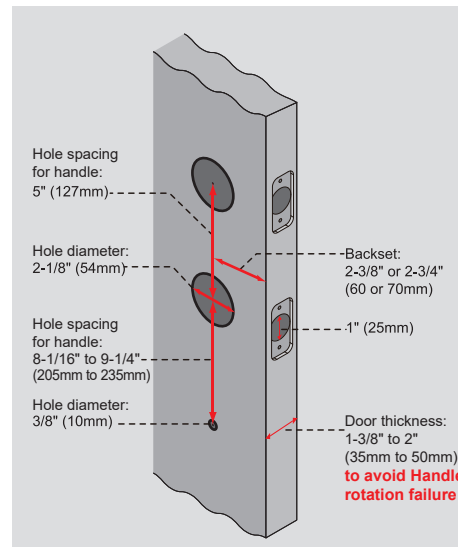

02

Latch Adjustment

Note: Be sure to use the provided Latch from the package, or it will not function properly.

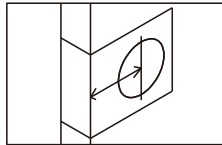

Backset is the distance from the door edge to the center of the hole in the door.

- 1** If the backset of your door is 2-3/8" (60mm), there is no need to adjust the Latch.

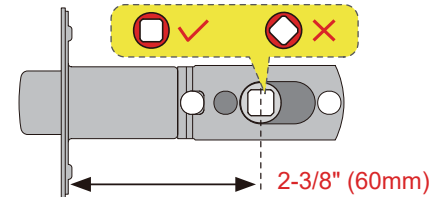

- 2** If the backset of your door is 2-3/4" (70mm), please adjust the Latch.

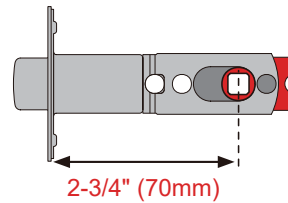
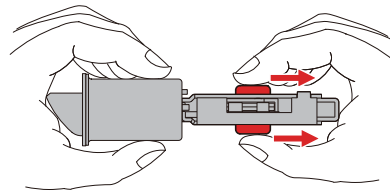

Holes must form a square, not a diamond.

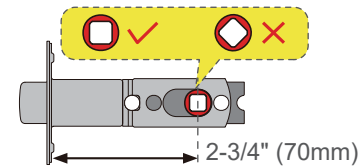

Install the Latch

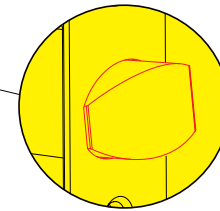
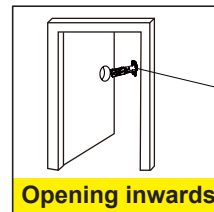
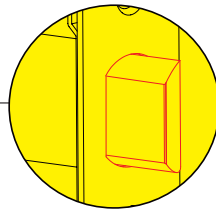
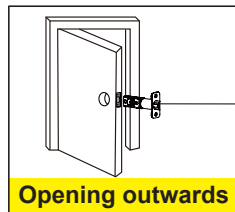

Install the Strike

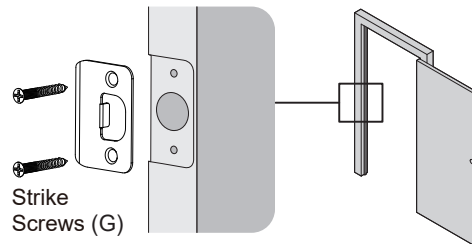

Note: The bevel of the Latch should be aligned with the bevel of the Strike.

04

Opening
outwards

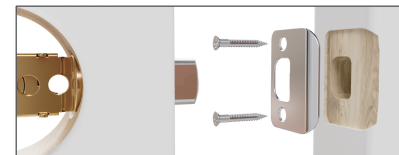

Opening
inwards

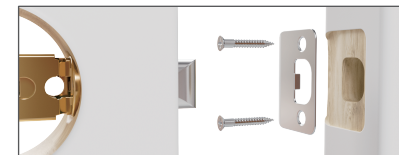

Install the Handle

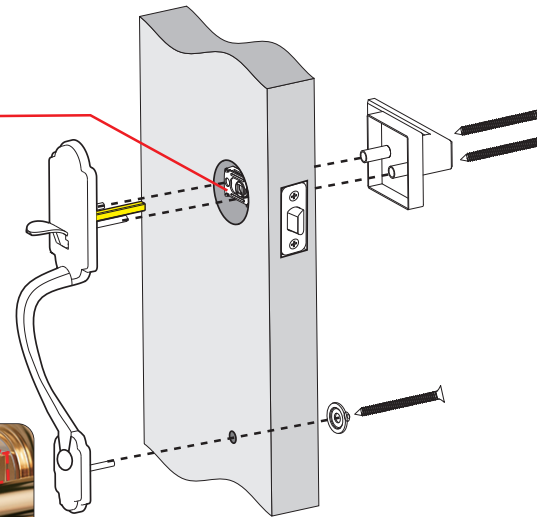
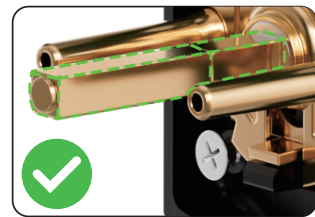
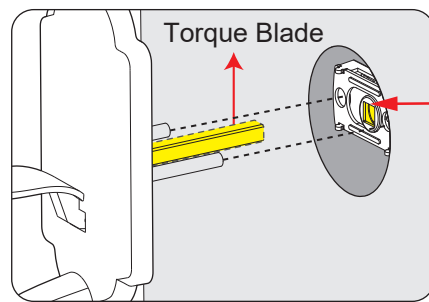

! IMPORTANT:
The Torque Blade must be aligned with the square hole. Otherwise, the Handle Button will not unlock when pressed.

Install the Handle Lever

⚠ IMPORTANT:
Don't press the button during the installation of the handle.

Test the Handleset

Keep the door open and check the Handleset to ensure it works smoothly.

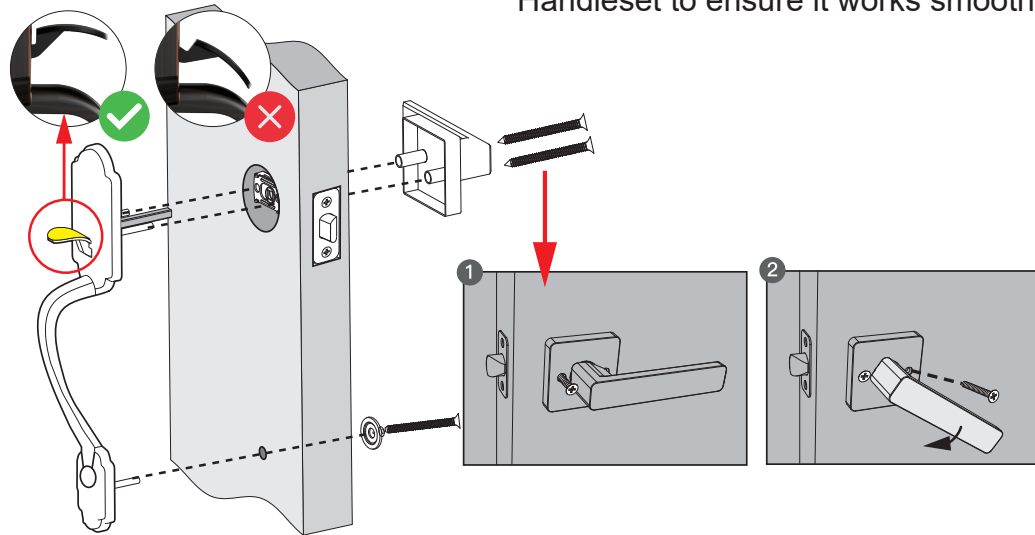

06

Need Help? Contact Us!

If you have any questions, please contact us at

 **+1(855)400-3853**

(Monday-Friday 9:00am-5:00pm PST)

 **support@iveise.com**  **iveise.com**

If you have your **order ID, videos or images of your problem** (if necessary) ready before contacting Customer Support, we will solve your problem faster and better.