

Veise

User Manual

Model No. **KS03**



Tutorial Video

Scan the QR code and search **KS03** to get the video.

Need Help? Contact Us!

Call us at **+1(855)400-3853** (Monday-Friday 9:00am-5:00pm PST), if you have any questions.

 support@iveise.com  iveise.com

»» Content

- At a Glance 01
- How to Lock / Unlock 02
- Programming Guide 05
- Definitions 11
- Code Format 14
- FAQ 15



At a Glance

Exterior Assembly

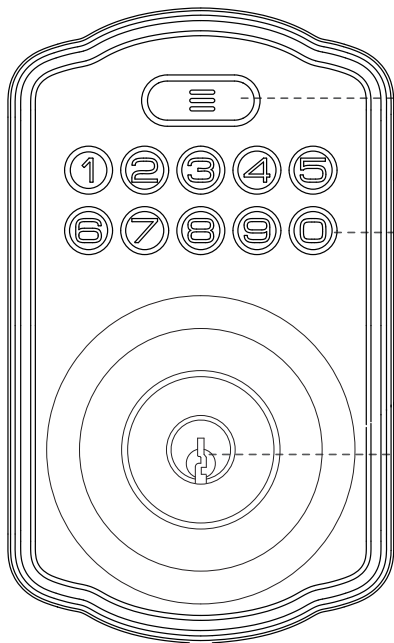

Multi-function Button (MFB)

Keypad

Cylinder

Interior Assembly

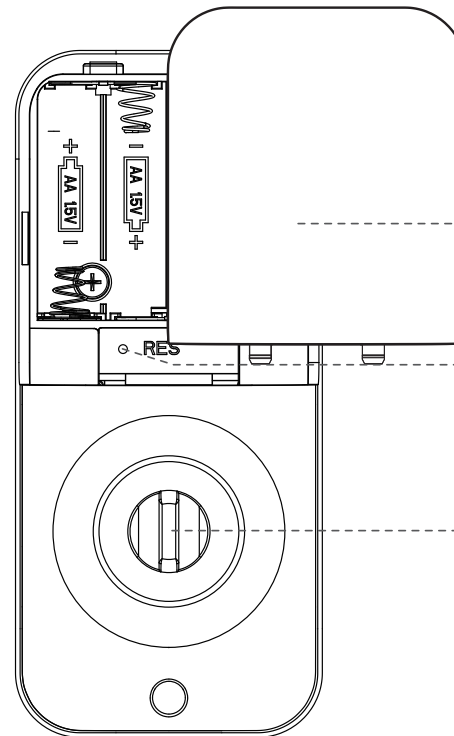

Battery Cover

Reset Button

Thumb Turn

01



How to Unlock

▶ 1. Unlock from **outside**.

1 Enter Master / User Code,
press 

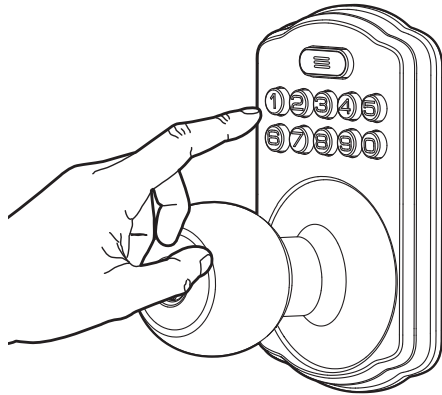

2 Use the Mechanical Key

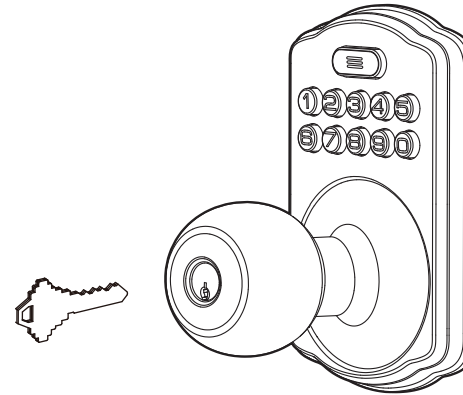

▶ 2. Unlock from **inside**.

1 Rotate the Thumb Turn



How to Lock

▶ 1. Lock from **outside**.

- 1** Press and hold **any button** on the Keypad for **2 seconds**

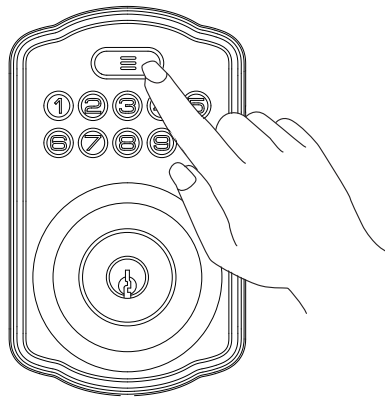

- 2** Use the Mechanical Key

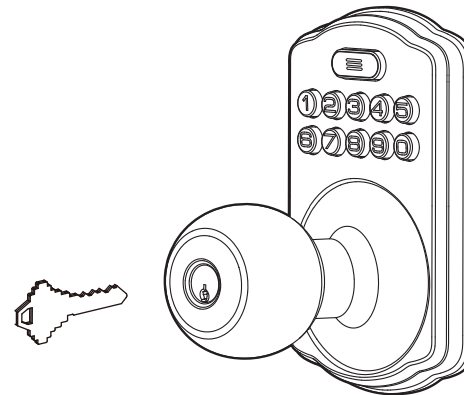

▶ 2. Lock from **inside**.

- 1** Rotate the Thumb Turn



Auto Lock

- ▶ In **Auto Lock** mode, your smart lock will automatically lock the door after 30 seconds. You can customize the Auto Lock time delay between **10** and **99** seconds.

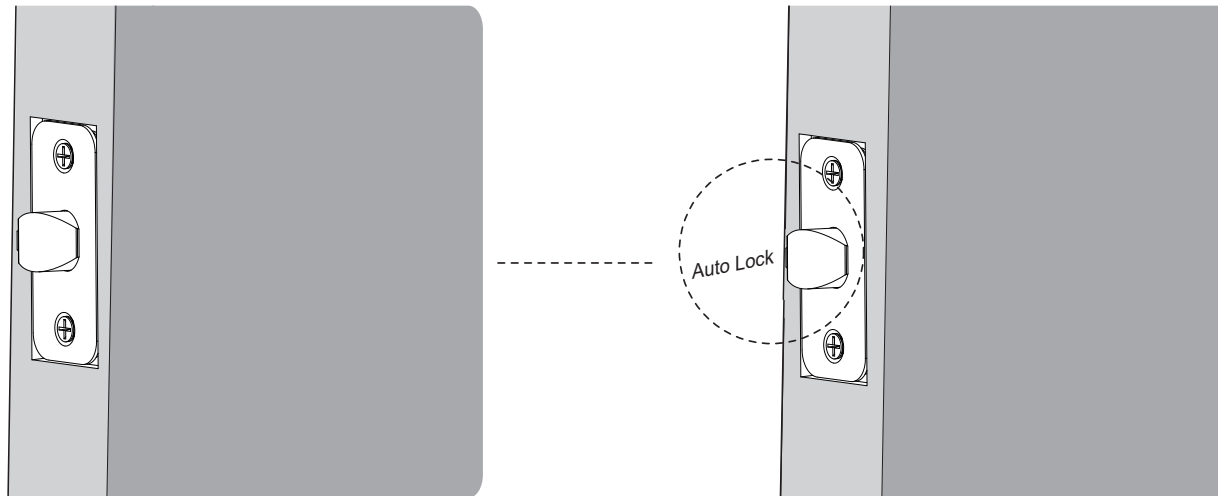

🕒 **30** seconds later

NOTE: Auto Lock is enabled by default. The lock doesn't have a built-in door sensor, if the Auto Lock is enabled, it will lock automatically whether your door is closed or open.



Programming Guide

⚠ Important:

- ▶ The **Default Master Code is 12345678**. Please change it to your own Master Code before programming. If the Master Code can't be changed, see the "How to Reset" section to reset the lock.
- ▶ If the setup is unsuccessful, the indicator light will flash **Red**.

▶ **Change Master Code**

1 Press  twice, then enter the Default Master Code, press  once.

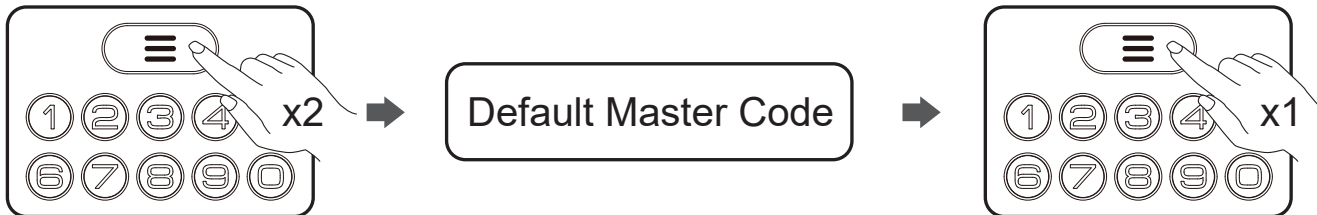

2 When green light flashes, press **1** on the Keypad.

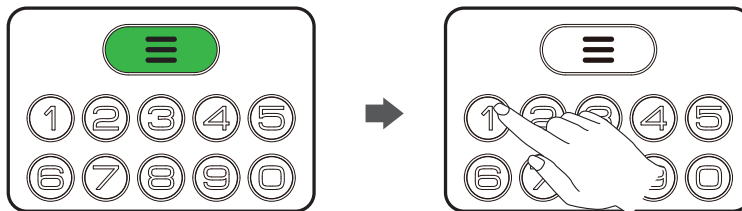



Programming Guide

3 Then enter your New Master Code, and then press .

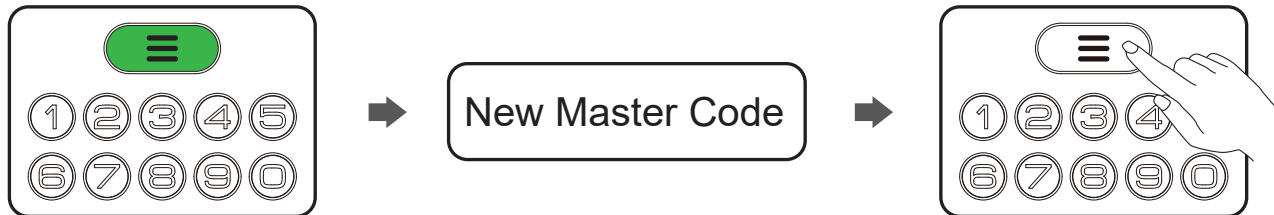

4 Enter your New Master Code again, and then press .

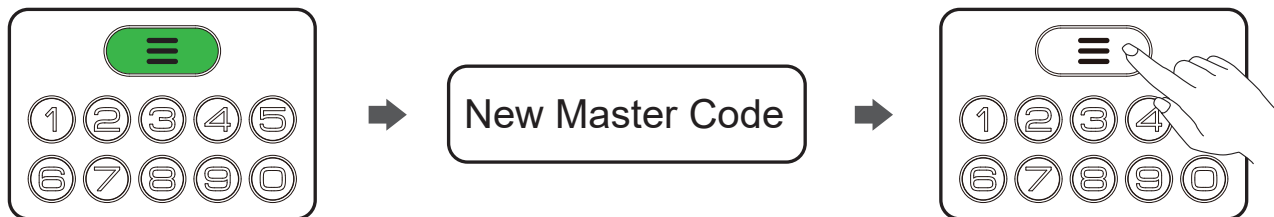

5 Congratulations! The programming is complete when the green indicator light flashes. You can now use your New Master Code to configure the following settings.



Programming Guide

▶ Add User Code

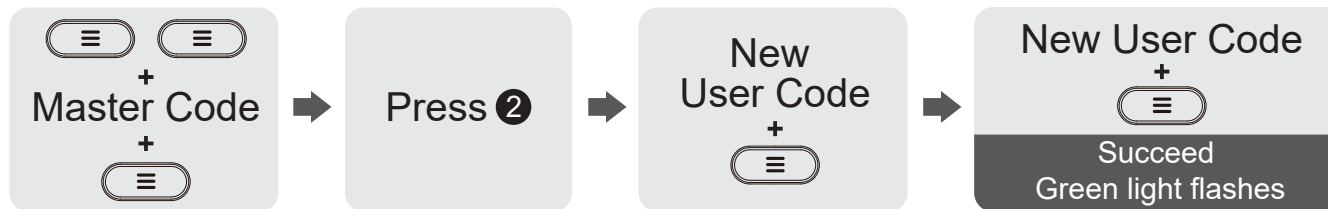

▶ Delete User Code

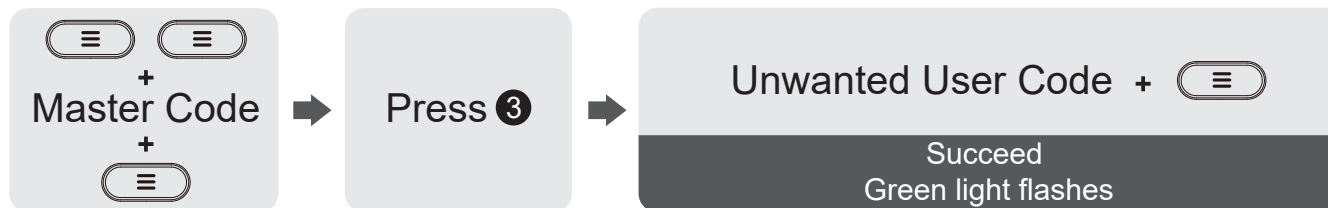

▶ Add One-Time Code

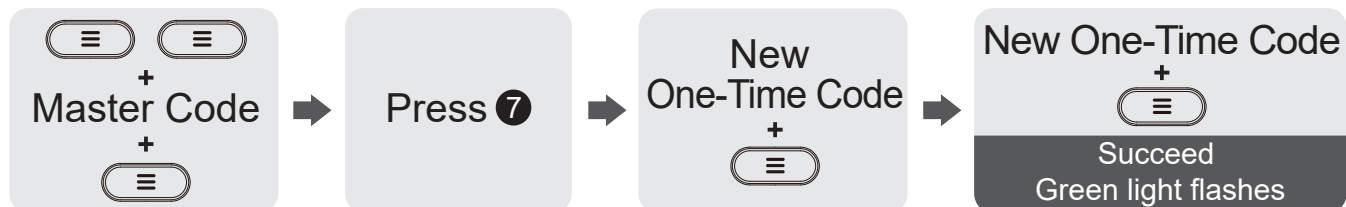



Programming Guide

▶ *Enable Auto Lock*

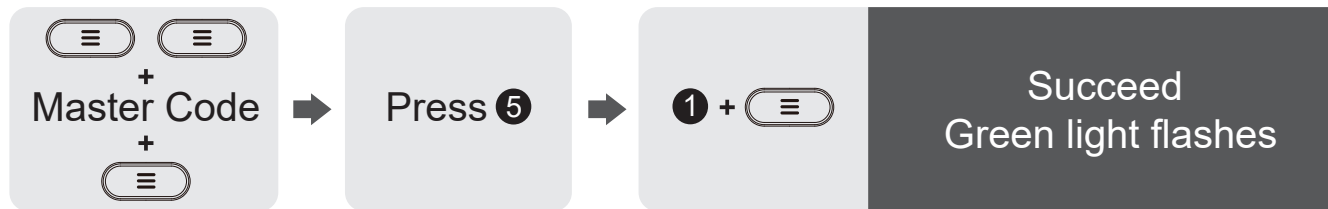

▶ *Disable Auto Lock*

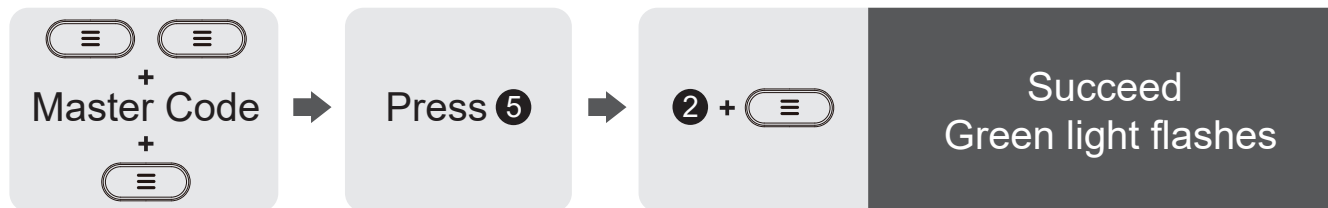

▶ *Set Auto Lock Time*

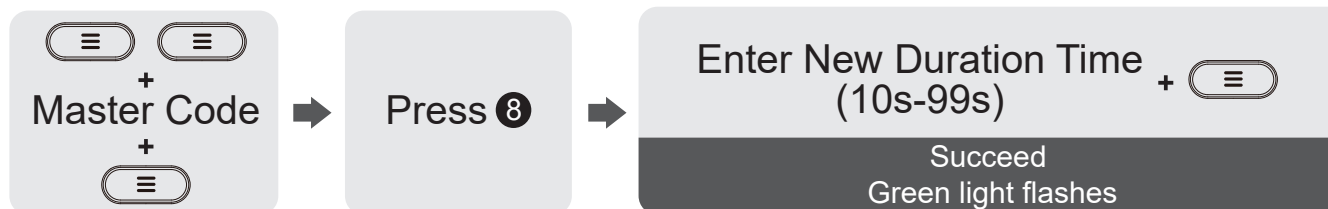



Programming Guide

▶ *Enable Silent Mode*

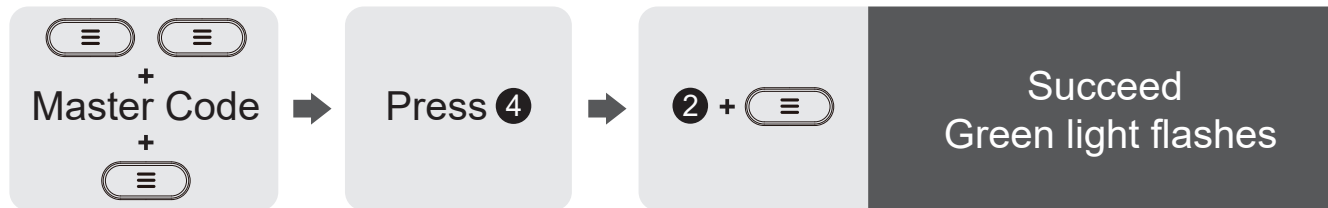

▶ *Disable Silent Mode*

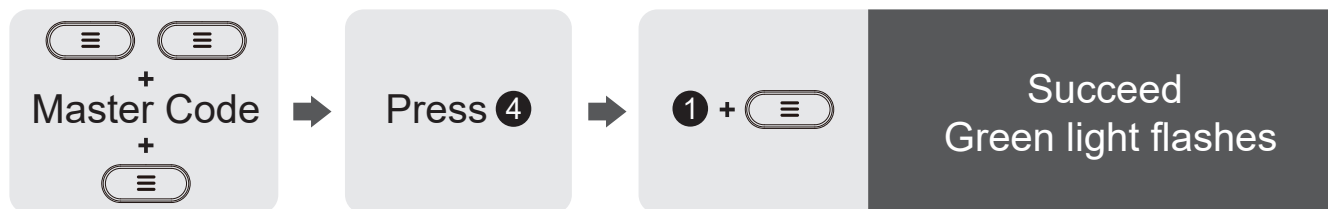

» Definitions

- **Master Code**

The Default Master Code is **12345678**. Before programming, it requires to change the Default Master Code to a new one.

Master Code can be used to unlock the door under Vacation Mode.

Property owner & manager should keep this information confidential.

- **Auto Lock**

In **Auto Lock** mode, your smart lock will automatically lock the door after **30** seconds.

Auto Lock is enabled by default. You can customize the Auto Lock time delay between **10** and **99** seconds.

- **One-touch Lock**

One-touch Lock is pressing and holding **any button** on the Keypad for **2** seconds **to lock from outside**.



Definitions

- **Wrong Entry Limit**

After **10** times unsuccessful attempts at entering an invalid code, the device will shut down for **3** minutes.

- **Silent Mode**

The beep sounds when pressing Keypad can be muted. But you will still hear low battery and system alerts.

- **Vacation Mode**

This is a security feature for you when you are leaving your home for vacation or a long trip.

Enabling the Vacation Mode will restrict all User Codes until Master Code is entered on the Keypad. If it's unlocked by the Thumb Turn from the inside, the lock will sound an alarm.

» Definitions

- **One-time User Code**

Only one One-time Code can be generated at a time.

It can be used once and will be automatically deleted and become invalid. If not used, it will be overwritten by a new one.

- **Anti-peeping Passcode**

Entering random numbers before or after correct passcode will also unlock the door, which can prevent the passcode being exposed.

The length of anti-peeping passcode should be within 16 digits.

83618 137192 14710

 PASSCODE

 RANDOM DIGITS

Code Format

⚠ Important:

- ▶ Master Code (4 to 10 digits): The Default Master Code is **12345678**. It is required that you change it to a code of your own before programming.
- ▶ User Code (4 to 10 digits): A total of 20 User Codes (including One-time User Code) can be programmed and stored.
- ▶ Neither Master Code nor User Code supports the following combination of numbers.

- A.

1	2	3	4	5	6	7	8	9
---	---	---	---	---	---	---	---	---

 ❌ Forward number sequence
- B.

9	8	7	6	5	4	3	2	1
---	---	---	---	---	---	---	---	---

 ❌ Backward number sequence
- C.

2	2	2	2	2	2	2	2	2
---	---	---	---	---	---	---	---	---

 ❌ Repeat number sequence
- D. If

5	6	8	3
---	---	---	---

 ✓
- Then

5	6	8	3	9	1
---	---	---	---	---	---

 ❌ Contain existing code sequence
- and

9	1	5	6	8	3
---	---	---	---	---	---

 ❌

» FAQ

▶ **Master Code can not be changed.**

Refer to “ **How to Reset** ” section to perform a resetting. If it doesn't solve the issue, please call us at **+1(855)400-3853**.

▶ **Fail to add a new User Code.**

1. Before adding a new User Code, please change the Default Master Code **12345678** to a new one.
2. Make sure the New Master Code has been entered correctly.
3. The lock can only set and store 20 User Codes. A User Code must be at least 4 to 10 digits.

▶ **Battery indicator keeps flashing.**

The battery is low if the battery indicator keeps flashing. Please replace with 4 new batteries for the best performance (Alkaline batteries only).

▶ **I forgot my Master Code.**

Perform a resetting and the Master Code will return to the default one **12345678**.

Need Help? Contact Us!

If you have any questions, please contact us at

 **+1(855)400-3853**

(Monday-Friday 9:00am-5:00pm PST)

 **support@iveise.com**  **iveise.com**

If you have your **order ID, videos or images of your problem** (if necessary) ready before contacting Customer Support, we will solve your problem faster and better.

V2.0