

# Wireless Keypad Instruction Manual



Read Carefully Before Use  
Keep for Future Reference

# SAFETY INFORMATION

- The wireless keypad is intended only for use with gate openers and door systems. **DO NOT** use it for any other purpose.
- Verify that the technical specifications of the keypad match the requirements of your gate opener or door system before proceeding.

# SPECIFICATIONS

<b>Dimensions</b>	3.4×3×1.4 in.	8.5×7.5×3.5 cm
<b>Power Supply</b>	6V DC CR2032 Lithium Battery	
<b>Battery Capacity</b>	230 mAh	
<b>Battery Life</b>	2 years	
<b>Indoor Transmission Range</b>	114 ft. 11 in.	35 m
<b>Outdoor Transmission Range</b>	656 ft. 7 in.	200 m
<b>Operating Frequency</b>	433.92 MHz	
<b>Weatherproof Rating</b>	IP54	
<b>Transmit Power</b>	About 1mW	
<b>Operating Temperature</b>	-4 to 131°F	-20 to 55°C
<b>Net Weight</b>	5.3 oz.	150 g

# INSTALLATION

1. Uncover the keypad by lifting out the metal cover using the square opening at the bottom.



2. Unscrew the hex bolts with a hex wrench (not included) to open the keypad.



3. Make 4 holes on the plate using a power drill or a hammer and nails (not included).



4. Install the keypad on the wall by embedding plastic expansion screws and attaching the plate onto the wall. Replace the keypad, hex screws, and metal cover.



# OPERATION

## Channel 1

1. Enter the password of Channel 1 and press ◀.
2. If the password is correct (the default password is "11"), a coded signal for Channel 1 will be sent and you should hear a long beep will be heard.
3. If the password is incorrect, the buzzer will give 5 short beeps.

## Channel 2

1. Enter the password of Channel 2 and press ▶.
2. If the password is correct (the default password is "22"), a coded signal for Channel 2 will be sent and a long beep will be heard.
3. If the password is incorrect, the buzzer will make 5 short beeps.

# CODE MATCHING

## Channel 1

1. Locate the "learning button" on the gate opener control panel and press it.
2. Input your password on the keypad and press ◀.
3. Re-enter the password and press ◀. If the indicator on the control panel flashes, the code matching process was successful.
4. To confirm the code matching, re-enter the password and press ◀. If the gate opener responds, the code has been successfully matched.

## Channel 2

1. Locate the "code button" on the gate opener control panel and press it.
2. Input your password on the keypad and press ▶.
3. Re-enter the password and press ▶. If the indicator on the control panel flashes, the code matching process was successful.
4. To confirm the code matching, re-enter the password and press ▶. If the gate opener responds, the code has been successfully matched.

# CHANGING THE PASSWORD

## Channel 1

1. Press and hold **0**.
2. Press and release **◀** while you keep holding **0**.
3. Release **0**. The buzzer will emit a long beep, indicating that you have entered the password change state.
4. Input the original password (the default password is "11") and press **◀**.
5. Enter a new password (no more than 8 digits) and press **◀**. If the new password exceeds 8 digits or the new password is inconsistent, the password change error will be displayed and the buzzer will make 5 short beeps. The system will then exit the password change status. If you do not enter a password and press **◀** twice instead, the password will be set to 0 digits, meaning no password. Simply press **◀** to send the encoded signal.
6. Re-enter the new password and press **◀**. The password has been successfully changed, and the buzzer will emit one long beep.

## Channel 2

1. Press and hold **0**.
2. Press and release **▶** while you keep holding **0**.
3. Release **0**. The buzzer will emit a long beep, indicating that you have entered the password change state.
4. Input the original password (the default password is "22") and press **▶**.
5. Enter a new password (no more than 8 digits) and press **▶**. If the new password exceeds 8 digits or the new password is inconsistent, the password change error will be displayed and the buzzer will make 5 short beeps. The system will then exit the password change status. If you do not enter a password and press **▶** twice instead, the password will be set to 0 digits, meaning no password. Simply press **▶** to send the encoded signal.
6. Re-enter the new password and press **▶**. The password has been successfully changed, and the buzzer will emit one long beep.

# RESETTING THE PASSWORD

1. Open the wireless keypad following the installation instructions.
2. Locate and press the **RESET** button.
3. The previous password should now be erased, reverting to the factory password.
4. Follow the manual to set a new password.

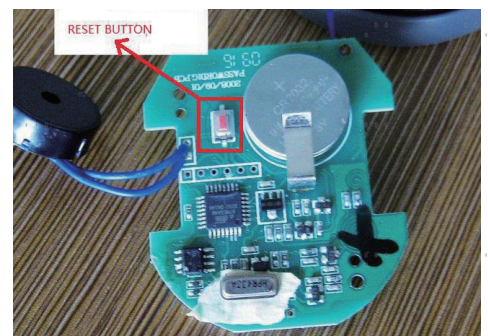

# SERIAL NUMBER AND ENCODING INFORMATION

- The encoding definition uses the standard HCS101 format and has a 28-digit serial number with a limit of 57.
- It's important to note that the serial number will be randomly generated when the device is first used or when the password is reset to its factory value. In these cases, you'll need to perform the code matching process again.
- There are two channels, channel 1 and channel 2, each with their own corresponding serial number and synchronization counter. This means that even if the passwords for the two channels are the same, the serial numbers may be different. If you're using both channels to control one control panel, it's recommended to match the codes separately.

## MAINTENANCE

- Regularly wipe the keypad with a damp cloth to remove dirt and debris that could affect the performance of the buttons. Do not rinse it or use abrasive cleaners or caustic chemicals.

## CONTACT US

Thank you for choosing our products! If you have any questions or comments, contact us at [help@cs-supportpro.com](mailto:help@cs-supportpro.com) and we'll resolve your issue ASAP!

For a .pdf copy of the latest version of these instructions, use the appropriate app on your smartphone to scan the QR code to the right.



W K C - 0 0 0 0 - 0 0  
Rev. 7 Feb. 2023