

E-mail
support@vava.com

Manufacturer: Shenzhen Danya Technology Co.,Ltd.
**Address: Room 3323, Building C, Galaxy World Phase II, Minle Community,
MinZhi Street, Longhua District, Shenzhen, China**

Learn more about the EU Declaration of Conformity:
<https://www.vava.com/pages/user-manual>



Model: VA-IH008
VAVA Smart Thermometer
User Guide

IMPORTANT SAFETY INSTRUCTIONS	01
Package Contents	03
Product Diagram	04
LED Display	05
Use Your Smart Thermometer	06
Alarm Reminds	17
Specifications	20
Cleaning and Maintenance	21
Warranty and Service	21



Thanks for choosing VAVA Smart Thermometer.
Please read this User Guide thoroughly
before use and retain it for future reference.

IMPORTANT SAFETY INSTRUCTIONS

VAVA

CAUTION

- Please read this User Guide carefully and operate correctly as instructed in the User Guide.
- Never try to disassemble this product by yourself. Non-professional maintenance or dismantling of the spare parts are not allowed.
- Do not place and use this product under high temperature or humidity. Do not expose it to the sun. (Operating Temperature: -10~50°C / 14~122°F; Storage Temperature: -20~60°C / -4~140°F).
- To reduce the risk of fire or explosion, do not expose the product to rain or fire.
- Stop using immediately if leakage or deformation occurs. Please email us at support@vava.com.
- Rinse out with clean water immediately if leakage enters the eyes by accident. Severe cases shall be immediately to the hospital for medical treatment.
- Use original or authorized charging device only to avoid abnormalities.
- Do not cut up or impale the thermometer battery to avoid any short circuit.
- Dispose this product as per local law and regulations.
- NOT toys. Do not allow children to play with this product.
- Do not place this product under the conditions of fire or high temperature (extremely hot).

IMPORTANT SAFETY INSTRUCTIONS



- Do not forcefully press, knock or rip this product apart.
- For high fever or continuous fever, please seek medical attention immediately.
- Children must always be supervised and never left unattended when using this thermometer. Contains small parts that can cause a choking hazard. Keep out of the reach of small children.
- The body temperature measured is for reference only, not for medical judgment.
- Stop using immediately if the thermometer has been damaged in any manner.
- Stop using the thermometer with abnormal heat.
- Not sterilized.
- Wipe and dry the armpit before use.
- When measuring the body temperature, make sure the temperature sensor is pointed to the armpit central. Lower the arm and sag naturally to closely attach it to the skin.
- If allergic reaction occurs, stop using and seek medical attention immediately in severe cases.
- When the non-woven tape has been used for a long time or cannot be closely attached to the skin, please replace with a new one.

READ AND SAVE THESE INSTRUCTIONS

Package Contents



1 x Storage Box



1 x Temperature Patch



10 x Non-woven Tape



1 x Travel Pouch

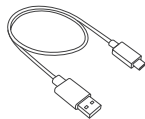

1 x Type-C Charging Cable



1 x User Guide



1 x Quick Start Guide

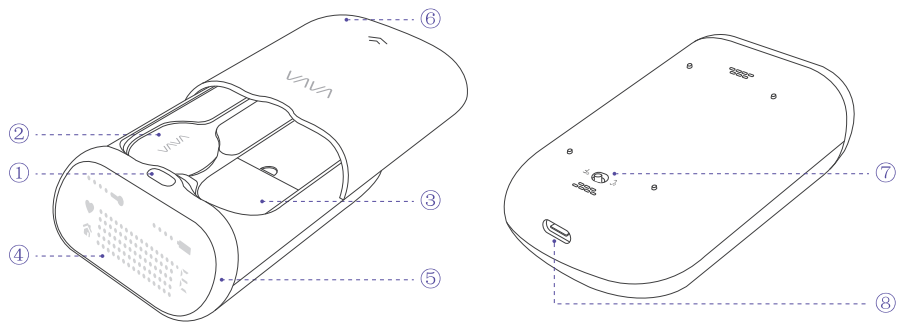

- ① Power Button
- ② Temperature Patch
- ③ Non-Woven Tape
- ④ LED Display
- ⑤ Alarm Ring
- ⑥ Storage Box
- ⑦ °C / °F Switching Button
- ⑧ Type-C Charging Port

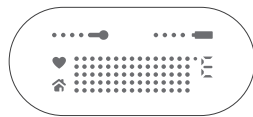

LED Display Symbols

Symbol	Meaning
♥	Body Temperature Mode
🏠	Ambient Temperature Mode
••••—	Temperature Patch Charging Indicator
••••—	Storage Box Charging Indicator
100.0°F	Temperature in °F (Fahrenheit)

88.0°C	Temperature in °C (Celsius)
OFF	Turn OFF
	Body Temperature Mode: ≥ 42°C (107.6°F) Ambient Temperature Mode: ≥ 40°C (104°F)
	Body Temperature Mode: ≤ 25°C (77°F) Ambient Temperature Mode: ≤ 0°C (32°F)
FALL	Fall Off Alarm
⚡	Disconnection Alarm
🔋	Battery Low

1. Turning ON the Smart Thermometer

• Storage Box

Press and hold the Power Button, all the icons on the LED display will light up, correctly showing the ambient temperature and the battery level of both storage box and temperature patch.

• Temperature Patch

Take the temperature patch out of the storage box, it will be turned on automatically with LED indicator (on the temperature patch) flashing 3 times.

2. Pairing

- Take out the temperature patch, it will pair with the storage box automatically.
- Successfully paired: LED Display shows the Body Temperature Mode (Body Temperature Mode indicator on).

Note:

If the temperature patch failed to pair with the storage box automatically, please re-pair as instructed below:

- 1) Put the temperature patch back in the storage box.
- 2) Press and hold the Power Button to turn off the storage box.

- 3) Connect the storage box to the USB charging adapter, it will be powered on automatically.
- 4) Press and hold the Power Button for 3S, “bo” displays on the LED Display. Take out the temperature patch, it will pair with the storage box automatically within 10 seconds.
- 5) Once successfully paired, Body Temperature Mode indicator will light up on the LED Display.

3. Body Temperature Measurement

• Paste Non-Woven Tape on Temperature Patch

- 1) Take out one piece of non-woven tape, put the temperature patch through the hole of the non-woven tape.

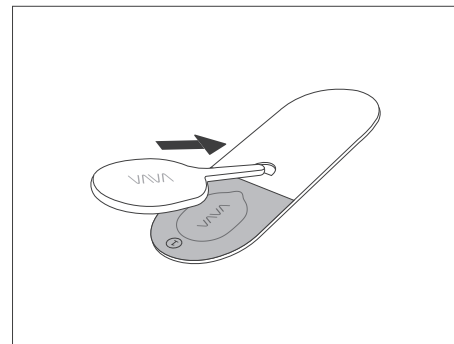

Use Your Smart Thermometer



Rip off the release paper ①, then paste it to the back side of the temperature patch.

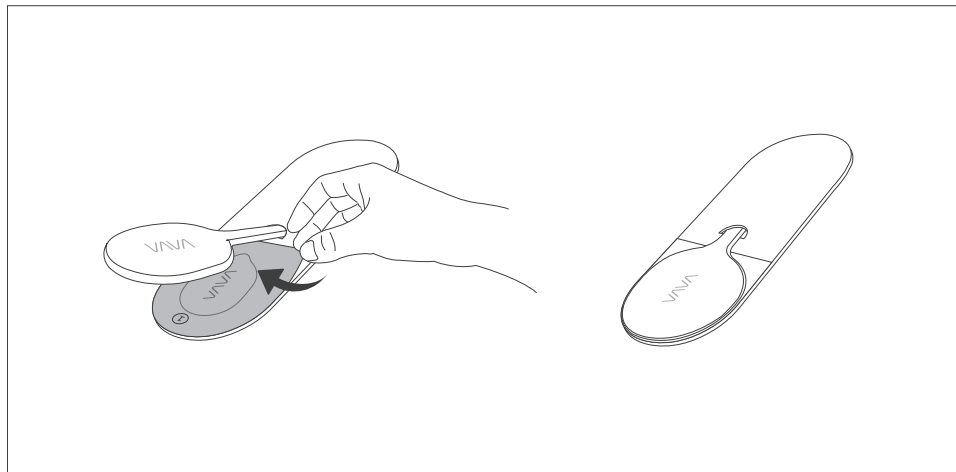

Use Your Smart Thermometer



2) Rip off the release paper ② and ③, then fix the temperature sensor on the back side of the non-woven tape.

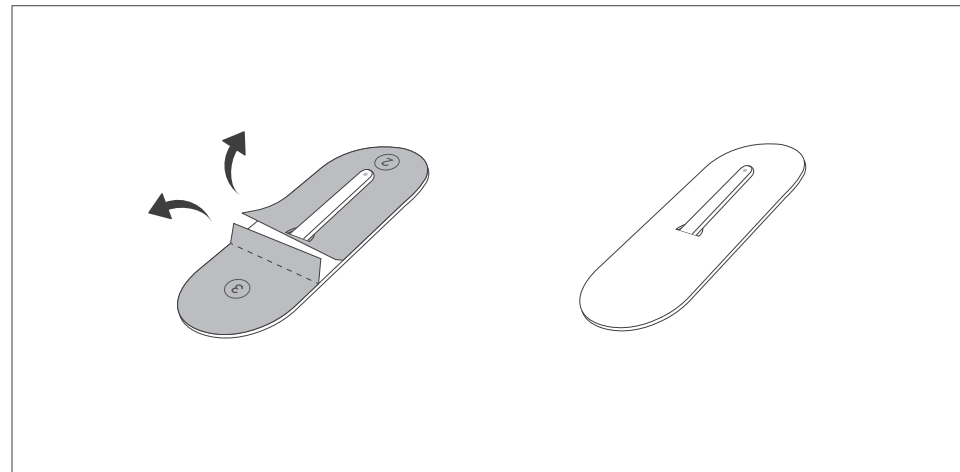

Use Your Smart Thermometer



• Measure the Body Temperature

- 1) Paste the fixed temperature sensor to the armpit, and lightly press to make sure it is closely attached to the skin.

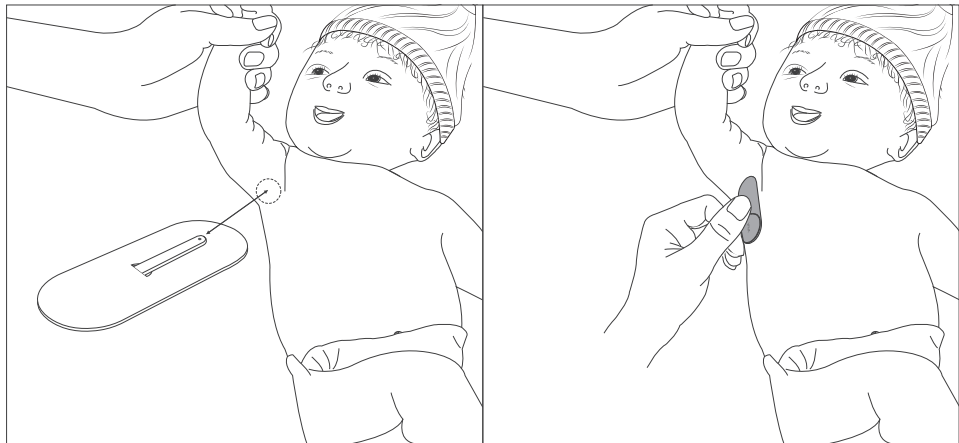

Use Your Smart Thermometer



- 2) Lower the arm and sag naturally. The temperature patch will start measuring the body temperature with the ♥ flashing on the LED display.
- 3) After the ♥ on the LED display stops flashing, you can read the accurate body temperature.

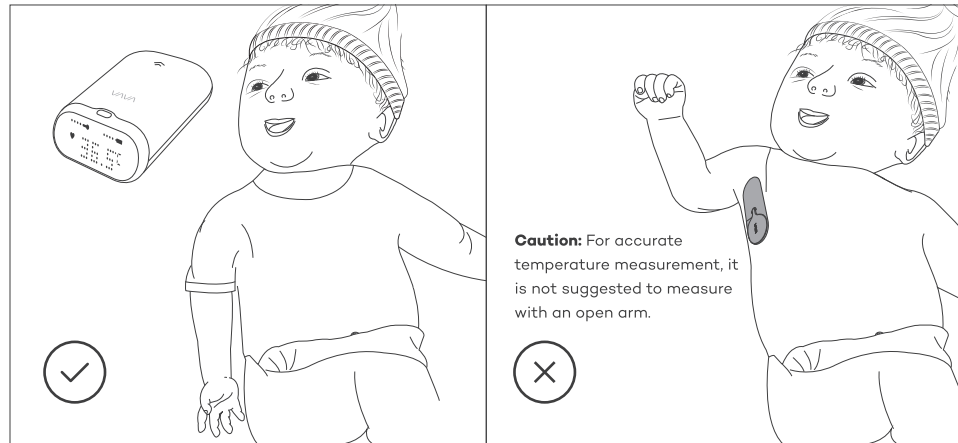

4. Ambient Temperature Detection

- Place the temperature patch back into the storage box with the metal patch facing down.
- At this point, the LED display starts to show the ambient temperature.

button once to turn on/off the LED display.

- When the body temperature is displayed on the LED display for more than 15 minutes, the LED display will turn off automatically. Press the Power button once to turn on/off the LED display.

5. Switching between °C and °F

Toggle the switch button on the bottom of the storage box to switch between °C and °F.

6. LED Display Auto OFF

- When the ambient temperature is displayed on the LED display for more than 1 minute, the LED display will turn off automatically. Press the Power

7. Auto Power OFF

- When the LED display is turned off for more than 1 hour, the storage box will power off automatically. To power it on, please press and hold the Power Button or connect the storage box to the USB charging adapter.
- The Temperature Patch will not power off automatically under body temperature measurement (except for low battery power off).

8. Charging

• Storage Box

- 1) Connect the storage box to the USB charging adapter via the included Type-C charging cable.

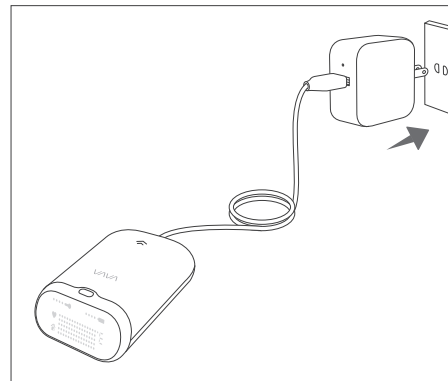

- 2) The charging indicators on the top right corner of the LED display will light up progressively indicating the charging status.

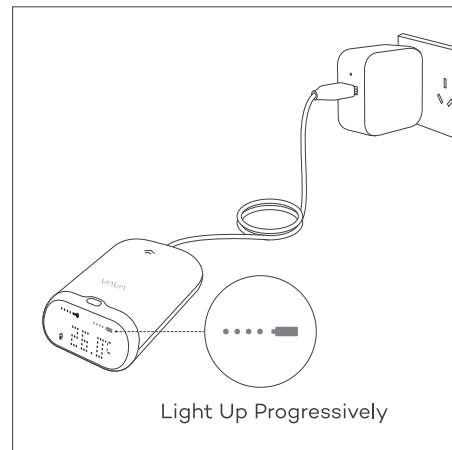

Use Your Smart Thermometer

VAVA

- 3) Once fully charged, the charging indicator will stay solid on.

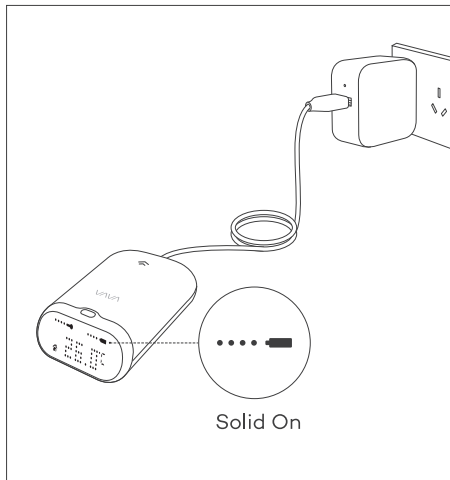

• Temperature Patch

- 1) Slide to open the storage box.

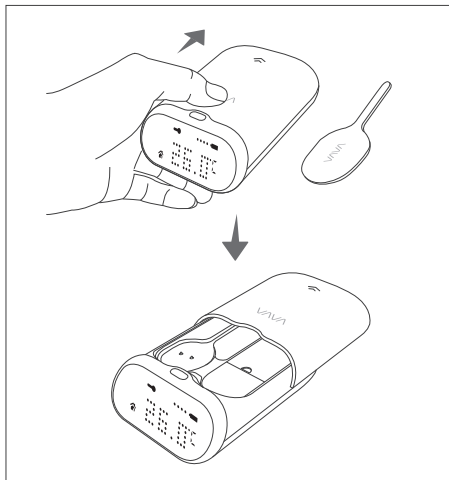

Use Your Smart Thermometer

VAVA

- 2) Place the temperature patch in the storage box with the charging contacts aligned.

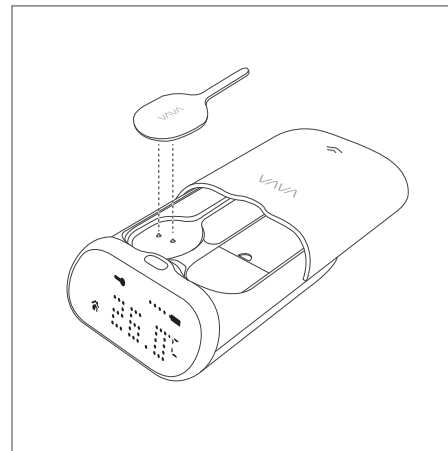

- 3) Slightly press the temperature patch until the charging indicators on the top left corner of the LED display light up progressively indicating the charging status.

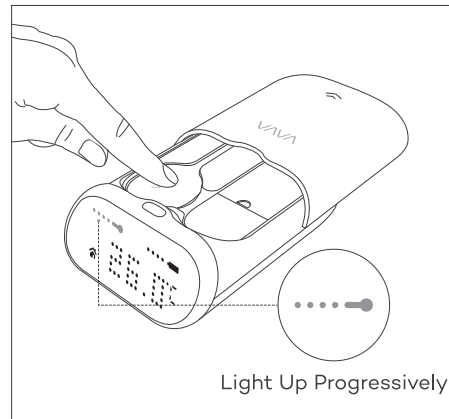

Use Your Smart Thermometer



4) Once fully charged, the charging indicator will stay solid on.

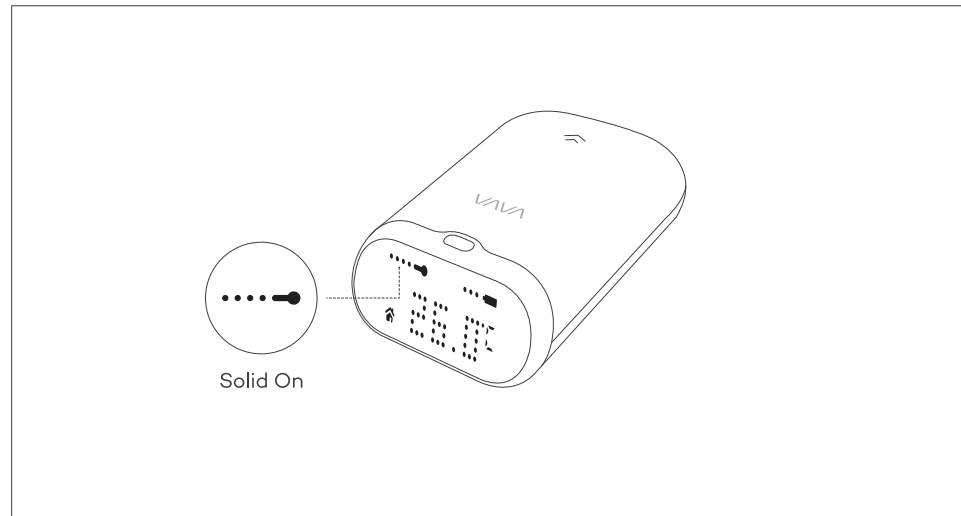





Alarm Reminds



Alarm	Trigger Condition	Reminder
Fever Alarm	Temperature reaches 37.5°C (99.5°F) or above	<ul style="list-style-type: none">· Fever alarm will be triggered with beep sound + current temperature flashing every 2 seconds.· To cancel the alarm, manually press the Power button.· If the temperature keep rising every 0.5°C (32.9°F), the fever alarm will be re-triggered.
High Fever Alarm	Temperature reaches 39°C (102.2°F) or above	<ul style="list-style-type: none">· High fever alarm will be triggered with beep sound + alarm ring flashing red + current temperature flashing every 2 seconds.· To cancel the alarm, manually press the Power button.· If the temperature keep rising every 0.5°C (32.9°F), the high fever alarm will be re-triggered.
Battery Low 	Temperature patch in low battery	<ul style="list-style-type: none">· The last charging indicator on the top left corner of the LED display will flash every 2 seconds with beep sound.· To cancel the alarm, put the temperature patch back to the storage box for charging, or manually press the Power button.





Alarm Reminds



Alarm	Trigger Condition	Reminder
Battery Low 	Storage box in low battery	<ul style="list-style-type: none"> The last charging indicator on the top right corner of the LED display will flash every 2 seconds with beep sound. To cancel the alarm, connect the storage box for charging, or manually press the Power Button.
Disconnection Alarm 	Temperature patch disconnected with storage box	<ul style="list-style-type: none"> The LED display will show  every 2 seconds with beep sound. To cancel the alarm, place the temperature patch within 15-meter range of the storage box, or manually press the Power button.
Fall Off Alarm 	Temperature detected drops below 32°C (89.6°F)	<ul style="list-style-type: none"> The LED display will keep flashing "FALL" until the temperature returns to normal with beep sound every 1 second. To cancel the alarm, manually press the Power button.

Alarm Reminds



Alarm	Trigger Condition	Reminder
	Body Temperature Mode: 42°C (107.6°F)	<ul style="list-style-type: none"> High fever alarm will be triggered "HI" + current body temperature flashing alternately
	Ambient Temperature Mode: $\geq 40^{\circ}\text{C}$ (104°F)	"HI" + current ambient temperature flashing alternately
	Body Temperature Mode: $\leq 25^{\circ}\text{C}$ (77°F)	"LO" + current body temperature flashing alternately
	Ambient Temperature Mode: $\leq 0^{\circ}\text{C}$ (32°F)	Keep flashing "LO"

Specifications



Temperature Patch

Accuracy	±0.1°C/0.2°F
RF Transmitting Power	<4dbm
Connection Range	Up to 15m / 49ft
Input	DC 5V \pm 20mA
Charging Time	1.5 hours
Battery	20mAh Li-Po battery
Operating Time	Up to 24 hours
Temperature Range	25°C-42°C / 77°F -107.6°F

Storage Box

Accuracy	±1°C/1.8°F
Connection Range	Up to 15m / 49ft
Input	DC 5V \pm 1500mA
Charging Time	2 hours
Battery	2000mAh Li-Po battery
Operating Time	Up to 72 hours
Temperature Range	0°C-40°C / 32°F -104°F

Cleaning and Maintenance

- Use a soft cloth to gently clean the thermometer.
- DO NOT immerse the Storage Box in water.
- DO NOT clean the thermometer with detergent or chemicals.
- Keep the thermometer clean and dry. Store it in a cool, dry place.
- You can use the pad saturated with 75% ethanol alcohol to wipe the thermometer.

Warranty and Service

This product is covered with VAVA product and labor warranty for 12 months from the date of its original purchase. If any problems occur, please contact the VAVA Customer Care Centre in your country via the contact information listed in this User Guide.

We can only provide after sales service for products that are sold by VAVA or VAVA authorized retailers and distributors. If you have purchased your unit from a different place, please contact your seller for return and warranty issues.

FCC Compliance



NOTE: This equipment has been tested and found to comply with the limits for a Class B digital device, pursuant to part 15 of the FCC Rules. These limits are designed to provide reasonable protection against harmful interference in a residential installation. This equipment generates uses and can radiate radio frequency energy and, if not installed and used in accordance with the instructions, may cause harmful interference to radio communications. However, there is no guarantee that interference will not occur in a particular installation. If this equipment does cause harmful interference to radio or television reception, which can be determined by turning the equipment off and on, the user

is encouraged to try to correct the interference by one or more of the following measures:

- Reorient or relocate the receiving antenna.
- Increase the separation between the equipment and receiver.
- Connect the equipment into an outlet on a circuit different from that to which the receiver is connected.
- Consult the dealer or an experienced radio/TV technician for help

Changes or modifications not expressly approved by the party responsible for compliance could void the user's authority to operate the equipment.

This device complies with Part 15 of the FCC Rules. Operation is subject to the following two conditions:

- (1) this device may not cause harmful interference, and
- (2) this device must accept any interference received, including interference that may cause undesired operation.

WEEE Compliance



WEEE Compliance

Correct Disposal of This Product (Waste Electrical & Electronic Equipment) (Applicable in countries with separate collection systems) This marking on the product, accessories or literature indicates that the product and its electronic accessories should not be disposed of with other household waste at the end of their working life. To prevent possible harm to the environment or human health from uncontrolled waste disposal, please separate these items from other types of waste and recycle them responsibly to

promote the sustainable reuse of material resources. Household users should contact either the retailer where they purchased this product, or their local government office, for details of where and how they can take these items for environmentally safe recycling. Business users should contact their supplier and check the terms and conditions of the purchase contract. This product and its electronic accessories should not be mixed with other commercial wastes for disposal.

FCC Warning

This device complies with Part 15 of the FCC Rules. Operation is subject to the following two conditions:

(1) This device may not cause harmful interference, and (2) this device must accept any interference received, including interference that may cause undesired operation. NOTE 1: This equipment has been tested and found to comply with the limits for a Class B digital device, pursuant to part 15 of the FCC Rules. These limits are designed to provide reasonable protection against harmful interference in a residential installation. This equipment generates, uses and can radiate radio frequency energy and, if not installed and used in accordance with the instructions, may cause harmful interference to radio communications. However, there is no guarantee that interference will not occur in a particular installation. If this equipment does cause harmful interference to radio or television reception, which can be determined by turning the equipment off and on, the user is encouraged to try to correct the interference by one or more of the following measures:

- Reorient or relocate the receiving antenna.
- Increase the separation between the equipment and receiver.
- Connect the equipment into an outlet on a circuit different from that to which the receiver is connected.
- Consult the dealer or an experienced radio/TV technician for help.

NOTE 2: Any changes or modifications to this unit not expressly approved by the party responsible for compliance could void the user's authority to operate the equipment. The device has been evaluated to meet general RF exposure requirement. The device can be used in portable exposure condition without restriction.