

Bluetooth Audio Transmitter and Receiver 2 in 1

Apt-X Low Latency
Bluetooth 4.1
Stereo HIFI Music



Product description:

The audio transceiver is a wonderful audio devices with the latest new technology "Aptx Low Latency" codec for bluetooth high quality audio streaming.

It is very easy and simple to use and enables any Bluetooth enabled music device to connect to both Bluetooth and non-Bluetooth devices, you may play the music via the non-Bluetooth speaker wirelessly or just enjoy the music from the TV to headphone wirelessly. This transceiver enables you to enjoy the music at any time and any place you want to play with it.

Product overview:

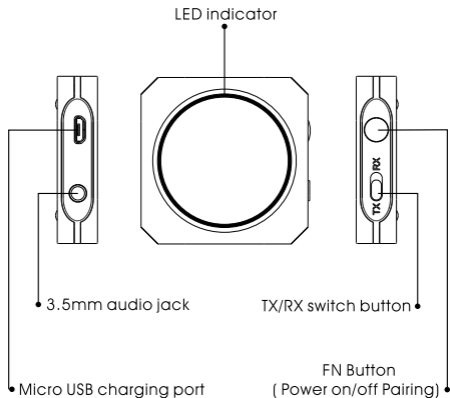

Packaging included

1. Transceiver ZW-420
2. User manual
3. 3.5mm to 3.5mm audio cable(Long)
4. 3.5mm to RCA audio cable
- 5.USB charging cable
- 6.3.5mm to 3.5mm audio cable(Short)

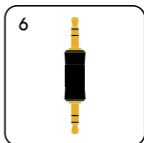
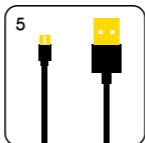
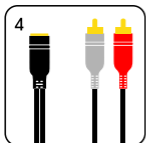
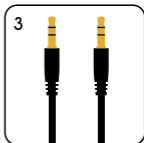
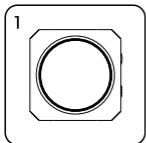

NOTE:

1. The device can be used when charging.
2. If there is no connection in 5 mins, the transceiver will power off.
3. We suggest fully charging the device at least once every two months.

Use as a receiver

1. Push the click button to RX mode from TX/RX position before power on the device.
2. Long press the FN button 4 sec to power on the device and then go to pairing mode with Blue and Red LED light flashing slowly.

3. Turn on the Bluetooth of your smartphone and search "Bluetooth Transceiver" click on and establish the connection.

4. Connect the transceiver to the audio input port of home Hi-Fi stereo system via the audio cable.

5. Connect with 2 different smartphone with the transceiver
a. After the connection with the first device, please turn off the bluetooth of your first smartphone. Then the transceiver goes into pairing mode, now turn on the bluetooth of your second smartphone to establish the connection.

b. turn on the bluetooth of your first smartphone, click "Bluetooth Transceiver" on your smartphone to establish the connection. Now the transceiver is connected with 2 smartphone.

Note: If the connection with 2 devices are not successful, you may try to connect with them manually:

1) Connect with the transceiver with the first smartphone

2) press FN key for 2 seconds, the transceiver goes into pairing mode.

3) turn on the bluetooth of your second smartphone, search "Bluetooth Transceiver" and click to establish the connection.

4) click "Bluetooth Transceiver" on the first smartphone to connect with the device again.

Note: It is not possible for 2 smartphones play music at the same time, default setting is the one which play music first. If you want to play music with the second smartphone, click pause on the first smartphone and then play music with the second one after 2-5 seconds.

After successful connection with the transceiver, the blue LED light will long time on.

The transceiver will power off if there is no connection within 5 mins

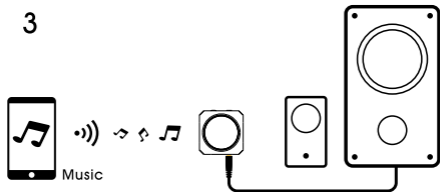
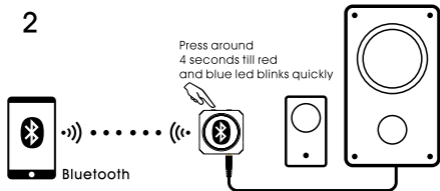
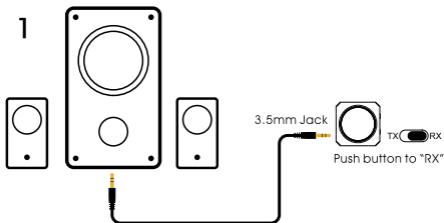

Use as a receiver(scene 1)

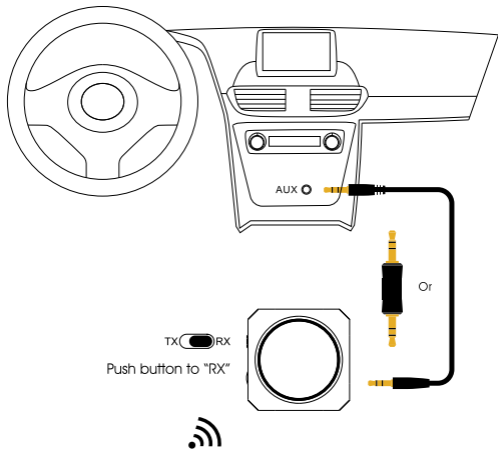

Connect with car stereo

Use as a receiver(scene2)

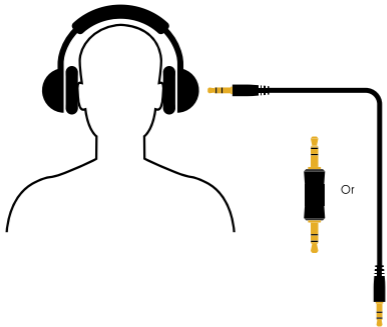

Or

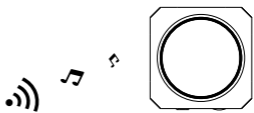

TX RX

Push button to "RX"

Connect with headphone



Use as a receiver(scene 3)

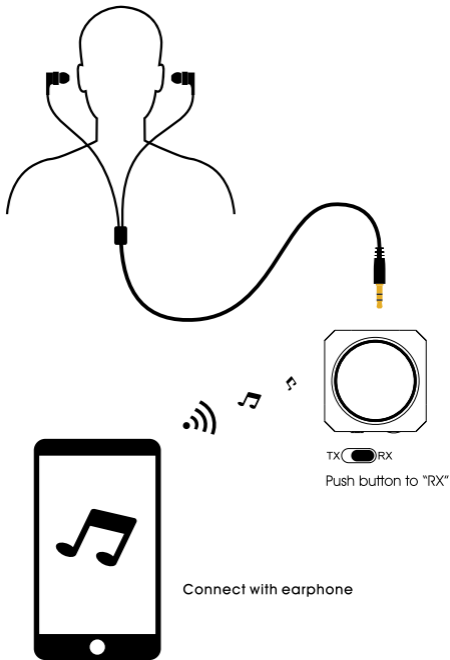

1

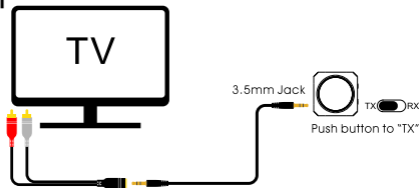

2

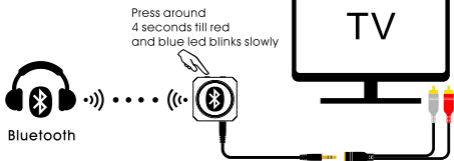

3

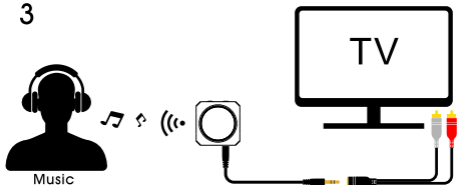

Use as a transmitter

1. Push the click button to TX mode from TX / RX position before power on.
2. Long press the button 4 sec to power on the device and then go to pairing mode when the Red and Blue LED light flashing.
3. Power on the bluetooth headset and once the connection is done, the blue LED light will long time on.
4. Connect the transceiver to the audio input port of home Hi-Fi stereo system via the audio cable
5. If you want to connect with the second headset, please power off the first headset and the transceiver, then power on the second headset and the transceiver again to do the pairing. Once the pairing is complete, please turn on the first headset and then it will re-connect with it automatically.

Note:

When transferring the TX/RX mode to RX/TX mode, please wait for 2-3 secs after power on the transceiver, otherwise it will power off.

Because of the different technology to be used on headset, it is better for you to use the same model when trying to connect with the transceiver for dual connection. Otherwise, it may happens that only one headset will be available.

The blue LED will long time on if the connection is complete. The transceiver will power off if there is no connection within 5 mins.

To take advantage of the better performance of the Apt-X

Low Latency Codec, the receiver must support the same codec. Otherwise other Codecs will be used instead. Due to Apt-X technology limitation, Apt-X Low Latency Codec does NOT support under dual link.

Charging the battery

The device use rechargeable lithium-ion battery. Only approved cable can be used for charging. It takes estimate about 2 hours to fully charge the battery. During charging, it will show red led indicator light. After finished charging, the red led indicator light will goes off. You can remove the usb charging cable from the device after fully charged. Notice: When the transceiver battery power is low, the red led light will be flashing and the blue led light long time on, the transceiver may work abnormally. You need to recharge the battery at this time.

Product Specification

- . Bluetooth 4.1
- . Bluetooth IC: CSR8670
- . Bluetooth profile supported: A2DPV1.2, APTX APTX Low Latency and AVRCP
- . Supported codec: aptX , SBC
- . Operation range: Class 2, 10 meters
- . TX mode working time: up to 15 hours
- . RX mode working time: up to 12 hours
- . Standby time: up to 450 hours
- . Charging time: about 2-3 hours
- . Charging input voltage: DC 5V
- . Battery: 350mAh rechargeable Lithium-ion battery

- . Weight: 20g
- . Size: 50mm(L)X50mm(W)X12mm(H)

The working and standby times may vary when used with different mobile phones or other compatible Bluetooth devices, usage settings, usage styles and environments.

Maintenance

Do not attempt to disassemble the device or replace rechargeable battery. Doing so will void the warranty.

The battery will discharge if stored for a long period of time without usage.

Use the specified USB charging cable. Disconnect the device after the battery has been fully charged.

Overcharging the battery will shorten the life span of the battery.

Do not expose the device in extreme heat or cold. Extreme temperatures will shorten the life span of the battery.

Use only a damp cloth with mild soap to clean the device. Solvents and other cleaning agents may cause damage to the device

Disposal



Always dispose of the used appliance at a recycling center. Do not dispose of the used appliance with the household waste.

Note:

The connection can be subject to interference from obstacles, like walls, metals, or other electronic devices. Please kindly make sure there is no obstacle between the transceiver and the device during operation.

In line with the policy of continued development, the manufacturer reserves the right to amend the specifications without prior notification. The illustrations in the user manual are for reference only. Please operate according to the actual object.

Website: www.zoweetek.com

Email: info@zoweetek.com

Contact: +86-755-85251755

Add: 4/F, Block 1, Zhongkenuo Industrial Park, Hezhou Industrial Zone, Xixiang, Baoan District, Shenzhen, China