



**RainPoint**<sup>®</sup>  
More Than Water Saving

# USER MANUAL

## Smart Soil Moisture Sensor

Model No. TCS024B



Save the user manual for future reference. If you have any questions, please contact us to get support.

# Contents

<b>1. Contents in the box</b>	<b>01</b>
<b>2. Introduction</b>	<b>02</b>
2.1 Product Overview	02
2.2 Specification	03
2.3 Product Features	03
<b>3. Connection And Installation</b>	<b>03</b>
3.1 Installing the APP	03
3.2 Connecting the Soil Moisture Sensor	04
<b>4. APP Programming</b>	<b>09</b>
4.1 Product Overview	09
4.2 Device Home Page	10
4.3 Plant List	11
4.4 Customized Settings	12
4.5 Home Management	13
4.6 Reset The Device	14
<b>5. Troubleshooting</b>	<b>15</b>
<b>6. Warranty Policy</b>	<b>16</b>
<b>7. FCC Statement</b>	<b>16</b>
<b>8. Customer Support</b>	<b>18</b>

# 1. Contents in the box



1

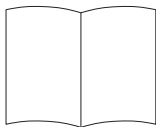

2

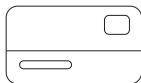

3

1. TCS024B Smart Soil Moisture Sensor
2. User Manual
3. Warranty Card

## 2. Introduction

### 2.1 Product Overview

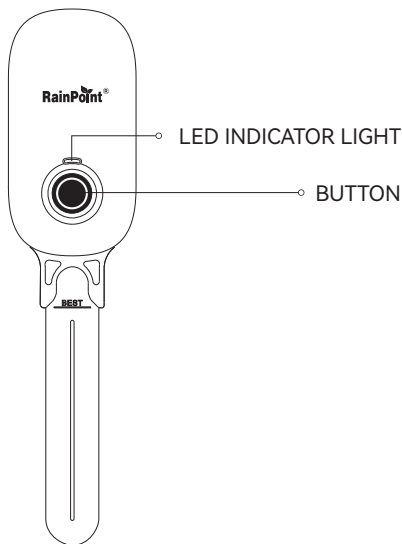

### Button Function

- Hold the button to enter connection mode.
- Press the button to make a real-time detection and the result will be shown on the APP.

## 2.2 Specification

- **Waterproof Level:** IP54
- **Temperature Range:** 37.4°F-122°F (3°C-50°C)
- **Moisture Range:** 0%RH-100%RH
- Communication by Bluetooth
- Powered by 3\*AAA batteries (Not included)

## 2.3 Product Features

- Measures soil moisture (%) and air temperature (°C/°F).
- App control for easy setup and operation.
- Used in indoor planters, learning more about areas of soil information.
- When the batteries are low, a short press on the button will cause the red light to flash rapidly for 3 times. The device will not perform any detection, and the app will display a low battery indication.

# 3. Connection And Installation

## 3.1 Installing the APP

1. **Download the RainPoint APP**  
Search for "**RainPoint**" on Google Play/App Store or scan the QR code to download the RainPoint APP.

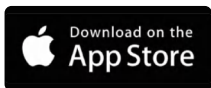

iOS/Android

2. **Register your RainPoint account**  
Open your RainPoint APP, select **"Set Up"**, and then follow the prompts to register a RainPoint account with your email or mobile phone.

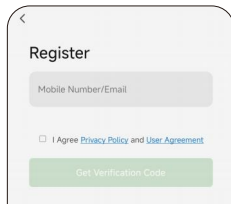

## 3.2 Connecting the Soil Moisture Sensor

### 3.2.1 Connecting the Soil Moisture Sensor to the RainPoint APP

- a. After account created, in the home page of the APP, click **+** on the top right corner, or then click **"Add Device"** to search and add devices.
- b. Tap **"Smart Irrigation"**, then select **"Bluetooth Soil Moisture Sensor"**.

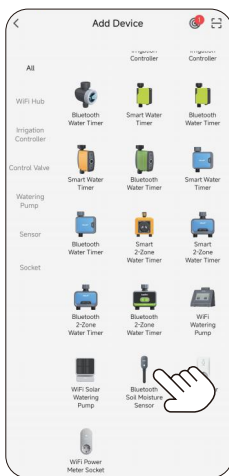
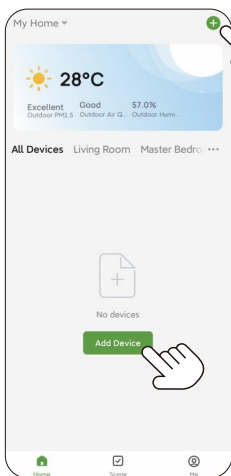

**Note:** Before adding the soil moisture sensor, please turn on the Bluetooth for pairing.

c. Installing the Battery.

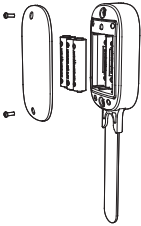

- ① Remove the battery cover from the back of the unit with a screwdriver.

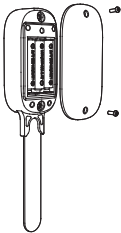

- ② Insert the battery, close the battery cover and tighten the screws.

- d. After the battery is correctly installed, the green LED indicator will start flashing rapidly (**2 times per second**) to enter pairing mode automatically, make sure the Bluetooth has been opened, and tap **"Next"**.  
Then select **"Make sure the device is in the state of network distribution"** and tap **"Next"**.

**Tips:** Besides that, you can also hold the button for 5 seconds to reset and reconnect if you fail to connect for the first time. (Please refer to the "RESETTHE DEVICE" to reset the soil moisture sensor)

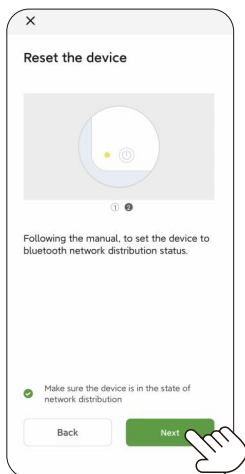
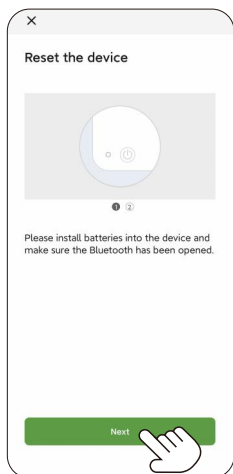

- e. Click **"Add"** on the right.

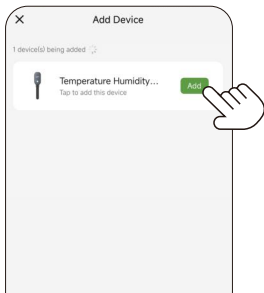

- f. When the check mark appears, click **"Done"** to complete the connection.

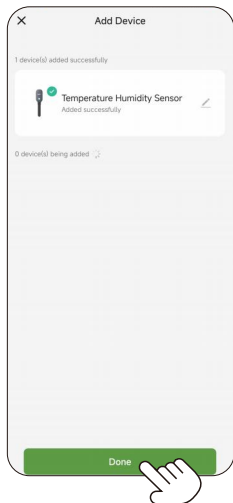

**NOTE:** If necessary, the Bluetooth soil moisture sensor can be paired with an intelligent gateway (Model:TWG009BW) to become a WiFi soil moisture sensor for remote control. The WiFi soil moisture sensor can also be paired with a water timer (Model: TTV102B) for smart watering.

### 3.2.2 Installing the Soil Moisture Sonser

If your soil is soft, insert the device in the "BEST" position.  
If your soil is hard, dig a hole and bury the device in the "BEST" position.

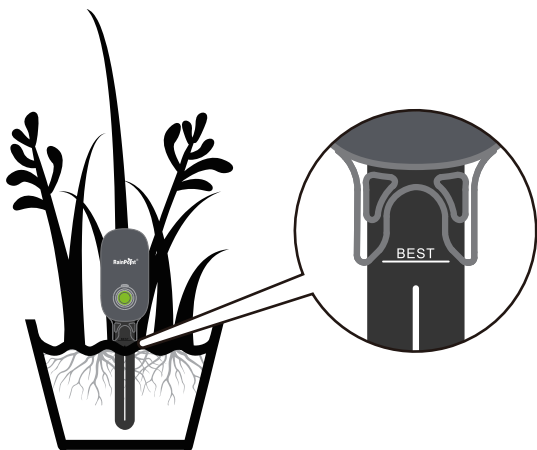

## 4. APP Programming

### 4.1 Product Overview

#### Local Weather Forecast

Get your local weather forecast from website to realize intelligent watering.

#### All Devices

A check list of all the devices you have connected. Tap to enter the operation page of devices you have added to program the operation schedule of the device.

#### Home Management

You can locate your home, customize the home name and add family members. It is convenient for you to manage irrigation schedules for different residences.

#### Scene

On the "Scene" screen, there is "Tap-To-Run" and "Automation" functions. You can automate multiple smart products by setting conditions and tasks.

#### Add Devices

You can add multiple RainPoint devices on the APP to create a smart home irrigation system.

#### Room Management

Room Management is for indoor automatic irrigation system in different room.

#### Me

On the "Me" screen, there is "Message Center" and "FAQ & Feedback" functions. You will receive water leak and low battery alerts on "Message Center". And you can get FAQ and report issue on "FAQ & Feedback".

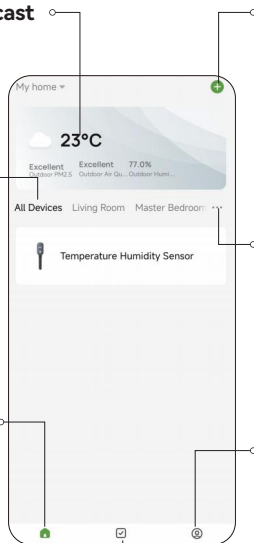

## 4.2 Device Home Page

Select the Bluetooth soil moisture sensor to go to the device home page. There are many data and functions as follows:

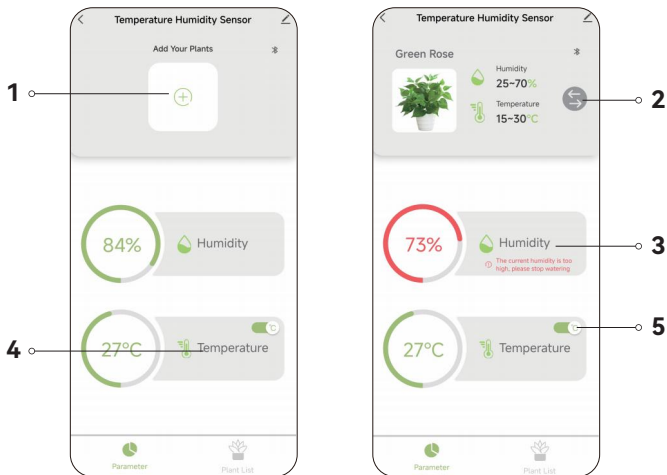

1. Quickly add
2. Switch plants
3. Current soil moisture
4. Current air temperature
5. Celsius degree/Fahrenheit switching

## 4.3 Plant List

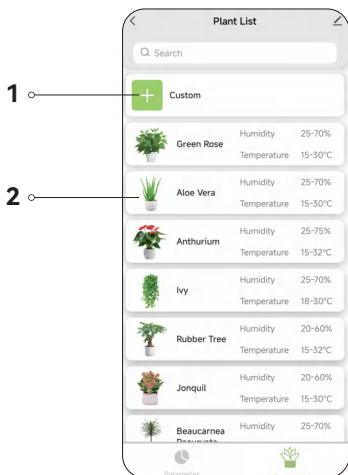

1. Add customized plants
2. Add a system of plants, there are twenty to choose from.

## 4.4 Customized Settings

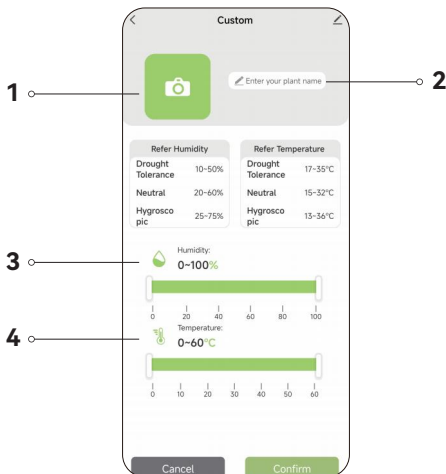

1. Click here to take a picture or upload a picture of the plant.
2. Enter the name of the plant.
3. Set the appropriate humidity range for the plant (Refer to the above data when setting).
4. Set the appropriate temperature range for the plant (Refer to the above data when setting).

## 4.5 Home Management

1. Tap **"Me"** at the bottom of the APP home screen.
2. Select **"Home Management"**.
3. Set your home name, room management and home location.

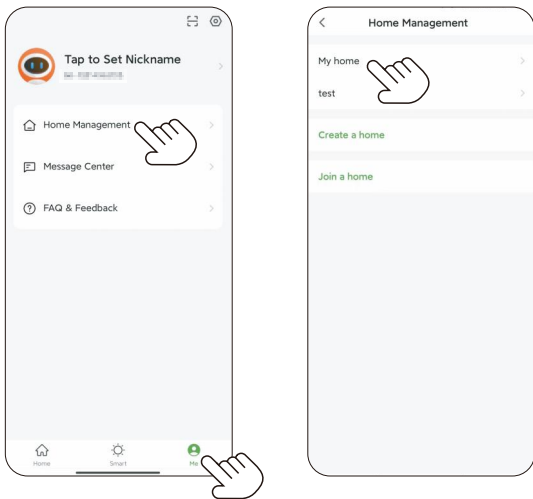

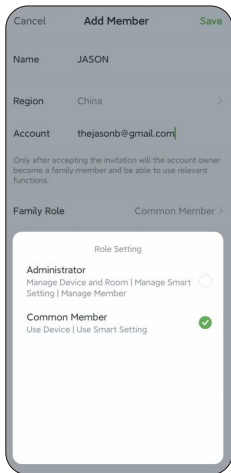
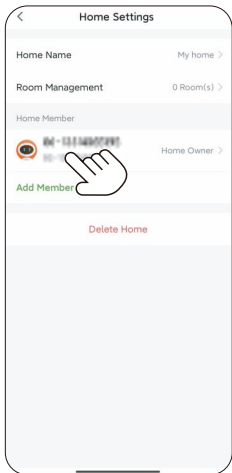

## 4.6 Reset The Device

### How to reset the smart soil moisture sonser?

#### Method One:

Remove all batteries from the battery compartment. After 10 seconds, insert 3 fresh AAA(1.5V) alkaline batteries into the battery compartment of the soil moisture sensor, then the green LED indicator quickly flashes (2 times per second), which means it enters to pairing mode.

#### Method Two:

Press and hold the button on the soil moisture sensor for about 5 seconds until the green LED indicator quickly flashes (2 times per second), then the Bluetooth soil moisture sensor is restored to pairing mode.

## 5. Troubleshooting

<b>Problem</b>	<b>Possible Factors</b>	<b>Solution may help</b>
Data inaccurate or incorrect.	Stones around the sensor.	Please ensure that there are no stones around the sensor while burying it to avoid any interference with the accuracy caused by the presence of stones.
No display on the screen.	Batteries are low.	Replace brand new alkaline batteries.
Sensor drains batteries quickly.	The cause of the battery itself.	<ul style="list-style-type: none"><li>• Test a new set of alkaline batteries. Write down the date of installation and the voltage of the batteries. When the batteries fail, please note the date and voltage again.</li><li>• Check for leaking batteries, which may damage the sensor.</li><li>• It is recommended to use reputable brands of alkaline batteries, which can provide a battery life of over 24 months.</li></ul>
Device cannot be connected.	<ul style="list-style-type: none"><li>• Distance between device and phone is too far.</li><li>• Bluetooth not turned on.</li></ul>	<ul style="list-style-type: none"><li>• Keep the distance between the phone and soil moisture sonser close while connecting.</li><li>• Please turn on your phone's Bluetooth on to pair with the device.</li></ul>

## 6. Warranty Policy

RainPoint provides a 1-year limited warranty on this product against manufacturing defects in materials and workmanship.

- Warranty service can only be performed by our authorized service center. The original dated bill of sale must be presented upon request as proof of purchase to us, or our authorized service center.
- To receive warranty service, the purchaser must contact with RainPoint nominated service center for the problem determination and service procedure.

Thank you for your choice of RainPoint products!

## 7. FCC Statement (FCC ID: 2AWDBTCS024B)

This device complies with Part 15 of the FCC Rules. Operation is subject to the following two conditions:

1. This device may not cause harmful interference.
2. This device must accept any interference received, including interference that may cause undesired operation.

**FCC Warning:** Any changes or modifications not expressly approved by the party responsible for compliance could void the user's authority to operate this equipment.

**Note:** This equipment has been tested and found to comply with the limits for a Class B digital device, pursuant to Part 15 of the FCC Rules. These limits are designed to provide reasonable protection against harmful interference in a residential installation. This equipment generates, uses, and can radiate radio frequency energy, if not installed and used in accordance with the instructions, may cause harmful interference to radio communications. However, there is no guarantee that interference will not occur in a particular installation. If this equipment does cause harmful interference to radio or television reception, which can be deter

mined by turning the equipment off and on, the user is encouraged to try to correct the interference by one of the following measures:

- Reorient or relocate the receiving antenna.
- Increase the separation between the equipment and the receiver.
- Connect the equipment into an outlet on a circuit different from that to which the receiver is connected.
- Consult the dealer or an experienced radio/TV technician for help.

**Note:** The manufacturer is not responsible for any radio or TV interference caused by unauthorized modifications to this equipment. Such modifications could void the user's authority to operate the equipment.

## 8. Customer Support

Still have trouble with setup, please search for "**RainPoint**" on Youtube for installation videos!

If the user manual doesn't have what you're looking for or you need other help, please contact us before returning the product to the store and let us know the LOT NO. of your device.

**LOT NO.:** XXXXXX (on the back of the timer)



Not included



Points de collecte sur [www.quefairedemesdechets.fr](http://www.quefairedemesdechets.fr)  
Privilégiez la réparation ou le don de votre appareil !

## Need Help ?

Scan the QR code for more help.



or Email:

[support@rainpointonline.com](mailto:support@rainpointonline.com)