

OVERVIEW

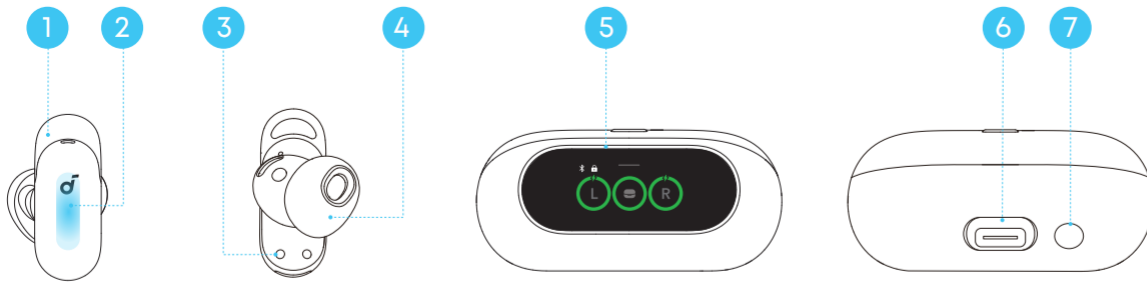

1. Ear Fin
 - Size 1 ear fins are pre-installed on the earbuds.
2. Touch Control Area
 - Tap the control area on the earbud stems to manage different functions.
3. Earbud Charging Contacts
4. Ear Tip
 - M-size eartips are pre-installed at the time of purchase.
5. Smart Screen
6. USB-C Charging Port
7. Charging Case Button

POWERING ON & PAIRING

Note: Before using the earbuds, remove all protective films and stickers from the earbuds and the charging case.

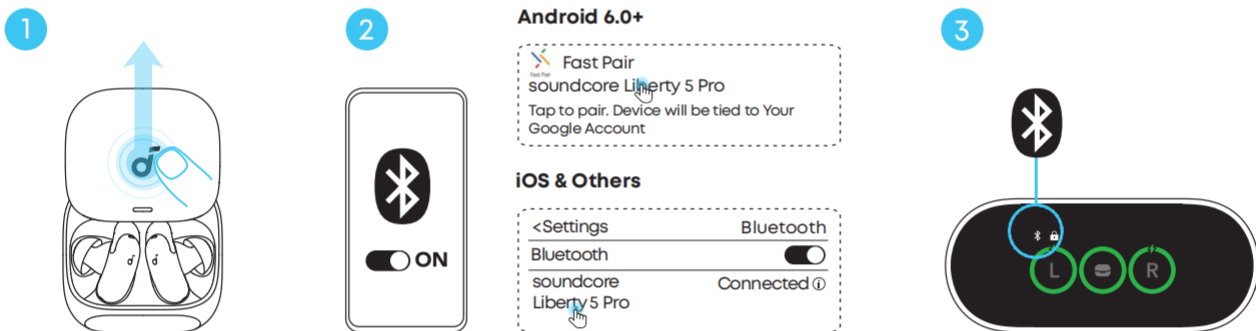

1. Slide open the charging case. The earbuds will power on and enter pairing mode.
2. Select "**soundcore Liberty 5 Pro**" on your device's Bluetooth list to connect.
Google Fast Pair Supported: Enjoy instant pairing with your Android smartphone (running Android 6.0 or above) using Google Fast Pair.
3. When connected, the Bluetooth icon on the Smart Screen will stay on.

WEARING GUIDE

1

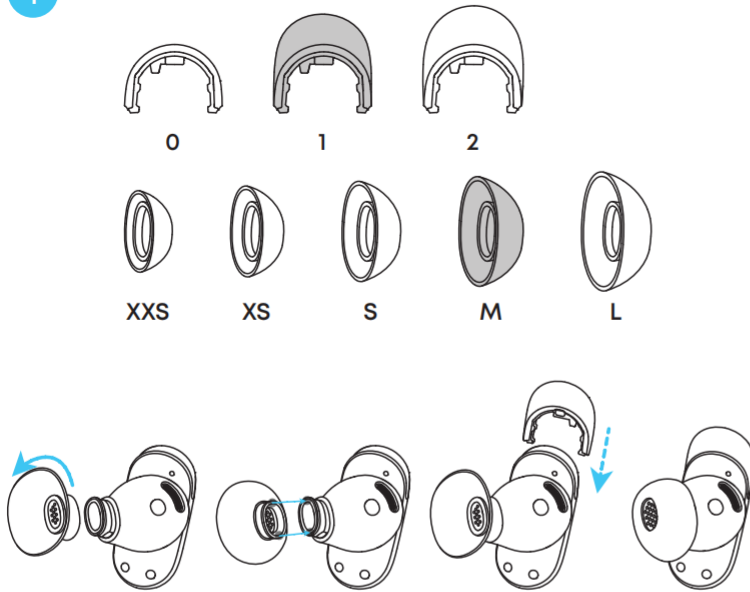

2

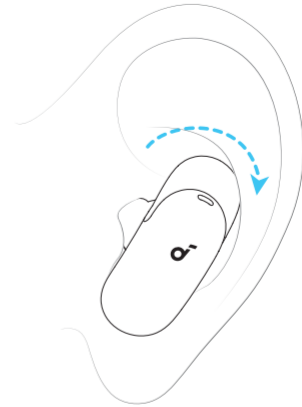

Properly wearing your earbuds will provide a more comfortable and stable fit while ensuring optimal noise cancellation and sound quality.

1. Try different ear tips and fins to find your best fit.



How to choose the right ear tips and fins?

Start by wearing the pre-installed size 1 ear fins and M-size ear tips. After wearing them properly:

- If the ear fins cause pressure or discomfort, switch to the size 0 or size 2 ear fins.
- With the default M-size eartips, if one earbud doesn't fit well, try using different sizes for each ear, such as medium in one ear and large in the other.

2. Gently place the earbuds into your ear canal and rotate them for a snug fit.

3. Take a fit test in the soundcore app (Go to **Settings > Fit Test**) to ensure you get the best active noise cancelling performance.

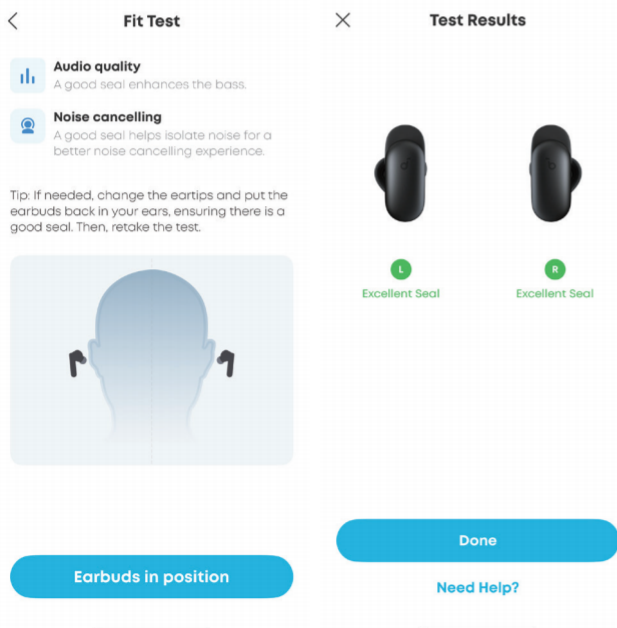

Note: The UI images are for illustration purposes only. Actual display contents may vary based on the software version.



- When wearing the earbuds, avoid touching the area near the logo to prevent accidental touches.
- Dust, earwax, or other debris can accumulate in the earbuds. To maintain optimal sound quality, clean them regularly. Use a slightly moistened cotton swab with rubbing alcohol to gently wipe the metal mesh filter beneath the rubber ear tips. Make sure the alcohol has completely dried on the metal mesh filter before using the earbuds again.

MULTI-DEVICE CONNECTION

Multi-Device Connection feature is enabled automatically. If you prefer to disable this feature, tap the gear icon in the upper-right corner to access **Settings**, then tap the toggle switch for **Multi-Device Connection** to turn it off.

How to Connect New Devices

1

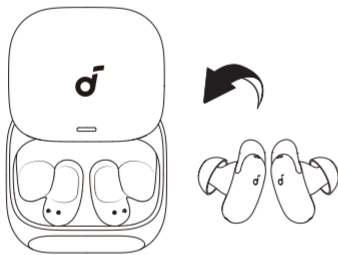

2

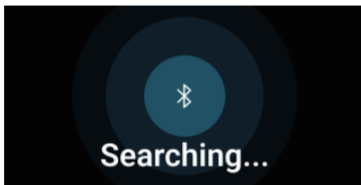
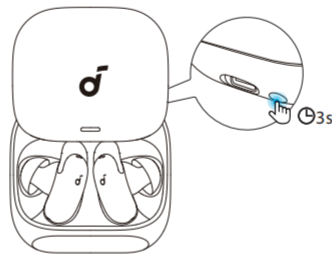

To connect a new device while one device is already connected, return both earbuds to the case, then press and hold the charging case button for 3 seconds with the lid open, until the Bluetooth Pairing prompt appears on the Smart Screen. You can then proceed to pair with new devices.

If you are wearing the earbuds, tap and hold the touch control area on both earbuds to enter pairing mode.

You can also tap **Connect New Device** in the app, then your earbuds can be discovered by another Bluetooth device.

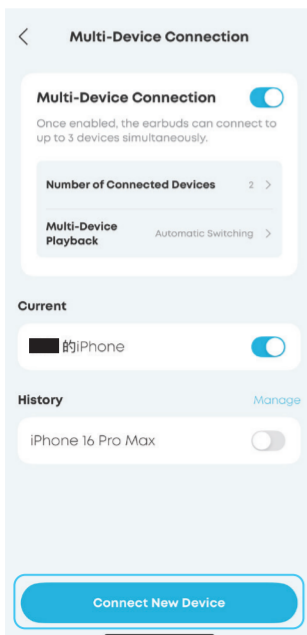

Note: The UI images are for illustration purposes only. Actual display contents may vary based on the software version.

Number of Connected Devices

In this setting, you can select the number of connected devices in the soundcore app. By default, the earbuds can connect 2 devices simultaneously. The maximum number of connected devices is 3.

Note: The UI images are for illustration purposes only. Actual display contents may vary based on the software version.

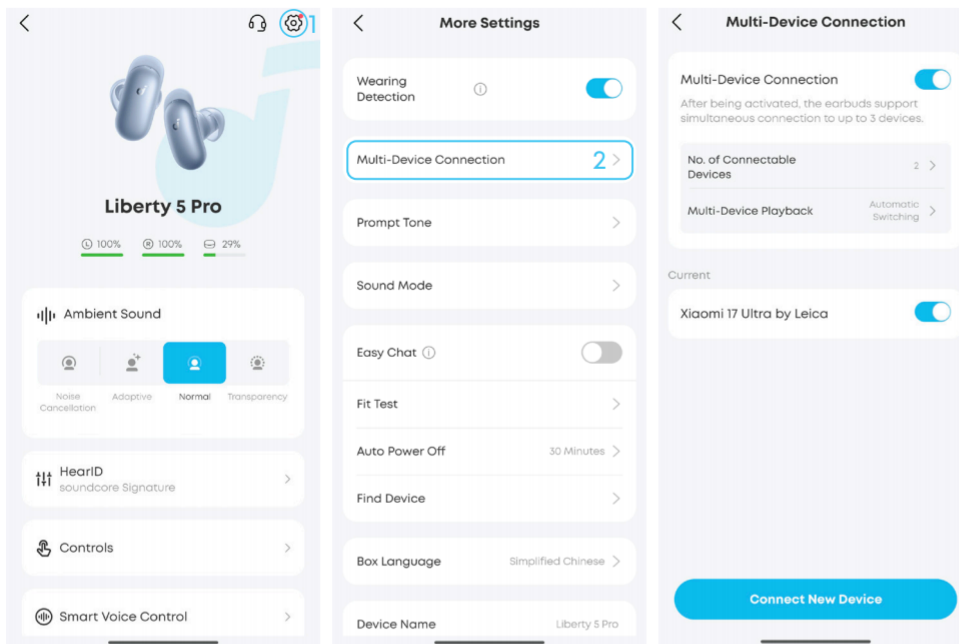

LDAC is unavailable when the earbuds are connected to 3 devices simultaneously.

Multi-Device Playback

There are two audio playback switching modes available in the soundcore app, giving you the ideal flexibility for audio experience across smartphones, tablets, and computers.

- **Automatic Switching:** The earbuds intelligently switch to the device that starts playback, ensuring a smooth and uninterrupted listening experience.
- **Manual Switching:** To change devices manually, pause audio on the current device, then start playback on another connected device.

SMART SCREEN

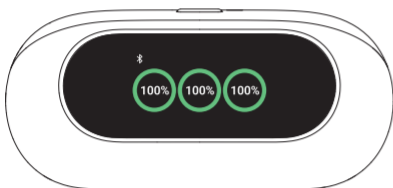

The Smart Screen on the charging case shows you the battery level of both the charging case and earbuds, and provides easy control over multiple features.

- Swipe up to unlock the Smart Screen.
- Swipe down to access different features after unlocking the screen.
- Swipe left or right to select different features

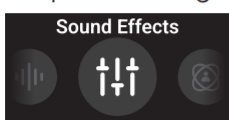

- Tap the feature icon to view details.

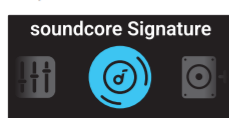

There are a total of seven features available for smart control via the charging case:

Ambient Sound: Adjust the ambient sound levels to suit your environment and preferences, ensuring an optimal listening experience.

Sound Effects: Customize your audio experience with preset sound modes to match your favorite music style.

Dolby Audio: Experience immersive 3D sound that adjusts dynamically based on your head movements, providing a more realistic audio experience.

Easy Chat: Automatically lowers the volume of music and enables Transparency mode so that you can have face-to-face conversations without removing the earbuds.

Remote Camera: With the camera feature activated on your phone, use the charging case to control your smartphone's camera remotely.

Find Device: Locate your misplaced earbuds within Bluetooth range by enabling them to sound alerts.

Bluetooth Pairing: Enter Bluetooth pairing mode directly from the Smart Screen to quickly connect with new devices.

CHARGING

1

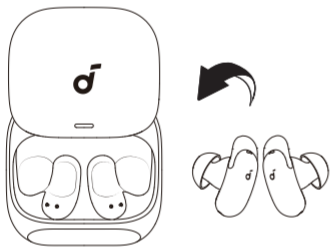

2

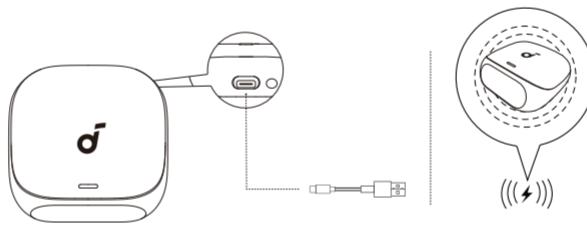

1. Place the earbuds in the charging case and close it.

- Ensure the earbuds and the USB-C charging port are fully dry before charging.
- Tip: Make sure the earbuds are correctly oriented before closing the case. Align the charging contacts on each earbud with the corresponding contacts inside the case, and ensure the right earbud is placed in the right slot and the left earbud is placed in the left slot. Note that the case lid can still close even if the earbuds are placed incorrectly, which will prevent them from charging.

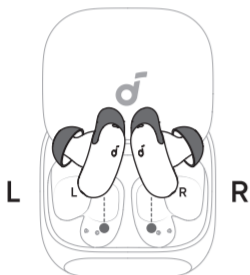

2. Connect the charging case to a power supply using the provided USB-C charging cable. For wireless charging, place the charging case at the center of your wireless charger.

- Recharging the charging case with the earbuds removed takes 3 hours via cable. A 5-minute charge of the earbuds provides 4 hours of playtime.

CONTROLS

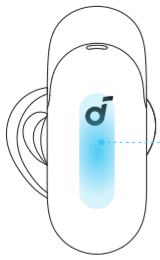

**Touch
Control Area**

		Using Dual Earbuds	Using Single Earbud
🎵	Play / Pause Audio	Double Tap (R)	Double Tap
	Play the Next Track	Double Tap (L)	/
☎️	Answer a Call / End a Call	Double Tap (L/R)	Double Tap
	Reject an Incoming Call / Change ANC Mode During a Call	Tap and Hold for 2 Seconds (L/R)	Tap and Hold for 2 Seconds
Note: To change ANC mode via touch controls, update the earbuds' firmware to the latest version.			
👂	Switch Between ANC and Transparency Modes	Tap and Hold for 2 Seconds (L/R)	Tap and Hold for 2 Seconds

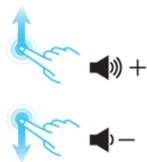

		Using Dual Earbuds	Using Single Earbud
🔊	Increase Volume	Slide up (L/R)	Slide up
	Decrease Volume	Slide down (L/R)	Slide down



You can customize controls in the soundcore app.

SOUND EFFECTS

Note: The UI images are for illustration purposes only. Actual display contents may vary based on the software version.

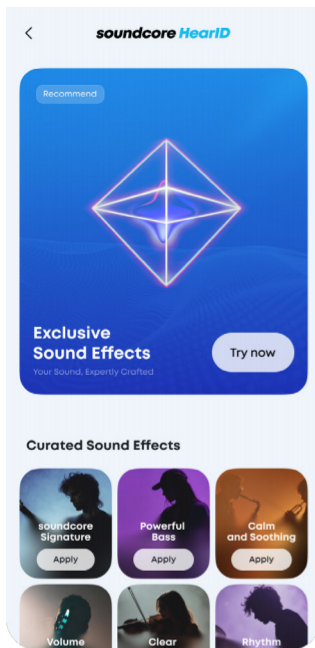

The soundcore app offers a range of preset EQ modes designed to match different listening preferences. Each preset EQ mode is carefully tuned to bring out distinct sound characteristics.

soundcore Signature (default): Suitable for various music styles and delivers pleasant listening experience.

Clear Vocals: Suitable for podcast, audiobooks, and music.

Powerful Bass: Suitable for hip-hop, rock, electronic, and dance music.

Calm and Soothing: Suitable for classical, jazz, and soothing music.

Balanced for Pure Enjoyment: Suitable for pop and blues music.

DOLBY AUDIO

Note: The UI images are for illustration purposes only. Actual display contents may vary based on the software version.

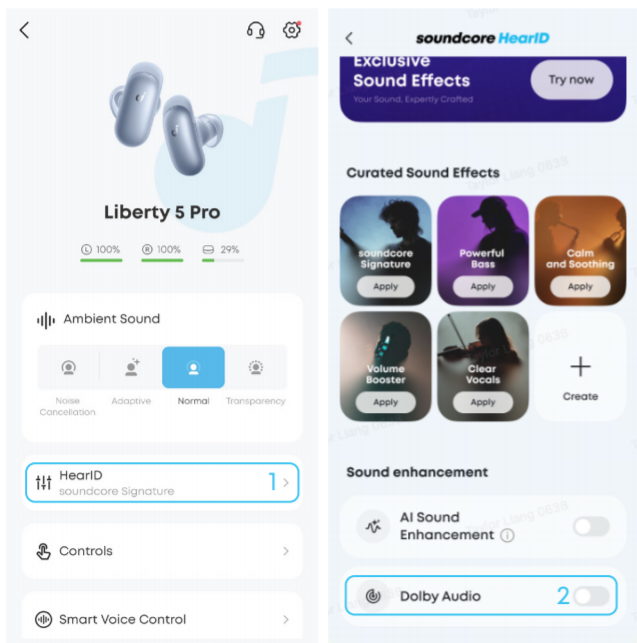

Dolby Audio creates an immersive listening experience by placing sound all around you.

Music Mode:

- **Head Tracking:** Hear surround sound that follows your head movement.
- **Fixed:** Listen to Spatial Audio without head tracking.

AMBIENT SOUND

Control with Smart Screen

You can easily switch between different ambient sound levels by sliding left or right on the Smart Screen.



Control with App

You can select from Noise Cancellation, Adaptive, Normal, or Transparency modes in the soundcore app.

- **Noise Cancellation (Level 1 to Level 5):** Adjust the strength of noise cancellation to match your environment.
- **Adaptive:** Experience seamless sound with Adaptive Noise Cancellation that intuitively tunes to your environment, preserving the perfect harmony between clarity and awareness.
- **Normal:** Enjoy balanced sound without noise cancellation.
- **Transparency:** Stay aware of your surroundings while listening to music.

EASY CHAT

Note: The UI images are for illustration purposes only. Actual display contents may vary based on the software version.

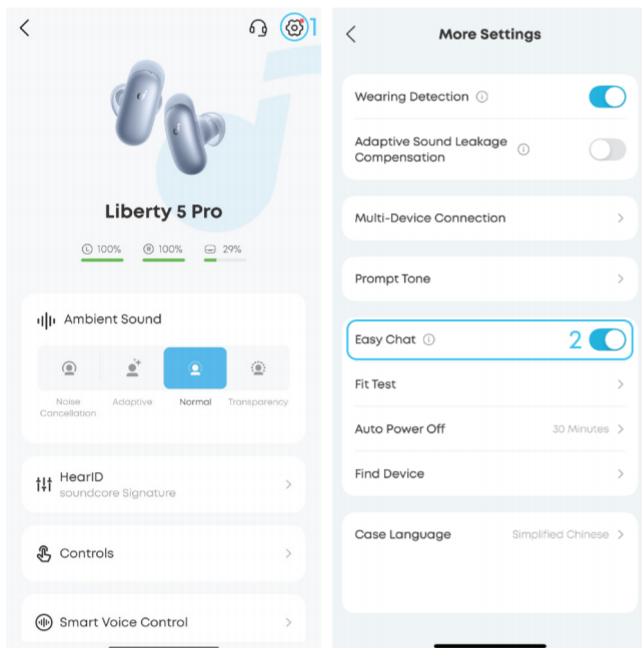

When activated, Easy Chat automatically switches the earbuds to Transparency mode and lowers your music volume, helping you communicate without taking off the earbuds.

Easy Chat is only available in ANC mode.

By default, when you have stopped talking for 5 seconds, your earbuds will automatically exit Easy Chat mode and resume the original ANC level and volume.

Tip: Turn off Easy Chat when not in use to avoid affecting your listening experience.

REMOTE PHOTO SNAP

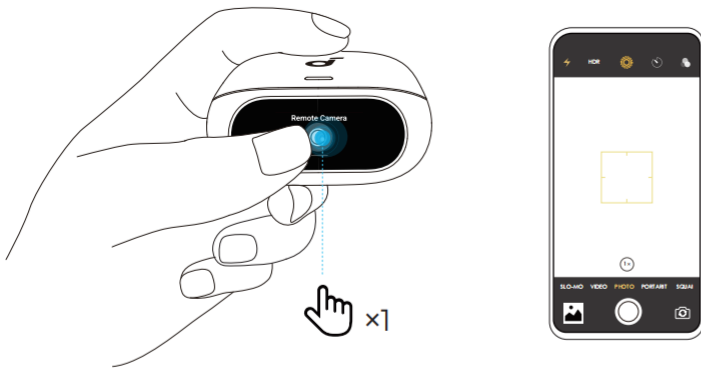

When the earbuds are connected to your phone via Bluetooth, open your phone's camera. Then tap the Remote Camera shortcut on the Smart Screen to take a photo remotely.



- Keep the earbuds connected to the phone via Bluetooth during use.
- Due to system settings, this feature is not supported on some phones.

WEARING DETECTION

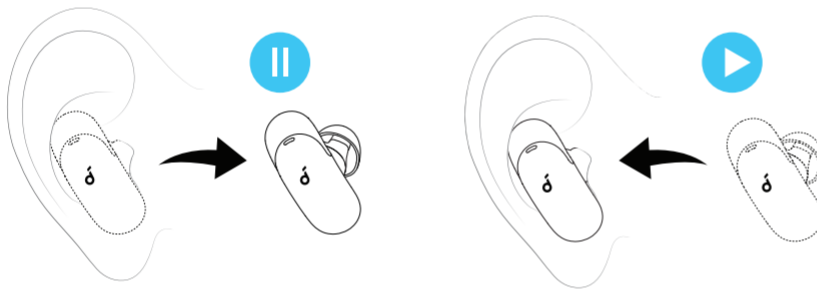

Your earbuds can automatically detect when you're wearing them.

Playback will pause when you remove an earbud, and resume as soon as you put it back on.

Wearing Detection is turned on by default. If you prefer to disable it, go to **Settings > Wearing Detection**, and toggle the switch to the left.

VOICE CONTROL

Note: The UI images are for illustration purposes only. Actual display contents may vary based on the software version.

Enable voice control to control your earbuds hands-free with voice commands.

This feature currently supports command words in Chinese, English, Japanese, and German. You can change voice command language anytime in app settings.

Access the complete voice command list in the soundcore app under **Voice Control**.

Note: Enabling voice control may reduce the earbuds' battery life.

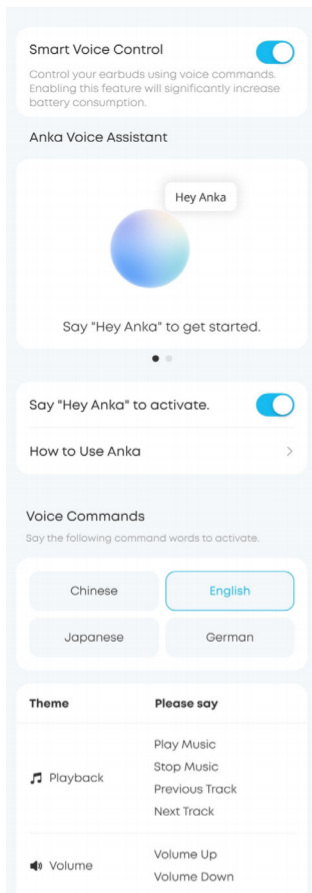

AI ASSISTANT

Before Use:

- Uninstall any previous versions of the soundcore app on your device and download the latest version.
- Keep the app open and your earbuds connected to your phone via Bluetooth while using the AI assistant. On Android devices, allow the app to run in the background.

Note:

- The AI assistant prioritizes your privacy and data security.
- AI-generated responses are for reference only and may contain inaccuracies. Please use your discretion.
- Feature interfaces may vary with app version updates.

What Anka Can Do for You

Function	What It Does	Example Command (Say the following to Anka after activating with "Hey Anka")
Answering Questions	Acts as your portable encyclopedia. Ask any question anytime.	"Why do giraffes have such long necks?"
Casual Conversation	Chats with you like a friend would and helps you relax.	"Tell me a joke."
Information Aggregation	Keeps you up to date with daily news and updates.	"Tell me the latest tech news for today."
Information Lookup	Checks the weather, the latest match scores, and more.	"What's the weather like in New York today? Will I need an umbrella when I go out?"



- Some voice commands may not work due to app limitations.

How to Access the Feature

In the soundcore app, go to **Anka Page > Chat With Anka**.

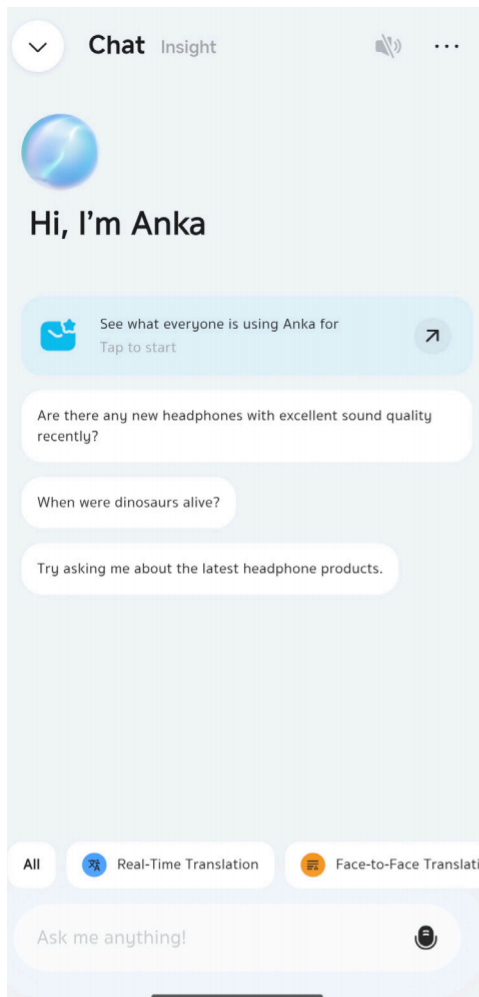

AI TRANSLATION

Note: Feature paths and interface visuals may change with software updates. For the most accurate guidance, please refer to your latest app version.

Before Use:

- Please upgrade to the latest version of the soundcore app and ensure that your earbuds are connected to the app.
- Disable Multi-Device Connection.

Real-Time Translation

In settings where you're exposed to content in a foreign language for extended periods (e.g., lectures, classes), real-time translation delivers continuous text display and audio playback of the translated content with almost no lag.

In the soundcore app, go to **Anka page** and tap **Real-Time Translation**. Make sure your earbuds are connected to the app.

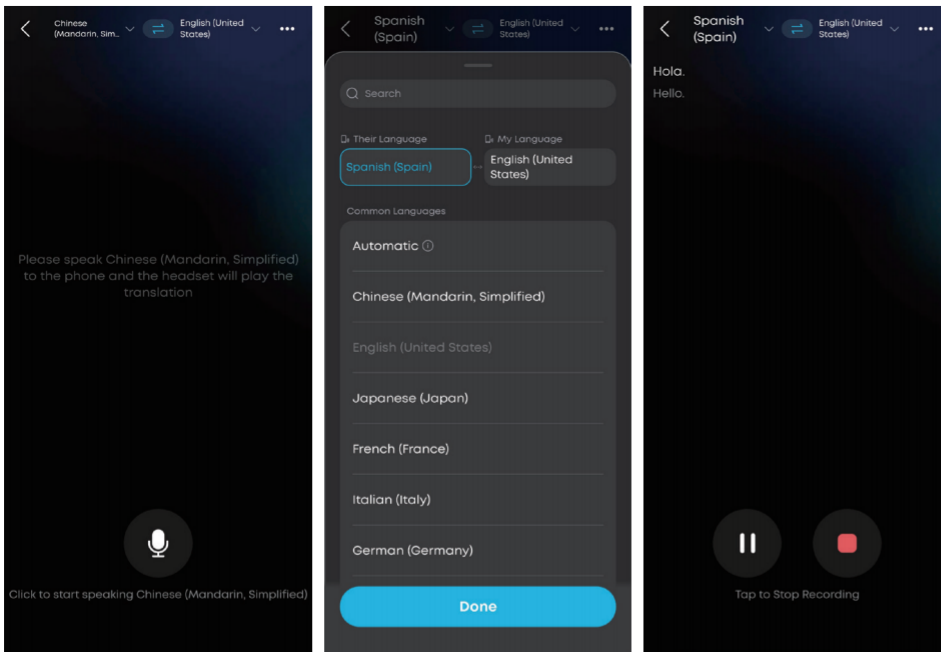

1. Tap **Real-Time Translation**.
2. Tap the language section at the top of the page, then select **Their Language** and **My Language**.
3. Tap the microphone button to start recording.

Face-to-Face Translation

In the soundcore app, go to **Anka page** and tap **Face-to-Face Translation**.

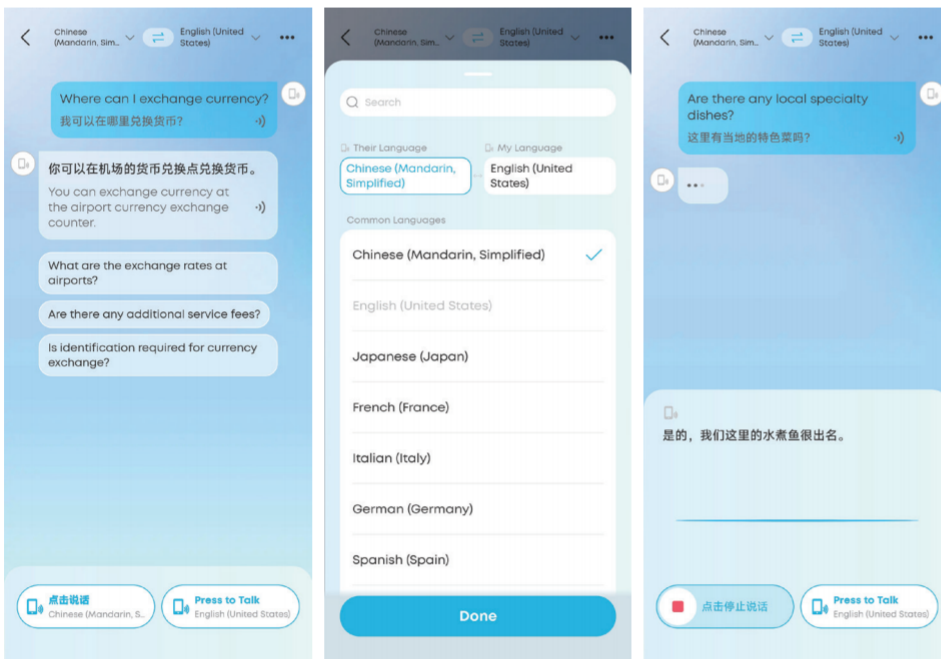

When your earbuds are connected to the app, follow the steps below to try out Face-to-Face Translation.

1. Tap the language section at the top of the page, then select **Their Language** and **My Language**.
2. Tap the bottom-right button and speak into your earbuds. The translation will play from your phone.
3. Tap the bottom-left button and speak into your phone. The translation will play from your earbuds.

Note: This feature works even if your earbuds aren't connected to the app. Just speak into your phone, and the translation will play through its speaker.

LDAC

Enable LDAC in the soundcore app to enjoy high-resolution audio on devices running Android 8.0 or later. This feature delivers higher sound quality but may increase power consumption and reduce playtime. For the best LDAC performance with stable Bluetooth connection, use LDAC in a low-interference environment.

Follow the steps below to enable LDAC on your device:

Note: UI images are for illustrative purposes only; actual display may vary by software version.

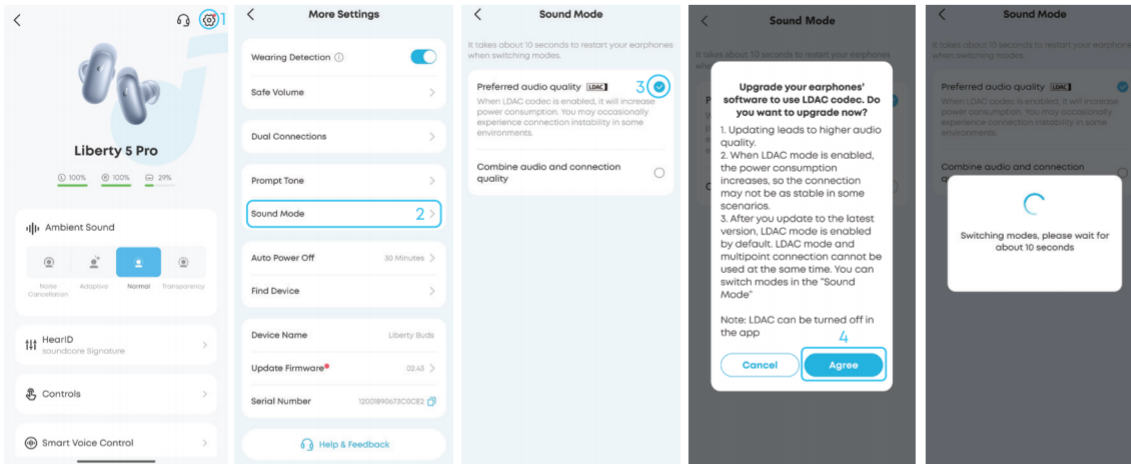

1. Open the soundcore app and go to Settings.
2. Tap **"Sound Mode"**.
3. Select **"Preferred audio quality"** to switch to LDAC codec.
4. Tap **"Agree"** to proceed.
5. Switching audio codecs takes about 10 seconds. You may be prompted to update your earbuds' firmware if an update is available.

RESETTING

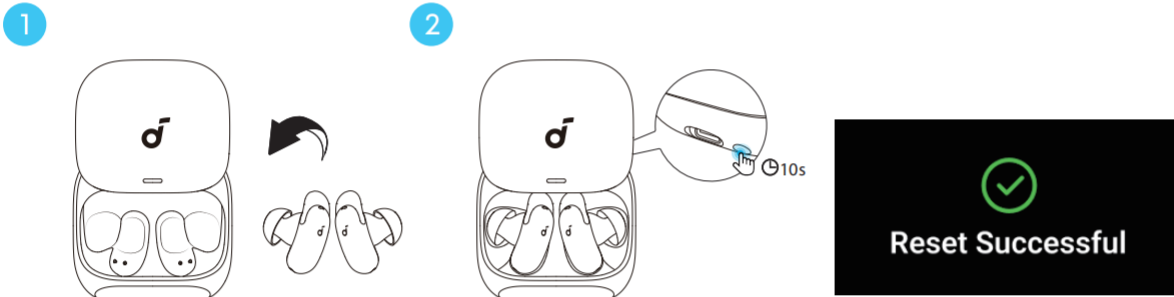

You might need to reset the earbuds if you experience any connectivity issues.

Place the earbuds in the charging case and leave the lid open. Press and hold the charging case button behind the charging case for 10 seconds. Upon a successful reset, the Smart Screen will show a prompt, and you will hear a notification sound from the charging case.

POWERING OFF

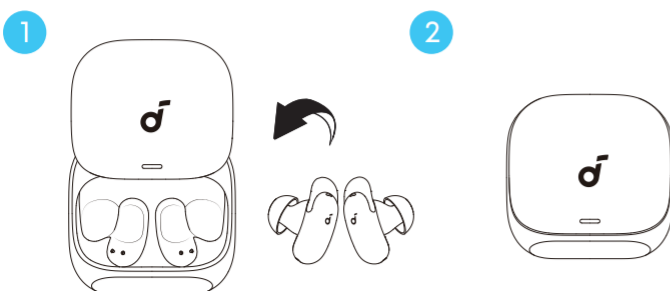

To power off, simply return the earbuds to the charging case and slide down the lid.

FIRMWARE UPDATE

You will be informed once a new firmware version is detected when you connect the earbuds to the app. Ensure the earbuds are placed in the charging case and the lid remains open until the firmware update is complete. During the update, ensure the earbuds are being charged and avoid using them.

SPECS

Specifications are subject to change without notice.

Input	5V \equiv 1A
Output	5V \equiv 0.54A (0.27A per port)
Battery Capacity	62mAh \times 2 (Earbuds) 690mAh (Charging case)
Playtime (with ANC Off)	Up to 12 hours (50 hours in total with the charging case)
Playtime (with ANC On)	ANC On: Up to 6.5 hours (28 hours in total with the charging case) ANC + Voice Call: Up to 4 hours ANC + Dolby Audio: Up to 5 hours ANC + Voice Control: Up to 5 hours ANC + AI Sound Enhancement: Up to 4.5 hours ANC + LDAC: Up to 4.5 hours
Charging Time	Up to 1 hour (Earbuds) Up to 3 hours (Charging case)
Driver Unit	9.2 mm dynamic driver
Frequency Response	10 Hz - 40 kHz
Impedance	17 Ω
Waterproof & Dustproof Rating (Earbuds Only)	IP55
Bluetooth Version	BT 6.1
Bluetooth Range	10 m / 33 ft

CUSTOMER SERVICE

service@soundcore.com
uk.support@soundcore.com (UK)
ie.support@soundcore.com (IE)



support.mea@anker.com (MEA)
support.india@anker.com (IN)

ced-cn@anker.com (CN)
support@anker.com (JP)
support.kr@anker.com (KR)

(US/CA) +1 (800) 988-7973

(UK) +44 (0) 1604 936 200

(DE) +49 (0) 69 9579 7960

(RSA) +27 801112209

(UAE) +971 8000 320 817

(KSA) +966 8008 500 030

(KW) +965 2206 9086



(EG) +20 8000 000 826

(TR) 00800 621 24 94

(IN) +91 8000 504 414

(CN) +86 400 0550 036

(JP) 03 4455 7823

(KR) +82 1666 8470

(AU/NZ) +61 1800 920 330

(PL) +48 800 707 993

(SE) +46 20 012 33 22

Note: The 'x' of SN Code: xxxxxxxxxxxxxxxx is a variable, see below table.

Variable 'x'	Range of variable	Content
Eighth	0-9 or A-F	Denotes the hardware version which is not effected on the safety compliance.
Ninth	8,9,A,B,C...	Denotes the year, 8 means 2018, 9 means 2019, A means 2020, B means 2021, C means 2022, and so on.
Tenth and Eleventh	01,02,03...	Denotes weeks, 01 means the first week in this year, 02 means the secondary week in this year, and so on.
Twelfth	1-7	Denotes date, 1 means Monday, 2 means Tuesday..., 7 means Sunday and so on.
The last five	00001-99999	Denotes serial No.

Hereby, Anker Innovations Limited declares that this device is in compliance with The Product Security and Telecommunications Infrastructure (Security Requirements for Relevant Connectable Products) Regulations 2023. For the Statement of Compliance, visit the website:

<https://uk.soundcore.com/pages/psti-related>.

Default Open Port: Classic Bluetooth

Port Description: After the device is powered on, Classic Bluetooth visibility (or pairing mode) is automatically enabled, providing Bluetooth pairing (or control) services. The Bluetooth service is disabled when the device is powered off.

This product is designed and intended for personal consumer use only.