

# TORQUE X

Foldable & Cordless Pressure Washer Gun



## Product Overview:

Thank you for choosing Portronics Torque X.

This foldable, cordless pressure washer gun is designed for quick and effective cleaning of everyday surfaces using high-pressure water.

Torque X helps remove stubborn dirt and grime from, cars & bikes, balconies & windows, outdoor furniture, garden tools, bathroom surfaces. Its foldable design, rechargeable battery, and multiple spray modes make cleaning easy and portable.

## Package Contents

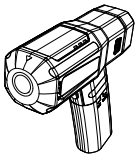

Torque X

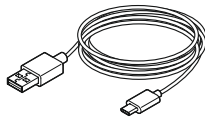

Type-C Charging Cable × 1

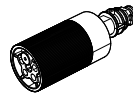

5-in-1 Rotating Nozzle × 1



Water Bottle Adapter × 1

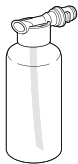

Detergent Bottle (200 ml) × 1

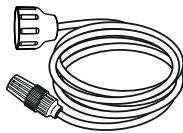

Self-Priming Hose × 1



Hose Clamp × 1



Filter Screens × 2



User Manual × 1

## Safety Guidelines

- Do not disassemble or modify the product
- Keep away from children
- Do not spray toward people, animals, or plants
- Do not use near fire, flammable liquids, or electrical appliances
- Avoid splashing water on the main unit
- Always use original accessories

## Product Specifications:

Battery: Built-in lithium battery 7.4V/4000 mAh	Main Unit Weight: 0.83 kg (excluding accessories)
Maximum Pressure: 1.5 MPa	Charging Time: Approximately 3 hours
Maximum Water Output: Approximately 180 L/h (when self-priming)	Continuous Usage Time: Approximately 26-70 minutes
Noise Level: 66 dB	Waterproof Rating: IPX5

## Part Names and Functions

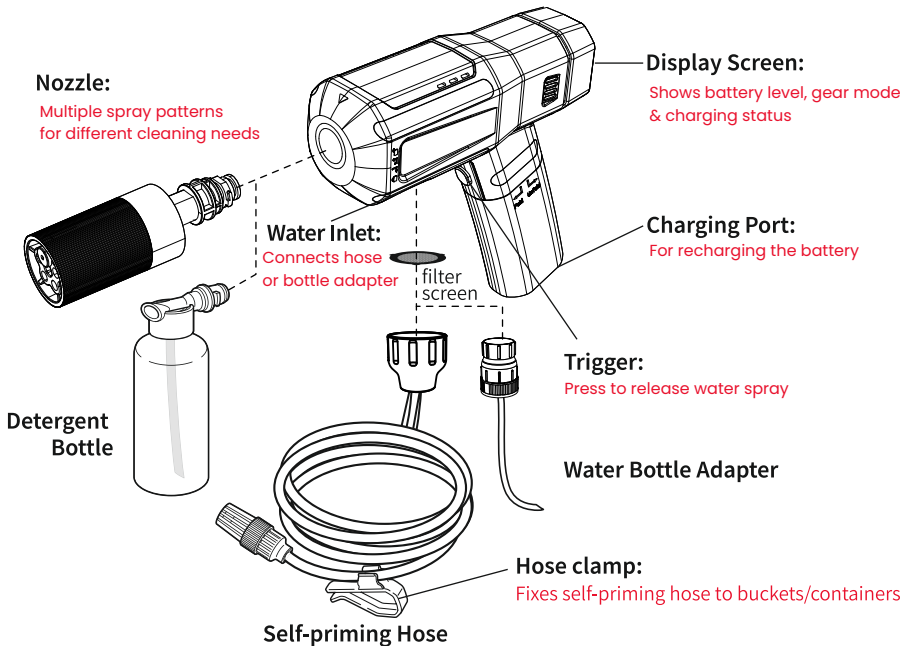

## Charging Instructions

- Connect the adaptor to a power socket
- Insert the Type-C cable into the adaptor
- The lightning icon blinks while charging
- Display shows 100% when fully charged

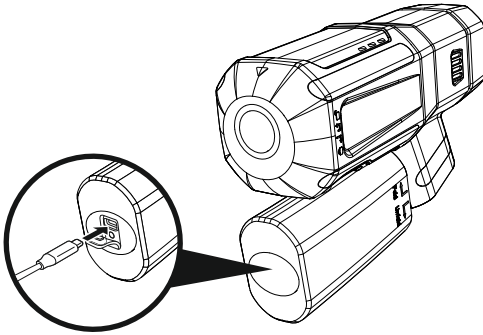
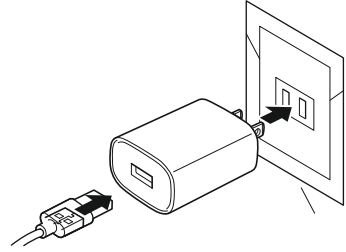

### ▲ Notes:

- Adapter not included
- Use a 5V/2A or higher adapter
- Do not charge in wet conditions
- The device cannot be used while charging
- When the battery is exhausted, the display will show "E3" and the device will automatically stop working to protect the battery.
- Avoid operating or leaving the device in a low-battery state, as this may lead to battery degradation or malfunction.
- Always recharge the unit fully before restarting use or storing it.
- To prevent battery over-discharge and maintain battery health, fully charge the battery at least once every 3–5 months, even when the product is not in regular use.

# Operating the Device

## I. Folding & Unfolding the Handle

- Always unfold the handle before operation
- Listen for a “click” to confirm it is locked in place
- Fold only when the unit is powered OFF

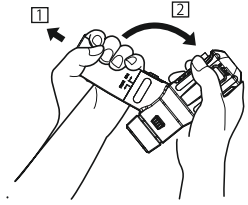

## II. Installing the 5-in-1 Nozzle

- Follow the lock-shaped markings on the main unit to ensure correct installation.
- Hold the 5-in-1 nozzle and align the oval clip on the nozzle with the oval groove inside the water outlet at the front of the main unit.
- Ensure the wider hollow end of the nozzle faces downward.
- Push the nozzle fully into the outlet, then rotate it clockwise until the triangular mark on the nozzle aligns with the water-shaped mark on the main unit.
- This indicates the nozzle is securely locked in place

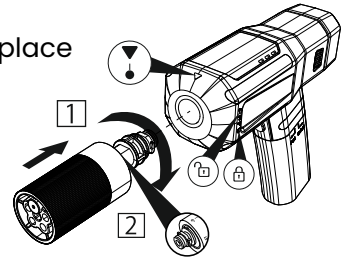
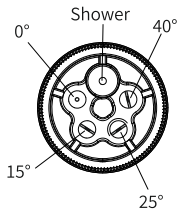

## III. Removing the 5-in-1 Nozzle

- Push the nozzle slightly inward and rotate it until the triangular mark moves away from the water-shaped mark.
- Pull the nozzle straight out from the main unit to remove it.

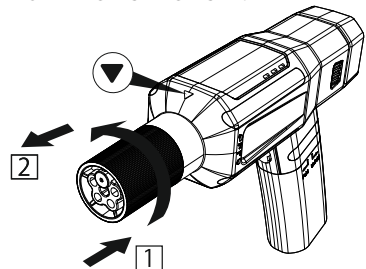

# Operating the Device

## IV. Water Supply Options

Torque X can draw water in two convenient ways. Choose the method that suits your cleaning setup.

### Method A: Using Stored Water (Bucket / Tank)

Connect the self-priming hose to the water inlet of the main unit.

Place the filter end of the hose fully into a bucket, tub, or water tank.

Ensure the hose end remains fully submerged in water during operation.

Tip: If the hose floats, secure it using the included hose clamp to keep the filter submerged.

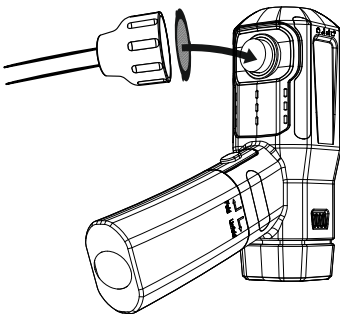
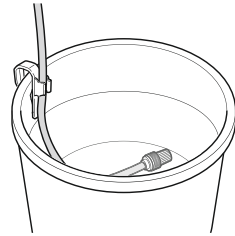
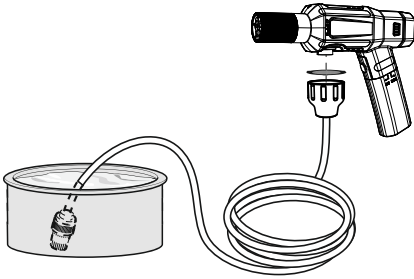

## Method B: Using a Water Bottle

- This method is ideal for quick cleaning tasks or portable use.
- Insert the adapter firmly into the water bottle opening. Rotate it clockwise until tight and secure. Do not overtighten.
- Attach the water bottle adapter to the water inlet.
- Use a standard 2-litre plastic bottle (28–32 mm mouth size recommended).
- Fill the bottle with clean tap water before installation.
- Tips:
  - Upto 2-litre bottles are recommended for proper fit and water flow.
  - One full 2-litre bottle provides approximately 50 seconds of continuous cleaning.

### Note:

**Plastic bottles are not included. Please arrange suitable bottles separately**

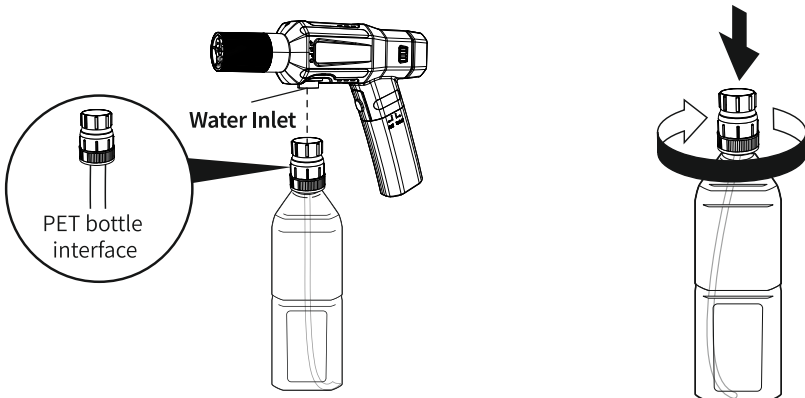

## Operating the Device

### V. Prime the Water Flow (Confirm Jet Status)

- Aim the nozzle in a safe direction.
- Press and hold the trigger to release water.
- Continue spraying until air trapped in the hose is fully discharged and the water flow becomes steady.

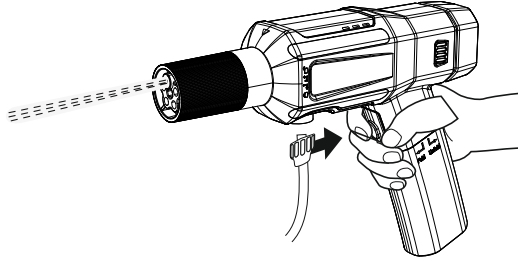

### VI. Power ON & Start Cleaning (Without Detergent)

- Press and hold the power button for 1 second to turn ON the unit.
- Press the same button for 3 seconds to start the device on gear 1.
- Press the same button briefly to switch between the gears.
- The device has three gear modes.
- Gear 1: Low pressure – light cleaning
- Gear 2: Medium pressure – regular cleaning
- Gear 3: High pressure – tough dirt removal
- The selected gear is shown on the digital display.

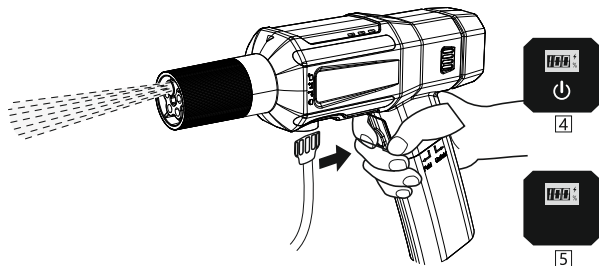

# Operating the Device

## VII. Cleaning with Detergent

Follow the steps below to safely and effectively use detergent with Torque X.

### Step 1: Prepare the Detergent Bottle

Remove the self-priming hose, if connected.

Remove the 5-in-1 nozzle from the main unit.

Unscrew the cap of the detergent bottle.

Fill the bottle with a suitable detergent (capacity: 200 ml).

(Use only detergents designed for pressure washers.)

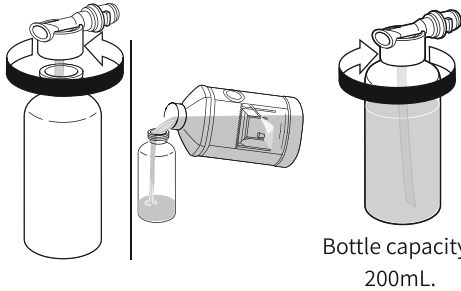

### Step 2: Install the Detergent Bottle

Hold the detergent bottle vertically and align it with the front interface of the main unit.

Insert the bottle and rotate the main unit downward by 90°, following the arrow direction, until it locks securely.

Caution:

Do not install the detergent bottle horizontally, as this may cause leakage.

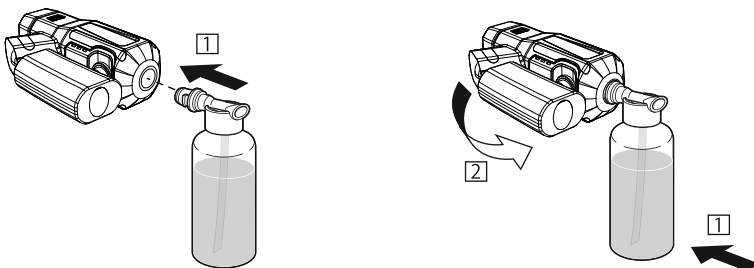

### **Step 3: Start Detergent Cleaning**

Fully unfold the handle before operation.

Connect the self-priming hose or water bottle adapter, as required.

Press the trigger to spray detergent evenly over the surface.

Recommendation:

Apply a light, even layer of detergent first for better stain removal.

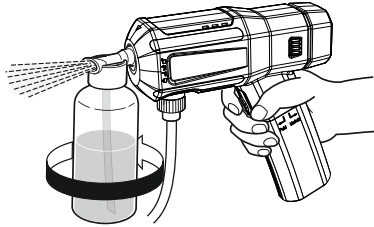

### **Step 4: Remove the Detergent Bottle**

After application, rotate the detergent bottle counterclockwise by 90° and remove it.

Do not press the trigger while removing the detergent bottle or installing the nozzle.

### **Step 5: Rinse the Surface**

Reinstall the 5-in-1 nozzle.

Select Standard Spray Mode (0° / 15° / 25° / 40°) or Shower Mode.

Rinse the surface thoroughly with clean water before the detergent dries.

### **Step 6: After Use**

Rinse the inside of the detergent bottle with clean water.

Store the bottle dry for next use.

# Cleaning the Self-Priming Hose Filter

Regular cleaning of the filter helps maintain smooth water flow and prevents blockages.

## Step 1: Remove the Filter

Remove the white filter screen from the front end of the self-priming hose. If the filter cover comes off, place it back correctly before continuing. If dust or residue is stuck inside, gently remove it using pliers.

## Step 2: Clean the Filter

Rinse the filter thoroughly under clean running water to remove dirt and debris. Ensure all visible particles are washed away.

## Step 3: Reinstall the Filter

Place the filter back into its original position. Secure it properly so it sits firmly in place before use.

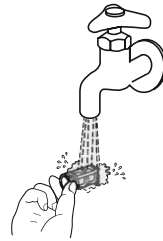
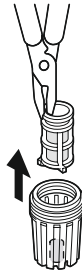
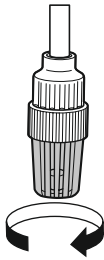

## Troubleshooting

Issue	Possible Reason	Solution
Unit not starting	Battery low	Recharge
No water flow	Blocked filter/nozzle	Clean filter
Low pressure	Nozzle blocked	Unclog nozzle
Water leakage	Loose connection	Loose connection



**[www.portronics.com](http://www.portronics.com)**

**For Support**

**Visit :** [www.portronics.com](http://www.portronics.com)

**Email :** [help@portronics.com](mailto:help@portronics.com)

**Contact No. :** +91 9555245245

(Working Hrs. : Monday – Saturday 10:00am – 6:00pm)



**E-waste Management**

Email - [info@3rrecycler.com](mailto:info@3rrecycler.com)

For E-waste & ROHS compliance refer to  
<http://www.portronics.com/ewaste.html>