



24-Hour Customer Service & 2-Year Warranty

Email: ukhelp@1byonebros.com
ushelp@1byonebros.com
Website: www.1byonebros.com

If any accessory is missing from the package or there are any issues with the product, please get in touch with our official customer service. We will be pleased to serve you!

1byone Products Inc.
1230 E Belmont Street, Ontario, CA, USA 91761
Customer Service: +1 909-391-3888
www.1byonebros.com

Made in China

AUTOMATIC HIGH-FIDELITY TURNTABLE



Instruction Manual
1-AD07US22 / 1-AD07UK22 / AT02



Introduction

Thank you for purchasing the 1byone Automatic High-Fidelity Turntable. This instruction manual contains important information about its safety, usage and disposal. Use the product as described and keep this manual for future reference. If you sell this turntable or pass it on, please also give this manual to the new owner.

Safety Instruction

1. Please use the appliance as instructed.
2. DO NOT expose the appliance to rain, moisture, dripping or splashing of water.
3. Ensure the power supply voltage matches the voltage indicated on the product.
4. DO NOT retrofit the plug yourself in any way.
5. DO NOT pull, bend, step on or compress the power cord.
6. Assemble the product as instructed, and DO NOT place any objects on the product.
7. Avoid dropping any objects or splashing any liquid into the appliance, for they may contact with dangerous voltage points or cause component short circuits, leading to fire or electric shock.
8. DO NOT attempt to repair the appliance or try to remove the casing panel yourself. All maintenance work should be left to qualified service personnel.
9. DO NOT use turntable replacement parts or components with this product that are not approved by the manufacturer.
10. DO NOT place the appliance anywhere near high temperature or open flame.
11. Place the product on a flat and stable surface; extra caution should be paid to prevent tipping or collision during moving or handling. 
12. The slots and openings on the body of the machine are designed to ensure ventilation and reliable operation of the product, preventing overheating. DO NOT block or cover these openings.
13. Unplug the appliance during a thunderstorm or when the product is not in use for extended periods.

Exterior Body Maintenance

1. When the turntable body is dirty or dusty, first disconnect the power adapter, and then wipe off the dirt and dust with a soft, dry cloth.
2. DO NOT use benzol, thinners, etc.
3. When storing the product for an extended period, disconnect the power adapter from the outlet and wrap the product securely for storage.
4. DO NOT allow the product or packaging to be damp.
5. The drive belt should be removed to prevent unequal stretching when the product is not in use.

Product Description

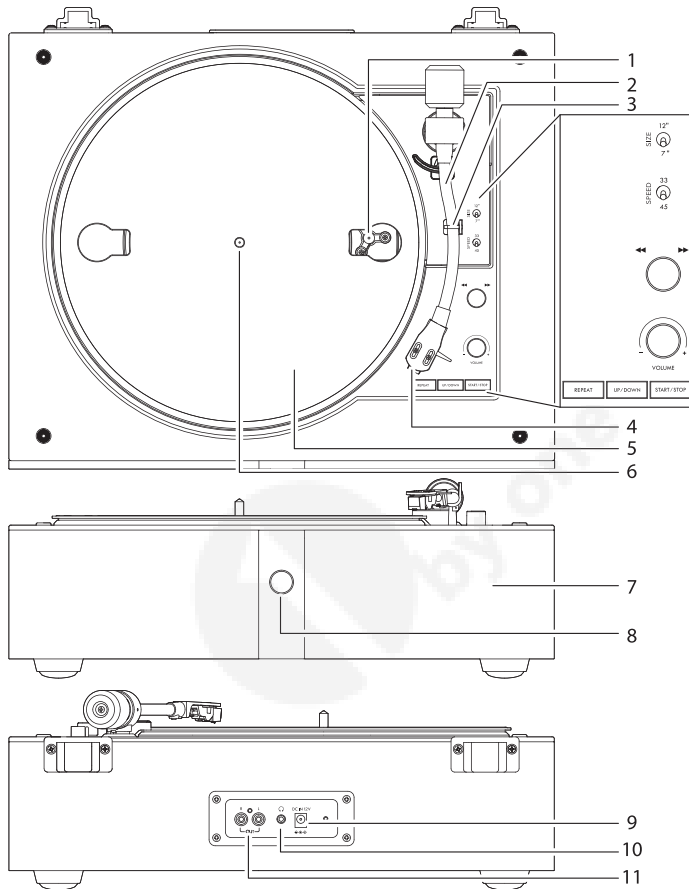

- 1. Motor Pulley
- 2. Tonearm
- 3. Tonearm Holder
- 4. Stylus
- 5. Turntable Platter
- 6. Turntable Spindle

- 7. Speaker
- 8. Power Button/Mode Selector/Indicator Light
- 9. Power Adapter Jack
- 10. Headphone Jack
- 11. R/L Audio Output Jack

Size Selector:
Select between 7" and 12" according to the record size.

Speed Selector:
Select between 33RPM and 45RPM speeds according to the record type.

Forward/ Backward Knob:
Rotate to forward or reverse the playback.

Volume Knob:
Rotate to adjust the turntable's volume to your desired level.

Start/Stop Button:
Press it to start/stop the playback.

Up/Down Button:
Press it to lift up or lay down the Tonearm.

Repeat Button:
Press it to activate (indicator turns green) or exit Repeat mode.

Main Power Connection

1. Insert the power adapter into the POWER ADAPTER JACK at the back of the turntable.
2. Plug the power plug into a normal power outlet.

Note: DO NOT plug into a power outlet before all turntable assembly is completed. Before powering on, recheck all connections to make sure they are correct and secure. Always turn off the turntable before connecting or disconnecting from power.

Remote Control

1. Remote Sensor
2. Power ON/OFF
3. Mode
4. Up
5. Start/Stop/Repeat
6. Backward
7. Down
8. Forward
9. Play/Pause
10. Volume +/-
11. Previous/Next
12. Battery Cover
13. Battery Holder

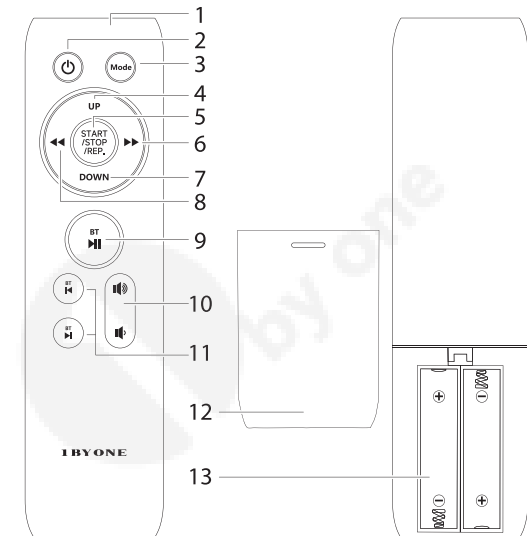

Battery Precautions

1. When installing the batteries, pay attention to the corresponding positive (+) pole and negative(-) pole marks.
2. Please replace the batteries in time when they run out of power.
3. Must keep the batteries out of the reach of children.

Included Items

Before installing the turntable, check the package contents to ensure all parts below are included and free of visible damage. Please retain the original packaging materials for exchange or return purposes.

- 1) Turntable Unit
- 2) Power Adapter
- 3) Dust Cover
- 4) Slip Mat
- 5) Turntable Platter with Belt
- 6) Hinge
- 7) Remote Control (with two AAA batteries)
- 8) 45 RPM Adapter
- 9) Quick Start Guide
- 10) Instruction Manual
- 11) Warranty Sheet

Installing the Turntable

- Mount the turntable on a level surface.
- To avoid the effects of vibrations and acoustic pressure, do not mount the turntable next to items such as speakers.
- The turntable may pick up radio static if placed next to a radio. Therefore, try to keep the turntable away from transmission devices such as radios.
- If the turntable is near equipment (such as a cell phone) that emits intense radio waves, noise may occur.

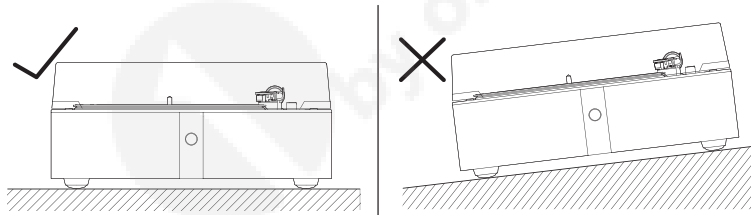

Turntable Platter and Belt Setup

- The belt is a consumable part. Replace the belt if the playback speed slows down or irregular rotation occurs. Usually, it is recommended to replace the belt annually.
- It is necessary to disconnect the power adapter before replacing the belt.

For the first time usage of this turntable, you need to install the platter and belt.

Step 1. Turn the platter over and you will see a raised circle.

Loop the belt around the middle circle.

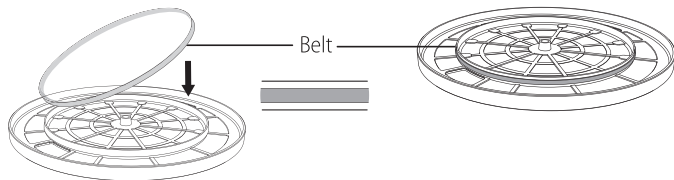

Step 2. Attach the platter.

Align one of the openings on the platter with the Motor Pulley on the turntable, then mount the platter onto the turntable.

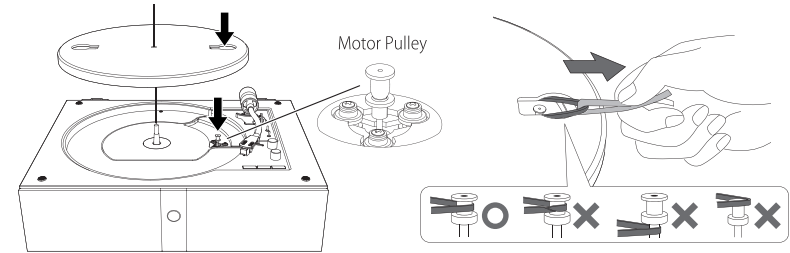

Step 3. Place the belt on the Motor Pulley.

Hold the belt and slide it onto the notch of the brass motor pulley. Remove the ribbon from the belt.

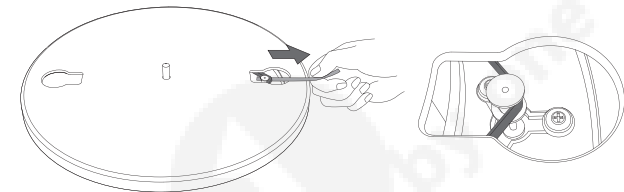

Step 4. Use your hand to slowly rotate the platter ten times clockwise, as shown.

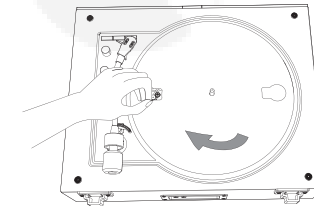

Installing the Dust Cover

1. Insert the supplied dust cover hinges into the corresponding hinge pockets of the turntable. Ensure they are fully seated.
2. Attach the dust cover to the hinge pockets. Gently push the dust cover downward until it clicks into place.

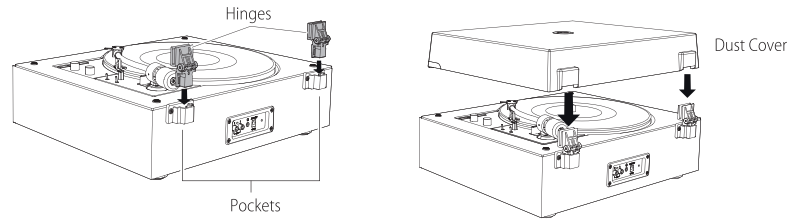

Playing a Record

Before Playing a Record

Place the record on the Slip Mat so that the center hole aligns with the spindle.

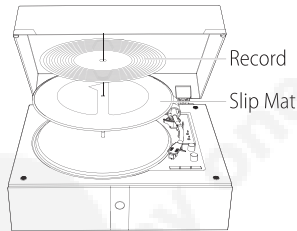

Turntable Operation

Sufficiently lower the volume first.

1. Attach the included **Power Adapter** to the turntable, press and hold the **POWER** button to power on or off the unit, and the indicator will light up when the device is activated.

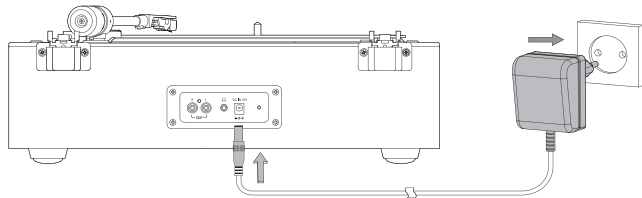

2. Press the **POWER** button to select the Record Play mode, and the indicator will turn **white**.

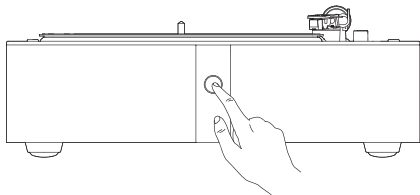

6

3. Release the **Tonearm**, and pull the **stylus protector** straight forward to remove it from the stylus.

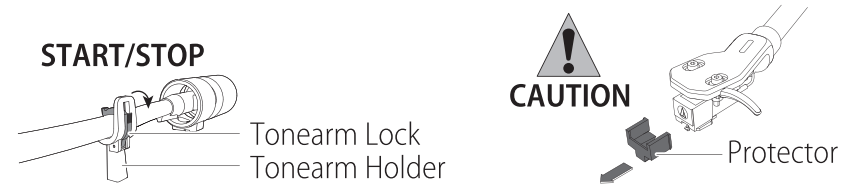

Note:

- If the Tonearm is locked, pressing START/STOP will make the indicator flash red as a reminder to unlock it. The Record Play mode will then deactivate after 10 seconds, and the indicator will turn white. Unlock the Tonearm and press the button again to proceed.
 - Applying a downward force may cause the Stylus to come off the body. If the Stylus was about to come off or already came off, only a faint sound will be produced. In such case, refer to "**Replacing the Stylus**" to reattach the Stylus correctly.
4. Turn the **SPEED** selector to select between **33RPM** and **45RPM** speeds according to the record type.

Note: For 45RPM records, ensure that the provided **45RPM adapter** is properly seated on the turntable's spindle before playback.

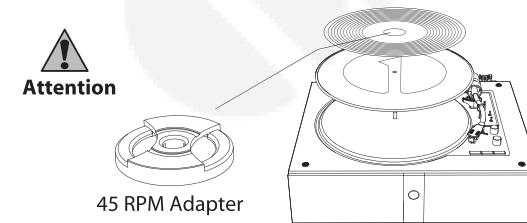

5. Turn the **SIZE** selector to select between **7"** and **12"** according to the record size.
6. Press the **START/STOP** button to start playback. Press it again to stop.
7. When the record finishes playing, the Tonearm will automatically return to the Tonearm holder. Fix the protector back to the Stylus. Power off the machine, and all indicator lights will shut off.

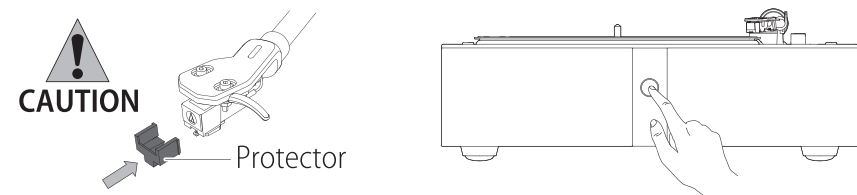

7

Bluetooth Operation

1. Power on the turntable and press the **POWER** button to enter Bluetooth mode, and the indicator will flash **blue**.
2. Place the devices within a range of 10 meters.
3. Turn on the Bluetooth function of your media device, search and select **"1byone AT02"** to pair the media device with the turntable.
4. Once the turntable is successfully paired with your media device, the Bluetooth indicator light will be stabilized.
5. The playback is mainly controlled by your media device.
6. The turntable will automatically reconnect to the last paired Bluetooth device when it is powered back on.

The Remote Control Operations

- (1) Press the **MODE** button to enter Bluetooth mode, and the indicator flashes blue.
- (2) Press the **PLAY/PAUSE** button to play or stop the playback.
- (3) Press the **PREVIOUS** or **NEXT** buttons to skip to the previous or next track.
- (4) Press the **VOLUME** buttons to adjust the volume.

Connecting to External Speaker with RCA Audio Cable

Use the **audio cable** to connect the Speakers or external amplifier, please follow the instructions below:

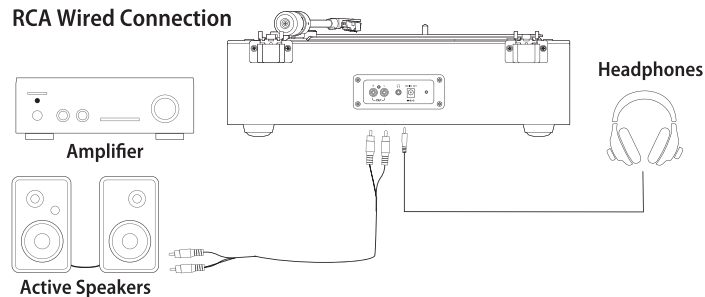

Note: To achieve the best sound, it is recommended to set the turntable volume to a minimal level. Then the turntable's audio will be played back through your own amplifier, speakers, etc.

Please avoid listening with headphones for a long time, as it can damage your hearing.

Replacing the Stylus

It is suggested to replace the stylus after 400 hours use. In addition to the deterioration of sound quality, records may also be damaged as the cartridge's stylus tip wears down.

Removing the Stylus

- Be sure to disconnect the product's power adapter from the outlet.
- When replacing the stylus, hold the headshell and the cartridge body tightly.

- Rotate the front of the stylus in a forward and down motion.

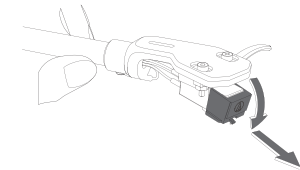

Installing a New Replacement Stylus

1. Mount the new replacement stylus to the cartridge.

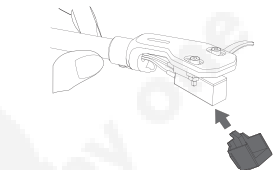

2. Lift the stylus up until a click is heard.

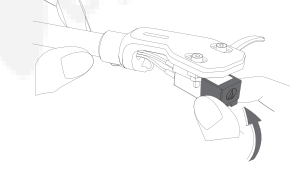

3. Make sure there is no gap between the headshell and the cartridge.



Cleaning the Stylus

- When the stylus becomes dirty or dusty, please clean it with a soft brush.
- It is recommended to use a stylus-specific cleaner(not included) to clean the stylus.
- Gently remove dust from the stylus tip by moving from the base toward the tip.

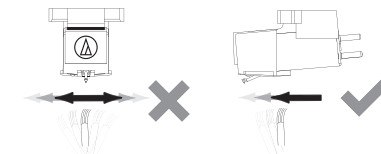

Adjusting the Stylus Drop Position

When the stylus tip lands outside the record or off the starting point on it (as shown), adjust the stylus drop position using the following steps.

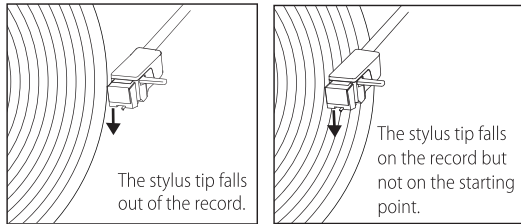

1. Before adjustment, it is necessary to stop the playback of the record and return the Tonearm to the Tonearm holder.
2. Whether adjusting the stylus inward or outward, there are only three operations for setting the stylus drop position:

(1) Inward (Towards the Center):

- Press and hold the **REPEAT** button for **at least 6 seconds**. The stylus will move towards the center of the record to the **1st** preset position.
- If you need to adjust further, repeat this step to move to the next preset position (2nd, 3rd). After each press and hold on the **REPEAT** button, the stylus moves to the next preset points.

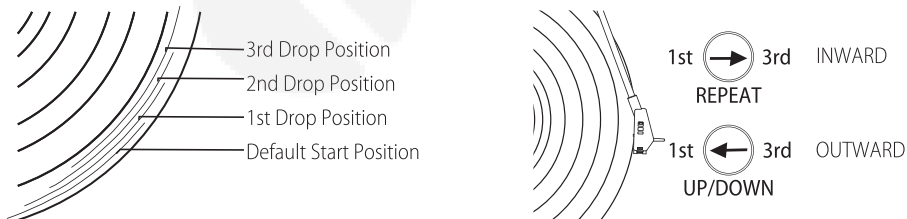

(2) Outward (Towards the Edge):

- Press and hold the **UP/DOWN** button for **at least 6 seconds**. The stylus will move towards the outer edge of the record to the **2nd** preset position.
- If you need to adjust further, repeat this step to move to the next preset position (1st or default start position). After each press and hold on the **UP/DOWN** button, the stylus returns to the next preset point.

(3) Reset to the Default Start Position:

- Press and hold the **START/STOP** button for at least 6 seconds. The stylus will return to the default start position.

Note: The turntable will memorize the last adjusted drop position for future use.

When Moving the Turntable

Pack the product using the original packaging materials, following the original arrangement. If you do not have the packaging materials, please take the following measures:

- Disconnect the Power Adapter from the outlet, remove the Slip Mat and the Platter, and wrap them to prevent damage.
- Place the stylus protector on.
- Secure the Tonearm to the rest of the unit with a cord or similar item to prevent it from falling off during the moving process.
- Wrap the turntable body with paper or a soft cloth to avoid damage.

Troubleshooting

Problem	Solution
The platter does not spin.	<ul style="list-style-type: none"> • Is the power adapter properly connected? <ul style="list-style-type: none"> - Please ensure the power adapter is properly connected to a power outlet. • What is the status of the indicator light? <ul style="list-style-type: none"> - If the indicator light is not on, please follow the operating steps to turn on the device correctly. After turning on the power, select the appropriate speed to start the turntable. - If the indicator light is blue, this means the turntable is in the Bluetooth mode. Please press the POWER button to enter to switch to the record mode. • Is the belt detached or damaged? <ul style="list-style-type: none"> - Please check the belt condition and ensure it is properly installed. If damaged, replace it with a new belt. • Is the motor working? <ul style="list-style-type: none"> - If installation and operation are correct, please check if the motor pulley is rotating.

Turntable is spinning, with no sound or only low volume coming out from the turntable.	<ul style="list-style-type: none"> • Are there any mistakes in wiring connections and function settings? <ul style="list-style-type: none"> - Check the wiring connections between the turntable and the audio device, as well as the device's functions and volume settings. • Is the stylus damaged? <ul style="list-style-type: none"> - Replace the stylus if necessary, and it is recommended to replace the stylus every 400 hours of use. • Is the stylus correctly installed on the cartridge base? <ul style="list-style-type: none"> - Check that the stylus and cartridge are correctly installed.
Music playback is slow or uneven.	<ul style="list-style-type: none"> • Is the belt installed correctly? <ul style="list-style-type: none"> - Refer to "Turntable Platter and Belt Setup" for correct installation. • Is the belt excessively stretched? <ul style="list-style-type: none"> - Replace it with a new belt.
Sound skip occurs.	<ul style="list-style-type: none"> • Is the record warped? <ul style="list-style-type: none"> - Check the record. • Is the record scratched? <ul style="list-style-type: none"> - Check the record.
There are strange noises coming out from the turntable.	<ul style="list-style-type: none"> • Is the product absorbing vibrations from the ground, walls or nearby speakers? <ul style="list-style-type: none"> - Reduce environmental vibrations or install the product on a surface that is less susceptible to vibrations. • Is the product installed on an unstable surface? <ul style="list-style-type: none"> - Ensure the product is placed on a stable surface.
There is noise generated during record playback.	<ul style="list-style-type: none"> • Is there dust accumulated on the stylus tip? <ul style="list-style-type: none"> - Clean the stylus with a professional cleaning brush. • Are there dust or scratches on the vinyl record? <ul style="list-style-type: none"> - Clean the surface with commercial record cleaning products, or replace the vinyl record.
The record playback speed is too fast or too slow.	<ul style="list-style-type: none"> • Is the turntable's speed setting correct? <ul style="list-style-type: none"> - Select the correct speed based on the type of record being played. • Is the speed still abnormal? <ul style="list-style-type: none"> - Check if the turntable is placed on a flat horizontal surface.

Specifications

Turntable

Model	1-AD07US22, 1-AD07UK22, AT02
Power Input	Input AC 100-240V~50/60Hz
Maximum Power Consumption	36W
Standby Power	<0.5W
Power Adapter	12V, 3A
Speed	33, 45 RPM
ERP II	15min

Cartridge

Model	Audio-Technica AT3600
Frequency Response	20Hz-20kHz
Recommended Cartridge Tracking Force	2.5±0.5g
Weight	0.18oz (5.1g)

Note: Design and specifications are subject to change without notice.

Disposal

Disposal of the Product



Under no circumstances should you dispose of this product in normal domestic waste.



This product is subject to the provisions of European Directive 2012/19/EU.

Dispose of this product via an approved disposal company or your municipal waste facility. Please observe currently applicable regulations.

Please contact your waste disposal center if you need any further information.

Information on Electrical and Electronic Equipment

The following information is intended for users of electrical and electronic equipment in private households.

Electrical and electronic equipment (WEEE) must be disposed of separately from household waste through designated collection systems.

Please remove batteries, accumulators, or detachable lamps before recycling unless handled by public authorities.

You can return old devices to public disposal facilities for proper disposal or reuse. Please contact local points for details.



Crossed-Out Dustbin Symbol indicates that devices should be disposed of separately from household waste.



The appliance's packaging is made from environmentally friendly material and can be disposed of at your local recycling plant.

Compliance with FCC Regulation

This device complies with Part 15 of FCC rules. Operation is subject to the following two conditions:

- (1) This device may not cause harmful interference, and
- (2) This device must accept any interference received, including interference that may cause undesired operation.

This equipment has been tested and found to comply with the limits for a Class B digital device, pursuant to Part 15 of the FCC rules. These limits are designed to provide reasonable protection against harmful interference in a residential installation.

This equipment generates, uses and can radiate radio frequency energy and, if not installed and used in accordance with the instructions, may cause harmful interference to radio communications. However, there is no guarantee that interference will not occur in a particular installation.

If this equipment does cause harmful interference to radio or television reception, which can be determined by turning the equipment off and on, the user is encouraged to try to correct the interference by one or more of the following measures:

- Reorient or relocate the receiving antenna.
- Increase the separation between the equipment and receiver.
- Connect the equipment into an outlet on a circuit different from that to which the receiver is connected.
- Consult the dealer or an experienced radio/TV technician for help.

RF Exposure Statement:

When using the product, maintain a distance of 20cm from the body to ensure compliance with RF exposure requirements.

WARNING: Changes or modifications to this unit not expressly approved by the party responsible for compliance could void the user's authority to operate the equipment.

WARNING: Cancer and Reproductive Harm - <http://www.P65Warnings.ca.gov>
For more information go to <http://www.1byonebros.com/Compliance/Prop65>

UKCA Declaration and Conformity

We, 1byone Products Inc, confirm that the appliance as detailed below does comply with all essential requirements of the relevant U.K. legislation for UKCA-marking and governing UK-regulations as mentioned below.

Article Description: AUTOMATIC HIGH-FIDELITY TURNTABLE

Brand Name: 1byone

Model Number: 1-AD07US22, 1-AD07UK22, AT02

Applicable Standard(s)

EN 62479:2010

BS EN 62368-1:2014+A11:2017

ETSI EN 300 328 V2.2.2(2019-07)

ETSI EN 301 489-1 V2.2.3(2019-11)

ETSI EN 301 489-17 V3.2.4(2020-09)

BS EN 55032:2015+A1:2020

BS EN 55035:2017+A11:2020

BS EN IEC 61000-3-2:2019+A1:2021

BS EN 61000-3-3:2013+A2:2021



Boze Yang
Department Manager

Customer Service

UNITED KINGDOM	Email: ukhelp@1byonebros.com
CANADA	Email: cahelp@1byonebros.com
UNITED STATES	Phone: +1 909-391-3888 (Mon-Fri 9:00am - 5:00pm PST) Email: ushelp@1byonebros.com
GERMANY/FRANCE ITALY/SPAIN	Email: euhelp@1byonebros.com

MANUFACTURER

1byone Products Inc.

1230 E Belmont Street, Ontario, CA, USA 91761

Customer Service: +1 909-391-3888

www.1byonebros.com

ukhelp@1byonebros.com

ushelp@1byonebros.com

BRITISH REPRESENTATIVE (IMPORTER) FOR PRODUCT & BATTERIES



APEX CE SPECIALISTS LIMITED

6f East Union Street, Manchester, England, M16 9AE

Info@apex-ce.com

Wells Yan