



Mars M1 Enhanced

Specification Sheet

V1.0

Key Features

- Integrated wireless video transmission and monitoring solution
- Switchable transmitter and receiver modes
- 1 TX + 1 RX and 1 TX + 2 RX operating modes
- Line-of-sight (LOS) transmission range of up to 450ft (150m)
- Monitoring on mobile phones through the HollyView app
- Ultra-low transmission latency of 0.08s, meeting professional film and television production requirements
- 5.1–5.8GHz frequency bands, supporting frequency configurations in different countries and regions
- Dynamic frequency selection (DFS) feature
- Video playback and automatic trigger recording capabilities
- Custom 3D lookup table (LUT) import via a USB flash drive
- Extended battery life when working as a monitor with video transmission Wi-Fi disabled
- Professional image analysis tools (Luma waveform, RGB waveform, vectorscope, and histogram)
- Multiple auxiliary monitoring functions (Zebra pattern, focus assist, false color, aspect mark, anamorphic desqueeze, zoom-in, center mark, and crosshatch)
- Compatibility with the Mars family of products — Mars 300 Pro, Mars 400S Pro, Mars 4K, and Mars M1

Note: The LOS range of up to 450ft (150m) and transmission latency of 0.08s provided above are based on laboratory testing results.

Item List



Monitor



Capsule Antenna



OTG Adapter



Tempered Glass
Screen Protector

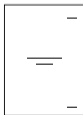

Quick Guide



Warranty Card



Packing List Card

Note: The item list varies by product configuration.

Item List

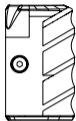

Rosewood Handle

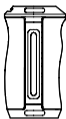

T-shaped Handle



Wrist Strap



Storage Case



Shoulder Strap

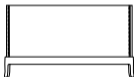

Monitor Hood
(with Bracket)

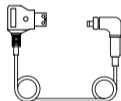

D-Tap to Locking
DC Cable

Note: The item list varies by product configuration.

Specifications

Device Mode	Transmitter mode	Receiver mode
Video Input Interface	HDMI 1.4b IN (Type-A female) 3G-SDI IN (BNC female)	/
Video Output Interface	HDMI 1.4b LOOPOUT (Type-A female)	HDMI 1.4b OUT (Type-A female)
Antenna Interface	Two RP-SMA male interfaces	Two RP-SMA male interfaces
Power Input Interface	DC IN (2.0mm core socket)	DC IN (2.0mm core socket)
Power Output Interface	DC OUT (2.0mm core socket)	DC OUT (2.0mm core socket)
Headphone Jack	3.5mm	3.5mm
Upgrade Interface	USB-C (USB-2.0 OTG)	USB-C (USB-2.0 OTG)
Screen Size	5.5" touchscreen	5.5" touchscreen
Screen Resolution	1920x1080 pixels	1920x1080 pixels
Pixel Density	403 PPI	403 PPI
Aspect Ratio	16:9	16:9
Screen Brightness	1,000 nits	1,000 nits
Contrast Ratio	1000:1	1000:1
Power Input Voltage	DC IN: 7–16V 2.5A (nominal 12V) NP-F battery: 6.8V–8.4V	DC IN: 7–16V 2.5A (nominal 12V) NP-F battery: 6.8V–8.4V
DC Output Voltage	8.4V±5%	8.4V±5%
Power Consumption	<16W	<13.6W

Specifications

Net Weight	Approx. 400g (14.1oz) with external antennas excluded	Approx. 400g (14.1oz) with external antennas excluded
Dimensions	(L x W x H): 152mm x 96mm x 40mm (5.98" x 3.78" x 1.57") with external antennas excluded	(L x W x H): 152mm x 96mm x 40mm (5.98" x 3.78" x 1.57") with external antennas excluded
Input Video Resolution	HDMI IN:	/
	720p50/59.94/60 Hz	/
	1080i50/59.94/60 Hz	/
	1080p23.98/24/25/29.97/30/50/59.94/60 Hz	/
	3840x2160p23.98/24/25/29.97/30 Hz	/
	4096x2160p23.98/24/25/29.97/30 Hz	/
	SDI IN:	/
	720p50/59.94/60 Hz	/
	1080i50/59.94/60 Hz	/
	1080p23.98/24/25/29.97/30	/
Output Video Resolution	1080p50/59.94/60 Hz (3G-SDI level A)	/
	1080p50/59.94/60 Hz (3G-SDI level B)	/
	HDMI LOOPOUT (HDMI IN):	HDMI OUT:
	720p50/59.94/60 Hz	720p50/59.94/60 Hz
	1080i50/59.94/60 Hz	1080i50/59.94/60 Hz
1080p23.98/24/25/29.97/30/50/59.94/60 Hz	1080p23.98/24/25/29.97/30/50/59.94/60 Hz	

Specifications

Output Video Resolution	3840x2160p23.98/24/25/29.97/30 Hz	1080p50/59.94/60 Hz
	4096x2160p23.98/24/25/29.97/30 Hz	1080p50/59.94/60 Hz
	HDMI LOOPOUT (SDI IN):	HDMI OUT:
	720p50/59.94/60 Hz	720p50/59.94/60 Hz
	1080i50/59.94/60 Hz	1080i50/59.94/60 Hz
	1080p23.98/24/25/29.97/30/50/59.94/60 Hz	1080p23.98/24/25/29.97/30/50/59.94/60 Hz
	<p>Note: When the device (in receiver mode) is connected to the Mars 4K transmitter, if the HDMI input video resolution of the Mars 4K transmitter is 3840x2160p24/25/30 Hz, the HDMI output video resolution of the device is 1920x1080p24/25/30 Hz.</p>	
Display Latency	<0.05s (test data when 1080p60 signals are transmitted in a laboratory environment. The display latency varies by video resolution.)	
Operating Frequency*	5.150–5.250GHz 5.250–5.350GHz 5.470–5.725GHz 5.725–5.850GHz	
Codec Technology	H.264	

Specifications

Bit Rate	12Mbps
TX Power	≤ 21+/-1.5dBm
Transmission Latency	Approx. 0.08s (test data when 1080p60 signals are transmitted in a laboratory environment)
LOS Range	Up to 450ft (150m) (test data in an unobstructed outdoor environment free of interference)
Bandwidth	20MHz
Audio Format	Eight audio channels for the HDMI 1.4b
Operating Temperature	-10°C to 60°C (14° F to 140° F)
Storage Temperature	-40°C to 60°C (-40° F to 140° F)

Note: The operating frequency and TX power vary by country and region. In some countries and regions, the 5.1GHz, 5.2GHz, and 5.8GHz frequency bands are prohibited, or the 5.1GHz and 5.2GHz frequency bands are only allowed for indoor use. Please refer to local laws and regulations for more information.

Support

If you encounter any problems in using the product or need any help, please contact Hollyland Support Team via the following ways:

 Hollyland User Group

 HollylandTech

 HollylandTech

 HollylandTech

 support@hollyland.com

 www.hollyland.com

Statement:

All copyrights belong to Shenzhen Hollyland Technology Co., Ltd. Without the written approval of Shenzhen Hollyland Technology Co., Ltd., no organization or individual may copy or reproduce part or all of any written or illustrative content and disseminate it in any form.

Trademark Statement:

All the trademarks are owned by Shenzhen Hollyland Technology Co., Ltd.

Note:

Due to product version upgrades or other reasons, this Quick Guide will be updated from time to time. Unless otherwise agreed, this document is provided as a guide for use only. All representations, information, and recommendations in this document do not constitute warranties of any kind, express, or implied.