

1.

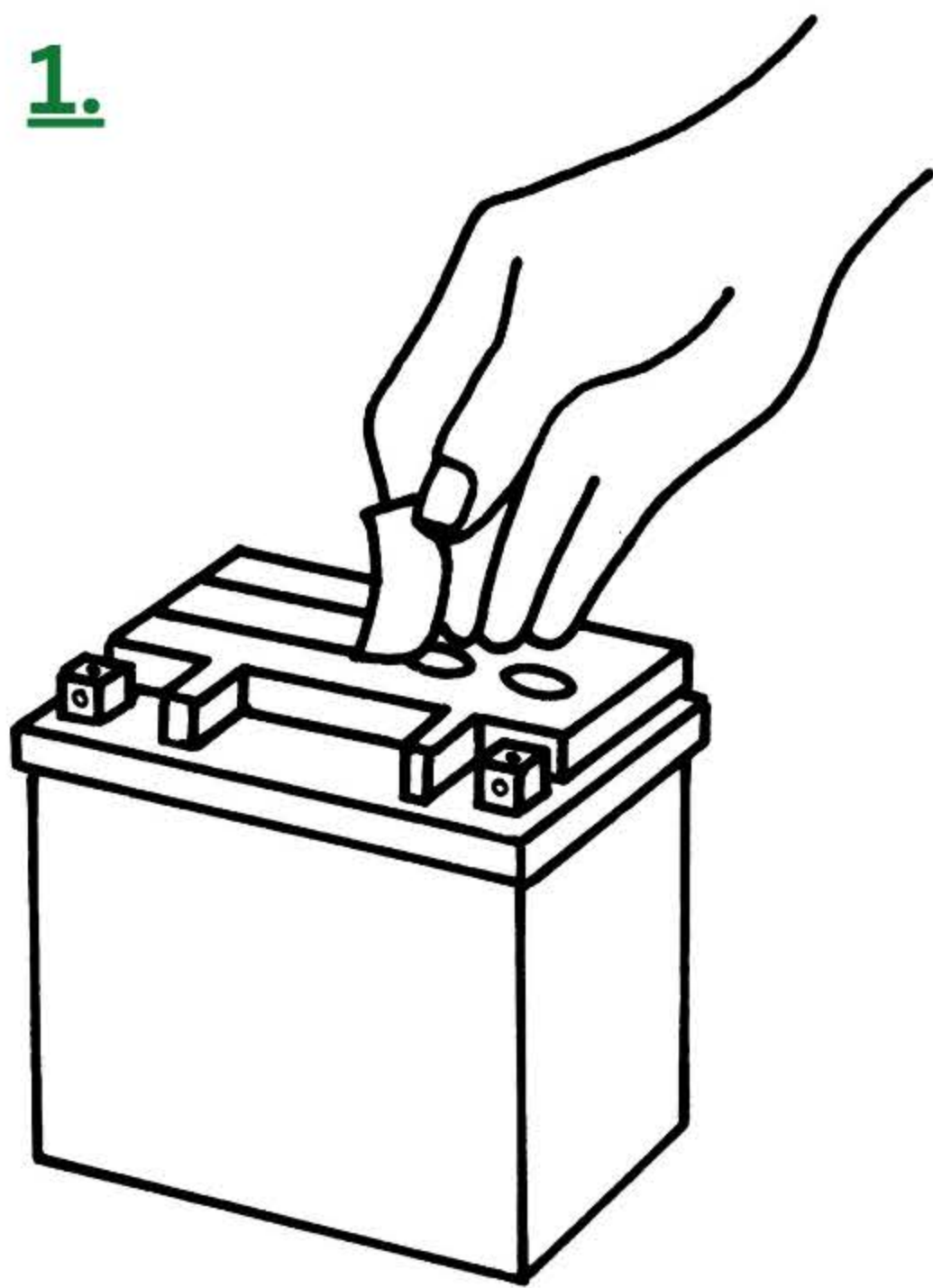

2.



3.

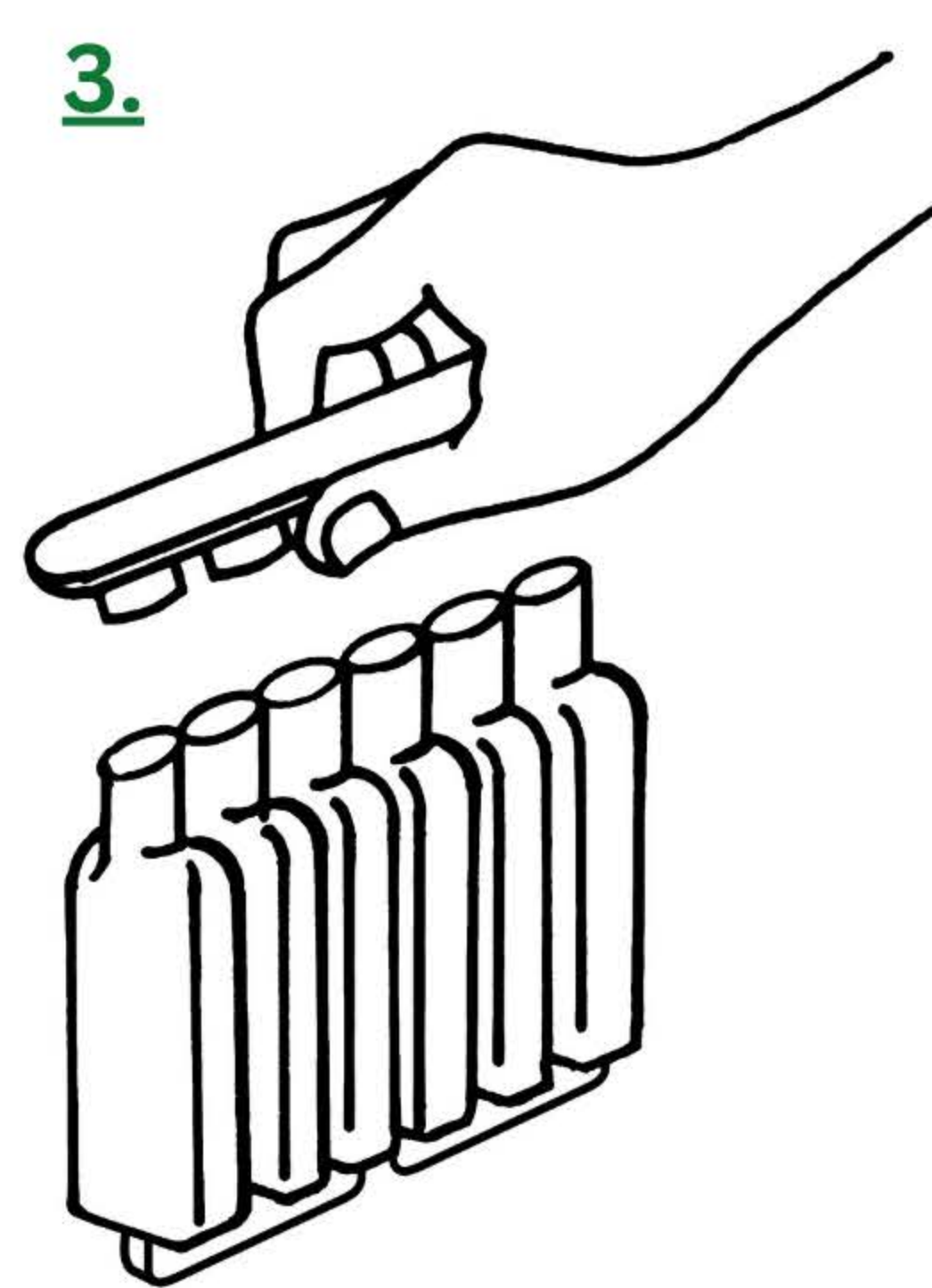

Simple steps to fill your AGM bottle-supplied batteries.

Benefits: Bottle-supplied is maintenance-free, ideal for long-term storage, offers 3X longer lifespan than conventional batteries.



4.

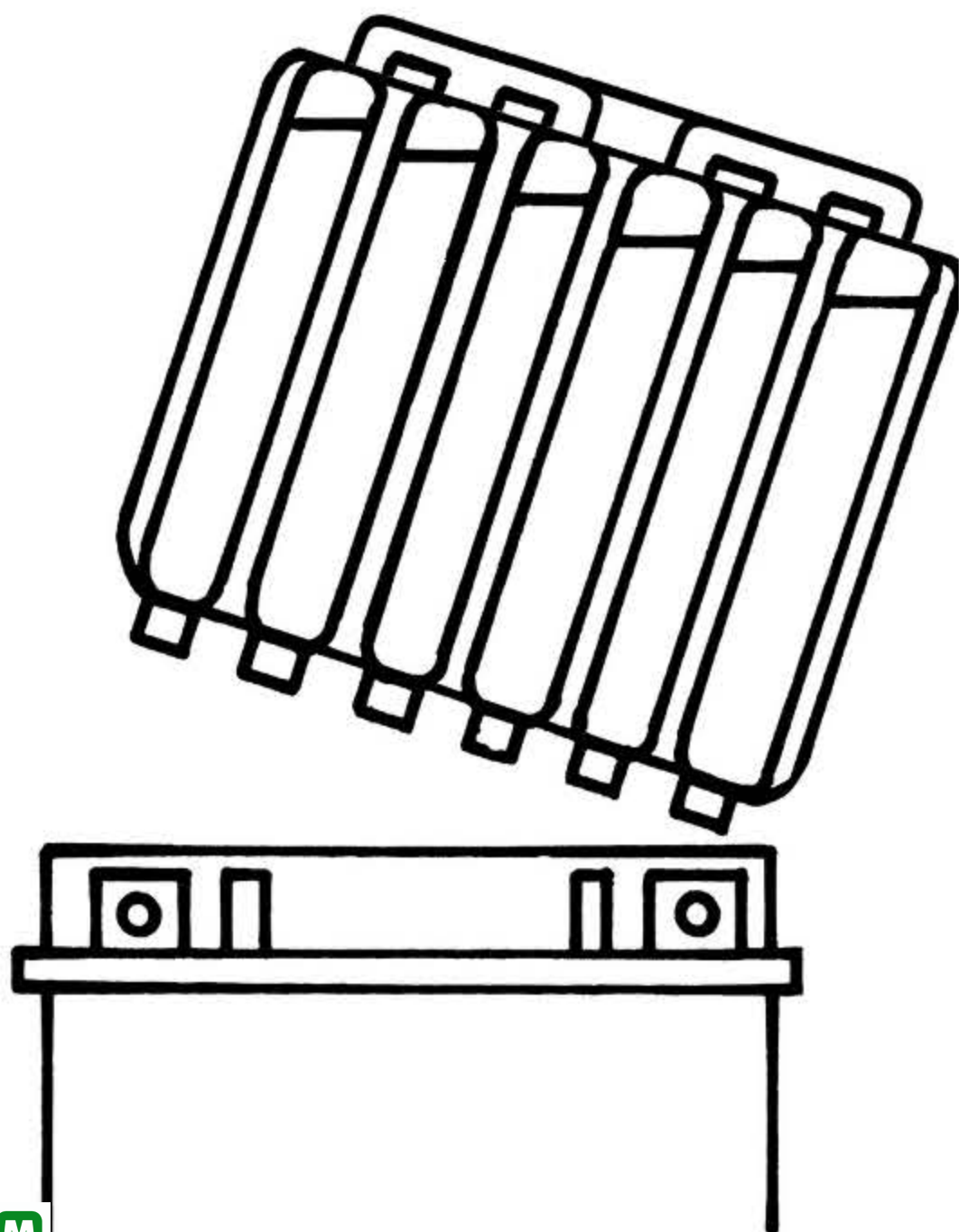

5.

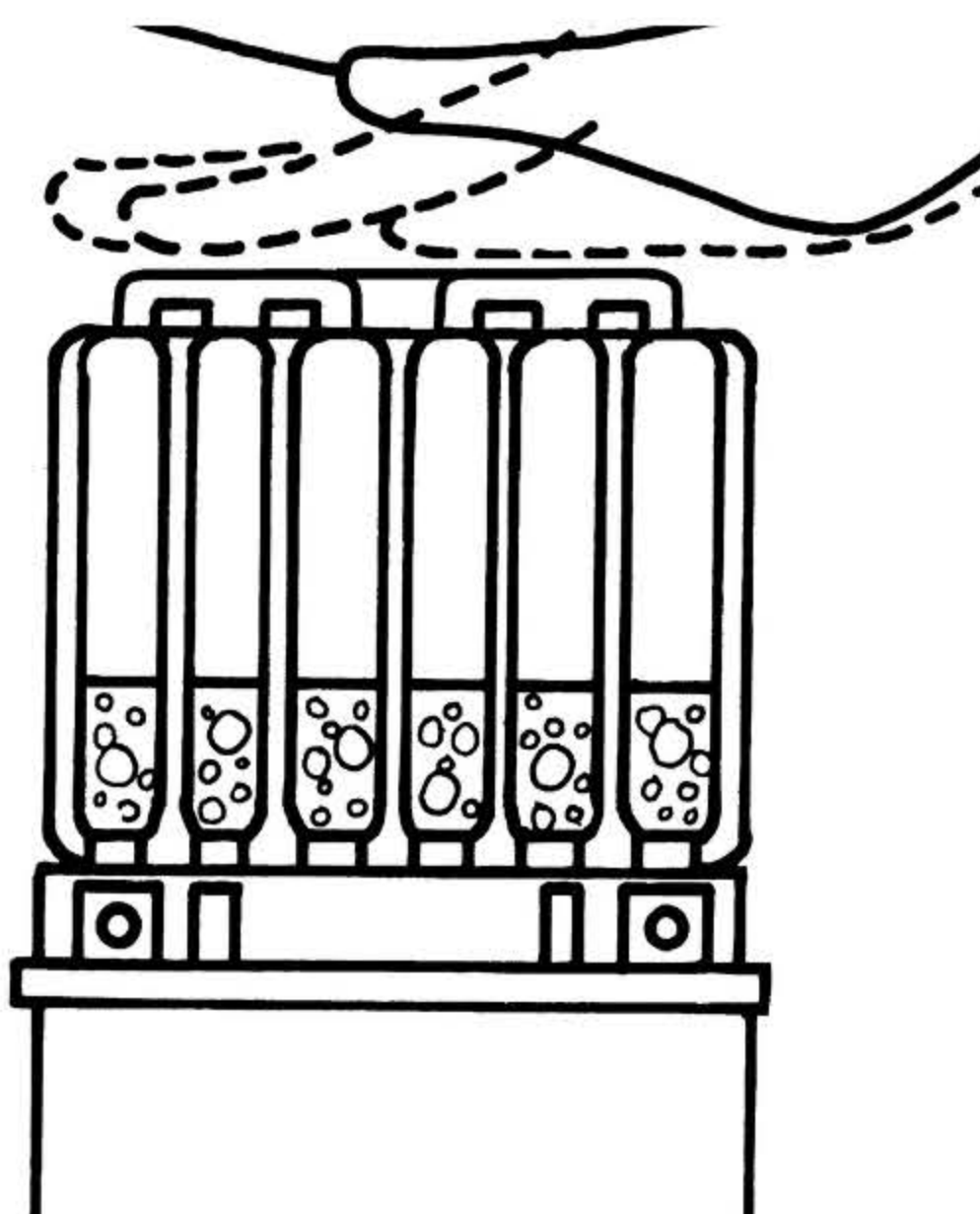

6.

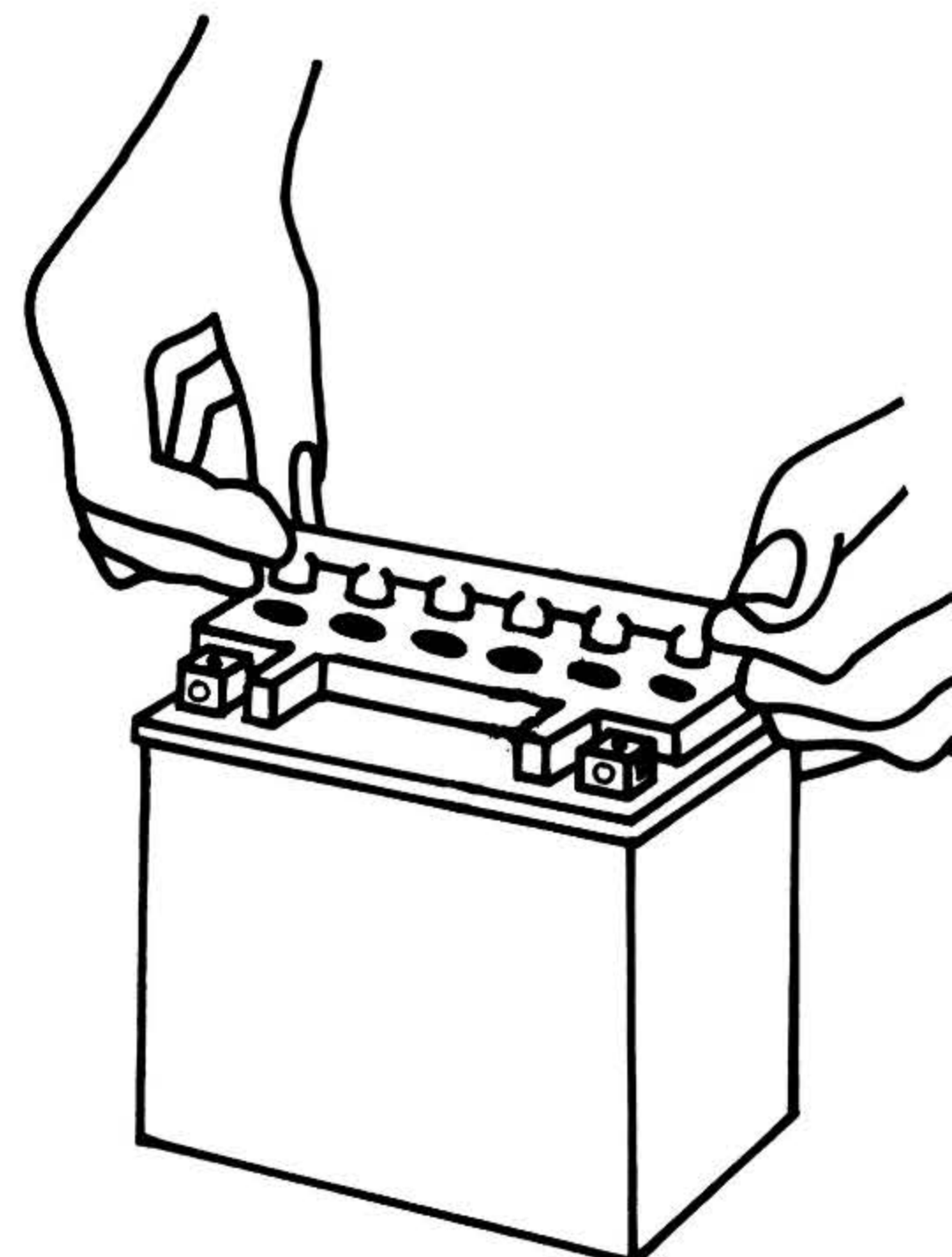



POWERSPORTS

AGM

MAINTENANCE FREE
DRY CHARGED • ACID PACK



POWERED BY



**BATTERY
OWNER'S
MANUAL**

IMPORTANT INFORMATION

PREPARING YOUR BATTERY FOR SERVICE

Read and follow all of these instructions carefully. Failure to do so may result in bodily injury and/or damage to vehicle.



DANGER/POISON!

KEEP OUT OF REACH OF CHILDREN

Be sure to read all safety instructions and follow directions carefully.



Shield eyes - Explosive gases can cause blindness or injury.



No sparks, flames or smoking.



Sulfuric acid can cause blindness or severe burns.



Flush eyes immediately with water.
Get medical help fast.



If spilled - spread baking soda over the wet area and then dilute with large amounts of water.



If swallowed - drink as much water or milk as possible. Get medical help fast.

STEP 1: BATTERY PREPARATION

NOTE: The battery may be equipped either with a foil strip or caps/plugs inserted into the filler openings. Remove the foil covering or plugs only when the battery is to be prepared for service prior to acid installation.

- 1a. Remove and retain the individual caps/plugs from the top of the battery. Remove and dispose of the foil strip from the top of the battery. There are normally six plastic caps or one foil strip.
- 1b. Remove and discard the vent cap from the top/side of the battery if applicable. Note - these are not used on AGM sealed batteries.

THERE ARE SIX FILL CAPS OR ONE FOIL STRIP

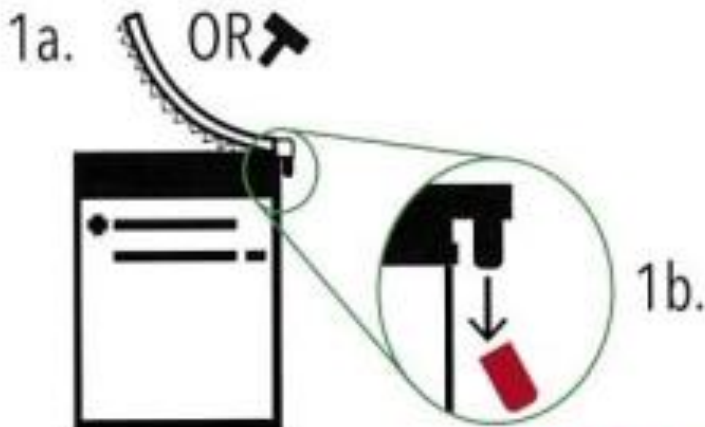

**REMOVE THE
VENT CAP AND
DISPOSE**



WARNING: Failure to remove the vent cap seal on conventional batteries prior to filling can cause the battery to explode or disperse excess acid/gas abnormally, causing personal injury and damage electrical, chrome and painted parts.

STEP 2: FILLING THE BATTERY

NOTE: There are two types of batteries - conventional and sealed. If you do not know which type you have, please consult your Interstate Batteries authorized dealer prior to filling the battery.

! Failure to follow instructions may shorten battery life and/or be dangerous.

Follow these instructions for filling batteries that have black cases or that are sealed.

- 2a. Place the battery on a level surface and remove the caps and/or sealing tape from the battery (not the acid bottles). Acid must not be warmer than 86° F/30° C at the time of filling.
- 2b. A separate container of sulfuric acid electrolyte will be included with the battery. **DO NOT** cut off or puncture the sealed end of the container's cap or remove the foil seal.

! **DO NOT PUNCTURE THE SEALS IN THE TOP OF THE ACID BOTTLES**



! **DO NOT PEEL THE SEALS AWAY FROM THE TOP OF THE ACID BOTTLES**



- 2c. Place the electrolyte (acid) container upside down with the six sealed areas so that the sealed ends mate with the six filler ports of the battery. Push the electrolyte (acid) container down firmly enough to break the seals. The electrolyte (acid) should start to flow when the seals are punctured. Be sure to keep the bottles straight up (vertical).

- 2d. Be sure that the bubbles are rising in all six cells after the puncture, thus emptying the electrolyte (acid). You may lightly tap on the bottom of the electrolyte (acid) container to expedite the process. Do not remove until all of the electrolyte (acid) has flowed into the battery case. Be careful not to drip any electrolyte (acid) when removing the electrolyte (acid) container.

Correct

Front View



Side View



Incorrect

Front View



Side View



- 2e. Let battery stand for a minimum of one hour to allow gases to escape.

NOTE: If you have extra acid in the fill bottle after filling the battery, you can neutralize the acid with an equal amount of baking soda. Dispose of acid bottle and any leftover acid according to local regulations.

STEP 3: INSTALLING THE CAP(S)/SEALING PLUG(S)

After the battery has stood for one hour, replace the cap(s)/sealing plug(s). Attach the clear (long) vent tube that is provided if you have not (where applicable), making sure the vent tube is not crimped and free of blockage. Wash off any acid spills with water, dry the battery and proceed with charging.

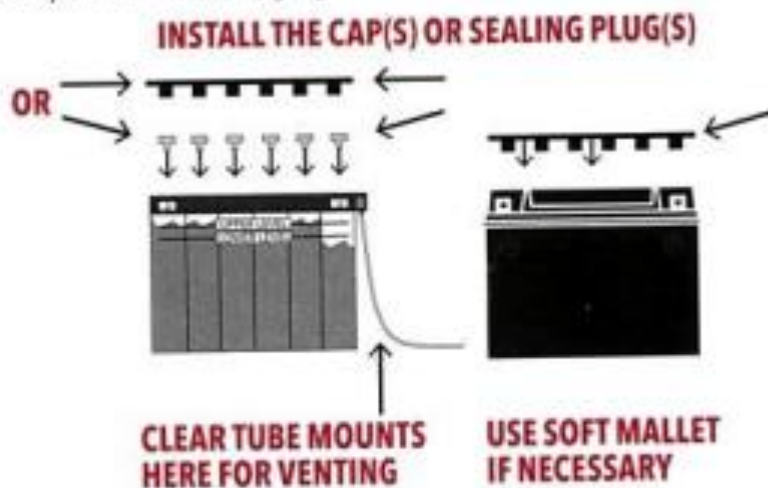

STEP 4: CHARGING THE BATTERY

DO NOT EXCEED CHARGING GUIDELINES

It is recommended to use a fully automatic battery charger of the correct amperage range and voltage for 6 volt and 12 volt batteries that has settings for AGM (sealed) batteries.

The battery will typically need to be charged for three to six hours or until the charger indicates the battery is fully charged.

- 4a. Select the correct amperage range. Failure to select the correct amperage range can result in battery damage. Use the guidelines below to select the correct amperage range.
 - For batteries that are rated 12 amp hours (AH) or less, charge with no more than 1 amp.
 - For batteries that are rated at 13 amp hours (AH) or greater, charge with no more than 1.5 amps.
- 4b. When the charger indicates that the battery is fully charged, disconnect the charger and let the battery sit for at least one hour.
- 4c. Measure the voltage.

AGM: if voltage measures 12.8 or less, put back on the charger for one to three hours (depending on your charger.)



WARNING: Do not exceed charging guidelines. Overcharging the battery may cause an explosion, excess gases and/or premature failure or shorter battery life.

STEP 5: INSTALLING THE BATTERY IN YOUR VEHICLE

- 5a. If any electrolyte (acid) has spilled on the battery, be sure to wash it off prior to installation.
- 5b. Position battery in holder.
- 5c. Fasten battery firmly to vehicle. Connect terminal properly—Positive (+) cable to the positive terminal on battery, Negative (-) cable to the negative terminal on battery.

MAINTENANCE/SERVICE

AGM batteries are maintenance free; do not open. Opening an AGM battery voids the warranty.

If the vehicle is not used frequently, the battery will require periodic recharging.



WARNING: Battery posts, terminals and related accessories can expose you to chemicals including lead and lead compounds, which are known to the State of California to cause cancer and birth defects or other reproductive harm. Wash hands after handling. For more information go to www.P65Warnings.ca.gov.

To replace under warranty in U.S., call 1.800.872.4100 or email amz@ibsa.com.

For limited warranty, see InterstateBatteries.com/amz-warranty.

Distributed by Interstate Batteries, Dallas, TX 75251 USA
interstatebatteries.com