



JLAB AUDIO
GO AIR
EARBUDS

We love that you are rocking JLab Audio!
We take pride in our products and fully stand behind them.



YOUR WARRANTY

All warranty claims are subject to JLab Audio authorization and at our sole discretion. Retain your proof of purchase to ensure warranty coverage.



CONTACT US

Reach out to us at support@jlabaudio.com or visit jlabaudio.com/contact

REGISTER TODAY

jlabaudio.com/register

Product updates | How-to tips
FAQs & more

BLUETOOTH PAIRING

- 1 Remove pull tab.
The charging case light will start **pulsing blue**.

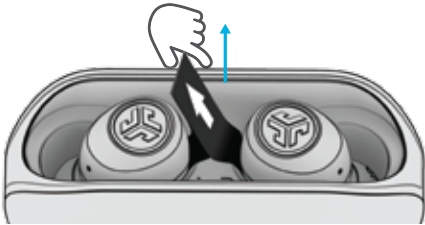

- 2 Remove earbuds by pulling straight up or from side.

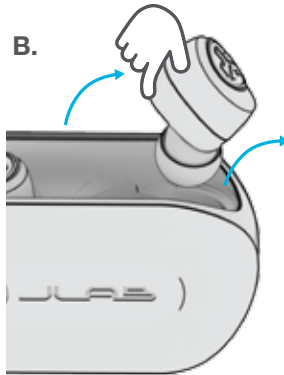
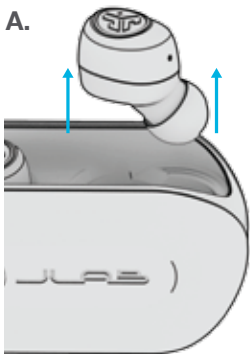

- 3 One earbud will **blink blue/white** indicating ready to pair to your device.

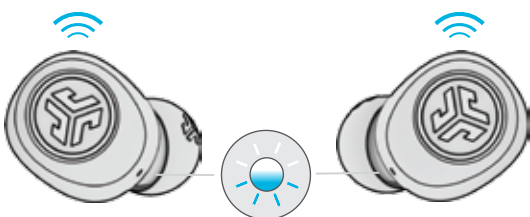

- 4 Select "JLab GO Air" in your device's Bluetooth settings to connect.

Voice prompt "You're connected" followed by solid white lights will indicate you are connected.

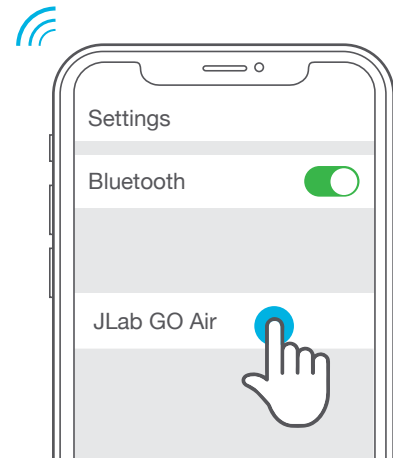
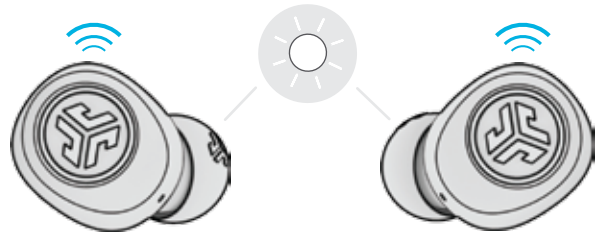

ADDING NEW / ADDITIONAL BLUETOOTH DEVICES:

Turn OFF Bluetooth from any previously connected device. **Turn ON Bluetooth** from new device.

Take earbuds out of the case.
Earbuds will automatically enter Bluetooth Pairing.

Select "JLab GO Air" in device settings to connect.

BUTTON FUNCTIONS



VOLUME DOWN: Single tap
SIRI (iOS) or "OK GOOGLE" (ANDROID): Double tap
TRACK BACK: Press & hold 1+ sec
EQ CHANGE: Triple tap
POWER ON: Press & hold 3+ sec

VOLUME UP: Single tap
PLAY / PAUSE: Double tap
TRACK FORWARD: Press & hold 1+ sec
ANSWER: Single tap
HANGUP: Double tap
REJECT INCOMING CALLS: Press & hold 1+ sec
EQ CHANGE: Triple tap
POWER ON: Press & hold 3+ sec

VOICE PROMPTS

"Hello": Power ON
"Ready to Pair": GO Air is ready to pair to Bluetooth device
"Bluetooth Connected": Earbud is connected to device
"Battery Full": 100-75%
"Battery Medium": 75-25%
"Low Battery": Less than 25% (When power decreases to 10%, "Low Battery" will play one time)
"Goodbye": Power OFF

CUSTOM EQ³ SOUND MODES

Tap either the right or left earbud 3 times for different EQ settings (GO Air will cycle 3 EQ settings).



JLab SIGNATURE
JLab C3™ signature sound with amplified bass and vocals



BALANCED
Even sound with no additional enhancements



BASS BOOST
Amplified bass and sub-bass

CHARGING EARBUDS

- 1 Earbuds will power off when placed in the case and first show charging case battery level.

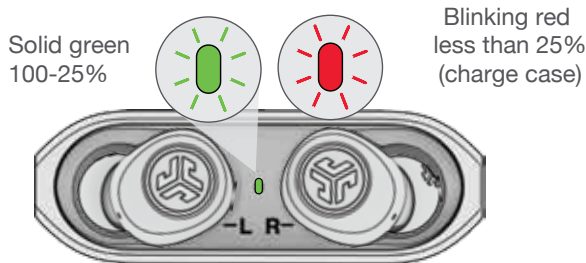

- 2 Then **pulsing blue light** indicates earbuds are charging and turns off when fully charged.

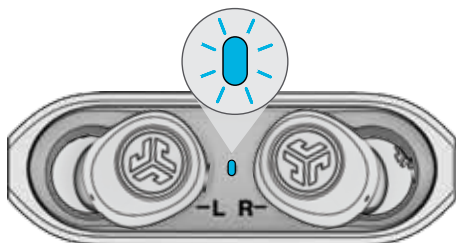

- 3 Earbuds will auto power on and connect to your device when removed.

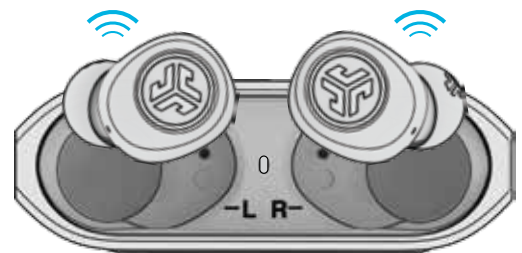

CHARGING CASE

Connect the GO Air into a computer or USB 5V 1A (or less) output device.

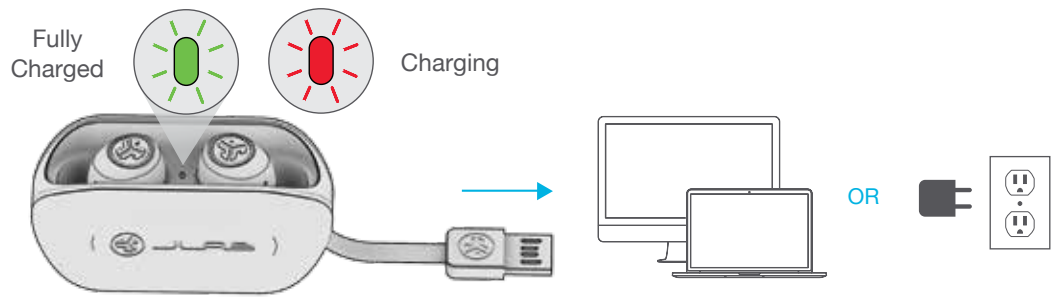

FITTING

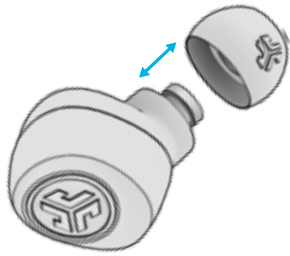

Try all ear tips for best fit and proper seal.



Place the earbud in the ear canal and slightly rotate to adjust for best fit.

QUICK TIPS

- The left or right earbud can be used independently for music and phone calls. Simply choose one and take out of the case to connect.
- Only ONE Bluetooth device can be connected at a time. Turn off Bluetooth on unwanted devices and turn on Bluetooth on chosen device to connect.

WARNING

Fully dry off the earbuds before putting in the charging case to avoid any damage to the case.

The earbuds are sweat/water resistant but the case is not.



TROUBLESHOOTING

Connection failure or earbuds disconnected from each other (Manual Reset)

- 1 Keep the earbuds in the charging case and forget "JLab GO Air" from your Bluetooth device settings.
- 2 Quick tap 7x on one earbud in charging case. Earbud blinks blue 3 times.
- 3 Quick tap 7x on other earbud in charging case. Earbud blinks blue 3 times.
- 4 Take both earbuds out of the charging case.
One earbud will be solid white and other will blink blue/white indicating ready to pair to your device.

Instructional videos at: JLABAUDIO.COM/MANUALS

CAUTIONS

- Avoid extreme heat, cold, and humidity.
- Avoid dropping or crushing the earbuds.
- Wax may build up in the earbud tips, lowering the sound quality.
Carefully remove the wax with a cotton swab or other small tool to improve the sound quality.
- If you experience discomfort or pain, try lowering the volume or discontinuing use temporarily.
- If you experience regular discomfort while using this product, discontinue use and consult your physician.
- We recommend you treat your earbuds as you would a nice pair of sunglasses and keep them in safe location when not in use.



Shop products | Product alerts | Burn-in your headphones

JLab Audio + Burn-in Tool



JLABAUDIO.COM