

### SIMPLE CAREGIVER PAGER SYSTEM

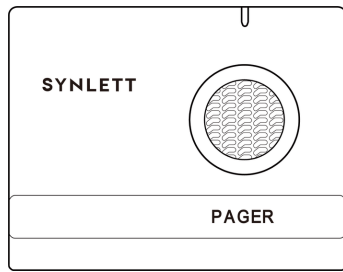

Caregiver Pager  
M091B



Call Button  
F100

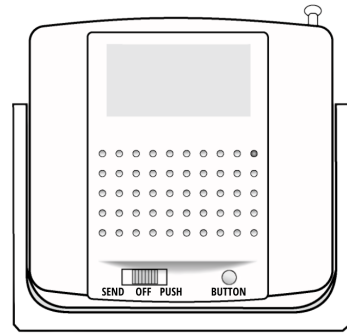

Motion Sensor  
QF029

#### Introduction

This simple caregiver pager system is an effective call and alert solution for staff or caregiver when assistance is required.

Call Button may be mounted on the headboard of a bed or worn as a pendant with lanyard. Press the call button to alert the pager remotely up to 300 feet\* range.

The Motion Sensor alerts the caregiver wearing the pager of a resident's activities when the resident interrupts the motion sensor's infrared field, as long as they are within 300 feet\* of each other.

The Caregiver Pager has an option of an audible alarm/chime to choose from and is compact enough to be carried in a pocket, clipped to a belt, or placed on a desk. This system allows both caregiver and resident freedom while calling for help.

#### Product Specifications

- Frequency: 433MHz;
- Operating Range: Up to 300ft\* (in open area);
- Motion Sensor Range Detection Area: see picture;
- Power Supply of Call Button: 23A 12V battery x 1 (included);
- Power Supply of Motion Sensor: AA battery x 3 (included) or 6-12V AC adaptor (not included);
- Power Supply of Pager: AA battery x 2 (included);

\*Note: surrounding metal walls or other electronic devices might interfere or affect the signal range.

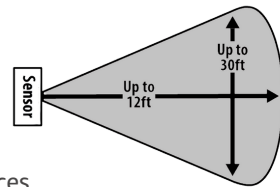

Thank you for your purchase.

Please read this manual carefully before using the product. For questions – email: [support.synlett@gaxintech.com](mailto:support.synlett@gaxintech.com).

#### Call Button - Setup

##### Battery Installation for Call Button

- 1 Gently pry open with the flathead screwdriver to access the battery compartment.
- 2 Insert the battery (included) inside the call button.
- 3 Push the button on the call button, the indicator lights up which means the call button is working correctly.

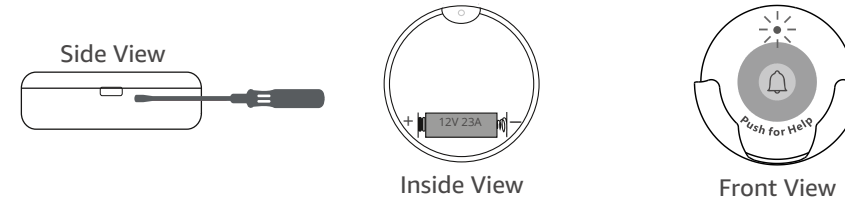

##### Call Button Installation

###### Mount Call Button with Double Sided Tape (Optional)

Place double sided tape on back of call button and mount to wall.

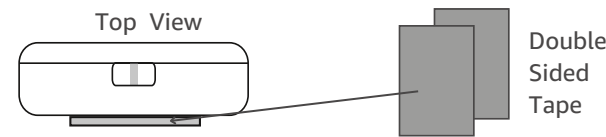

###### Mount Call Button to Wall with Bracket (Optional)

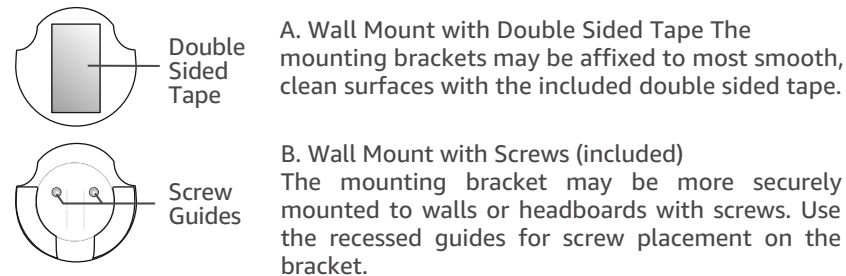

###### Lace Lanyard Strap thru Call Button (Optional)

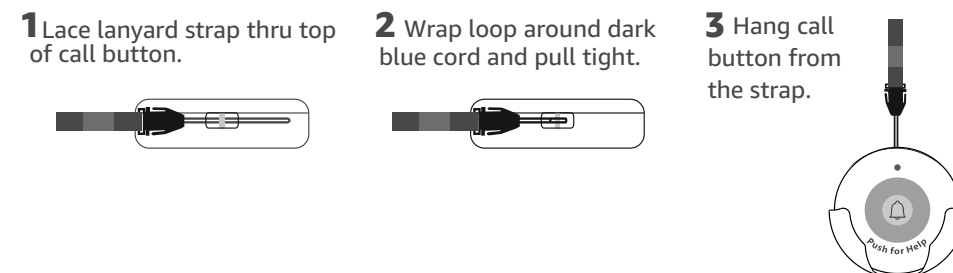

#### Motion Sensor - Setup

##### Motion Sensor

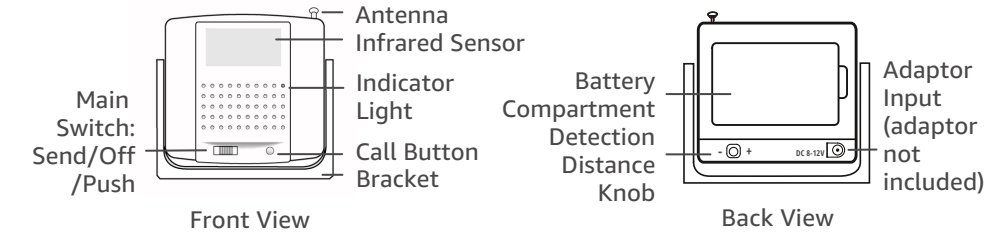

##### Motion Sensor Installation

If you use screws to fix the motion sensor to a permanent position, you will need to separate it from the bracket before you screw the bracket to a fixture.

- Rotate the motion sensor in its bracket 90 degrees so that it is facing the ceiling.
- Apply gentle pressure to one arm of the bracket so the motion sensor can easily pop out.

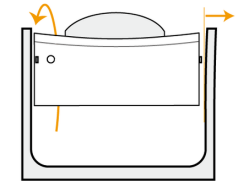

##### Mount the Motion Sensor

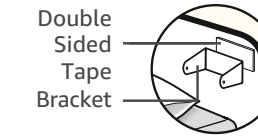

A. Wall Mount with Double Sided Tape  
The motion sensor may be affixed to most smooth, clean surfaces with the included double sided tape.

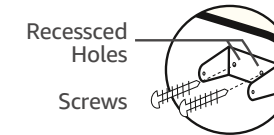

B. Wall Mount with Screws  
The motion sensor may be more securely mounted to walls or headboards with the included screws. Use the recessed holes for screw placement on the motion sensor.

##### Motion Sensor - Setup

- 1 Push in to release the battery compartment cover. Remove the insulating pull tab from the battery and close the battery compartment cover.
- 2 Slide the main switch to **SEND**: waving a hand in front of the infrared sensor. If the indicator lights up, it means the motion sensor is working correctly and a signal is being sent to the pager.

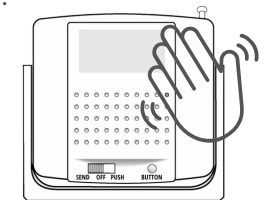
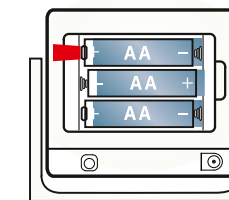

**3** Slide the main switch to **PUSH**: the infrared field is turned down and will only send a signal to the pager by pushing "**BUTTON**" on the right. If the indicator lights up, it means the motion sensor is working correctly.

**Tip: the "BUTTON" is also a button to pair the motion sensor to the pager.**

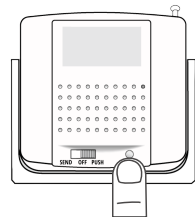

## Caregiver Pager - Setup

### ■ Set Up the Pager

Slide the belt clip into the slot on the back of the pager if needed.

The batteries are pre-installed in the pager. Slide open the battery cover on the back of the pager. Remove the insulating tab from the battery and close the battery cover.

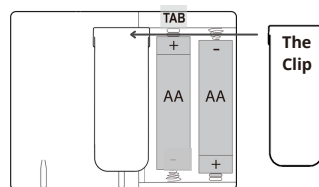

### ■ Select An Alert Mode

Slide the switch on the bottom of the pager to select either chime sound or alarm siren as alert.

**DINGDONG** - the pager only sounds one time when receiving a signal from the call button or the motion sensor.

**ALARM** - alarm siren will sound for about 20 sec when receiving a signal from the call button or the motion sensor.

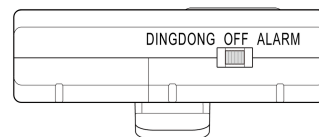

### ■ Adjust Volume Level

Adjust the pager volume by pressing the "**VOLUME**" button on the side of the pager to cycle through volume levels from low, medium and high.

A "Di-Di" sound rings out to indicate the current volume level.

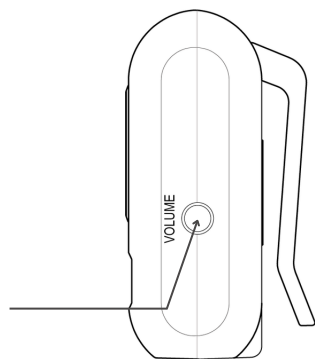

### ■ Stop the Alarm Sound

When the pager is on **ALARM** mode, the alarm siren will sound for 20 sec when the pager is triggered.

**Press and hold the "VOLUME" button for about 2 sec to stop the alarm if needed.**

### ■ Press the Component to Test

The pager will sound the selected alert tone with an indicator flashing when receiving a signal from a component.

**The pager is capable to program with up to 3 components** and each component represents unique indicator color: **RED, GREEN and BLUE**. It allows the caregiver to recognize and differentiate the call by reading the indicator color on pager.

## Add / Replace Component



**IMPORTANT: All existing components are required to re-program to the pager regardless of adding or replacing component(s) to the existing pager.**



**NOTICE: The first component that you would like to pair to the pager MUST be a BRAND NEW unprogrammed component. Otherwise the pager will NOT initiate the programming mode.**

To add a new component or replace component to your exiting pager, please follow the steps below (**if you are pairing the motion sensor(s), slide the main switch to PUSH mode before proceeding to the steps below**) :

**1** Switch the pager to OFF then switch it to DINGDONG mode, quickly within 5 seconds, press and hold the **NEW unprogrammed component** until you hear a DINGDONG sound.

For the call button, press and hold the call button; for the motion sensor, ensure it is on PUSH mode, press and hold the mini BUTTON on the right as the image shows below.

#### NEW Unprogrammed Call Button

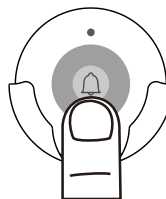

press and hold

#### NEW Unprogrammed Motion Sensor

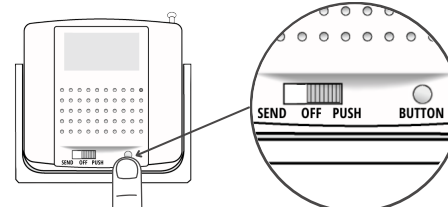

press and hold

OR

**2** A RED indicator on pager will light up with a DINGDONG sound, it means the 1st component is programmed to the pager in RED successfully.

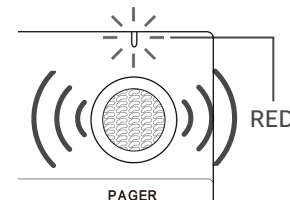

**5** The pager will exit the programming mode automatically after 5 seconds with no operations.

**3** Quickly, within 5 sec, press and hold the next component button until a GREEN indicator lights up on pager with a DINGDONG sound. The 2nd component is programmed to the pager in GREEN successfully.

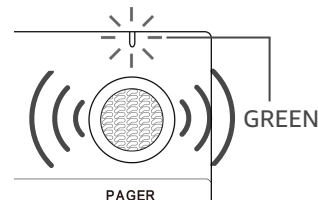

**4** Repeat the step, quickly within 5 sec, press and hold the next component button until a BLUE indicator lights up on the pager with a DINGDONG sound. The 3rd component is programmed to the pager in BLUE successfully.

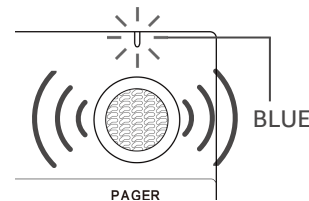

## Instructional Videos

Watch more hands-on instructional videos.

Available at SYNLETT Youtube channel:

<https://www.youtube.com/@mysynlett>.

Or scan the QR code for a direct link to SYNLETT Youtube channel.



## Frequently Asked Questions - FAQ

- Q: When I press the call button, the pager does not respond.  
A: Check if the indicator lights up on the call button when pressing the button. Or try replacing it with new AA batteries on the pager.  
If the issue persists, follow the instructions on "Add/Replace Component" to re-program the call button(s) to the pager.
- Q: Are the call buttons waterproof?  
A: The call buttons are rated IPX4 water resistant - meaning it withstands splashes from any direction, making them splash-proof. However, they cannot be submerged in water.
- Q: When I switch on the pager to DINGDONG or ALARM and press the VOLUME button to adjust the volume, the pager does not function correctly or it makes a strange click noise.  
A: Switch the pager to OFF and to ALARM/DINGDONG a few times and check if the issue persists.
- Q: Can I pair additional components or pager to the existing pager system?  
A: Yes. The pager is capable to program with up to 3 components. Follow the instructions on "Add/Replace Component" to start the programming. The programming color sequence for the pager is RED, GREEN and BLUE.
- Q: Can I adjust the detection distance of the motion sensor?  
A: There is a detection adjustment knob, which is below the battery compartment of the sensor. Insert a mini screwdriver into the slot and twist the knob in a clockwise/anti-clockwise direction to adjust the detection distance.

## Legal Disclaimer

SYNLETT's products rely on wireless technology which is subject to physical and environmental considerations. Please be aware that the transmitter will not be 100% accurate if it is out of range at anytime. It is the end-user's responsibility to make sure that the product is used correctly and within range of each other. SYNLETT's products are designed to augment well designed care programs & practices. We do not claim that any of its products are suitable as a substitute, or as a total solution for individuals that require care and constant supervision & are at risk. We recommend that all personnel receive periodic training in the operation of these products and products are tested before each use. It is important to read and follow the directions. **WARNING:** Failure to comply with the warning may result in injury or death. These devices are not suitable for all individuals. Other devices may be required. These devices are not a substitute for visual monitoring by a caregiver. The manufacturer does not claim that these devices will stop elopement and/or stop falls. These devices are designed to augment caregivers' comprehensive resident mobility management program. These devices are to be used by a licensed caregiver only. Test these devices before each use. Read the instructions and Legal Disclaimer. The SYNLETT wireless call system and its optional add-ons/accessories have a simple design that's easily installed by the end user. As such, it is the entire responsibility of the buyer to insure that the product is properly installed and tested. Further, the product is not designed to replace good caregiving practices including, but not limited to: A.) Direct patient supervision B.) Adequate training for staff personnel for elopement and fall prevention C.) Testing of the system before each use. **WHERE PERMISSIBLE, IT IS THE SELLER'S INTENT TO LIMIT ANY LIABILITY FOR SPECIAL, CONSEQUENTIAL OR INCIDENTAL ECONOMIC DAMAGES TO REFUND OF THE PURCHASE PRICE OR REPLACEMENT OF THE GOODS. SELLER DISCLAIMS ANY LIABILITY FOR COMPENSATORY OR OTHER DAMAGES ARISING OUT OF THE USE OF THE GOODS.** FCC ID: 2A4LY-F007 & 2A4WH-QF018.

FCC STATEMENT: Changes or modifications not expressly approved by the party responsible for compliance could void your authority to operate the equipment. NOTE: This equipment has been tested and found to comply with the limits for a Class B digital device, pursuant to Part 15 of the FCC Rules. These limits are designed to provide reasonable protection against harmful interference in a residential installation. This equipment generates uses and can radiate radio frequency energy and, if not installed and used in accordance with the instructions, may cause harmful interference to radio communications. However, there is no guarantee that interference will not occur in a particular installation. If this equipment does cause harmful interference to radio or television reception, which can be determined by turning the equipment off and on, the user is encouraged to try to correct the interference by one or more of the following measures: 1) reorient or relocate the receiving antenna, 2) increase the separation between the equipment and receiver, 3) connect the equipment into an outlet on a circuit different from that to which the receiver is connected, or 4) consult the dealer or an experienced radio/TV technician for help. This device complies with Part 15 of the FCC rules. Operation is subject to the following two conditions: 1) this device may not cause harmful interference, and 2) this device must accept any interference received including interference that may cause undesired operation.

Manufactured by Zhongshan Gaxin Technology Co., Ltd.  
Email: support.synlett@gaxintech.com  
MADE IN CHINA



Ver 2023Q2