



You're home.™

Energise Vibe™

Let's get started



C85-E2-(Be,Pe,Re)

vax.co.uk

Let's talk safety



Basic safety precautions

This vacuum cleaner is intended for household use only and NOT for commercial or industrial use.

- Only use the vacuum cleaner indoors on dry surfaces and keep the area you're cleaning well lit.
- Keep fingers, hair and loose clothing away from moving parts and openings whilst using the vacuum cleaner.
- This vacuum cleaner can be used by children aged from 8 years and above and persons with reduced physical,



Don'ts

- Don't use the vacuum cleaner if it has been dropped, damaged or left outdoors.
- Don't run over the power cord or use vacuum cleaner if the power cord or plug is damaged. Please contact our Customer Care Line on: 0330 026 8455 (Mon-Fri 8:30am to 6:30pm, Sat 9:00am to 5:00pm).
- Don't handle the plug or use the vacuum cleaner with wet hands.
- Don't pull or carry the vacuum cleaner by the power cord.
- Don't use the power cord as a handle, pull the power cord around corners, sharp edges or close a door over the power cord.
- Don't unplug vacuum cleaner by pulling on the power cord.



Do's

- Turn off all controls on the vacuum cleaner before disconnecting or connecting the power cord.
- Always make sure the filters are in place before use.
- Always switch off the vacuum cleaner before disconnecting or connecting the hose and accessories.
- Keep all openings clear and free from debris as this may affect the airflow/suction.
- Always replace the fuse in the plug with a British 13amp fuse. Always protect the power cable from heated surfaces and open flames.

sensory or mental capabilities or lack of experience and knowledge if they have been given supervision or instruction concerning use of the vacuum cleaner in a safe way and understand the hazards involved. Children shall not play with the vacuum cleaner. Cleaning and user maintenance shall not be made by children without supervision.

- Only Vax recommended tools and accessories should be used with this vacuum cleaner.

Please keep instructions for further use.

- Don't vacuum up any flammable or combustible materials (lighter fluid, petrol, kerosene etc.) or use the vacuum cleaner in an area with explosive vapours or liquid.
- Don't vacuum up hot coals, cigarette butts, matches or smoking hot burning items or use in an area where there may be harmful fluids (chlorine, bleach, and ammonia drain cleaner).
- Don't attempt to remove blockages with sharp objects as this may cause damage to the vacuum cleaner.
- Don't vacuum up hard or sharp objects such as glass, nails, screws or coins etc.
- Don't use the vacuum cleaner with incorrect voltage as this may result in damage or injury to the user. The correct voltage is listed on the ratings label.

- Take extra care when positioning and using the vacuum cleaner on the stairs.
- Use only CE approved 13amp extension cords, non-approved extension cords may overheat. Care should be taken to arrange the extension cord as it can be a trip hazard.
- Store the vacuum cleaner in a cool, dry area. If filters have been cleaned as per user guide instructions ensure they are thoroughly dry before storing away.

Thank you for buying this Energise Vibe™ product.

Taking care of your carpets and hard floors

The Energise Vibe™ product is designed to make vacuuming carpets and hard floors regularly, as effective and efficient as possible and this user guide will help you get the most out of your machine.

Maintaining your carpets and hard floors will ensure they keep their appearance for longer. You've chosen the carpets and hard floors for your home for a reason and Vax will help you take good care of them.

Taking care of your Energise Vibe™ product

Also inside this guide are instructions on maintaining your new machine, so that it's always ready when you are to tackle your carpets and hard floors.

Taking care of you

We're here if you need us. Instead of taking me back to the shop, simply visit:

vax.co.uk/support or call:

(UK) **0330 026 8455** (ROI) 1-800 928 308

Monday-Friday 8.30am to 6.30pm, Saturday 9.00am to 5.00pm

Calls are charged at the UK local rate. Please make a note of the serial number and model number of the product before calling.

Alternatively, you can write to us at:

Vax Ltd. Plot 302, Stonebridge Cross Business Park, Hampton Lovett, Droitwich, WR9 0LW, UK

This User Guide can be found online at: vax.co.uk/support



You're home.™



Let us know what you think @VaxUK

Contents

Let's talk safety

Getting to know your machine

Getting started

Using your machine

Taking care of your machine

Let's talk technical

Accessories

What to do if it goes wrong

Getting in touch

Initial Setup for normal operation

1. Use the base accessories.
 - a. Shortest hose
 - b. Extension tube set to shortest practicable length.
2. Clean filters installed.
3. Dust receptacle empty.
4. All Bleeds must be closed.
5. Floorheads/tools set to Carpet Mode for carpet cleaning.
6. Mechanical Agitation turned ON for carpet cleaning.
7. Floorheads/tools set to Hard Floor Mode for hard floor cleaning.
8. Mechanical Agitation turned OFF for hard floor cleaning.

Energise Vibe™ (Included with all models)

Included with your machine



Hose

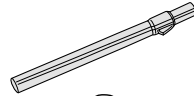

Telescopic
extension tube

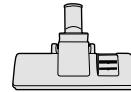

Combination floorhead



3-in-1 Tool



Pre-motor
filter



Post-motor
filter

Energise Vibe™ Pet



Tool connector



TurboTool

Energise Vibe™ Reach



Flexi-crevice tool



4.2m accessory
stretch hose

Getting to know your machine

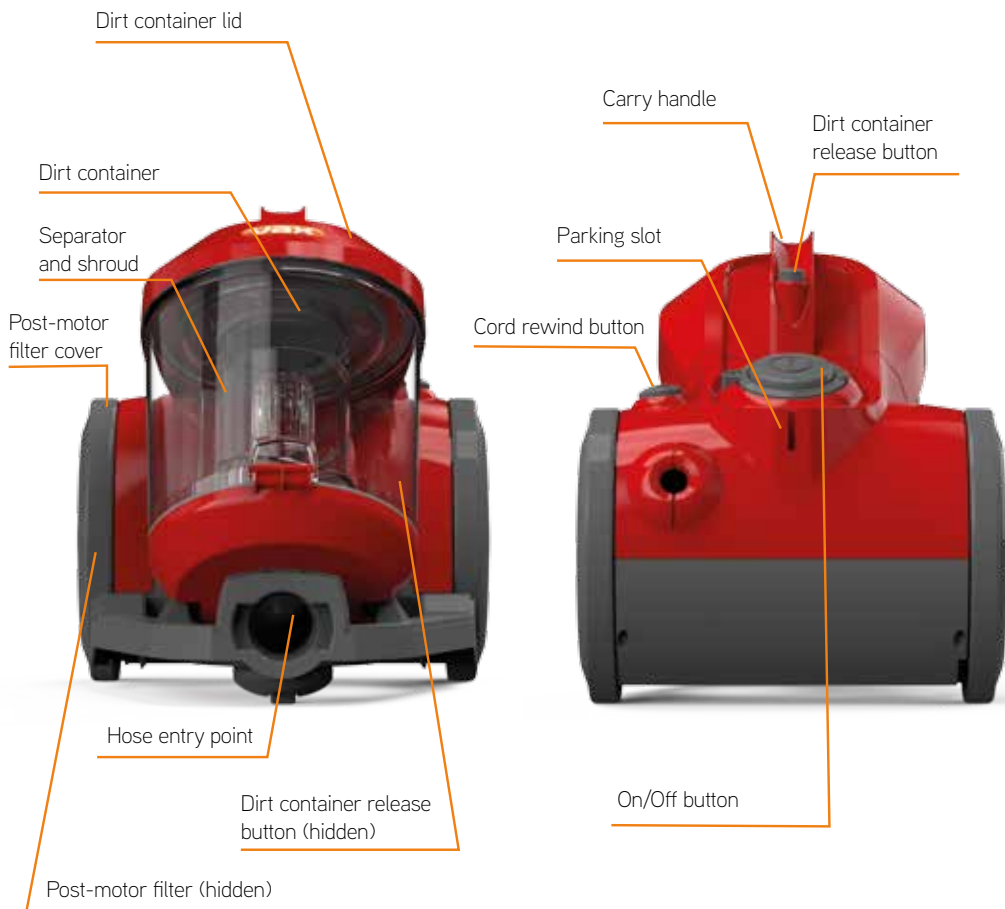

Technical Specification

Name **Energise Vibe™**
Voltage **See rating label on machine for details**
Wattage **See rating label on machine for details**
Cord Length **5m**
Weight **4.3kg**

Accessories & Consumables

Filter Kit (Type 95) 1-1-134231-00	Crevice Tool (Type 9) 1-3-128633-00
Upholstery Tool (type 3) 1-1-132116-00	Dusting Brush (Type 5) 1-9-127512-00
TurboTool (Type 6) 1-1-134419-00	Hard Floor Tool (Type 3)* 1-1-135705-00

PLEASE READ 'LET'S TALK SAFETY' AT THE BEGINNING BEFORE USE

Before you begin cleaning

CAUTION: Always switch off the vacuum cleaner before connecting or disconnecting the hose/attachments, or removing and emptying the dirt container.

IMPORTANT: The vacuum cleaner is equipped with a thermal cut-out. If for any reason the vacuum cleaner does overheat the thermostat will automatically turn the vacuum cleaner off. If this happens, switch the vacuum cleaner off and unplug. Remove and empty the dirt container also check the vacuum cleaner for blockages. Allow the vacuum cleaner to cool for approximately 1 hour (if you have cleaned the filters please wait 24 hours for the filters to fully dry before putting back into the machine).

Clean the pre-motor filter every time the dirt container is emptied and replace the post-motor filter every 12 months. If the vacuum cleaner is blocked, switch off and unplug before removing the blockage.

Assembling your vacuum cleaner

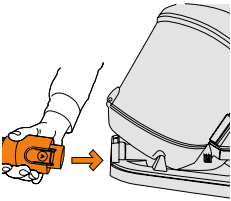

Press both buttons at the end of hose and insert into hose entry point.

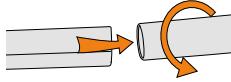

Insert hose grip into telescopic extension tube.

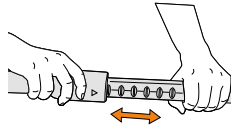

Press button on telescopic extension tube and adjust to required length.

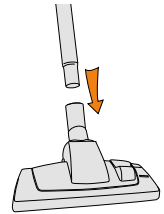

Insert the other end of the telescopic tube into the floorhead.

Using your accessories

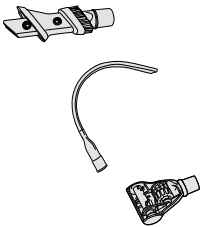

Choose an accessory.



Push the accessory onto the telescopic extension tube or hose end.

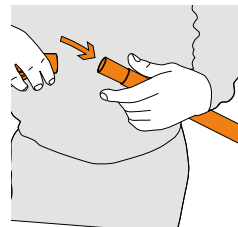

For some tools you may need to use the tool connector if it does not fit.

Using your machine

IMPORTANT: The base of the vacuum cleaner should always be positioned flat on the floor when starting and in use. The dirt container should be locked into place before lifting the vacuum cleaner by the carry handle.

IMPORTANT: The power cord must always be completely unwound, do not pull further than the yellow marker.

Operating the appliance and accessories

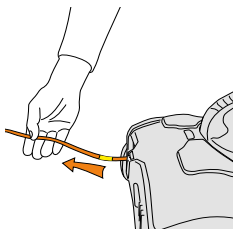

Unwind the power cord. Do not pull further than the yellow marker.

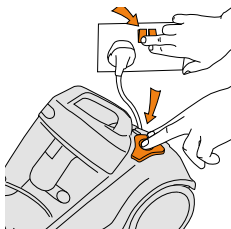

Plug into mains and press the On/Off button to switch the machine on.

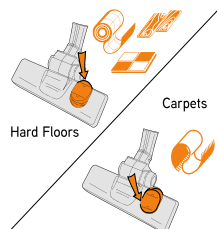

For use on carpets, click rocker switch forward. For use on hard floors click rocker switch back.

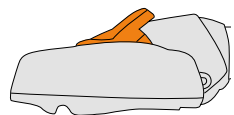

Raise brushes for carpets.

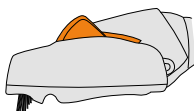

Lower brushes for hard floors.

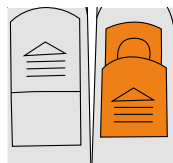

Slide vent cover on hose grip open to reduce suction if required.

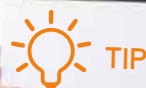

Brushes on the floorhead should be visible when using on hard floors.

Taking care of your machine

IMPORTANT: Unplug and switch off vacuum cleaner before performing maintenance or troubleshooting checks.

Emptying and cleaning the dirt container

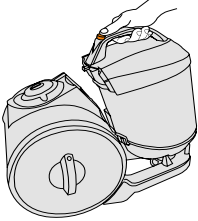

Press dirt container release button. Lift to remove dirt container from machine.

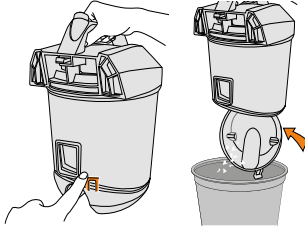

Hold dirt container over the bin. Press release clip at the bottom of the container, the dirt release door will open allowing dirt/debris to fall out.



TIP

Don't over fill the dirt container to avoid blocking the air flow through the vacuum cleaner.

Cleaning the pre-motor filter

NOTE: Clean the pre-motor filter every time the dirt container is emptied and replace the filters every 12 months. Filters available at www.vax.co.uk

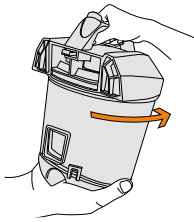

Turn the dirt container lid anti-clockwise to remove.



Lift to remove the pre-motor filter out of dirt container.

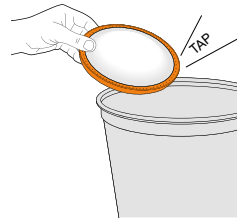

Tap the filter against a bin to remove excess debris.



Wash pre-motor filter under running water.

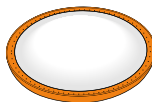
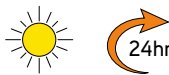

Leave to dry for 24 hours or until fully dry before placing back in the machine.

Taking care of your machine

Cleaning the shroud

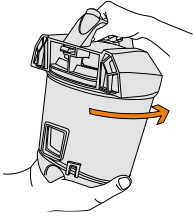

Turn the dirt container lid anti-clockwise to remove.



Lift to remove the pre-motor filter out of dirt container.



Using central grips lift to remove separator from dirt container.

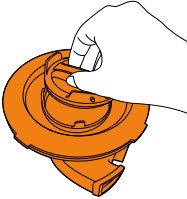

Twist grips clockwise and remove cap from separator.



Tap the separator against a bin to remove any dirt or debris.



Refitting separator and shroud

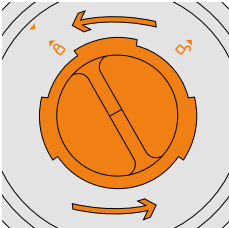

Line up lugs on separator cap with separator. Twist grips anti-clockwise to lock into place.



Line up lugs on separator with lugs on dirt container rim. Make sure the rectangular hole in the dirt container lines up with the rectangular hole on the separator.

IMPORTANT: Incorrect fitting of the shroud and separator will reduce suction.

Taking care of your machine

Post-motor filter maintenance

IMPORTANT: The exhaust filter is designed to offer long life with no maintenance. The filter should be checked periodically and when heavily discoloured it should be replaced. Please do not wash, scrub or brush the filter as this will damage the delicate filter media.

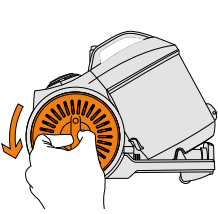

Turn the post-motor filter cover anti-clockwise to remove.

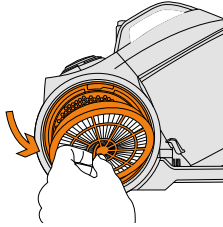

Pull to remove post-motor filter.

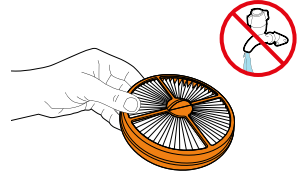

Check the post-motor filter for discolouration.

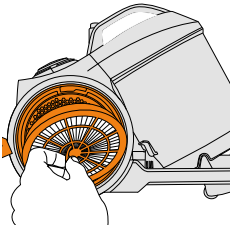

Push post-motor filter into wheel and re-fit.

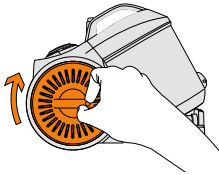

Line up the filter cover tabs with the wheel and turn clockwise. The filter cover will be locked into place when the centre trim is in the horizontal position.

Storing your vacuum cleaner

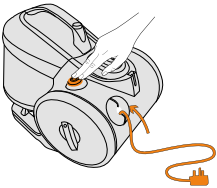

Unplug from the mains and hold the cord rewind button in, the cord will retract into the vacuum cleaner.

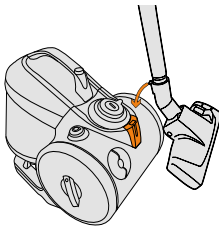

Place floorhead into parking slot located at back of vacuum cleaner for storage and carrying.

CAUTION: Make sure to hold the cord with your other hand to prevent injury when re-winding.

Let's talk technical

Removing blockages from the TurboTool (some models only)

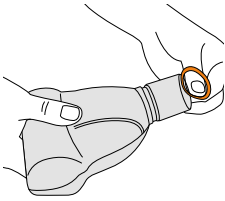

Slide the locking ring to remove.

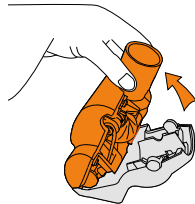

Lift and separate the housing.

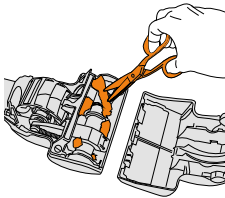

Using a pair of scissors, remove any threads or hair caught around the brushbar.

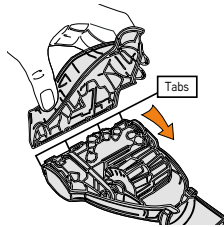

Line up the tabs on front of housing and push together to refit. Slide locking ring into groove to secure.

Removing a blockage from the hose

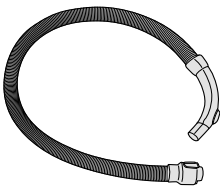

Remove the hose from the vacuum cleaner and telescopic extension tube. Insert a broom handle or similar blunt instrument into the hose to remove blockage.

Don't forget your accessories!

Order at: www.vax.co.uk/spares-and-solutions

Pro Cleaning Kit (Type 2)

1-1-133326-00

All our best tools all in one kit that makes cleaning your home quicker, easier and with even better results. We've taken care of cleaning all of the hard to reach areas such as on top of cupboards and in between blinds to the dust that collates behind and within the radiator.



TurboTool (Type 6)

1-1-134419-00

Use the TurboTool for vacuuming your stairs, upholstery and car interiors. It's great for picking up stubborn pet hair.



Fur 'n' Fluff Tool

1-1-131392-00

Specifically designed to remove extra stubborn pet hair from upholstery, furniture and carpets.



What to do if it goes wrong

Problem

Solution

Is there an accessory missing?

- Check the 'This pack contains' panel on the box to make sure the part is included with your vacuum cleaner.

Why won't the vacuum cleaner pick up?

- The dirt container may not be correctly fitted, remove the dirt container from the vacuum cleaner and check it's assembled correctly, refit ensuring it's locked into place.
- The shroud is blocked. Go to 'Taking care of your machine'.
- The separator and shroud are incorrectly fitted. Go to 'Taking care of your machine'.
- The filter may be clogged, clean the filter. Go to 'Taking care of your machine'.
- The dirt container may be blocked, empty the dirt container. Go to 'Taking care of your machine'.
- There may be a blockage in the hose/tube. Disconnect from the vacuum cleaner and carefully remove any blockages. Go to 'Let's talk technical'.

Why does my vacuum cleaner have no power?

- The plug may not be fully pushed into the electrical socket.
- Check the fuse in the plug if this needs replacing, always replace with a 13amp fuse.
- The motor thermostat may have tripped. If this has happened, unplug the vacuum cleaner. Remove and empty the dirt container and check the hose for blockages. Clean the filters and allow the vacuum cleaner to cool for approximately 1 hour (if you have washed the filters you will need to wait 24 hours for the filters to fully dry before putting them back into the vacuum cleaner).

Why is dust escaping from the vacuum?

- The filters may be clogged, clean the filter. Go to 'Taking care of your machine'.

CAUTION: To reduce the risk of personal injury, unplug the vacuum cleaner before performing maintenance /troubleshooting checks.

It's quick and easy to
register for your **FREE**

**2 year
guarantee[†]**

Online at: **vax.co.uk/guarantees**

Please retain your original receipt for proof of purchase.

we're here if you need us

Online **vax.co.uk/support**

Call: (UK) **0330 026 8455** (ROI) 1-800 928 308

Monday-Friday 8.30am to 6.30pm, Saturday 9.00am to 5.00pm*

Alternatively, you can write to us at:

Vax Ltd, Plot 302, Stonebridge Cross Business Park, Hampton Lovett, Droitwich,
Worcestershire, WL9 0LW, UK

* Calls are charged at the UK local rate. Please make a note of the serial number and model number of the product before calling.

† Registration required. Terms and conditions apply, see vax.co.uk for details.



You're home.™



@VaxUK

Vax Ltd., 5th Floor 2 Colmore Square, 38 Colmore Circus, Queensway, Birmingham, B4 6BN, UK
email: info@vax.co.uk website: vax.co.uk



EEC Statement of Compliance: Manufacturer/EEC importer: Vax Limited, hereby on our own responsibility, declare that the C85-E2-(Be,Pe,Re) series is manufactured in compliance with the following Directives:
Safety: 2006/95/EC Low Voltage Directive. **EMC:** 2004/108/EC Electromagnetic Compatibility Directive.



Waste electrical products should not be disposed of with household waste. Please recycle where facilities exist. Check with your Local Authority or retailer for recycling advice.