

Bissell®



STAINERASER™ TURBO MODEL 2982F

What's in the Box?.....	4	Removing & Emptying the Dirty Water Tank	8
Cleaning Formulas.....	4	After-Cleaning Care.....	9
Charging the Battery	5	Storing Your Machine.....	10
Positioning the Machine Correctly.....	5	Troubleshooting.....	10
Filling the Formula Tank.....	6	Warranty	11
Spot Cleaning Carpet & Upholstery.....	7		

Product Overview

1. Suction Channel
2. Brush Roll Cover Plate
3. Dirty Water Tank Release Latch
4. Dirty Water Tank
5. Removable Suction Lens
6. Spray Tip
7. Formula Tank
8. Formula Tank Cap
9. Control Buttons
10. Battery Status Indicator
11. Charging Port

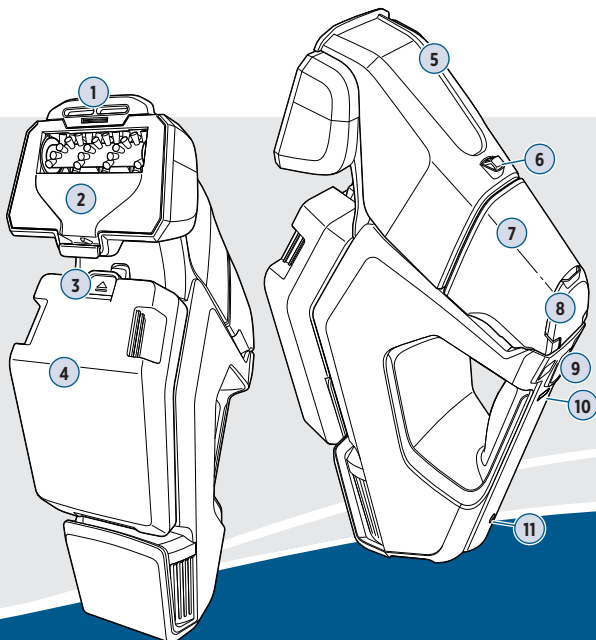

Go online for a comprehensive walkthrough of your new purchase!

This guide has everything you need to get ready for first use, including setting up, using and maintaining your machine, but online you'll find additional resources like tips and troubleshooting, videos, product registration, parts, and more. Go to **BISELL.com**.

IMPORTANT SAFETY INSTRUCTIONS

READ ALL INSTRUCTIONS BEFORE USING YOUR APPLIANCE. When using an electrical appliance, basic precautions should be observed, including the following:



WARNING

TO REDUCE THE RISK OF FIRE, ELECTRIC SHOCK OR INJURY:

- This appliance is not intended for use by persons (including children) with reduced physical, sensory or mental capabilities, or lack of experience and knowledge, unless they have been given supervision or instruction concerning use of the appliance by a person responsible for their safety.
- Children should be supervised to ensure that they do not play with the appliance.
- Unplug from electrical socket when not in use, before cleaning, maintaining, or servicing the appliance, and if your appliance has an accessory tool with a moving brush, before connecting or disconnecting the tool.
- Do not immerse in water or liquid.
- Keep hair, loose clothing, fingers, and all parts of body away from openings and moving parts of the appliance and its accessories.
- If the charger supply cable is damaged, it must be replaced by the manufacturer, its service agent or similarly qualified person in order to avoid a hazard.
- Do not incinerate the appliance even if it is severely damaged. The batteries can explode in a fire.
- The battery is to be disposed of safely.
- For specific battery removal instructions visit BISSELL.com.
- This appliance contains batteries that are only replaceable by skilled persons.
- Under abusive conditions, liquid may be ejected from the battery; avoid contact. If contact accidentally occurs, flush with water. If liquid contacts eyes, additionally seek medical help. Liquid ejected from the battery may cause irritation or burns.
- Use only with charger manufactured by E-TEK, Model ZD0006C100063AUE.
- This appliance must only be supplied at safety extra low voltage corresponding to the marking on the appliance.
- Recharge only with the charger specified by the manufacturer. A charger that is suitable for one type of battery pack may create a risk of fire when used with another battery pack.
- Unplug charger from electrical socket when not in use, before cleaning, maintaining or servicing the appliance, and if your appliance has an accessory tool with a moving brush, before connecting or disconnecting the tool.
- The battery must be removed from the appliance before it is scrapped.
- Do not use with damaged cable or charger. If appliance is not working as it should, has been dropped, damaged, left outdoors, or dropped into water, return it to a service center.
- The appliance must be disconnected from the supply mains when removing the battery.
- The appliance is only to be used with the power supply machine provided with the appliance.
- **WARNING:** For the purposes of recharging the battery, only use the detachable supply machine provided with this appliance.
- The orientation of the battery with regard to polarity is controlled by the keyed connector, the black wire is negative polarity and the red wire is positive polarity.
- Do not use non-rechargeable batteries.
- Do not mix batteries with general household waste. Recycle used batteries at your nearest recycling center.
- Battery pack and charger base output terminals are not to be short-circuited.
- Keep batteries out of reach of children.

- Dispose of used batteries promptly.
- Do not immerse. Use only on surfaces moistened by the cleaning process. Use only BISSELL® cleaning products intended for use with this machine.
- Use only the type and amount of liquids specified under the operations section of this guide.
- Use only on carpet moistened by the cleaning process.
- Liquid must not be directed towards equipment containing electrical components.
- Do not pull or carry charger by cable, use cable as a handle, close door on cable, or pull cable around sharp edges or corners.
- Keep charger cable away from heated surfaces.
- To unplug, grasp the charger plug, not the cable.
- Do not handle charger plug or appliance with wet hands.
- Do not charge the machine outdoors.
- The appliance must be disconnected from the supply mains when removing the battery.
- Do not recharge, disassemble, heat above 60°C, or incinerate.
- Never put batteries in mouth. If swallowed, contact your physician or local poison control.
- Prevent unintentional starting. Ensure the switch is in the OFF position before picking up or carrying the appliance. Carrying the appliance with your finger on the switch or energising appliance that have the switch on invites accidents.
- Do not modify or attempt to repair the appliance except as indicated in the instructions for use and care.
- Keep the temperature range of between 4-40°C when charging battery, storing or using the machine.
- Do not expose appliance to fire or excessive temperature. Exposure to fire or temperature above 130°C may cause explosion.
- Do not use appliance that is damaged or modified. Damaged or modified batteries may exhibit unpredictable behavior resulting in fire, explosion or risk of injury.
- Follow all charging instructions and do not charge the appliance outside of the temperature range specified in the instructions. Charging improperly or at temperatures outside of the specified range may damage the battery and increase the risk of fire.
- Have servicing performed by a qualified repair person using only identical replacement parts. This will ensure that the safety of the product is maintained.
- Make sure the power switch is OFF and the battery pack is removed from the appliance before making any adjustments, changing accessories, or storing appliance. Such preventive safety measures reduce the risk of starting the appliance accidentally.
- Use appliances only with specifically designated battery packs. Use of any other battery packs may create a risk of injury and fire.
- When battery pack is not in use, keep it away from other metal objects, like paper clips, coins, keys, nails, screws or other small metal objects, that can make a connection from one terminal to another. Shorting the battery terminals together may cause burns or a fire.
- Plastic film can be dangerous. To avoid danger of suffocation, keep away from children.
- Use only as described in this user guide.
- Use only manufacturer's recommended attachments.
- If appliance is not working as it should, has been dropped, damaged, left outdoors, or dropped into water; do not attempt to operate it and have it repaired at an authorised service center.
- Do not put any object into openings.
- Do not use with any opening blocked; keep free of dust, lint, hair, and anything that may reduce air flow.
- Use extra care when cleaning on stairs.
- Do not use to pick up flammable or combustible liquids, such as petroleum, or use in areas where they may be present.
- Do not pick up toxic material (chlorine bleach, ammonia, drain cleaner, etc.).
- Do not use appliance in an enclosed space filled with vapours given off by oil-based paint, paint thinner, some moth-proofing substances, flammable dust, or other explosive or toxic vapours.
- Do not pick up hard or sharp objects such as glass, nails, screws, coins, etc.
- Do not pick up anything that is burning or smoking, such as cigarettes, matches or hot ashes.
- Do not use without filters in place.
- Do not expose to rain. Store indoors.

SAVE THESE INSTRUCTIONS
ORIGINAL INSTRUCTIONS. FOR OPERATION ON A 220-240 VOLT
A.C. 50-60 HZ POWER SUPPLY ONLY.
THIS MODEL IS FOR HOUSEHOLD USE ONLY.

IMPORTANT INFORMATION

- Plastic tanks are not dishwasher safe. Do not put tanks in dishwasher.
- Disposal of Battery: To disconnect the battery charger from the product. Turn power OFF. Remove the battery cover screw. Remove the battery from compartment and disconnect by individually cutting the wires. For specific battery removal instructions visit BISSELL.com.

What's in the Box?

Standard accessories may vary by model. To identify what should be included with your purchase, please refer to the "Carton Contents" list located on the carton top flap.

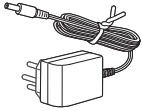
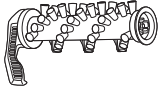
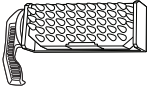
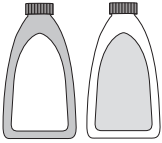
				
StainEraser™ Turbo	Charger	Tough Stain PowerBrush	Pet Tool	Trial-Size Formulas

Cleaning Formulas

➤ Find more formulas at [BISSELL.com](https://www.bissell.com).

Note: Always use genuine BISSELL® cleaning formulas for portable carpet and upholstery washers in your machine.

Pretreat

Pretreat spots and stains to improve cleaning performance.

	
Stain Pretreat Loosens set-in stains & odours before carpet washing.	Pet Stain Pretreat Loosens tough pet stains & odours before carpet washing.

Formula

Keep plenty of BISSELL cleaning formulas on hand so you can clean whenever it fits your schedule.

	
Spot & Stain Quick and effective spot cleaning.	Pet Stain & Odour Removes tough pet stains & odours.

Boost

Add to any formula to increase its effectiveness.

Oxy Boost Add to formula for permanent stain removal.

⚠ WARNING To reduce the risk of fire and electric shock due to internal component damage, use only BISSELL cleaning formula intended for use with this machine. Use of cleaning formulas that contain eucalyptus, lemon or pine oil may damage this appliance and void the warranty. Chemical spot cleaners or solvent-based soil removers should not be used. These products may react with the plastic materials used in your carpet washer causing cracking or pitting.

Charging the Battery

↖ If you need additional help charging your battery, search for your product on [BISSELL.com](https://www.bissell.com).

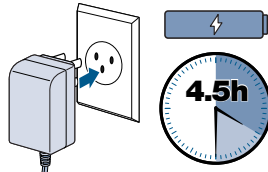
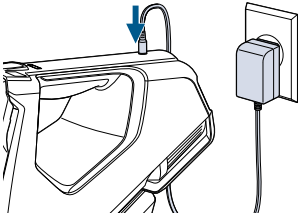

1. Charge machine before use. Make sure the machine is OFF. Insert Charger into the Charging Port as shown.

Note: There is a door covering the Charging Port that slides out of the way once Charger is inserted.

2. Plug the Charger into a wall outlet. The Battery Status Indicator lights will illuminate when charging.

Note: For maximum run time (up to 20 minutes), charge the machine for 4.5 hours prior to use.

Positioning the Machine Correctly

↖ For more helpful tips, check out [BISSELL.com](https://www.bissell.com).

To prevent leaking, ensure the machine is always in a horizontal or upright position.

Correct Positions

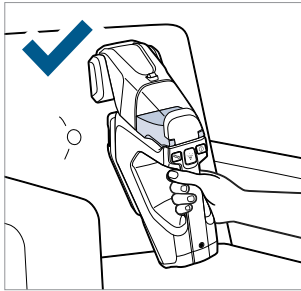
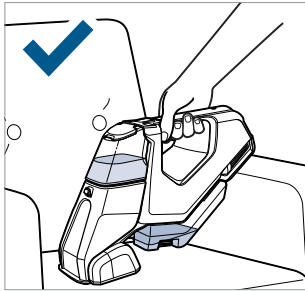

Incorrect Positions

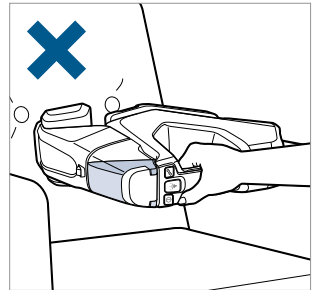
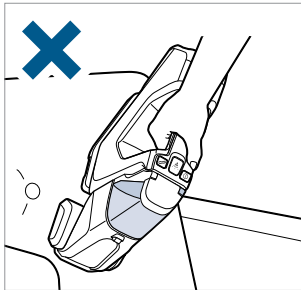
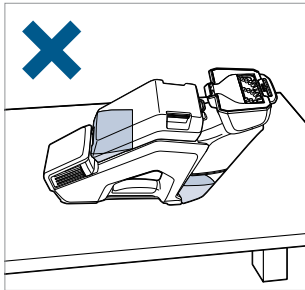

Filling the Formula Tank

↖ For tips and tricks on using your machine, search for your product on **BISSELL.com**.

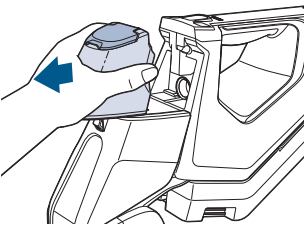

1. Remove the clean tank.



2. Open the Formula Tank Cap.

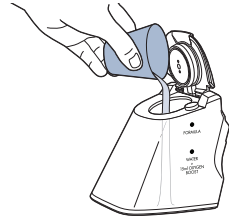

3. Optional: Add 15mL of BISSELL® Oxy Boost Formula.

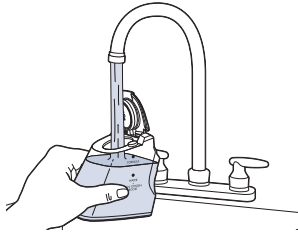

4. Add water to the “water + 15mL Oxygen Boost” dot.

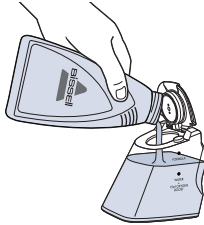

5. Add formula to the “formula” dot.

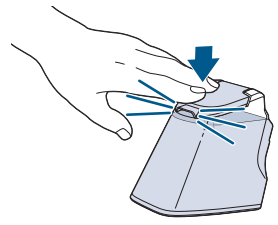

6. “Click” the Formula Tank Cap into place and make sure it’s secure.

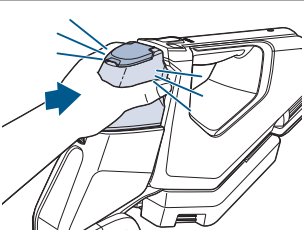

7. “Click” the Formula Tank into place and make sure it’s secure.

⚠ WARNING Keep spray away from face. Failure to do so may result in personal injury.

Spot Cleaning Carpet & Upholstery

▶ More of a video person? Search for your product on [BISSELL.com](https://www.bissell.com).

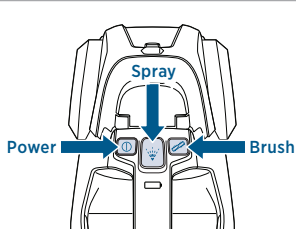

1. Press power button to turn machine ON.

Note: The rotating brush automatically turns on when powering machine ON. Press the brush button to turn off.

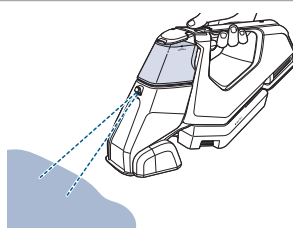

2. To remove the spot or stain, tilt the machine down so the Spray Tip is pointing at the area. Press the spray button to dispense formula.

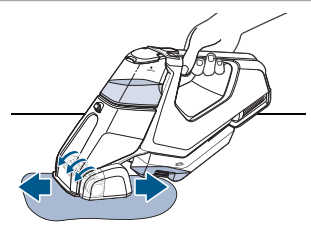

3. Scrub the area with the rotating PowerBrush, keeping the nose of the machine flat on the ground, as shown.

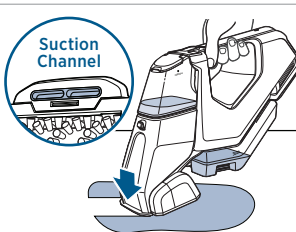

4. For maximum suction, tilt the machine forward and firmly press the Suction Channel down on the cleaning surface.

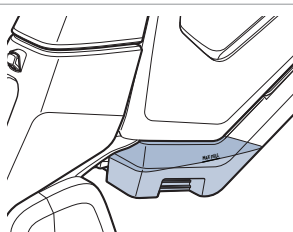

5. Make sure to check the Dirty Water Tank for when it reaches the "MAX FULL" line. See next page on how to empty.

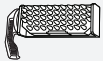

Note: The Pet Tool is an easy-to-clean brush for pet messes. See page 9 for steps on switching the tool.

⚠ WARNING Keep spray away from face. Failure to do so may result in personal injury.

Removing & Emptying the Dirty Water Tank

↖ We have additional tips for maintaining your machine at [BISSELL.com](https://www.bissell.com).

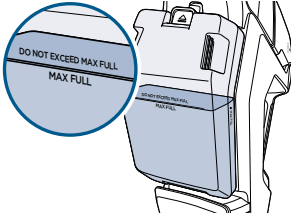

1. It is important to empty the Dirty Water Tank when it reaches the “MAX FULL” line as the machine is not intended for use above this point.

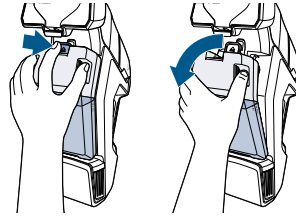

2. Ensure the machine is OFF. To remove Dirty Water Tank, sit the machine upright on a flat surface. Press up on the Dirty Water Tank Release Latch at the top and pull the tank out.

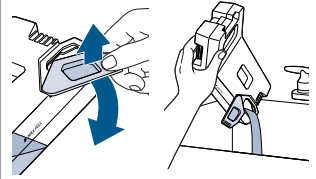

3. Pull the Dirty Water Tank plug open and empty into a sink or toilet.

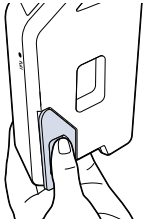

4. Ensure plug is secured back onto the tank by pressing firmly in the center of the plug.

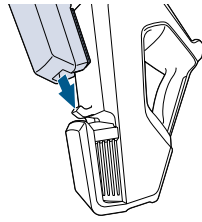

5. Return the Dirty Water Tank to the machine by aligning the bottom of the tank with the hook on the machine (as shown above).

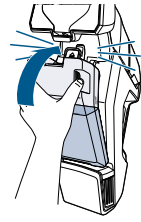

6. Rotate the tank forward until it “clicks” into place.

⚠ WARNING To reduce the risk of fire, electric shock or injury, turn power OFF and disconnect from charger before performing maintenance or troubleshooting.

After-Cleaning Care

For more tips on how to maintain your machine, visit BISSELL.com.

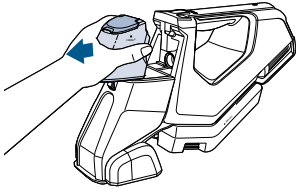

1. Remove the Formula Tank by grabbing the sides and pulling outward.

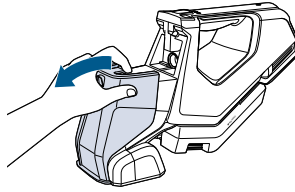

2. Release the Removable Suction Lens by raising the latch at the top and pulling outward.

Note: Be sure to empty the Dirty Water Tank prior to removing the Brush Roll.

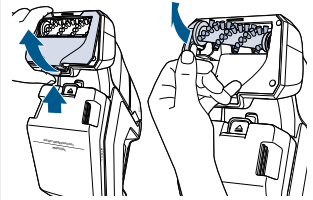

3. Sit machine upright on a flat surface. Pull the latch on the Brush Roll Cover Plate to open. Grab the brush by its handle and pull out.

Note: Pet Tool follows the same steps.

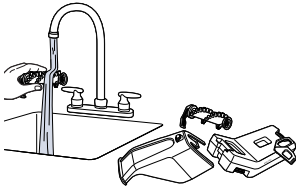

4. Rinse all components and allow to dry. See steps for "Removing & Emptying the Dirty Water Tank" on page 8.

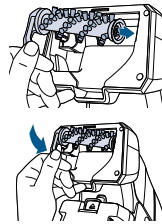

5. Sit machine upright. Replace the Brush Roll by carefully lining up the opposite end as shown.

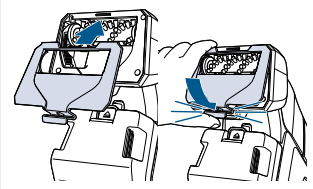

6. Replace Brush Roll Cover Plate by first sliding into the top and then rotating downward until "clicked" into place.

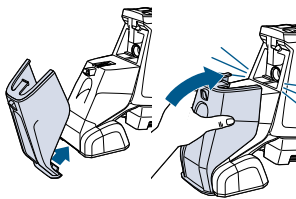

7. To install the Removable Suction Lens, attach the front lip to the front of the machine near the Brush Roll. Rotate the lens toward the machine until "clicked" into place.

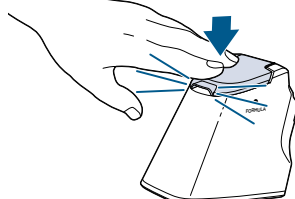

8. Click the Formula Tank Cap back into place. Ensure it is secure.

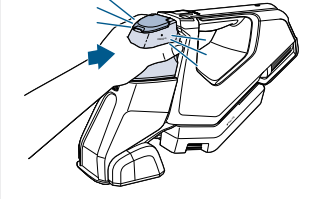

9. Replace the Formula Tank back onto the machine until "clicked" into place.

NOTICE To reduce the risk of a leaking condition, do not store where freezing may occur. Damage to internal components may result.

⚠ WARNING To reduce the risk of fire, electric shock or injury, turn power OFF and disconnect from charger before performing maintenance or troubleshooting.

Storing Your Machine

For more helpful maintenance tips, check out [BISSELL.com](https://www.bissell.com).

Before storing your machine, ensure the Dirty Water Tank is empty. Machine should not be left on its side with water in the Dirty Water Tank. Store your machine in a protected, dry area.

Troubleshooting

Below are some of the issues you may run into. If you don't see the issue you're experiencing below, visit [BISSELL.com](https://www.bissell.com).

Problem	Possible Cause	Remedies
Machine is not powering ON	Machine is not charged or needs to "wake up" before first use.	Charge machine before use.
Machine is leaking	Formula Tank and Formula Tank Cap are not properly seated.	Remove and replace Formula Tank and Formula Tank Cap until "clicked" into place, see page 6.
	Dirty Water Tank and plug are not sealed properly.	Remove and replace Dirty Water Tank and plug until secured into place, see page 8.
	Dirty Water Tank is full.	Empty tank. Machine should not be left on its side with water in the tank.
	Machine is tilted on its side, back or pointed directly downward.	Ensure machine is in horizontal or upright position.
Machine is not charging	Charger plug/cable not properly connected.	Make sure charger cable is secured into back of machine and charger plug is inserted fully into a working wall outlet.
Reduced or no spray	Pump not primed.	While the machine is ON, press and hold Spray Trigger for a few seconds.
	Spray Tip clogged.	Rinse Spray Tip with clean water.
	Formula Tank not fully inserted or is empty.	Ensure tank is full and securely seated by removing and then replacing, see page 6.
	Machine is in vertical orientation.	Use machine in horizontal orientation.
Reduced or no suction	Dirty Water Tank not properly installed.	Reinstall Dirty Water Tank and confirm plug is secure, see page 8.
	Removable Suction Lens not properly installed or is clogged.	Remove, clean, and reinstall Removable Suction Lens, see page 9.
	Removable Suction Lens not engaged with the carpet.	Tilt machine forward and press down firmly on the carpet.
Brushes not rotating	Removable brush improperly installed.	Remove and reinstall the brush, see page 9.
	Brush power off.	Press the brush button and ensure the brush LED is illuminated.
	Brush chamber full of debris.	Clear brush chamber of debris, see page 9.

Other maintenance or service not included in the manual should be performed by an authorized service representative.

⚠️ WARNING To reduce the risk of fire, electric shock or injury, turn power OFF and disconnect from charger before performing maintenance or troubleshooting.

Warranty

This warranty gives you specific legal rights, in addition to rights you may have under the *Australian Consumer Law*. If you need additional instruction regarding this warranty or have questions regarding what it may cover, please contact your local BISSELL Consumer Care on the details set out below.

It may be necessary to obtain some of your personal information, such as a mailing address, to fulfill terms of this warranty. Any personal data will be handled pursuant to BISSELL's Privacy Policy, which can be found at global.BISSELL.com/privacy-policy.

BISSELL® Two Year Warranty

Subject to the *conditions identified below, BISSELL will repair or replace (with new, refurbished, lightly used, or remanufactured components or products), at BISSELL's option, free of charge from the date of purchase by the original purchaser, for two years any defective or malfunctioning part due to manufacturer defect. This warranty applies to product used for personal purposes, and not commercial or rental service. This warranty does not apply to fans or routine maintenance or consumable components such as filters, belts, brush rolls, etc., damage or malfunction caused by negligence, abuse, neglect, unauthorized repair, or any other use not in accordance with the user guide. BISSELL recommends that the original packaging be kept for the duration of the warranty period in case such need arises within the warranty period that the item needs re-packing and transportation.

***Conditions of Warranty**

Subject to whether such loss is reasonably foreseeable, BISSELL and its in-country distributors are not liable for incidental or consequential damages of any nature associated with the use of this product.

This warranty is in addition to other rights or remedies under law. Nothing in this warranty excludes, limits or modifies any liability of BISSELL which is imposed by law, or limits or modifies any remedy available to the consumer which is granted by law. To make a claim under this warranty contact BISSELL Australia PTY LTD (details below). Contact BISSELL prior to returning any goods. Where agreed, BISSELL will reimburse reasonable postage / handling costs (if any) for returning goods to BISSELL. To claim expenses incurred in making a claim under this warranty please provide BISSELL with a copy of the receipt of the expenses by email or post.

For Australian Consumers Only: Our goods come with guarantees that cannot be excluded under the *Australian Consumer Law*. You are entitled to a replacement or refund for a major failure and compensation for any other reasonably foreseeable loss or damage. You are also entitled to have the goods repaired or replaced if the goods fail to be of acceptable quality and the failure does not amount to a major failure.

Consumer Care

Australia

Telephone: 1300 247 735

Website: www.BISSELL.com.au

New Zealand

Telephone: 0800 247 735

Website: www.BISSELL.co.nz

But wait, there's more!

Join us online for a complete guide to your new product, including troubleshooting, parts and more. **Go to [BISSELL.com](https://www.bissell.com).**



INFO



VIDEOS



PARTS



©2021 BISSELL Inc. All rights reserved.
Part Number 1624947 02/21