

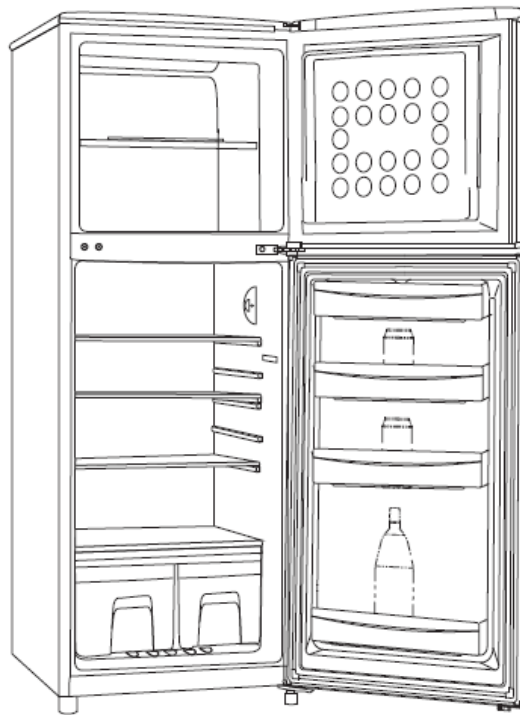

## REFRIGERATOR / FREEZER

Model **CP97R-1**



*Instruction Manual*

BEFORE USE, PLEASE READ AND FOLLOW ALL SAFETY RULES  
AND OPERATING INSTRUCTIONS.

**Felix Storch, Inc.**  
**Summit Appliance Division**  
**770 Garrison Avenue**  
**Bronx, New York, 10474**  
**[www.summitappliance.com](http://www.summitappliance.com)**

# TABLE OF CONTENTS

<b>Important Safeguards</b> .....	<b>2 - 3</b>
<b>In Case of Problems</b> .....	<b>4</b>
<b>Location of Parts</b> .....	<b>5</b>
<b>Installation Instructions</b> .....	<b>6 - 7</b>
<i>Before Using Your Appliance</i> .....	6
<i>Installation of Your Appliance</i> .....	6
<i>Electrical Connection</i> .....	6 - 7
<i>Reversing the Door Swing of Your Appliance</i> .....	7 - 8
<b>Operating Your Appliance</b> .....	<b>8 - 9</b>
<i>Temperature Control</i> .....	8
<i>Interior Light</i> .....	8
<i>Defrosting Your Appliance</i> .....	8 - 9
<i>Freezer Compartment</i> .....	9
<i>Using Your Ice Cube Tray</i> .....	9
<b>Care and Maintenance</b> .....	<b>10 - 11</b>
<i>Cleaning Your Appliance</i> .....	10
<i>Changing the Light Bulb</i> .....	10
<i>Power Failure</i> .....	10
<i>Vacation Time</i> .....	10
<i>Moving Your Appliance</i> .....	11
<i>Energy Saving Tips</i> .....	11
<b>Troubleshooting</b> .....	<b>12</b>
<b>Wiring Diagram</b> .....	<b>13</b>
<b>Limited Warranty</b> .....	<b>15</b>



# IMPORTANT SAFEGUARDS

Before the refrigerator/freezer is used, it must be properly positioned and installed as described in this manual, so read the manual carefully. To reduce the risk of fire, electrical shock or injury when using this appliance, follow basic precautions, including the following:



- Plug into a grounded 3-prong outlet, do not remove grounding prong, do not use an adaptor and do not use an extension cord.
- It is recommended that a separate circuit, serving only your refrigerator, be provided. Use receptacles that cannot be turned off by a switch or pull chain.
- Never clean refrigerator parts with flammable fluids. These fumes can create a fire hazard or explosion. Also, do not store or use gasoline or other flammable vapors and liquids in the vicinity of this or any other appliance. The fumes can create a fire hazard or explosion.
- Before proceeding with cleaning and maintenance operations, unplug the refrigerator or disconnect power. Failure to do so can result in electrical shock or death.
- Do not connect or disconnect the electric plug when your hands are wet.
- Do not attempt to repair or replace any part of your refrigerator unless it is specifically recommended in this manual. All other servicing should be referred to a qualified technician.
- **DANGER: Risk of child entrapment!**  
Child entrapment and suffocation are not problems of the past. Junked or abandoned appliances are still dangerous, even if they will "just sit in the garage a few days."
  - ✓ Before you throw away your old refrigerator or freezer, take off the doors. Leave the shelves in place so that children may not easily climb inside.
  - ✓ Never allow children to operate, play with or crawl inside the refrigerator.

## **WARNING**

FOLLOW WARNING CALL-OUTS BELOW ONLY WHEN APPLICABLE TO YOUR MODEL

- **This unit is not designed to operate in enclosed spaces. When placing your unit, make sure you allow adequate airflow on all sides.**
- Use two or more people to move and install the refrigerator. Failure to do so can result in back or other injury.
- To ensure proper ventilation for your refrigerator, the front of the unit must be completely unobstructed. Choose a well-ventilated area with temperatures above 60°F (16°C) and below 90°F (32°C). This unit must be installed in an area protected from the elements such as wind, rain, water spray or drips.
- The refrigerator should not be located next to ovens, grills or other sources of high heat.
- The refrigerator must be installed with all electrical, water and drain connections in accordance with state and local codes. A standard electrical supply (115-120V AC only, 60 Hz), properly grounded in accordance with the National Electrical Code and local codes and ordinances is required.
- Do not kink or pinch the power supply cord of the refrigerator.
- The fuse (or circuit breaker) size should be 15 amperes.
- It is important for the refrigerator to be leveled in order to work properly. You may need to make several adjustments to level it.
- All installation must be in accordance with local plumbing code requirements.
- Make certain that pipes are not pinched, kinked or damaged during installations.
- Check for leaks after connection.
- Although the unit has been tested at the factory, due to long-term transit and storage, the first batch of ice cubes must be discarded.
- Do not use solvent-based cleaning agents or abrasives on the interior. These cleaners may damage or discolor the interior.
- Do not use this apparatus for other than its intended purpose.

**CAUTION:** THIS APPLIANCE IS NOT DESIGNED FOR THE STORAGE OF MEDICINE OR OTHER MEDICAL PRODUCTS.

***SAVE THESE INSTRUCTIONS***

## **In Case of Problems**

Read this guide carefully. It is intended to help you operate and maintain your new appliance properly. Keep it handy to answer your questions.

Keep proof of original sales date (such as your sales slip) with this guide to establish the warranty period.

Write down the model and serial numbers. You'll find them on a plate located either on the back of the appliance or on an interior wall.

Please write these numbers here:

---

Date of Purchase

---

Model Number

---

Serial Number

Use these numbers in any correspondence or service calls concerning your appliance.

If you received a damaged appliance, immediately contact the dealer (or builder) who sold you the appliance.

Save time and money. Before you call for service, check the *Troubleshooting Guide* on page 12. It lists causes of minor operating problems that you may be able to correct yourself.

If you still need service, call the Summit Customer Help number at  
**1-718-893-3900**

## LOCATION OF PARTS

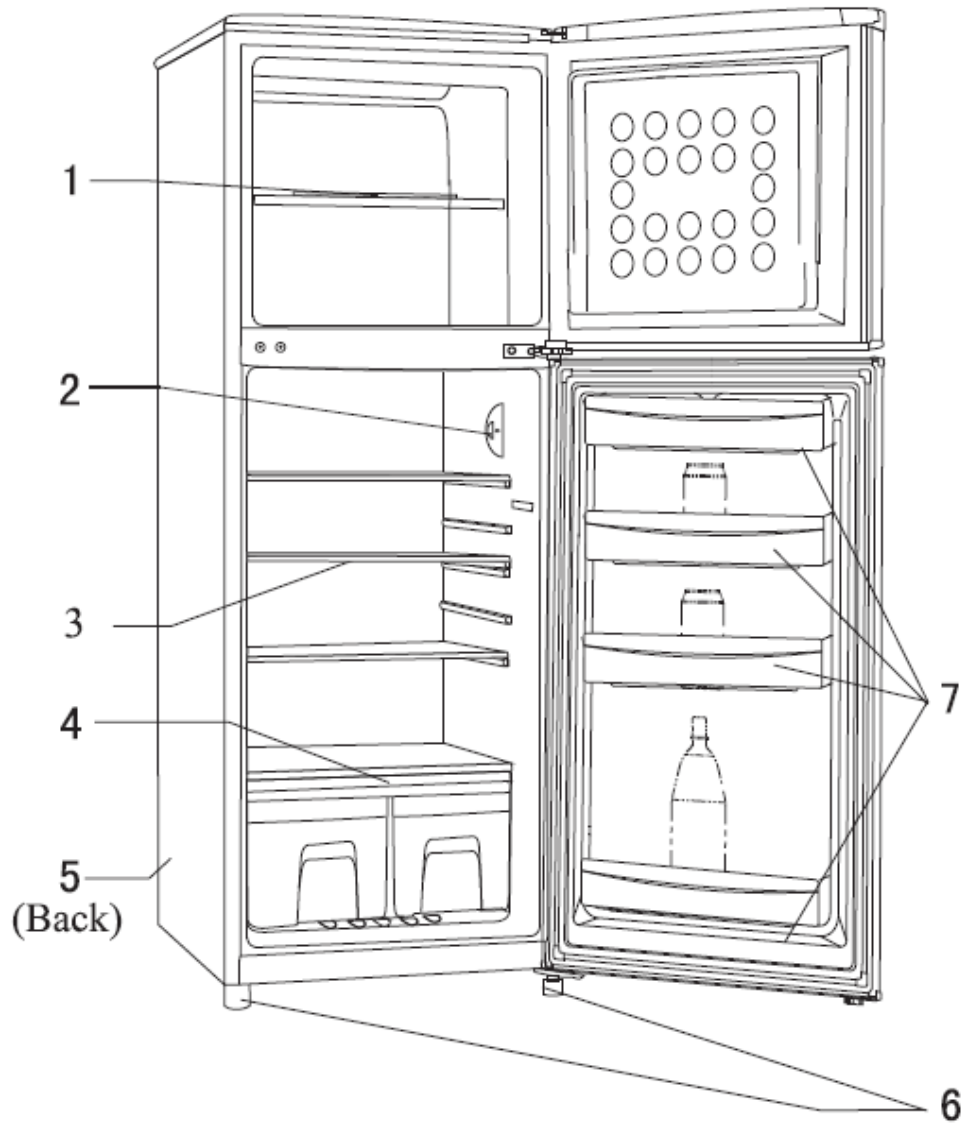

1. Freezer shelf
2. Temperature control (thermostat)
3. Refrigerator shelf
4. Crispers with glass cover
5. Compressor
6. Leveling legs
7. Door bins

# INSTALLATION INSTRUCTIONS

## **Before Using Your Appliance**

1. Remove the exterior and interior packing.
2. Check to be sure you have all the following parts:
  - 3 door bins
  - 1 bottle bin
  - 3 refrigerator shelves
  - 1 freezer shelf
  - 2 crispers
  - 1 glass crisper cover
  - 1 ice cube tray
  - Instruction manual
3. Before connecting the appliance to the power source, let it stand upright for approximately 2 hours. This will reduce the possibility of a malfunction in the cooling system from handling during transportation.
4. Clean the interior surfaces with lukewarm water using a soft cloth.
5. In case the interior accessories are not arranged correctly, reposition them as shown in *Location of Parts* on page 5.

## **Installation of Your Appliance**

- Place your appliance on a floor that is strong enough to support the unit when it is fully loaded. To level your appliance, adjust the legs at the front of the appliance.
- Leave 5" of space between the back and sides of the appliance and other surfaces, which allows the proper air circulation to cool the compressor.
- Locate the appliance away from direct sunlight and sources of heat (stove, heater, radiator, etc.). Direct sunlight may affect the refrigerator's coating and heat sources may increase electrical consumption. Extremely cold ambient temperatures may also cause the appliance not to perform properly.
- Avoid locating the appliance in moist areas. Too much moisture in the air will cause frost to form quickly on the evaporator, requiring more frequent defrosting of the appliance.

## **Electrical Connection**

### **⚡ Warning ⚡**

Improper use of the grounded plug can result in the risk of electrical shock. If the power cord is damaged, have it replaced by an authorized service technician.

- This appliance should be properly grounded for your safety. The power cord of this appliance is equipped with a three-prong plug which mates with standard three-prong wall outlets to minimize the possibility of electrical shock.
- Do not under any circumstances cut or remove the third ground prong from the power cord supplied.
- Plug the appliance into an exclusive, properly installed grounded wall outlet. Any questions regarding power and/or grounding should be directed toward a certified electrician or an authorized Summit service center.
- The use of extension cords is not recommended.
- This appliance requires a standard 115/120-volt, 60 Hz electrical outlet with three-prong ground. To prevent accidental injury, the cord should be secured behind the appliance and not left exposed or dangling.

### **Reversing the Door Swing of Your Appliance**

This refrigerator has the capability of opening either from the left or the right side. The unit is delivered to you with the door opening from the left side. Should you desire to reverse the opening direction, please call Summit Customer Service at **1-800-932-4267** for reversal instructions.

# OPERATING YOUR APPLIANCE

## Temperature Control

- Your appliance has only one control for regulating the temperature in the fresh food and freezer compartments. The temperature control, or thermostat, is located on the upper right hand side of the fresh food section.
- The range of the temperature control is from **1** (the warmest) to **7** (the coldest). The first time you turn the unit on, set the control to its maximum setting, which is **7**.
- After 24 to 48 hours, adjust the temperature control to the setting that best suits your needs. A setting of **4** or **5** should be appropriate for home or office use.
- To turn the appliance off, turn the temperature control to **0**.

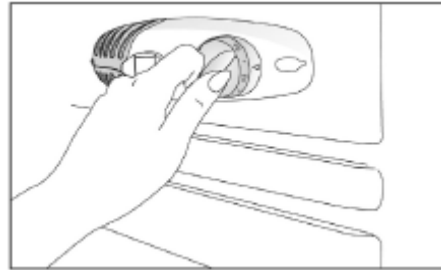

## **NOTES:**

- Turning the temperature control to the **0** position stops the cooling cycle but does not shut off the power to the appliance.
- If the unit is unplugged, has lost power, or is turned off, you must wait 3 to 5 minutes before restarting the unit. If you attempt to restart before this time delay, the unit will not start.

## Interior Light

When you open the door to the refrigerator compartment, the light will be ON automatically. When you close the door, the light goes OFF automatically.

## Defrosting Your Appliance

**When?** For the most efficient operation and minimum energy consumption, defrost the freezer compartment when the frost on the freezer walls is excessive, or 1/4" thick. There is no need to defrost the refrigerator compartment, because ice depositing on the inner back wall is defrosted automatically. Ice deposits on the inner back wall during compressor operation; later on, when the compressor is not operating, ice defrosts. Water droplets collect and drain through an outlet in the inner back wall into the drain pan situated above the compressor, where the water evaporates.

### **How?**

1. Reset the thermostat to the OFF position, **0**, and disconnect the power supply.
2. Remove the frozen food from the appliance and place it in a cooler to protect the food.

3. Leave the door open for a while so that you can easily scrape off the frost. Use a plastic scraper but be careful not to damage the inner surfaces of the freezer.
4. Wipe up the scraped ice before it is completely defrosted.
5. Reconnect the power and close the door. Set the thermostat to its original position.
6. Allow time for the freezer to reach its normal temperature, then reload the food.

**CAUTION:** Do not use boiling water for defrosting because it may damage the plastic parts. In addition, never use a sharp or metallic instrument to remove frost as it may damage the cooling system and will void the warranty. We recommend using a plastic scraper.

### **Freezer Compartment**

- Proper use of the appliance, adequately packed food, correct temperature and hygienic precautions will substantially influence the quality of freezing food or storing frozen food.
- Carefully select food you intend to freeze; it should be of adequate quality and suitable for freezing.
- Use correct packaging and wrap it carefully.
- The packaging should be airtight and shouldn't leak since this could cause substantial nutrition loss and dehydration of foods.
- Foils and bags should be flexible enough to tightly wrap around the foods.
- When preparing foods to be frozen, consider sanitary precautions.
- Mark packages with the following data: kind and amount of food and date of loading.
- It is most important that the food be frozen as quickly as possible.
- If the loading amount is too large, the quality of freezing is reduced which in turn affects the quality of the frozen foods.

### **Using Your Ice Cube Tray**

- Recommended thermostat setting for ice making is the maximum setting, **7**.
- Fill the ice cube tray two-thirds full with cold water or with any liquid suitable for freezing and place the tray on the floor of the freezer to freeze properly.
- Be sure the bottom of the tray is dry, otherwise it may stick to the floor of the freezer.
- The best method of releasing ice cubes from the tray is to hold the tray under cold tap water for a second.
- To eject ice cubes from the tray, place over an ice bucket and twist slightly.

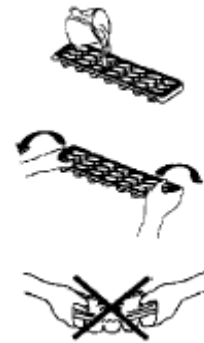

# CARE AND MAINTENANCE

## Cleaning Your Appliance

1. Turn the temperature control to **0**, unplug the appliance and remove the food, shelves and trays.
2. Wash the inside with a solution of warm water and baking soda. The solution should be about 2 tablespoons of baking soda to a quart of water.
3. Wash the shelves and trays with a mild detergent solution. Plastic parts cannot be washed in a dishwasher.
4. The outside of the appliance should be cleaned with a solution of mild detergent in warm water.
5. The condenser coils in the back of the unit should be vacuumed when they are dusty or dirty.
6. Clean the drain pan on the refrigerator compressor. Do not remove the drain pan.
7. After cleaning, reconnect the appliance to its power source and reload the food packages.

## Changing the Light Bulb

1. Unplug the AC power cord from the wall.
2. Squeeze the tabs at the top and bottom of the light bulb cover simultaneously.
3. Remove the light bulb cover.
4. Unscrew the bulb.
5. Replace with a 10-watt bulb that is the same shape and size.
6. Replace the light bulb cover.

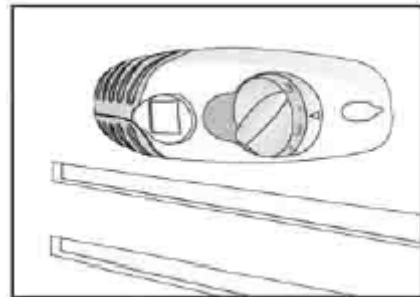

## Power Failure

Most power failures are corrected within a few hours and should not affect the temperature of your appliance if you minimize the number of times the door is opened. If the power will be off for a longer period of time, you need to take the proper steps to protect your food.

## Vacation Time

During long absences, remove all the food. Unplug your appliance, clean it and leave the door open slightly to avoid formation of condensation, mold and odors.

### **Moving Your Appliance**

1. Remove all the food and disconnect the unit from the power source.
2. Securely tape down all loose items inside your appliance.
3. Turn the leveling screws up to the base to avoid damage.
4. Tape the doors shut.
5. Be sure the appliance stays in the upright position during transportation.

### **Energy Saving Tips**

- The appliance should be located in the coolest area of the room, away from heat-producing appliances or heating ducts, and out of direct sunlight.
- Let hot foods cool to room temperature before placing in the appliance. Overloading the appliance forces the compressor to run longer. Foods that freeze too slowly may lose quality or spoil.
- Be sure to wrap foods properly, and wipe containers dry before placing them in the appliance. This cuts down on frost build-up inside the appliance.
- Appliance storage bins and shelves should not be lined with aluminum foil, wax paper or paper toweling. Liners interfere with cold air circulation, making the appliance less efficient.
- Organize and label food to reduce door openings and extended searches. Remove as many items as needed at one time, and close the door as soon as possible.
- Try not to open the door too often, especially when the weather is wet and hot.
- Every so often, check if the appliance is sufficiently ventilated.
- A layer of ice and frost increases energy consumption, so clean the appliance as soon as the layer is 1/4" thick.

## TROUBLESHOOTING

Problem	Possible Cause
Appliance does not operate.	Not plugged in. The circuit breaker has tripped or the fuse has blown.
Appliance does not cool.	Temperature control is set at <b>0</b> .
Compressor turns on and off frequently.	Condenser coil at back of the unit is dirty. The room temperature is hotter than normal. A large amount of food has been added to the appliance. The door is open too often. The door is not closed completely. The temperature control is not set correctly. The door gasket does not seal properly. The appliance does not have the correct clearances (5" to both sides and back of unit).
The light does not work.	The circuit breaker has tripped or the fuse has blown. The appliance is unplugged. The bulb has burned out. (See <i>Care and Maintenance</i> for replacement procedure.)
Vibrations	Check to be sure the appliance is level.
The appliance seems to make too much noise.	A rattling noise may come from the flow of the refrigerant, which is normal. As each cycle ends, you may hear gurgling sounds caused by the flow of refrigerant in your appliance. Contraction and expansion of the inside walls may cause popping and crackling noises. The appliance is not level.
The door will not close properly.	The appliance is not level. The doors were reversed and not properly installed. The gasket is dirty. The shelves, bins or baskets are out of position.

# WIRING DIAGRAM

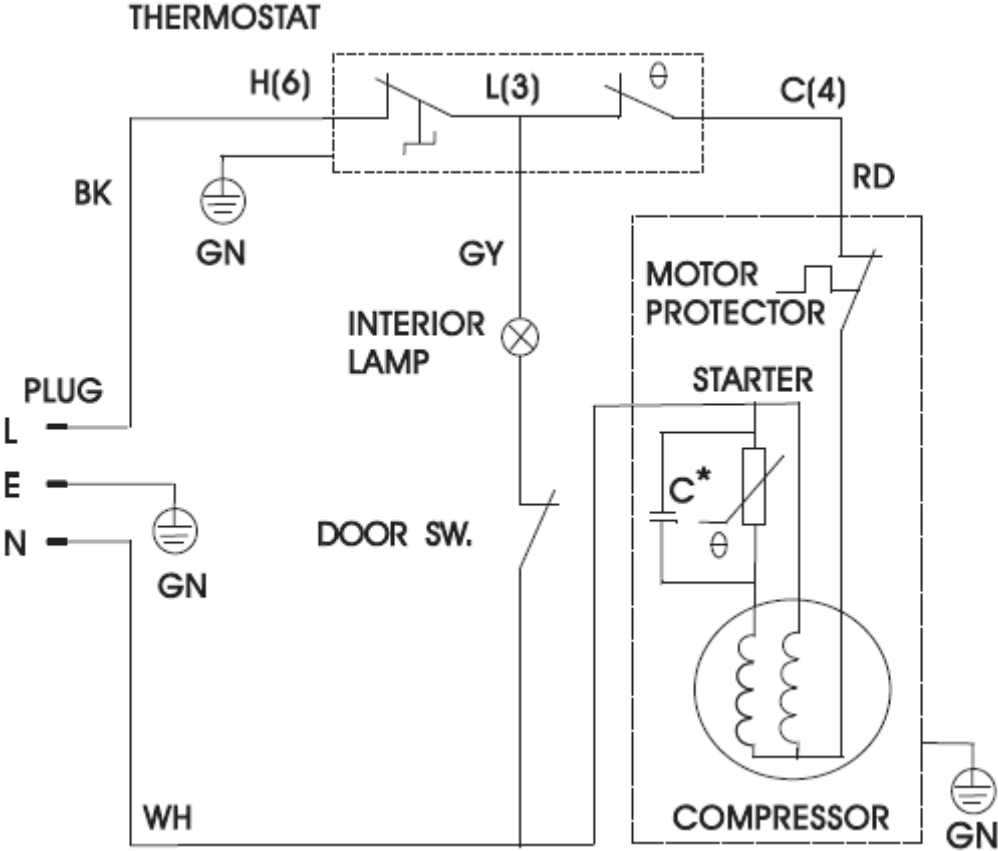

# NOTES

# LIMITED WARRANTY

## ONE YEAR LIMITED WARRANTY

Within the 48 contiguous United States, for one year from the date of purchase, when this appliance is operated and maintained according to instructions attached to or furnished with the product, warrantor will pay for factory-specified parts and repair labor to correct defects in materials or workmanship. Service must be provided by a designated service company. Outside the 48 states, all parts are warranted for one year from manufacturing defects. Plastic parts, shelves and cabinets are warranted to be manufactured to commercially acceptable standards, and are not covered from damage during handling or breakage.

## 5 YEAR COMPRESSOR WARRANTY

1. The compressor is covered for 5 years.
2. Replacement does not include labor.

### **ITEMS WARRANTOR WILL NOT PAY FOR:**

1. Service calls to correct the installation of your appliance, to instruct you how to use your appliance, to replace or repair fuses or to correct wiring or plumbing.
2. Service calls to repair or replace appliance light bulbs or broken shelves. Consumable parts (such as filters) are excluded from warranty coverage.
3. Damage resulting from accident, alteration, misuse, abuse, fire, flood, acts of God, improper installation, installation not in accordance with electrical or plumbing codes, or use of products not approved by warrantor.
4. Replacement parts or repair labor costs for units operated outside the United States.
5. Repairs to parts or systems resulting from unauthorized modifications made to the appliance.
6. Expenses for travel and transportation for product service in remote locations.
7. The removal and reinstallation of your appliance if it is installed in an inaccessible location or is not installed in accordance with published installation instructions.

## DISCLAIMER OF IMPLIED WARRANTIES – LIMITATION OF REMEDIES

CUSTOMER'S SOLE AND EXCLUSIVE REMEDY UNDER THIS LIMITED WARRANTY SHALL BE PRODUCT REPAIR AS PROVIDED HEREIN. IMPLIED WARRANTIES, INCLUDING WARRANTIES OF MERCHANTABILITY OR FITNESS FOR A PARTICULAR PURPOSE, ARE LIMITED TO ONE YEAR. WARRANTOR SHALL NOT BE LIABLE FOR INCIDENTAL OR CONSEQUENTIAL DAMAGES. SOME STATES DO NOT ALLOW THE EXCLUSION OR LIMITATION OF INCIDENTAL OR CONSEQUENTIAL DAMAGES, OR LIMITATIONS ON THE DURATION OF IMPLIED WARRANTIES OF MERCHANTABILITY OR FITNESS, SO THESE EXCLUSIONS OR LIMITATIONS MAY NOT APPLY TO YOU. THIS WARRANTY GIVES YOU SPECIFIC LEGAL RIGHTS AND YOU MAY ALSO HAVE OTHER RIGHTS, WHICH VARY FROM STATE TO STATE.

**WARNING!** This product may contain chemicals known to the state of California to cause cancer or birth defects or other reproductive harm. For more information, visit: [www.summitappliance.com/prop65](http://www.summitappliance.com/prop65)

Chemicals known by the manufacturer to be present in this product in concentrations higher than threshold limits: NONE.

**FELIX STORCH, INC.**  
770 Garrison Avenue  
Bronx, NY 10474  
Phone: (718) 893-3900  
Fax: (718) 842-3093  
[www.summitappliance.com](http://www.summitappliance.com)

# SUMMIT

For parts and accessory ordering,  
troubleshooting and helpful hints, visit:  
[www.summitappliance.com/support](http://www.summitappliance.com/support)