

GRANITE SINK INSTALLATION INSTRUCTIONS

Please retain for consumer as care instructions are included

Oliveri®



CHECK MODEL

The model number on the sink packaging must match the model of sink the customer ordered. **Do not install if incorrect.**



CHECK THE CONDITION

Inspect the sink for any visible defects. **Do not install the sink if defects are found.** Contact your sink retailer / point of purchase.



AVOID CUTS

The perimeter and punch-outs on the sink may contain sharp edges. Handle the sink carefully to avoid personal injury.



AVOID BREAKAGES

Granite sinks can be broken if proper care is not taken during installation.

IT IS HIGHLY RECOMMENDED THE ACTUAL SINK BE PRESENT AT TIME OF CUTTING

DO NOT USE SILICONE

BASKET WASTE INSTALLATION

1. Fit the basket waste into the hole in the sink and then place the drain under the hole. **DO NOT USE SILICONE ADHESIVE.**
2. Fasten the basket waste to the drain using a screw. Do not overtighten.

DRILLING THE TAP HOLE

3. Oliveri granite sinks with drainboards are provided with a pre-punched hole (picture A) placed on the front and back of the sink in order to choose which side the bowls / drainer will sit. **NOTE!**

In order to avoid any possible damage to the sink, we strictly recommend to drill these pre-punched holes using 35-37mm drill following the procedure shown in pictures B and C. We recommend using a diamond coated drill to drill this hole.



Fig. A - Pre-punched tap holes



Fig. B - Place the tool on the pre-punched hole.



Fig. C - Drill the hole.

DO NOT USE SILICONE

CUTTING THE COUNTER / BENCHTOP

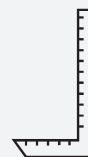

CHECK SPACE

Ensure there is adequate space for tapware (including a splashback if specified). Check space for installation (underneath) and operation (above). Particular care must be taken when a thick splash back is used (it may interfere with tapware location and operation). Ensure the cabinet will not foul the sink mounting flange or basins.



TEMPLATE *

Cut out templates for your Oliveri sink are available online at oliverisinks.com. Use the product model number to find the template. Some sink templates apply to both left-hand and right-hand model sinks. Ensure template is correct way around for your model.



MARK CUT OUT *

Carefully mark out the template (or follow drawing instructions) making allowance for any additional polishing back that is required after cutting. **NOTE: THE TEMPLATE IS THE EXACT FINISHED CUT-OUT SIZE REQUIRED.**



CUT & FINISH HOLE *

Drill pilot holes to accept an appropriate cutting tool for the counter/ benchtop material (wear suitable personal protection equipment). Cut inside the mark, allowing sufficient room for any polishing back. **Note: Accuracy is essential to ensure the bowl / basin and accessories fit correctly.**



TRIAL FIT THE SINK

Carefully position the sink against counter/benchtop to make sure it fits the cut-out correctly. If the fit is not correct, remove the sink and proceed with remedial work. Perform another trial fit after corrections have been made.

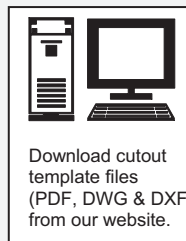

OLIVERI DOES NOT RECOMMEND THE USE OF A WASTE DISPOSAL UNIT WITH GRANITE SINKS.

Any advice, recommendation, information, assistance or service provided by Tasman Sinkware in relation to goods manufactured by it or their use and installation, is given in good faith and is believed by Tasman Sinkware to be appropriate and reliable. However, any advice, recommendation, information, assistance or service is provided by Tasman Sinkware without responsibility or liability.

GRANITE SINK INSTALLATION INSTRUCTIONS

Please retain for consumer as care instructions are included

Oliveri®

DO NOT USE SILICONE

FOR TOPMOUNT INSTALLATION

The special seal (1) should be placed carefully onto the upper surface of the counter, on the edge of the cutout. Press down on it lightly so that it sticks to the surface. Carefully lower the sink into the cutout and onto the seal. Fasten the mounting brackets (4) to the sink as shown, using the screws provided. Then tighten the mounting bracket with a screwdriver, making sure that the sink is pulled down towards the counter top and compresses the seal (1).

NOTE: Do not overtighten the mounting bracket screws.

Once the sink is installed carefully trim any excess seal from around the sink.

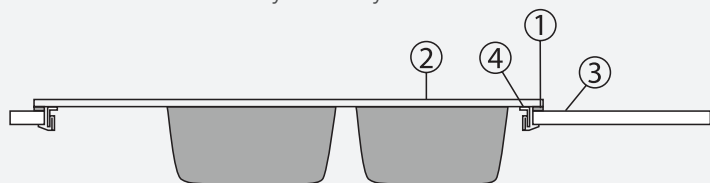

1. SPECIAL SEAL
2. SINK
3. COUNTER TOP
4. MOUNTING BRACKET SUITABLE FOR WORKTOP OF THICKNESS FROM 30 TO 40 MM.

FOR UNDERMOUNT INSTALLATION

Bolt it to the counter /benchttop using "molly" assemblies. Care must be taken during drilling and tightening to avoid cracking. GRANITE SINKS ARE NOT RECOMMENDED TO BE INSTALLED IN COUNTER/BENCHTOPS THINNER THAN 25MM.

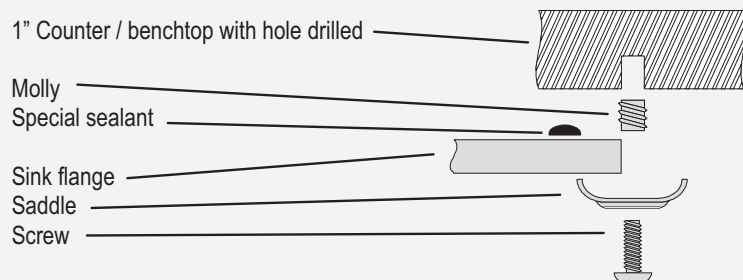

If you have any doubts, confirm the correct mounting method for your material by consulting the counter/benchttop supplier.

PRACTICAL ADVICE ON THE CARE AND MAINTENANCE OF THE SINK

- Avoid placing pots, pans or other hot objects in excess of 280° C on the surface of the sink (CAUTION! The bottom of a pot or pan just removed from the burner can reach temperatures of over 600°C).
- Pots, pans and other hot objects must be placed on appropriate potholders (made of wood, rubber, etc.). Avoid causing excessive thermal shock due to the presence of very hot and very cold objects on the sink at the same time.
- Do not use the sink as a cutting surface: rather, use a cutting board made of hardwood or polyethylene, which can be purchased together with the sink.
- The use of stainless steel dish baskets or surface protectors (which can be purchased together with the sink) can reduce the risk of accidental damage.
- Do not use abrasive substances or metal cleaning pads (steel wool) to clean the sink because they scratch the surface, making it susceptible to stains.
- Heavy or pointed objects that fall on the surface of the sink can damage it.
- Scratches and chips on the surface of the sink can be removed using sandpaper and then a coat of polish.
- CAUTION! Do not pour alcohol, gasoline, trichloroacetic acid or any solvents in general into or onto the sink because they could react with the chemical structure of the sink and damage it beyond repair.

OTHER INSTRUCTIONS ON HOW TO CLEAN THE SINK

- Clean the sink regularly after each time it is used with warm water and a liquid detergent and a soft cloth.
- Generic stains should be removed immediately.
- Cleaning powders and creams which are even slightly abrasive should not be used, nor chemically aggressive detergents.
- Abrasive cleaning products can be used only under exceptional circumstances, e.g. when a cigarette burn must be removed; however, these products should be used with extreme care.
- Marks caused by foods or liquid which stain easily, i.e. tea, coffee, fruit juice and the like, must be removed immediately with very hot water and a cleaning product.
- Special stains, such as those caused by Indian ink, ink, oil-based stains or paints, etc., must be removed immediately.
- If these stains are difficult to remove, use a cloth dampened with denatured alcohol.
- For organic stains which are especially difficult to remove, it is recommended that you fill the sink with a highly diluted organic cleaner such as bleach and let stand overnight. The next morning, rinse with warm water and a soft cloth.
- Lines caused by contact between a pot or fork and the surface of the sink should be removed with a cloth or sponge and liquid detergent.