



User Guide

Mini Smart Wi-Fi Plug with Homekit



Contents

About This Guide	1
Introduction	2
Appearance	3
Set Up Your Smart Plug	4
Add Your Plug to Home	5
Set Up via Amazon Frustration-Free Setup	7
Basic Device Control	11
Configure Your Smart Plug	12
Smart Actions	13
Share Your Smart Plug	16
Voice Control	17
Authentication	18

About This Guide

This guide provides a brief introduction to the Mini Smart Wi-Fi Plug with homekit and regulatory information.

Please note that features available in Tapo may vary by model and software version. Tapo availability may also vary by region. All images, steps, and descriptions in this guide are only examples and may not reflect your actual Tapo experience.

Conventions

In this guide, the following convention is used:

Convention	Description
Blue	Key information appears in blue, including management page text such as menus, items, buttons and so on.
<u>Underline</u>	Hyperlinks are in teal and underlined. You can click to redirect to a website.
📌Note:	Ignoring this type of note might result in a malfunction or damage to the device.

More Info

- Specifications can be found on the product page at <https://www.tapo.com>.
- Our Technical Support and troubleshooting information can be found at <https://www.tapo.com/support/>.
- The setup video can be found at <https://www.tp-link.com/support/setup-video/>.

Introduction

Tapo P125 Mini Smart Wi-Fi Plug is a compact home device that turns your typical electrical wall outlet into a controllable, customizable and multi-functional outlet, enabling you to easily control your lights and household electronic devices via the Tapo app, no matter where you find yourself.

- **Voice Control** - Manage your smart socket with voice commands via Amazon Alexa or the Google Assistant.
- **Remote Control** - Instantly turn connected devices on/off wherever you are through the Tapo app.
- **Schedule** - Preset a schedule to automatically manage devices.
- **Apple Homekit Supported** - Fully integrates into your Apple Home ecosystem.
- **Away Mode** - Automatically turns devices on and off at different times to give the appearance that someone is home.
- **Compact Design** - Mini-sized to avoid blocking adjacent sockets.
- **Easy Setup and Use** - No hub required, set up quickly and manage easily through the free app. Bluetooth onboarding technology makes setup simpler for faster connection.

Appearance

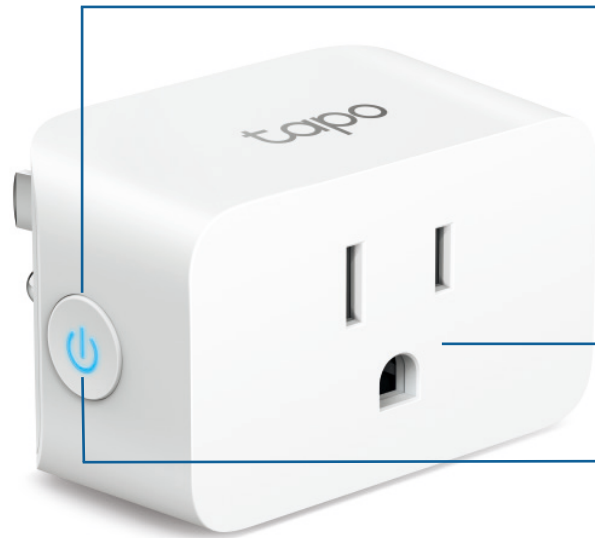

Power Button:

- **Press once:**
Turn on or off the smart plug.
- **Press and hold for 5 seconds:**
Keep the existing settings except Wi-Fi.
- **Press and hold for 10 seconds:**
Restore your smart plug to factory default settings.

Smart Socket:

Plug in your device and control it from Tapo app on your phone/tablet.

System LED

- 🌀 **Blinking orange and blue:** Ready for setup
- 🌀 **Blinking orange:** Connecting to a Wi-Fi network
- **Solid orange:** Connected to Wi-Fi or disconnected from the Wi-Fi; offline
- **Solid blue:** Connected to server and working properly
- 🌀 **Blinking blue:** Being reset; being upgraded

Set Up Your Smart Plug

Follow the steps below to get started with your new smart plug, or you can follow the setup video at <https://www.tp-link.com/support/setup-video/>.

Step 1. Download Tapo App

Get the [Tapo](#) app from the App Store or Google Play, or by scanning the QR code below.



OR



Step 2. Log In

Open the app, and log in with your TP-Link ID. If you don't have an account, create one first.

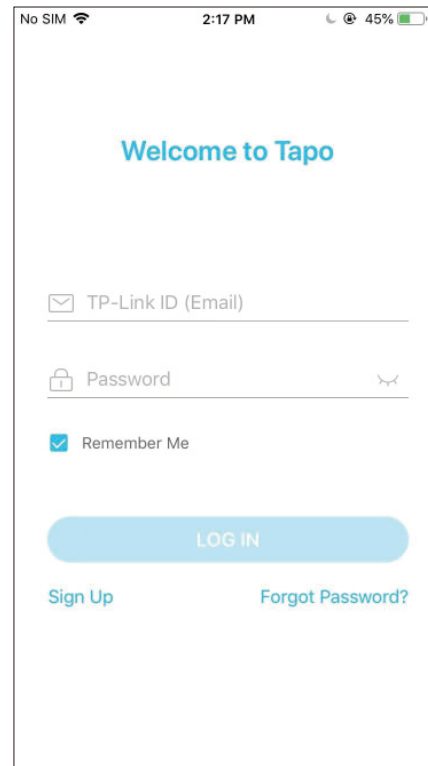

Step 3. Add Your Plug

Tap the ⊕ button in the Tapo app, choose [Plugs](#), and select your model. Follow the instructions in the Tapo app to complete the setup.

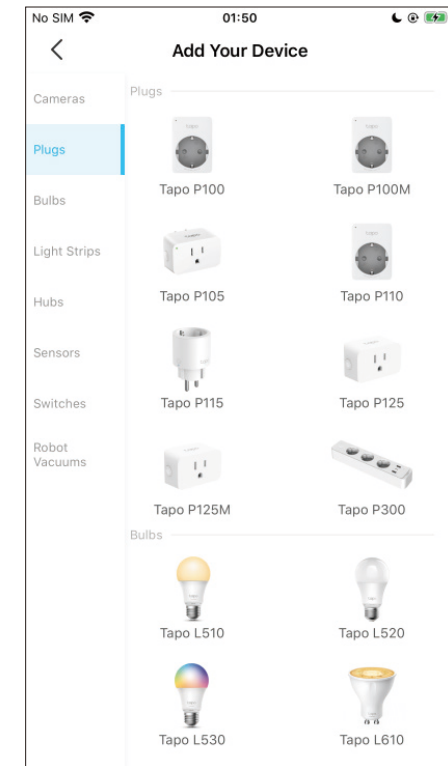

Add Your Plug to Home

This is a HomeKit-enabled device. You can also add it to the Home app for easy control from your iPhone or iPad. Follow the steps below to add your smart mini plug via the [Home](#) app.

Before you start:

1. Your iPhone or iPad should be connected to a stable 2.4 GHz Wi-Fi network.
2. To control this HomeKit-enabled accessory, the latest version of iOS or iPadOS is recommended.
3. HomeKit will be disabled after 10 minutes since the smart plug is powered on. You can power off your device and power it back on, then try again.

Add to Home

1. Open the Home app. Or if you have added the smart plug to Tapo, you can also tap [Add to Home](#) in the [Device Settings](#) page.

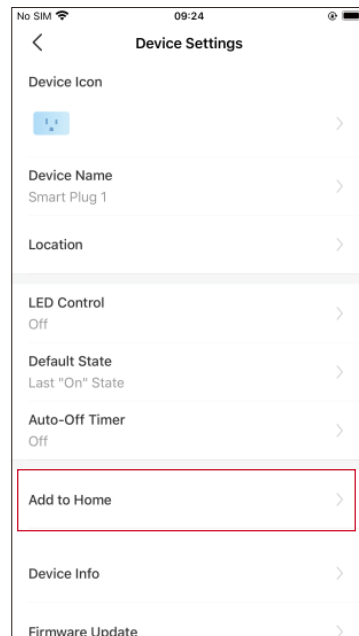
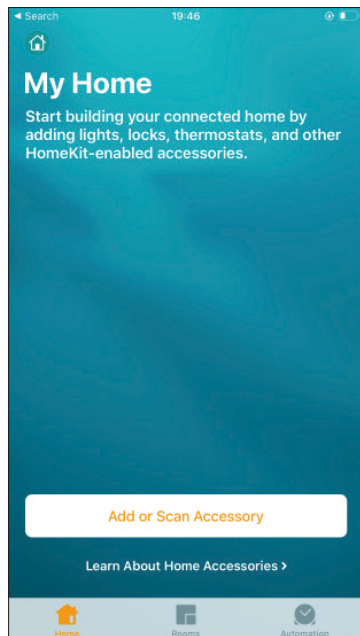

2. Scan the HomeKit QR code on the provided label. It will be added to Home automatically.

Failed to add to Home?

1. Press and hold the Power button for at least 10 seconds to factory reset the smart plug and and restart your phone. Then try again.



2. Move both your iPhone/iPad and the smart plug closer to the router to get a stronger Wi-Fi signal.

3. Turn off the Wi-Fi on your iPhone/iPad for a few seconds, then turn it back on to clear the cache of the Home app.

4. Make sure your iPhone/iPad is connected to the 2.4 GHz Wi-Fi network. Set different names for 2.4 GHz and 5 GHz networks, or temporarily turn off the router's 5 GHz Wi-Fi until your smart device is successfully added.

5. Change the router's 2.4 GHz Wi-Fi channel to a fixed one, such as 1, 6, and 11. Then reboot your router.

6. If you still cannot add the smart plug to Home, tap [set it up with Tapo manually](#). Then follow the app instructions to add your smart plug.

7. If the problem persists, refer to the FAQ for detailed instructions: <https://www.tp-link.com/support/faq/3390/>



Set Up via Amazon Frustration-Free Setup

What is Amazon Frustration-Free Setup?

Amazon Frustration-Free Setup can help connect and set up Tapo smart devices in fewer steps, without having to remember and re-enter your Wi-Fi password on each device.

To use this feature, confirm the following:

- The new Tapo device supports Amazon FFS (short for Amazon Frustration-Free Setup).
- You have an Amazon FFS enabled Alexa device or router.
- You have saved your Wi-Fi information to Amazon by using Alexa echo.
- Your Tapo device and router are on the same network as your Alexa echo.

LED Indications during Amazon Frustration-Free Setup

LED	Status
Blinking orange and blue	Ready for setup
Blinking blue	FFS setup in progress
Solid blue	Working properly

If the LED does not turn solid green after a long time, you can try to add the Tapo device manually. (Open the Tapo app, tap the + button on the page, select your device model, and follow the app instructions to complete setup.)

How to use Amazon Frustration-Free Setup with Tapo devices

1. Open the Amazon Alexa app. Then tap **More** and select **Skills & Games**.

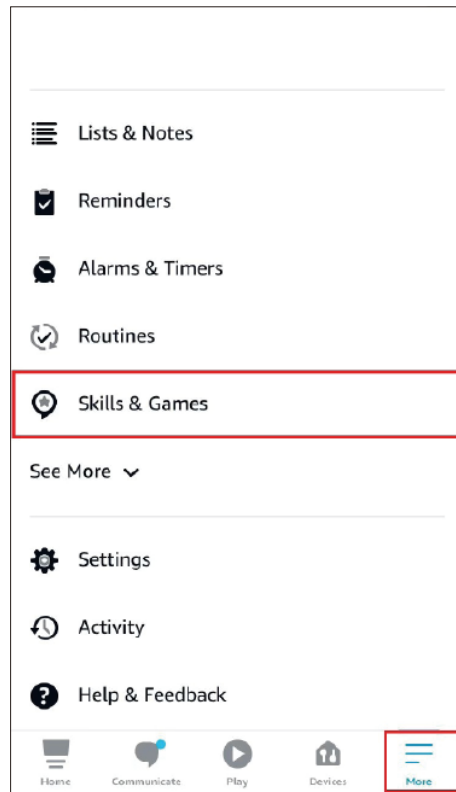

2. Enter **Tapo** in the search bar and choose **Tapo**.

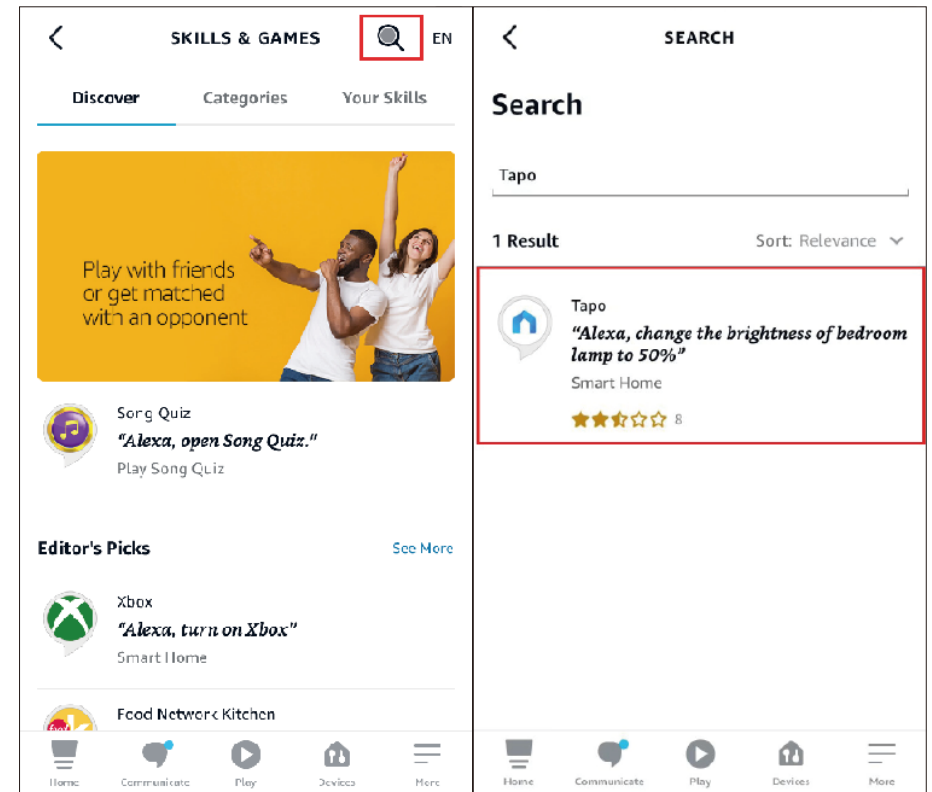

3. Tap the **ENABLE TO USE** button.

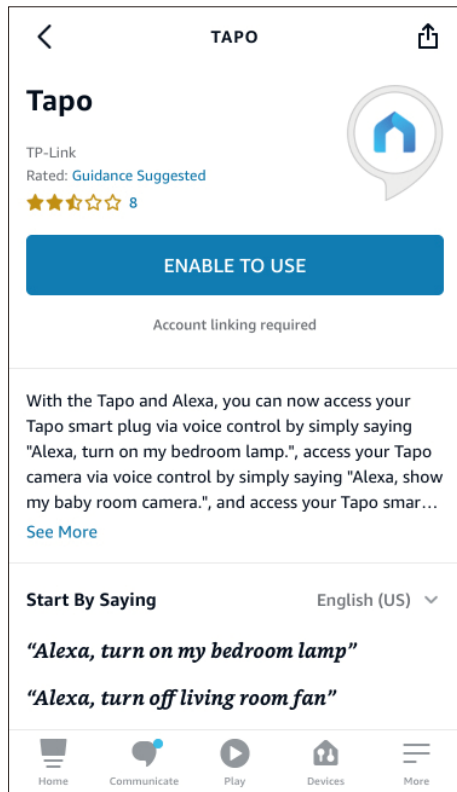

4. Log in with your TP-Link ID that has bound to your Tapo device, and tap **Authorize**. After authorized successfully, the message **Tapo has been successfully linked** will come up.

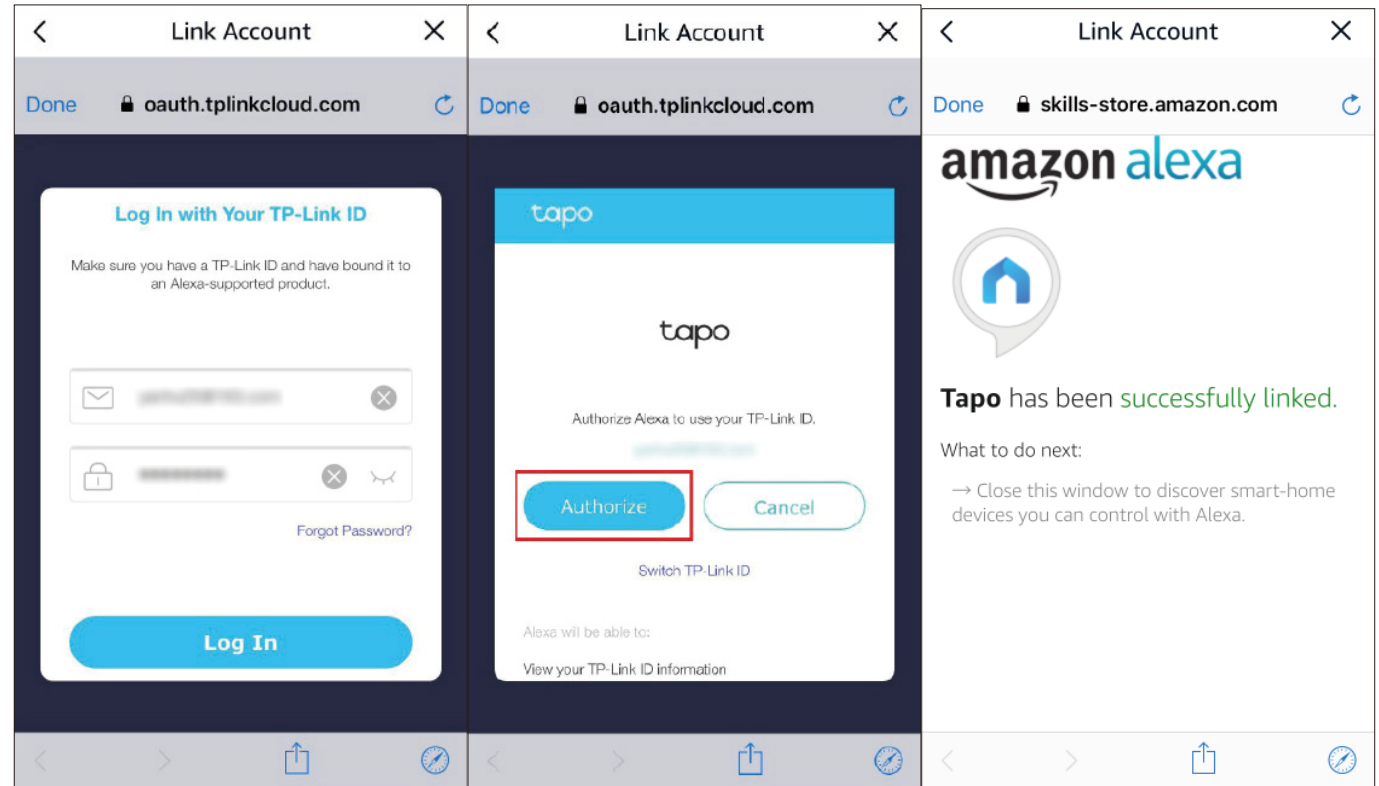

5. Plug in your Tapo device and the setup will complete automatically in two minutes.

For setting up more Tapo devices, just plug in and enjoy!

Done!

If this device displays on the Home page in the Tapo app, it indicates this device has been successfully associated with your Amazon account and joined your Wi-Fi network automatically.

If this device does not display on the Home page in the Tapo app, try setting it up manually. (Tap the + button on the page, select your device model, and then follow the app instructions to complete setup.)

Basic Device Control

After successfully set up your smart plug, you will see the home page of the Tapo app. Here you can view the status of all devices that you've added and manage them. You can tap on the device to control and manage it on the Tapo app.

Home Page

You can turn on/off your plug any time anywhere and tap the plug card to enter the status page.

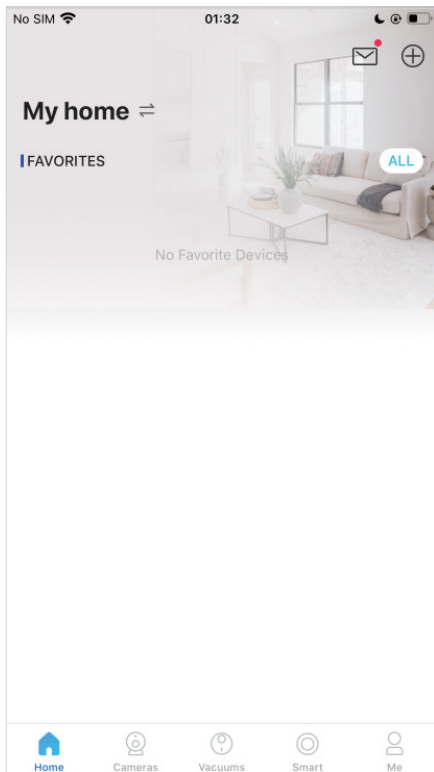

Device Status Page

You can turn on/off your plug with one tap, customize Schedule, enable Away Mode, set a timer, and more.

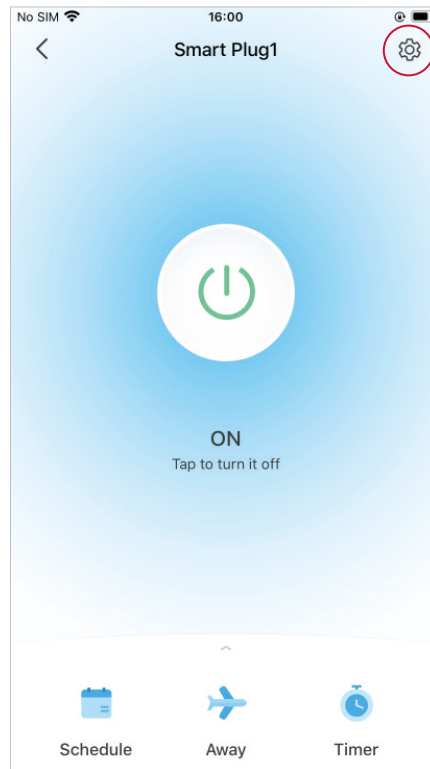

Device Settings Page

Tap  to view the Device Settings page. You can edit the basic information, control the LED, update firmware and more.

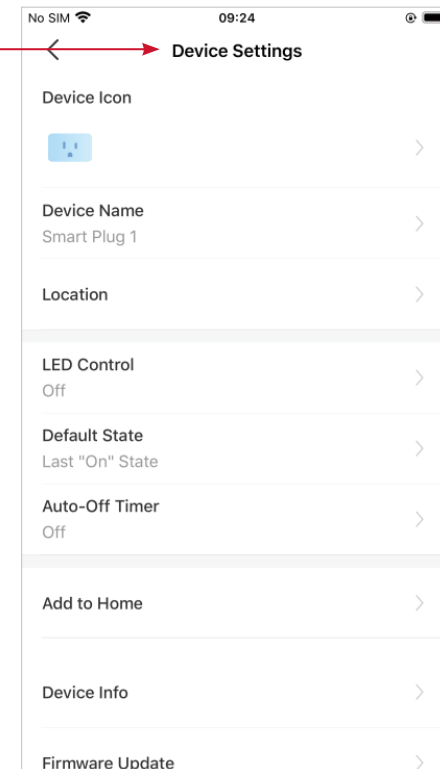

Configure Your Smart Plug

You can configure your smart plug by setting Schedule, Timer, Away Mode and more.

Set Schedule

Tap  to set schedules for your plug to automatically turn on/off to simplify your daily routine.

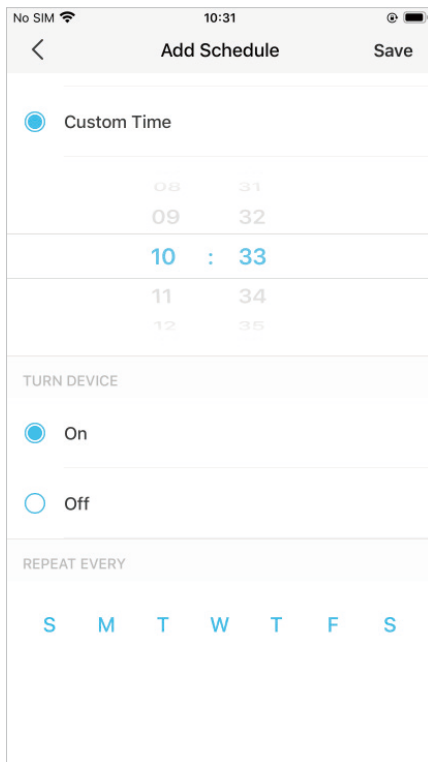

Set Away Mode

Tap  to preset the Away Mode, set the start and end time, then your plug will be randomly turned on/off during this period.

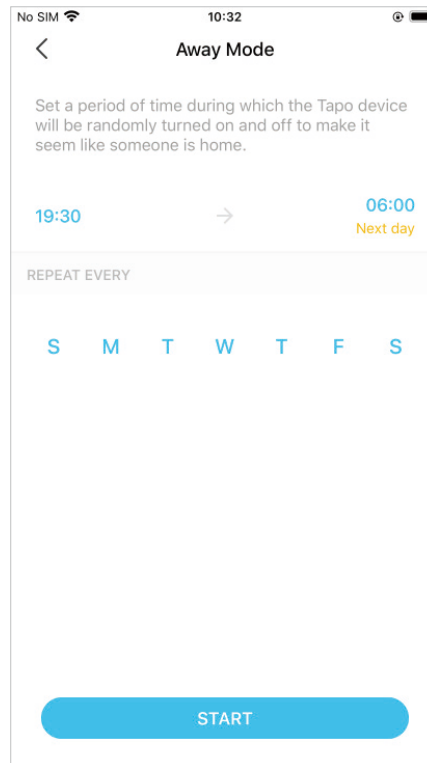

Set Timer

Tap  to set the timer, then your plug will automatically turn on/off after the timer ends.

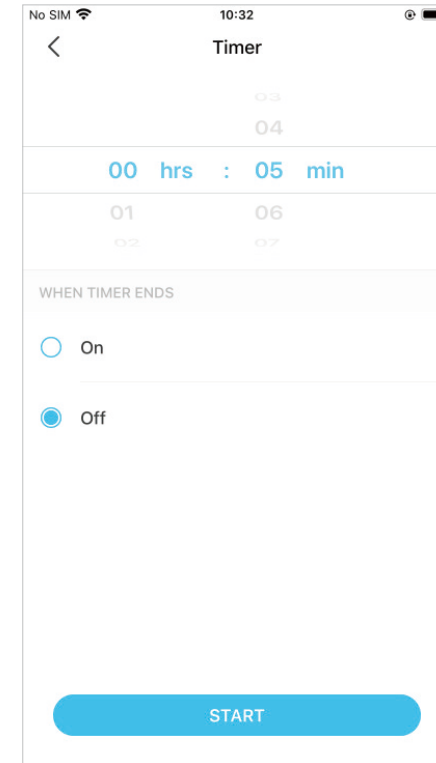

Smart Actions

Smart Actions automate repetitive tasks, allowing you to blaze through tedium with utmost ease. Set everything up once and never have to worry about it again. With Smart Actions, giving your home that level of intelligence is a snap. Shortcut lets you perform an action with a simple tap. Automation allows you to automate tasks to be performed at a set time. e.g. The lamp plugged into your smart plug will light on at 7 PM.

Option 1: Edit Routine Actions on the featured shortcuts

1. Go to the [Smart Actions](#) page and you will see the [Featured Actions](#) (Shortcut or Automation).
2. Tap on a featured action. Tap [EDIT](#) to change the settings as needed and tap [APPLY](#) to save changes.

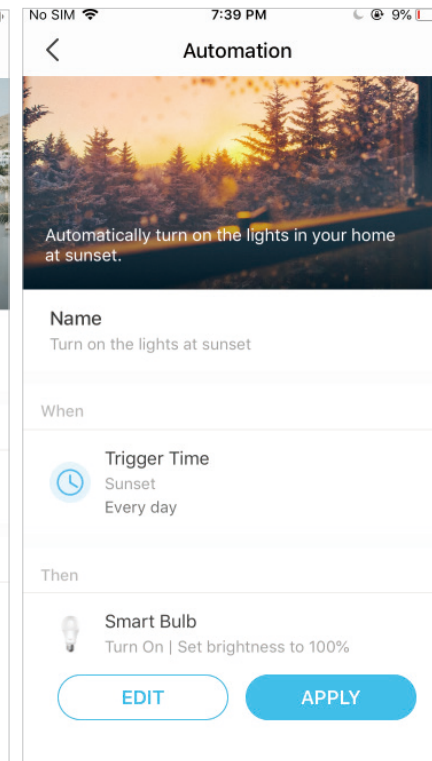
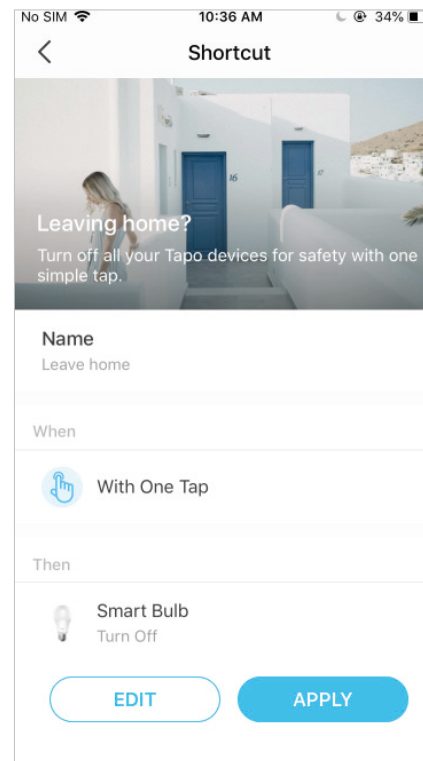
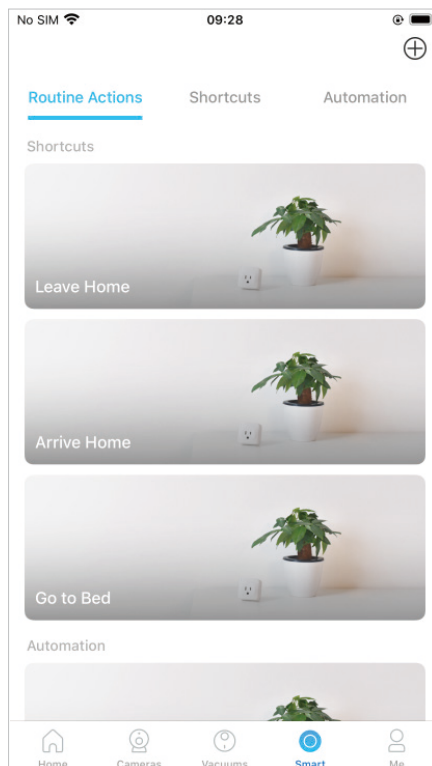

Option 2: Create your own actions

1. Tap + and then choose [Automation](#) to add a simple and smart action.

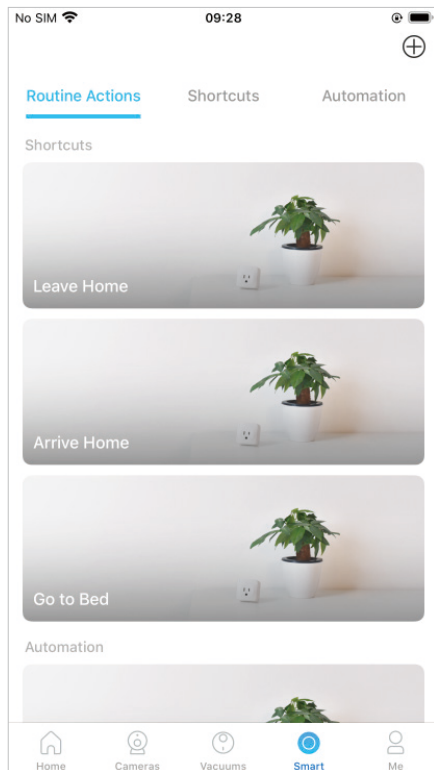

2. Add conditions ([When](#)) like the trigger time, and tap + to add tasks ([Then](#)) like turning on the smart plug.

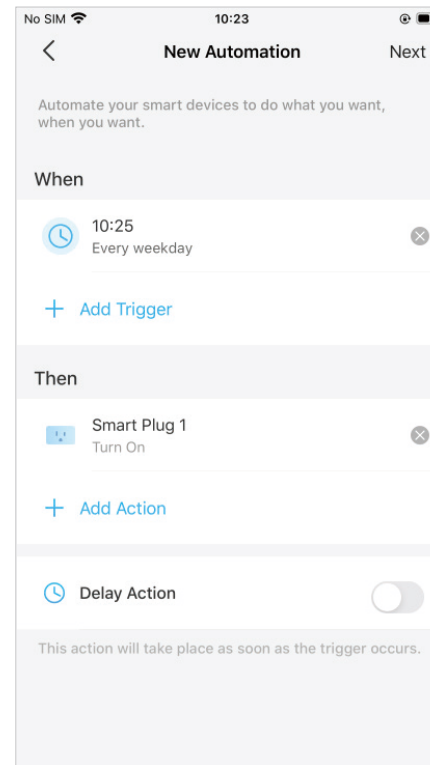

3. When the action is created, you can also delay the action for a specific time. Tap **Done** to save all the settings.

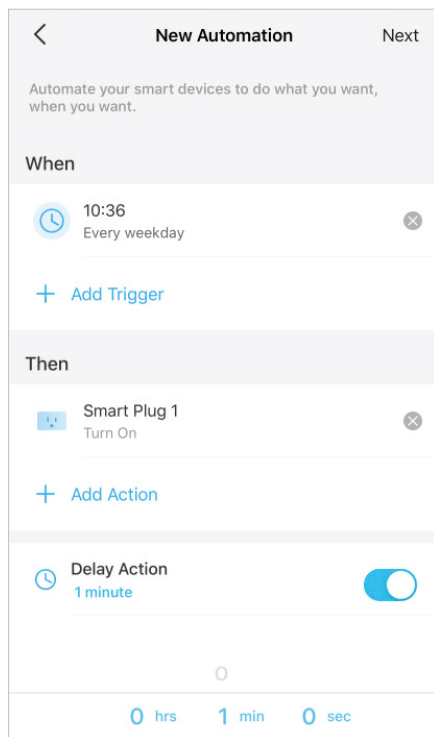

4. Give your new automation a name and then you can decide when to perform the action by setting the Effective Time.

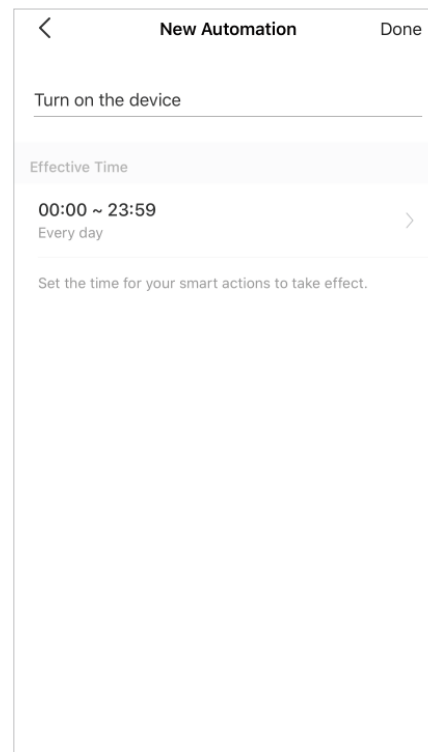

Share Your Smart Plug

You can invite your family members to manage your Tapo devices together by entering the TP-Link ID (email) you want to share the devices with.

Method 1

Go to [Device Status](#) page, slide up and tap [Device Sharing](#).

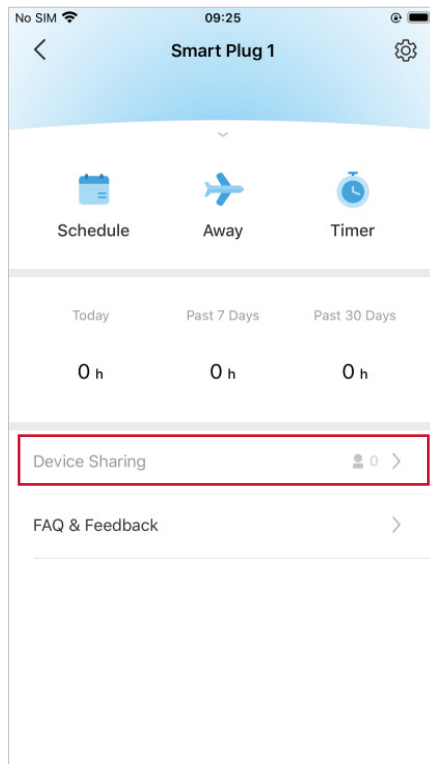

Method 2

Go to [Me](#) page and tap [Device Sharing](#) to view your shared devices and devices shared from others.

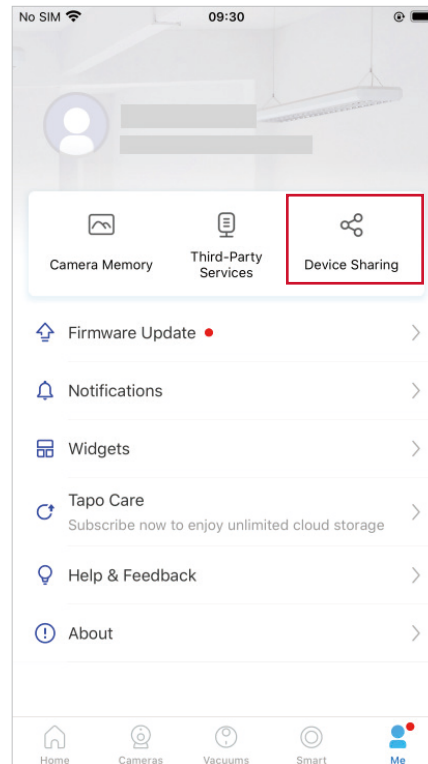

Voice Control

Free up your hands with simple voice commands to control your devices via Amazon Alexa or Google Assistant.

1. Go to [Me](#) page and tap [Third-Party Services](#) to connect to Amazon Alexa or Google Assistant.

2. Select a voice assistant and follow the instructions to control your device via voice.

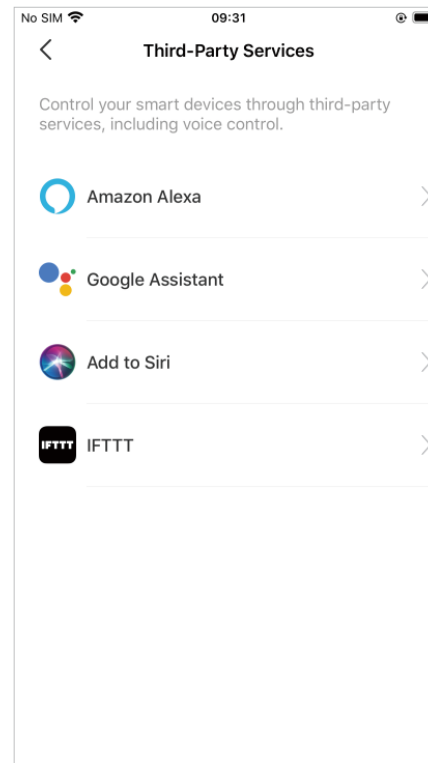
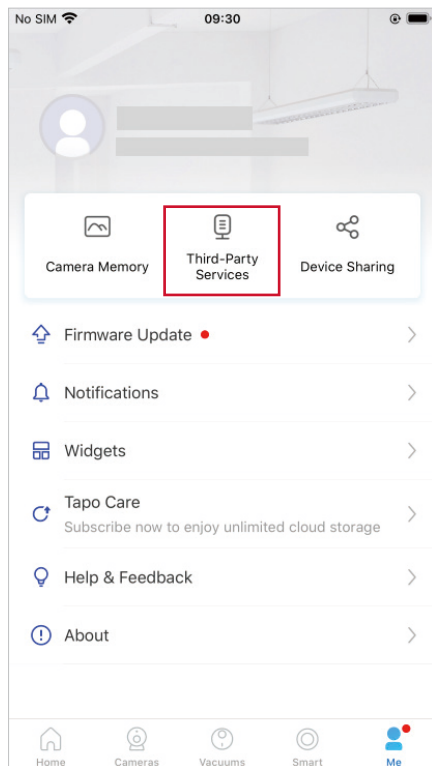

Authentication

FCC Compliance Information Statement



Product Name: Mini Smart Wi-Fi Plug with homekit

Model Number: Tapo P125

Responsible Party:

TP-Link USA Corporation

Address: 10 Mauchly, Irvine, CA 92618

Website: <http://www.tp-link.com/us/>

Tel: +1 626 333 0234

Fax: +1 909 527 6804

E-mail: sales.usa@tp-link.com

This equipment has been tested and found to comply with the limits for a Class B digital device, pursuant to part 15 of the FCC Rules. These limits are designed to provide reasonable protection against harmful interference in a residential installation. This equipment generates, uses and can radiate radio frequency energy and, if not installed and used in accordance with the instructions, may cause harmful interference to radio communications. However, there is no guarantee that interference will not occur in a particular installation. If this equipment does cause harmful interference to radio or television reception, which can be determined by turning the equipment off and on, the user is encouraged to try to correct the interference by one or more of the following measures:

- Reorient or relocate the receiving antenna.
- Increase the separation between the equipment and receiver.
- Connect the equipment into an outlet on a circuit different from that to which the receiver is connected.
- Consult the dealer or an experienced radio/ TV technician for help.

This device complies with part 15 of the FCC Rules. Operation is subject to the following two conditions:

1. This device may not cause harmful interference.

2. This device must accept any interference received, including interference that may cause undesired operation.

Any changes or modifications not expressly approved by the party responsible for compliance could void the user's authority to operate the equipment.

Note: The manufacturer is not responsible for any radio or TV interference caused by unauthorized modifications to this equipment. Such modifications could void the user's authority to operate the equipment.

FCC RF Radiation Exposure Statement

This equipment complies with FCC RF radiation exposure limits set forth for an uncontrolled environment. This device and its antenna must not be co-located or operating in conjunction with any other antenna or transmitter.

"To comply with FCC RF exposure compliance requirements, this grant is applicable to only Mobile Configurations. The antennas used for this transmitter must be installed to provide a separation distance of at least 20 cm from all persons and must not be co-located or operating in conjunction with any other antenna or transmitter."

We, **TP-Link USA Corporation**, has determined that the equipment shown as above has been shown to comply with the applicable technical standards, FCC part 15. There is no unauthorized change is made in the equipment and the equipment is properly maintained and operated.

Canadian Compliance Statement

This device complies with Industry Canada license-exempt RSSs. Operation is subject to the following two conditions:

- 1) This device may not cause interference, and
- 2) This device must accept any interference, including interference that may cause undesired operation of the device.

Le présent appareil est conforme aux CNR d'Industrie Canada applicables aux appareils radio exempts de licence. L'exploitation est autorisée aux deux conditions suivantes :

- 1) l'appareil ne doit pas produire de brouillage;
- 2) l'utilisateur de l'appareil doit accepter tout brouillage radioélectrique subi, même si le brouillage est susceptible d'en compromettre le fonctionnement.

Radiation Exposure Statement:

This equipment complies with IC radiation exposure limits set forth for an uncontrolled environment. This equipment should be installed and operated with minimum distance 20cm between the radiator & your body.

Déclaration d'exposition aux radiations:

Cet équipement est conforme aux limites d'exposition aux rayonnements IC établies pour un environnement non contrôlé. Cet équipement doit être installé et utilisé avec un minimum de 20 cm de distance entre la source de rayonnement et votre corps.

Industry Canada Statement

CAN ICES-3 (B)/NMB-3(B)

NCC Notice

注意!

取得審驗證明之低功率射頻器材，非經核准，公司、商號或使用者均不得擅自變更頻率、加大功率或變更原設計之特性及功能。

低功率射頻器材之使用不得影響飛航安全及干擾合法通信；經發現有干擾現象時，應立即停用，並改善至無干擾時方得繼續使用。

前述合法通信，指依電信管理法規定作業之無線電通信。

低功率射頻器材須忍受合法通信或工業、科學及醫療用電波輻射性電機設備之干擾。

BSMI Notice

安全諮詢及注意事項

- 清潔本產品之前請先切斷電源。請勿使用液體、噴霧清潔劑或濕布進行清潔。
- 注意防潮，請勿將水或其他液體潑灑到本產品上。
- 請勿將本產品置放於靠近熱源的地方。除非有正常的通風，否則不可放在密閉位置中。
- 不要私自拆開機殼或自行維修，如產品有故障請與原廠或代理商聯繫。

限用物質含有情況標示聲明書

設備名稱：Mini Smart Wi-Fi Plug Equipment name		型號（型式）：Tapo P125 Type designation (Type)				
單元 Unit	限用物質及其化學符號 Restricted substances and its chemical symbols					
	鉛 Lead (Pb)	汞 Mercury (Hg)	鎘 Cadmium (Cd)	六價鉻Hexavalent chromium (Cr ⁶⁺)	多溴聯苯 Polybrominated biphenyls (PBB)	多溴二苯醚Polybrominated diphenyl ethers (PBDE)
PCB	○	○	○	○	○	○
外殼	○	○	○	○	○	○
電源供應板	—	○	○	○	○	○
其他及其配件	—	○	○	○	○	○
備考1. “超出0.1 wt %” 及 “超出0.01 wt %” 係指限用物質之百分比含量超出百分比含量基準值 Note 1: “Exceeding 0.1 wt %” and “exceeding 0.01 wt %” indicate that the percentage content of the restricted substance exceeds the reference percentage value of presence condition.						
備考2. “○” 係指該項限用物質之百分比含量未超出百分比含量基準值。 Note 2: “○” indicates that the percentage content of the restricted substance does not exceed the percentage of reference value of presence.						
備考3. “—” 係指該項限用物質為排除項目。 Note 3: The “—” indicates that the restricted substance corresponds to the exemption.						

Safety Information

- Keep the device away from water, fire, humidity or hot environments.
- Do not attempt to disassemble, repair, or modify the device.
- Do not use the device where wireless devices are not allowed.
- The socket-outlet shall be installed near the equipment and shall be easily accessible.

- The devices are not intended for use in locations where the temperature may be less than actual room conditions, such as unheated warehouses or garages.
- For indoor use only.
- Do not overload power outlets. This can result in the risk of fire or electric shock.
- Completely insert the product into the power outlet. Failure to do so may cause electric shock and / or excessive heat resulting in fire.
- Regularly remove dust etc from the product by pulling it out from the power outlet and wiping with a DRY cloth. Accumulated dust may cause an insulation defect resulting in fire.
- Unplug from the power outlet if it emits smoke, has an abnormal smell or makes an unusual noise.
- Do not use the product if the casing has been broken. Danger of electric shock.
- Never touch the product with wet hands.
- Do not place near automatically controlled devices such as fire alarms. Radio waves emitted from this product may cause such devices to malfunction resulting in an accident.
- Do not use this product at a refuelling point.
- Observe restrictions on using wireless products in fuel depots, chemical plants or when blasting operations are in progress.
- Do not use liquid to clean the product. Only use a dry cloth.
- Never put metal objects inside the product. If a metal object enters the product turn off the circuit breaker and contact an authorised electrician.
- Be careful to connect the following- cooking appliances, irons, other devices that generate a large amount of heat. There is a risk of fire, burns or injury. – power tools, electric machinery, or other devices that could cause injury and therefore must be used under direct careful observation. – heating or cooling devices or any type of device which could cause health risks particularly to the elderly or children.
- This product is not intended to be used when providing medical care. Consult the manufacturer of any personal medical devices, such as pacemakers or hearing aids to determine if they are adequately shielded from external RF (radio frequency) energy.
- Do not use this product in health care facilities. Hospitals or health care facilities may be using equipment that could be sensitive to external RF energy.
- Do not use this product near water for example near a bath tub, wash bowl, kitchen sink or laundry tub, in a wet basement or near a swimming pool.
- The product should be kept free from excessive smoke, dust or high temperature and vibration.
- This product should not be exposed to direct sunlight.
- Do not place heavy objects on top of the product.

- When you leave the product unused for a long time unplug the product from the power outlet.
- Product should be kept away from heat sources such as radiators, cookers etc.- it should not be placed in rooms where the temperature is less than 0 degrees or greater than 40 degrees. Damp basements should also be avoided.
- This product may interfere with other electronic products such as TV, radios, personal computers, phones or other wireless devices.
- Operating Humidity: 10%-90%RH, Non-condensing
- Storage Humidity: 5%-90%RH, Non-condensing
- Function switch of MICRO-DISCONNECTION is used. Power is completely off only when the plug has been withdrawn from Tapo smart socket. Automatic action type of the integrated switch: MICRO-DISCONNECTION (Type 1.B).
- This is a portable direct plug-in device. Plug the device into a suitable outlet.





CAUTION

Electrical switch integrated in this product is only intended for functional purposes.
Unplug the appliance before servicing.

Please read and follow the above safety information when operating the device. We cannot guarantee that no accidents or damage will occur due to improper use of the device. Please use this product with care and operate at your own risk.

Explanation of the symbols on the product label

Symbol	Explanation
	Indoor use only
	AC voltage
	<p>RECYCLING</p> <p>This product bears the selective sorting symbol for Waste electrical and electronic equipment (WEEE). This means that this product must be handled pursuant to European directive 2012/19/EU in order to be recycled or dismantled to minimize its impact on the environment.</p> <p>User has the choice to give his product to a competent recycling organization or to the retailer when he buys a new electrical or electronic equipment.</p>