

HOTO BlowVac Handheld Vacuum

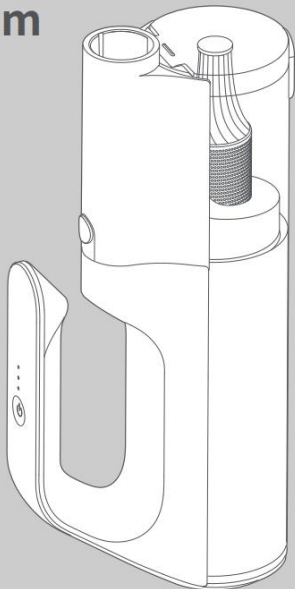

Make It Happen



Scan the QR code to access
additional usage guidelines.



Visit our website for more Cool
Tools (www.hototools.com)

01 Safety Instructions

Please read all safety warnings, instructions, illustrations, and rules provided along with the product and keep all warnings and instructions for reference.

Read this manual carefully before use, and retain it for future reference.

This product will produce noise above 79 dB (A) when in operation.

Please exercise caution.

This product is not a toy, and children are forbidden to use it.

Do not vacuum cleaning without attaching dust cup.

This product is very powerful, please keep distance with your hair while using.

02 Product Overview

HOTO BlowVac Handheld Vacuum is a handheld dust collector for cleaning inside and outside the car and small indoor spaces. After appropriate accessories are installed on both ends of the product, the product enables dust suction, dust blowing or inflation. For detailed features, please refer to the product sales page or contact HOTO customer service. The product images are for illustrative purposes only. Please refer to the actual product.

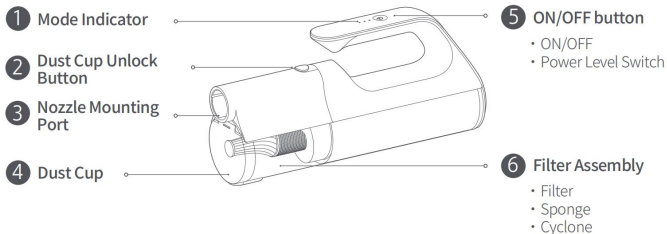

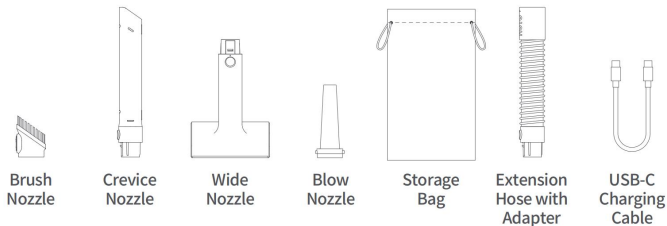
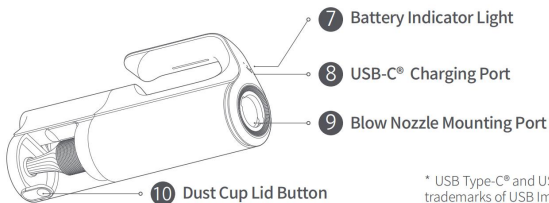

03 Instructions for Use

Battery indicator and charging

Please fully charge this product before first use. Please charge the product using an adapter that matches the product's charging power through a USB-C charging cable. The adapter is not included in the product package. Please buy a safe and compliant USB adapter.

Note: The product is provided with a USB-C to USB-C charging cable.

Battery level indicator

Not charging



| Battery indicator light | Battery level |
|-------------------------|---|
| ✱ ○ ○ | Low battery, flashes quickly for 5 seconds and then turns off |
| ● ○ ○ | <30% |
| ● ● ○ | 30%-70% |
| ● ● ● | 70%-100% |

Charging

| Battery indicator light | Battery level |
|-------------------------|---|
| ✱ ○ ○ | <30% |
| ● ✱ ○ | 30%-70% |
| ● ● ✱ | 70%-99% |
| ● ● ● | 100%, off after it stays on for 20 seconds. |

● Light On ○ Light Off ✱ Light Flash

Notes: Do not use the product when it is being charged.

When the battery is low, the battery indicator flashes quickly. When charging, the battery indicator flashes slowly.

If all the power indicator lights flash simultaneously, the device has entered temperature protection mode. Please let it cool down to room temperature before charging.

Power on/power off/gear switch

Power on

Press and hold the ON/OFF button for 2 second to power on the product and it will start working.

Power off

When the product is working, press and hold the ON/OFF button for 2 second to make it stop working and power it off.

Gear switch

After powering on, press the ON/OFF button to cycle through: **Low** → **High** → **Storm mode**.

Note: Before using the vacuum cleaner, please install the accessory nozzle first.

If the power level indicator light flashes, the device is stalled. Clean the dust cup filter or keep the nozzle at a safe distance from the object being cleaned.

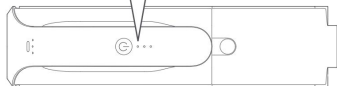
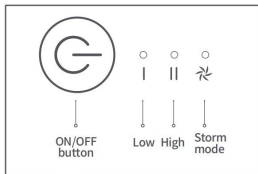

Installation and cleaning of the accessories

Crevice Nozzle

Installation: Insert the crevice nozzle into the nozzle mounting port as shown until you hear a "click" sound.

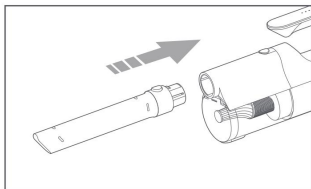

Removal: Hold the crevice nozzle button and pull out the crevice nozzle.

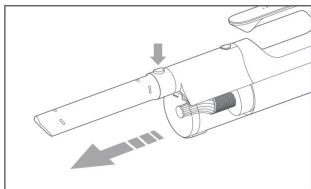

Brush Nozzle

Installation: Fix the brush nozzle into the crevice nozzle as shown until you hear a "click" sound.

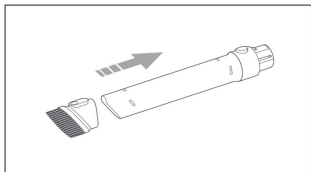

Removal: Hold the brush nozzle button and pull out the brush nozzle.

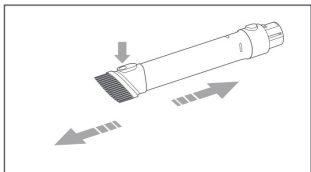

Storage: Press the brush nozzle button and push the brush nozzle to the crevice nozzle's end.

Note: The brush nozzle should be used in conjunction with the crevice nozzle.

Wide Nozzle

Installation: Insert the wide nozzle into the nozzle mounting port as shown until you hear a "click" sound

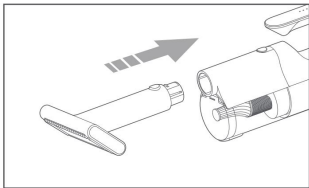

Removal: Hold the wide nozzle button and pull out the wide nozzle.

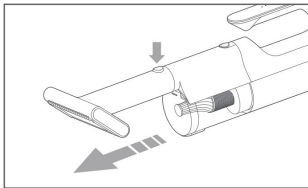

Hose connection

Installation: Insert one end into the nozzle mounting port, and connect the nozzle to the other end, until you hear a "click" sound.

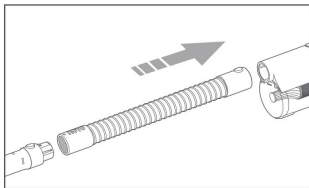

Removal: Hold the nozzle button on one end and pull out the nozzle; on the other end, hold the hose adapter button and pull out the hose.

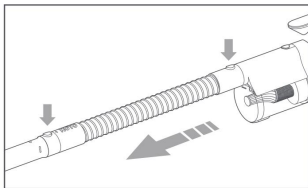

Note: Please align the triangular mark on the hose with the circular mark on the nozzle before inserting.

Blow Nozzle

Installation: Rotate and remove the dust cup assembly, install the blow nozzle and tighten it clockwise.

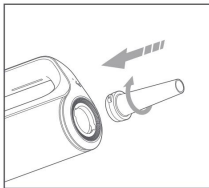
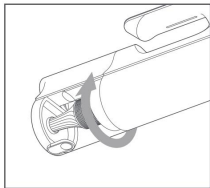

Removal: Rotate and remove the blow nozzle, and reinstall the dust cup assembly.

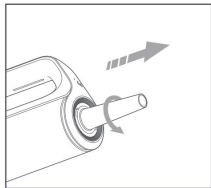

Note: Do not use the vacuum function when the blow nozzle is connected to the main unit. Do not use the vacuum cleaner to suck up any liquids (e.g., water, beverages).

Empty dust

1. Lightly press the dust cup lid button to open the lid, and empty the trash.
2. After cleaning the trash inside the dust cup, close the lid.

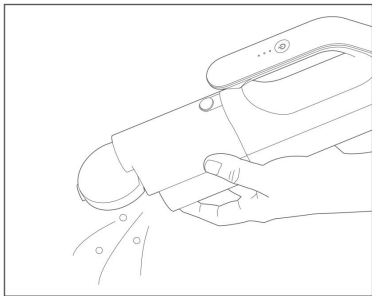

Disassemble and cleaning of the dust cup assembly

Disassemble the dust cup assembly

Press the dust cup unlock button, and rotate in the direction as shown to unlock the dust cup. As shown in the diagram below, align the buckle with the dust cup, and rotate to lock the dust cup.

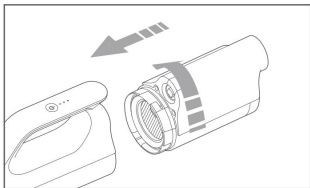
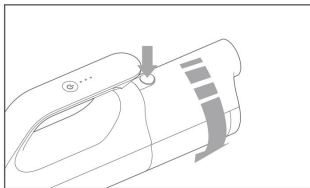

Disassemble the filter assembly

Pull the silicone handle of the filter to remove the filter, then remove the sponge and cyclone in sequence.

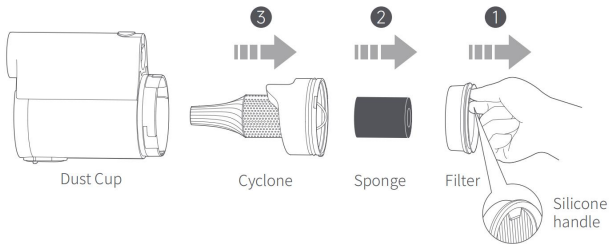

Clean components

1. After removing the filter, gently tap the filter to remove surface dust.
2. Wash the dust cup, cyclone, filter, and sponge. After drying them, reinstall them to the main unit in the order shown in the diagram.

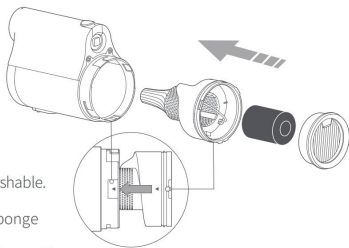
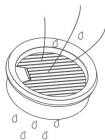

Note:

- The dust cup, cyclone, filter, and sponge are washable.
- Please air dry for 24 hours after washing.
- It is recommended to replace the filter and sponge components every 3 months.
- Please align the triangle indicator on the cyclone with the dust cup and reinstall the cyclone.
- Please purchase the filter and sponge components compatible with this product through official channels.

Precautions

- Be sure to use original parts; otherwise, it may not function properly.
- If the filter is blocked, the mode indicator will flash, and the main unit will stop after 5 seconds. Please clean the filter promptly before using it again.
- Before cleaning, ensure the accessories are detached from the main unit to prevent accidental startup causing personal injury.
- When not in use for a long time, please fully charge the vacuum cleaner and store it in a cool and dry place. Do not put it under direct sunlight or in humid environments.
- The body is not washable, but can be wiped with a soft dry cloth. Do not let water enter the charging port.
- Do not place the dust cup assembly in the dishwasher or washing machine for cleaning.
- Do not dry the dust cup assembly near a drum dryer, oven, microwave, or open flame.
- Do not use detergents to clean the body or accessories.
- It is recommended to replace the filter cartridge every 3 months based on actual usage.
- Do not use the vacuum function without the dust cup assembly installed.

04 Precautions

1. This appliance is not intended for use by persons (including children) with reduced physical, sensory or mental capabilities, or lack of experience and knowledge, unless they have been given supervision or instruction concerning use of the appliance by a person responsible for their safety. Children should be supervised to ensure that they do not play with the appliance.
2. The built-in lithium battery of the product cannot be disassembled. Do not throw the product into the fire or discard it at will. Overheating and hitting of the lithium battery and water damage to it may cause fire, autoignition, and explosion. Please do not place the product in hot environments such as vehicles for long.
3. Do not keep the product at a temperature below -10°C or above 45°C , because overcooling or overheating will shorten the product's life of service and damage the built-in battery.
4. If the product is left idle for long, its battery may be damaged. Please charge the product at least every three months.
5. The product is equipped with a built-in direct current machine. Please do not use it in flammable and explosive environments.
6. If the machine makes a strange noise or overheats during operation, please turn it off immediately.
7. Please do not leave during the inflating. Observe the inflating process to prevent the inflating pressure from being too high.
8. Please use the product in a dry and clean environment, as the product is not waterproof. Do not rinse the product.
9. Please use a safe and compliant adapter, in combination with a compliant charging cable, to charge the product. Faults caused by a failure to charge as stipulated above will not be covered by the warranty.
10. Do not use the product to clean any burning objects. Do not use the product to pick up flammable or combustible liquids, corrosive gases, or undiluted acids or solvents.
11. Do not suck up liquids.

05 Battery

- Please do not place the battery in extremely hot environments, such as sunshine, fire, microwave oven, and oven. Otherwise, explosions or flammable liquid and gas leakages may be caused.
- Please do not disassemble, hit, crush, or cut the battery. Otherwise, explosions may be caused.
- Please do not place the battery under extremely low air pressure. Otherwise, the battery may explode, or the flammable liquid and gas may leak.
- Please do not use the product if its battery is severely swollen.
- Before disposing of the device, remove the battery.
- Ensure the device is disconnected from the power supply when removing the battery.
- The battery must be disposed of safely.

Faults and troubleshoot

| Fault | Cause | Troubleshooting |
|---------------------------------|---|---|
| Vacuum cleaner not working | <ol style="list-style-type: none">1. Product has no power or insufficient battery2. Blocked airways or clogged filter3. Overheating of the airway leading to activation of protection | <ol style="list-style-type: none">1. Charge the product fully before use2. Clean the suction inlet or airways, and wash the filter3. Wait for the main unit to cool down and then try again |
| Reduced suction power | <ol style="list-style-type: none">1. Dust cup is full or filter is clogged2. Blockage in the suction head or other accessories | <ol style="list-style-type: none">1. Empty the dust cup and clean the filter2. Clean the blockages in the accessories |
| Shorter battery life | <ol style="list-style-type: none">1. Battery not fully charged2. Dust cup is full or filter is clogged3. Blockage in the suction head or other accessories | <ol style="list-style-type: none">1. Use the product after it is fully charged2. Empty the dust cup and clean the filter3. Clean the blockages in the accessories |
| Abnormal noise during operation | Foreign objects in the dust cup or suction head | Clean the blockages in the dust cup or suction head |

| | | |
|------------------------------------|---|--|
| Charging indicator not lighting up | <ol style="list-style-type: none"> 1. Main unit and charger are not properly connected 2. Battery is fully charged and has entered sleep mode | <ol style="list-style-type: none"> 1. Check if the charger and charging cable are properly connected 2. Reconnect the charging cable and check if the charging indicator lights up |
| Slow charging | <ol style="list-style-type: none"> 1. Battery temperature is too low or too high 2. Charger power is too low | <ol style="list-style-type: none"> 1. Wait for the battery temperature to return to normal before charging 2. Replace with a new charger that supports at least 20V---3A |

06 Specifications

Product name: HOTO BlowVac Handheld Vacuum

Product model: QWCXA006

Product dimension: Approx. 135.5×70×288 mm (5.33×2.76×11.34 in)
(bare machine, without accessories)

Net weight: Approx. 948 g (2.09 lb) (bare machine, without accessories)

Color: Black

Max Suction: 23000 Pa

Operating temperature: 0°C–40°C

Charging temperature: 5°C–40°C

Storage temperature: -10°C–45°C

Battery type: Lithium-ion battery

Typical Capacity: 2500 mAh

Rated Capacity: 2400 mAh

Operating Noise: Around 79 dB (A)

Rated Voltage: 18V---

Rated Power: 225W

Rated Input: 5V---2A, 9V---2A, 12V---2A, 15V---3A, 20V---3A

Charging Port: USB-C

Charging Time: Approx. 1.5 hours (20V---3A)

07 Regulatory Compliance Information



We, Shanghai HOTO Technology Co., Ltd., hereby, declare that this equipment is in compliance with the applicable Directives and European Norms, and amendments.

Disposal and recycling information



All products bearing this symbol are waste electrical and electronic equipment (WEEE as in directive 2012/19/EU) which should not be mixed with unsorted household waste. Instead, you should protect human health and the environment by handing over your waste equipment to a designated collection point for the recycling of waste electrical and electronic equipment, appointed by the government or local authorities. Correct disposal and recycling will help prevent potential negative consequences to the environment and human health. Please contact the installer or local authorities for more information about the location as well as terms and conditions of such collection points.

Notes for packaging



The packaging materials are recyclable. Please dispose of packaging in an environmentally friendly manner.



HOTO EUROPE AB
Pumpgatan 1, 417 55 GÖTEBORG,
Sweden
service@hototools.com

Federal Communications Commission Supplier's Declaration of Conformity

This supplier's declaration of conformity is hereby for

Product: HOTO BlowVac Handheld Vacuum

Model Number(s): QWCXA006

Brand/Trade: HOTO

We declare that the above mentioned device has been tested and found in compliance with CFR 47 Part 15 Regulation.

This device complies with part 15 of the FCC Rules. Operation is subject to the following two conditions: (1) This device may not cause harmful interference, and (2) this device must accept any interference received, including interference that may cause undesired operation.

Note:This equipment has been tested and found to comply with the limits for a Class B digital device, pursuant to part 15 of the FCC Rules. These limits are designed to provide reasonable protection against harmful interference in a residential installation. This equipment generates, uses and can radiate radio frequency energy and, if not installed and used in accordance with the instructions, may cause harmful interference to radio communications. However, there is no guarantee that interference will not occur in a particular installation. If this equipment does cause harmful interference to radio or television reception, which can be determined by turning the equipment off and on, the user is encouraged to try to correct the interference by one or more of the following measures:

- Reorient or relocate the receiving antenna.
- Increase the separation between the equipment and receiver.
- Connect the equipment into an outlet on a circuit different from the receiver is connected.
- Consult the dealer or an experienced radio/TV technician for help.

Representative of Responsible Party for SDoC

Company: HOTO (US) TECHNOLOGY CO LTD

Address: 919 North Market Street, Suite 950, Wilmington DE 19801

Country: U.S.A.

Customer Service(US): +1 855-577-2659 service@hototools.com

Mon-Fri 9: 00am-5: 00pm(CST)

Language spoken: English

DECLARATION OF CONFORMITY



EU Declaration of Conformity

We

Shanghai HOTO Technology Co., Ltd.

Declare that the product:

HOTO BlowVac Handheld Vacuum/ QWCXA006

Complies with the essential health and safety requirements of the following directives:

2014/30/EU Electromagnetic Compatibility directive References to the following harmonized standard were made:

EN IEC 55014-1:2021

EN IEC 55014-2:2021

EN IEC 61000-3-2:2019+A1:2021+A2:2024

EN 61000-3-3:2013+A2:2021+AC:2022-01

2011/65/EU+ (EU) 2015/863 Restrictions of the Use of Certain Hazardous

Substances in Electrical and Electronic Equipment

Authorised signatory and technical file holder:

Shanghai HOTO Technology Co., Ltd.

Building 45, No.50 Moganshan Road, Shanghai, China.

Manufacturer: Shanghai HOTO Technology Co., Ltd.

Address: Building 45, No.50 Moganshan Road, Shanghai, China

Designed by **HOTO**