

# This section describes how to bind smart speakers

## Set your Echo speaker by Alexa APP

1. If you have finished to install “Smart Life” then open Amazon Alexa App: sign in your Alexa account and enter password.
2. Click the menu on the left corner-click “Settings: choose “Set up a new device”(choose a device ,like Echo)Note:When the below page appears, long press the small dot on your Echo device until the light turns to yellow. Then Click Continue on App

**Note: at this moment, the mobile phone cannot open a variety of VPN software.**

Choose your own WiFi and wait for a few minutes. After an introduction video, click next step, it will enter Home page automatically. Now the Echo had connected to Wi-Fi successfully.

## Enable Smart Life Skill in Alexa

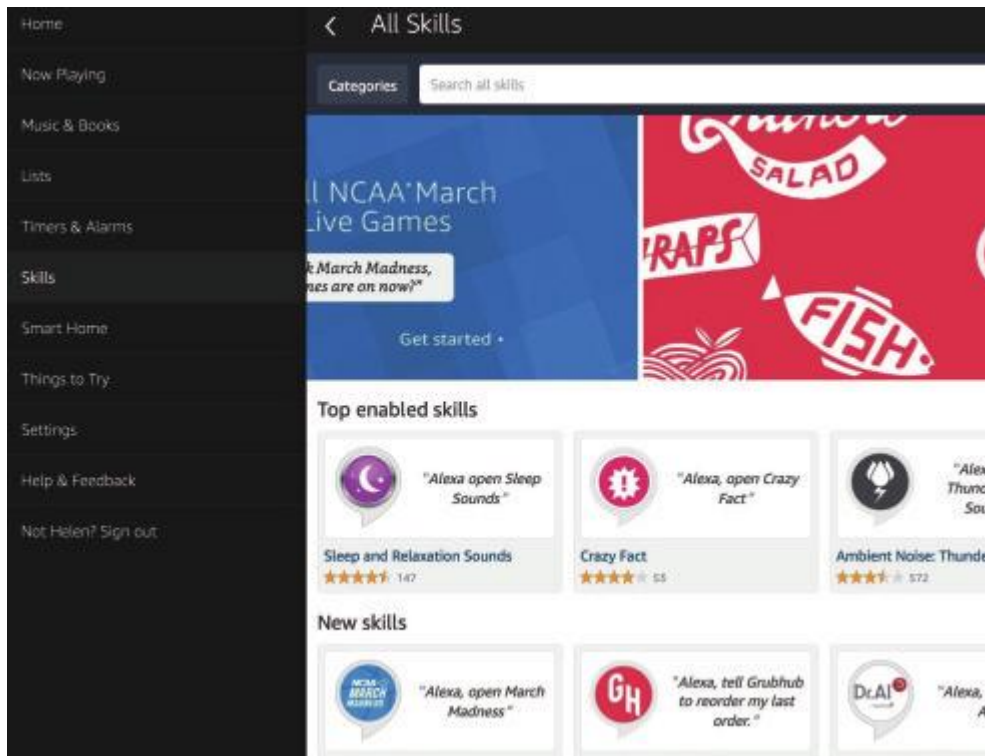

**Step 1:** Choose "Skill" in the option bar, and then search "SMART Life" in the input box.

**Step 2:** Select Smart Life in the search results, and then click "Enable Skill".

**Step 3:** Then input the user name and password of Smart Life APP that you had previously registered.

## Control the device by voice

After the above operation is successful, you can control the device via Echo.

### 1: Discover Device

Firstly , you need to say to the Echo:

Echo (or Alexa), discover my devices.

Echo will start to find the device which is added in the Smart Life APP.

It will take about 20 seconds, then Echo will tell you the result. You can also click "Discover devices" in Alexa APP , then it will show the devices that have been found successfully .

## 2: Control Device by Voice

Note: The name of the device must be consistent with the addition of Smart Life APP.

You can also group the device and give instructions to control them together.

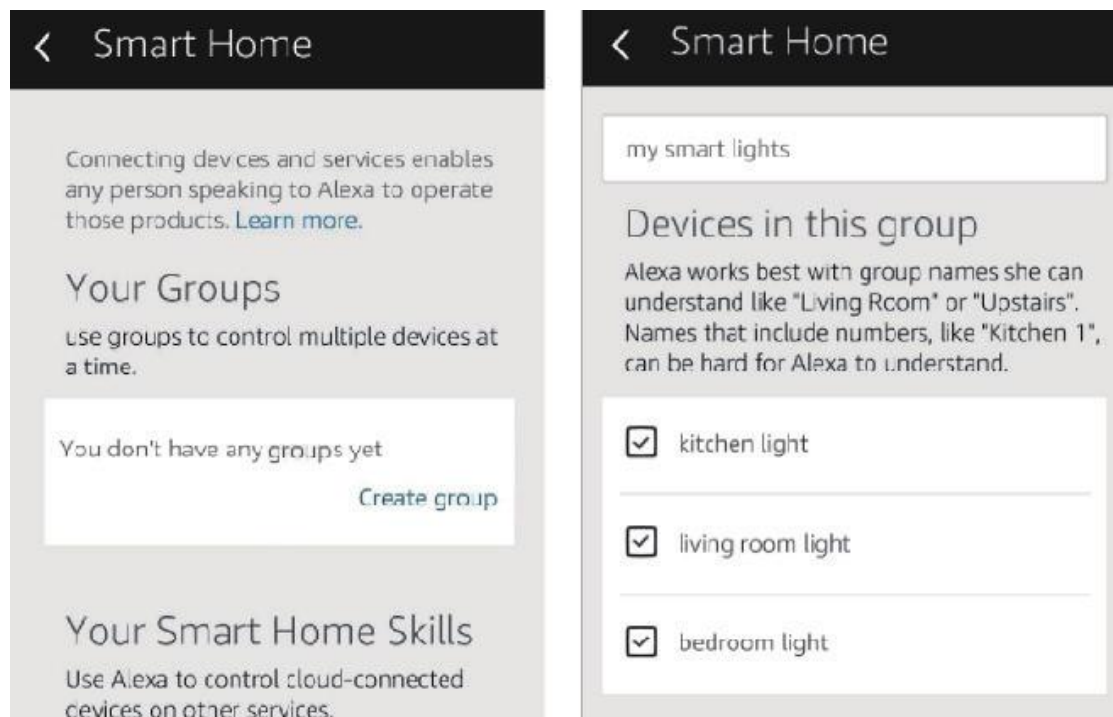

Note: Echo is one of the wake -up names, which can be any of the three names (Settings) Alexa, Echo, Amazon.

### 3: Support Skill List

You can control the devices by instructions like these:

Alexa(or Echo, turn on the Devices

Alexa(or Echo),turn off the Devices.

## Google Assistant –Activate Smart Life in Google

### Preparation

- Have downloaded the Google Home App-compatible With Android(4.2 or higher) or IOS(8.0 or higher)smartphones or tablet.
- Have registered your google Account.
- Have paired Device with Smart Life App and named it with a recognizable name.
- Have finished setting up Google Home.

**Step 1:** Open Google Home App ;tap( )on the upper left corner; select “More Settings :to enter the next interface.

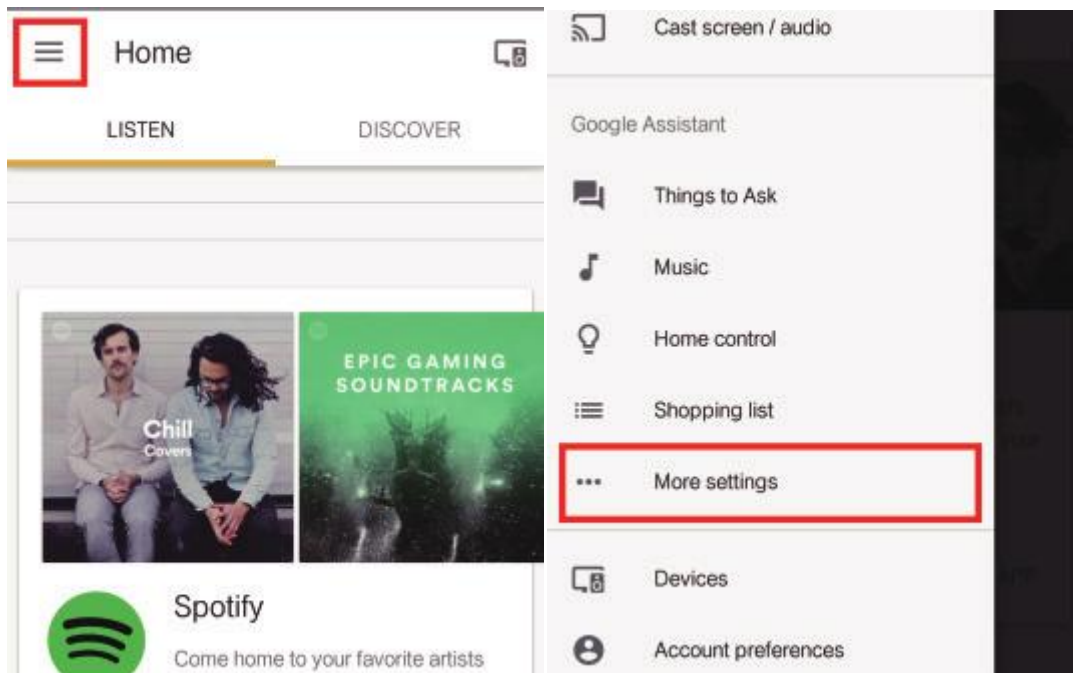

**Step 2:** Choose “Services” in the options bar and select “Smart Life” to enter the next interface.

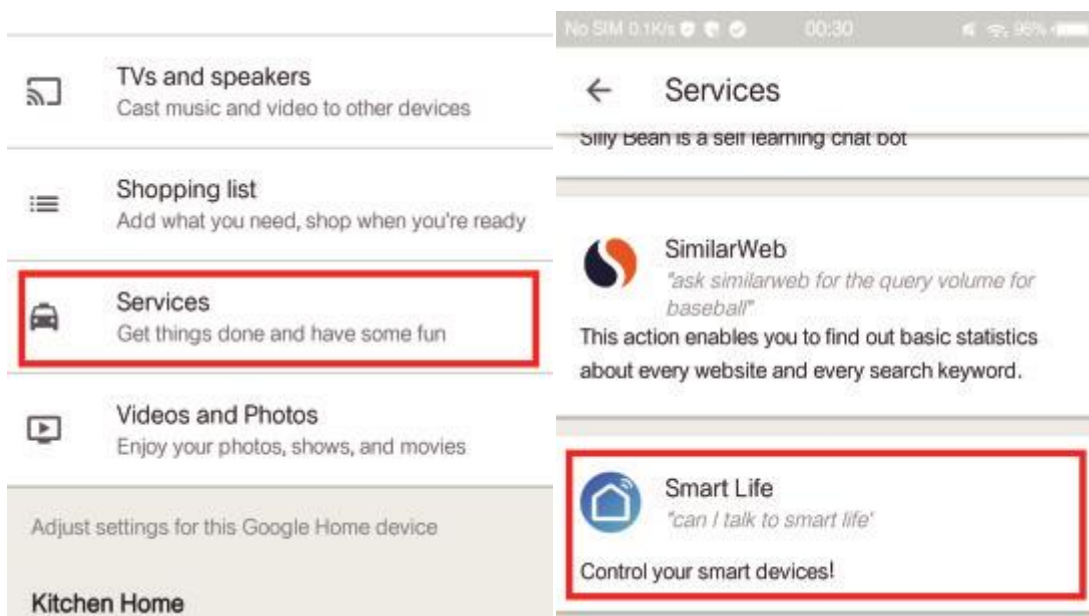

**Step 3:** Tap “ Link Account “, then sign in your smart Life Account.

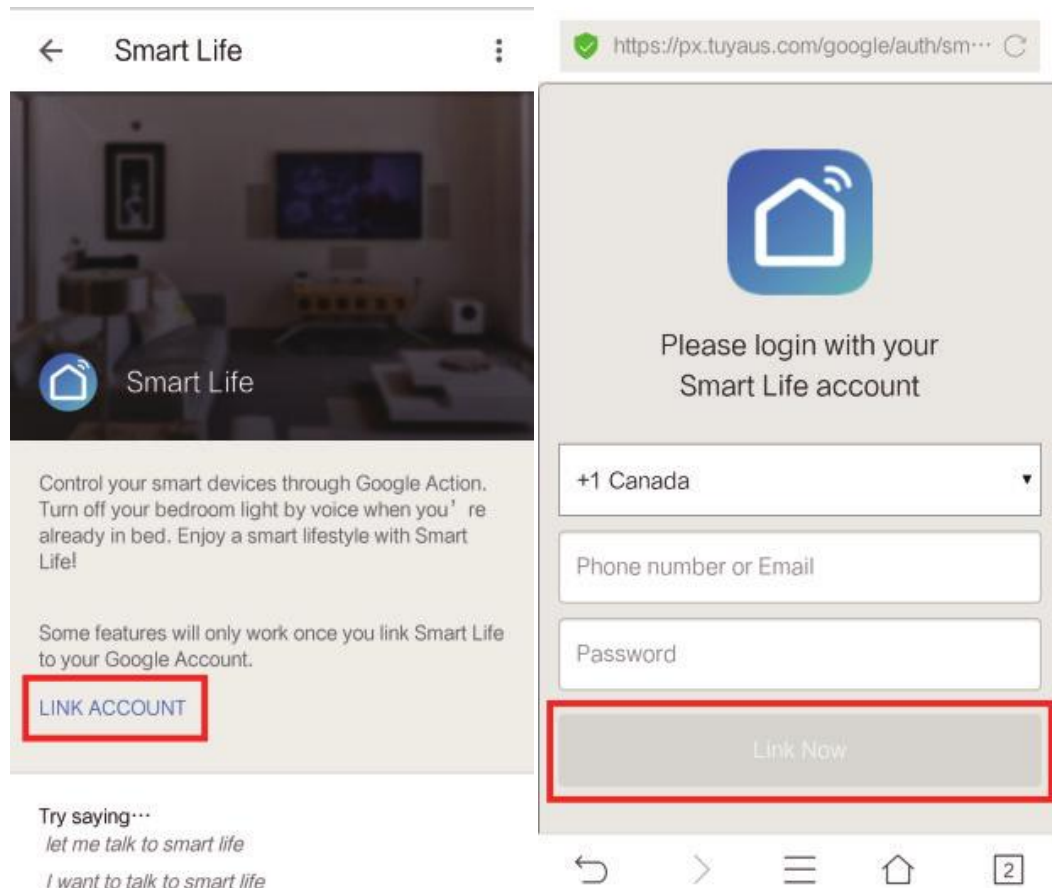

**Step 4:** Tap “Link Now”, after your Smart Life account had linked to Google Assistant, the smart devices will automatically appear.

## Command the Device through Your

Firstly ,you need to say “OK Google ,talk to Smart Life” to wake up the Smart Life. Then you can control the device by instructions like these:

Turn on the/Turn off the

**Note:** After Smart Life has been wakened up ,you may say “Cancel ”or “Stop” to exit Smart

Life or say “Nothing” when you hear “what can I do for you ” .Then you can say “OK Google, talk to Smart Life” to start voice control.

# IFTTT-Setup and Usage

Get Started: How to connect the product to IFTTT?

**Step 1:** Visit the IFTTT official website on your PC and sign in with your IFTTT account.

**Note:** You can also use IFTTT app and follow similar steps to connect your device to the IFTTT.

In the FAQ we take the website setting method for example.

**Step 2:** Search for “Smart Life”, and then click “Smart Life” service

**Step 1:** Click “Connect”, then log in your Smart Life ID and tap “Link Now”.

(The Smart Life ID is the same with that of Smart Life APP)

**Step 4:** After successfully connecting your IFTTT account to your Smart Life ID.