

# USER MANUAL

## N-S Wireless Controller (S09)

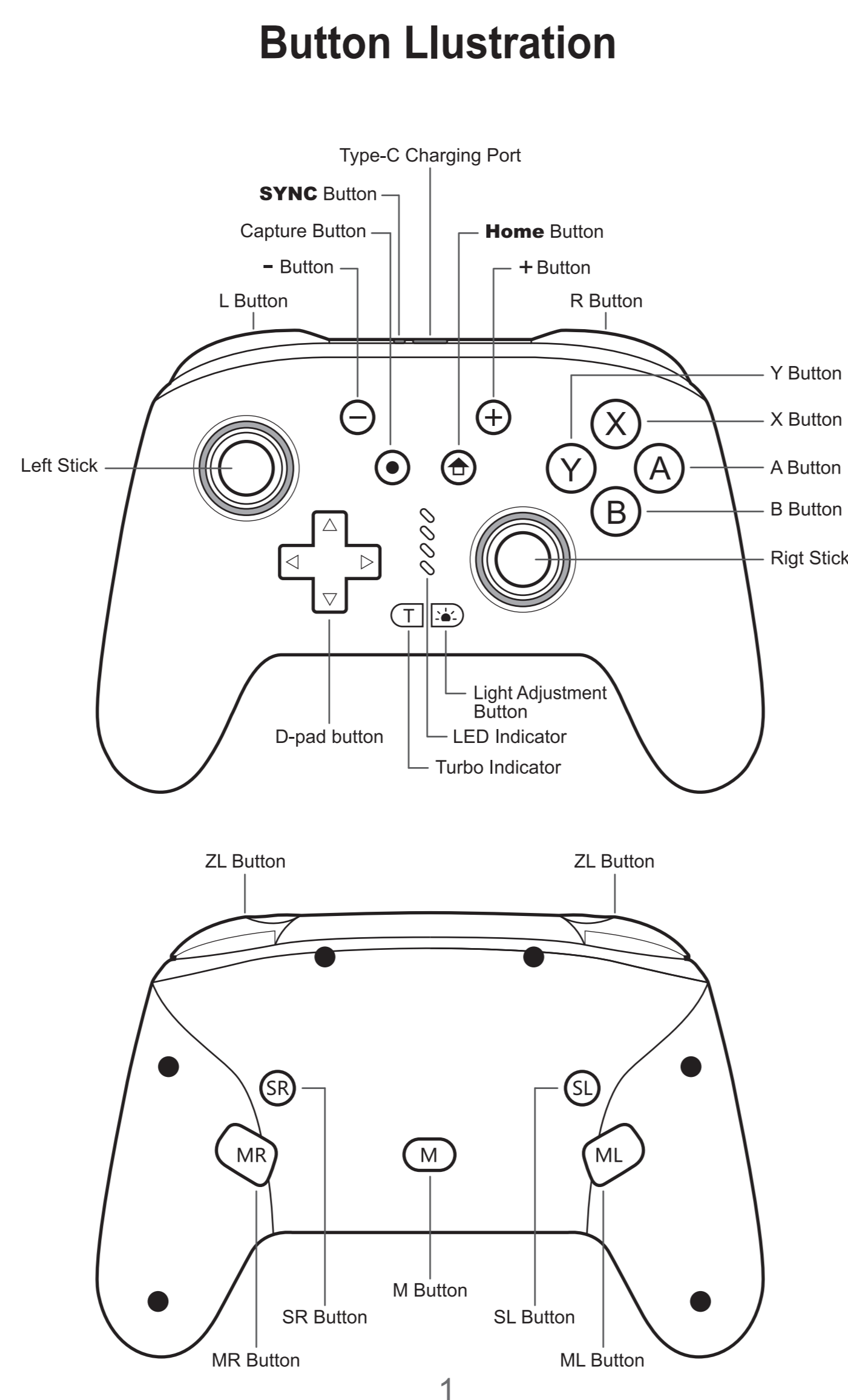
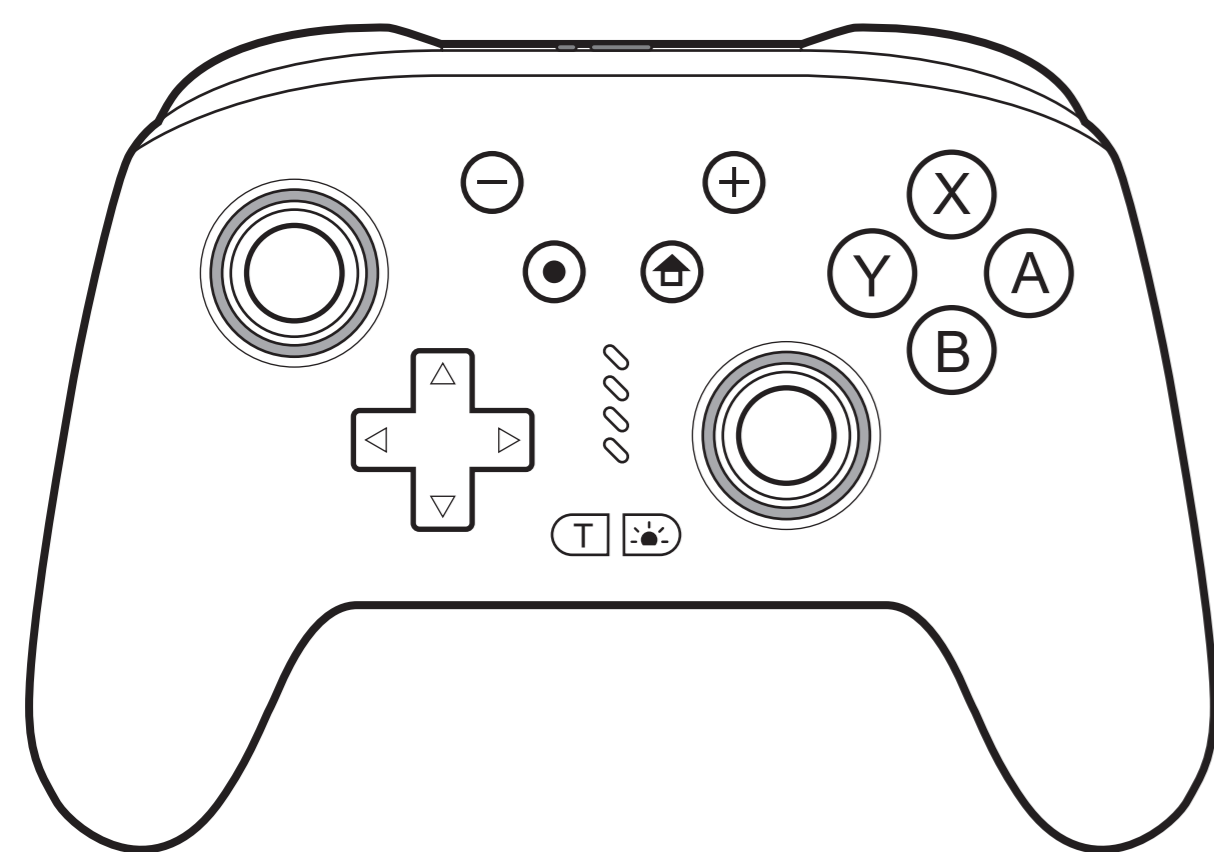

## About Connection Method

### Connect to N-S Console -Wireless Mode

- Note: ① Do not touch the stick while connected.  
② Please turn off airplane mode.

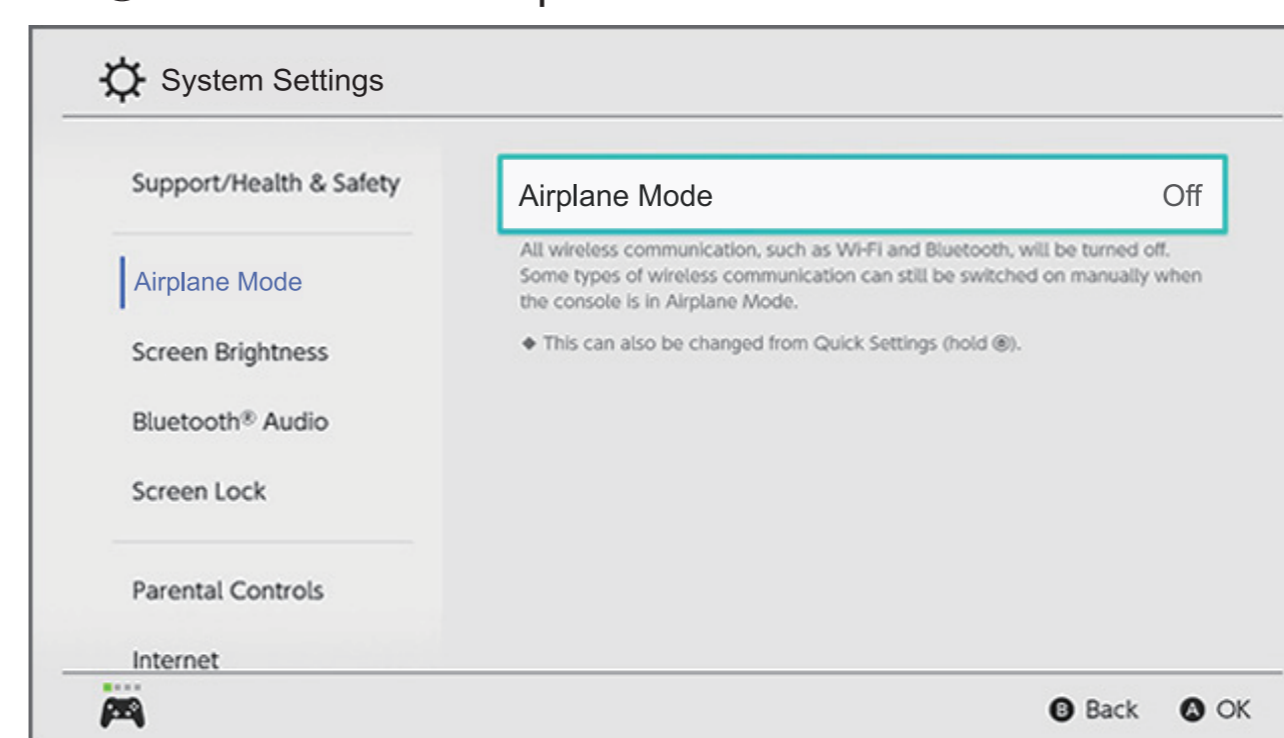

1. In the initial menu of N-S/Lite/OLED Console, click on "Controllers" option- then click on "Change Grip/Order" option and enter the Controller Pairing Mode.

Note: You can also open "System Settings - Controllers and Sensors - Change Grip/Order", enter the Controller Pairing Mode.

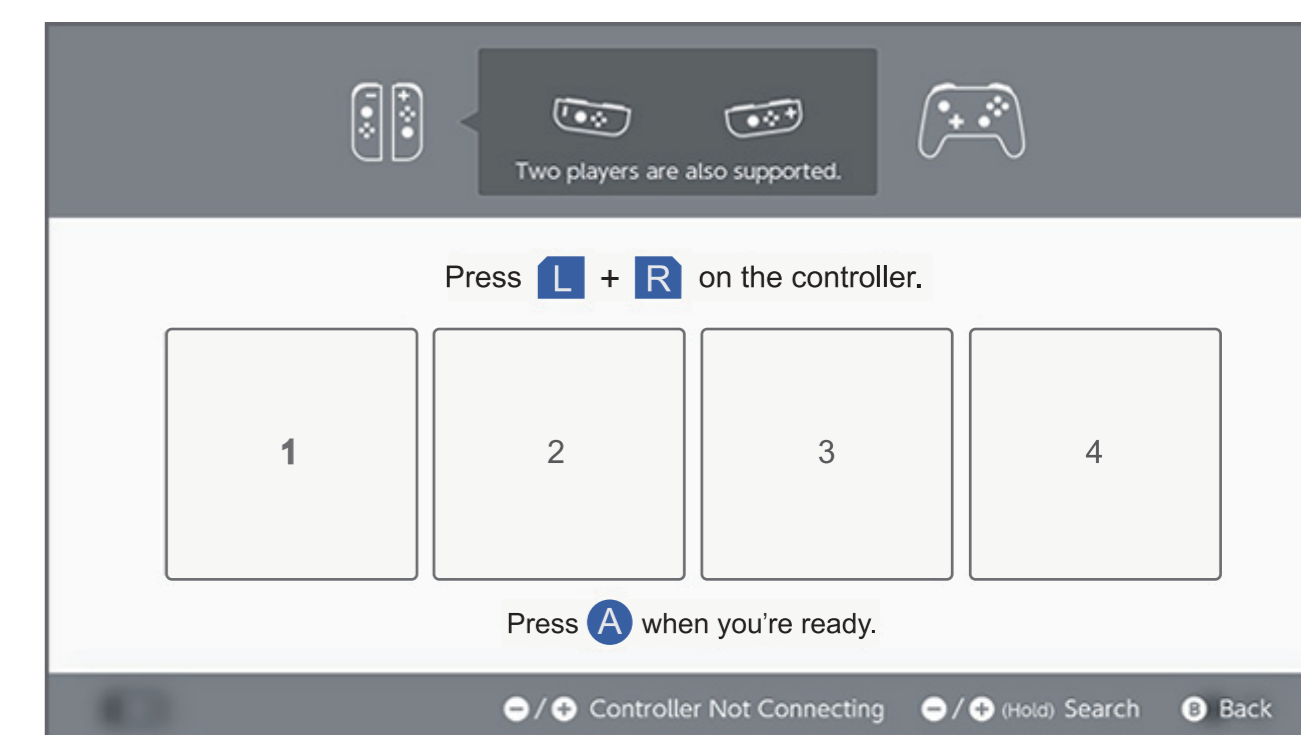
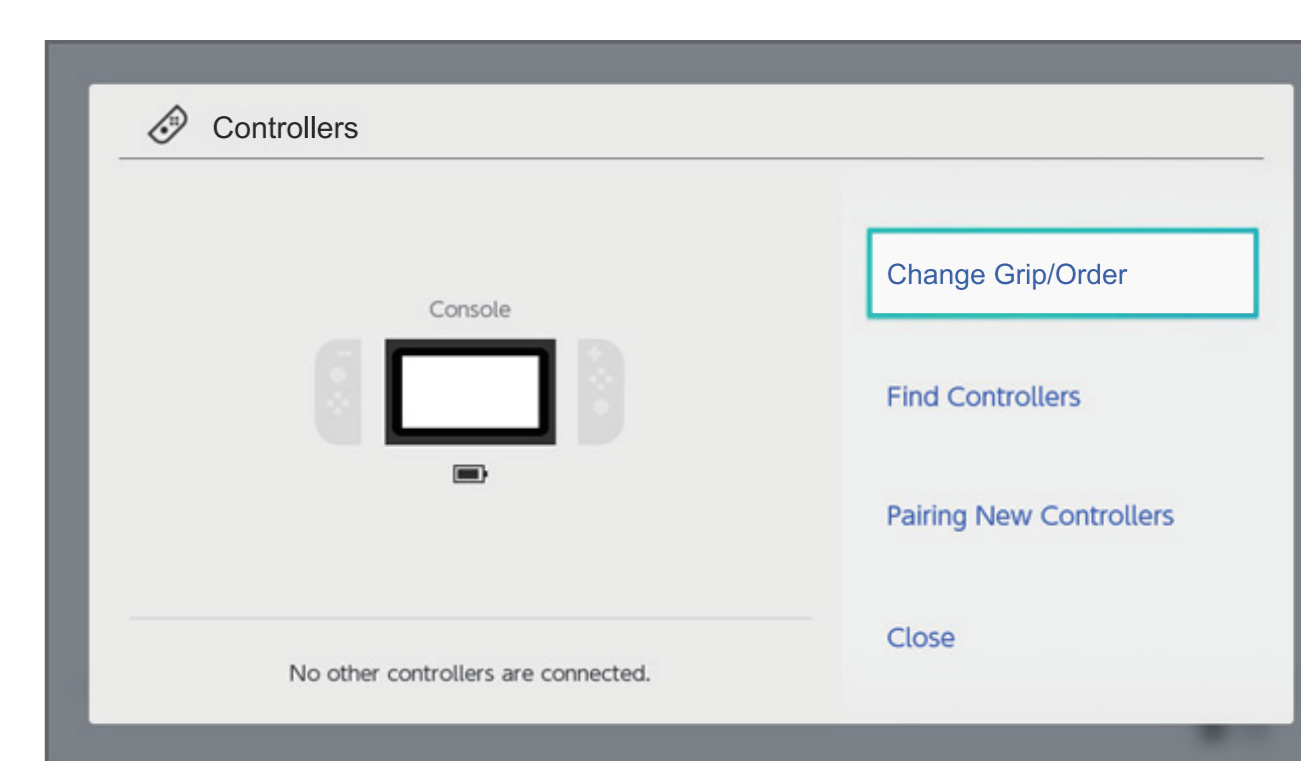
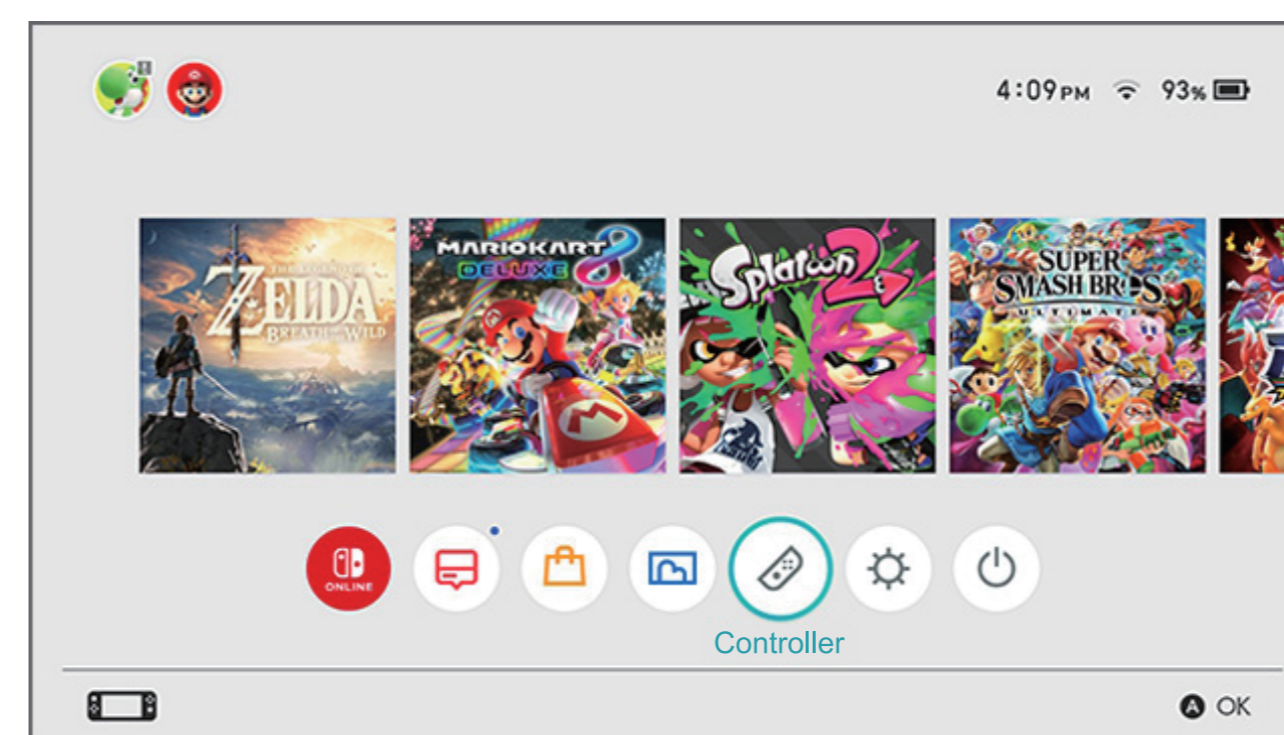

2. Press and hold the **[SYNC]** button for 3 seconds to enter the pairing state, the LEDs flash frequently.

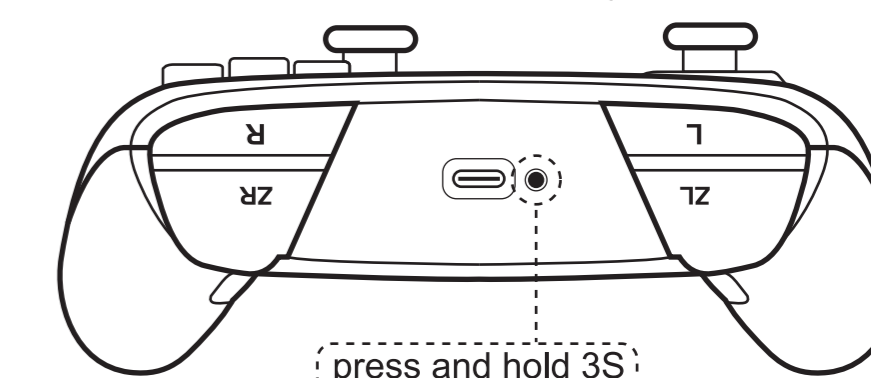

3. After the connection is successful, the LED1 is constantly on.



### For N-S Console -Wired Mode

1. Before starting the wired connection, please make sure that the "Pro Controller Wired Communication" option is turned on in the system settings of the N-S Console.

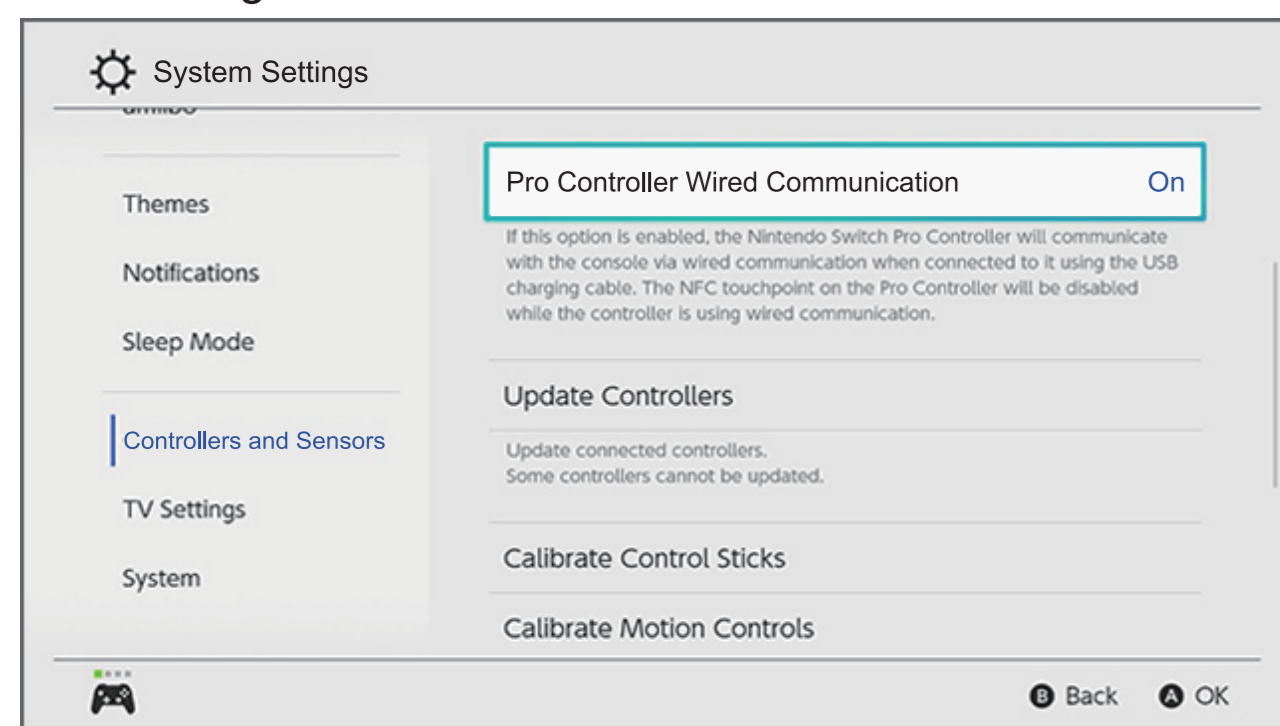

2. When the controller is connected to the official dock of the N-S with the Console sit in through the USB-C cable, it can be used as a wired controller.

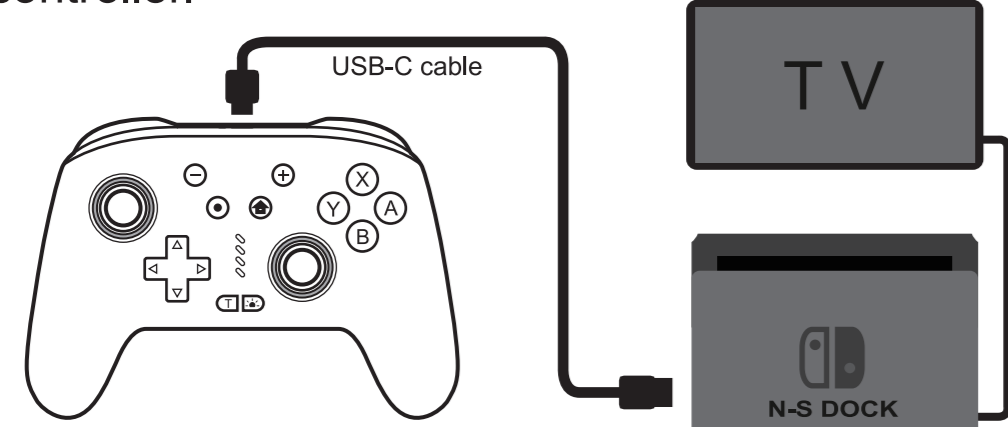

3. Unplug the USB-C cable, the controller turns into the wireless (Blue-tooth) mode, and automatically reconnects to the Console.  
4. If our controller turns off after unplugging the cable, please press the **[HOME]** button for a few seconds.

### Wake up (and Re-connect) the N-S Console

Press and hold the **[Home]** button for 1S can wake up (and re-connect) the console, but please note the wake up and re-connect function only works when the connected device this time is the same device connected last time.

4

### Connect to Android via Blue-tooth

Note: Not all Android/IOS games are compatible with the controller, please confirm that the game supports the controller before use.

1. Press the **[B]** and **[HOME]** buttons at the same time to turn on the controller. when the LED1/LED2 flash frequently, the controller enters the search mode.

(To prevent accidental touch, it is recommended to press and hold the **[B]** button first and then press the **[HOME]** button. Please make sure that these two buttons are pressed and held at the same time for more than 3 seconds)



2. Turn on the Blue-tooth of phone, enter the search mode, and click on the device to search for the controller of "Gamepad" to connect.

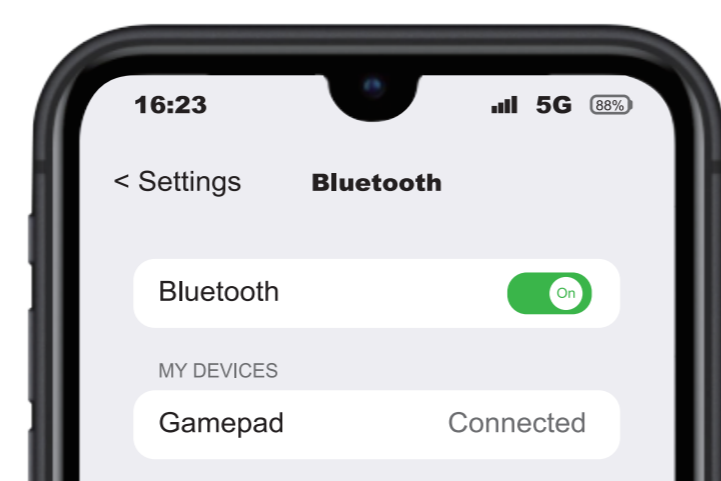

### Connect to IOS via Blue-tooth

1. Press the **[A]** and **[HOME]** buttons at the same time to turn on the controller. when the LED2/LED3 flash frequently, the controller enters the search mode.

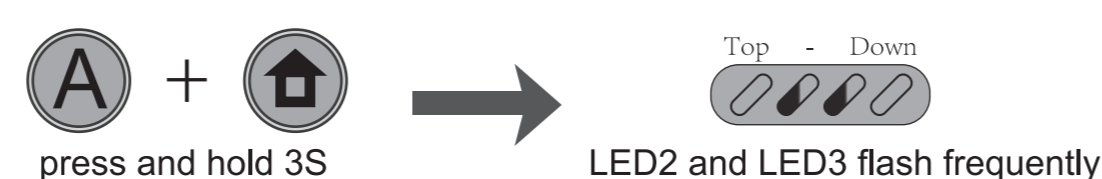

2. Turn on the Blue-tooth of phone, enter the search mode, and click on the device to search for the controller of "Xbox Wireless Controller" to connect.

5

### Connect to PC via USB-C Cable

Connect the controller to the computer with the USB cable. The LED1 and LED4 of the controller will flash slowly at the same time, and then it is successfully connected. The controller defaults to Xinput mode on the PC side.

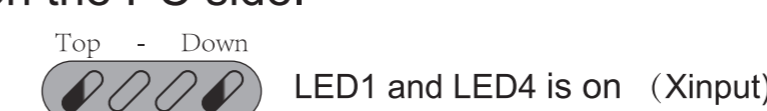

- Press and hold the **[HOME]** button for 3s, it can be converted from Xinput to the Dinput mode.

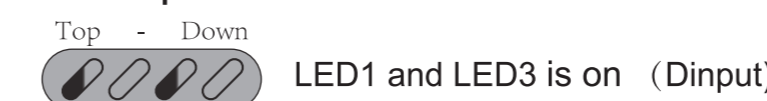

Note:

- ① On PC devices which is required Win 7 above system version.  
② Not all PC games are compatible with the controller, please confirm that the game supports the controller before use.

### About TURBO Function

1. The Buttons Support Turbo: A / B / X / Y / L / ZL / R / ZR buttons.

2. Two types of turbo: manual turbo and auto turbo:

- ① Open manual turbo: Press and hold the **[T]** button, and then press and hold one of the function buttons to turn on the manual turbo.

- ② Open auto turbo: Press and hold the **[T]** button, and then press and hold the button that has turned on the manual turbo to turn on auto turbo.

6

3. Clear turbo:

- ① Press and hold the **[T]** button, and then press and hold the button that has turned on the auto turbo to turn off the current button with turbo function.

- ② Clear all set button turbo: Press and hold the **[-]** button and the **[Down]** arrow on the D-pad. Once the controller vibrates, the turbo function of all buttons are closed.

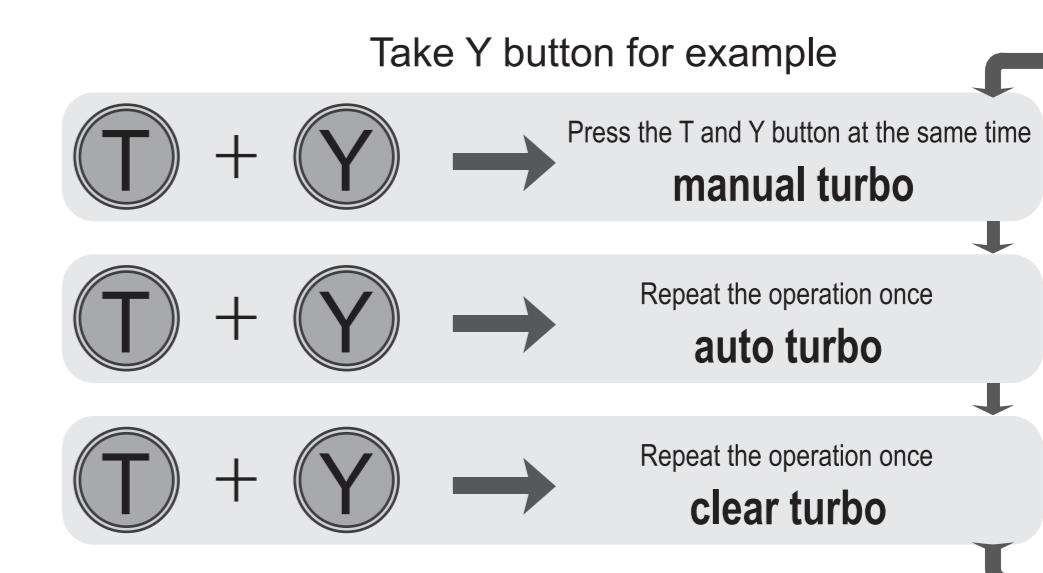

4. Turbo Speeds: The first level is 5 shots/s; the second level is 12 shots/s; the third level is 25 shots/s.

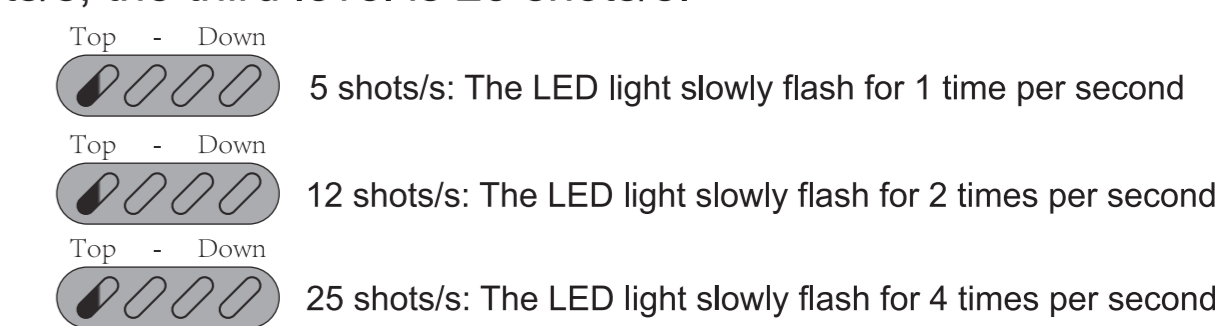

5. Adjust the turbo speed

- ① Press and hold the **[T]** button and the **[Up]** arrow on the D-pad. Once the controller vibrates, the turbo speed is successfully increased.

- ② Press and hold the **[T]** button and the **[Down]** arrow on the D-pad. Once the controller vibrates, the turbo speed is successfully reduced.

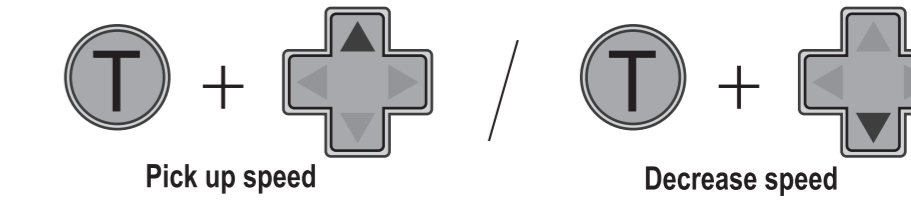

7

### About Back Button Function

1. The buttons that support mapping to back button (ML/MR): A / B / X / Y / L / ZL / R / ZR / L3 / R3 / D-pad (Up, Down, Left, Right)  
2. Up to 16 button can be mapped to ML/MR button.

#### Setting Steps

1. Firstly, keep the controller under working, press and hold the **[M]** button and **[ML]** (or MR) button about 3 seconds simultaneously, the controller vibrates one time, the RGB lights turns white and slow flashing.

2. Then press function buttons you want to set.

3. Lastly, press the **[ML]** (or MR) button again to save, the controller vibrates one time, RGB lights return to the normal connection status, setup complete.

(For example: press and hold the **[M]** button and the **[ML]** button at the same time for 3 seconds, after the RGB lights turns white and flashes slowly, press the **[B]** button, then press the **[A]** button after one second, last press the **[X]** button after 3 seconds, when the setting is completed, press **[ML]** button to save and exit. The function of "ML" button at this time is "B" button function, after 1 second is "A" button, after 3 seconds is "X" button).

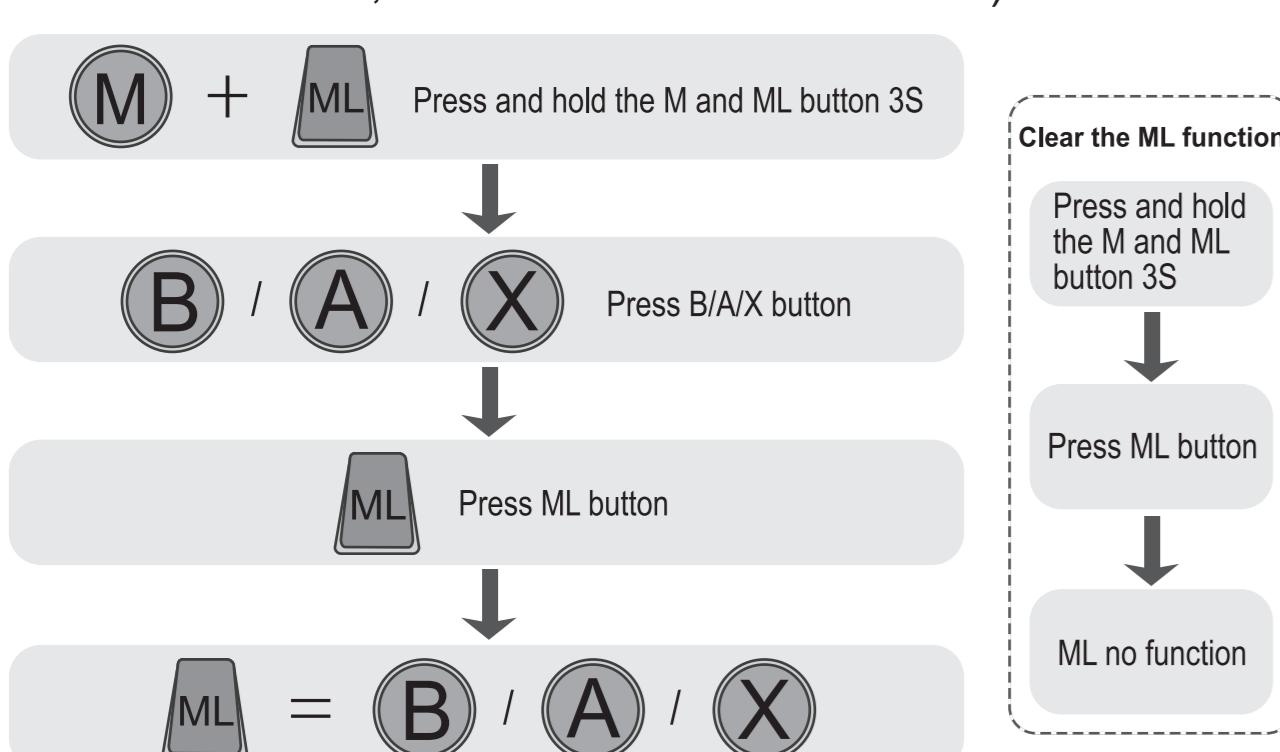

Clear the back button function: Press and hold the **[M]** button for 5 seconds

8

### Enable and Disable of the back button

This function is mainly to solve the problem of touching the back button by mistake. After completing the setting of functions with ML or MR button, double-click the SL button to disable/enable the ML button, double-click the SR button to disable/enable the MR button. (Double-click means clicking twice quickly.)

#### Auto turbo of the back button

This function is only available when multiple key values are edited with the ML or MR button, and not available when only a single key value is edited.

Take ML/SL button as example:

After completing the setting of functions with **[ML]** button, long press the **[SL]** button for 3 seconds, the controller vibrates once, at this point, the **[ML]** button will enter into auto turbo state. After every time releasing the auto turbo function, the auto turbo function releases again automatically interval of 5 seconds. Then long press the **[SL]** button for 3 seconds once again, the controller vibrates once to delete the auto turbo function of the **[ML]** button. (The MR/SR buttons are set in the same way as the ML/SL buttons)

#### RGB Lighting Adjustment

1. There are 10 kinds of RGB light modes: dazzling color mode, continuous light changing mode, 7 kinds of fixed color mode (Red, Orange, Yellow, Green, Cyan, Blue, Purple), flicker mode.

2. Press light adjustment button **[L]** once to change another mode. After completely switching the 10 kinds of light modes, the light will be turned off. Then press the light adjustment button **[L]** once again, the light will be turned on from dazzling color mode.

3. There are 4 levels light intense of RGB: 40%-60%-80%-100%. Press and hold the light adjustment button, then push up the left stick once to add one level, push down the left stick once to downshift one level.

4. Press the light adjustment button and **[T]** button at the same time will switch to dazzling color mode.

5. Long press light adjustment button for 6 seconds to turn off the RGB light.

9

### Vibration Intensity Adjustment

1. 4 Levels strength: 0%-30%-75%-100%, Default 75%.

2. Press **[L]** **[ZL]** **[R]** **[ZR]** buttons and hold about 2 seconds simultaneously, the intensity of vibration will be adjusted.

- Note: ① Be sure your controller has connected with the N-S console.  
② The vibration setting will be saved when the controller is turned off.

#### Charging Tips

1. When the controller is turned on: the LED indicator will flash rapidly when the battery is in low power status; the LED indicator will flash in low speed when the battery is charging; the LED indicator will stop flashing when the battery is fully charged.

2. When the controller is turned off: the LED indicator will flash in low speed when the battery is charging; the LED indicator will go out when the battery is fully charged.

#### Charging parameters

Polymer battery: 1000mAh Input voltage: 5V 0.5A  
Normal operating current: 20mA Maximum vibration operating current: <250mA  
Charging time: 2.5-3.5 Hours

#### How To Power Off

1. Under connection status, there is not any operations within 5 minutes, then the controller power off automatically.

2. When controller disconnection and console's screen display being off, then the controller power off automatically.

3. Press and hold the **[HOME]** button about 5 seconds until the controller power off.

4. Press **[SYNC]** button.

#### How to Restore Factory

1. Press and hold **[L3]** and **[R3]** button at the same time, and press the **[HOME]** button for 2 seconds, the four LEDs turn on once and then off, the setting is complete. (make sure the controller is turned off)

10



## SERVICE SUPPORT

If you encounter difficulties or product defects in the process of using the product, please contact our after-sales service through the purchase platform. We will take analyzing once receive your feedback, and assist you to solve the problem or provide replacement of the product. We also welcome your valuable suggestions to help us continuously optimize this product. We wish you a pleasant life.