

# INSTRUMENT WIRELESS MICROPHONE

## USER MANUAL



### PRODUCT FEATURE DESCRIPTION

#### PREFACE

Dear User:  
Thank you for purchasing the musical instrument wireless microphone. To help you better understand how to use this product, we recommend that you read this manual carefully before use.

#### PRODUCT FEATURES

Instrument wireless microphone, supports wireless microphone amplification;

Uses 2.4G wireless transmission technology, with an indoor wireless range of up to 30 meters;

Adopts wireless digital technology to suppress howling and noise, restoring high-fidelity sound quality;

Built-in high-performance lithium-ion battery for long-lasting use;

Multiple devices can be connected intelligently and compatibly;

Compatible with various instruments, with automatic pairing when turned on;

The product features a brand-new appearance design, with a novel shape, stylish look, and lightweight, convenient use.

#### COMPATIBLE DEVICES

Trolley speaker, amplifier, computer speaker, portable speaker, mixer, KTV set

### SAFETY WARNING

#### SAFETY WARNING

To avoid personal injury or property damage that may be caused by electric shock, high temperatures, fire, radiation, explosions, mechanical hazards, or improper use, please read and follow the following precautions carefully before using this product:

- When using the product, please ensure that the connected device is compatible with the product and adjust the volume appropriately. Do not use it at volumes or power levels exceeding the product's specifications for extended periods to avoid malfunction;
- If any abnormalities occur during use (such as smoke or unusual odors), immediately turn off the power and unplug the device, then send it to an authorized service center for inspection;
- If the consumer uses a power adapter, it should be a compatible adapter with CCC certification and meet the required standards;
- The product and its accessories should be placed in a dry, ventilated indoor location. Do not store them long-term in humid or dusty environments. During use, avoid close contact with fire, exposure to rain or water, excessive impact, dropping, vibration, or covering ventilation holes to prevent functional damage;
- If the product needs to be mounted on a wall or ceiling, ensure it is securely fixed to prevent the risk of falling due to insufficient mounting strength;
- When using this product, observe relevant safety regulations. Do not use it in any locations where it is explicitly prohibited by laws or regulations to avoid accidents;
- Do not disassemble, modify, or repair the product yourself to prevent personal injury. If there are any issues or service needs, please contact the local after-sales service center for assistance.

#### TROUBLESHOOTING:

If there is no sound or the sound is weak, first check the power supply, ensure the receiver is properly connected, the instrument microphone has sufficient battery, and the battery is inserted correctly. If the power is all normal but the sound is still weak, try turning up the volume of the speaker or amplifier.

If there is distortion or extra noise, check if there are any interference devices nearby, such as CD players, computers, digital devices, or in-ear monitoring systems, and try removing them. If multiple systems are being used, increase the frequency spacing between each system.

### SIZE PARAMETERS

#### LAUNCHER

Connection Type: 2.4GHz  
Frequency : 60Hz-16kHz  
Directionality: Unidirectional  
Sensitivity: -45 ~ -46dB  
Usage Distance: 30 meters (indoor)  
Battery Type: Lithium-ion battery  
Battery Capacity: 3.7V/200mAh  
Charging size: 5V-1A  
Charging Time: About 30 minutes  
Usage Time: About 4 hours  
Net Weight: About 3.5g  
Charging Port: USB 3.0/2.0/1.1  
Voltage: 3.7V

#### RECEIVER

Connection Type: 2.4GHz  
Usage distance: 30 meters (indoor)  
Battery type: Lithium-ion battery  
Battery capacity: 3.7V/200mAh  
Charging size: 5V-1A  
Charging time: About 30 minutes  
Usage time: About 4 hours  
Device weight: About 3.5g  
Charging port: USB3.0/2.0/1.1  
voltage: 3.7V

#### FUNCTION SELECTION

Double-click the power button to select the high-cut, flat, or low-cut function

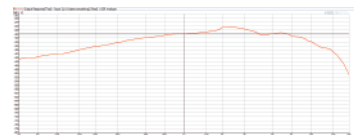

HIGH-PASS FUNCTION

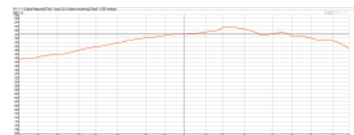

STRAIGHTENING FUNCTION

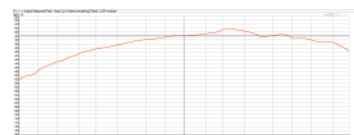

LOW-CUT FUNCTION

### TRANSMITTER FUNCTION

#### TRANSMITTER

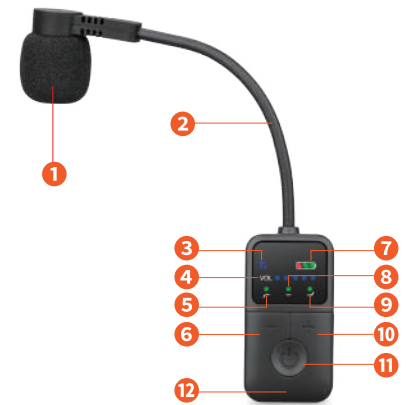

- HIGH-FIDELITY PICKUP MICROPHONE:** Reduces environmental noise interference, picks up sound clearly, and restores the true sound.
- 360° ADJUSTABLE HOSE:** Freely adjust the direction, positioning the microphone head at the instrument's sound output for clearer pickup.
- SIGNAL INDICATOR LIGHT:** Flashes during wireless pairing, stays on when pairing is successful.
- VOLUME SIGNAL LIGHT:** Displays the volume level.
- HIGH-CUT INDICATOR LIGHT:** Lights up when the high-cut function is selected (removes corresponding high frequencies, suitable for more scenarios).
- VOLUME DOWN BUTTON:** Decreases the volume.
- BATTERY INDICATOR LIGHT:** Shows the transmitter's battery level, automatically powers off when the battery is low.
- FLAT INDICATOR LIGHT:** Lights up when the flat function is selected (sound curve is relatively balanced, suitable for more scenarios).
- LOW-CUT INDICATOR LIGHT:** Lights up when the low-cut function is selected (removes corresponding low frequencies, suitable for more scenarios).
- VOLUME UP BUTTON:** Increases the volume.
- POWER/FUNCTION BUTTON:** Long press to power on/off, double-click to switch between high-cut, flat, and low-cut functions, single click to mute.
- DC5V 1A CHARGING PORT:** Connect an external power adapter to charge the receiver. Please turn off the receiver's power switch while charging.

### RECEIVER FUNCTION

#### RECEIVER PARAMETERS



- 3.5MM RECEIVER PLUG:** Equipped with a 3.5mm connector, convenient for connecting to various audio devices.
- CHANNEL SIGNAL INDICATOR LIGHT:** Stays on when pairing is successful. Channel A/B - blue light.
- BATTERY INDICATOR LIGHT:** Displays the battery level of the transmitter. Automatically shuts off when out of power.
- POWER SWITCH:** Long press to turn on/off.
- DC5V 1A CHARGING PORT:** Connect an external power adapter to charge the receiver. Please turn off the receiver power switch while charging.
- RESET BUTTON:** If the device is completely unresponsive, the most direct and effective way to restart is to long press this button.

### TRANSMITTER CONNECTION

#### INSTRUCTIONS FOR USE

- PAIRING METHOD**  
1. Turn on the power switches of the instrument microphone and the receiver;
- Press the power button on the instrument microphone, and wait until the working indicator light on the microphone changes from blinking to steady, indicating that pairing is successful;
- Plug the receiver into the MIC input of the amplifier to start amplification;
- Turn on the power switches of both the instrument microphone and the receiver, which will automatically pair. When the microphone indicator light changes from blinking to steady and sound is output from the amplifier when you press the pickup button and speak into the microphone, pairing is successful.



Note: Due to structural issues, the mesh cotton has been removed privately and cannot be returned or serviced.

FCC Caution.

This device complies with part 15 of the FCC Rules. Operation is subject to the following two conditions:

- (1) This device may not cause harmful interference, and
- (2) this device must accept any interference received, including interference that may cause undesired operation.

Any Changes or modifications not expressly approved by the party responsible for compliance could void the user's authority to operate the equipment.

Note: This equipment has been tested and found to comply with the limits for a Class B digital device, pursuant to part 15 of the FCC Rules. These limits are designed to provide reasonable protection against harmful interference in a residential installation. This equipment generates uses and can radiate radio frequency energy and, if not installed and used in accordance with the instructions, may cause harmful interference to radio communications. However, there is no guarantee that interference will not occur in a particular installation. If this equipment does cause harmful interference to radio or television reception, which can be determined by turning the equipment off and on, the user is encouraged to try to correct the interference by one or more of the following measures:

- Reorient or relocate the receiving antenna.
- Increase the separation between the equipment and receiver.
- Connect the equipment into an outlet on a circuit different from that to which the receiver is connected.
- Consult the dealer or an experienced radio/TV technician for help.

The device has been evaluated to meet general RF exposure requirement. The device can be used in portable exposure condition without restriction

