

ANKRA

FotoCube

Innovation for Connection

User Manual



<https://www.youtube.com/@FotoCubeFrame>

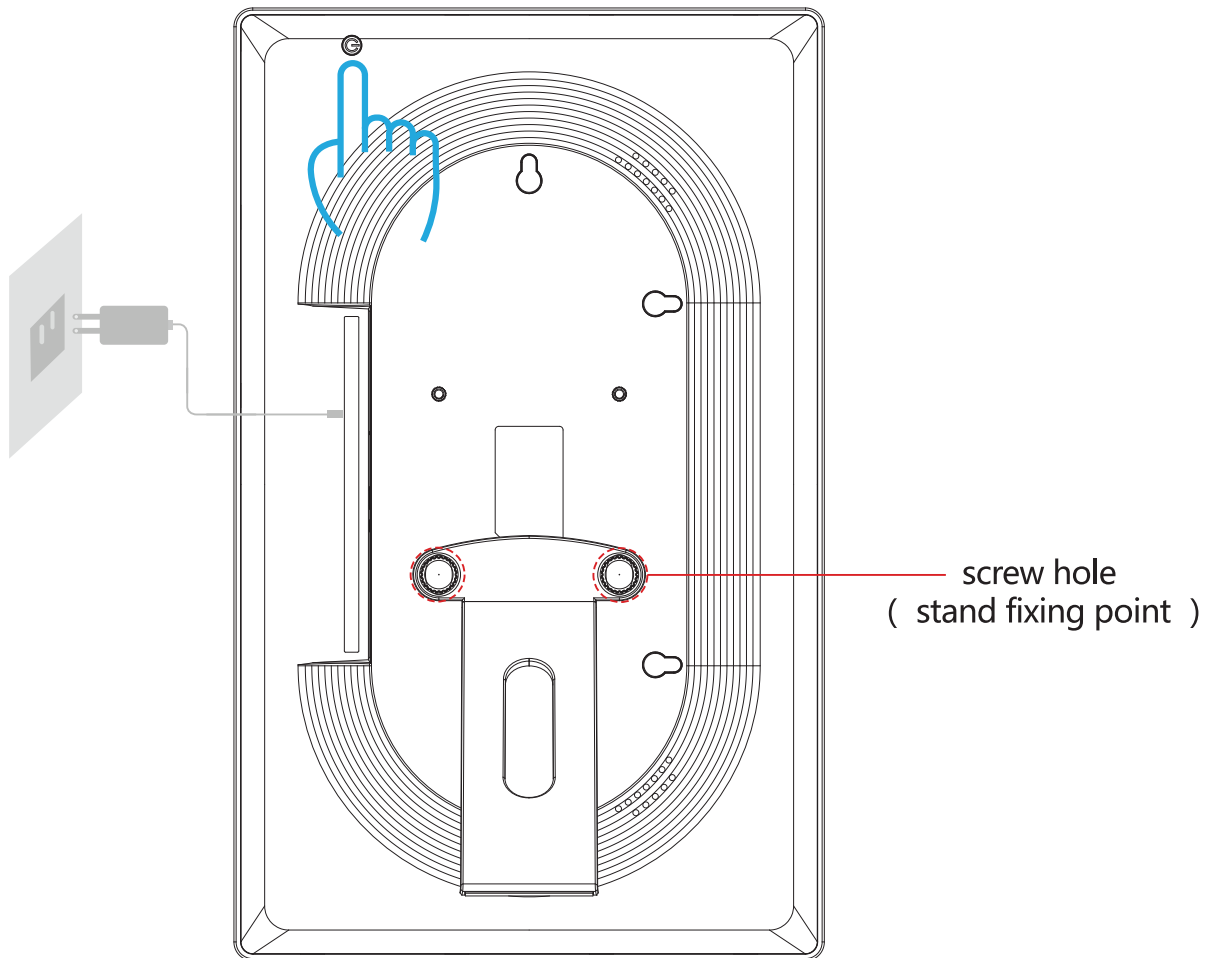
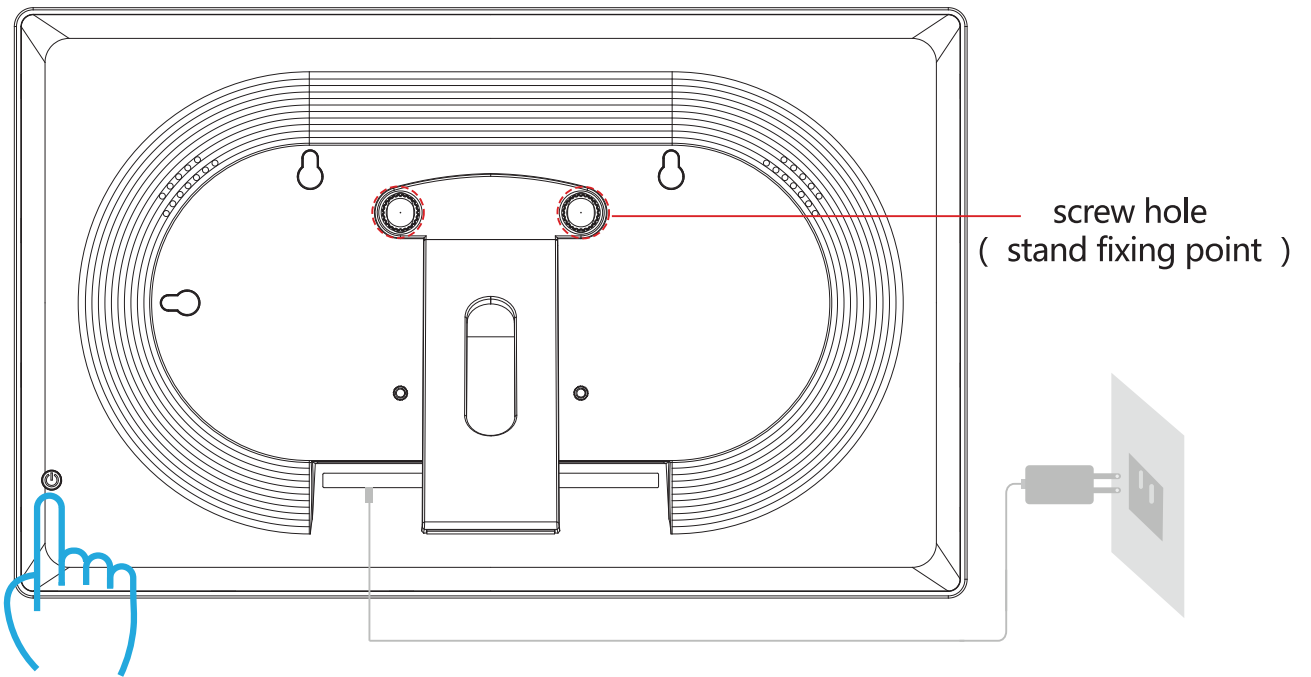

1. Getting Started	5
2. FotoCube Smart Display	5
2.1 How to Use FotoCube Smart Display	5
2.2 How to Pair the Smart Display with the FotoCube APP	8
2.3 How to Use FotoCube Smart Display Offline	9
2.4 Photo Frame	9
2.4.1 Operation	9
2.4.2 Menu	9
2.5 Family Calendar	12
2.5.1 Calendar	12
2.5.2 Daily To-Do List	13
2.5.3 Import Calendars	14
2.5.4 Member List	16
2.5.5 Star Points	16
2.5.6 Gift Redemption	17
2.5.7 Meal Plan	18
2.5.8 Habit Plan	19
2.5.9 Lists	19
2.5.10 Clock	20
2.5.11 Add Voice	20
2.5.12 Title Templates	21
2.5.13 Repeat Customization	21
2.5.14 Switch to Photo Frame Mode	21
2.5.15 Sleep Mode	22
2.5.16 Calendar Screensaver	22
2.6 Art Gallery	22
2.6.1 Display of Art Paintings	22
2.6.2 Switch Interval Time	22
2.6.3 Select Mode	22
2.7 How to Send Blessings	22
2.8 System Settings	23
2.8.1 Device Settings	23

2.8.2 Account Settings	24
2.8.3 Display Settings	24
2.8.4 Playback Settings	25
2.8.5 Wi-Fi	25
2.8.6 Help	26
2.8.7 System Information	26
3. FotoCube APP	27
3.1 Quick Setup	27
3.2 Register an Account	27
3.3 Send Photos or Videos	27
3.4 Manage the Family Calendar	28
3.4.1 Select the Smart Display to Manage	28
3.4.2 Create New Calendar Events (To-Do Items)	28
3.4.3 Add New Members	29
3.4.4 Edit or Delete Members	29
3.4.5 Import Third-Party Calendars	29
3.4.6 Meal Plan	29
3.4.7 Habit Plan	30
3.4.8 Clock	30
3.4.9 Star Points	31
3.4.10 Title Templates	31
3.5 Send Blessings	32
3.6 Manage Devices	32
4. Language Support	32
5. Warranty, Compliance, Technical Support, and Safety Information	32

1. Getting Started

If you are just starting to use FotoCube:

1. Insert the power supply to start the Smart Display;
2. Follow the guide on the screen to start setting up the Smart Display step by step;
3. Complete the setup and start interacting with your friends and family.

FotoCube Smart Display



The FotoCube Smart Display provides three modes: Photo-Frame, Family-Calendar, and Art-Gallery. Choose the mode you like.

The touchscreen operation is easy to use, making photo sharing and family schedule management smoother and more convenient, providing you with a high-quality, simple, and enjoyable experience.

FotoCube APP

The FotoCube app supports rich functions on Android and iOS systems, allowing for easy sharing of connected devices anytime and anywhere. No matter where you are in the world, you can send photos, videos, or manage the family schedule online in real-time at any time.

Download FotoCube APP

<p>F Method 1: Scan the QR code to download the APP</p> <div data-bbox="277 1408 475 1608"></div> <p>Download from Google Play</p> <div data-bbox="523 1408 715 1608"></div> <p>Download from Apple store</p>	<p>F Method 2: Search for and download the FotoCube APP in the app store</p> <ul style="list-style-type: none">• Android: Search for "FotoCube" on Google Play and then download the APP.• iOS: Search for "FotoCube" on the Apple Store and then download the APP.
---	--

2. FotoCube Smart Display

2.1 How to Use FotoCube Smart Display

When you use the Smart Display for the first time, you need to set it up.

- **Choose a language:** Select your preferred language as the default language.

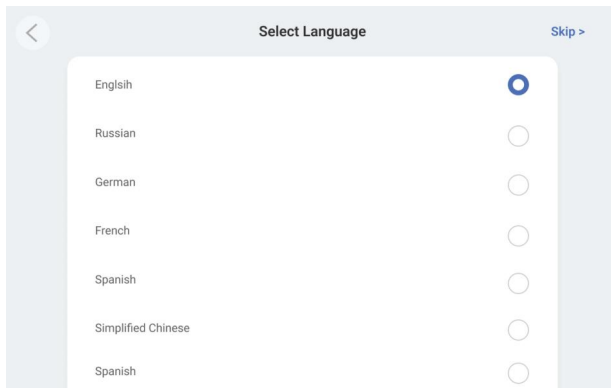

- **Connect to Wi-Fi:** Connect to the Wi-Fi at home to connect the Smart Display to the internet.

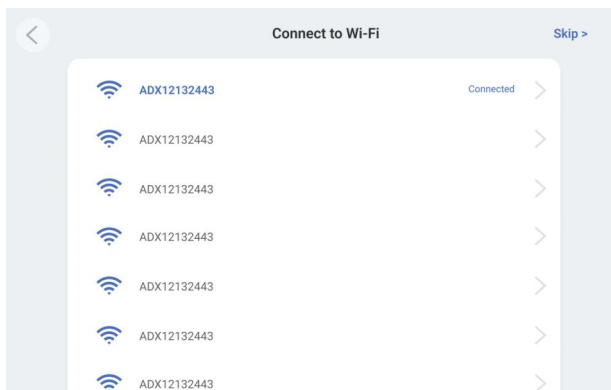

- **Set Time Zone:** Set the time zone to accurately display time information.

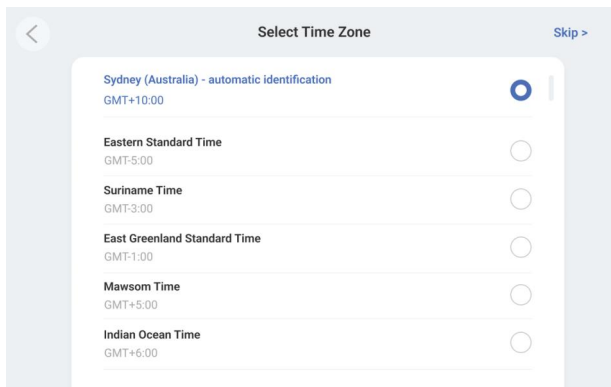

- **Name the device:** For example, "Lily's Family".
- **Set the location of the device:** Such as the living room, kitchen, or office, to facilitate the distinction between different devices. [Note: This step requires an internet connection to complete the operation.](#)

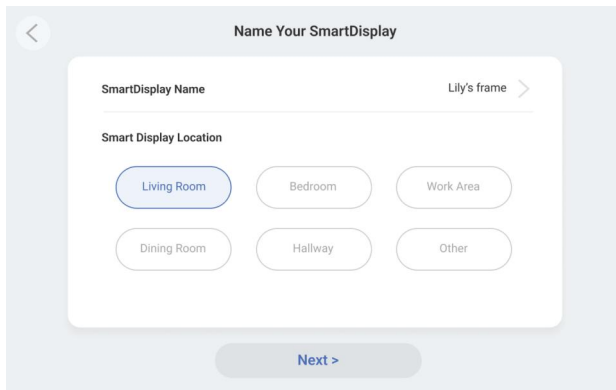

- **Novice Guide:** View the quick guide on the FotoCube Smart Display.

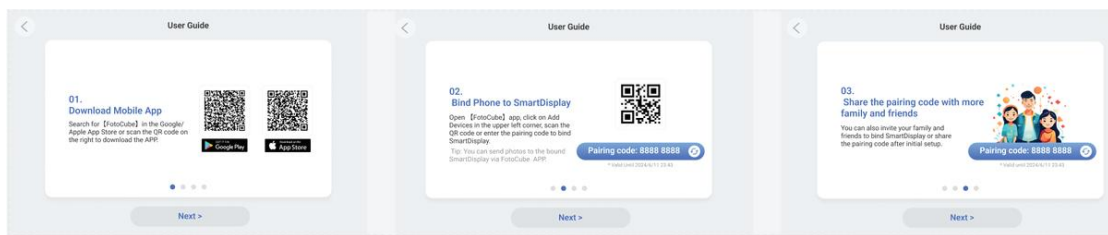

- **Selection Mode:** FotoCube Smart Display supports 3 modes, please select the one you like.
- **Photo Frame:** Send photos or videos from your phone to the device, which will be displayed on the screen in real time, an intelligent album that connects family emotions.
- **Family Calendar:** Share the family task board, easily add and manage the daily to-do items of the whole family, and improve family collaboration efficiency.
- **Art Gallery:** Automatically loop and play world-class artworks, bringing elegant art into your living space.

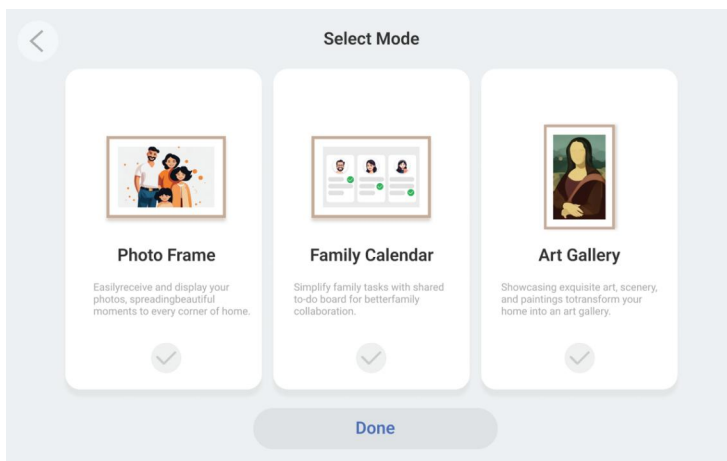

2.2 How to Pair the Smart Display with the FotoCube APP

Make sure your smart display is correctly connected to the Wi-Fi network and your mobile phone has downloaded and installed the FotoCube application.

- **Pairing Code**

Click the "Add" icon on the lower left corner of the screen. A dialog box will appear, displaying the QR code and the pairing code (The pairing code is time-limited, please bind it within the valid period).

- **Share the pairing code**

Now, you can share the QR code or pairing code with your friends via your preferred methods, such as SMS, email, instant messaging, or phone calls.

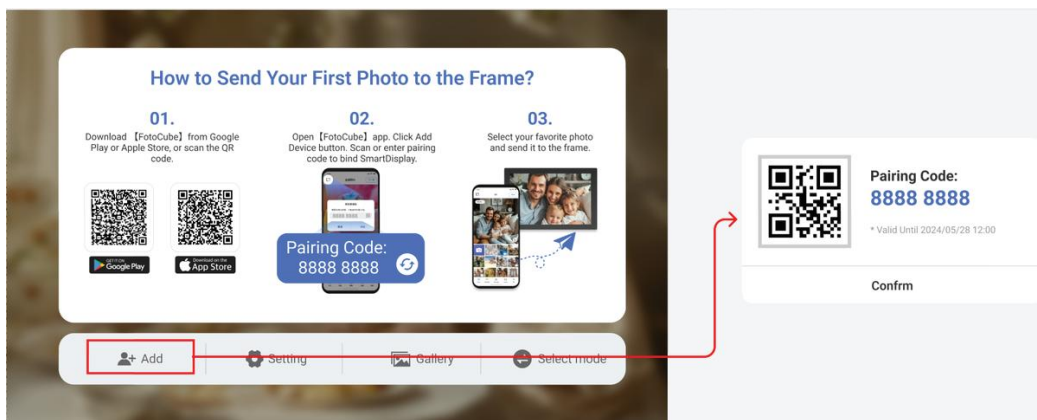

- **Binding the Smart Display with the Mobile App**

Open the FotoCube App, register and log in to your account, then click the "Add Device" button on the upper left corner. Scan the QR code of the device or enter the pairing code to add the device.

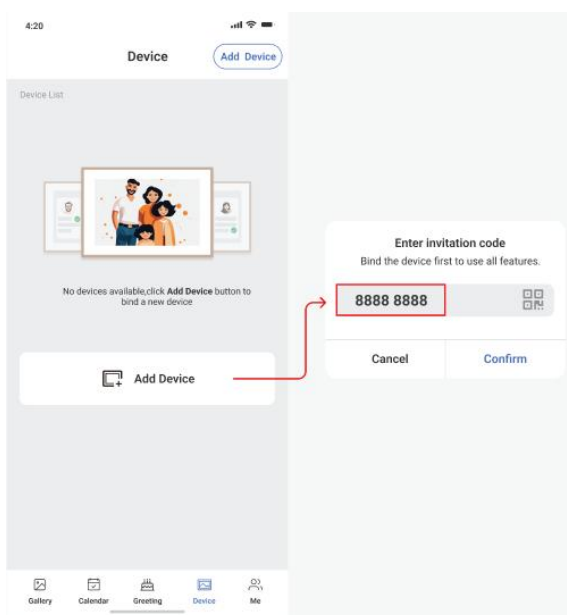

- **Check Connected Devices**

Once the device is connected to your FotoCube APP, you will be able to find them in "Settings - Account Settings" on the device or in the "Devices" tab of the APP.

2.3 How to Use FotoCube Smart Display Offline

- **External Storage (SD Card)**

You can copy photos and videos to the SD card, then insert the SD card into the device and view or play them through "Photo Frame" - "Menu" - "Gallery" - "External SD Card".

2.4 Photo Frame

You can send photos or videos from your mobile phone to the device, which will be displayed on the screen in real time. You can interact with the device simply and conveniently through the touch screen.

2.4.1 Operation

Swipe left or right to view your photos. To access the menu bar, simply click once on the screen, which will display the menu.

2.4.2 Menu

In the menu, you can quickly access functions such as adding friends, settings, gallery, and mode switching. From the menu, you can also make relevant settings for the currently displayed photos, such as using the AI photo processing function, deleting, rotating, setting the playback order, and selecting the slide transition effect, etc.

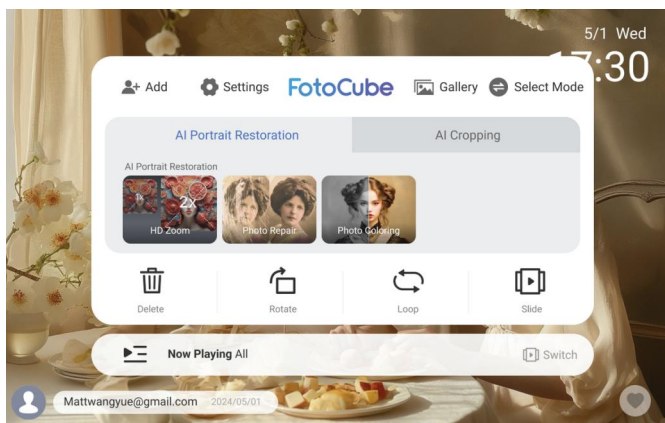

- **Add More Friends**

Click the **【Add】** icon to generate a pairing code and QR code to connect the device. Use either the pairing code or the QR code to connect the Smart Display to your mobile APP, and then you can send photos.

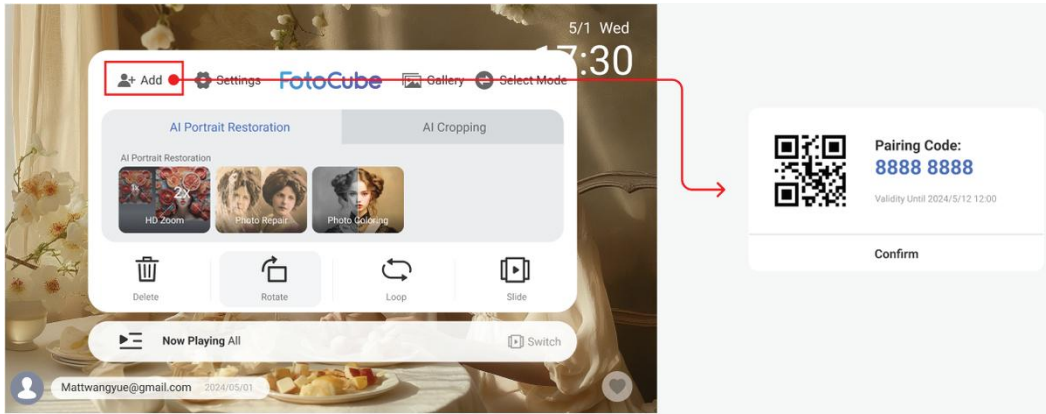

- **Gallery**

Open the gallery and browse the media sources in it.

- You can view the album list created by different accounts and the photos shared in each album.
- You can view the "Like" photos.
- You can start playing photos or videos from the current position of the photo or video you are viewing.
- You can play the album content of a specific account separately.
- You can play photos or videos in the SD card.

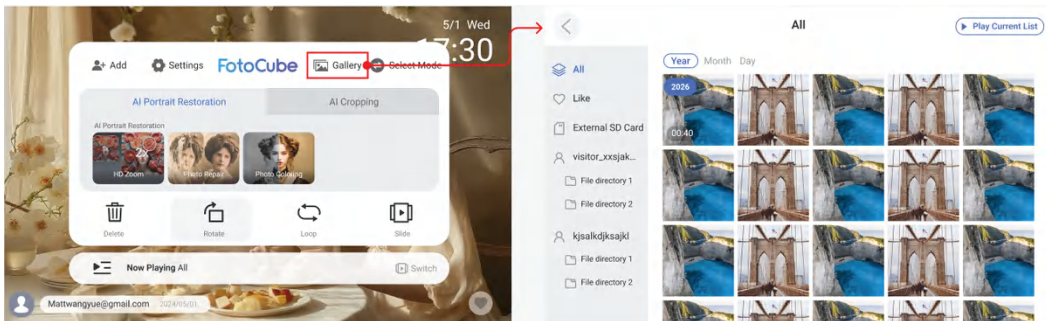

- **Switching Modes**

Three modes are supported: Photo Frame, Family Calendar, or Art Gallery. Select and switch to your favorite mode.

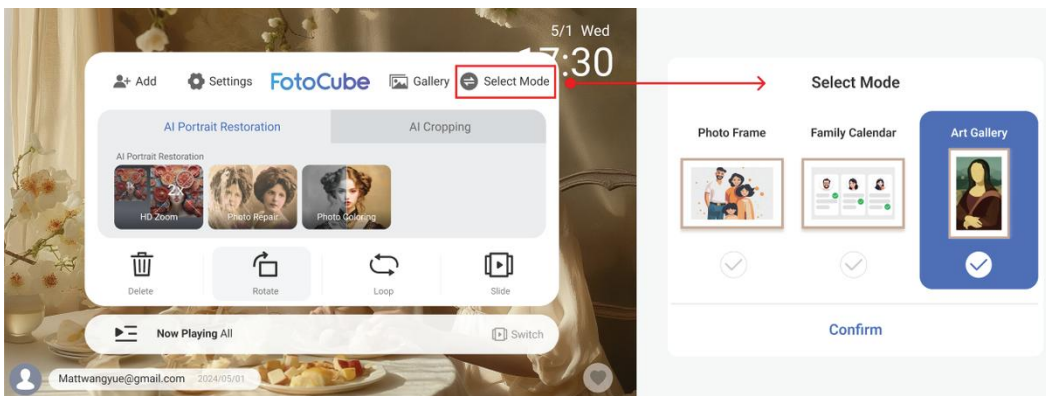

- **Shuffle/Sequential Play**
 - **Shuffle Play:** Play the contents of the current playlist randomly.
 - **Sequential Play:** Play the contents of the current playlist in sequence.
- **AI Portrait Restoration**

AI Portrait function is supported to restore the old portrait photos currently playing (more AI capabilities are continuously updated).

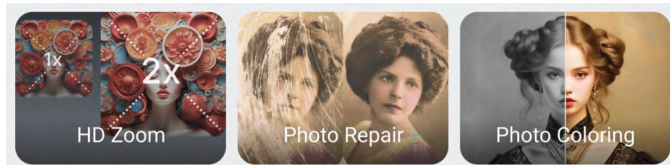

- **Cropping**
- **Full Screen Photo Display**

The cropped photo is displayed in the device in its original proportion.

Click "Menu -> AI Crop -> Display mode -> Full Screen", which supports displaying all photos in full-screen mode.

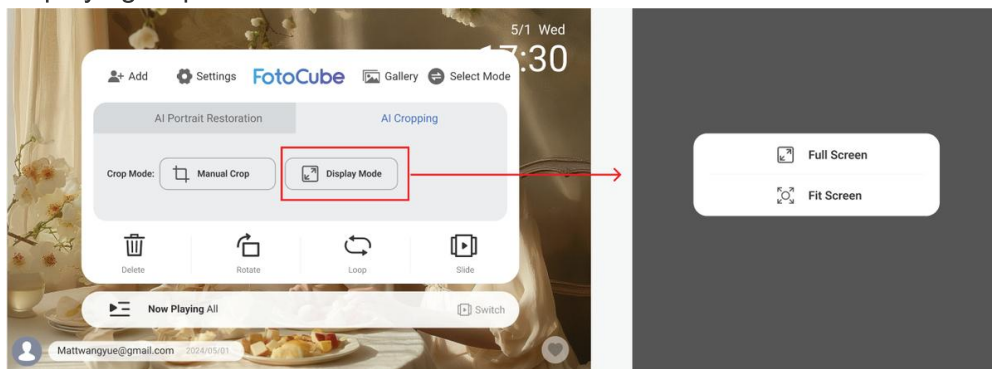

- **Delete**
 - 🗑️ Click the "Delete" button to delete the current photo or video.
- **Rotate Photo**
 - 🔄 You can rotate the photo clockwise by 90, 180, or 270 degrees.
- **Slide Show**
 - 🖼️ Supports multiple slide transition effects, but only valid for photo slides.
- **Like**
 - ❤️ Click the "Like" button on the screen to collect your favorite photos or videos.
- **Volume Settings**
 - For video volume, you can adjust the volume level in "Settings".

2.5 Family Calendar

Share the family task board, easily add and manage the daily to-do items of the whole family, and improve the efficiency of family collaboration.

2.5.1 Calendar

Display the calendar information of the schedule/day/week/month. Also display the current time, date, and the name of the smart display.

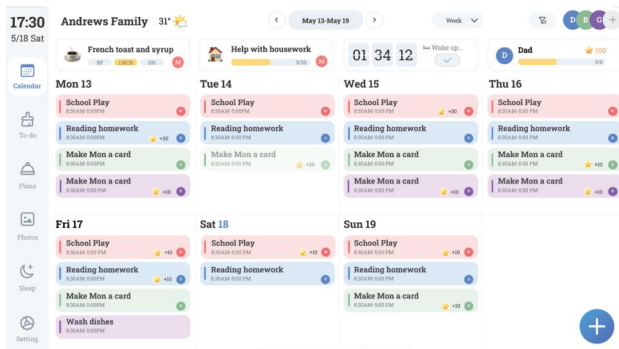

- **New Event**

 **Add Event:** Click the "+" button to create a new event, and it will be synced to the schedule list of all members bound to this smart display via the cloud.

 **Emoji Support:** Content creation supports the inclusion of Emoji expressions, and synchronization of these Emojis is supported between mobile phones and the smart display for consistent display.

- **Edit the Event**

Click on the event to edit or delete the event.

- **Switch Between Schedule/Day/Week/Month Views**

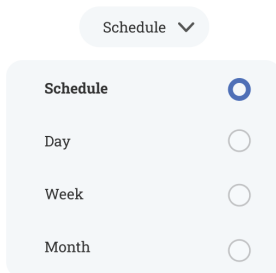

Supports viewing in "Schedule" "Day" "Week" and "Month" views. Click the dropdown menu options to switch view types directly.

If you need to adjust the time range, click the corresponding buttons to switch to the previous/next week or month.

- **Views**

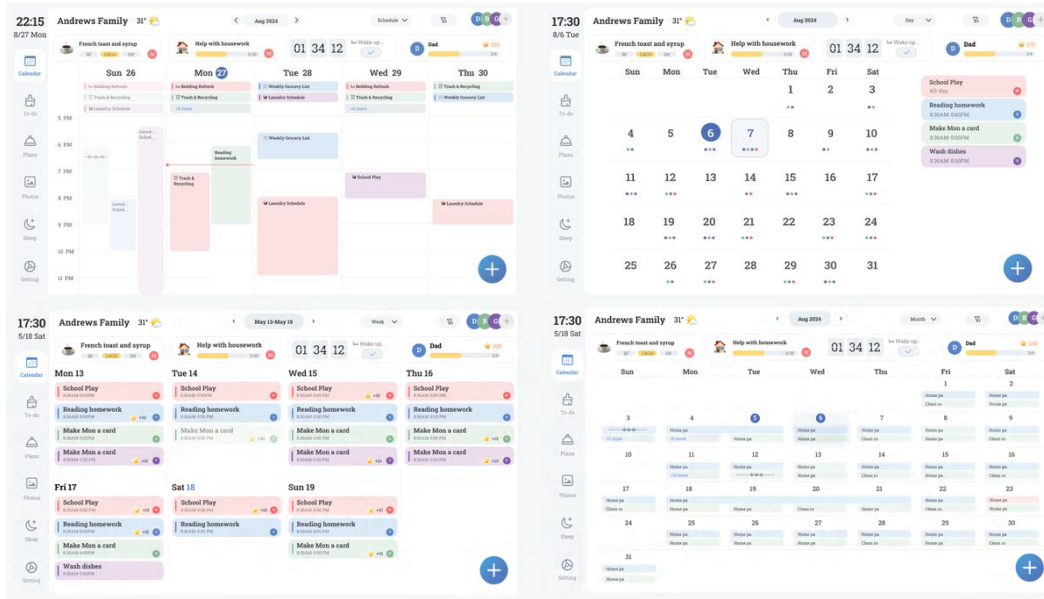

- **Event Reminder**

Expiring events will trigger a pop-up reminder.

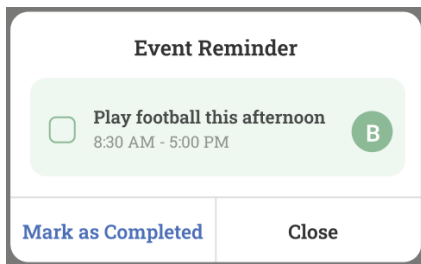

2.5.2 Daily To-Do List

Display the daily To-Do task list by member dimension.



- **Create a To-Do**

Displays the name, time, and person in charge of the to-do item.

- **Edit a To-Do**

Click on the To-Do item to edit the content.



- **Complete a To-Do Task**

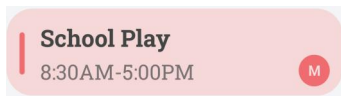

Click the circular button on the left to complete the task.

- **Reminder for Agents**

Expired items will be reminded in the form of pop-up windows.

2.5.3 Import Calendars

- **Calendar Synchronization:**



Google Calendar Real-time Sync

1. Open **FotoCube** -> Click the "**Calendar**" tab at the bottom.
2. Click the "**Import**" button in the top-right corner.
3. Sync with "**Google Calendar**".
4. Log in to your Google Account and authorize consent.
5. Choose between one-way or two-way synchronization.
6. Select the calendar categories you wish to Sync.
7. Complete the calendar synchronization a few minutes later.



Subscribe to iCloud Calendar

1. Open the **Calendar** app on your iPhone.
2. Tap the **Calendars** button at the bottom of the screen.
3. Tap the **info (i) icon** next to the calendar you want to share.
4. Enable **Public Calendar**, then tap **Share Link** and **Copy** the URL.
5. Open **FotoCube** and tap **Calendar** at the bottom.
6. Tap the **Import** button in the top-right corner.
7. Tap the Sync button next to **iCloud Calendar**.
8. Paste the copied URL into the input field and complete the import.



Subscribe to Cozi Calendar

1. Open the **Cozi** app.
2. Tap **Family** at the bottom of the home screen.
3. Tap the **Settings** icon (next to profile picture).
4. Select **Share Cozi Calendars**.
5. Choose to share **All Events** or specific calendars, then tap **View or Send Cozi URL** and copy the link.

6. Open **FotoCube** and tap **Calendar** at the bottom.
7. Tap the **Import** button in the top-right corner.
8. Tap the **Sync** button next to **Cozi Calendar**.
9. Paste the URL into the input field and complete the import.



Subscribe to Yahoo Calendar

1. On a computer, open a browser and go to "calendar.yahoo.com".
2. In the left sidebar, click the More "v" icon next to "**My Calendars**".
3. Select **Edit Calendar**.
4. Toggle on **Get Shareable Link** and copy the **ICS URL** from the bottom of the page.
5. Open **FotoCube** and tap **Calendar** at the bottom.
6. Tap the **Import** button in the top-right corner.
7. Tap the **Sync** button next to **Yahoo Calendar**.
8. Paste the URL into the input field and complete the import.



Subscribe to TeamSnap Calendar

1. On a computer, open a browser and go to "go.teamsnap.com".
2. Click **My Teams** on the left side of the page.
3. From the team homepage, click the **Schedule** tab at the top.
4. Click the **Settings** icon in the upper-right corner, then select **Sync Calendar/Export**.
5. Copy the **Full Calendar** or **Games Only ICS URL**.
6. Open **FotoCube** and tap **Calendar** at the bottom.
7. Tap the **Import** button in the top-right corner.
8. Tap the **Sync** button next to **TeamSnap**.
9. Paste the URL into the input field and complete the import.



Subscribe to Outlook Calendar

1. On a computer, open a browser and go to "outlook.live.com".
2. Sign in to your account, then click the **Settings** icon in the top-right corner.
3. In the left panel, go to **Calendar > Shared calendars**.
4. Under **Publish a calendar**, select the calendar you want to share and copy its **ICS link**.
5. Open **FotoCube** and tap **Calendar** at the bottom.
6. Tap the **Import** button in the top-right corner.
7. Tap the **Sync** button next to **Outlook**.
8. Paste the URL into the input field and complete the import.

- **Import Local Calendar Events from Mobile Devices:**

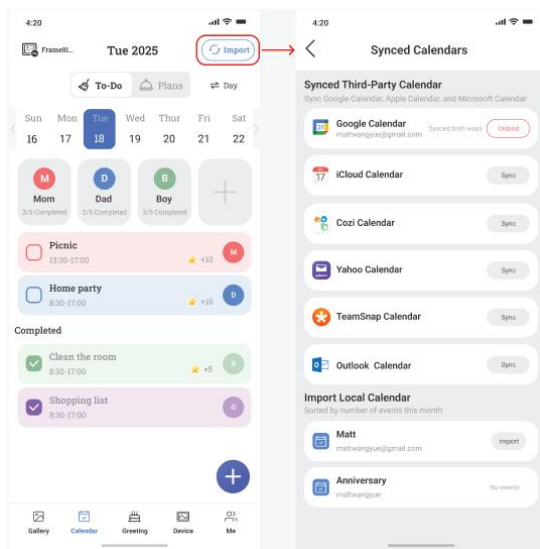

Supports importing local third-party calendar from Google Calendar, Apple Calendar, Microsoft Outlook, and other mobile apps.

- Open **FotoCube** -> After logging in, click the "**Calendar**" tab at the bottom.
- Click the "**Import**" button in the top-right corner.
- Select the local calendar you wish to import.
- The imported calendar information will be synchronized and displayed in the calendar lists of all members.

2.5.4 Member List

Supports adding, deleting, and editing member information.

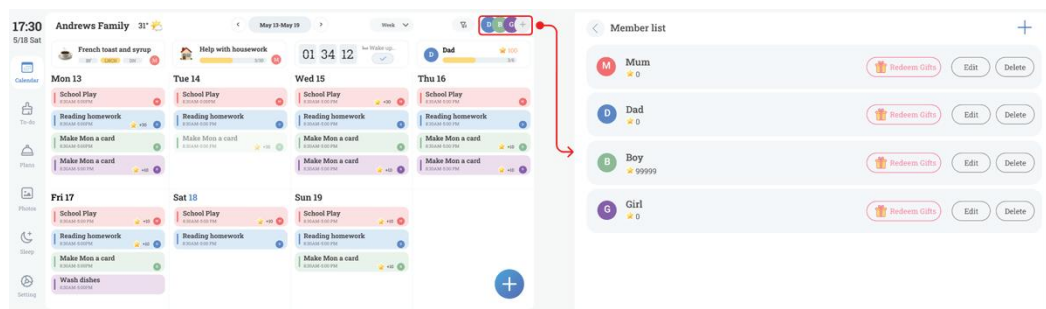

2.5.5 Star Points

- **Add Star Points**

Create general schedules, alarms, cooking events, and all other activities. Set up incentive points for children to encourage the development of good habits. Points will be accumulated once the child completes the assigned tasks.

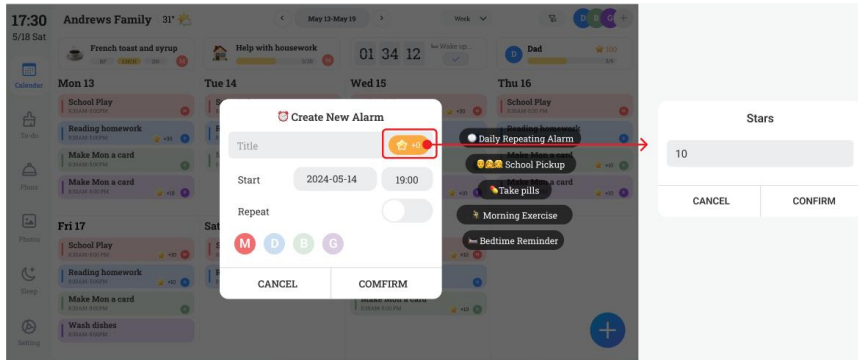

- **Clear Star Points**

In the gift redemption interface, click the "Clear" button in the upper-right corner to clear all Star Points of the user.

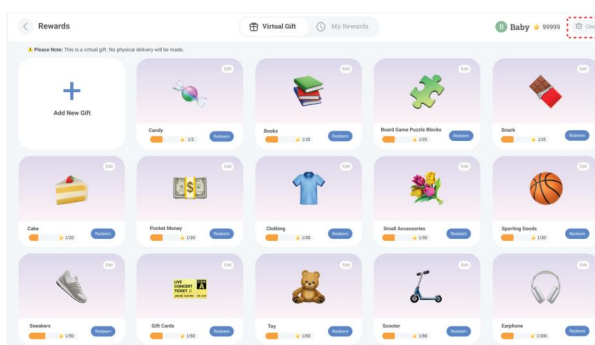

2.5.6 Gift Redemption

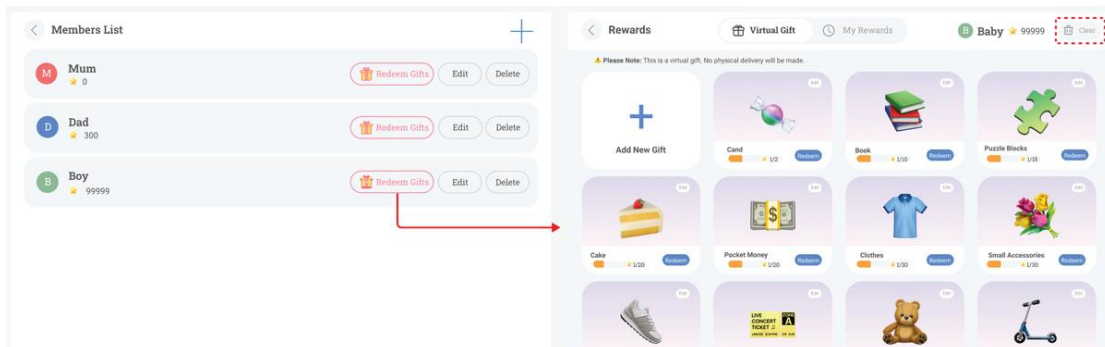

- **Redeem**

Members can earn Star Points by completing tasks and use them to redeem gifts.

Tap the **Member List** button in the top right → select the corresponding member card → tap **Gift Redemption** → choose the gift and quantity you wish to redeem.

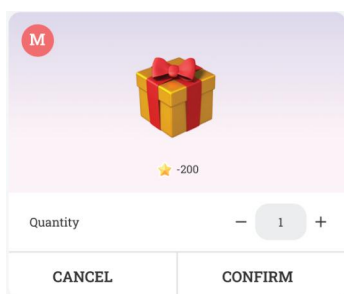

- **Redemption History**

Tap **My Rewards** to view the record of successfully redeemed gifts.

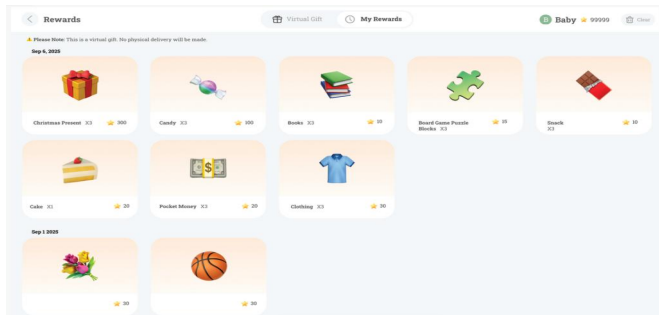

- **Custom Gifts**

Tap **Add New Gift** to customize as follows: 1. Tap the question mark and select an emoji from the input method. 2. Enter the gift name. 3. Add the required number of Star Points.

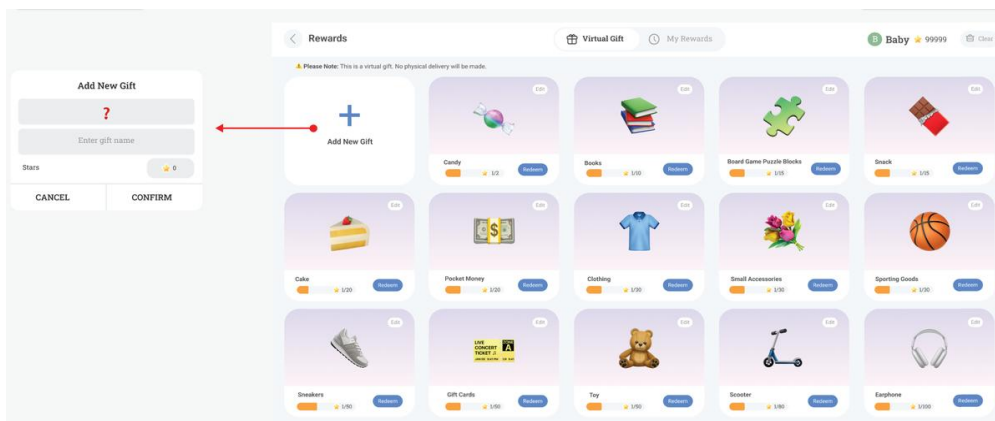

2.5.7 Meal Plan

- **Create a Meal Plan**

Click on the breakfast, lunch, or dinner card to create a corresponding meal plan.

- **View or Edit Recipes**

In the plan creation popup, click "Description" to edit recipe details. To add or view menu images, you must use the mobile app, as this feature is exclusive to mobile devices.

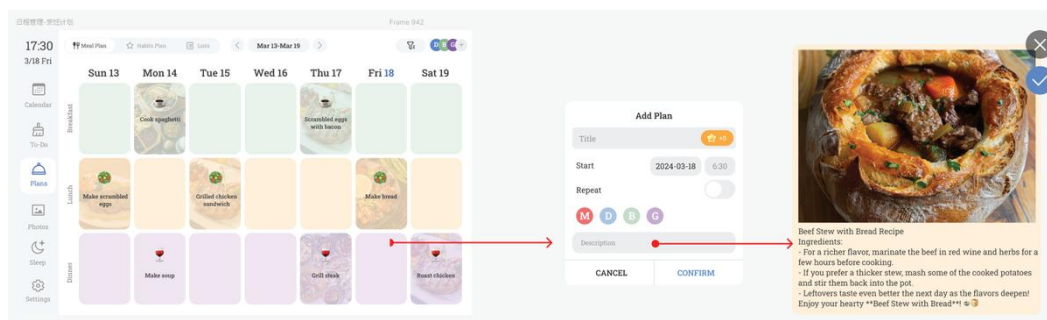

2.5.8 Habit Plan

- **Create a Habit Plan**

Click the “+ Add” button to create a 30-day habit plan. You can customize the title and set member information for the plan.

- **Track Your Habit Progress**

You can view and manage habit tasks in the “Schedule,” “To-Do,” and “Habit Plan” dashboards.

Click to mark a task as “Completed” to record completion of your daily habit goal.

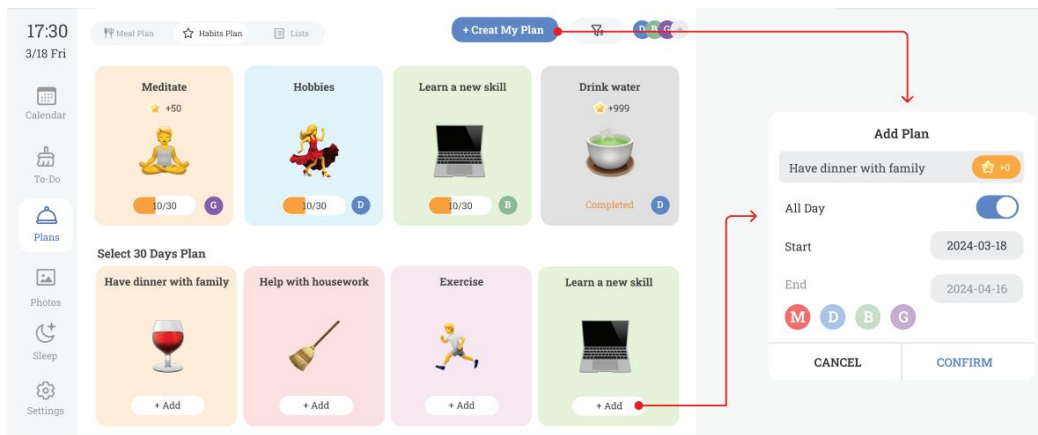

2.5.9 Lists

- **Supports creating multi-scenario checklists (e.g., shopping lists, daily to-do lists). Core features:**

List grouping: Manage tasks through grouping for clearer organization.

Complete/Cancel: Mark tasks as completed and quickly cancel the mark if needed.

Edit/Delete: Modify task content at any time, and delete unnecessary tasks directly.

