

USER MANUAL

CHARGE & GO MAX JMP2500

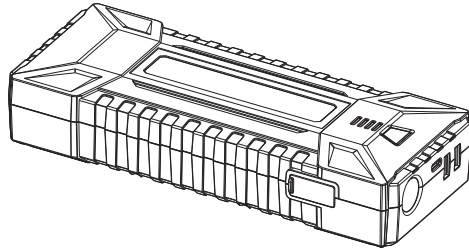

25000mAh

Please read the entire manual before use.

STARTING STATE INDICATOR LIGHT:

Green Light ON: Ready to Jump Start Mode / Connections and circuits are correct and working properly.

Green Light Flashing: Indicates vehicle battery voltage is low. Press the BOOST button and wait until the Green light is solid ON, then turn on the engine within 30 seconds.

Red Light & Alarm ON: Indicates Short Circuit, Over Current - Remove clamps from the unit to recover.

Red / Green Light Flashing: Unit in Protection Mode after 4 continuous attempts to jump. Wait 120 seconds before another attempt. If still unable to jump, DO NOT make additional attempts. Contact your local All Battery Center for assistance.

No Indicator Light ON: Vehicle battery may be damaged.

JUMP STARTER BATTERY INDICATOR:

Press the POWER button to check the battery level of the unit. All lights will be OFF when the level is 0%, charging is paused or completed. 1 Light = 25%, 2 Lights = 50%, 3 Lights = 75%, 4 Lights = 100%

LED FLASHLIGHT MODES:

Press and hold the POWER button for 3 seconds to turn the LED light ON. While ON, press and release the POWER button to cycle through ON, S.O.S, Strobe, and OFF modes.

Thank you for choosing the JMP2500 jump starter. Please read this manual carefully before use and keep for future reference.



SAFETY & MAINTENANCE

- This unit is designed to jump start 12V vehicle batteries. Do not use on 6V or 24V batteries. If the vehicle does not start immediately, wait for 1 minute to allow the unit to cool before trying again. To avoid damage to the starter motor, visit an Interstate All Battery Center for a battery test, if it does not start after five attempts.
- Do not open this unit. Opening the unit may break or damage components and will void the warranty.
- Do not place the unit in a high intensity magnetic field. This may damage components that may cause the unit to fail.
- The unit is not water proof. Do not use in wet conditions. Water may short-circuit the unit and may cause excessive heat, product deformation, damage or explosion.
- Not to be used by children.
- Recharge the unit every 3-6 months for best performance (even if the unit has not been used). This will extend the life of the battery.



SAFETY & MAINTENANCE

- Do not throw unit into fire.
- Use only the provided smart clamps and AC charger provided with the unit.
- Once product life is complete, please recycle as a rechargeable lithium battery in accordance with local regulations.
- This unit is to be used in emergency situations to jump start a vehicle. It is not to be used in place of the vehicle battery.
- When in use, do not allow the positive and negative clamps to touch. This may result in sparking, short circuit and may compromise safety.
- When a vehicle battery is less than 3 volts the unit's jump start capabilities will be disabled.
- The unit may get hot while charging. This is normal. Use caution when handling. Disconnect the unit when fully charged.
- Before using the product to jump start a vehicle, turn off all electric equipment on the vehicle (lights, air conditioning, navigation, etc.).

PRODUCT DESCRIPTION

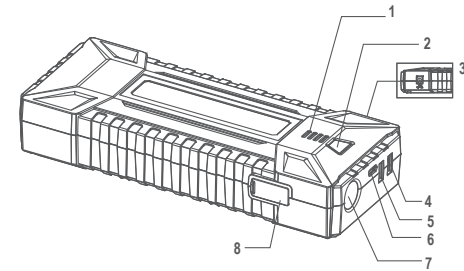

1. Indicator
2. Switch
3. 15V 10A output port
4. USBV 2.4A output port
5. Quick Charge output port
6. USB-C input/output port
7. LED Flash Light
8. Jump start socket

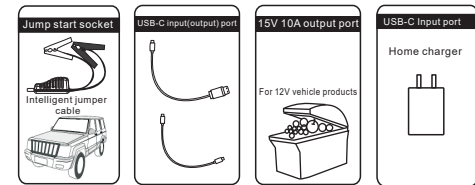

STARTING STATE INDICATOR LIGHT:

Green Light ON: Ready to Jump Start Mode / Connections and circuits are correct and working properly.

Green Light Flashing: Indicates vehicle battery voltage is low. Press the BOOST button and wait until the Green light is solid ON, then turn on the engine within 30 seconds.

Red Light & Alarm ON: Indicates Short Circuit, Over Current - Remove clamps from the unit to recover.

Red / Green Light Flashing: Unit in Protection Mode after 4 continuous attempts to jump. Wait 120 seconds before another attempt. If still unable to jump, DO NOT make additional attempts. Contact your local All Battery Center for assistance.

No Indicator Light ON: Vehicle battery may be damaged.

JUMP STARTER BATTERY INDICATOR:

Press the POWER button to check the battery level of the unit. All lights will be OFF when the level is 0%, charging is paused or completed. 1 Light = 25%, 2 Lights = 50%, 3 Lights = 75%, 4 Lights = 100%

LED FLASHLIGHT MODES:

Press and hold the POWER button for 3 seconds to turn the LED light ON. While ON, press and release the POWER button to cycle through ON, S.O.S, Strobe, and OFF modes.

JUMP STARTING A VEHICLE

1. Connect the red battery clamp to the positive (+) battery terminal and the black battery clamp to the negative (-) battery terminal.

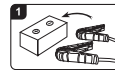

2. Connect the jump starter Smart Clamps to the EC5 port on the unit. After correct connection, the green starting state indicator light will be ON. If the starting state indicator light is not showing solid green, please reference the previous section to diagnose. Notice, the green light should be solid and not flashing.



3. Attempt to start vehicle. Once the engine has started, first disconnect the Smart Clamps from the jump starter unit and second, disconnect the Smart Clamps from the vehicle battery.

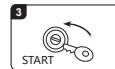

If starting is unsuccessful, wait one minute and repeat steps 1, 2, and 3.

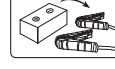
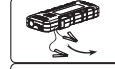

NOTE: Remove the product from the vehicle within 30 seconds of jump starting. If not, it could lead to damage.

RECHARGING THE UNIT

To charge the jump starter, use the included AC adapter and USC-C charge cable. Only use the chargers provided with this unit. In order to fully recharge the unit, please allow for 8-9 hours of charge time on the provided AC charger adapter.

To extend battery life, charge the unit every 3-6 months.

Disconnect unit when fully charged.

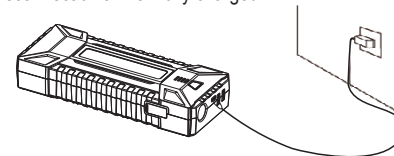

CHARGING ELECTRONIC DEVICES

To charge electronic devices, plug in the 3-in-1 USB cable into the USB output port. Connect the cable to your device and press the POWER button on the unit.

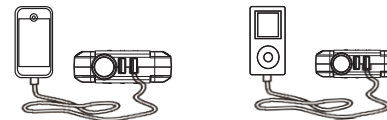

TECHNICAL SPECIFICATIONS

Capacity	25000mAh, 92.5Wh
Dimensions(L,W,H)	8.19 x 3.52 x 1.72in (224 x 89.6 x 43.8mm)
Weight	1.709lb (775g)
Built-In Battery	High Rate Discharge Lithium Polymer Batteries
Input Recharging	USB-C 15W (5V/3A)
Fully Charged Time	8-9 hours
EC5 Output	Supports 12V Battery System Vehicle
Output	Quick Charge USB: 5V/2.4A; 5V/2.4A, Type-C 15W (5V/3A)
Bulb Type	Ultra Bright LED Flashlight/SOS/Strobe
Starting / Peak Amps	600A / 1500A
Operation Temperature Range	-4°F to 140°F (-20°C to 60°C)
Lifecycle	>500 times
Safety Technology	MultiSafety Protection
Package Includes	1 x Jump Starter 1 x AC Power Adapter 1 x 3-in-1 Charging Cable 1 x USB-C Charging Cable 1 x Smart Clamps 1 x User Manual



All rights reserved. Reproduction in whole or in part without written permission is prohibited. All other trademarks are trademarks of their respective owners. Features and specifications are subject to change without notice.

866.842.5368

CustomerService@interstatebatteries.com

Distributed by Retail Acquisition and Development, Inc.
Urbandale, IA 50323

©2022 Interstate Batteries

MADE IN CHINA

