



RAXIAL

INLINE BOOSTER FAN

USER MANUAL

WELCOME

Thank you for choosing AC Infinity. We are committed to product quality and friendly customer service. If you have any questions or suggestions, please don't hesitate to [contact](#) us. Visit www.acinfinity.com and click contact for our contact information.

EMAIL

support@acinfinity.com

WEB

www.acinfinity.com

LOCATION

Los Angeles, CA

MANUAL CODE RA1909X1

PRODUCT

RAXIAL S4

RAXIAL S6

RAXIAL S8

MODEL

AC-RXS4

AC-RXS6

AC-RXS8

UPC-A

819137021105

819137021112

819137021129

MANUAL INDEX

Manual Index	Page 5
Warning	Page 6
Key Features	Page 7
Product Contents	Page 8
Mounting	Page 9
Programming	Page 13
Other AC Infinity Products	Page 14
Warranty	Page 15

WARNING

DO NOT use this fan to exhaust hazardous or explosive materials and vapors. Do not use to exhaust air filled with lint, grease, or oil.

DO NOT let children and pets near this product when it is in operation.

DO NOT handle or install this fan while it is running; it has an unguarded impeller and has an unguarded impeller and does NOT come with a fan guard. This fan also has sharp edges and may cause bodily harm.

NEVER use a rheostat or a light dimmer switch to control the fan speed. Always use this fan with the included speed controller.

This fan is intended to be installed with both ends connected to ducting, and is designed to only boost dry (ambient) heated or cooled airflow in HVAC systems with temperatures between 40°F and 140°F (4°C-60°C). NEVER expose this fan to temperatures over 140°F (60°C).

This fan cannot be used with a carbon filter. Improper use of this fan may result in electrical shock, fires, serious injuries or death. Disconnect and/or lockout all remote electric power supplies before servicing or installing this fan.

GENERAL NOTES

To achieve greater boosted airflow, you may use tapered reducers that allow you to install larger diameter duct fans in smaller diameter ducts.

Regularly clean your duct booster fan at least twice a year. This will keep your fan clear of lint, dust, and debris and running optimally. Install your duct booster fan in an accessible area.

KEY FEATURES

STEEL CONSTRUCTION

Cylindrical shell made of steel and powder-coated for a smooth black finish. Fan built with five balanced steel blades.

AC VOLTAGE

Directly powered by any US household outlet without the use of an adapter. Rated between 100-125V AC.

SPEED CONTROLLER

Utilizes a knob to increase or decrease the fan speed, adjusting the airflow and noise level for various applications.

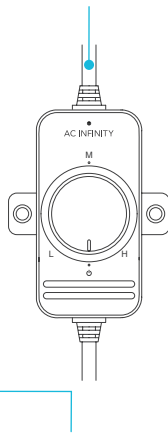
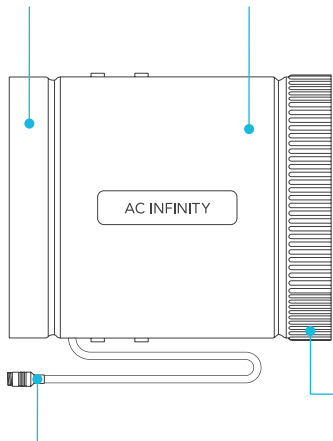

RETAINER LOCK

Includes a twist lock mechanism that tightly secures connections and prevents moisture from leaking inside.

BALL BEARINGS

Permanently lubricated for a long-lasting fan that runs quietly with no maintenance required. Engineered for maximum boost.

EASY INSTALLATION

Portable, lightweight body with a crimped flange that is grooved on both sides for ease of installation and a complete seal on ducting.

PRODUCT CONTENTS

S-SERIES

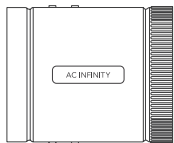

AC DUCT
FAN SYSTEM
(x1)

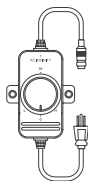

SPEED
CONTROLLER
(x1)



CONTROLLER
SCREW SET
(x2)

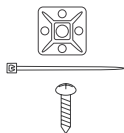

WIRE
TIES SET
(x1)

MOUNTING

STEP 1

Locate a spot in your ducting route where you want to install the duct booster fan.

We recommend placing it 6-10 feet from your register for maximum performance and minimum noise.

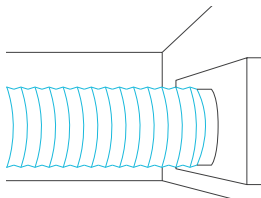

STEP 2

Cut your ducting as needed. Slide your ducting over the duct booster fan on both ends.

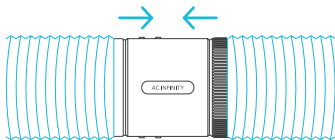

MOUNTING

STEP 3

Secure them using duct tape or clamps (sold separately). Make sure the duct booster fan is well supported.

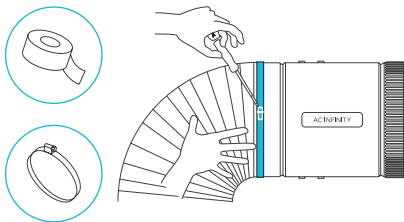

STEP 4

If the fan is installed off the ground, loop a pair of rope clip hangers (sold separately) around the duct booster fan.

Route the rope end carabiner under the fan and over a mounting bar. Link it to the ratchet end carabiner. Press the tab on the ratchet to extend the rope as needed.

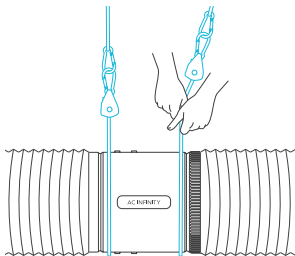

MOUNTING

STEP 5

Before connecting the fan to the speed controller, identify the **arrows** and **notches** on their aviation ports.

Line up the arrows and notches to connect the two aviation ports.

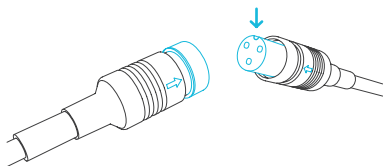

STEP 6

Twist lock the female aviation port's retainer to secure the connection.

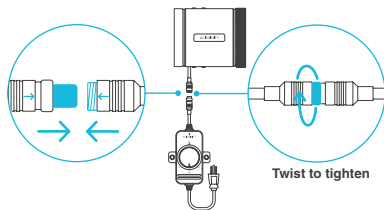

MOUNTING

STEP 7

You may use the included wire tie set to cable manage the cords.

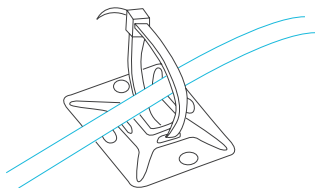

STEP 8

Plug the speed controller into an open outlet to power the duct booster fan.

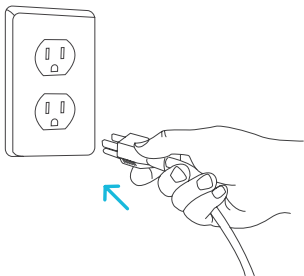

PROGRAMMING

LIGHT INDICATOR

When the controller is turned on and receiving power, the LED at the top of the controller will light up to show it is on.

ON

Turn the knob clockwise until you hear and feel a click to turn on the fan.

OFF

Turn the knob counterclockwise from ON until you hear and feel a click to turn off the fan.

SPEED CONTROL

Turning the knob will gradually adjust the fan speed between low, medium, and high.

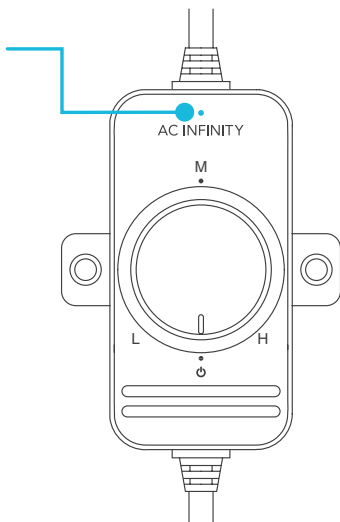

AC INFINITY PRODUCTS

Duct Fans

The CLOUDLINE series is a line of duct fans designed to quietly ventilate AV rooms and closets, as well as various DIY air circulation and exhaust projects. Features a thermal controller with intelligent programming that will automatically adjust duct fan speeds in response to changing temperatures.



Duct Filters

The duct carbon filter is designed to eliminate odors and chemicals for grow tents and hydroponic spaces. It utilizes premium grade Australian charcoal that features greater absorption power and a longer lifespan. Enables maximum airflow pass through as part of an intake or an exhaust system.

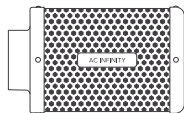

Duct Accessories

The four-layer ducting tube is used to direct airflow, designed for ventilation systems in applications like HVAC, dryers, and grow rooms. It is highly durable and flexible, and can be used anywhere from tight spaces to wide open areas.

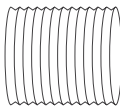

The rope hanger is designed to hang various ventilation equipment, such as fans and filters. It features zinc-plated steel carabiners and braided polypropylene rope that can hold up to 150 pounds per pair. The ratchet mechanism to adjust the rope's length.

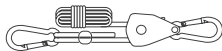

The duct clamp is designed to secure ducting components to various ventilation fans. It is built with heavy-duty stainless steel and a worm drive lock that stays tightly fastened. Each clamp is finished with a corrosion-resistant gloss and is rustproof.



Discover the latest innovations in cooling and ventilation at acinfinity.com

WARRANTY

This warranty program is our commitment to you, the product sold by AC Infinity will be free from defects in manufacturing for a period of two years from the date of purchase. If a product is found to have a defect in material or workmanship, we will take the appropriate actions defined in this warranty to resolve any issues.

The warranty program applies to any order, purchase, receipt, or use of any products sold by AC Infinity or our authorized dealerships. The program covers products that have become defective, malfunctioned, or expressively if the product becomes unusable. The warranty program goes into effect on the date of purchase. The program will expire two years from the date of purchase. If your product becomes defective during that period, AC Infinity will replace your product with a new one or issue you a full refund.

The warranty program does not cover abuse or misuse. This includes physical damage, submersion of the product in water, incorrect installation such as wrong voltage input, and misuse for any reason other than intended purposes. AC Infinity is not responsible for consequential loss or incidental damages of any nature caused by the product. We will not warrant damage from normal wear such as scratches and dings.

For more information about our dealers and distributors, please contact our customer service at support@acinfinity.com or (626) 923-6399 Monday to Friday (9:00 am to 5:00 pm PST).



If you run into any issues with this product, contact us and we'll happily issue a replacement or a full refund!

COPYRIGHT © 2020 AC INFINITY INC. ALL RIGHTS RESERVED

No part of the materials including graphics or logos available in this booklet may be copied, photocopied, reproduced, translated or reduced to any electronic medium or machine readable form, in whole or in part, without specific permission from AC Infinity Inc.

www.acinfinity.com