

Body-Solid®

Built for Life

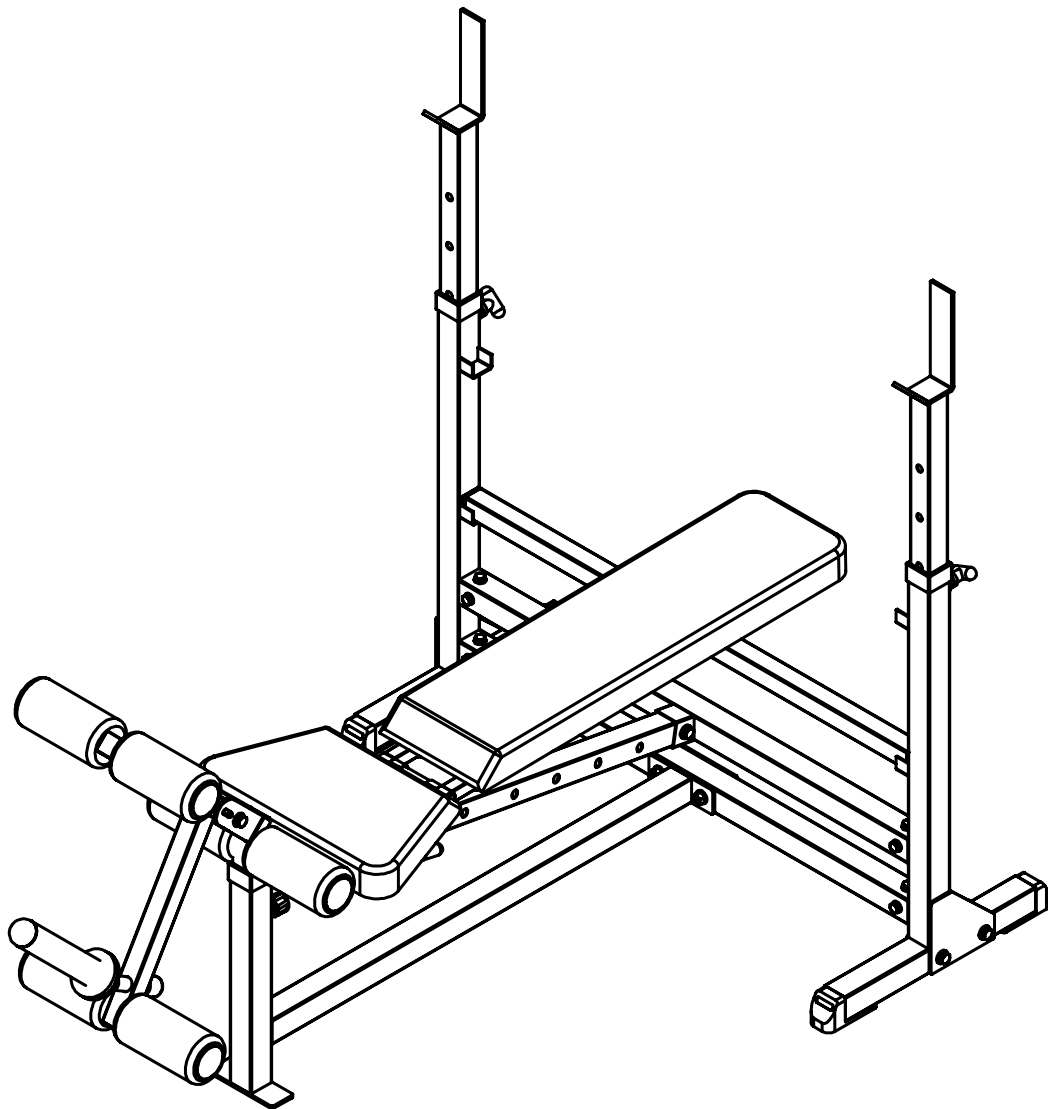

GDIB46LB

Assembly Instructions

OWNER'S & MANUAL

V. GDIB46LB-20240408

Warning, Safety & Maintenance

Be sure that all users carefully read and understand all warning, safety and maintenance labels on the machine before each use. Failure to do so may result in death or serious injury.

It is imperative that you retain this Owner's Manual and be sure all warning labels are legible and intact. Replacement Owner's Manuals and warning labels are available from your local Body-Solid dealer.

If you have any questions about the operation, set up or maintenance of this machine please call our customer service department at 1 (800) 556-3113.

THERE IS A RISK ASSUMED BY INDIVIDUALS WHO USE THIS TYPE OF EQUIPMENT. TO MINIMIZE RISK, YOU MUST FOLLOW THESE RULES:

1. Inspect equipment before each workout. Check that all nuts, bolts, screws and pop pins are in place and fully tightened. Also, before use, check cables for signs of wear. Replace all worn parts immediately. Never use machine if any parts are damaged or missing. **FAILURE TO FOLLOW THESE RULES MAY RESULT IN SERIOUS INJURY.**
2. Keep clear of the cables and all moving parts when the machine is in use.
3. Always make sure all Snap Links are closed when doing any cable/pulley/strap exercises.
4. Exercise with care. Perform your exercises at a smooth moderate pace; never perform jerky or uncoordinated movements that may cause injury.
5. It is recommended that you should workout with a training partner.
6. Do not allow children or minors to play on or around this equipment.
7. If unsure of proper use of equipment, call your local Body-Solid distributor or the Body-Solid customer service department at 1-800-556-3113.
8. **WARNING:** Consult your physician before starting your exercise program. For your own safety, do not begin any exercise program without proper instruction. RAL8-6-03 WC-54

MAINTENANCE SCHEDULE		D A I L Y	W E E K L Y
Check the function and integrity of the following components. As noted, inspect equipment before each workout. Replace all damaged, broken or worn components immediately.			
Cables:	Check tension, end fittings, and coating	✓	
	Check that locking nut at weight stack is tight		✓
Upholstery:	Wipe down and dry	✓	
	Clean and condition		✓
Frame:	Wipe down and dry	✓	
	Polish / Wax		✓
Chrome:	Wipe down and dry	✓	
	Polish / Lubricate		✓
Nuts / Bolts / Fasteners:	Tighten and / or adjust as needed		✓
Guide Rods:	Lubricate and clean		✓
Linear Rods:	Lubricate and clean		✓
Seat Sleeves:	Lubricate and clean		✓
Adjustments / Locking Pins / Tightening Knobs			✓
Weight Stack Pins			✓
Warning Instruction Labels			✓
Springs / Pop Pins		✓	
Anti Skid Surfaces			✓
Hand Grips / Rollers			✓

For Body-Solid Customer Service
Call 1-800-556-3113
 #MSSTKR0803



Table of Contents

- SAFETY INSTRUCTIONS..... PAGE 4
- PREPARATION..... PAGE 5
- HARDWARE ILLUSTRATION..... PAGE 6
- PART / HARDWARE LIST..... PAGE 10
- ASSEMBLY INSTRUCTIONS..... PAGE 12
- EXPLODED VIEW..... PAGE 21
- CONTACT PAGE..... PAGE 22

Important Safety Instructions

Before beginning any fitness program, you should obtain a complete physical examination from your physician.

*Il est conseillé de subir un examen médical complet avant d'entreprendre tout programme d'exercice.
Si vous avez des étourdissements ou des faiblesses, arrêtez les exercices immédiatement.*

Antes de comenzar cualquier programa de ejercicios, deberías tener un examen físico con su doctor.

When using exercise equipment, you should always take basic precautions, including the following:

- Read all instructions before using the **GDIB46LB**. These instructions are written to ensure your safety and to protect the unit.
- **Do not remove any safety labels from the machine.**
- Do not allow children on or near the equipment.
- Use the equipment only for its intended purpose as described in this guide. Do not use accessory attachments that are not recommended by the manufacturer. Such attachments might cause injuries.
- Wear proper exercise clothing and shoes for your workout, no loose clothing.
- Keep hands, limbs, loose clothing, and long hair well out of the way of all moving parts.
- Use care when getting on or off the unit.
- Do not overexert yourself or work to exhaustion.
- If you feel any pain or abnormal symptoms, stop your workout immediately and consult your physician.
- Never operate unit when it has been dropped or damaged. Return the equipment to a service center for examination and repair.
- Never drop or insert objects into any opening in the equipment.
- Always check the unit and its cables before each use. Make sure that all fasteners and cables are secure and in good working condition.
- Do not use the equipment outdoors or near water.

Personal Safety During Assembly

- Before beginning assembly, please take the time to read the instructions thoroughly.
- Read each step in the assembly instructions and follow the steps in sequence. Do not skip ahead. If you skip ahead, you may learn later that you have to disassemble components and that you may have damaged the equipment.
- Assemble and operate the **GDIB46LB** on a solid, level surface. Locate the unit a few feet from the walls or furniture to provide easy access.

The **GDIB46LB** is designed for your enjoyment. By following these precautions and using common sense, you will have many safe and pleasurable hours of healthful exercise with your Body-Solid F//D Olympic Bench with Leg Developer.

After assembly, you should check all functions to ensure correct operation. If you experience problems, first recheck the assembly instructions to locate any possible errors made during assembly. If you are unable to correct the problem, call the dealer from whom you purchased the machine or call **1-800-556-3113** for the dealer nearest you.

Obtaining Service

Please use this Owner's Manual to make sure that all parts have been included in your shipment. When ordering parts, you must use the part number and description from this Owner's Manual. Use only Body-Solid replacement parts when servicing this machine. Failure to do so will void your warranty and could result in personal injury.

For information about product operation or service, check out the official Body-Solid website at www.bodysolid.com or contact an authorized Body-Solid dealer or a Body-Solid factory-authorized service company or contact Body-Solid customer service at one of the following:

Toll Free: 1-800-556-3113
Phone: 1-708-427-3555
Fax: 1-708-427-3556
Hours: M-F 8:30-5:00 CST
E-Mail: service@bodysolid.com

**Or write to: Body-Solid, Inc.
Service Department
1900 S. Des Plaines Ave.
Forest Park, IL 60130 USA**

Retain this Owner's Manual for future reference. If you need to order replacement parts please be prepared to provide the following information when contacting us so that we can assist you better.

- 1. Model Number**
- 2. Place of Purchase**
- 3. Serial Number (S/N)**
- 4. Part # and Description**

Preparation

Thank you for purchasing the **GDIB46LB**. This Product is part of the Body-Solid line of quality strength training machines, which lets you target specific muscle groups to achieve better muscle tone and overall body conditioning. To maximize your use of the equipment please study this Owner's Manual thoroughly.

Required Tools

The basic tools that you must obtain before assembling the **GDIB46LB** include but are not limited to:

- Standard Wrench Set
- Metric Wrench Set
- Adjustable Wrench

Installation Requirements

Follow these installation requirements when assembling the **GDIB46LB**:

Set up the **GDIB46LB** on a solid, flat surface. A smooth, flat surface under the machine helps keep it level. A level machine has fewer malfunctions.

Provide ample space around the machine. Open space around the machine allows for easier access.

Insert all bolts in the same direction. For aesthetic purposes, insert all bolts in the same direction unless specified (in text or illustrations) to do otherwise.

Leave room for adjustments. Tighten fasteners such as bolts, nuts, and screws so the unit is stable, but leave room for adjustments. Do not fully tighten fasteners until instructed in the assembly steps to do so.

Fill out and mail the warranty card.

Assembly Tips

Read all "Notes" on each page before beginning each step.

While you may be able to assemble the **GDIB46LB** using the illustrations only, important safety notes and other tips are included in the text.

Some pieces may have extra holes that you will not use. Use only those holes indicated in the instructions and illustrations.

NOTE: With so many assembled parts, proper alignment and adjustment is critical. While tightening the nuts and bolts, be sure to leave room for adjustments.

CAUTION: Obtain assistance! If you feel like you can't assemble the **GDIB46LB** by yourself then do not attempt to do so as this could result in injury. Review the installation requirements before proceeding with the following steps.

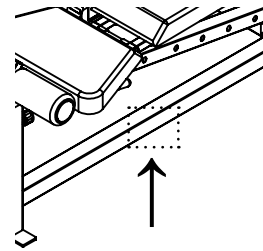

Your S/N# can
be found here

Body-Solid continually seeks ways to improve the performance, specifications and product manuals in order to ensure that only superior products are released from our factories. Please take the time to carefully read through this manual thoroughly. Instructions contained in this document are not intended to cover all details or variations possible with Body-Solid equipment, or to cover every contingency that may be met in conjunction with installation, operation, maintenance or troubleshooting of the equipment. Even though we have prepared this manual with extreme care, neither the publisher nor the author can accept responsibility for any errors in, or omission from, the information given. Should additional information be required, or should situations arise that are not covered by this manual, the matter should be directed to your local Body-Solid representative, or the Service Department at Body-Solid Inc. in Forest Park, Illinois.

G D I B 4 6 L B Hardware Illustration

Part #1

M12x85mm HEX HEAD BOLT

QTY. 1

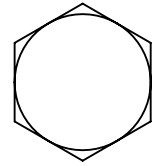
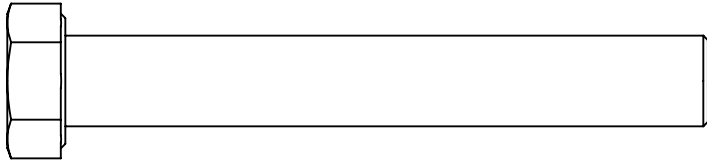

Part #2

M12x75mm HEX HEAD BOLT

QTY. 6

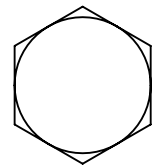
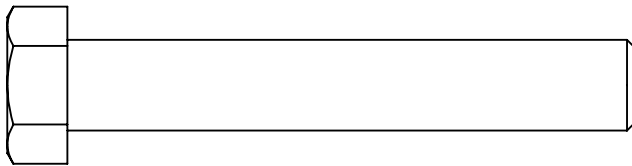

Part #3

M12x70mm HEX HEAD BOLT

QTY. 1

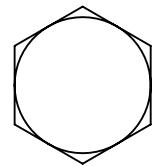
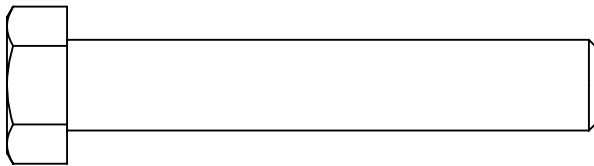

Part #4

M10x20mm HEX HEAD BOLT

QTY. 12

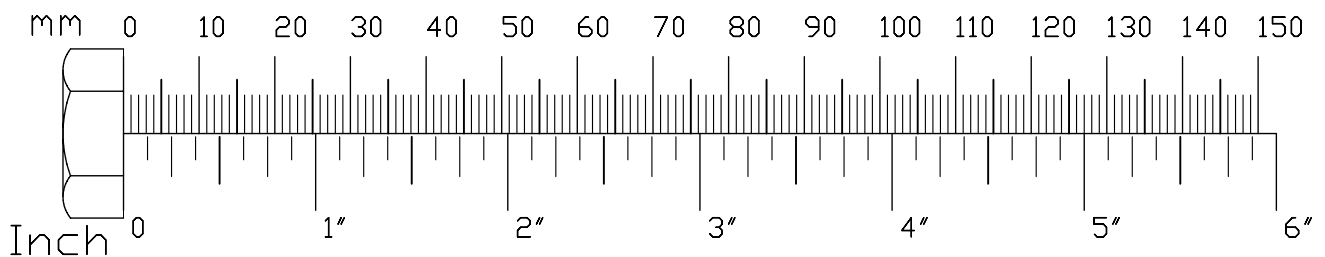
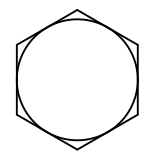
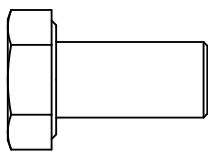

G D I B 4 6 L B Hardware Illustration

Part #5

M10x20mm BUTTON HEAD CAP SCREW

QTY. 1

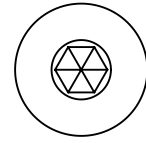
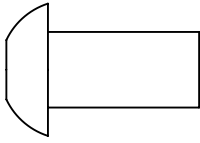

Part #6

M8x40mm HEX HEAD BOLT

QTY. 10

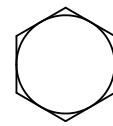
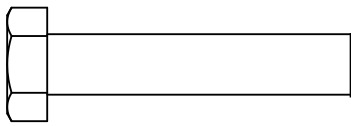

Part #7

M12 FLAT WASHER

QTY. 16

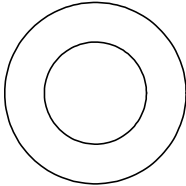

Part #8

M10 FLAT WASHER

QTY. 12

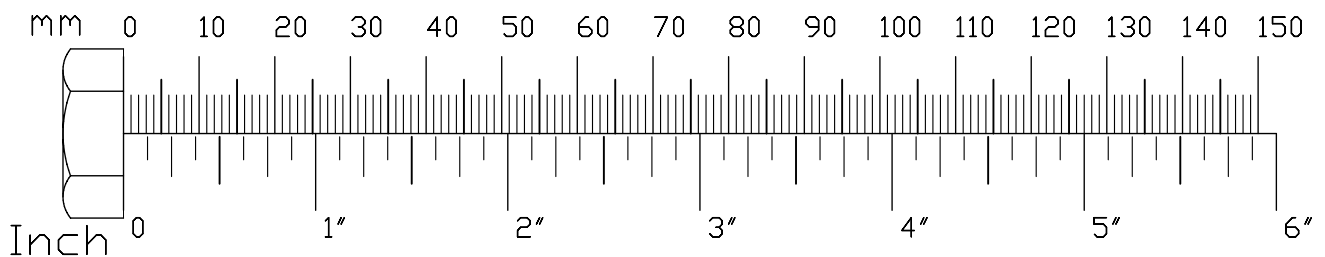
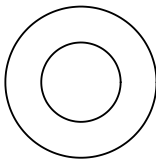

GDIB46LB Hardware Illustration

Part #9

M10 LOCK WASHER

QTY. 1

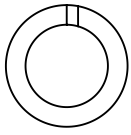

Part #10

M10 LARGE WASHER

QTY. 1

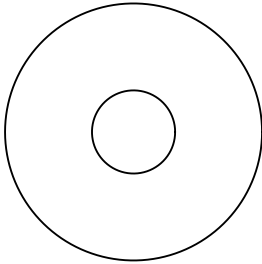

Part #11

M8 FLAT WASHER

QTY. 10

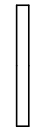
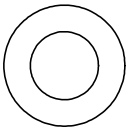

Part #12

M8 LOCK WASHER

QTY. 10

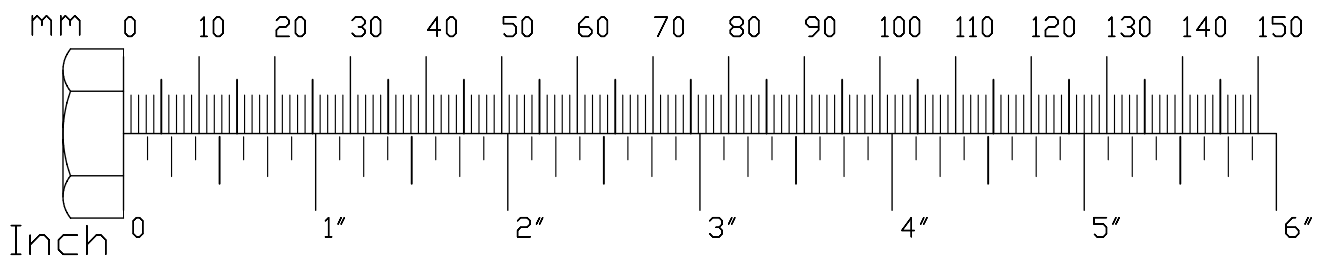
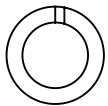

GDIB46LB Hardware Illustration

Part #13

M12 NYLON LOCK NUT

QTY. 8

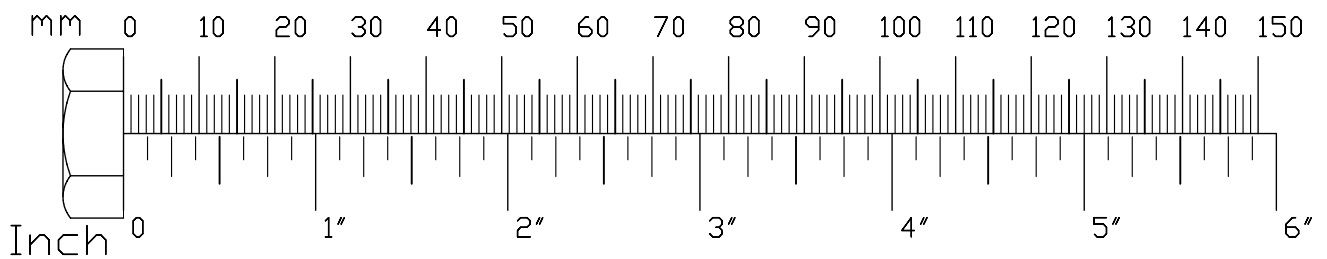
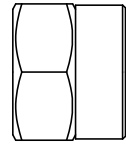
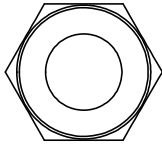

GDIB46LB Parts & Hardware List

Part#	Qty	Description
A	1	FRONT BASE FRAME
B	2	SIDE BASE FRAME
C	1	LOWER MIDDLE FRAME
D	1	RIGHT UPRIGHT
E	1	UPPER MIDDLE FRME
F	1	LEFT UPRIGHT
G	1	BACK FRAME SUPPORT
H	2	ADJUSTABLE UPRIGHT
J	1	SLIDER CARRIAGE
K	2	SEAT FRAME
L	2	BACK FRAME
M	1	HEIGHT ADJUSTMENT FRAME
N	1	PIVOT FRAME
P	3	FOAM ROLLER BAR
Q	3	STEEL BRACKET C-C 100mm
R	1	WEIGHT HORN
1	1	M12x85mm HEX HEAD BOLT
2	6	M12x75mm HEX HEAD BOLT
3	1	M12x70mm HEX HEAD BOLT
4	12	M10x20mm HEX HEAD BOLT
5	1	M10x20mm BUTTON HEAD CAP SCREW
6	10	M8x40mm HEX HEAD BOLT
7	16	M12 FLAT WASHER
8	12	M10 FLAT WASHER
9	1	M10 LOCK WASHER
10	1	M10 LARGE WASHER
11	10	M8 FLAT WASHER
12	10	M8 LOCK WASHER
13	8	M12 NYLON LOCK NUT
14	3	PLASTIC BUSHING, 55x55mm
15	1	TURN & LOCK POP PIN
16	1	THREADED STUD KNOB
17	3	T-HANDLE TURN & LOCK POP PIN
18	2	PLASTIC BUSHING, 60x60mm

GDIB46LB Parts & Hardware List

Part#	Qty	Description
19	1	T-HANDLE PULL PIN
20	4	PLASTIC END CAP, 25x25mm
21	4	FOOT CAP, 50x50mm
22	5	PLASTIC END CAP, 38x38mm
23	2	METAL BUSHING, $\varnothing 20 \times \varnothing 12.6 \times 10$ mm
24	1	QUICK RELEASE PULL PIN
25	6	FOAM ROLLER, $\varnothing 90 \times 185$ mm
26	6	PLASTIC END CAP, $\varnothing 60$ mm
27	1	ROUND DOME PLASTIC END CAP, $\varnothing 50$ mm
28	1	PLASTIC END CAP, 45x45mm
29	1	RUBBER BUMPER, $\varnothing 35 \times \varnothing 25 \times 35$ mm
30	1	RUBBER RING, $\varnothing 85 \times \varnothing 50 \times 10$ mm
31	1	SEAT PAD
32	1	BACK PAD

STEP**1**

Be careful to assemble all components in the sequence they are presented.

NOTE:

Finger tighten all hardware in this step. DO NOT wrench tighten until instructed. Some components may be pre-assembled. Nylon lock nuts will not fully screw onto bolts, they must be wrench tightened to fully go on.

- 1A.** Attach Right Upright (**D**) to Side Base Frame (**B**) using:
 - 2 - (#2) M12x75mm Hex Head Bolt**
 - 4 - (#7) M12 Flat Washer**
 - 2 - (#13) M12 Nylon Lock Nut**
 - 1 - (Q) Steel Bracket**

- 1B.** Attach Left Upright (**F**) to Side Base Frame (**B**) using:
 - 2 - (#2) M12x75mm Hex Head Bolt**
 - 4 - (#7) M12 Flat Washer**
 - 2 - (#13) M12 Nylon Lock Nut**
 - 1 - (Q) Steel Bracket**

- 1C.** Attach Lower Middle Frame (**C**) & Upper Middle Frame (**E**) to Right Upright (**D**) using:
 - 6 - (#4) M10x20mm Hex Head Bolt**
 - 6 - (#8) M10 Flat Washer**

- 1D.** Attach Lower Middle Frame (**C**) & Upper Middle Frame (**E**) to Left Upright (**F**) using:
 - 6 - (#4) M10x20mm Hex Head Bolt**
 - 6 - (#8) M10 Flat Washer**

- 1E.** Put Back Frame Support (**G**) between Uprights (**D & F**).

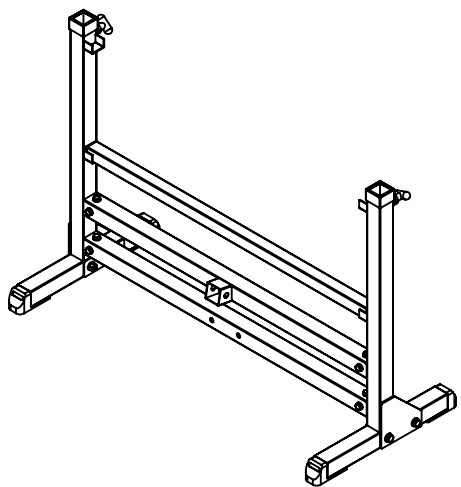

Above shows Step 1 assembled and completed.

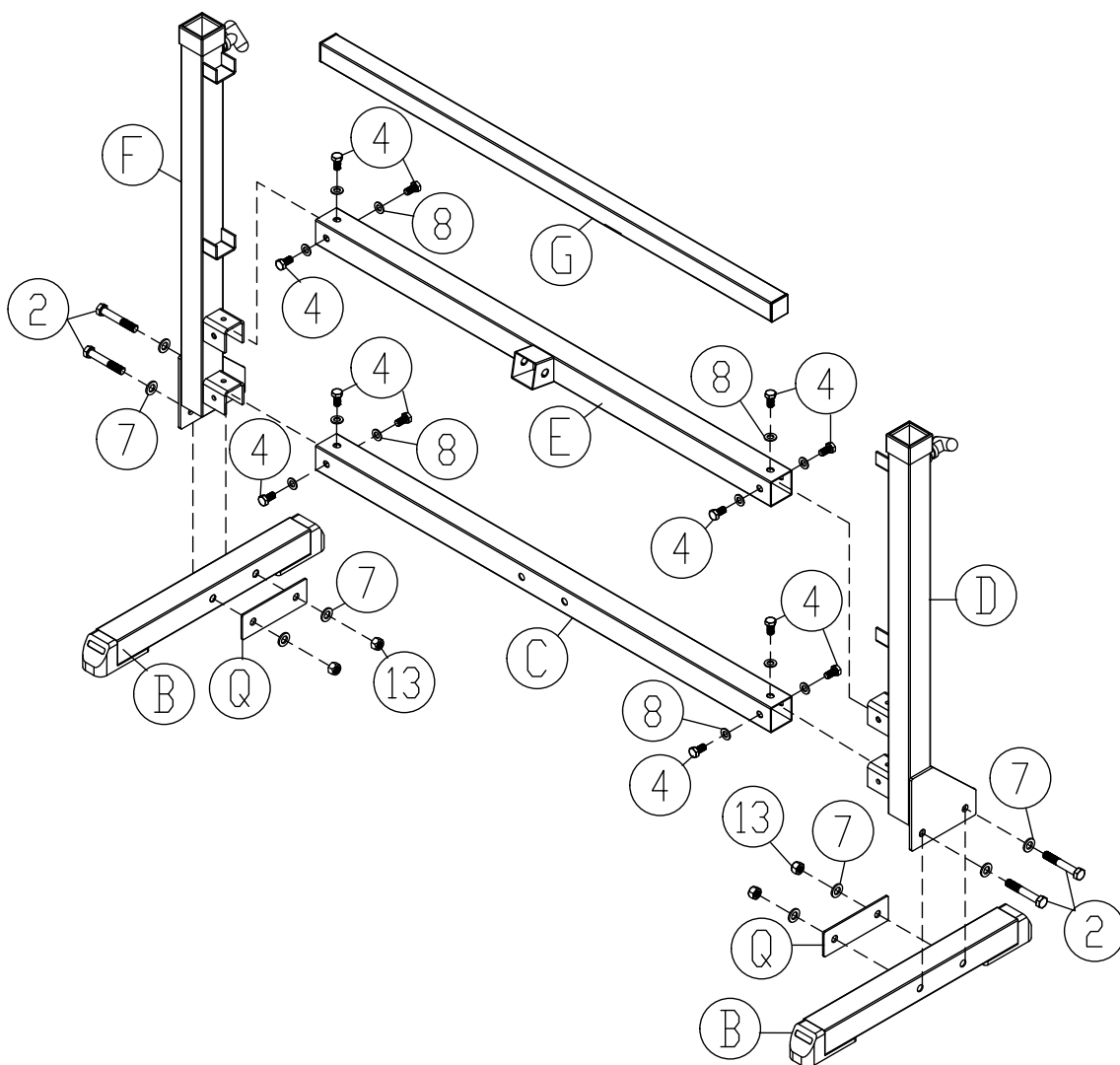

STEP**2**

Be careful to assemble all components in the sequence they are presented.

NOTE:

Wrench tighten ALL hardware at the end of STEP 2B. Some components may be pre-assembled. Nylon lock nuts will not fully screw onto bolts, they must be wrench tighten to fully go on.

- 2A.** Insert Sliding Carriage (**J**) onto Front Main Frame (**A**)

- 2B.** Attach Front Main Frame (**A**) to Lower & Upper Middle Frames (**C & E**) using:
 - 2 - (#2) M12x75mm Hex Head Bolt**
 - 1 - (#3) M12x70mm Hex Head Bolt**
 - 6 - (#7) M12 Flat Washer**
 - 3 - (#13) M12 Nylon Lock Nut**
 - 1 - (Q) Steel Bracket**

- 2C.** Insert Adjustable Uprights (**H**) into Left & Right Upright (**F & D**).

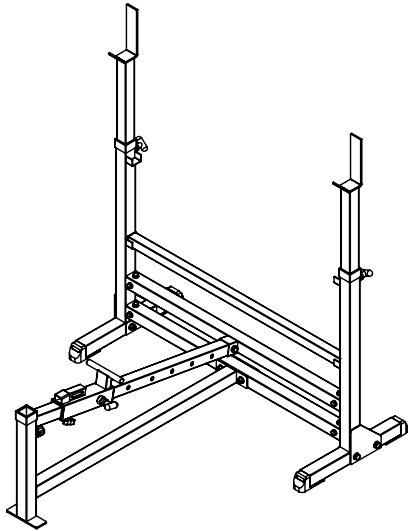

Above shows Step 2 assembled and completed.

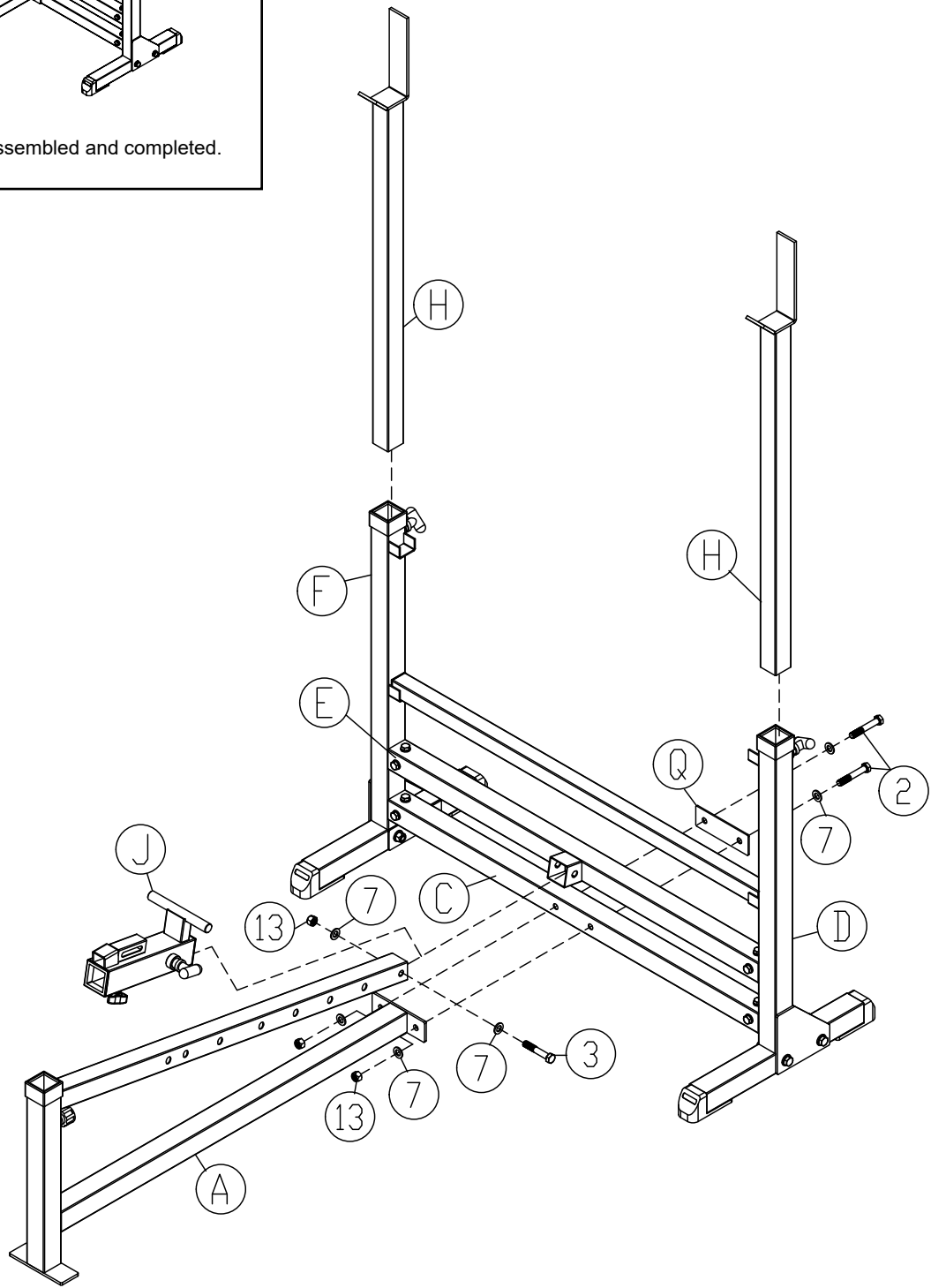

STEP**3**

Be careful to assemble all components in the sequence they are presented.

NOTE:

Wrench tighten ALL hardware at the end of STEP 3E. Some components may be pre-assembled. Nylon lock nuts will not fully screw onto bolts, they must be wrench tighten to fully go on.

- 3A.** Insert Seat Frames (**K**) onto Sliding Carriage (**J**).
- 3B.** Attach Seat Pad (**#31**) to Seat Frames (**K**) using:
 - 4 - (#6) M8x40mm Hex Head Bolt**
 - 4 - (#11) M8 Flat Washer**
 - 4 - (#12) M8 Lock Washer**
- 3C.** T-Handle Pull Pin (**#19**) is to be used for Seat Angle Adjustment.
- 3D.** Insert Back Frames (**L**) onto Sliding Carriage (**J**).
- 3E.** Attach Back Pad (**#32**) to Back Frames (**L**) using:
 - 6 - (#6) M8x40mm Hex Head Bolt**
 - 6 - (#11) M8 Flat Washer**
 - 6 - (#12) M8 Lock Washer**

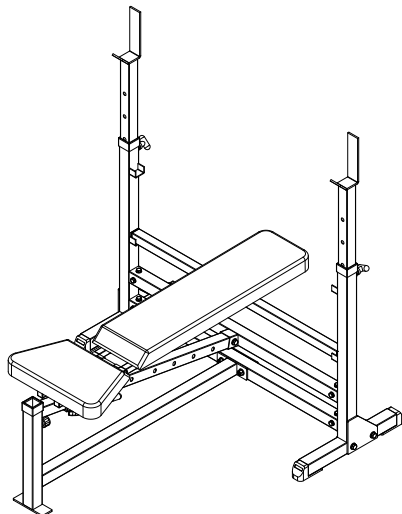

Above shows Step 3 assembled and completed.

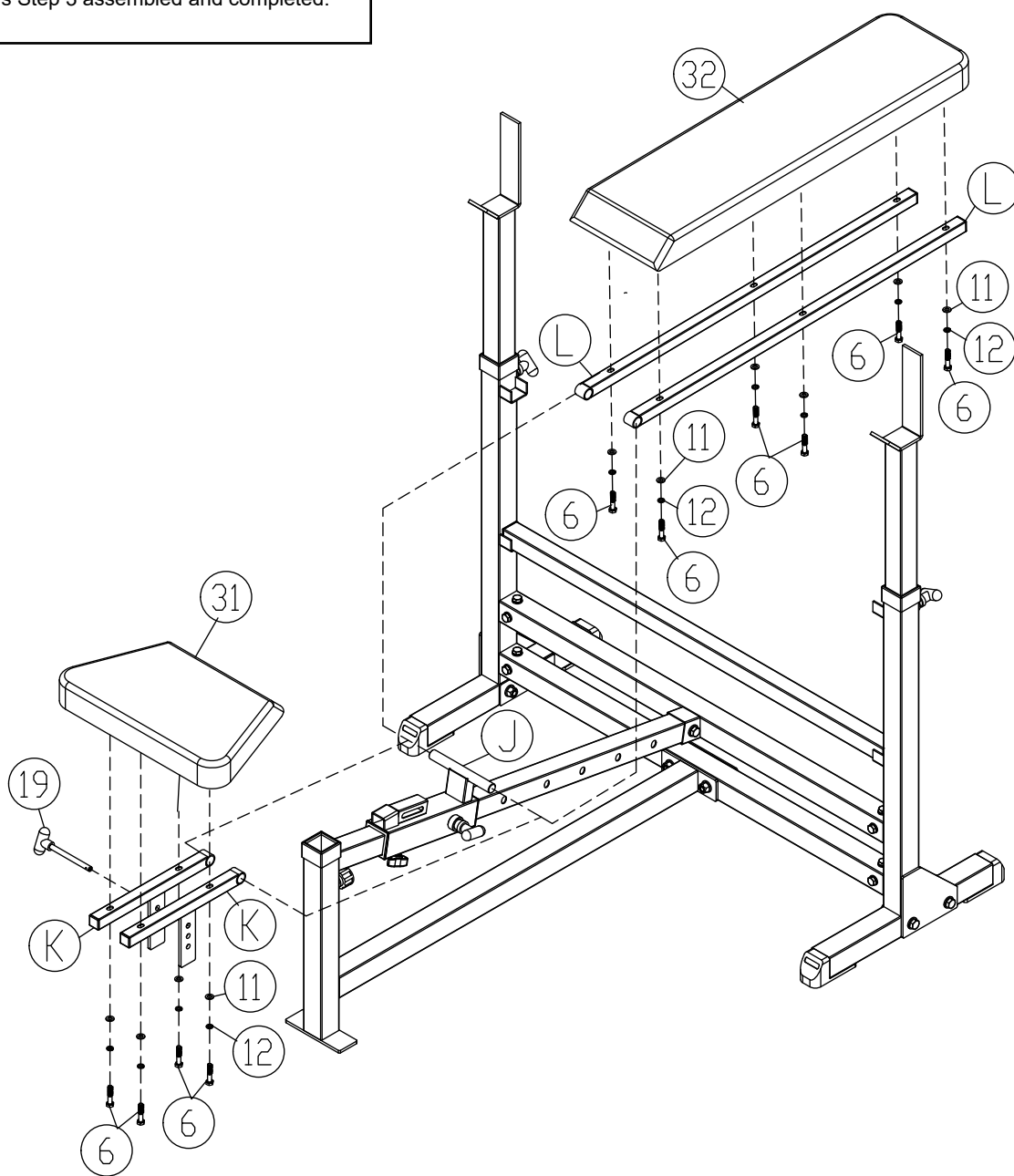

STEP**4**

Be careful to assemble all components in the sequence they are presented.

NOTE:

Wrench tighten ALL hardware at the end of STEP 4B. Some components may be pre-assembled. Nylon lock nuts will not fully screw onto bolts, they must be wrench tighten to fully go on.

- 4A.** Insert Height Adjustment Frame (**M**) into Front Base Frame (**A**).
- 4B.** Attach Pivot Frame (**N**) to Height Adjustment Frame (**M**) using:
 - 1 - (#1) M12x85mm Hex Head Bolt**
 - 2 - (#7) M12 Flat Washer**
 - 1 - (#13) M12 Nylon Lock Nut**
- 4C.** Insert Foam Roller Bars (**K**) into Height Adjustment Frame (**M**) & Pivot Frame (**N**).
- 4D.** Install Foam Rollers (**#25**) & Plastic End Caps (**#29**) onto each Foam Roller Bars (**K**).
- 4E.** Attach Weight Horn (**R**) to Pivot Frame (**N**) using:
 - 1 - (#1) M10x20mm Button Head Cap Screw**
 - 1 - (#9) M10 Lock Washer**
 - 1 - (#10) M10 Large Washer**
- 4F.** Insert Round Dome Plastic End Cap (**#27**) into Weight Horn (**R**).
- 4G.** Insert Rubber Ring (**#30**) onto Weight Horn (**R**).
- 4G.** Quick Release Pull Pin (**#24**) is to be used for Locking Pivot Frame (**N**) from rotating.

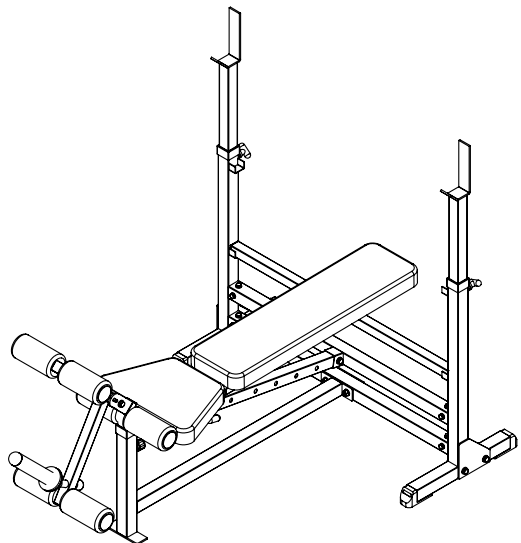

Above shows Step 4 assembled and completed.

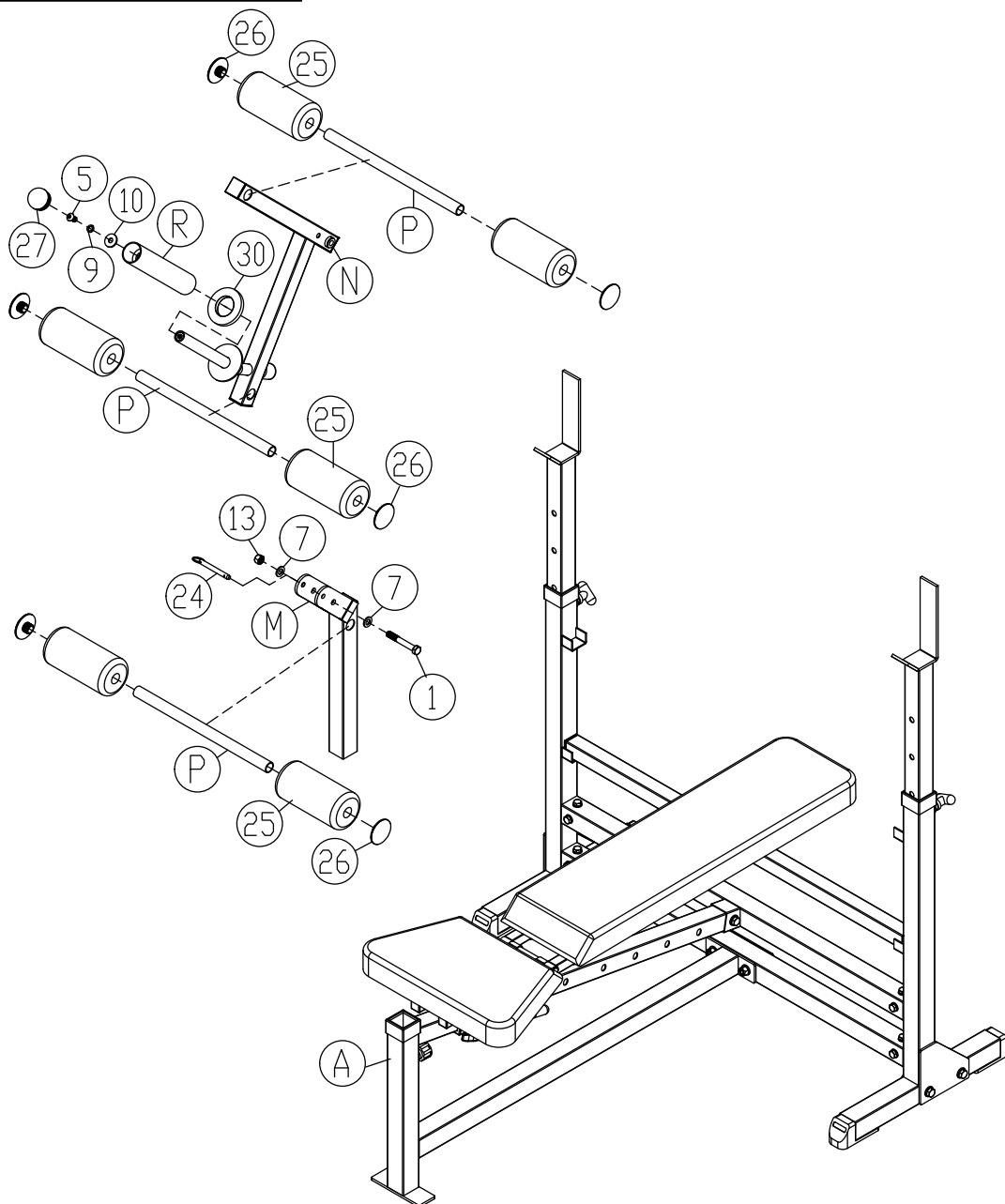

Notes



GDIB46LB

PLEASE WRITE YOUR SERIAL NUMBER IN THE BOXES BELOW

S/N # 000766----

1900 S. Des Plaines Ave.
Forest Park, IL 60130
Phone:(708)427-3555
Fax:(708)427-3556
Hours: M-F 8:30 - 5:00 CST

www.bodysolid.com

Copyright 2009. Body-Solid. All rights reserved. Body-Solid reserves the right to change design and specifications when we feel it will improve the product. Body-Solid machines maintain several patented and patent pending features and designs. All rights reserved on all design patents and utility patents.